

This drawing involves proprietary design rights of Tyco Electronics Corporation, and all design, manufacture, reproduction, use and sale rights regarding the same are expressly reserved. It is submitted for a specific purpose and the recipient by accepting this drawing, assumes custody and control and agrees to take reasonable precautions: (a) that this drawing will not be copied and reproduced, in whole or in part, or its contents revealed in any manner, or to any person except to meet the purpose for which it was delivered and (b) that any special features peculiar to this design will not be incorporated in other projects without the expressed written permission of Tyco Electronics Corporation.

REVISIONS			
EC	REV	DESCRIPTION	DATE
0S1Q-0337-04	A	INITIAL DRAWING	10/07/04
0S1Q-0436-04	B	ADDED DETAIL A FOR COMPLIANT PRESS FIT AND DETAIL B FOR OPTIONAL STYLE COMPLIANT TAIL ADDED NOTE 7 ON SHEETS 1 & 3	12/13/04

## NOTES: UNLESS OTHERWISE SPECIFIED

- PART NUMBER CHANGES AND OR DESIGN CHANGES AFFECTING ITEM INTERCHANGEABILITY REQUIRE PRIOR ELCON APPROVAL AND AUTHORIZATION BY REVISION TO THIS DRAWING
- MATERIALS:  
 INSULATORS: THERMPLASTIC, GLASS REINFORCED, COLOR: BLK  
 UL 94V-0 FLAMMABILITY RATED  
 SIGNAL CONTACTS: COPPER ALLOY  
 POWER CONTACTS: COPPER ALLOY
- FINISHES:  
 CONTACT PLATING: SELECTIVE GOLD PER MIL-G-45204, 0.000030" NOMINAL OVER NICKEL PER QQ-N-290  
 TERMINALS: TIN PLATED, MATTE FINISH, .000040" TO .000120" THICKNESS (PRE-PRODUCTION TERMINATION MAY BE TIN/LEAD PLATED)

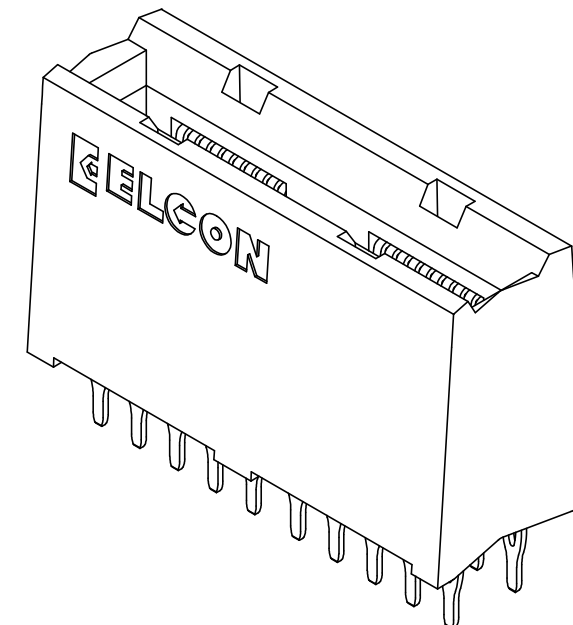

- CONNECTOR ACCEPT 0.093 ± .005" [2.36 ± 0.13] THICK PCB.
- RECOMMENDED PRINTED CIRCUIT HOLE  
 FINISHED HOLE:  $\phi 1.02 \pm .08$  [.040 ± .003]  
 DRILLED HOLE:  $\phi 1.15 \pm .013$  [.0453 ± .0005]  
 COPPER PLATE: .025 [.0010] MINIMUM (PER SURFACE)  
 TIN PLATE: .008 [.0003] MINIMUM (PER SURFACE)
- MACHINED PART 284-0492-00900 WILL BE REPLACED BY MOLDED PART 284-0492-11000 WHEN TOOLING BECOMES AVAILABLE.
- TO AVOID CONTACT DAMAGE, REMOVE SHARP PCB EDGE.

- ITEMS PROVIDED TO THIS SPECIFICATION TO BE PERMANENTLY IDENTIFIED PER THE FOLLOWING IDENTIFIER:

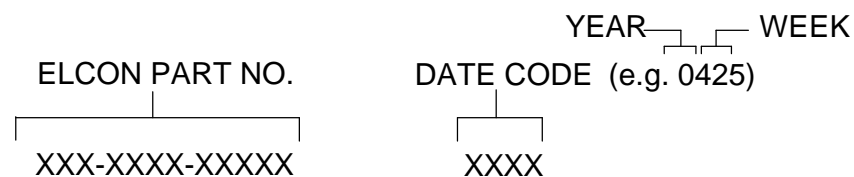

- REFERENCE ELCON PART NO. 284-0492-11000  
284-0492-00900

OR MM [INCH]	DRAWN R. Thein	DATE 09/15/04	Tyco Electronics Corporation Menlo Park, CA 94025		
 THIRD ANGLE PROJECTION	CHECKED		TITLE <b>SOCKET CONNECTOR, CROWNEDGE 2 SEGMENTS, COMPLIANT TAIL, .093" BLADE</b> PN: 284-0492-11000 (MOLDED) PN: 284-0492-00900 (MACHINED)		
UNLESS OTHERWISE SPECIFIED DIMENSIONS ARE IN MILLIMETERS [INCH]	APPROVED				
TOLERANCES	APPROVED D. CHAU	12/13/04	SIZE <b>B</b>	DWG NUMBER <b>C</b> = 1766354	REV. <b>B</b>
ANGLES ± 2.0°	DCA APPROVED M. ALIM	12/15/04			
DECIMALS	FILE NAME	SC1766354B.SLDDRW	DWG SCALE: 3 = 1		SH 1 OF 3
.XX ± 0.25 [.010]					
.X ± 0.5 [.02]					

This drawing involves proprietary design rights of Tyco Electronics Corporation, and all design, manufacture, reproduction, use and sale rights regarding the same are expressly reserved. It is submitted for a specific purpose and the recipient by accepting this drawing, assumes custody and control and agrees to take reasonable precautions: (a) that this drawing will not be copied and reproduced, in whole or in part, or its contents revealed in any manner, or to any person except to meet the purpose for which it was delivered and (b) that any special features peculiar to this design will not be incorporated in other projects without the expressed written permission of Tyco Electronics Corporation.

REVISIONS			
EC	REV	DESCRIPTION	DATE
		SEE SHEET 1	

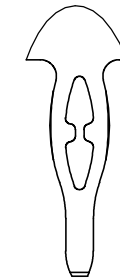
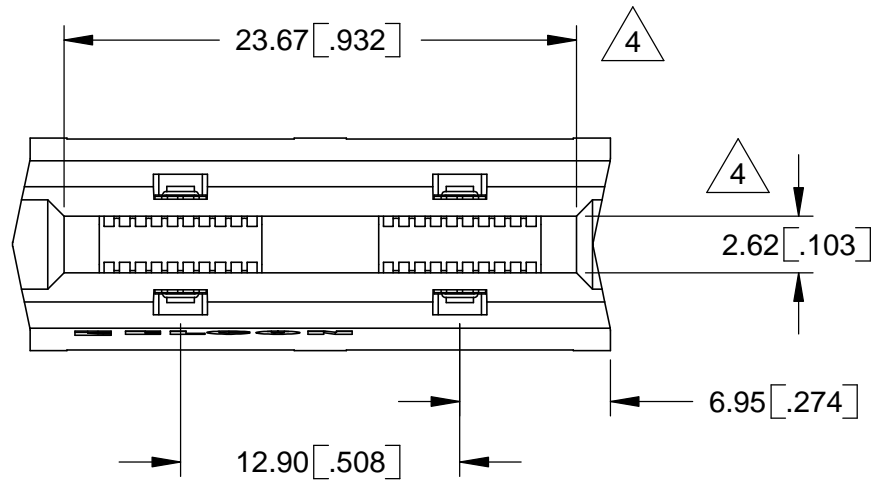

DETAIL B  
OPTIONAL STYLE  
COMPLIANT PRESS FIT  
SCALE 6 : 1

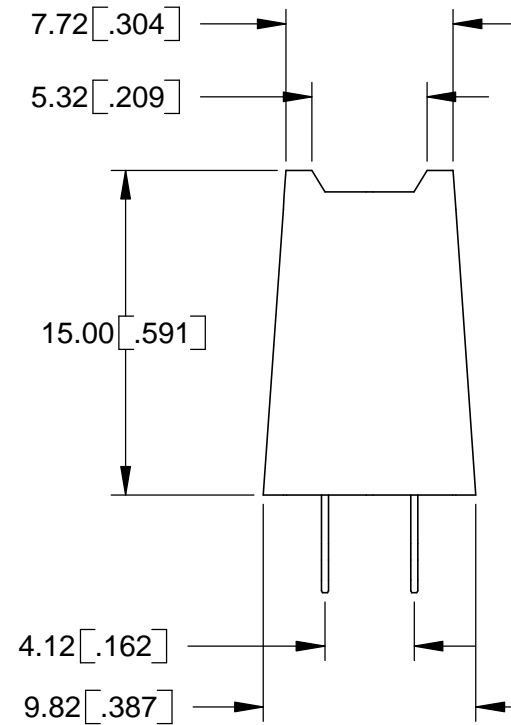
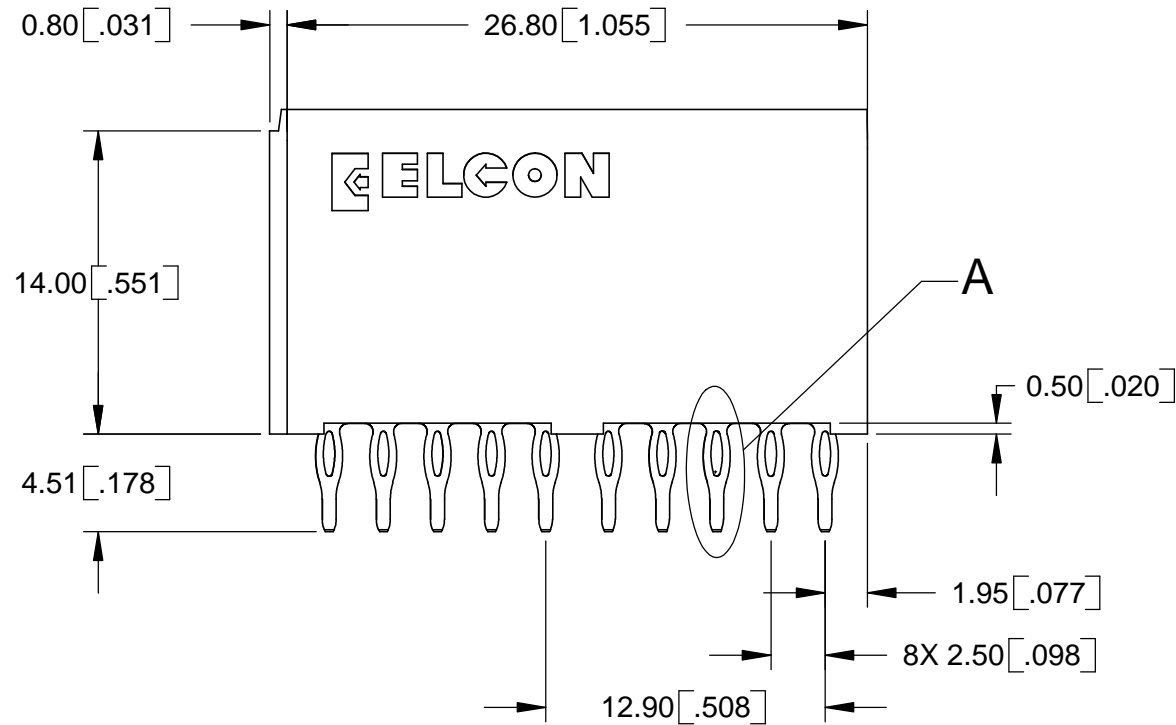

DETAIL A  
COMPLIANT PRESS FIT  
SCALE 6:1

<p>THIRD ANGLE PROJECTION</p> <p>UNLESS OTHERWISE SPECIFIED DIMENSIONS ARE IN MILLIMETERS [INCH]</p> <p>TOLERANCES</p> <p>ANGLES ± 2.0°</p> <p>DECIMALS</p> <p>.XX ± 0.25 [.010]</p> <p>.X ± 0.5 [.02]</p>	<p>DRAWN</p> <p>R. Thein</p>	<p>DATE</p> <p>09/15/04</p>	<p>Tyco Electronics Corporation Menlo Park, CA 94025</p>
	<p>CHECKED</p>	<p>APPROVED</p>	<p>TITLE</p> <p>SOCKET CONNECTOR, CROWNEDGE 2 SEGMENTS, COMPLIANT TAIL, .093" BLADE PN: 284-0492-11000 (MOLDED) PN: 284-0492-00900 (MACHINED) </p>
<p>APPROVED</p> <p>D. CHAU</p> <p>12/13/04</p>	<p>DCA APPROVED</p> <p>M. ALIM</p> <p>12/15/04</p>	<p>SIZE</p> <p><b>B</b></p>	<p>DWG NUMBER</p> <p><b>C</b> = 1766354</p>
<p>FILE NAME</p> <p>SC1766354B.SLDDRW</p>	<p>DWG SCALE: 3 = 1</p>	<p>REV.</p> <p><b>B</b></p>	<p>SH 2 OF 3</p>

This drawing involves proprietary design rights of Tyco Electronics Corporation, and all design, manufacture, reproduction, use and sale rights regarding the same are expressly reserved. It is submitted for a specific purpose and the recipient by accepting this drawing, assumes custody and control and agrees to take reasonable precautions: (a) that this drawing will not be copied and reproduced, in whole or in part, or its contents revealed in any manner, or to any person except to meet the purpose for which it was delivered and (b) that any special features peculiar to this design will not be incorporated in other projects without the expressed written permission of Tyco Electronics Corporation.

REVISIONS			
EC	REV	DESCRIPTION	DATE
		SEE SHEET 1	

B

B

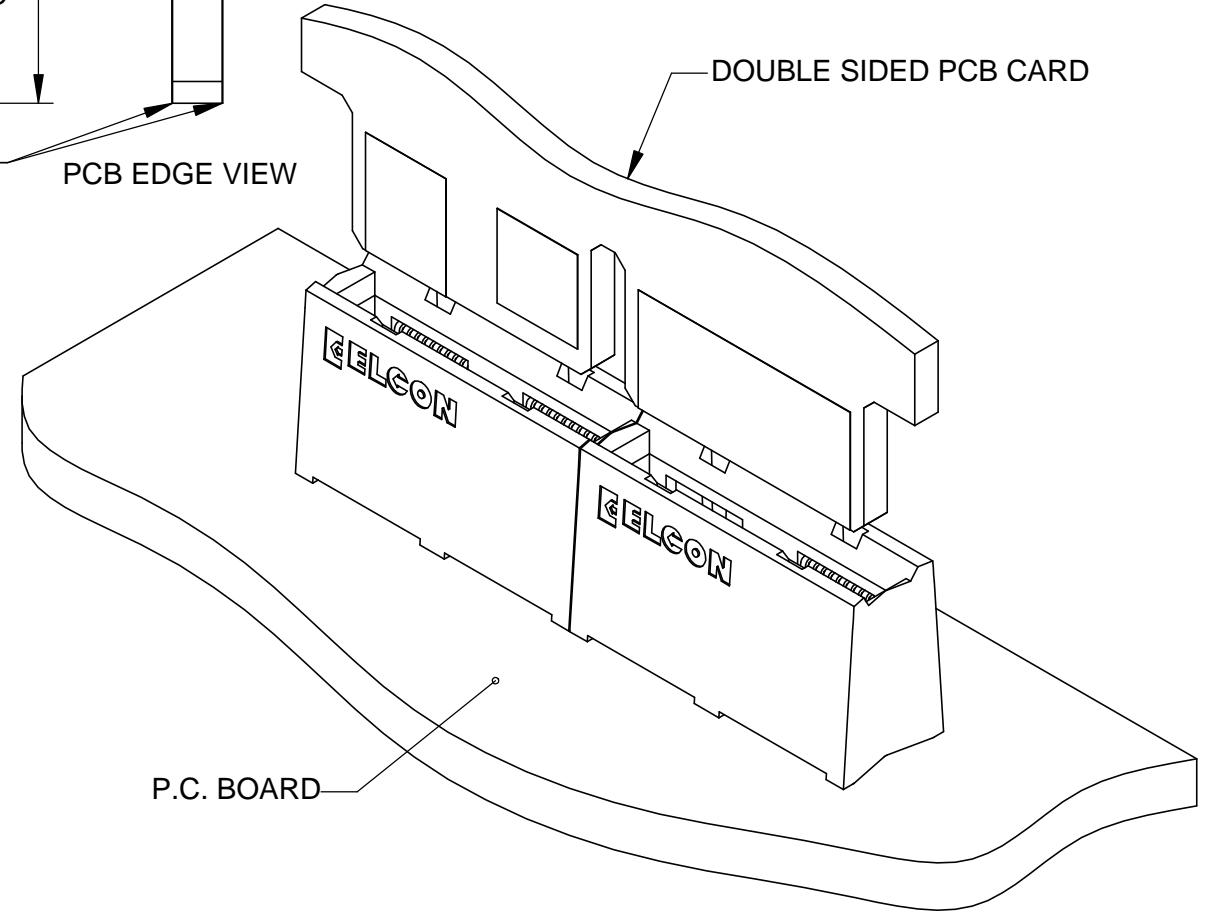
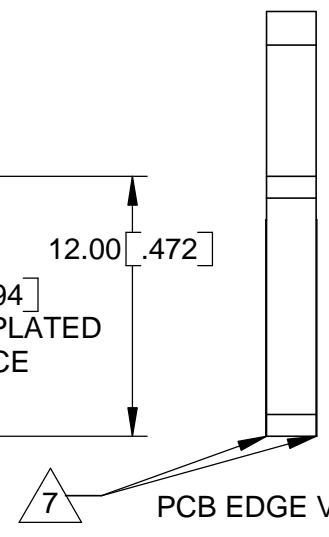
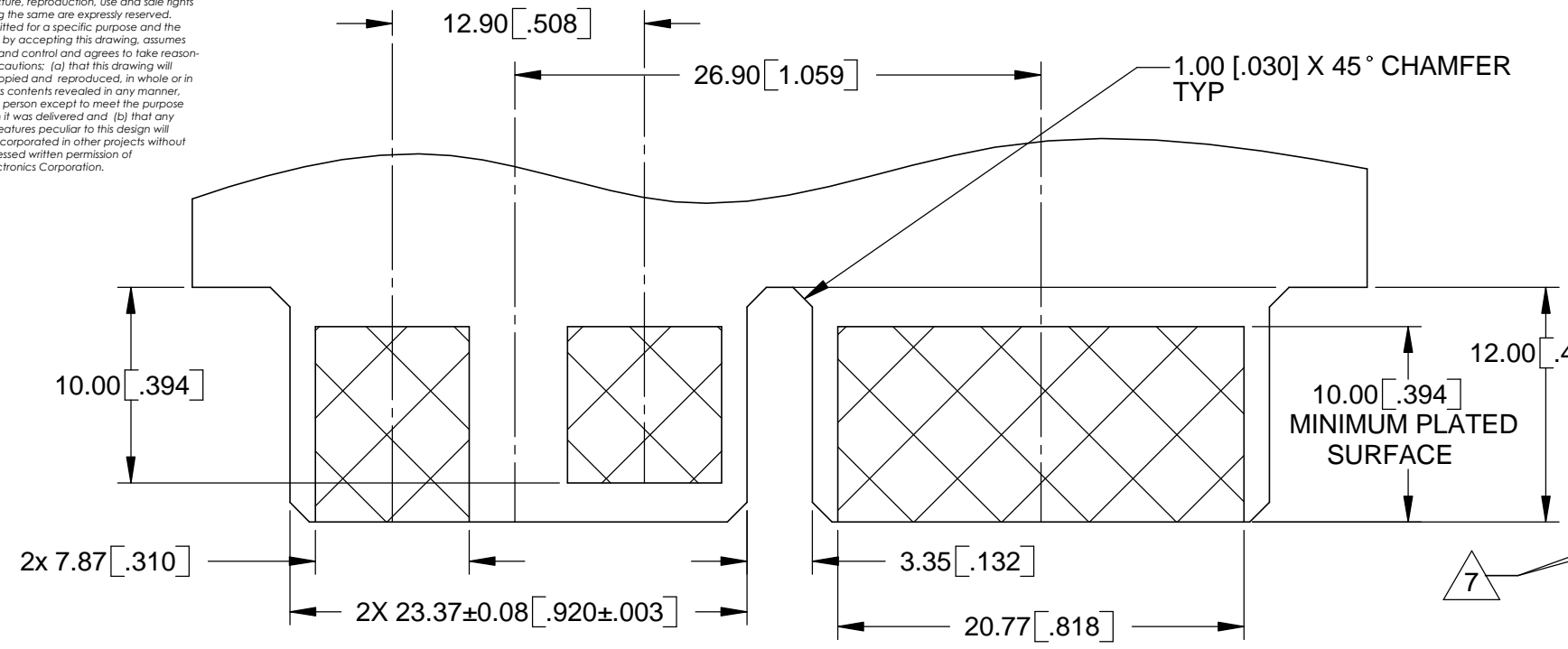

A

A

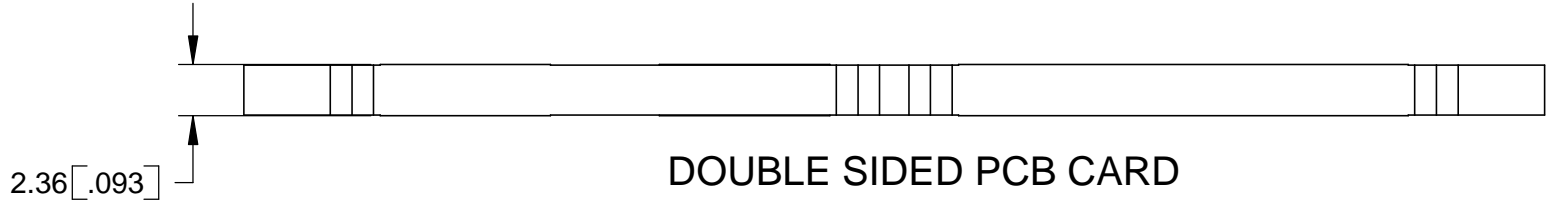

DOUBLE SIDED PCB CARD

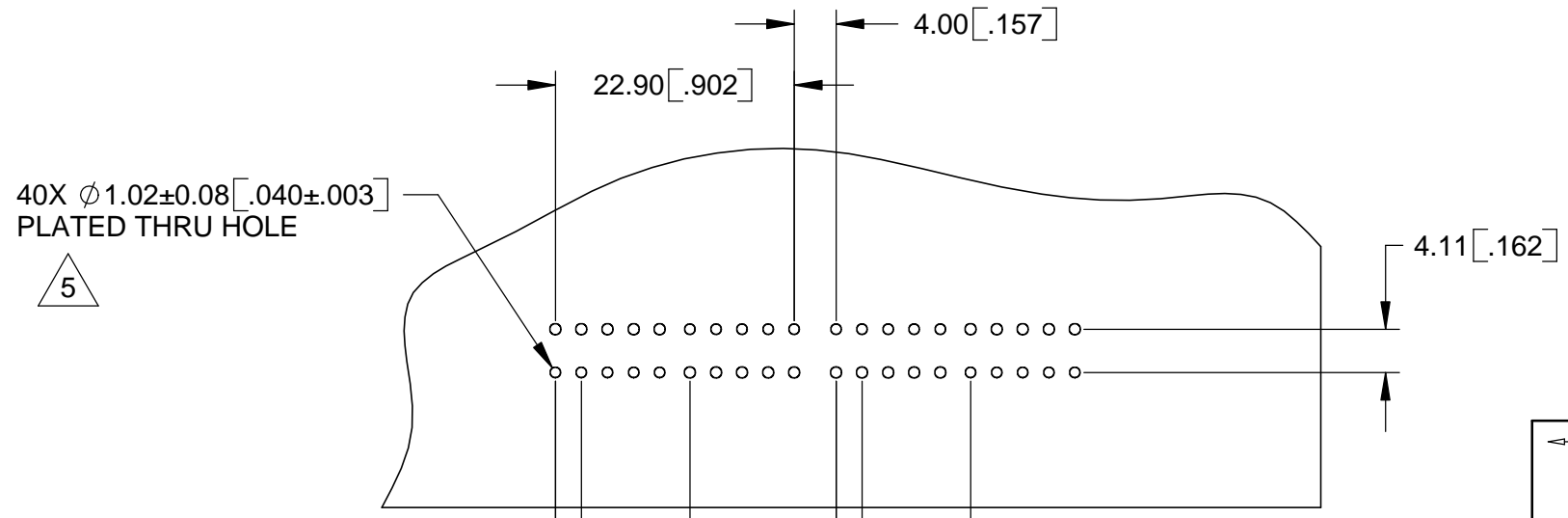

5 RECOMMENDED PCB LAYOUT

 THIRD ANGLE PROJECTION UNLESS OTHERWISE SPECIFIED DIMENSIONS ARE IN MILLIMETERS [INCH] TOLERANCES ANGLES ± 2.0° DECIMALS .XX ± 0.25 [.010] .X ± 0.5 [.02]	DRAWN R. Thein CHECKED APPROVED APPROVED D. CHAU DCA APPROVED M. ALIM FILE NAME SC1766354B.SLDDRW	DATE 06/02/04  12/13/04 12/15/04	Tyco Electronics Corporation Menlo Park, CA 94025 	TITLE <b>USER INFORMATION RECOMMENDED PCB LAYOUT AND MATING BOARD</b>	SIZE <b>B</b>	DWG NUMBER <b>C = 1766354</b>	REV. <b>B</b>
	DWG SCALE: 3 = 1		SH 3 OF 3				

4

3

2

1



Компания «ЭлектроПласт» предлагает заключение долгосрочных отношений при поставках импортных электронных компонентов на взаимовыгодных условиях!

Наши преимущества:

- Оперативные поставки широкого спектра электронных компонентов отечественного и импортного производства напрямую от производителей и с крупнейших мировых складов;
- Поставка более 17-ти миллионов наименований электронных компонентов;
- Поставка сложных, дефицитных, либо снятых с производства позиций;
- Оперативные сроки поставки под заказ (от 5 рабочих дней);
- Экспресс доставка в любую точку России;
- Техническая поддержка проекта, помощь в подборе аналогов, поставка прототипов;
- Система менеджмента качества сертифицирована по Международному стандарту ISO 9001;
- Лицензия ФСБ на осуществление работ с использованием сведений, составляющих государственную тайну;
- Поставка специализированных компонентов (Xilinx, Altera, Analog Devices, Intersil, Interpoint, Microsemi, Aeroflex, Peregrine, Syfer, Eurofarad, Texas Instrument, Miteq, Cobham, E2V, MA-COM, Hittite, Mini-Circuits, General Dynamics и др.);

Помимо этого, одним из направлений компании «ЭлектроПласт» является направление «Источники питания». Мы предлагаем Вам помощь Конструкторского отдела:

- Подбор оптимального решения, техническое обоснование при выборе компонента;
- Подбор аналогов;
- Консультации по применению компонента;
- Поставка образцов и прототипов;
- Техническая поддержка проекта;
- Защита от снятия компонента с производства.



#### Как с нами связаться

**Телефон:** 8 (812) 309 58 32 (многоканальный)

**Факс:** 8 (812) 320-02-42

**Электронная почта:** [org@eplast1.ru](mailto:org@eplast1.ru)

**Адрес:** 198099, г. Санкт-Петербург, ул. Калинина, дом 2, корпус 4, литера А.