

REVISIONS					
#	LY#	DESCRIPTION	DATE	OWN	APVD
F34		REVISED PER ECO-17-007768	30MAY2017	DLD	DCM
F35		REVISED PER ECO-17-014872	24OCT2017	JMS	CM
F36		REVISED PER ECO-18-005691	16APR2018	JMS	CM
F37		ECO-18-013134	13SEP2018	KP	CM

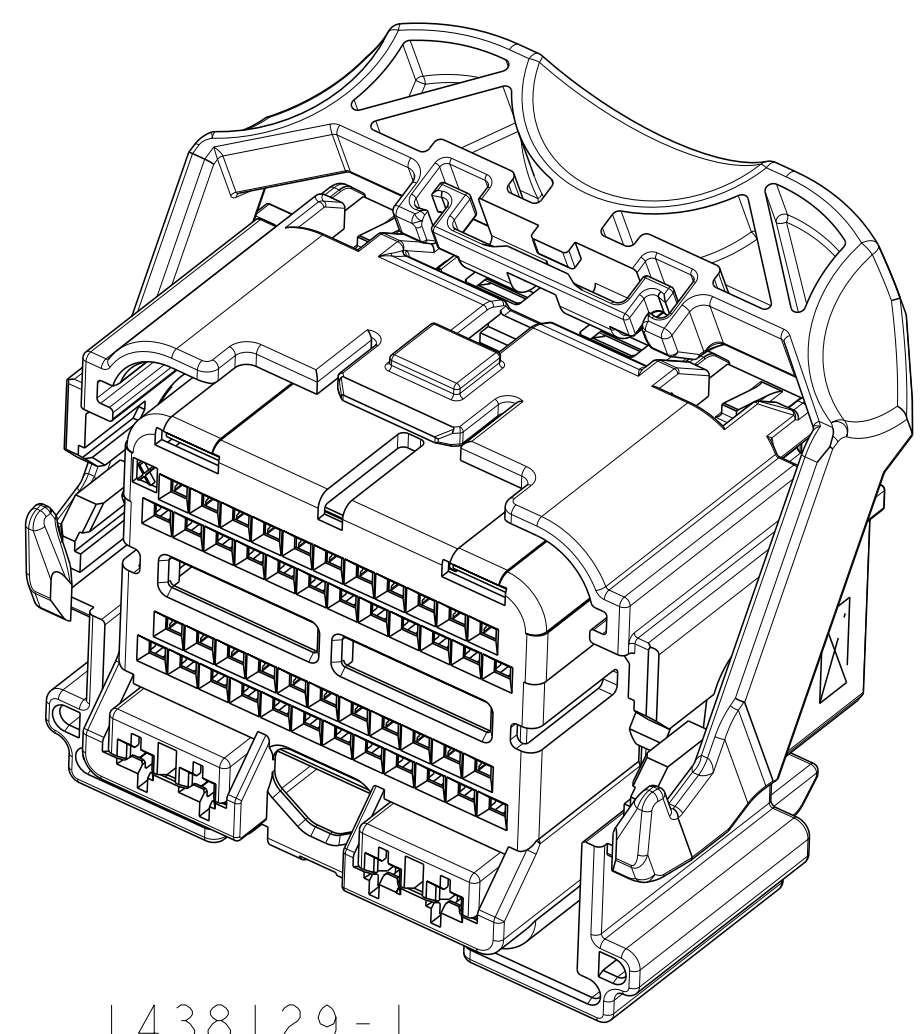

1438129-1
 SHOWN WITH SPACER
 IN SEATED POSITION

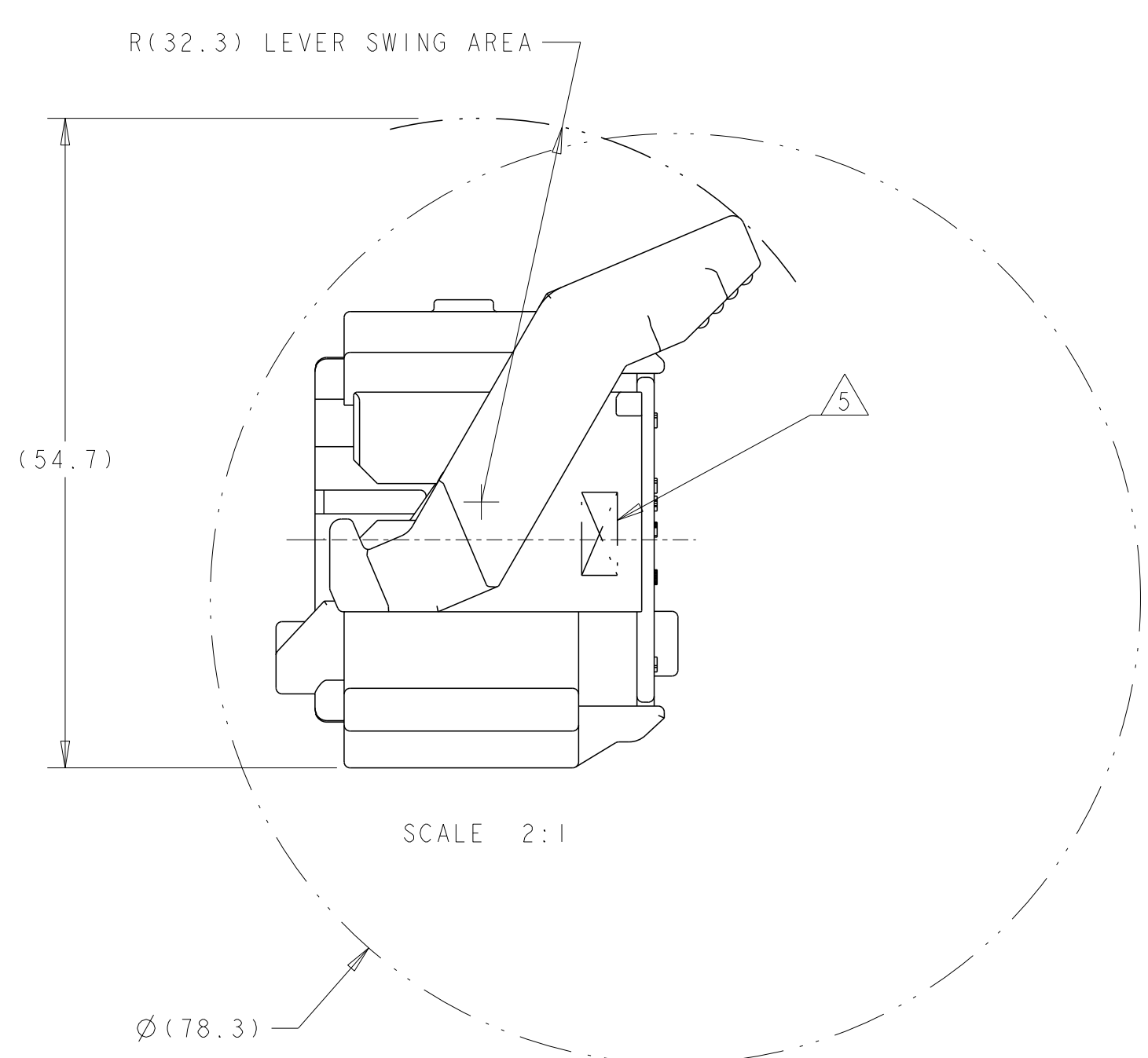
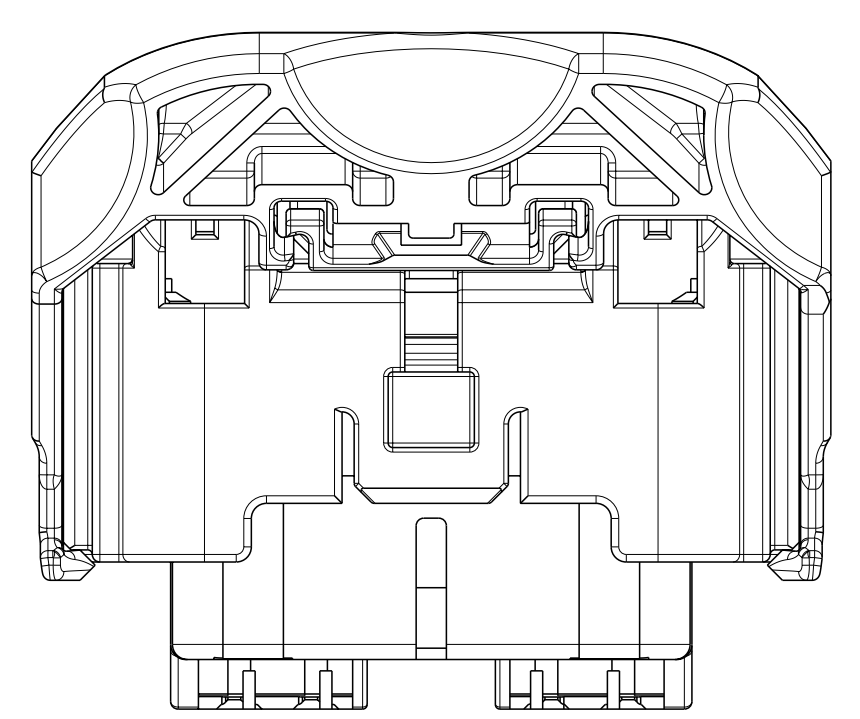

- 1. PRINT PART NUMBER (5S4T-14A464-L*-***, 5S4T-14A464-M*-***, 5S4T-14A464-N*-***) AND TRACEABILITY (YY : 2 DIGIT YEAR, JJJ = JULIAN DATE, HH = 2 DIGIT MILITARY HOUR CODE IN THE LOCATION AT ASSEMBLY. SEE SHEET 3 THRU 7 (-*) PART NUMBERS.
- 2. APPLICABLE MOLEX (1.5) POWER TERMINAL PART NUMBERS:
 33012-0002 TIN 0.50-1.50mm²
- 3. CAM LEVER AND SPACER ARE SHIPPED IN THEIR PRE-ASSEMBLED POSITIONS.
- 4. REFERENCE TE CONNECTIVITY INSTRUCTION SHEET 408-8893.
- 5. COMPANY LOGO.

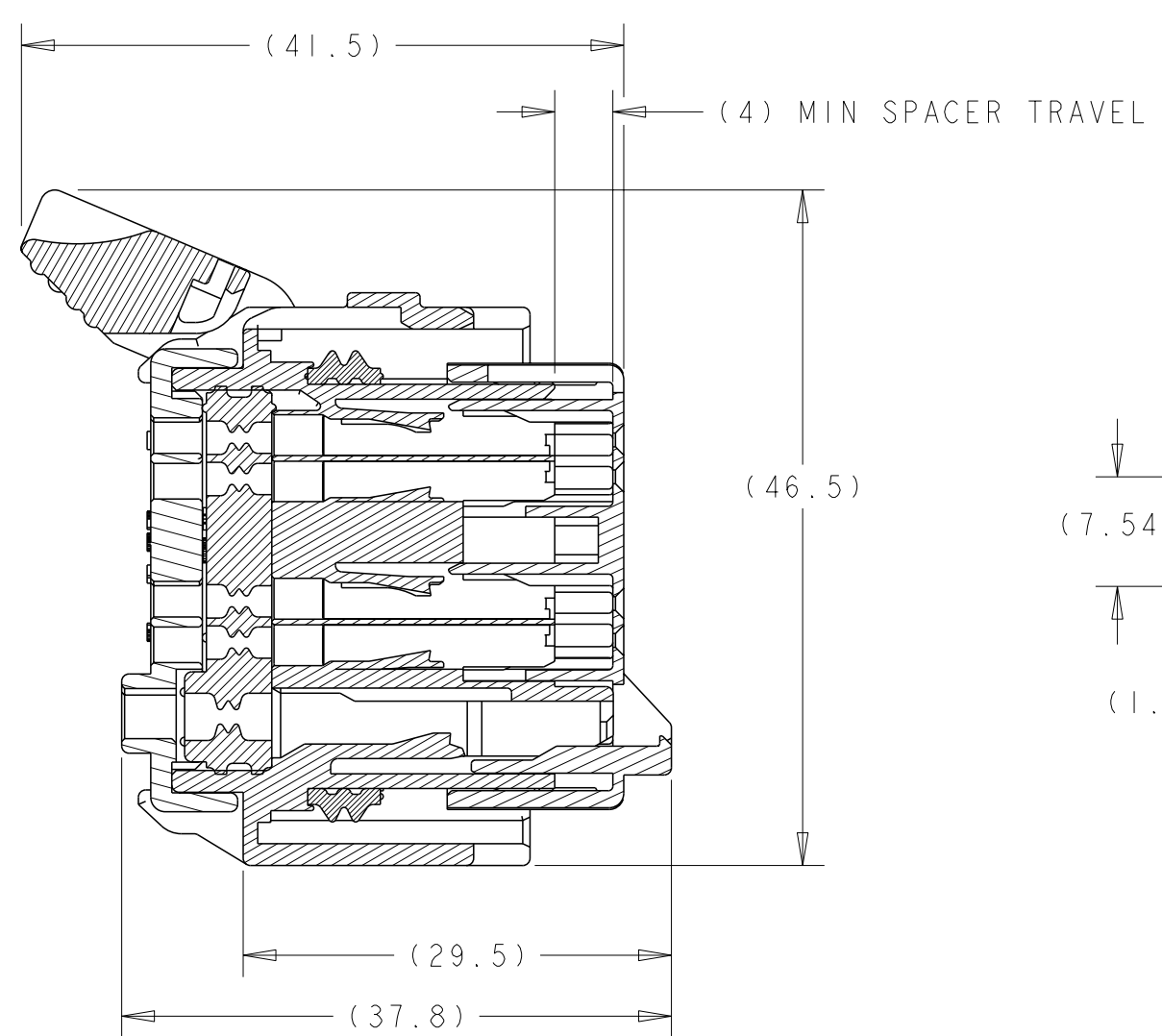

SECTION A-A
 SPACER AND LEVER IN
 PRE-SEATED POSITION
 (DELIVERY CONDITION)

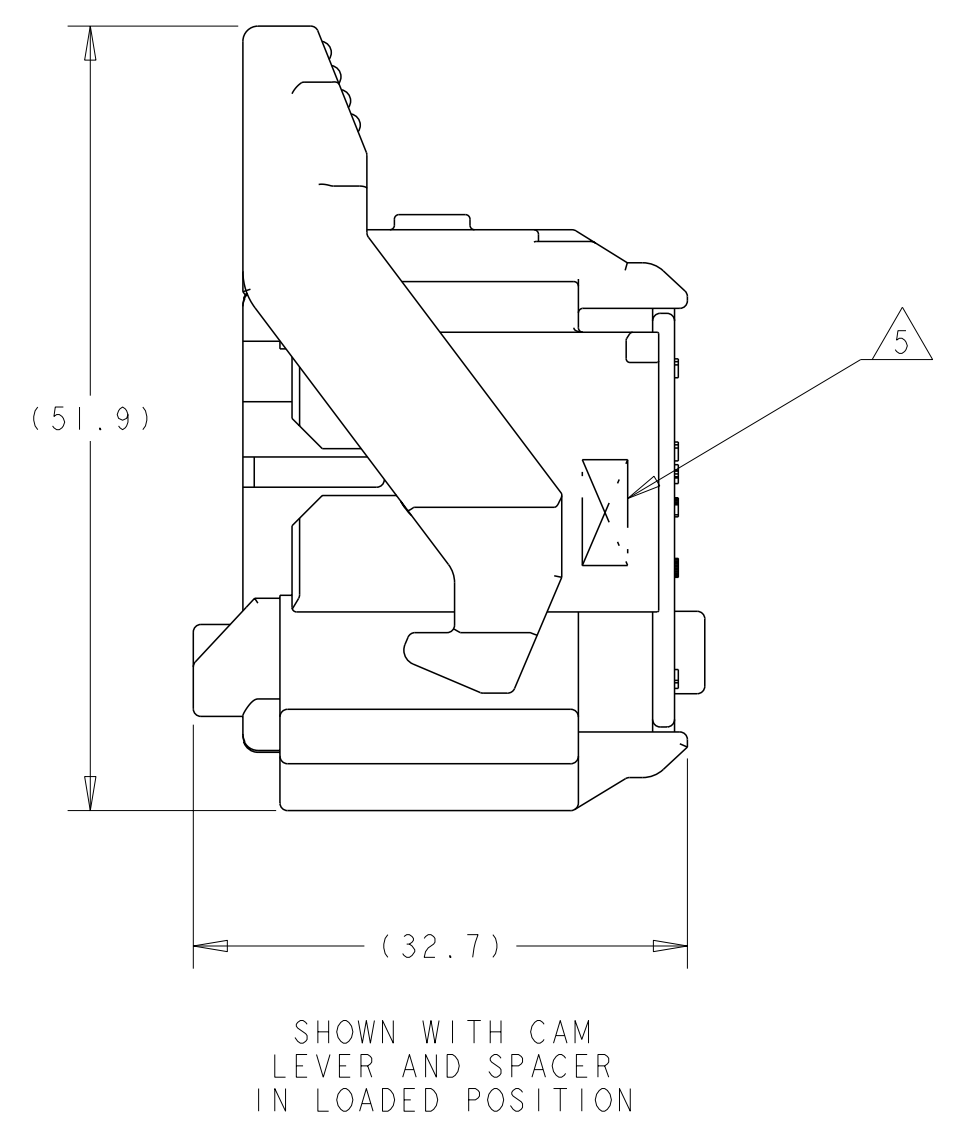
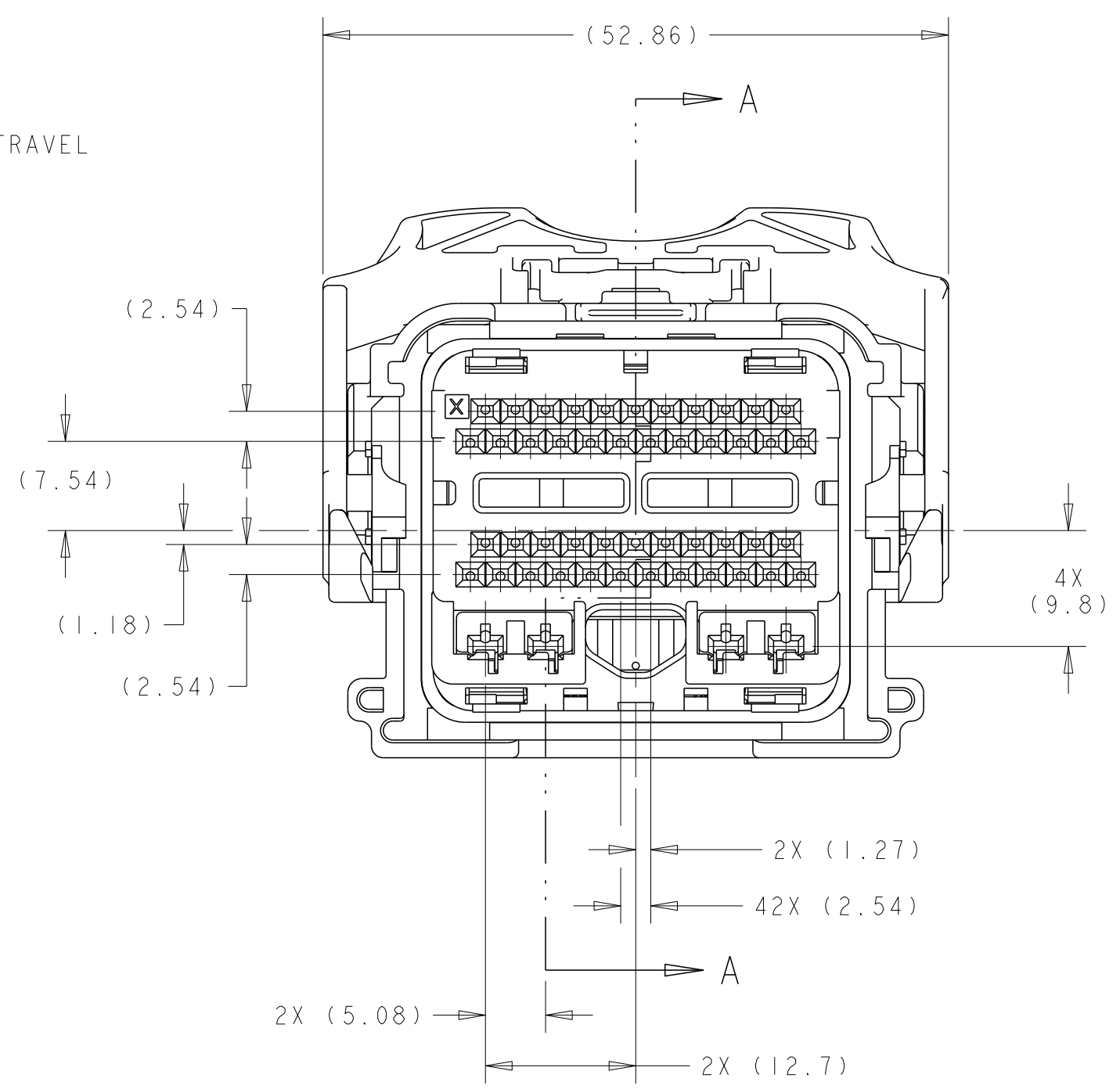

SHOWN WITH CAM
 LEVER AND SPACER
 IN LOADED POSITION

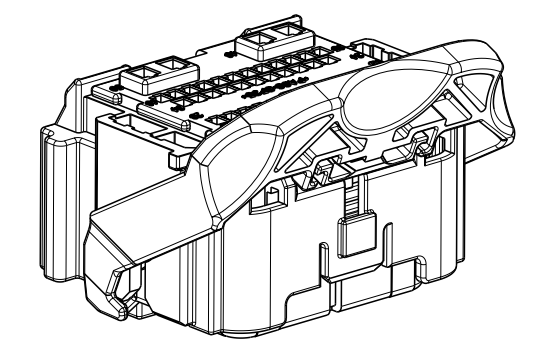
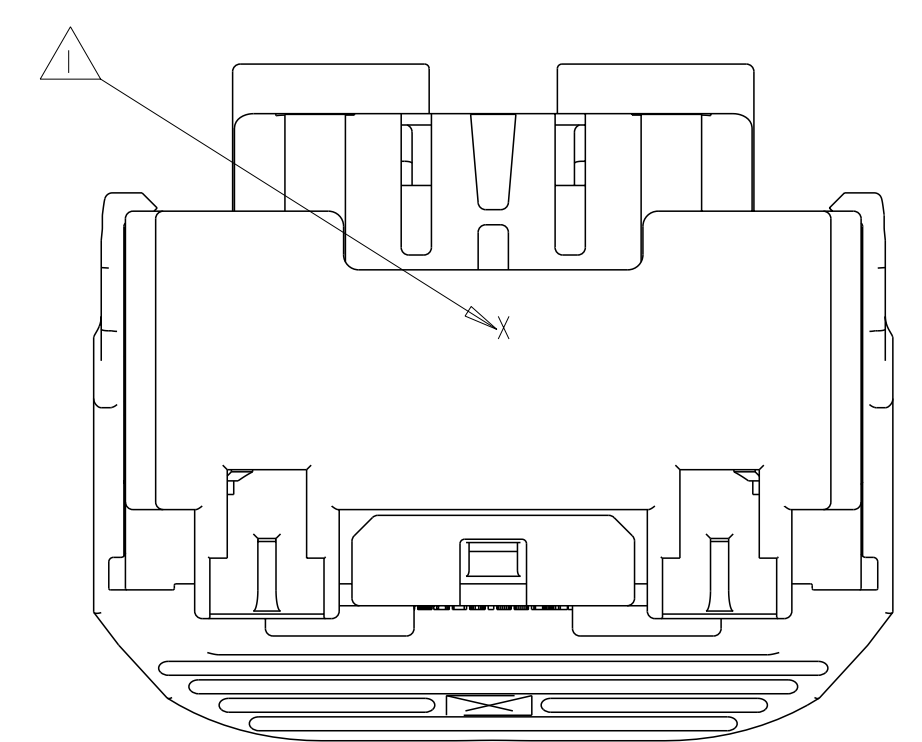

SCALE 1:1

APPLICABLE COMPONENTS (FOR REFERENCE ONLY)						
DESCRIPTION	NOMINAL TERMINAL SIZE	COLOR/PLATING	FORD COMPONENT PART NUMBER	SUPPLIER PART NUMBER	MATERIAL/SPECIFICATION NUMBER	SAE WIRE SIZE
TERMINAL - FEMALE (Ag)	0.64 (CAT. 0)	SILVER	7S4T-14474-AA	I393366-2	COPPER ALLOY/SILVER PLATE	20AWG
TERMINAL - FEMALE (Ag)	0.64 (CAT. 0)	SILVER	7S4T-14474-BA	I393367-2	COPPER ALLOY/SILVER PLATE	18AWG
TERMINAL - FEMALE (Sn)	0.64 (CAT. 0)	TIN	1L2T-14474-AA	I393366-1	COPPER ALLOY/TIN PLATE	20AWG
TERMINAL - FEMALE (Sn)	0.64 (CAT. 0)	TIN	1L2T-14474-BA	I393367-1	COPPER ALLOY/TIN PLATE	18AWG
TERMINAL - FEMALE (Au)	0.64 (CAT. 0)	GOLD	1L2T-14474-CA	I393365-1	COPPER ALLOY/GOLD PLATE	20AWG
TERMINAL - FEMALE (Au)	0.64 (CAT. 0)	GOLD	1L2T-14474-DA	I393364-1	COPPER ALLOY/GOLD PLATE	18AWG
TERMINAL - FEMALE (Au)	0.64 (CAT. 0)	GOLD	1L2T-14474-DA	I393364-1	COPPER ALLOY/GOLD PLATE	22AWG

ANY DESIGN CHANGES ON THIS ASSEMBLY MAY
 ALSO BE REQUIRED ON ASSEMBLY DRAWING 1438691

SEE TABLES
 SHEETS 3 THRU 7
 PART NUMBER

THIS DRAWING IS A CONTROLLED DOCUMENT.		OWN: R. VESTAL 15APR2005	
DIMENSIONS: mm		CHK: T. VALASEK 15APR2005	
TOLERANCES UNLESS OTHERWISE SPECIFIED:		APVD: T. VALASEK 15APR2005	NAME: 50-WAY HARNESS ASSEMBLY, PCM
0 PLC ± 1 PLC ±0.3 2 PLC ±0.10 3 PLC ± 4 PLC ± ANGLES ±1° FINISH		PRODUCT SPEC: -	APPLICATION SPEC: -
MATERIAL: -		WEIGHT: -	RESTRICTED TO: -
CUSTOMER DRAWING		SIZE: A1 00779	SCALE: 1:1 SHEET 1 OF 10 REV F37

REVISIONS				
P	LY#	DESCRIPTION	DATE	OWN
-	-	SEE SHEET 1	-	-

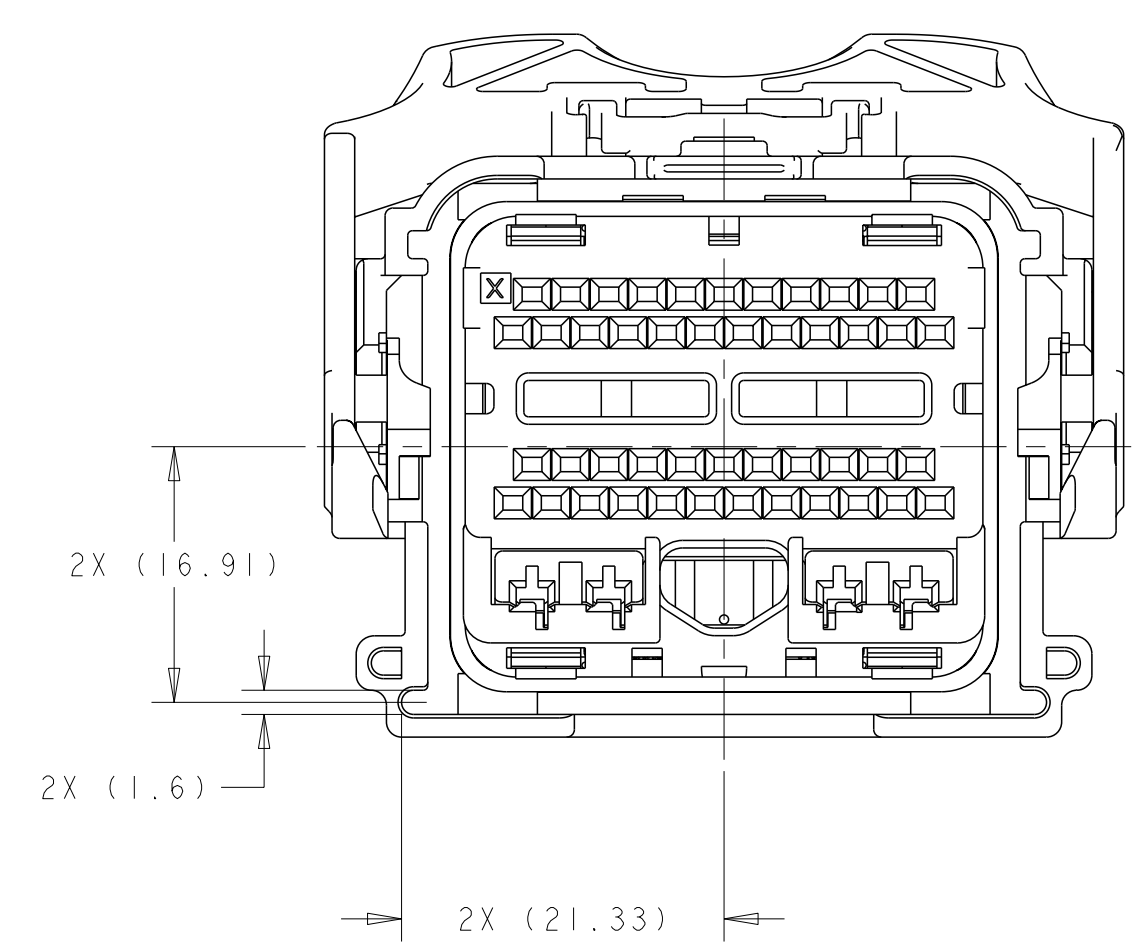
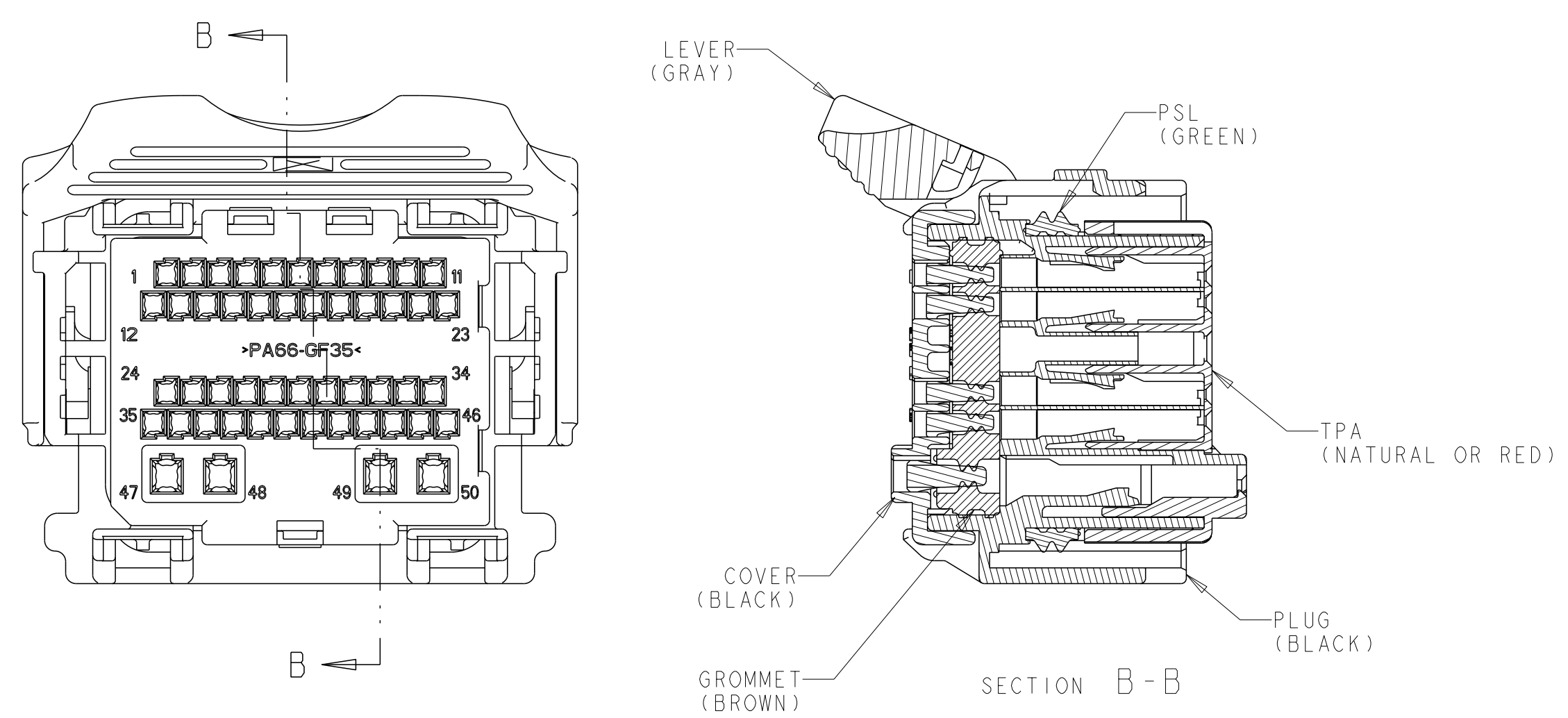

1438129-1
KEYING OPTION "A"

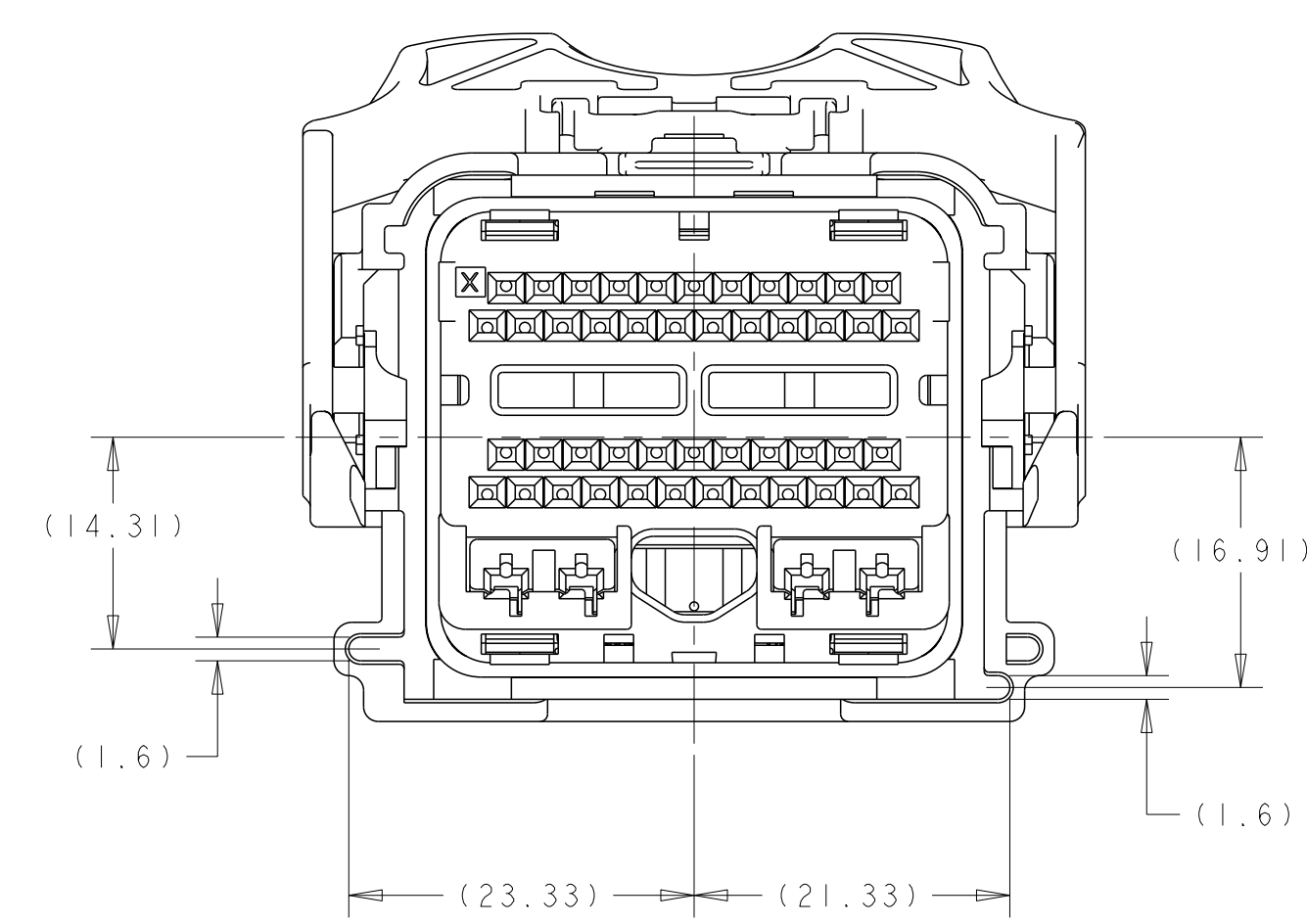

1438129-2
KEYING OPTION "B"

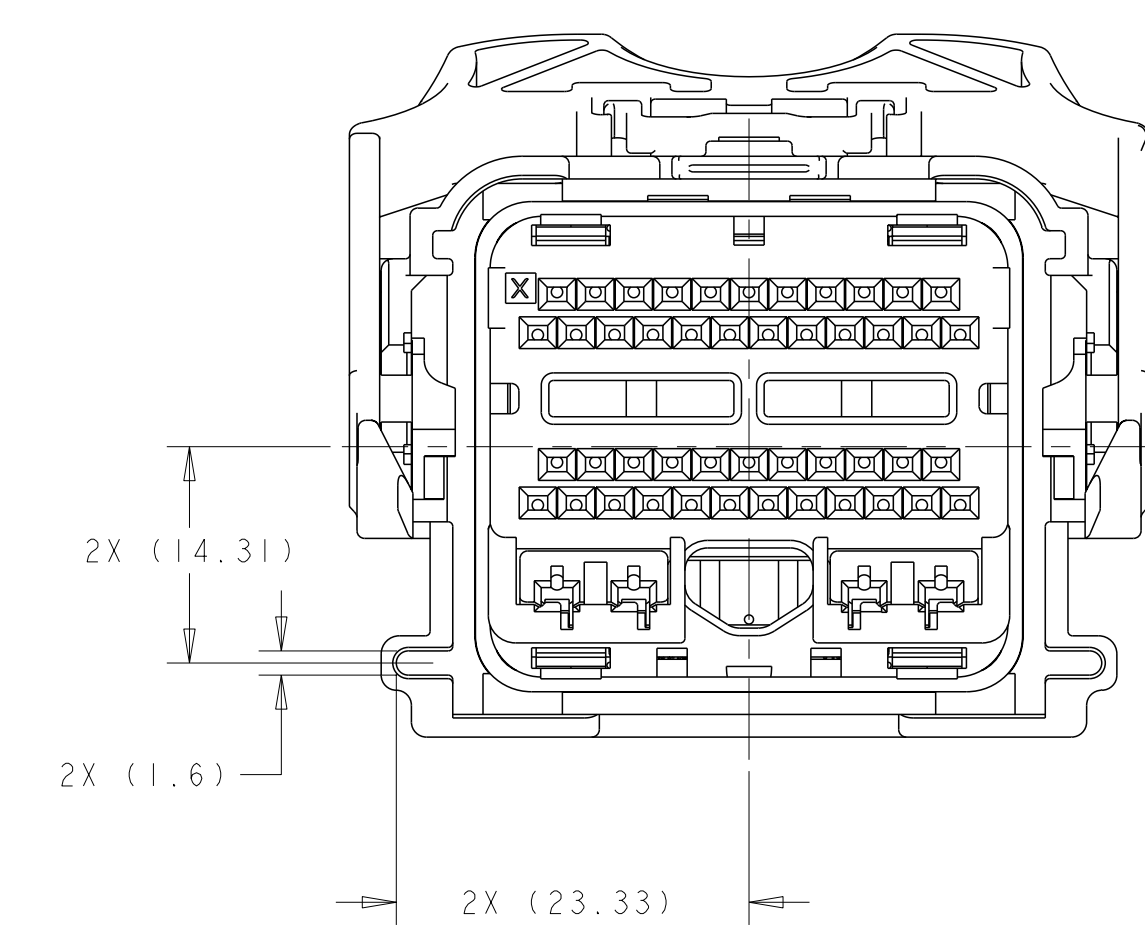

1438129-3
KEYING OPTION "C"

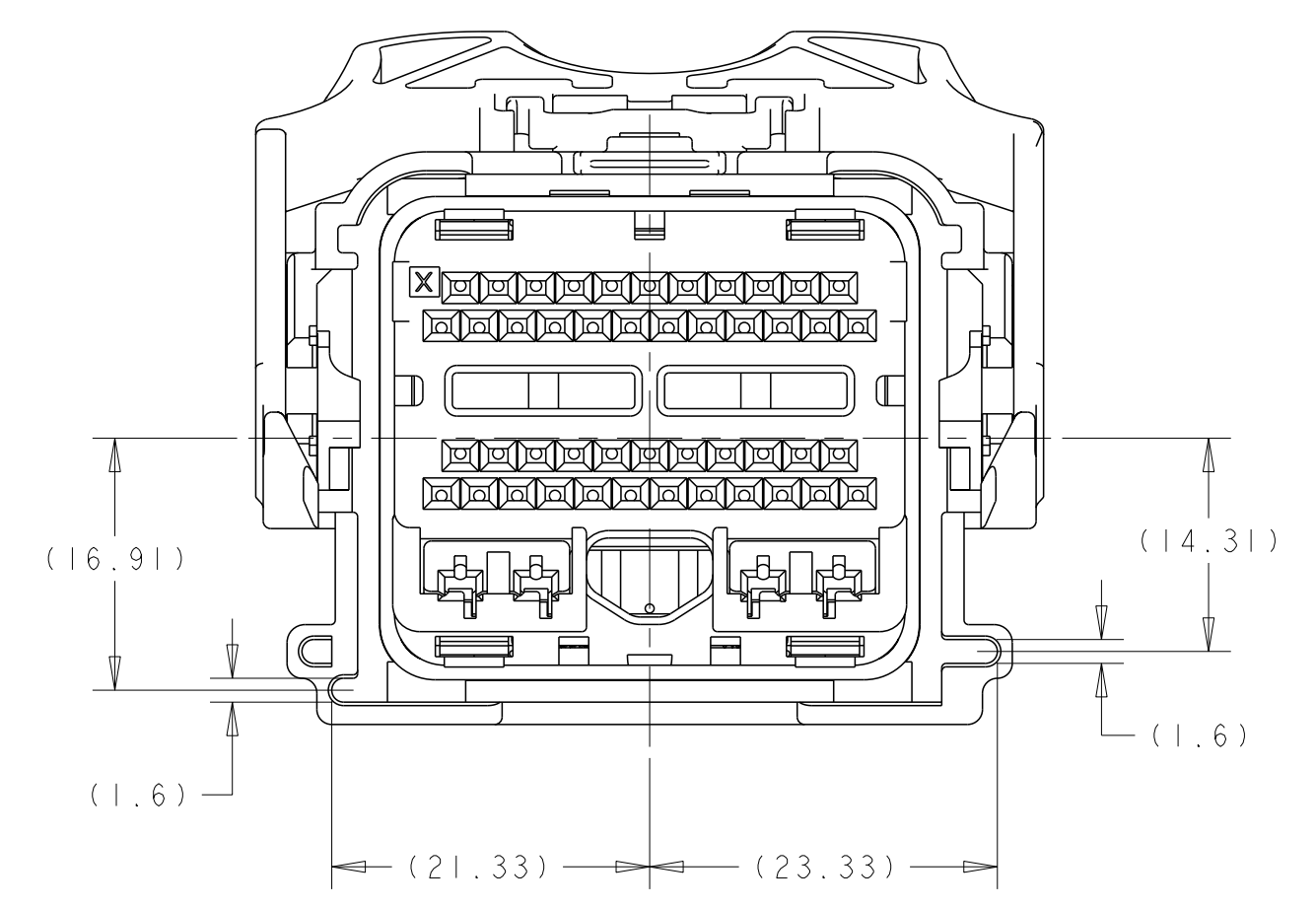

1438129-4
KEYING OPTION "D"

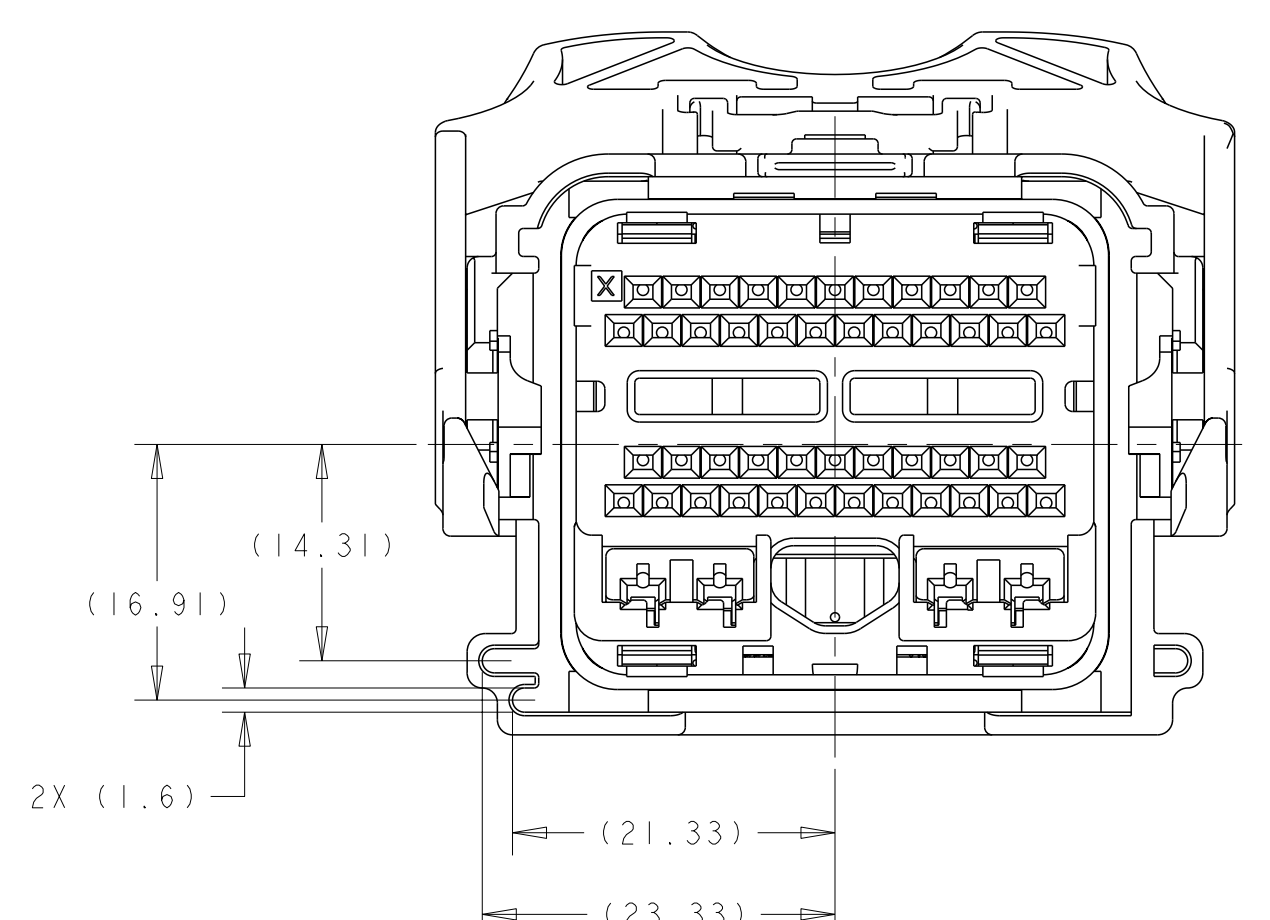

1438129-5
KEYING OPTION "E"

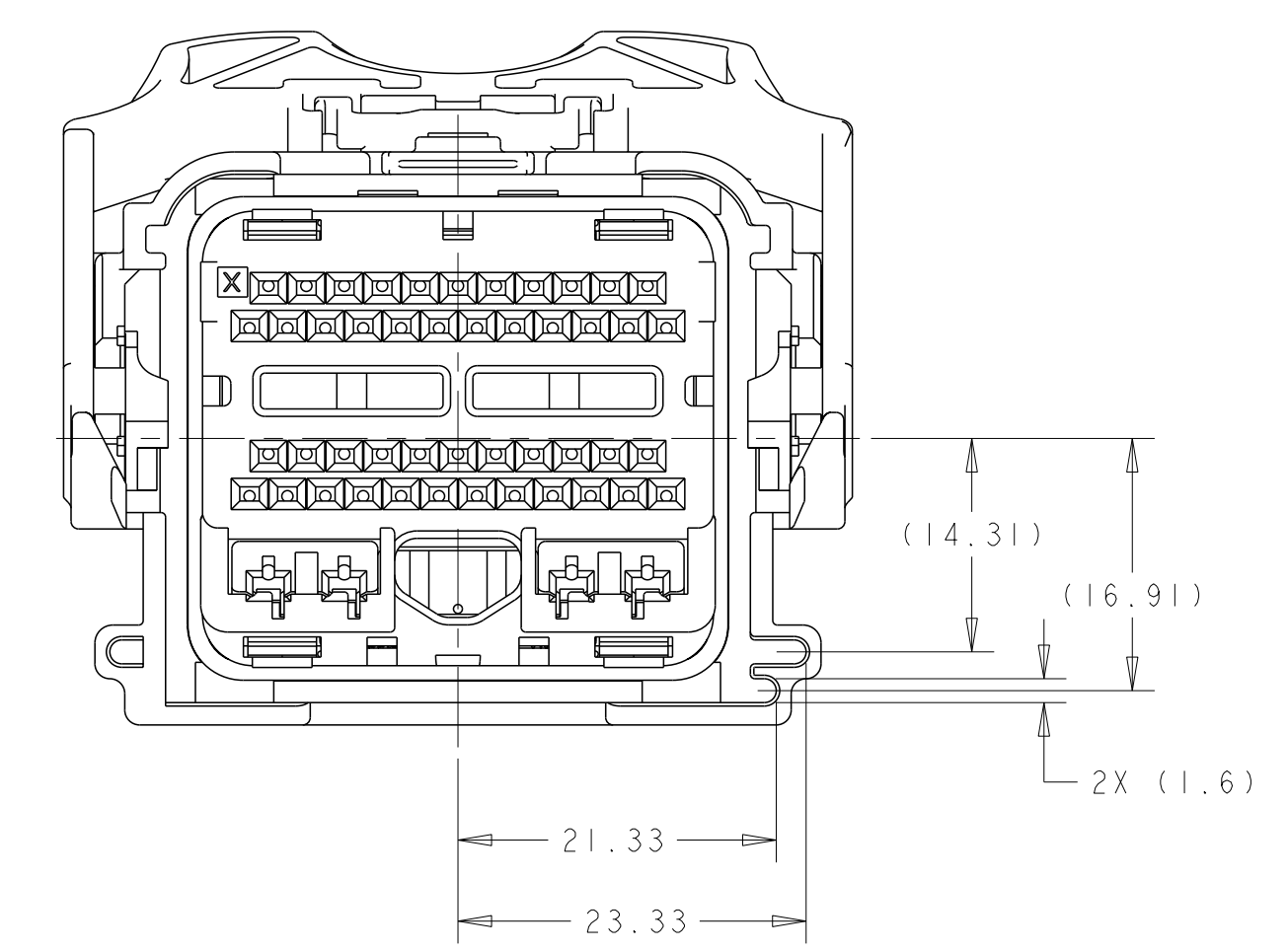

1438129-6
KEYING OPTION "F"

THIS DRAWING IS A CONTROLLED DOCUMENT.		OWN R. VESTAL 15APR2005	
DIMENSIONS:		CHK T. VALASEK 15APR2005	
mm	0 PLC ± 1 PLC ±0.3 2 PLC ±0.10 3 PLC ± 4 PLC ±	APVD T. VALASEK 15APR2005	NAME 50-WAY HARNESS ASSEMBLY, PCM
TOLERANCES UNLESS OTHERWISE SPECIFIED:		PRODUCT SPEC	SIZE A100779
MATERIAL		APPLICATION SPEC	CAGE CODE C=1438129
FINISH		WEIGHT	DRAWING NO. 1438129
CUSTOMER DRAWING		SCALE 2:1	SHEET 2 OF 10

THIS DRAWING IS UNPUBLISHED. RELEASED FOR PUBLICATION 2018
 © COPYRIGHT 2018 BY - TE CONNECTIVITY ALL RIGHTS RESERVED.

REVISIONS				
P.	LT#	DESCRIPTION	DATE	OWN / APPV
-	-	SEE SHEET 1	-	- / -

KEYING OPTION B	46	43	42	41	40	38	37	34	33	32	31	30	29	28	27	26	25	24	20	19	17	16	15	14	13	9	8	7	6	5	4	1	6-1924783-8	5S4T-14A464-MA-094									
	46	43	41	40	39	38	37	34	33	32	31	30	29	28	27	26	25	24	22	20	19	17	16	15	14	9	8	7	5	4	2	1	6-1924783-3	5S4T-14A464-MA-093									
									33	32				27						9								3	1	4-1924783-3	5S4T-14A464-MA-092												
			42	40	39				34	33	32		29		26					20				15	13		9	7		3		2-1924783-4	5S4T-14A464-MA-091										
	46	43	42		39				34	33	32		29		26	25	22							15	14		9	7			1	2-1924783-2	5S4T-14A464-MA-090										
			42		39				34	33		31			27	25	22	20																1-1924783-9	5S4T-14A464-MA-089								
			42		39				34	33		31				25	22	20																	1-1924783-8	5S4T-14A464-MA-088							
	46	43	42		39				34	33	32		29		26	25	22						15	14		9	7							1-1924783-4	5S4T-14A464-MA-087								
		43			39				34	33	32		29										15	14											1-1924783-3	5S4T-14A464-MA-086							
		43		41	40	39	38	37		34		32	31		29					20				15	14	13									3	1-1924783-2	5S4T-14A464-MA-085						
		43	42									31		29		27	25	22	20		18		16	15							1	1924783-8	5S4T-14A464-MA-084										
		43	42									31			27	25	22	20		18		16	15								1	1924783-7	5S4T-14A464-MA-083										
		43	42									31		29		27	25	22			18		16	15							1	1924783-3	5S4T-14A464-MA-082										
		43	42									31			27	25	22				18		16	15						1	1924783-2	5S4T-14A464-MA-081											
	46													28	27													9			1	9-1438950-9	5S4T-14A464-MA-080										
				42		39						34	33	32	31			26	25		20														9-1438950-6	5S4T-14A464-MA-079							
				42		39						34	33	32	31			27	26	25		20														9-1438950-5	5S4T-14A464-MA-078						
			43									34	33	32		29							15	14												9-1438950-4	5S4T-14A464-MA-077						
46																				28				13			9			1	9-1438950-1	5S4T-14A464-MA-076											
46	43	42			39	38	37				33		31		27	25	22				18	16												7	8-1438950-9	5S4T-14A464-MA-075							
46	43				39	38	37				33				27	25	22				18	16													7	8-1438950-8	5S4T-14A464-MA-074						
		45	44			40	39	38	37	36	35	34	33	32	31	30	28	27	26	25	24	23	21	20	19	18	17	16		13	10	9	8	7	6	5	4	3	2	1	8-1438950-7	5S4T-14A464-MA-073	
			43								33		30									20	19		15	14	13														7-1438950-7	5S4T-14A464-MA-072	
			43								33		30									20	19		15	13															7-1438950-5	5S4T-14A464-MA-071	
		43									34	33	32									20			15																	7-1438950-4	5S4T-14A464-MA-070

CAVITIES WITH A NUMERIC SYMBOL INDICATES CLOSED TERMINAL LOCATIONS											42	41	40	39	38												9	7		3					6-1438950-9	5S4T-14A464-MA-069																
											43				38							29			27	25	22									1	6-1438950-5	5S4T-14A464-MA-068														
BLANK CAVITIES INDICATES OPEN TERMINAL HOLE LOCATIONS	50		46				42				37						33	31	30	29	28	27		24	22				19	18	17	16	14					6-1438950-4	5S4T-14A464-MA-067													
TERMINAL HOLE POSITION	50	49	48	47	46	45	44	43	42	41	40	39	38	37	36	35	34	33	32	31	30	29	28	27	26	25	24	23	22	21	20	19	18	17	16	15	14	13	12	11	10	9	8	7	6	5	4	3	2	1	6-1438950-3	5S4T-14A464-MA-066

5S4T-14A464-M* PIN-OUT CHART

ASSEMBLY PART NUMBER
 FORD PART NUMBER

THIS DRAWING IS A CONTROLLED DOCUMENT.		OWN R. VESTAL 15APR2005		NAME	50-WAY HARNESS ASSEMBLY, PCM			RESTRICTED TO
DIMENSIONS: mm		CHK T. VALASEK 15APR2005		PRODUCT SPEC	SIZE	CAGE CODE	DRAWING NO.	
		APPV T. VALASEK 15APR2005		APPLICATION SPEC	SCALE	SHEET	OF	10
MATERIAL		TOLERANCES UNLESS OTHERWISE SPECIFIED: 0 PLC ±.3 2 PLC ±.10 3 PLC ±. 4 PLC ±. ANGLES FINISH *		TOLERANCES UNLESS OTHERWISE SPECIFIED: ±. ±. ±. ±.*	WEIGHT	A100779	C=1438129	REV F37
		CUSTOMER DRAWING	SCALE 1:1		SHEET 5 OF 10			

REVISIONS table with columns: P, LTR, DESCRIPTION, DATE, DWN, APVD

Main grid table for pin-out chart with columns for pin numbers (47, 46, 45, 44, 43, 42, 41, 40, 39, 38, 37, 36, 35, 34, 33, 32, 31, 30, 29, 28, 27, 26, 25, 24, 23, 22, 21, 20, 19, 18, 17, 16, 15, 14, 13, 12, 11, 10, 9, 8, 7, 6, 5, 4, 3, 2) and rows for terminal locations (50, 49, 48, 47, 46, 45, 44, 43, 42, 41, 40, 39, 38, 37, 36, 35, 34, 33, 32, 31, 30, 29, 28, 27, 26, 25, 24, 23, 22, 21, 20, 19, 18, 17, 16, 15, 14, 13, 12, 11, 10, 9, 8, 7, 6, 5, 4, 3, 2, 1). Includes a diagonal label 'KEYING OPTION C'.

Legend table with rows: CAVITIES WITH A NUMERIC SYMBOL INDICATES CLOSED TERMINAL LOCATIONS, BLANK CAVITIES INDICATES OPEN TERMINAL HOLE LOCATIONS, TERMINAL HOLE POSITION. Includes a technical drawing of a terminal hole.

5S4T-14A464-N* PIN-OUT CHART

Technical drawing metadata including: THIS DRAWING IS A CONTROLLED DOCUMENT, DIMENSIONS, TOLERANCES UNLESS OTHERWISE SPECIFIED, MATERIAL, CUSTOMER DRAWING, and product information for 50-WAY HARNESS ASSEMBLY, PCM.

REVISIONS				
P.	LYR	DESCRIPTION	DATE	OWN / APVD
-		SEE SHEET 1	-	-



KEYING OPTION C

CAVITIES WITH A NUMERIC SYMBOL INDICATES CLOSED TERMINAL LOCATIONS	39	38	37	36	29	28	23	20	19	10	9	8	7	6	5	7-1924783-8	5S4T-14A464-NA-135																																			
BLANK CAVITIES INDICATES OPEN TERMINAL HOLE LOCATIONS	39	38	37	36	29	28	23	20	19	10	9	8	7	6	5	7-1924783-4	5S4T-14A464-NA-134																																			
TERMINAL HOLE POSITION	50	49	48	47	46	45	44	43	42	41	40	39	38	37	36	35	34	33	32	31	30	29	28	27	26	25	24	23	22	21	20	19	18	17	16	15	14	13	12	11	10	9	8	7	6	5	4	3	2	1	7-1924783-2	5S4T-14A464-NA-133
												39	38	37	36	28	26	25	23	20	11	10	8	6	5	7-1924783-0	5S4T-14A464-NA-132																									

5S4T-14A464-N* PIN-OUT CHART

ASSEMBLY PART NUMBER
 FORD PART NUMBER

THIS DRAWING IS A CONTROLLED DOCUMENT.		OWN: R. VESTAL 15APR2005		NAME: 50-WAY HARNESS ASSEMBLY, PCM
DIMENSIONS: mm	TOLERANCES UNLESS OTHERWISE SPECIFIED:	CHK: T. VALASEK 15APR2005		PRODUCT SPEC:
	0 PLC ±.3 1 PLC ±0.3 2 PLC ±0.10 3 PLC ±. 4 PLC ±. ANGLES FINISH *1°	APVD: T. VALASEK 15APR2005		APPLICATION SPEC:
MATERIAL:				RESTRICTED TO:
		WEIGHT: -	SIZE: A	CAGE CODE: 100779
		CUSTOMER DRAWING	SCALE: 1:1	SHEET 8 OF 10

REVISIONS				
REV	DATE	DESCRIPTION	BY	APPROV
1	15APR2005	SEE SHEET 1		

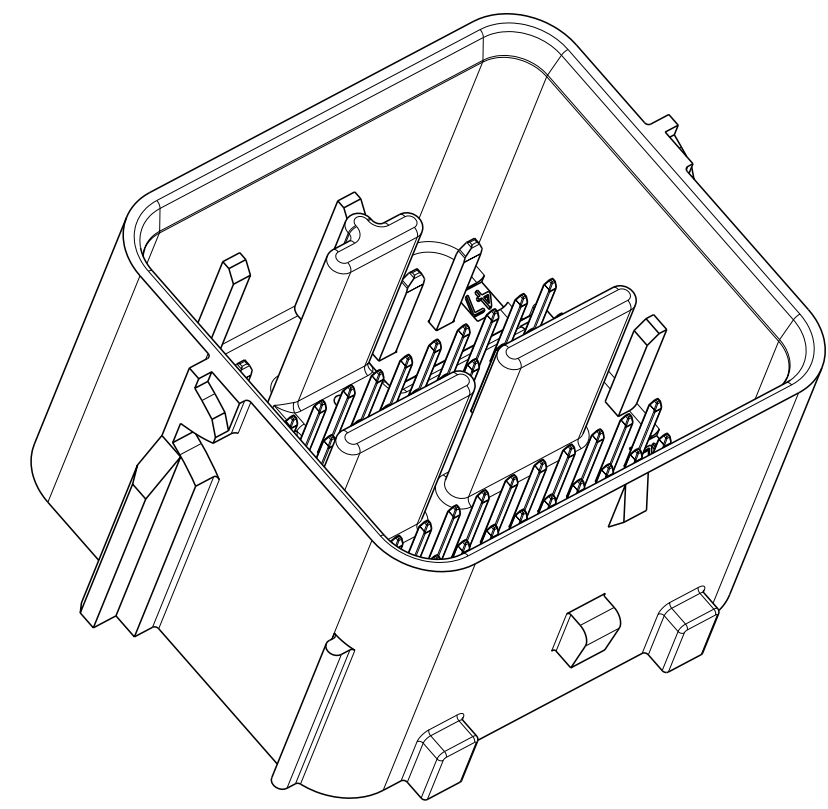

SCALE 2:1

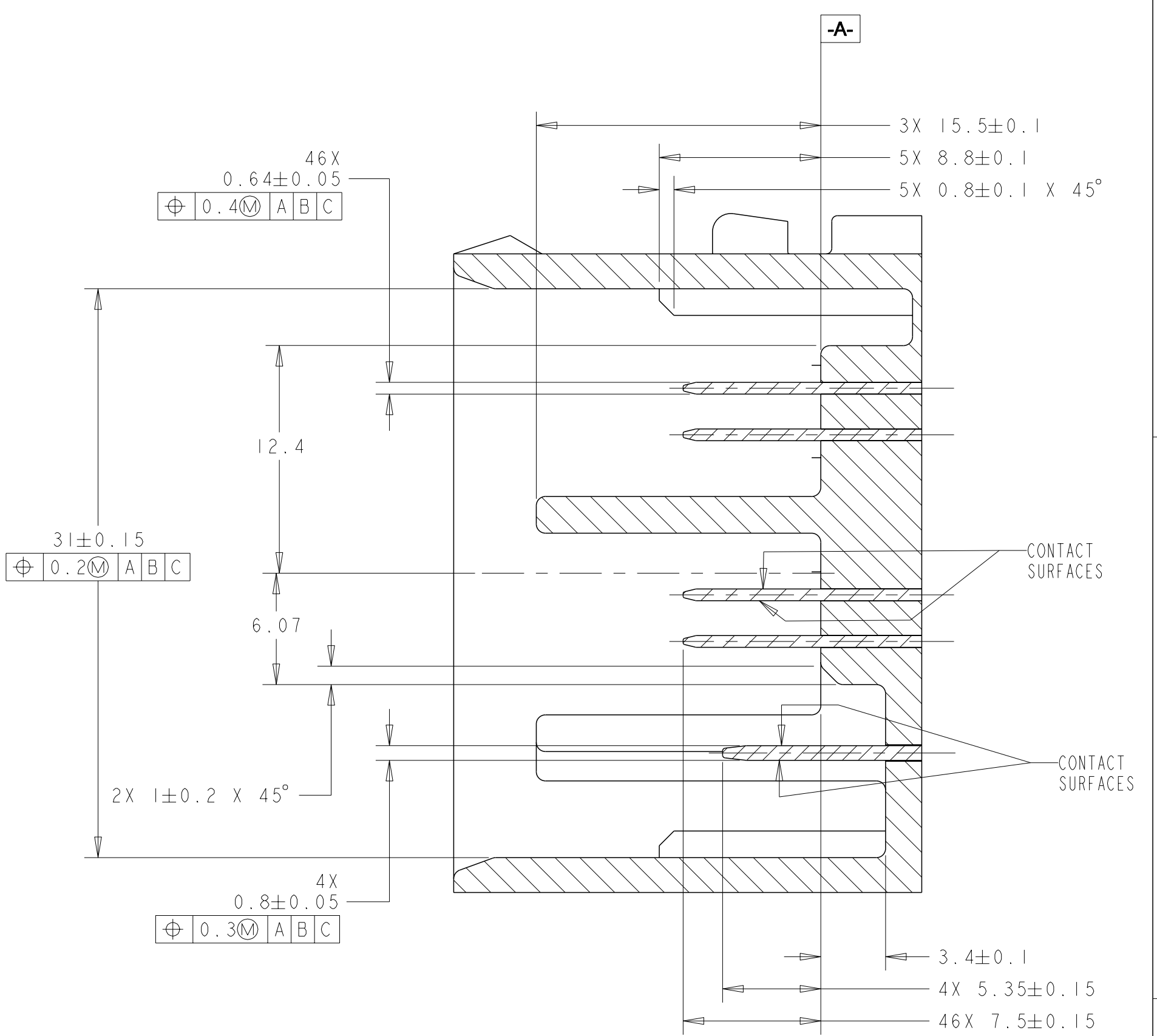
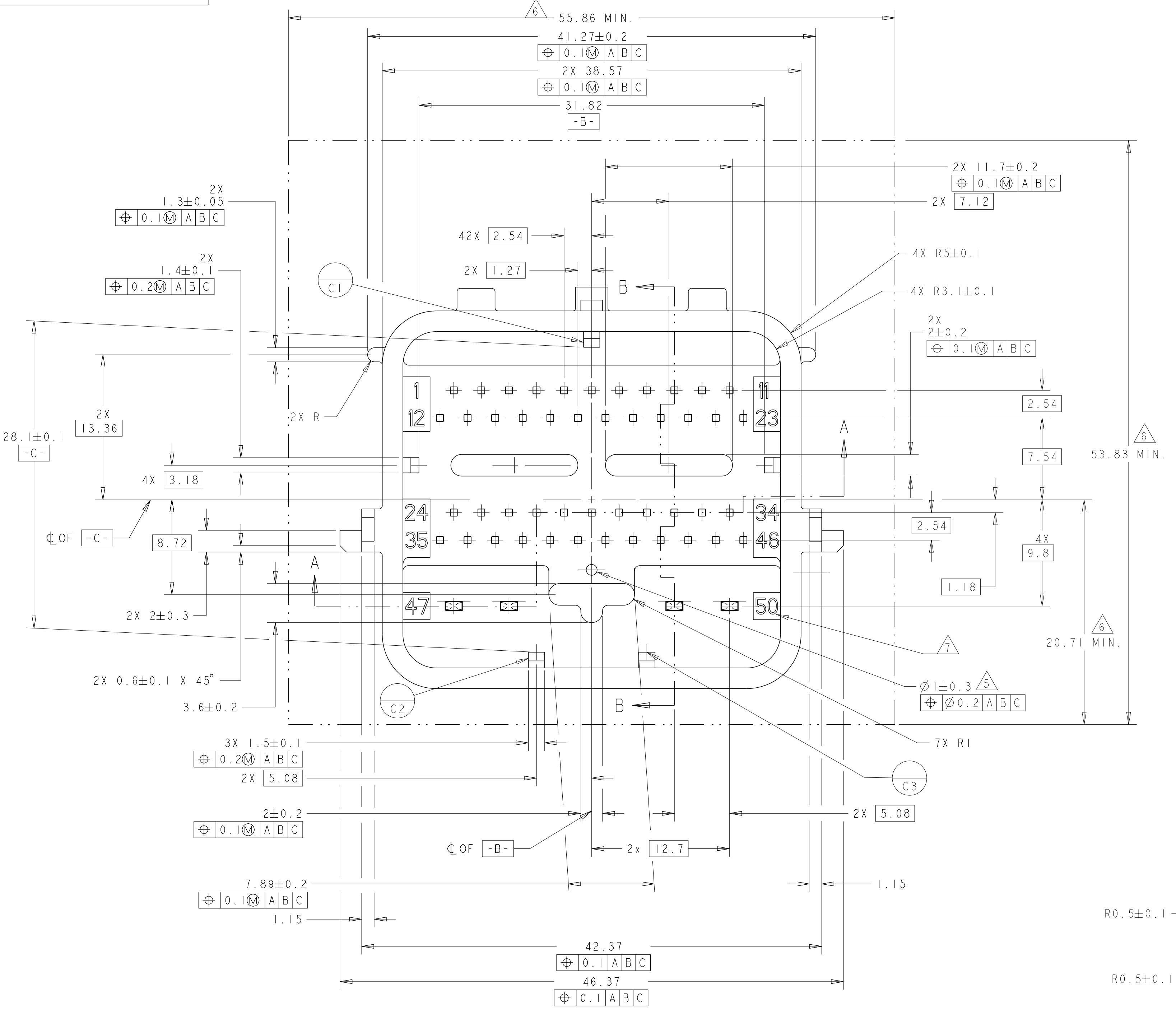

SECTION B-B

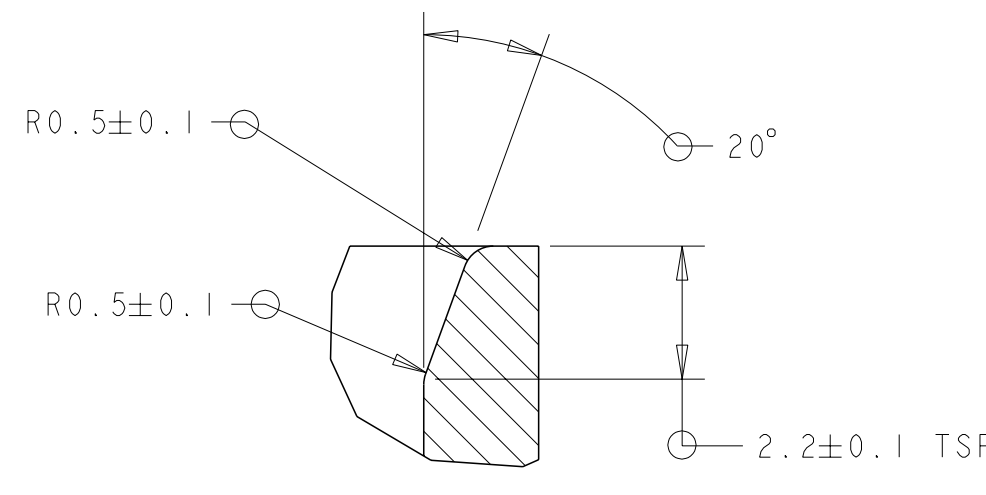

DETAIL E
SCALE 8:1

- NOTES: UNLESS OTHERWISE SPECIFIED
- 1. GENERAL TOLERANCE:
 ±0.3 ALL ONE PLACE DIMENSIONS
 ±0.10 ALL TWO PLACE DIMENSIONS
 ±1°00' ALL ANGULAR DIMENSIONS
 - 2. DRAFT ANGLE PERMISSIBLE ONLY WITHIN DRAWING TOLERANCE.
 - 3. SEALING SURFACE, NO WITNESS LINES OR DAMAGE PERMITTED.
 - 4. ALL UNMARKED RADIUS TO BE 0.5 MAX., UNLESS OTHERWISE SPECIFIED.
 - 5. VENT HOLE SIZE AND LOCATION IS OPTIONAL.
 - 6. THIS AREA TO REMAIN CLEAR FOR THE HARNESS ASSEMBLY.
 - 7. TERMINAL POSITION IDENTIFICATION.
 - 8. MATES WITH TYCO ELECTRONICS PART NUMBERS 1438129-• & 1438950-•

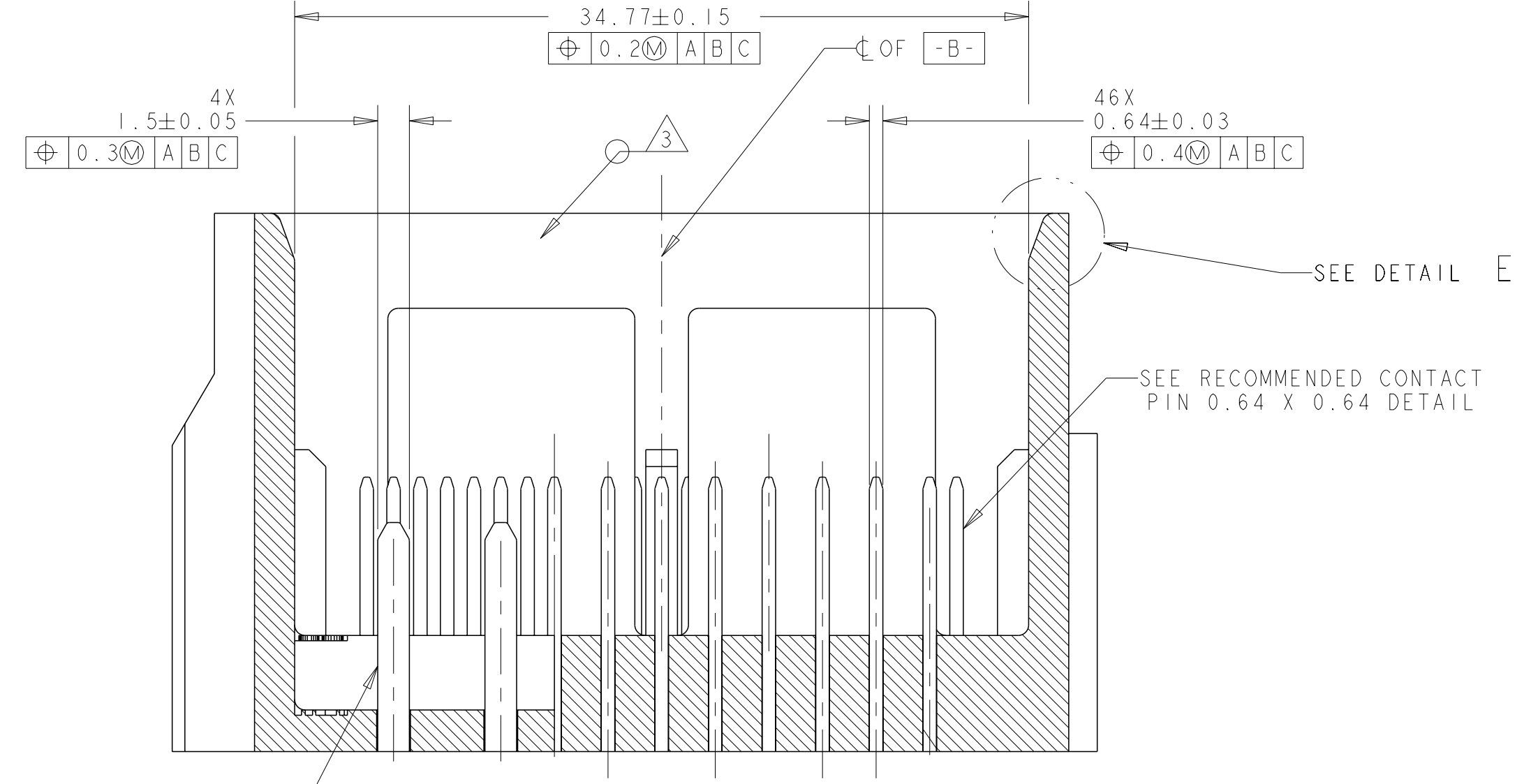

SECTION A-A

THIS DRAWING IS A CONTROLLED DOCUMENT.		OWN R. VESTAL 15APR2005	TE Connectivity
DIMENSIONS:		CHK T. VALASEK 15APR2005	
mm	TOLERANCES UNLESS OTHERWISE SPECIFIED:	APVD T. VALASEK 15APR2005	
mm	0 PLC ± 1 PLC ±0.3 2 PLC ±0.10 3 PLC ± 4 PLC ±	NAME 50-WAY HARNESS ASSEMBLY, PCM	
MATERIAL	FINISH	APPLICATION SPEC	SIZE CAGE CODE DRAWING NO RESTRICTED TO
-	-	WEIGHT	A100779C=1438129
CUSTOMER DRAWING	SCALE 1:1	SHEET 9 of 10	REV F37

HEADER INTERFACE KEYING OPTIONS

REVISIONS				
REV	DATE	DESCRIPTION	OWN	APVD
-	-	SEE SHEET 1	-	-

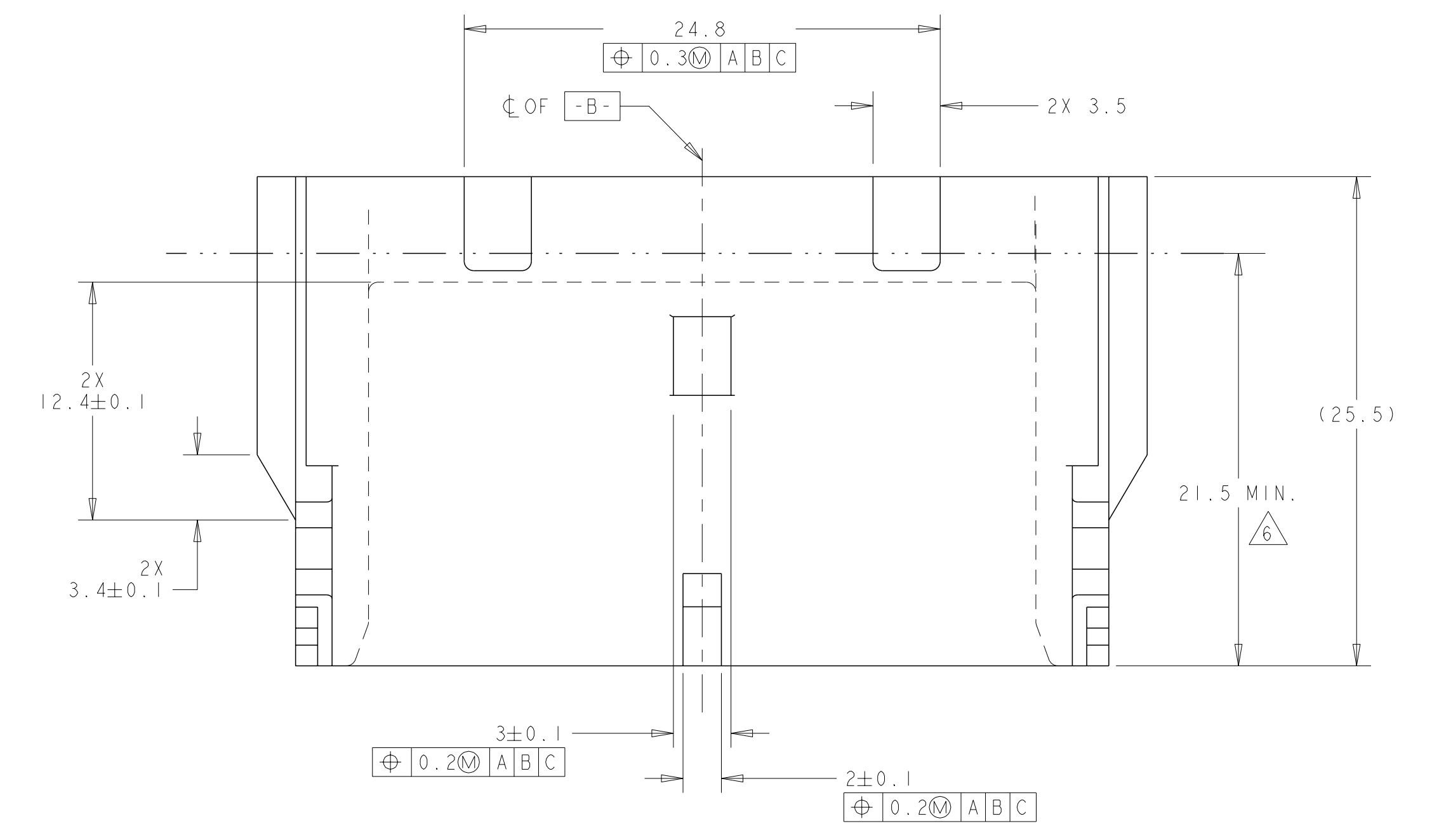
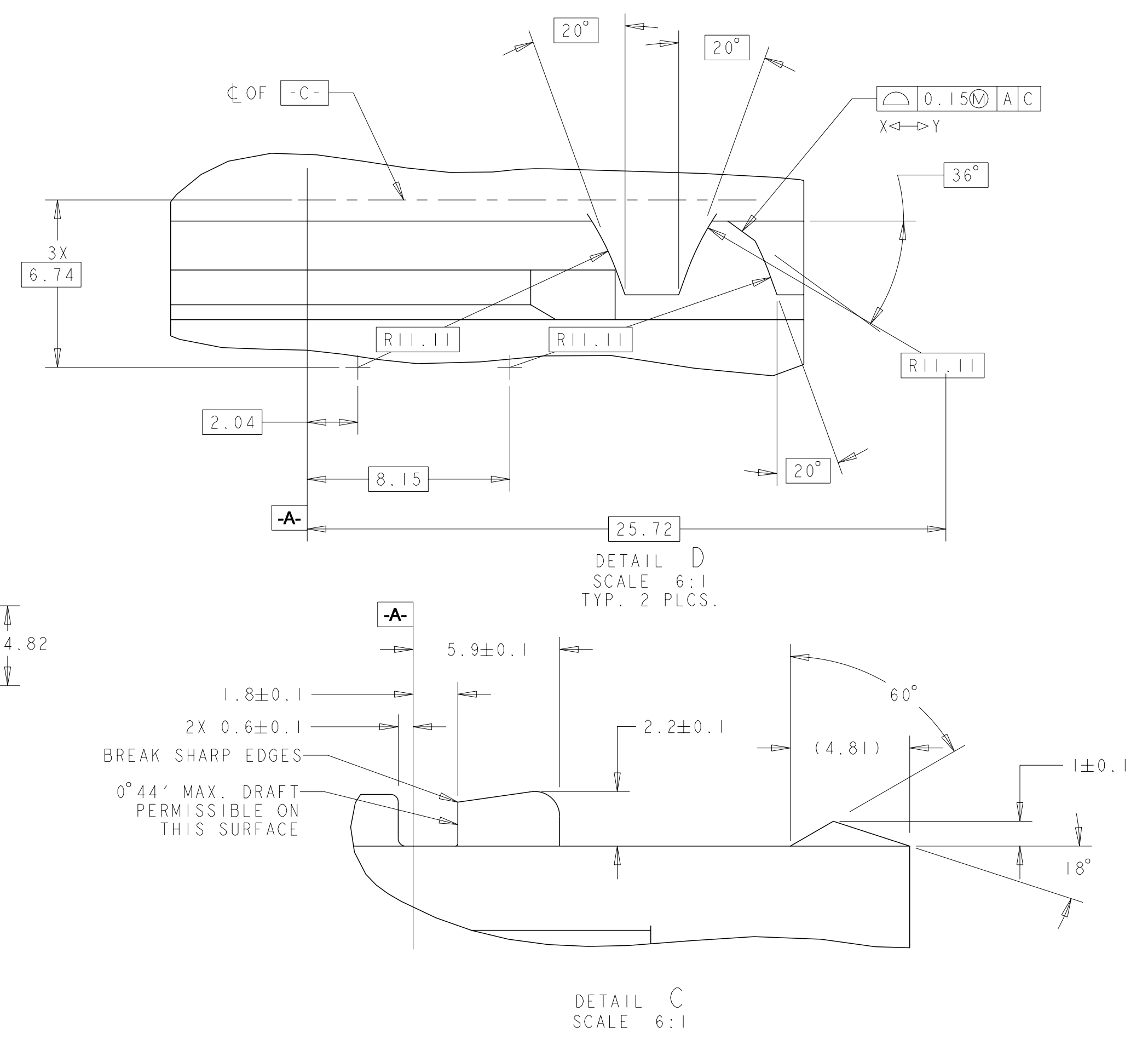
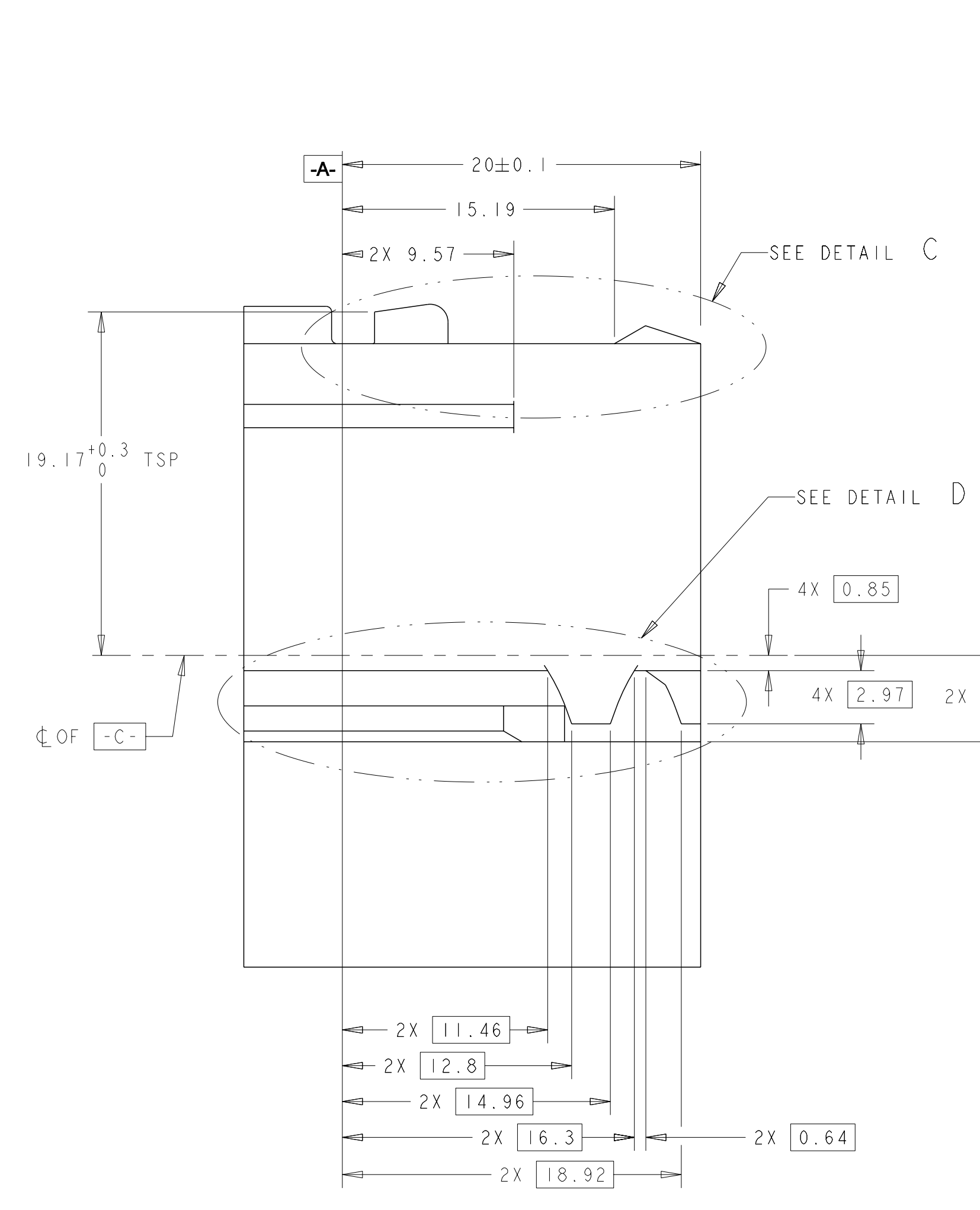
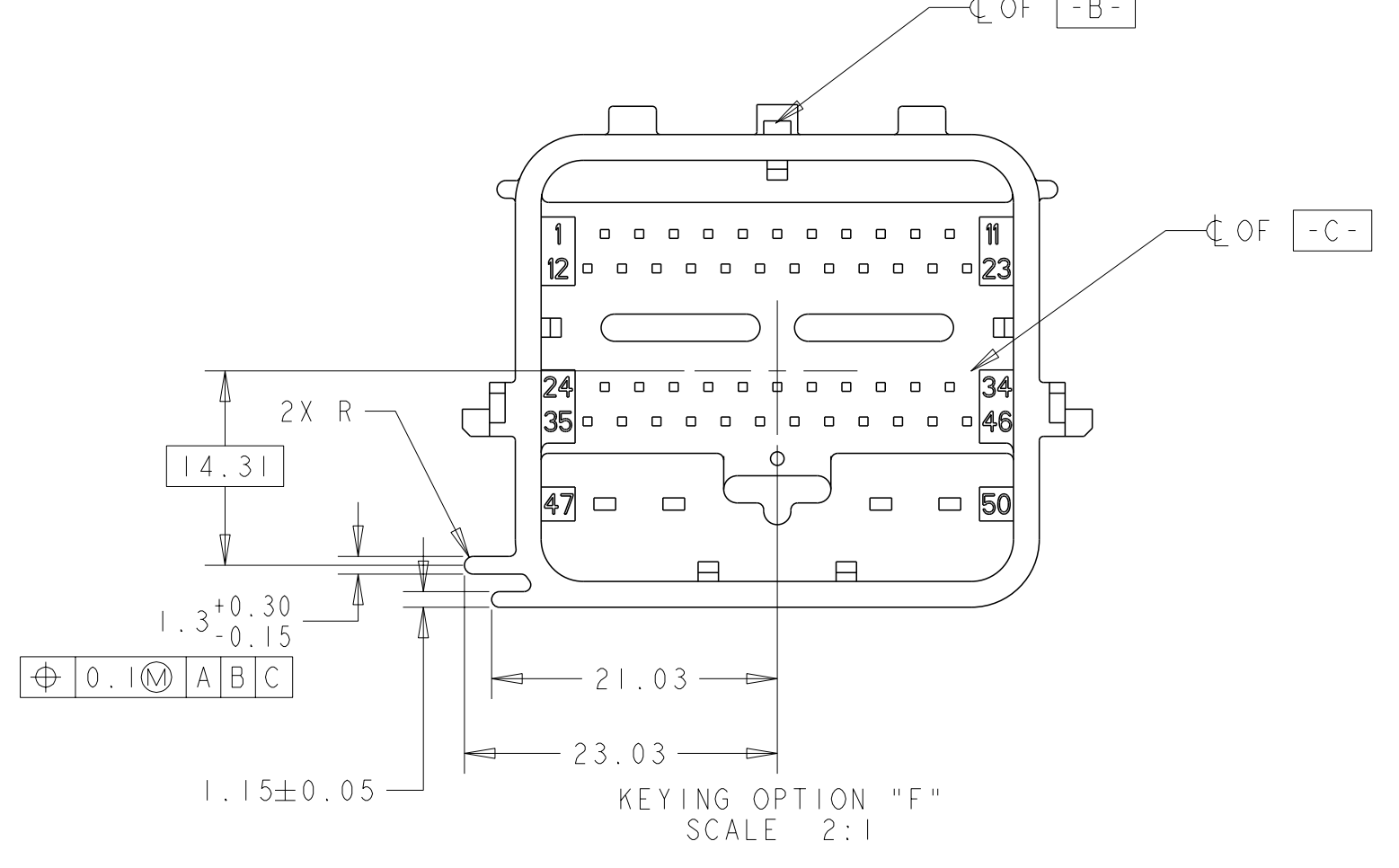
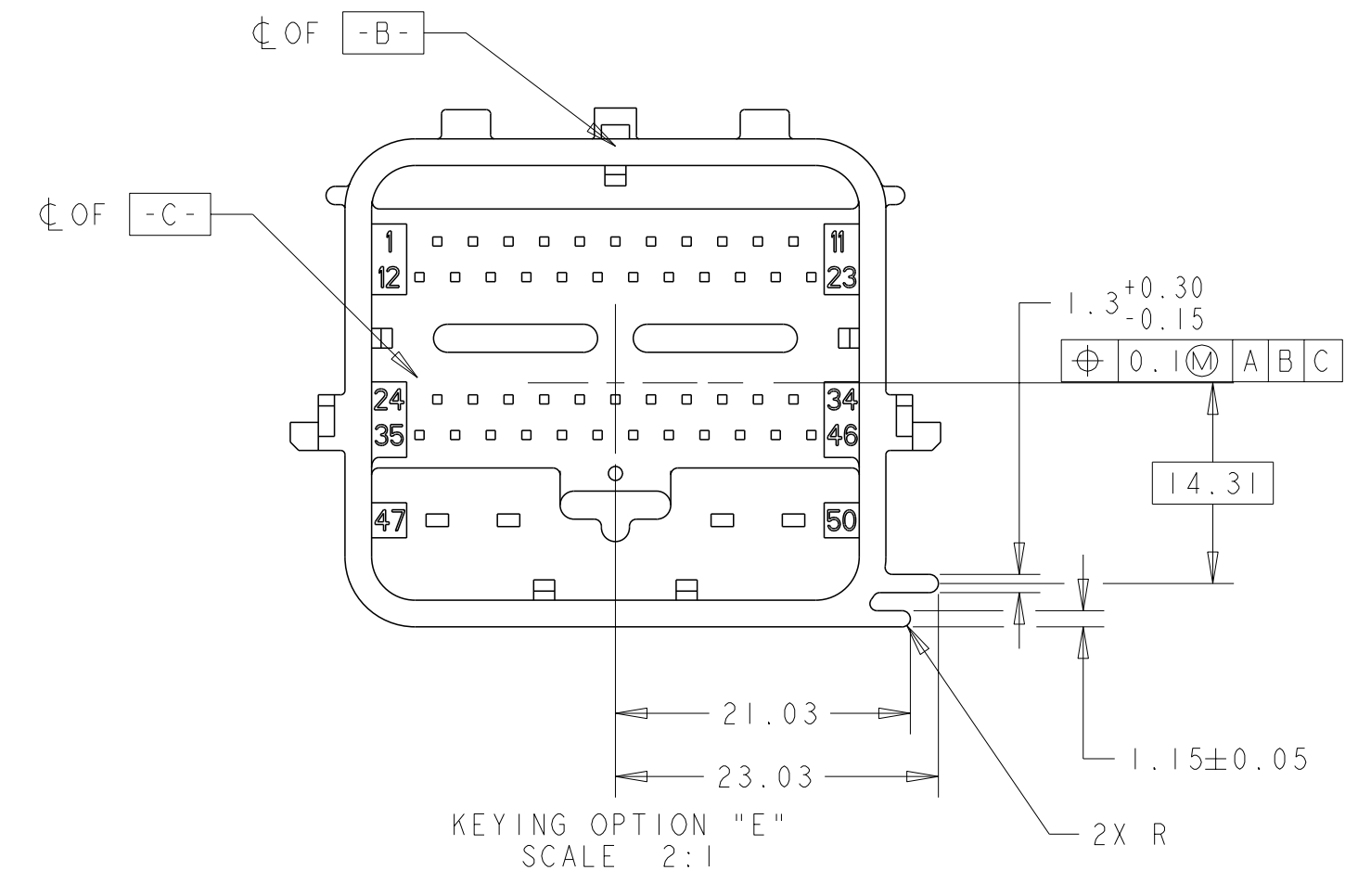
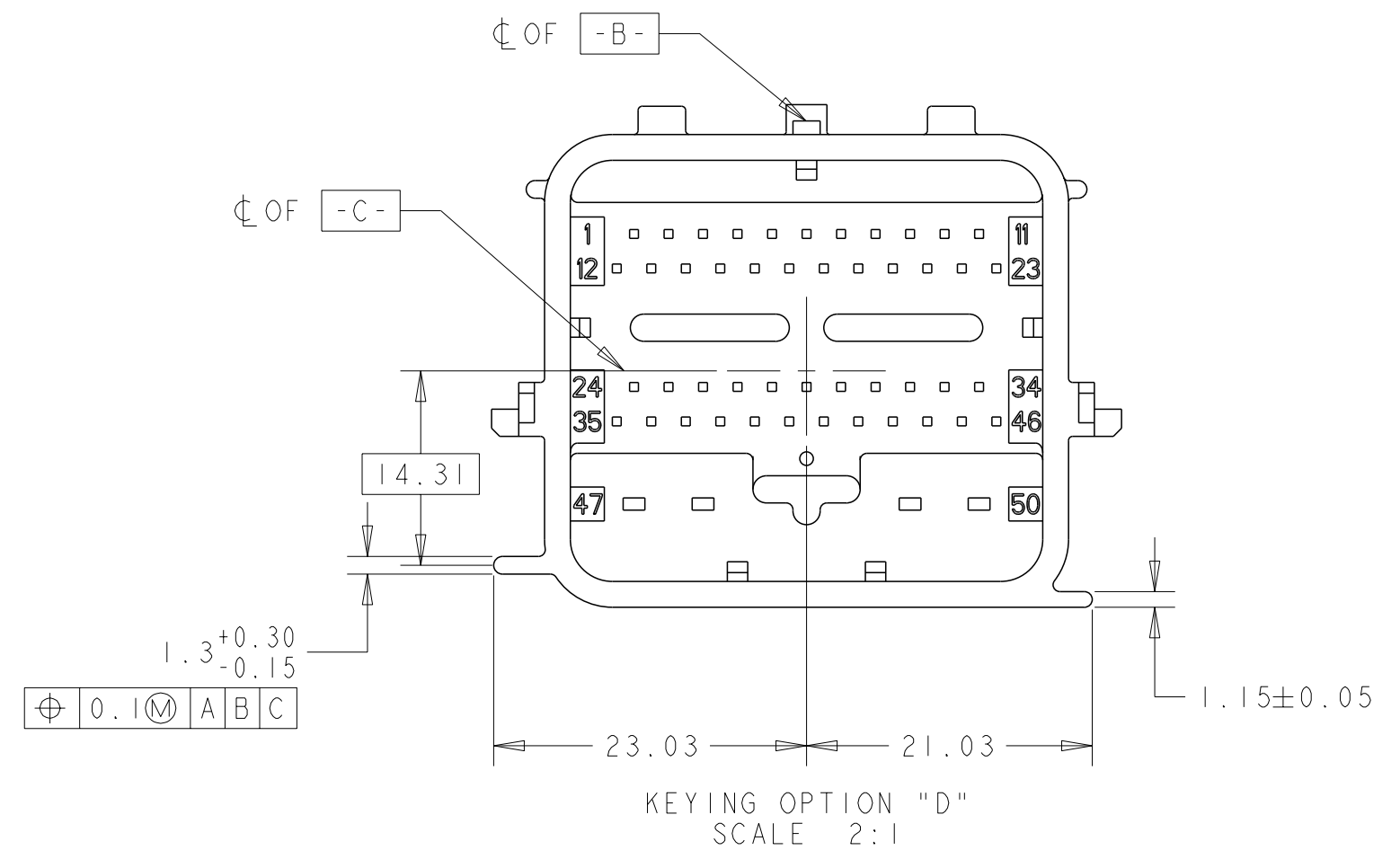
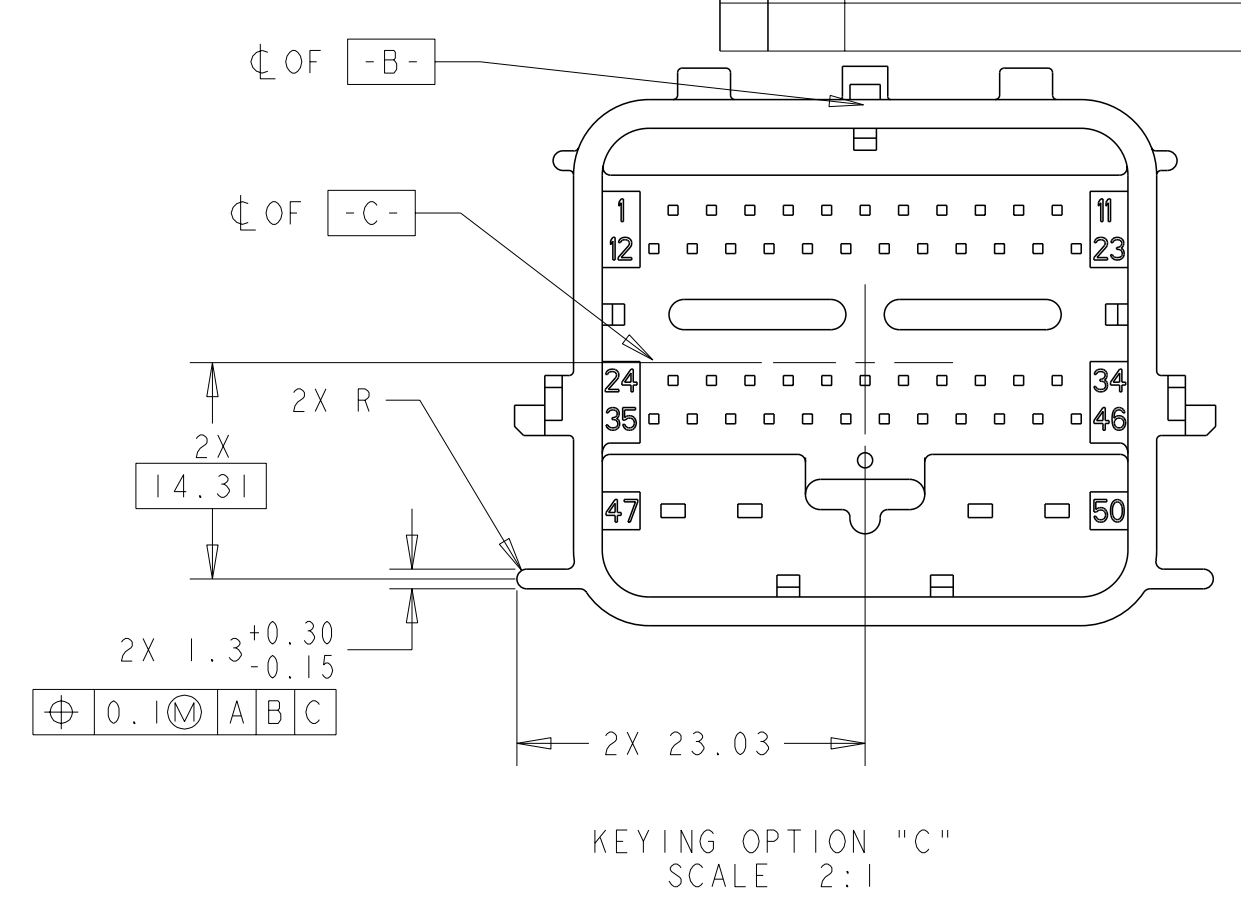
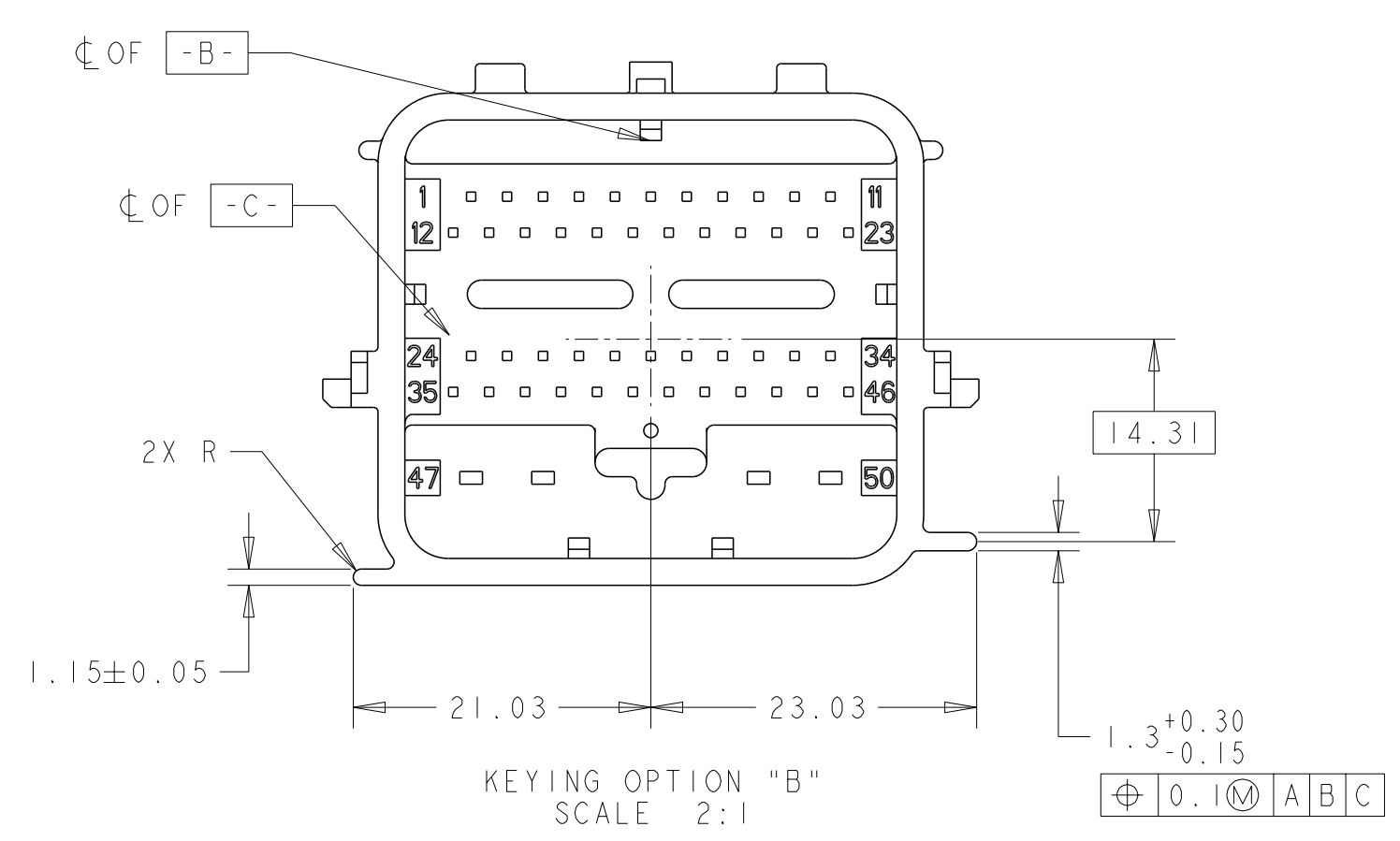
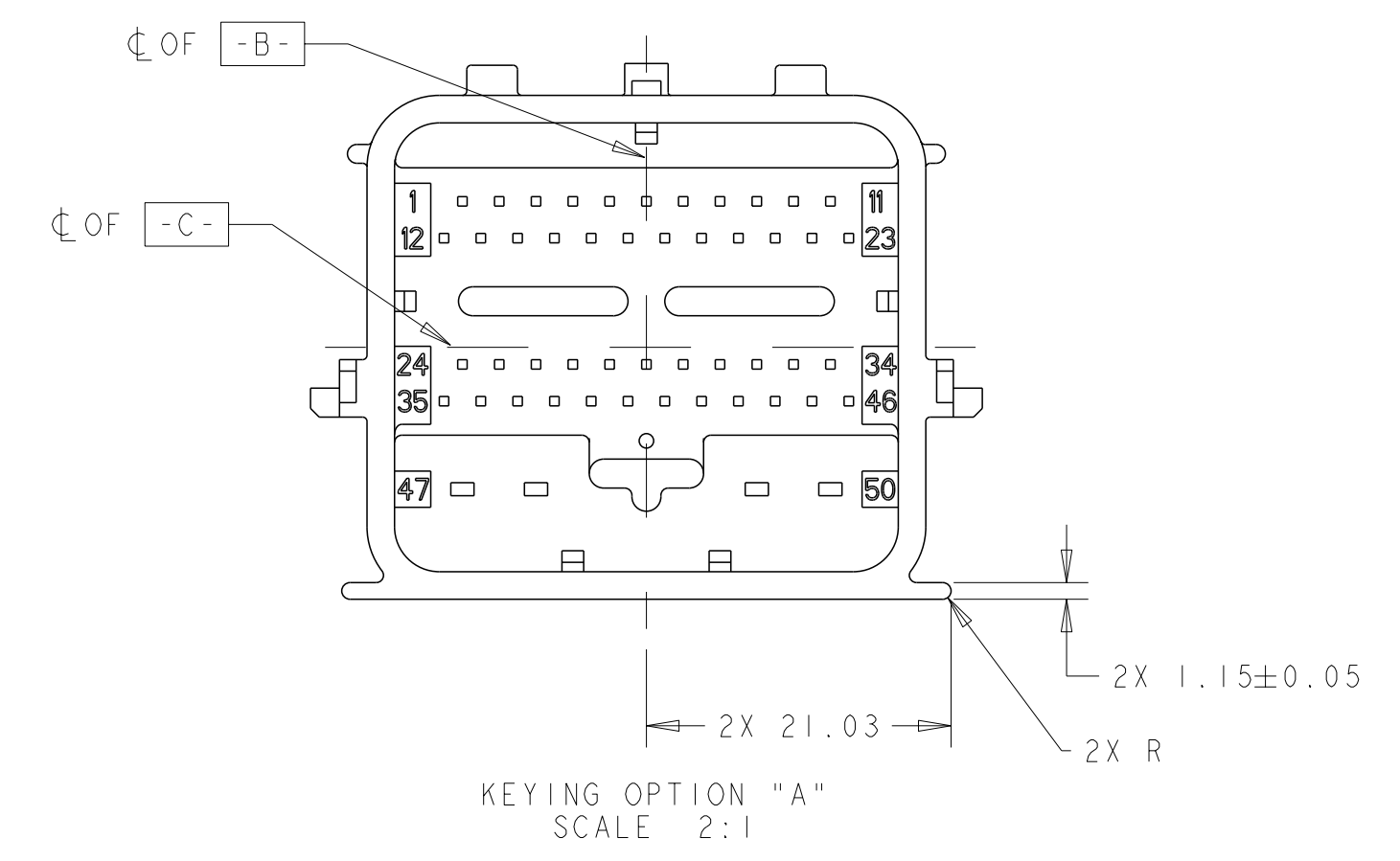

THIS DRAWING IS A CONTROLLED DOCUMENT.		OWN: R. VESTAL 15APR2005	TE Connectivity
DIMENSIONS: mm		CHK: T. VALASEK 15APR2005	
TOLERANCES UNLESS OTHERWISE SPECIFIED:		APVD: T. VALASEK 15APR2005	NAME: 50-WAY HARNESS ASSEMBLY, PCM
0 PLC ±	1 PLC ±0.3	PRODUCT SPEC	SIZE: CAGE CODE DRAWING NO. RESTRICTED TO
2 PLC ±0.10	3 PLC ±	APPLICATION SPEC	A100779C=1438129
4 PLC ±	ANGLES ±*	WEIGHT	SCALE 1:1 SHEET 10 OF 10 REV F37
MATERIAL	FINISH	CUSTOMER DRAWING	



Компания «ЭлектроПласт» предлагает заключение долгосрочных отношений при поставках импортных электронных компонентов на взаимовыгодных условиях!

Наши преимущества:

- Оперативные поставки широкого спектра электронных компонентов отечественного и импортного производства напрямую от производителей и с крупнейших мировых складов;
- Поставка более 17-ти миллионов наименований электронных компонентов;
- Поставка сложных, дефицитных, либо снятых с производства позиций;
- Оперативные сроки поставки под заказ (от 5 рабочих дней);
- Экспресс доставка в любую точку России;
- Техническая поддержка проекта, помощь в подборе аналогов, поставка прототипов;
- Система менеджмента качества сертифицирована по Международному стандарту ISO 9001;
- Лицензия ФСБ на осуществление работ с использованием сведений, составляющих государственную тайну;
- Поставка специализированных компонентов (Xilinx, Altera, Analog Devices, Intersil, Interpoint, Microsemi, Aeroflex, Peregrine, Syfer, Eurofarad, Texas Instrument, Miteq, Cobham, E2V, MA-COM, Hittite, Mini-Circuits, General Dynamics и др.);

Помимо этого, одним из направлений компании «ЭлектроПласт» является направление «Источники питания». Мы предлагаем Вам помощь Конструкторского отдела:

- Подбор оптимального решения, техническое обоснование при выборе компонента;
- Подбор аналогов;
- Консультации по применению компонента;
- Поставка образцов и прототипов;
- Техническая поддержка проекта;
- Защита от снятия компонента с производства.



Как с нами связаться

Телефон: 8 (812) 309 58 32 (многоканальный)

Факс: 8 (812) 320-02-42

Электронная почта: org@eplast1.ru

Адрес: 198099, г. Санкт-Петербург, ул. Калинина, дом 2, корпус 4, литера А.