

LSG Series

Features

- Snap-in terminal type
- 105°C, 2,000 hours assured
- RoHS Compliance



Sleeve & Marking Color: Brown & White

Specifications

| Items | Performance | | | | | | | | | | | | | | | | | | | | | | | | | | | | | | | | | | | | | | | | | | | | | | | | | | | | |
|--|---|-----------------------------|------------------------------|-----------|--------------------|------------------------------|------|-----------------------------------|-----------------|------------------------|-----------|------|------|--------|--------------|-----------|------|------|------------|-----------|-------------------|-----------|------|------|------|------|------|-----------|------|------|------|------|------|--------------|-----------|------|-------|-------------------|------|------|---|---|---|---|---|---|---|---|---|---|---|---|---|
| | Category Temperature Range | 16 ~ 100V -40°C ~ +105°C | 160 ~ 500V -25°C ~ +105°C | | | | | | | | | | | | | | | | | | | | | | | | | | | | | | | | | | | | | | | | | | | | | | | | | | |
| Capacitance Tolerance | ±20% (at 120Hz, 20°C) | | | | | | | | | | | | | | | | | | | | | | | | | | | | | | | | | | | | | | | | | | | | | | | | | | | | |
| Leakage Current (at 20°C) | $I = 3\sqrt{CV}$ or 1.5 mA whichever is smaller (after 5 minutes) Where, C = rated capacitance in μF V = rated DC working voltage in V | | | | | | | | | | | | | | | | | | | | | | | | | | | | | | | | | | | | | | | | | | | | | | | | | | | | |
| Tanδ (at 120Hz, 20°C) | <table border="1"> <thead> <tr> <th>Rated Voltage</th> <th>16</th> <th>25</th> <th>35</th> <th>50</th> <th>63</th> <th>80</th> <th>100</th> <th>160</th> <th>200</th> <th>250</th> <th>350</th> <th>400</th> <th>420</th> <th>450</th> <th>500</th> </tr> </thead> <tbody> <tr> <td>Tanδ (max)</td> <td>0.50</td> <td>0.45</td> <td>0.40</td> <td>0.35</td> <td>0.30</td> <td>0.25</td> <td>0.20</td> <td>0.15</td> <td>0.15</td> <td>0.15</td> <td>0.15</td> <td>0.15</td> <td>0.15</td> <td>0.15</td> <td>0.15</td> </tr> </tbody> </table> | | Rated Voltage | 16 | 25 | 35 | 50 | 63 | 80 | 100 | 160 | 200 | 250 | 350 | 400 | 420 | 450 | 500 | Tanδ (max) | 0.50 | 0.45 | 0.40 | 0.35 | 0.30 | 0.25 | 0.20 | 0.15 | 0.15 | 0.15 | 0.15 | 0.15 | 0.15 | 0.15 | 0.15 | | | | | | | | | | | | | | | | | | | |
| Rated Voltage | 16 | 25 | 35 | 50 | 63 | 80 | 100 | 160 | 200 | 250 | 350 | 400 | 420 | 450 | 500 | | | | | | | | | | | | | | | | | | | | | | | | | | | | | | | | | | | | | | |
| Tanδ (max) | 0.50 | 0.45 | 0.40 | 0.35 | 0.30 | 0.25 | 0.20 | 0.15 | 0.15 | 0.15 | 0.15 | 0.15 | 0.15 | 0.15 | 0.15 | | | | | | | | | | | | | | | | | | | | | | | | | | | | | | | | | | | | | | |
| Low Temperature Characteristics (at 120Hz) | <p>Impedance ratio shall not exceed the values given in the table below.</p> <table border="1"> <thead> <tr> <th colspan="2">Rated Voltage</th> <th>16</th> <th>25</th> <th>35</th> <th>50</th> <th>63</th> <th>80</th> <th>100</th> <th>160</th> <th>200</th> <th>250</th> <th>350</th> <th>400</th> <th>420</th> <th>450</th> <th>500</th> </tr> </thead> <tbody> <tr> <td>Impedance</td> <td>Z(-25°C)/Z(+20°C)</td> <td>4</td> <td>3</td> <td>3</td> <td>2</td> <td>2</td> <td>2</td> <td>4</td> <td>4</td> <td>4</td> <td>4</td> <td>8</td> <td>8</td> <td>8</td> <td>8</td> <td>8</td> </tr> <tr> <td>Ratio</td> <td>Z(-40°C)/Z(+20°C)</td> <td>15</td> <td>10</td> <td>8</td> <td>6</td> <td>5</td> <td>5</td> <td>4</td> <td>-</td> <td>-</td> <td>-</td> <td>-</td> <td>-</td> <td>-</td> <td>-</td> <td>-</td> </tr> </tbody> </table> | | Rated Voltage | | 16 | 25 | 35 | 50 | 63 | 80 | 100 | 160 | 200 | 250 | 350 | 400 | 420 | 450 | 500 | Impedance | Z(-25°C)/Z(+20°C) | 4 | 3 | 3 | 2 | 2 | 2 | 4 | 4 | 4 | 4 | 8 | 8 | 8 | 8 | 8 | Ratio | Z(-40°C)/Z(+20°C) | 15 | 10 | 8 | 6 | 5 | 5 | 4 | - | - | - | - | - | - | - | - |
| Rated Voltage | | 16 | 25 | 35 | 50 | 63 | 80 | 100 | 160 | 200 | 250 | 350 | 400 | 420 | 450 | 500 | | | | | | | | | | | | | | | | | | | | | | | | | | | | | | | | | | | | | |
| Impedance | Z(-25°C)/Z(+20°C) | 4 | 3 | 3 | 2 | 2 | 2 | 4 | 4 | 4 | 4 | 8 | 8 | 8 | 8 | 8 | | | | | | | | | | | | | | | | | | | | | | | | | | | | | | | | | | | | | |
| Ratio | Z(-40°C)/Z(+20°C) | 15 | 10 | 8 | 6 | 5 | 5 | 4 | - | - | - | - | - | - | - | - | | | | | | | | | | | | | | | | | | | | | | | | | | | | | | | | | | | | | |
| Endurance | <table border="1"> <thead> <tr> <th>Test Time</th> <th>2,000 Hrs</th> </tr> </thead> <tbody> <tr> <td>Capacitance Change</td> <td>Within ±20% of initial value</td> </tr> <tr> <td>Tanδ</td> <td>Less than 200% of specified value</td> </tr> <tr> <td>Leakage Current</td> <td>Within specified value</td> </tr> </tbody> </table> <p>* The above Specifications shall be satisfied when the capacitors are restored to 20°C after the rated voltage applied with rated ripple current for 2,000 hours at 105°C.</p> | | Test Time | 2,000 Hrs | Capacitance Change | Within ±20% of initial value | Tanδ | Less than 200% of specified value | Leakage Current | Within specified value | | | | | | | | | | | | | | | | | | | | | | | | | | | | | | | | | | | | | | | | | | | |
| Test Time | 2,000 Hrs | | | | | | | | | | | | | | | | | | | | | | | | | | | | | | | | | | | | | | | | | | | | | | | | | | | | |
| Capacitance Change | Within ±20% of initial value | | | | | | | | | | | | | | | | | | | | | | | | | | | | | | | | | | | | | | | | | | | | | | | | | | | | |
| Tanδ | Less than 200% of specified value | | | | | | | | | | | | | | | | | | | | | | | | | | | | | | | | | | | | | | | | | | | | | | | | | | | | |
| Leakage Current | Within specified value | | | | | | | | | | | | | | | | | | | | | | | | | | | | | | | | | | | | | | | | | | | | | | | | | | | | |
| Shelf Life Test | <table border="1"> <thead> <tr> <th>Test Time</th> <th>1,000 Hrs</th> </tr> </thead> <tbody> <tr> <td>Capacitance Change</td> <td>Within ±20% of initial value</td> </tr> <tr> <td>Tanδ</td> <td>Less than 150% of specified value</td> </tr> <tr> <td>Leakage Current</td> <td>Within specified value</td> </tr> </tbody> </table> <p>* The above Specifications shall be satisfied when the capacitors are restored to 20°C after exposing them for 1,000 hours at 105°C without voltage applied. The rated voltage shall be applied to the capacitors before the measurements (Refer to JIS C 5101-4 4.1).</p> | | Test Time | 1,000 Hrs | Capacitance Change | Within ±20% of initial value | Tanδ | Less than 150% of specified value | Leakage Current | Within specified value | | | | | | | | | | | | | | | | | | | | | | | | | | | | | | | | | | | | | | | | | | | |
| Test Time | 1,000 Hrs | | | | | | | | | | | | | | | | | | | | | | | | | | | | | | | | | | | | | | | | | | | | | | | | | | | | |
| Capacitance Change | Within ±20% of initial value | | | | | | | | | | | | | | | | | | | | | | | | | | | | | | | | | | | | | | | | | | | | | | | | | | | | |
| Tanδ | Less than 150% of specified value | | | | | | | | | | | | | | | | | | | | | | | | | | | | | | | | | | | | | | | | | | | | | | | | | | | | |
| Leakage Current | Within specified value | | | | | | | | | | | | | | | | | | | | | | | | | | | | | | | | | | | | | | | | | | | | | | | | | | | | |
| Ripple Current & Frequency Multipliers | <table border="1"> <thead> <tr> <th rowspan="2">Case size</th> <th rowspan="2">W. V.(V)</th> <th colspan="5">Freq.(Hz)</th> </tr> <tr> <th>50 / 60</th> <th>100 / 120</th> <th>500</th> <th>1k</th> <th>10k up</th> </tr> </thead> <tbody> <tr> <td rowspan="3">Length ≤ 55L</td> <td>Under 100</td> <td>0.92</td> <td>1.00</td> <td>1.13</td> <td>1.19</td> <td>1.20</td> </tr> <tr> <td>160 ~ 250</td> <td>0.81</td> <td>1.00</td> <td>1.32</td> <td>1.45</td> <td>1.50</td> </tr> <tr> <td>350 to up</td> <td>0.77</td> <td>1.00</td> <td>1.30</td> <td>1.41</td> <td>1.43</td> </tr> <tr> <td>Length ≥ 60L</td> <td>160 ~ 450</td> <td>0.88</td> <td>1.00</td> <td>1.20</td> <td>1.25</td> <td>1.40</td> </tr> </tbody> </table> | | Case size | W. V.(V) | Freq.(Hz) | | | | | 50 / 60 | 100 / 120 | 500 | 1k | 10k up | Length ≤ 55L | Under 100 | 0.92 | 1.00 | 1.13 | 1.19 | 1.20 | 160 ~ 250 | 0.81 | 1.00 | 1.32 | 1.45 | 1.50 | 350 to up | 0.77 | 1.00 | 1.30 | 1.41 | 1.43 | Length ≥ 60L | 160 ~ 450 | 0.88 | 1.00 | 1.20 | 1.25 | 1.40 | | | | | | | | | | | | | |
| Case size | W. V.(V) | Freq.(Hz) | | | | | | | | | | | | | | | | | | | | | | | | | | | | | | | | | | | | | | | | | | | | | | | | | | | |
| | | 50 / 60 | 100 / 120 | 500 | 1k | 10k up | | | | | | | | | | | | | | | | | | | | | | | | | | | | | | | | | | | | | | | | | | | | | | | |
| Length ≤ 55L | Under 100 | 0.92 | 1.00 | 1.13 | 1.19 | 1.20 | | | | | | | | | | | | | | | | | | | | | | | | | | | | | | | | | | | | | | | | | | | | | | | |
| | 160 ~ 250 | 0.81 | 1.00 | 1.32 | 1.45 | 1.50 | | | | | | | | | | | | | | | | | | | | | | | | | | | | | | | | | | | | | | | | | | | | | | | |
| | 350 to up | 0.77 | 1.00 | 1.30 | 1.41 | 1.43 | | | | | | | | | | | | | | | | | | | | | | | | | | | | | | | | | | | | | | | | | | | | | | | |
| Length ≥ 60L | 160 ~ 450 | 0.88 | 1.00 | 1.20 | 1.25 | 1.40 | | | | | | | | | | | | | | | | | | | | | | | | | | | | | | | | | | | | | | | | | | | | | | | |
| Failure percentage Failure rate | <p>≤ 3 % (During useful life) Rated Voltage ≤ 100V DC: ≤ 40 fit (40 10⁹/h) Rated voltage ≥ 160V DC: ≤ 70 fit (70 10⁹/h)</p> | | | | | | | | | | | | | | | | | | | | | | | | | | | | | | | | | | | | | | | | | | | | | | | | | | | | |

Diagram of Dimensions

Unit: mm

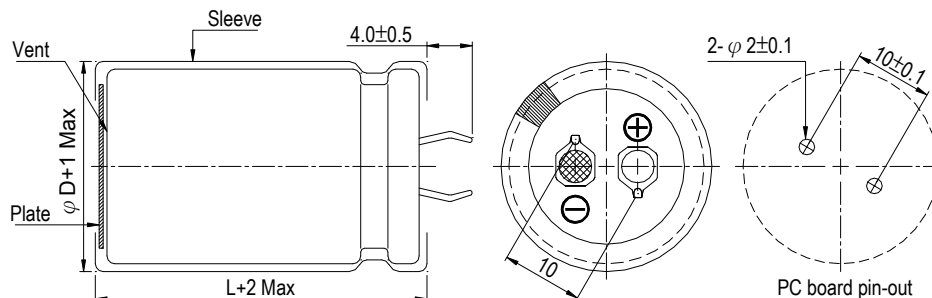

Dimension & Permissible Ripple Current

| Working Voltage V. DC | Capacitance 120Hz, 20°C μF | φ D×L mm | Ripple Current 120 Hz, 105°C A/rms | Tan δ at 120Hz, 20°C | ESR 120Hz, 20°C Ω | LC 5 minutes mA | Part Number |
|--------------------------|----------------------------------|-------------|--|-------------------------|-------------------------|-----------------------|------------------|
| 16 | 10,000 | 20 × 25 | 1.61 | 0.50 | 0.066 | 1.20 | LSG103M1C--A2025 |
| | 10,000 | 22 × 25 | 1.78 | 0.50 | 0.066 | 1.20 | LSG103M1C--A2225 |
| | 12,000 | 22 × 25 | 1.92 | 0.50 | 0.055 | 1.31 | LSG123M1C--A2225 |
| | 15,000 | 22 × 30 | 2.20 | 0.50 | 0.044 | 1.47 | LSG153M1C--A2230 |
| | 15,000 | 25 × 25 | 2.25 | 0.50 | 0.044 | 1.47 | LSG153M1C--A2525 |
| | 18,000 | 22 × 35 | 2.49 | 0.50 | 0.037 | 1.50 | LSG183M1C--A2235 |
| | 18,000 | 25 × 30 | 2.52 | 0.50 | 0.037 | 1.50 | LSG183M1C--A2530 |
| | 18,000 | 30 × 25 | 2.61 | 0.50 | 0.037 | 1.50 | LSG183M1C--A3025 |
| | 22,000 | 22 × 40 | 2.90 | 0.50 | 0.030 | 1.50 | LSG223M1C--A2240 |
| | 22,000 | 25 × 30 | 2.77 | 0.50 | 0.030 | 1.50 | LSG223M1C--A2530 |
| | 22,000 | 30 × 25 | 2.88 | 0.50 | 0.030 | 1.50 | LSG223M1C--A3025 |
| | 27,000 | 25 × 35 | 3.02 | 0.50 | 0.025 | 1.50 | LSG273M1C--A2535 |
| | 27,000 | 30 × 30 | 3.15 | 0.50 | 0.025 | 1.50 | LSG273M1C--A3030 |
| | 33,000 | 30 × 30 | 3.48 | 0.50 | 0.020 | 1.50 | LSG333M1C--A3030 |
| | 33,000 | 35 × 25 | 3.57 | 0.50 | 0.020 | 1.50 | LSG333M1C--A3525 |
| | 39,000 | 30 × 35 | 4.03 | 0.50 | 0.017 | 1.50 | LSG393M1C--A3035 |
| 39,000 | 35 × 30 | 4.16 | 0.50 | 0.017 | 1.50 | LSG393M1C--A3530 | |
| 47,000 | 35 × 35 | 4.85 | 0.50 | 0.014 | 1.50 | LSG473M1C--A3535 | |
| 25 | 8,200 | 22 × 25 | 1.73 | 0.45 | 0.073 | 1.36 | LSG822M1E--A2225 |
| | 10,000 | 22 × 30 | 2.05 | 0.45 | 0.060 | 1.50 | LSG103M1E--A2230 |
| | 10,000 | 25 × 25 | 2.05 | 0.45 | 0.060 | 1.50 | LSG103M1E--A2525 |
| | 12,000 | 22 × 35 | 2.23 | 0.45 | 0.050 | 1.50 | LSG123M1E--A2235 |
| | 12,000 | 25 × 25 | 2.09 | 0.45 | 0.050 | 1.50 | LSG123M1E--A2525 |
| | 12,000 | 30 × 25 | 2.45 | 0.45 | 0.050 | 1.50 | LSG123M1E--A3025 |
| | 12,000 | 35 × 25 | 2.74 | 0.45 | 0.050 | 1.50 | LSG123M1E--A3525 |
| | 15,000 | 22 × 40 | 2.65 | 0.45 | 0.040 | 1.50 | LSG153M1E--A2240 |
| | 15,000 | 25 × 35 | 2.80 | 0.45 | 0.040 | 1.50 | LSG153M1E--A2535 |
| | 15,000 | 30 × 25 | 2.72 | 0.45 | 0.040 | 1.50 | LSG153M1E--A3025 |
| | 15,000 | 35 × 25 | 3.00 | 0.45 | 0.040 | 1.50 | LSG153M1E--A3525 |
| | 18,000 | 22 × 45 | 2.93 | 0.45 | 0.033 | 1.50 | LSG183M1E--A2245 |
| | 18,000 | 25 × 35 | 2.83 | 0.45 | 0.033 | 1.50 | LSG183M1E--A2535 |
| | 18,000 | 30 × 30 | 3.07 | 0.45 | 0.033 | 1.50 | LSG183M1E--A3030 |
| | 18,000 | 35 × 25 | 3.02 | 0.45 | 0.033 | 1.50 | LSG183M1E--A3525 |
| | 22,000 | 22 × 50 | 3.31 | 0.45 | 0.027 | 1.50 | LSG223M1E--A2250 |
| | 22,000 | 25 × 40 | 3.22 | 0.45 | 0.027 | 1.50 | LSG223M1E--A2540 |
| | 22,000 | 30 × 30 | 3.18 | 0.45 | 0.027 | 1.50 | LSG223M1E--A3030 |
| 22,000 | 35 × 25 | 3.07 | 0.45 | 0.027 | 1.50 | LSG223M1E--A3525 | |
| 27,000 | 30 × 35 | 3.35 | 0.45 | 0.022 | 1.50 | LSG273M1E--A3035 | |
| 27,000 | 35 × 30 | 3.46 | 0.45 | 0.022 | 1.50 | LSG273M1E--A3530 | |
| 35 | 3,300 | 22 × 25 | 1.31 | 0.40 | 0.161 | 1.02 | LSG332M1V--A2225 |
| | 3,900 | 22 × 30 | 1.54 | 0.40 | 0.136 | 1.11 | LSG392M1V--A2230 |
| | 4,700 | 22 × 25 | 1.63 | 0.40 | 0.113 | 1.22 | LSG472M1V--A2225 |
| | 4,700 | 25 × 25 | 1.70 | 0.40 | 0.113 | 1.22 | LSG472M1V--A2525 |
| | 5,600 | 22 × 25 | 1.63 | 0.40 | 0.095 | 1.33 | LSG562M1V--A2225 |
| | 5,600 | 25 × 25 | 1.77 | 0.40 | 0.095 | 1.33 | LSG562M1V--A2525 |
| | 5,600 | 30 × 25 | 1.99 | 0.40 | 0.095 | 1.33 | LSG562M1V--A3025 |
| | 6,800 | 22 × 30 | 1.86 | 0.40 | 0.078 | 1.46 | LSG682M1V--A2230 |
| | 6,800 | 25 × 30 | 2.04 | 0.40 | 0.078 | 1.46 | LSG682M1V--A2530 |
| | 6,800 | 30 × 30 | 2.24 | 0.40 | 0.078 | 1.46 | LSG682M1V--A3030 |
| | 8,200 | 22 × 35 | 2.10 | 0.40 | 0.065 | 1.50 | LSG822M1V--A2235 |
| | 8,200 | 25 × 35 | 2.60 | 0.40 | 0.065 | 1.50 | LSG822M1V--A2535 |
| | 8,200 | 30 × 25 | 2.49 | 0.40 | 0.065 | 1.50 | LSG822M1V--A3025 |
| | 8,200 | 35 × 25 | 2.69 | 0.40 | 0.065 | 1.50 | LSG822M1V--A3525 |
| | 10,000 | 22 × 40 | 2.42 | 0.40 | 0.053 | 1.50 | LSG103M1V--A2240 |
| | 10,000 | 25 × 40 | 2.83 | 0.40 | 0.053 | 1.50 | LSG103M1V--A2540 |
| | 10,000 | 30 × 30 | 2.75 | 0.40 | 0.053 | 1.50 | LSG103M1V--A3030 |
| | 12,000 | 22 × 45 | 2.79 | 0.40 | 0.044 | 1.50 | LSG123M1V--A2245 |
| | 12,000 | 25 × 45 | 3.00 | 0.40 | 0.044 | 1.50 | LSG123M1V--A2545 |
| | 12,000 | 30 × 35 | 2.96 | 0.40 | 0.044 | 1.50 | LSG123M1V--A3035 |
| 12,000 | 35 × 25 | 2.75 | 0.40 | 0.044 | 1.50 | LSG123M1V--A3525 | |



Dimension & Permissible Ripple Current

| Working Voltage V _{DC} | Capacitance 120Hz, 20°C μF | φ D×L mm | Ripple Current 120 Hz, 105°C A/rms | Tan δ at 120Hz, 20°C | ESR 120Hz, 20°C Ω | LC 5 minutes mA | Part Number |
|------------------------------------|----------------------------------|-------------|--|-------------------------|-------------------------|-----------------------|------------------|
| 35 | 15,000 | 25 × 45 | 3.24 | 0.40 | 0.035 | 1.50 | LSG153M1V--A2545 |
| | 15,000 | 30 × 35 | 3.24 | 0.40 | 0.035 | 1.50 | LSG153M1V--A3035 |
| | 15,000 | 35 × 25 | 3.12 | 0.40 | 0.035 | 1.50 | LSG153M1V--A3525 |
| | 18,000 | 25 × 50 | 3.71 | 0.40 | 0.029 | 1.50 | LSG183M1V--A2550 |
| | 18,000 | 30 × 45 | 4.07 | 0.40 | 0.029 | 1.50 | LSG183M1V--A3045 |
| | 18,000 | 35 × 35 | 4.02 | 0.40 | 0.029 | 1.50 | LSG183M1V--A3535 |
| | 22,000 | 30 × 45 | 4.34 | 0.40 | 0.024 | 1.50 | LSG223M1V--A3045 |
| | 22,000 | 35 × 40 | 4.69 | 0.40 | 0.024 | 1.50 | LSG223M1V--A3540 |
| 50 | 1,800 | 22 × 25 | 1.33 | 0.35 | 0.258 | 0.90 | LSG182M1H--A2225 |
| | 2,200 | 22 × 25 | 1.48 | 0.35 | 0.211 | 0.99 | LSG222M1H--A2225 |
| | 2,700 | 22 × 25 | 1.53 | 0.35 | 0.172 | 1.10 | LSG272M1H--A2225 |
| | 2,700 | 25 × 25 | 1.57 | 0.35 | 0.172 | 1.10 | LSG272M1H--A2525 |
| | 3,300 | 22 × 30 | 1.76 | 0.35 | 0.141 | 1.22 | LSG332M1H--A2230 |
| | 3,300 | 25 × 25 | 1.70 | 0.35 | 0.141 | 1.22 | LSG332M1H--A2525 |
| | 3,900 | 22 × 35 | 1.97 | 0.35 | 0.119 | 1.32 | LSG392M1H--A2235 |
| | 3,900 | 25 × 25 | 1.82 | 0.35 | 0.119 | 1.32 | LSG392M1H--A2525 |
| | 3,900 | 30 × 25 | 1.95 | 0.35 | 0.119 | 1.32 | LSG392M1H--A3025 |
| | 4,700 | 22 × 35 | 2.01 | 0.35 | 0.099 | 1.45 | LSG472M1H--A2235 |
| | 4,700 | 25 × 30 | 2.18 | 0.35 | 0.099 | 1.45 | LSG472M1H--A2530 |
| | 4,700 | 30 × 25 | 2.04 | 0.35 | 0.099 | 1.45 | LSG472M1H--A3025 |
| | 4,700 | 35 × 25 | 2.48 | 0.35 | 0.099 | 1.45 | LSG472M1H--A3525 |
| | 5,600 | 22 × 40 | 2.32 | 0.35 | 0.083 | 1.50 | LSG562M1H--A2240 |
| | 5,600 | 25 × 35 | 2.47 | 0.35 | 0.083 | 1.50 | LSG562M1H--A2535 |
| | 5,600 | 30 × 25 | 2.33 | 0.35 | 0.083 | 1.50 | LSG562M1H--A3025 |
| | 6,800 | 22 × 45 | 2.70 | 0.35 | 0.068 | 1.50 | LSG682M1H--A2245 |
| | 6,800 | 25 × 40 | 2.92 | 0.35 | 0.068 | 1.50 | LSG682M1H--A2540 |
| | 6,800 | 30 × 30 | 2.84 | 0.35 | 0.068 | 1.50 | LSG682M1H--A3030 |
| | 6,800 | 35 × 25 | 2.91 | 0.35 | 0.068 | 1.50 | LSG682M1H--A3525 |
| | 8,200 | 25 × 45 | 3.13 | 0.35 | 0.057 | 1.50 | LSG822M1H--A2545 |
| | 8,200 | 30 × 35 | 3.13 | 0.35 | 0.057 | 1.50 | LSG822M1H--A3035 |
| | 8,200 | 35 × 30 | 3.23 | 0.35 | 0.057 | 1.50 | LSG822M1H--A3530 |
| | 10,000 | 25 × 50 | 3.39 | 0.35 | 0.046 | 1.50 | LSG103M1H--A2550 |
| | 10,000 | 30 × 40 | 3.55 | 0.35 | 0.046 | 1.50 | LSG103M1H--A3040 |
| | 10,000 | 35 × 30 | 3.47 | 0.35 | 0.046 | 1.50 | LSG103M1H--A3530 |
| | 12,000 | 30 × 45 | 4.04 | 0.35 | 0.039 | 1.50 | LSG123M1H--A3045 |
| | 12,000 | 35 × 35 | 3.98 | 0.35 | 0.039 | 1.50 | LSG123M1H--A3535 |
| 15,000 | 30 × 50 | 4.60 | 0.35 | 0.031 | 1.50 | LSG153M1H--A3050 | |
| 15,000 | 35 × 45 | 4.80 | 0.35 | 0.031 | 1.50 | LSG153M1H--A3545 | |
| 63 | 1,200 | 22 × 25 | 1.19 | 0.30 | 0.332 | 0.82 | LSG122M1J--A2225 |
| | 1,500 | 22 × 25 | 1.30 | 0.30 | 0.265 | 0.92 | LSG152M1J--A2225 |
| | 1,500 | 25 × 25 | 1.38 | 0.30 | 0.265 | 0.92 | LSG152M1J--A2525 |
| | 1,800 | 22 × 25 | 1.36 | 0.30 | 0.221 | 1.01 | LSG182M1J--A2225 |
| | 1,800 | 25 × 25 | 1.52 | 0.30 | 0.221 | 1.01 | LSG182M1J--A2525 |
| | 2,200 | 22 × 30 | 1.55 | 0.30 | 0.181 | 1.12 | LSG222M1J--A2230 |
| | 2,200 | 25 × 25 | 1.60 | 0.30 | 0.181 | 1.12 | LSG222M1J--A2525 |
| | 2,700 | 22 × 35 | 1.89 | 0.30 | 0.147 | 1.24 | LSG272M1J--A2235 |
| | 2,700 | 25 × 30 | 1.90 | 0.30 | 0.147 | 1.24 | LSG272M1J--A2530 |
| | 2,700 | 30 × 25 | 1.97 | 0.30 | 0.147 | 1.24 | LSG272M1J--A3025 |
| | 3,300 | 22 × 40 | 1.99 | 0.30 | 0.121 | 1.37 | LSG332M1J--A2240 |
| | 3,300 | 25 × 35 | 2.06 | 0.30 | 0.121 | 1.37 | LSG332M1J--A2535 |
| | 3,300 | 30 × 25 | 2.00 | 0.30 | 0.121 | 1.37 | LSG332M1J--A3025 |
| | 3,300 | 35 × 25 | 2.22 | 0.30 | 0.121 | 1.37 | LSG332M1J--A3525 |
| | 3,900 | 22 × 45 | 2.34 | 0.30 | 0.102 | 1.49 | LSG392M1J--A2245 |
| | 3,900 | 25 × 35 | 2.20 | 0.30 | 0.102 | 1.49 | LSG392M1J--A2535 |
| | 3,900 | 30 × 25 | 2.18 | 0.30 | 0.102 | 1.49 | LSG392M1J--A3025 |
| | 3,900 | 35 × 25 | 2.40 | 0.30 | 0.102 | 1.49 | LSG392M1J--A3525 |
| | 4,700 | 22 × 50 | 2.58 | 0.30 | 0.085 | 1.50 | LSG472M1J--A2250 |
| | 4,700 | 25 × 40 | 2.51 | 0.30 | 0.085 | 1.50 | LSG472M1J--A2540 |
| | 4,700 | 30 × 30 | 2.48 | 0.30 | 0.085 | 1.50 | LSG472M1J--A3030 |
| | 4,700 | 35 × 25 | 2.54 | 0.30 | 0.085 | 1.50 | LSG472M1J--A3525 |
| | 5,600 | 25 × 45 | 2.92 | 0.30 | 0.071 | 1.50 | LSG562M1J--A2545 |
| | 5,600 | 30 × 35 | 2.91 | 0.30 | 0.071 | 1.50 | LSG562M1J--A3035 |
| | 5,600 | 35 × 30 | 3.00 | 0.30 | 0.071 | 1.50 | LSG562M1J--A3530 |
| | 6,800 | 30 × 50 | 3.65 | 0.30 | 0.059 | 1.50 | LSG682M1J--A3050 |
| | 6,800 | 35 × 30 | 3.30 | 0.30 | 0.059 | 1.50 | LSG682M1J--A3530 |



Dimension & Permissible Ripple Current

| Working Voltage V _{DC} | Capacitance 120Hz, 20°C μF | φ D×L mm | Ripple Current 120 Hz, 105°C A/rms | Tan δ at 120Hz, 20°C | ESR 120Hz, 20°C Ω | LC 5 minutes mA | Part Number |
|------------------------------------|----------------------------------|-------------|--|-------------------------|-------------------------|-----------------------|------------------|
| 63 | 8,200 | 30 × 45 | 3.57 | 0.30 | 0.049 | 1.50 | LSG822M1J--A3045 |
| | 8,200 | 35 × 35 | 3.52 | 0.30 | 0.049 | 1.50 | LSG822M1J--A3535 |
| | 10,000 | 35 × 40 | 3.90 | 0.30 | 0.040 | 1.50 | LSG103M1J--A3540 |
| | 12,000 | 35 × 45 | 4.50 | 0.30 | 0.033 | 1.50 | LSG123M1J--A3545 |
| 80 | 1,000 | 22 × 25 | 1.05 | 0.25 | 0.332 | 0.85 | LSG102M1K--A2225 |
| | 1,200 | 22 × 30 | 1.24 | 0.25 | 0.276 | 0.93 | LSG122M1K--A2230 |
| | 1,500 | 22 × 35 | 1.48 | 0.25 | 0.221 | 1.04 | LSG152M1K--A2235 |
| | 1,500 | 25 × 25 | 1.38 | 0.25 | 0.221 | 1.04 | LSG152M1K--A2525 |
| | 1,800 | 22 × 40 | 1.72 | 0.25 | 0.184 | 1.14 | LSG182M1K--A2240 |
| | 1,800 | 25 × 30 | 1.63 | 0.25 | 0.184 | 1.14 | LSG182M1K--A2530 |
| | 2,200 | 22 × 45 | 1.82 | 0.25 | 0.151 | 1.26 | LSG222M1K--A2245 |
| | 2,200 | 25 × 30 | 1.65 | 0.25 | 0.151 | 1.26 | LSG222M1K--A2530 |
| | 2,700 | 25 × 45 | 2.17 | 0.25 | 0.123 | 1.39 | LSG272M1K--A2545 |
| | 2,700 | 30 × 30 | 2.03 | 0.25 | 0.123 | 1.39 | LSG272M1K--A3030 |
| | 3,300 | 25 × 50 | 2.51 | 0.25 | 0.101 | 1.50 | LSG332M1K--A2550 |
| | 3,300 | 35 × 25 | 2.30 | 0.25 | 0.101 | 1.50 | LSG332M1K--A3525 |
| | 3,900 | 30 × 45 | 2.89 | 0.25 | 0.085 | 1.50 | LSG392M1K--A3045 |
| | 3,900 | 35 × 30 | 2.68 | 0.25 | 0.085 | 1.50 | LSG392M1K--A3530 |
| | 4,700 | 30 × 50 | 2.97 | 0.25 | 0.071 | 1.50 | LSG472M1K--A3050 |
| | 4,700 | 35 × 30 | 2.64 | 0.25 | 0.071 | 1.50 | LSG472M1K--A3530 |
| | 5,600 | 30 × 45 | 3.10 | 0.25 | 0.059 | 1.50 | LSG562M1K--A3045 |
| | 5,600 | 35 × 45 | 3.39 | 0.25 | 0.059 | 1.50 | LSG562M1K--A3545 |
| 6,800 | 35 × 40 | 3.56 | 0.25 | 0.049 | 1.50 | LSG682M1K--A3540 | |
| 6,800 | 35 × 50 | 3.90 | 0.25 | 0.049 | 1.50 | LSG682M1K--A3550 | |
| 100 | 820 | 22 × 30 | 1.14 | 0.20 | 0.324 | 0.86 | LSG821M2A--A2230 |
| | 1,000 | 22 × 30 | 1.26 | 0.20 | 0.265 | 0.95 | LSG102M2A--A2230 |
| | 1,200 | 22 × 35 | 1.55 | 0.20 | 0.221 | 1.04 | LSG122M2A--A2235 |
| | 1,200 | 25 × 30 | 1.56 | 0.20 | 0.221 | 1.04 | LSG122M2A--A2530 |
| | 1,200 | 30 × 25 | 1.68 | 0.20 | 0.221 | 1.04 | LSG122M2A--A3025 |
| | 1,500 | 22 × 40 | 1.78 | 0.20 | 0.177 | 1.16 | LSG152M2A--A2240 |
| | 1,500 | 25 × 35 | 1.80 | 0.20 | 0.177 | 1.16 | LSG152M2A--A2535 |
| | 1,500 | 30 × 25 | 1.76 | 0.20 | 0.177 | 1.16 | LSG152M2A--A3025 |
| | 1,500 | 35 × 25 | 1.98 | 0.20 | 0.177 | 1.16 | LSG152M2A--A3525 |
| | 1,800 | 22 × 45 | 1.99 | 0.20 | 0.147 | 1.27 | LSG182M2A--A2245 |
| | 1,800 | 25 × 35 | 1.95 | 0.20 | 0.147 | 1.27 | LSG182M2A--A2535 |
| | 1,800 | 30 × 30 | 2.29 | 0.20 | 0.147 | 1.27 | LSG182M2A--A3030 |
| | 1,800 | 35 × 25 | 2.34 | 0.20 | 0.147 | 1.27 | LSG182M2A--A3525 |
| | 2,200 | 22 × 50 | 2.21 | 0.20 | 0.121 | 1.41 | LSG222M2A--A2250 |
| | 2,200 | 25 × 40 | 2.15 | 0.20 | 0.121 | 1.41 | LSG222M2A--A2540 |
| | 2,200 | 30 × 30 | 2.12 | 0.20 | 0.121 | 1.41 | LSG222M2A--A3030 |
| | 2,200 | 35 × 25 | 2.27 | 0.20 | 0.121 | 1.41 | LSG222M2A--A3525 |
| | 2,700 | 25 × 50 | 2.59 | 0.20 | 0.098 | 1.50 | LSG272M2A--A2550 |
| | 2,700 | 30 × 35 | 2.37 | 0.20 | 0.098 | 1.50 | LSG272M2A--A3035 |
| | 2,700 | 35 × 30 | 2.62 | 0.20 | 0.098 | 1.50 | LSG272M2A--A3530 |
| | 3,300 | 30 × 40 | 2.77 | 0.20 | 0.080 | 1.50 | LSG332M2A--A3040 |
| | 3,300 | 35 × 35 | 2.99 | 0.20 | 0.080 | 1.50 | LSG332M2A--A3535 |
| | 3,900 | 30 × 45 | 3.02 | 0.20 | 0.068 | 1.50 | LSG392M2A--A3045 |
| | 3,900 | 35 × 40 | 3.35 | 0.20 | 0.068 | 1.50 | LSG392M2A--A3540 |
| 4,700 | 35 × 40 | 3.30 | 0.20 | 0.056 | 1.50 | LSG472M2A--A3540 | |
| 5,600 | 35 × 45 | 3.51 | 0.20 | 0.047 | 1.50 | LSG562M2A--A3545 | |
| 160 | 270 | 22 × 25 | 0.86 | 0.15 | 0.737 | 0.62 | LSG271M2C--A2225 |
| | 330 | 22 × 25 | 1.10 | 0.15 | 0.603 | 0.69 | LSG331M2C--A2225 |
| | 390 | 22 × 30 | 1.22 | 0.15 | 0.510 | 0.75 | LSG391M2C--A2230 |
| | 390 | 25 × 25 | 1.15 | 0.15 | 0.510 | 0.75 | LSG391M2C--A2525 |
| | 470 | 22 × 35 | 1.35 | 0.15 | 0.423 | 0.82 | LSG471M2C--A2235 |
| | 470 | 25 × 25 | 1.33 | 0.15 | 0.423 | 0.82 | LSG471M2C--A2525 |
| | 560 | 22 × 40 | 1.50 | 0.15 | 0.355 | 0.90 | LSG561M2C--A2240 |
| | 560 | 25 × 30 | 1.45 | 0.15 | 0.355 | 0.90 | LSG561M2C--A2530 |
| | 560 | 30 × 25 | 1.40 | 0.15 | 0.355 | 0.90 | LSG561M2C--A3025 |
| | 680 | 22 × 45 | 1.65 | 0.15 | 0.293 | 0.99 | LSG681M2C--A2245 |
| | 680 | 25 × 35 | 1.65 | 0.15 | 0.293 | 0.99 | LSG681M2C--A2535 |
| | 680 | 30 × 25 | 1.65 | 0.15 | 0.293 | 0.99 | LSG681M2C--A3025 |
| | 820 | 22 × 50 | 1.93 | 0.15 | 0.243 | 1.09 | LSG821M2C--A2250 |
| | 820 | 25 × 40 | 1.85 | 0.15 | 0.243 | 1.09 | LSG821M2C--A2540 |



Dimension & Permissible Ripple Current

| Working Voltage V _{DC} | Capacitance 120Hz, 20°C μF | φ D×L mm | Ripple Current 120 Hz, 105°C A/rms | Tan δ at 120Hz, 20°C | ESR 120Hz, 20°C Ω | LC 5 minutes mA | Part Number |
|------------------------------------|----------------------------------|-------------|--|-------------------------|-------------------------|-----------------------|------------------|
| 160 | 820 | 30 × 30 | 1.76 | 0.15 | 0.243 | 1.09 | LSG821M2C--A3030 |
| | 820 | 35 × 25 | 1.91 | 0.15 | 0.243 | 1.09 | LSG821M2C--A3525 |
| | 1,000 | 25 × 45 | 2.20 | 0.15 | 0.199 | 1.20 | LSG102M2C--A2545 |
| | 1,000 | 30 × 35 | 2.02 | 0.15 | 0.199 | 1.20 | LSG102M2C--A3035 |
| | 1,000 | 35 × 30 | 2.44 | 0.15 | 0.199 | 1.20 | LSG102M2C--A3530 |
| | 1,200 | 25 × 50 | 2.45 | 0.15 | 0.166 | 1.31 | LSG122M2C--A2550 |
| | 1,200 | 30 × 40 | 2.35 | 0.15 | 0.166 | 1.31 | LSG122M2C--A3040 |
| | 1,200 | 35 × 35 | 2.50 | 0.15 | 0.166 | 1.31 | LSG122M2C--A3535 |
| | 1,500 | 30 × 45 | 2.82 | 0.15 | 0.133 | 1.47 | LSG152M2C--A3045 |
| | 1,500 | 35 × 40 | 2.70 | 0.15 | 0.133 | 1.47 | LSG152M2C--A3540 |
| | 1,800 | 30 × 50 | 3.31 | 0.15 | 0.111 | 1.50 | LSG182M2C--A3050 |
| | 1,800 | 35 × 45 | 2.85 | 0.15 | 0.111 | 1.50 | LSG182M2C--A3545 |
| | 200 | 270 | 22 × 25 | 0.95 | 0.15 | 0.737 | 0.70 |
| 330 | | 22 × 30 | 1.13 | 0.15 | 0.603 | 0.77 | LSG331M2D--A2230 |
| 330 | | 25 × 25 | 1.13 | 0.15 | 0.603 | 0.77 | LSG331M2D--A2525 |
| 390 | | 22 × 35 | 1.25 | 0.15 | 0.510 | 0.84 | LSG391M2D--A2235 |
| 390 | | 25 × 30 | 1.21 | 0.15 | 0.510 | 0.84 | LSG391M2D--A2530 |
| 390 | | 30 × 25 | 1.20 | 0.15 | 0.510 | 0.84 | LSG391M2D--A3025 |
| 470 | | 22 × 35 | 1.23 | 0.15 | 0.423 | 0.92 | LSG471M2D--A2235 |
| 470 | | 25 × 30 | 1.32 | 0.15 | 0.423 | 0.92 | LSG471M2D--A2530 |
| 470 | | 30 × 25 | 1.50 | 0.15 | 0.423 | 0.92 | LSG471M2D--A3025 |
| 560 | | 22 × 40 | 1.43 | 0.15 | 0.355 | 1.00 | LSG561M2D--A2240 |
| 560 | | 25 × 35 | 1.50 | 0.15 | 0.355 | 1.00 | LSG561M2D--A2535 |
| 560 | | 30 × 30 | 1.52 | 0.15 | 0.355 | 1.00 | LSG561M2D--A3030 |
| 560 | | 35 × 25 | 1.49 | 0.15 | 0.355 | 1.00 | LSG561M2D--A3525 |
| 680 | | 22 × 50 | 1.74 | 0.15 | 0.293 | 1.11 | LSG681M2D--A2250 |
| 680 | | 25 × 40 | 1.70 | 0.15 | 0.293 | 1.11 | LSG681M2D--A2540 |
| 680 | | 30 × 30 | 1.58 | 0.15 | 0.293 | 1.11 | LSG681M2D--A3030 |
| 680 | | 35 × 25 | 1.72 | 0.15 | 0.293 | 1.11 | LSG681M2D--A3525 |
| 820 | | 25 × 45 | 1.85 | 0.15 | 0.243 | 1.21 | LSG821M2D--A2545 |
| 820 | | 30 × 35 | 1.85 | 0.15 | 0.243 | 1.21 | LSG821M2D--A3035 |
| 820 | | 35 × 30 | 1.90 | 0.15 | 0.243 | 1.21 | LSG821M2D--A3530 |
| 1,000 | | 25 × 55 | 2.13 | 0.15 | 0.199 | 1.34 | LSG102M2D--A2555 |
| 1,000 | | 30 × 40 | 2.06 | 0.15 | 0.199 | 1.34 | LSG102M2D--A3040 |
| 1,000 | | 35 × 30 | 2.01 | 0.15 | 0.199 | 1.34 | LSG102M2D--A3530 |
| 1,200 | | 30 × 45 | 2.37 | 0.15 | 0.166 | 1.47 | LSG122M2D--A3045 |
| 1,200 | | 35 × 35 | 2.34 | 0.15 | 0.166 | 1.47 | LSG122M2D--A3535 |
| 1,500 | | 30 × 50 | 2.77 | 0.15 | 0.133 | 1.50 | LSG152M2D--A3050 |
| 1,500 | | 35 × 40 | 2.76 | 0.15 | 0.133 | 1.50 | LSG152M2D--A3540 |
| 1,800 | 35 × 45 | 3.17 | 0.15 | 0.111 | 1.50 | LSG182M2D--A3545 | |
| 2,200 | 35 × 55 | 3.82 | 0.15 | 0.090 | 1.50 | LSG222M2D--A3555 | |
| 2,700 | 40 × 50 | 4.39 | 0.15 | 0.074 | 1.50 | LSG272M2D--A4050 | |
| 250 | 180 | 22 × 25 | 0.78 | 0.15 | 1.106 | 0.64 | LSG181M2E--A2225 |
| | 220 | 22 × 30 | 0.85 | 0.15 | 0.905 | 0.70 | LSG221M2E--A2230 |
| | 220 | 25 × 25 | 0.90 | 0.15 | 0.905 | 0.70 | LSG221M2E--A2525 |
| | 270 | 22 × 30 | 0.91 | 0.15 | 0.737 | 0.78 | LSG271M2E--A2230 |
| | 270 | 25 × 25 | 0.91 | 0.15 | 0.737 | 0.78 | LSG271M2E--A2525 |
| | 270 | 30 × 25 | 1.01 | 0.15 | 0.737 | 0.78 | LSG271M2E--A3025 |
| | 330 | 22 × 35 | 1.03 | 0.15 | 0.603 | 0.86 | LSG331M2E--A2235 |
| | 330 | 25 × 30 | 1.13 | 0.15 | 0.603 | 0.86 | LSG331M2E--A2530 |
| | 330 | 30 × 25 | 1.05 | 0.15 | 0.603 | 0.86 | LSG331M2E--A3025 |
| | 390 | 22 × 40 | 1.13 | 0.15 | 0.510 | 0.94 | LSG391M2E--A2240 |
| | 390 | 25 × 35 | 1.27 | 0.15 | 0.510 | 0.94 | LSG391M2E--A2535 |
| | 390 | 30 × 25 | 1.11 | 0.15 | 0.510 | 0.94 | LSG391M2E--A3025 |
| | 470 | 22 × 45 | 1.31 | 0.15 | 0.423 | 1.03 | LSG471M2E--A2245 |
| | 470 | 25 × 40 | 1.49 | 0.15 | 0.423 | 1.03 | LSG471M2E--A2540 |
| | 470 | 30 × 30 | 1.37 | 0.15 | 0.423 | 1.03 | LSG471M2E--A3030 |
| | 470 | 35 × 25 | 1.17 | 0.15 | 0.423 | 1.03 | LSG471M2E--A3525 |
| | 560 | 25 × 45 | 1.79 | 0.15 | 0.355 | 1.12 | LSG561M2E--A2545 |
| | 560 | 30 × 35 | 1.58 | 0.15 | 0.355 | 1.12 | LSG561M2E--A3035 |
| | 560 | 35 × 25 | 1.61 | 0.15 | 0.355 | 1.12 | LSG561M2E--A3525 |
| | 680 | 25 × 50 | 1.77 | 0.15 | 0.293 | 1.24 | LSG681M2E--A2550 |
| | 680 | 30 × 40 | 2.00 | 0.15 | 0.293 | 1.24 | LSG681M2E--A3040 |
| | 680 | 35 × 30 | 1.95 | 0.15 | 0.293 | 1.24 | LSG681M2E--A3530 |



Dimension & Permissible Ripple Current

| Working Voltage V _{DC} | Capacitance 120Hz, 20°C μF | φ D×L mm | Ripple Current 120 Hz, 105°C A/rms | Tan δ at 120Hz, 20°C | ESR 120Hz, 20°C Ω | LC 5 minutes mA | Part Number |
|------------------------------------|----------------------------------|-------------|--|-------------------------|-------------------------|-----------------------|------------------|
| 250 | 820 | 30 × 45 | 2.30 | 0.15 | 0.243 | 1.36 | LSG821M2E--A3045 |
| | 820 | 35 × 35 | 2.27 | 0.15 | 0.243 | 1.36 | LSG821M2E--A3535 |
| | 1,000 | 30 × 50 | 2.37 | 0.15 | 0.199 | 1.50 | LSG102M2E--A3050 |
| | 1,000 | 35 × 40 | 2.65 | 0.15 | 0.199 | 1.50 | LSG102M2E--A3540 |
| | 1,200 | 30 × 55 | 2.71 | 0.15 | 0.166 | 1.50 | LSG122M2E--A3055 |
| | 1,200 | 35 × 45 | 3.05 | 0.15 | 0.166 | 1.50 | LSG122M2E--A3545 |
| | 1,500 | 35 × 50 | 3.18 | 0.15 | 0.133 | 1.50 | LSG152M2E--A3550 |
| | 1,800 | 35 × 60 | 3.76 | 0.15 | 0.111 | 1.50 | LSG182M2E--A3560 |
| | 2,200 | 35 × 70 | 4.45 | 0.15 | 0.090 | 1.50 | LSG222M2E--A3570 |
| 350 | 100 | 22 × 25 | 0.58 | 0.15 | 2.927 | 0.46 | LSG101M2V--A2225 |
| | 120 | 22 × 30 | 0.69 | 0.15 | 1.990 | 0.56 | LSG121M2V--A2230 |
| | 120 | 25 × 25 | 0.69 | 0.15 | 1.990 | 0.56 | LSG121M2V--A2525 |
| | 150 | 22 × 35 | 0.80 | 0.15 | 1.327 | 0.69 | LSG151M2V--A2235 |
| | 180 | 25 × 30 | 0.82 | 0.15 | 1.106 | 0.75 | LSG181M2V--A2530 |
| | 180 | 30 × 25 | 0.85 | 0.15 | 1.106 | 0.75 | LSG181M2V--A3025 |
| | 220 | 22 × 40 | 0.95 | 0.15 | 0.905 | 0.83 | LSG221M2V--A2240 |
| | 220 | 25 × 40 | 1.04 | 0.15 | 0.905 | 0.83 | LSG221M2V--A2540 |
| | 220 | 30 × 30 | 1.02 | 0.15 | 0.905 | 0.83 | LSG221M2V--A3030 |
| | 220 | 35 × 25 | 1.04 | 0.15 | 0.905 | 0.83 | LSG221M2V--A3525 |
| | 270 | 25 × 45 | 1.17 | 0.15 | 0.737 | 0.92 | LSG271M2V--A2545 |
| | 270 | 30 × 35 | 1.17 | 0.15 | 0.737 | 0.92 | LSG271M2V--A3035 |
| | 270 | 35 × 25 | 1.12 | 0.15 | 0.737 | 0.92 | LSG271M2V--A3525 |
| | 330 | 25 × 50 | 1.20 | 0.15 | 0.603 | 1.02 | LSG331M2V--A2550 |
| | 330 | 30 × 35 | 1.12 | 0.15 | 0.603 | 1.02 | LSG331M2V--A3035 |
| | 330 | 35 × 30 | 1.21 | 0.15 | 0.603 | 1.02 | LSG331M2V--A3530 |
| | 390 | 30 × 40 | 1.29 | 0.15 | 0.510 | 1.11 | LSG391M2V--A3040 |
| | 470 | 30 × 45 | 1.48 | 0.15 | 0.423 | 1.22 | LSG471M2V--A3045 |
| | 470 | 35 × 40 | 1.63 | 0.15 | 0.423 | 1.22 | LSG471M2V--A3540 |
| | 560 | 35 × 40 | 1.69 | 0.15 | 0.355 | 1.33 | LSG561M2V--A3540 |
| | 560 | 40 × 30 | 1.63 | 0.15 | 0.355 | 1.33 | LSG561M2V--A4030 |
| | 680 | 35 × 35 | 1.52 | 0.15 | 0.293 | 1.46 | LSG681M2V--A3535 |
| | 680 | 40 × 35 | 1.58 | 0.15 | 0.293 | 1.46 | LSG681M2V--A4035 |
| | 820 | 35 × 50 | 1.86 | 0.15 | 0.243 | 1.50 | LSG821M2V--A3550 |
| | 820 | 40 × 50 | 2.01 | 0.15 | 0.243 | 1.50 | LSG821M2V--A4050 |
| | 1,000 | 35 × 60 | 2.22 | 0.15 | 0.199 | 1.50 | LSG102M2V--A3560 |
| | 1,000 | 40 × 50 | 2.21 | 0.15 | 0.199 | 1.50 | LSG102M2V--A4050 |
| 1,200 | 40 × 55 | 2.52 | 0.15 | 0.166 | 1.50 | LSG122M2V--A4055 | |
| 1,500 | 40 × 65 | 3.03 | 0.15 | 0.133 | 1.50 | LSG152M2V--A4065 | |
| 400 | 100 | 22 × 25 | 0.52 | 0.15 | 1.990 | 0.60 | LSG101M2G--A2225 |
| | 120 | 22 × 30 | 0.62 | 0.15 | 1.659 | 0.66 | LSG121M2G--A2230 |
| | 120 | 25 × 25 | 0.61 | 0.15 | 1.659 | 0.66 | LSG121M2G--A2525 |
| | 150 | 22 × 35 | 0.70 | 0.15 | 1.327 | 0.73 | LSG151M2G--A2235 |
| | 150 | 25 × 30 | 0.73 | 0.15 | 1.327 | 0.73 | LSG151M2G--A2530 |
| | 180 | 22 × 40 | 0.81 | 0.15 | 1.106 | 0.80 | LSG181M2G--A2240 |
| | 180 | 25 × 35 | 0.85 | 0.15 | 1.106 | 0.80 | LSG181M2G--A2535 |
| | 180 | 30 × 25 | 0.83 | 0.15 | 1.106 | 0.80 | LSG181M2G--A3025 |
| | 220 | 22 × 45 | 0.94 | 0.15 | 0.905 | 0.89 | LSG221M2G--A2245 |
| | 220 | 25 × 40 | 1.00 | 0.15 | 0.905 | 0.89 | LSG221M2G--A2540 |
| | 220 | 30 × 30 | 0.99 | 0.15 | 0.905 | 0.89 | LSG221M2G--A3030 |
| | 270 | 22 × 55 | 1.14 | 0.15 | 0.737 | 0.99 | LSG271M2G--A2255 |
| | 270 | 25 × 45 | 1.17 | 0.15 | 0.737 | 0.99 | LSG271M2G--A2545 |
| | 270 | 30 × 35 | 1.16 | 0.15 | 0.737 | 0.99 | LSG271M2G--A3035 |
| | 270 | 35 × 25 | 1.08 | 0.15 | 0.737 | 0.99 | LSG271M2G--A3525 |
| | 330 | 25 × 50 | 1.30 | 0.15 | 0.603 | 1.09 | LSG331M2G--A2550 |
| | 330 | 30 × 40 | 1.36 | 0.15 | 0.603 | 1.09 | LSG331M2G--A3040 |
| | 390 | 30 × 45 | 1.56 | 0.15 | 0.510 | 1.18 | LSG391M2G--A3045 |
| | 390 | 35 × 30 | 1.44 | 0.15 | 0.510 | 1.18 | LSG391M2G--A3530 |
| | 470 | 30 × 50 | 1.72 | 0.15 | 0.423 | 1.30 | LSG471M2G--A3050 |
| | 470 | 35 × 40 | 1.78 | 0.15 | 0.423 | 1.30 | LSG471M2G--A3540 |
| | 560 | 30 × 55 | 1.95 | 0.15 | 0.355 | 1.42 | LSG561M2G--A3055 |
| | 560 | 35 × 40 | 1.86 | 0.15 | 0.355 | 1.42 | LSG561M2G--A3540 |
| | 560 | 40 × 35 | 1.91 | 0.15 | 0.355 | 1.42 | LSG561M2G--A4035 |

Dimension & Permissible Ripple Current

| Working Voltage V. DC | Capacitance 120Hz, 20°C μF | φ D×L mm | Ripple Current 120 Hz, 105°C A/rms | Tan δ at 120Hz, 20°C | ESR 120Hz, 20°C Ω | LC 5 minutes mA | Part Number |
|--------------------------|----------------------------------|-------------|--|-------------------------|-------------------------|-----------------------|------------------|
| 400 | 680 | 35 × 50 | 2.25 | 0.15 | 0.293 | 1.50 | LSG681M2G--A3550 |
| | 680 | 40 × 40 | 2.22 | 0.15 | 0.293 | 1.50 | LSG681M2G--A4040 |
| | 820 | 35 × 55 | 2.58 | 0.15 | 0.243 | 1.50 | LSG821M2G--A3555 |
| | 820 | 40 × 50 | 2.67 | 0.15 | 0.243 | 1.50 | LSG821M2G--A4050 |
| | 1,000 | 35 × 65 | 2.90 | 0.15 | 0.243 | 1.50 | LSG102M2G--A3565 |
| | 1,000 | 40 × 55 | 2.92 | 0.15 | 0.199 | 1.50 | LSG102M2G--A4055 |
| | 1,200 | 35 × 75 | 3.39 | 0.15 | 0.199 | 1.50 | LSG122M2G--A3575 |
| | 1,200 | 40 × 60 | 3.31 | 0.15 | 0.166 | 1.50 | LSG122M2G--A4060 |
| | 1,500 | 45 × 70 | 4.23 | 0.15 | 0.133 | 1.50 | LSG152M2G--A4570 |
| | 1,800 | 45 × 80 | 4.92 | 0.15 | 0.111 | 1.50 | LSG182M2G--A4580 |
| 420 | 82 | 22 × 25 | 0.45 | 0.15 | 2.427 | 0.56 | LSG820M2P--A2225 |
| | 100 | 22 × 30 | 0.53 | 0.15 | 1.990 | 0.61 | LSG101M2P--A2230 |
| | 120 | 22 × 35 | 0.62 | 0.15 | 1.659 | 0.67 | LSG121M2P--A2235 |
| | 120 | 25 × 25 | 0.58 | 0.15 | 1.659 | 0.67 | LSG121M2P--A2525 |
| | 150 | 22 × 40 | 0.74 | 0.15 | 1.327 | 0.75 | LSG151M2P--A2240 |
| | 180 | 22 × 45 | 0.85 | 0.15 | 1.106 | 0.82 | LSG181M2P--A2245 |
| | 180 | 25 × 30 | 0.77 | 0.15 | 1.106 | 0.82 | LSG181M2P--A2530 |
| | 220 | 22 × 50 | 1.00 | 0.15 | 0.905 | 0.91 | LSG221M2P--A2250 |
| | 220 | 25 × 40 | 0.96 | 0.15 | 0.905 | 0.91 | LSG221M2P--A2540 |
| | 220 | 30 × 30 | 0.95 | 0.15 | 0.905 | 0.91 | LSG221M2P--A3030 |
| | 270 | 22 × 60 | 1.20 | 0.15 | 0.737 | 1.01 | LSG271M2P--A2260 |
| | 270 | 25 × 50 | 1.10 | 0.15 | 0.737 | 1.01 | LSG271M2P--A2550 |
| | 270 | 30 × 35 | 1.06 | 0.15 | 0.737 | 1.01 | LSG271M2P--A3035 |
| | 270 | 35 × 30 | 1.09 | 0.15 | 0.737 | 1.01 | LSG271M2P--A3530 |
| | 330 | 25 × 55 | 1.36 | 0.15 | 0.603 | 1.12 | LSG331M2P--A2555 |
| | 330 | 30 × 40 | 1.24 | 0.15 | 0.603 | 1.12 | LSG331M2P--A3040 |
| | 330 | 35 × 30 | 1.21 | 0.15 | 0.603 | 1.12 | LSG331M2P--A3530 |
| | 390 | 30 × 45 | 1.42 | 0.15 | 0.510 | 1.21 | LSG391M2P--A3045 |
| | 390 | 35 × 35 | 1.40 | 0.15 | 0.510 | 1.21 | LSG391M2P--A3535 |
| | 390 | 40 × 40 | 1.60 | 0.15 | 0.510 | 1.21 | LSG391M2P--A4040 |
| | 470 | 35 × 40 | 1.62 | 0.15 | 0.423 | 1.33 | LSG471M2P--A3540 |
| | 470 | 40 × 35 | 1.66 | 0.15 | 0.423 | 1.33 | LSG471M2P--A4035 |
| | 560 | 35 × 45 | 1.77 | 0.15 | 0.355 | 1.45 | LSG561M2P--A3545 |
| | 560 | 40 × 40 | 1.82 | 0.15 | 0.355 | 1.45 | LSG561M2P--A4040 |
| | 680 | 35 × 50 | 2.12 | 0.15 | 0.293 | 1.50 | LSG681M2P--A3550 |
| | 680 | 40 × 45 | 2.11 | 0.15 | 0.293 | 1.50 | LSG681M2P--A4045 |
| | 820 | 35 × 60 | 2.42 | 0.15 | 0.243 | 1.50 | LSG821M2P--A3560 |
| | 820 | 40 × 55 | 2.52 | 0.15 | 0.243 | 1.50 | LSG821M2P--A4055 |
| 1,000 | 35 × 70 | 3.08 | 0.15 | 0.199 | 1.50 | LSG102M2P--A3570 | |
| 1,000 | 40 × 60 | 2.88 | 0.15 | 0.199 | 1.50 | LSG102M2P--A4060 | |
| 1,200 | 35 × 90 | 3.51 | 0.15 | 0.166 | 1.50 | LSG122M2P--A3590 | |
| 1,200 | 40 × 70 | 3.38 | 0.15 | 0.166 | 1.50 | LSG122M2P--A4070 | |
| 450 | 82 | 22 × 25 | 0.45 | 0.15 | 2.427 | 0.58 | LSG820M2W--A2225 |
| | 100 | 22 × 30 | 0.53 | 0.15 | 1.990 | 0.54 | LSG101M2W--A2230 |
| | 100 | 25 × 25 | 0.51 | 0.15 | 1.990 | 0.64 | LSG101M2W--A2525 |
| | 120 | 22 × 35 | 0.62 | 0.15 | 1.659 | 0.70 | LSG121M2W--A2235 |
| | 150 | 22 × 40 | 0.74 | 0.15 | 1.327 | 0.78 | LSG151M2W--A2240 |
| | 150 | 25 × 30 | 0.70 | 0.15 | 1.327 | 0.78 | LSG151M2W--A2530 |
| | 150 | 35 × 25 | 0.83 | 0.15 | 1.327 | 0.78 | LSG151M2W--A3525 |
| | 180 | 22 × 45 | 0.88 | 0.15 | 1.106 | 0.85 | LSG181M2W--A2245 |
| | 180 | 25 × 35 | 0.82 | 0.15 | 1.106 | 0.85 | LSG181M2W--A2535 |
| | 180 | 30 × 25 | 0.80 | 0.15 | 1.106 | 0.85 | LSG181M2W--A3025 |
| | 220 | 25 × 40 | 0.96 | 0.15 | 0.905 | 0.94 | LSG221M2W--A2540 |
| | 220 | 30 × 30 | 0.95 | 0.15 | 0.905 | 0.94 | LSG221M2W--A3030 |
| | 270 | 25 × 50 | 1.21 | 0.15 | 0.737 | 1.05 | LSG271M2W--A2550 |
| | 270 | 30 × 35 | 1.12 | 0.15 | 0.737 | 1.05 | LSG271M2W--A3035 |
| | 330 | 25 × 55 | 1.35 | 0.15 | 0.603 | 1.06 | LSG331M2W--A2555 |
| | 330 | 30 × 40 | 1.31 | 0.15 | 0.603 | 1.06 | LSG331M2W--A3040 |
| | 330 | 35 × 30 | 1.27 | 0.15 | 0.603 | 1.06 | LSG331M2W--A3530 |
| | 390 | 30 × 45 | 1.49 | 0.15 | 0.510 | 1.26 | LSG391M2W--A3045 |
| | 390 | 35 × 35 | 1.47 | 0.15 | 0.510 | 1.26 | LSG391M2W--A3535 |
| | 390 | 40 × 30 | 1.51 | 0.15 | 0.510 | 1.26 | LSG391M2W--A4040 |

Dimension & Permissible Ripple Current

| Working Voltage V. DC | Capacitance 120Hz, 20°C μF | φ D×L mm | Ripple Current 120 Hz, 105°C A/rms | Tan δ at 120Hz, 20°C | ESR 120Hz, 20°C Ω | LC 5 minutes mA | Part Number |
|--------------------------|----------------------------------|-------------|--|-------------------------|-------------------------|-----------------------|------------------|
| 450 | 470 | 30 × 55 | 1.79 | 0.15 | 0.423 | 1.38 | LSG471M2W--A3055 |
| | 470 | 35 × 40 | 1.71 | 0.15 | 0.423 | 1.38 | LSG471M2W--A3540 |
| | 470 | 40 × 35 | 1.75 | 0.15 | 0.423 | 1.38 | LSG471M2W--A4035 |
| | 560 | 35 × 45 | 1.96 | 0.15 | 0.355 | 1.50 | LSG561M2W--A3545 |
| | 560 | 40 × 40 | 2.02 | 0.15 | 0.355 | 1.50 | LSG561M2W--A4040 |
| | 680 | 35 × 55 | 2.35 | 0.15 | 0.293 | 1.50 | LSG681M2W--A3555 |
| | 680 | 40 × 45 | 2.33 | 0.15 | 0.293 | 1.50 | LSG681M2W--A4045 |
| | 820 | 40 × 50 | 2.68 | 0.15 | 0.243 | 1.50 | LSG821M2W--A4050 |
| | 1,000 | 40 × 60 | 3.03 | 0.15 | 0.199 | 1.50 | LSG102M2W--A4060 |
| | 1,200 | 35 × 90 | 3.68 | 0.15 | 0.166 | 1.50 | LSG122M2W--A3590 |
| 500 | 1,200 | 40 × 70 | 3.54 | 0.15 | 0.166 | 1.50 | LSG122M2W--A4070 |
| | 1,500 | 45 × 80 | 4.49 | 0.15 | 0.133 | 1.50 | LSG152M2W--A4580 |
| | 82 | 22 × 30 | 0.75 | 0.15 | 2.427 | 0.61 | LSG820M2H--A2230 |
| | 82 | 25 × 30 | 0.81 | 0.15 | 2.427 | 0.61 | LSG820M2H--A2530 |
| | 100 | 22 × 40 | 0.94 | 0.15 | 1.990 | 0.67 | LSG101M2H--A2240 |
| | 100 | 25 × 40 | 1.00 | 0.15 | 1.990 | 0.67 | LSG101M2H--A2540 |
| | 120 | 22 × 50 | 1.14 | 0.15 | 1.659 | 0.73 | LSG121M2H--A2250 |
| | 120 | 25 × 50 | 1.22 | 0.15 | 1.659 | 0.73 | LSG121M2H--A2550 |
| | 150 | 22 × 50 | 1.27 | 0.15 | 1.327 | 0.82 | LSG151M2H--A2250 |
| | 150 | 25 × 55 | 1.42 | 0.15 | 1.327 | 0.82 | LSG151M2H--A2555 |
| | 180 | 30 × 35 | 1.42 | 0.15 | 1.106 | 0.90 | LSG181M2H--A3035 |
| | 220 | 30 × 35 | 1.57 | 0.15 | 0.905 | 0.99 | LSG221M2H--A3035 |
| | 220 | 35 × 40 | 1.74 | 0.15 | 0.905 | 0.99 | LSG221M2H--A3540 |
| | 270 | 35 × 45 | 2.02 | 0.15 | 0.737 | 1.10 | LSG271M2H--A3545 |
| | 330 | 35 × 50 | 2.45 | 0.15 | 0.603 | 1.22 | LSG331M2H--A3550 |
| | 470 | 35 × 60 | 2.62 | 0.15 | 0.423 | 1.45 | LSG471M2H--A3560 |
| | 680 | 35 × 70 | 3.38 | 0.15 | 0.293 | 1.50 | LSG681M2H--A3570 |
| | 820 | 40 × 70 | 4.00 | 0.15 | 0.243 | 1.50 | LSG821M2H--A4070 |
| 1,000 | 40 × 80 | 4.68 | 0.15 | 0.199 | 1.50 | LSG102M2H--A4080 | |

Part Numbering System

| LSG series | 100μF | ±20% | 400V | | 4.0±0.5mm | 22 φ × 30L | Pb-free Terminal + PET Sleeve | | | | | | | | | | | | | | | | | | | | | | | | | | | | | | | | | | | | | | |
|--|-------------|-----------------------|---------------|---------------|-----------------|-------------|----------------------------------|-----|---|----|--------|-----|----|-----|----|---|------|--------|--------|----|--------|----|---|-------|------|-------|------|-------|------|-------|------|---|------|--------|---|------|---|------|---|-----------------|--------|------------|---|--|--|
| LSG | 101 | M | 2G | -- | A | 2230 | | | | | | | | | | | | | | | | | | | | | | | | | | | | | | | | | | | | | | | |
| Series name | Capacitance | Capacitance tolerance | Rated voltage | Terminal type | Terminal length | Case size | Terminal and Sleeve Type | | | | | | | | | | | | | | | | | | | | | | | | | | | | | | | | | | | | | | |
| Example: | Example: | Example: | Example: | Example: | Example: | Example: | | | | | | | | | | | | | | | | | | | | | | | | | | | | | | | | | | | | | | | |
| <table border="1"> <tr><th>Cap.</th><th>Symbol</th></tr> <tr><td>56</td><td>560</td></tr> <tr><td>220</td><td>221</td></tr> <tr><td>470</td><td>471</td></tr> </table> | Cap. | Symbol | 56 | 560 | 220 | 221 | 470 | 471 | <table border="1"> <tr><th>WV</th><th>Symbol</th></tr> <tr><td>400</td><td>2G</td></tr> <tr><td>450</td><td>2W</td></tr> </table> | WV | Symbol | 400 | 2G | 450 | 2W | <table border="1"> <tr><th>Type</th><th>Symbol</th></tr> <tr><td>2 pins</td><td>--</td></tr> <tr><td>5 pins</td><td>L5</td></tr> </table> | Type | Symbol | 2 pins | -- | 5 pins | L5 | <table border="1"> <tr><th>φ D×L</th><th>Code</th></tr> <tr><td>22×30</td><td>2230</td></tr> <tr><td>25×25</td><td>2525</td></tr> <tr><td>30×40</td><td>3040</td></tr> </table> | φ D×L | Code | 22×30 | 2230 | 25×25 | 2525 | 30×40 | 3040 | <table border="1"> <tr><th>Cap.</th><th>Symbol</th></tr> <tr><td>M</td><td>±20%</td></tr> <tr><td>K</td><td>±10%</td></tr> </table> | Cap. | Symbol | M | ±20% | K | ±10% | <table border="1"> <tr><th>Terminal length</th><th>Symbol</th></tr> <tr><td>6.3±1.0 mm</td><td>A</td></tr> </table> | Terminal length | Symbol | 6.3±1.0 mm | A | | |
| Cap. | Symbol | | | | | | | | | | | | | | | | | | | | | | | | | | | | | | | | | | | | | | | | | | | | |
| 56 | 560 | | | | | | | | | | | | | | | | | | | | | | | | | | | | | | | | | | | | | | | | | | | | |
| 220 | 221 | | | | | | | | | | | | | | | | | | | | | | | | | | | | | | | | | | | | | | | | | | | | |
| 470 | 471 | | | | | | | | | | | | | | | | | | | | | | | | | | | | | | | | | | | | | | | | | | | | |
| WV | Symbol | | | | | | | | | | | | | | | | | | | | | | | | | | | | | | | | | | | | | | | | | | | | |
| 400 | 2G | | | | | | | | | | | | | | | | | | | | | | | | | | | | | | | | | | | | | | | | | | | | |
| 450 | 2W | | | | | | | | | | | | | | | | | | | | | | | | | | | | | | | | | | | | | | | | | | | | |
| Type | Symbol | | | | | | | | | | | | | | | | | | | | | | | | | | | | | | | | | | | | | | | | | | | | |
| 2 pins | -- | | | | | | | | | | | | | | | | | | | | | | | | | | | | | | | | | | | | | | | | | | | | |
| 5 pins | L5 | | | | | | | | | | | | | | | | | | | | | | | | | | | | | | | | | | | | | | | | | | | | |
| φ D×L | Code | | | | | | | | | | | | | | | | | | | | | | | | | | | | | | | | | | | | | | | | | | | | |
| 22×30 | 2230 | | | | | | | | | | | | | | | | | | | | | | | | | | | | | | | | | | | | | | | | | | | | |
| 25×25 | 2525 | | | | | | | | | | | | | | | | | | | | | | | | | | | | | | | | | | | | | | | | | | | | |
| 30×40 | 3040 | | | | | | | | | | | | | | | | | | | | | | | | | | | | | | | | | | | | | | | | | | | | |
| Cap. | Symbol | | | | | | | | | | | | | | | | | | | | | | | | | | | | | | | | | | | | | | | | | | | | |
| M | ±20% | | | | | | | | | | | | | | | | | | | | | | | | | | | | | | | | | | | | | | | | | | | | |
| K | ±10% | | | | | | | | | | | | | | | | | | | | | | | | | | | | | | | | | | | | | | | | | | | | |
| Terminal length | Symbol | | | | | | | | | | | | | | | | | | | | | | | | | | | | | | | | | | | | | | | | | | | | |
| 6.3±1.0 mm | A | | | | | | | | | | | | | | | | | | | | | | | | | | | | | | | | | | | | | | | | | | | | |

Note: For more details, please refer to "Part Numbering System (Snap-in Type)" on page 13.

Typical Endurance Curves

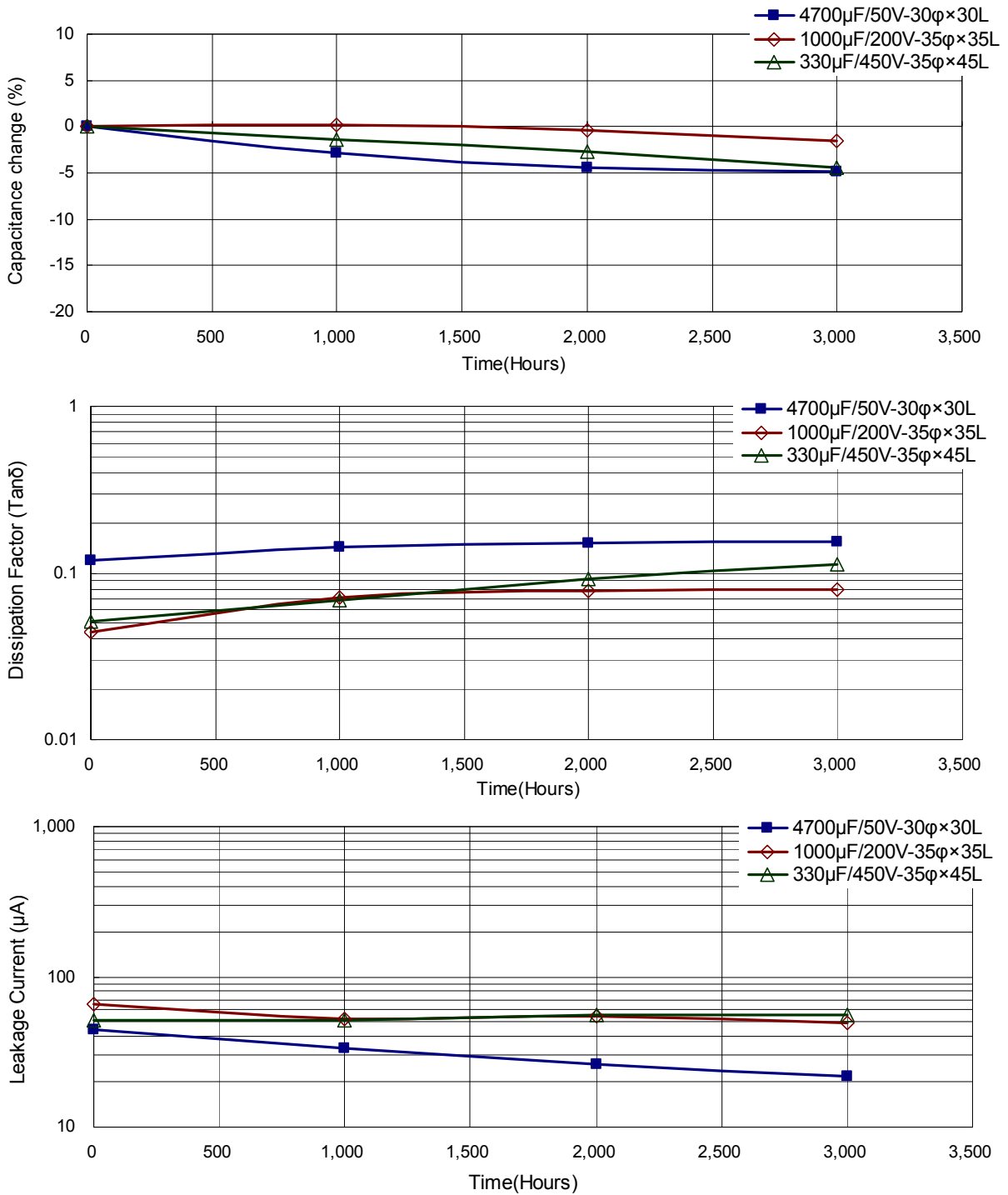

Useful Life Chart

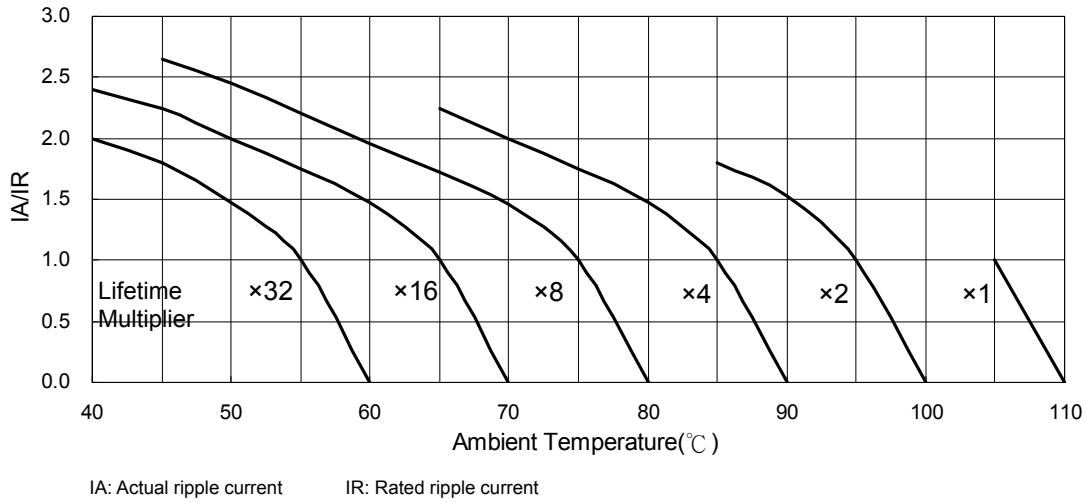

ESR-Frequency Characteristics

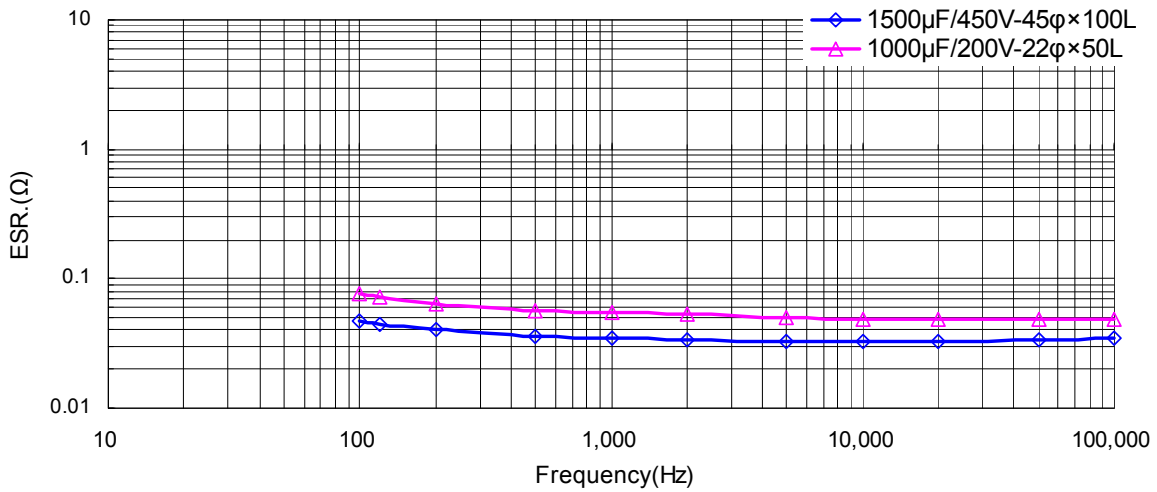

ESR-Temperature Characteristics

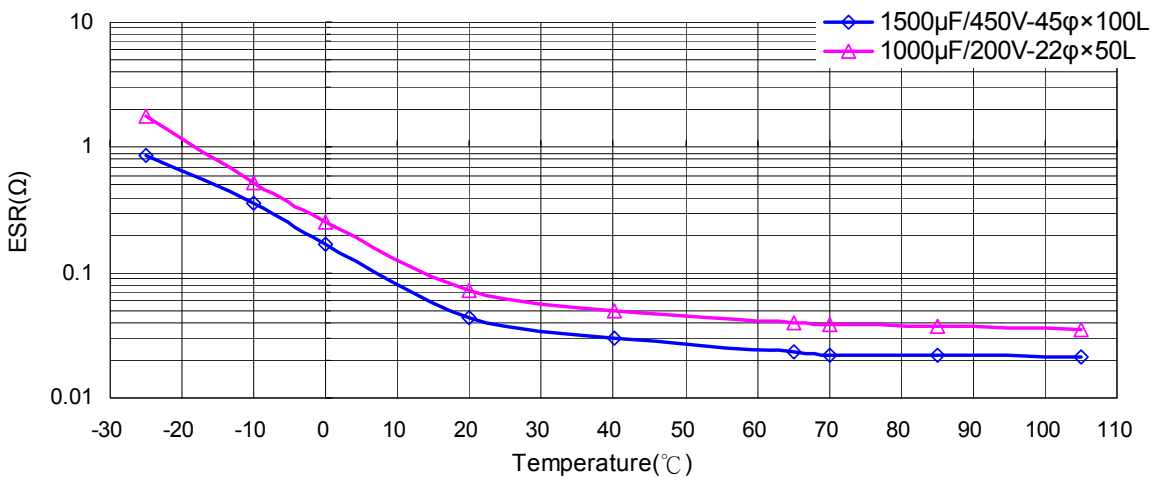



Компания «ЭлектроПласт» предлагает заключение долгосрочных отношений при поставках импортных электронных компонентов на взаимовыгодных условиях!

Наши преимущества:

- Оперативные поставки широкого спектра электронных компонентов отечественного и импортного производства напрямую от производителей и с крупнейших мировых складов;
- Поставка более 17-ти миллионов наименований электронных компонентов;
- Поставка сложных, дефицитных, либо снятых с производства позиций;
- Оперативные сроки поставки под заказ (от 5 рабочих дней);
- Экспресс доставка в любую точку России;
- Техническая поддержка проекта, помощь в подборе аналогов, поставка прототипов;
- Система менеджмента качества сертифицирована по Международному стандарту ISO 9001;
- Лицензия ФСБ на осуществление работ с использованием сведений, составляющих государственную тайну;
- Поставка специализированных компонентов (Xilinx, Altera, Analog Devices, Intersil, Interpoint, Microsemi, Aeroflex, Peregrine, Syfer, Eurofarad, Texas Instrument, Miteq, Cobham, E2V, MA-COM, Hittite, Mini-Circuits, General Dynamics и др.);

Помимо этого, одним из направлений компании «ЭлектроПласт» является направление «Источники питания». Мы предлагаем Вам помощь Конструкторского отдела:

- Подбор оптимального решения, техническое обоснование при выборе компонента;
- Подбор аналогов;
- Консультации по применению компонента;
- Поставка образцов и прототипов;
- Техническая поддержка проекта;
- Защита от снятия компонента с производства.



Как с нами связаться

Телефон: 8 (812) 309 58 32 (многоканальный)

Факс: 8 (812) 320-02-42

Электронная почта: org@eplast1.ru

Адрес: 198099, г. Санкт-Петербург, ул. Калинина, дом 2, корпус 4, литера А.