

| NO. CKTS | DIM. A | DIM. B |
|----------|----------------|----------------|
| 2 | 5.08 2.00 | 2.54 1.00 |
| 3 | 7.62 3.00 | 5.08 2.00 |
| 4 | 10.16 4.00 | 7.62 3.00 |
| 5 | 12.70 5.00 | 10.16 4.00 |
| 6 | 15.24 6.00 | 12.70 5.00 |
| 7 | 17.78 7.00 | 15.24 6.00 |
| 8 | 20.32 8.00 | 17.78 7.00 |
| 9 | 22.86 9.00 | 20.32 8.00 |
| 10 | 25.40 1.000 | 22.86 9.00 |
| 11 | 27.94 1.100 | 25.40 1.000 |
| 12 | 30.48 1.200 | 27.94 1.100 |
| 13 | 33.02 1.300 | 30.48 1.200 |
| 14 | 35.56 1.400 | 33.02 1.300 |
| 15 | 38.10 1.500 | 35.56 1.400 |
| 16 | 40.64 1.600 | 38.10 1.500 |
| 17 | 43.18 1.700 | 40.64 1.600 |
| 18 | 45.72 1.800 | 43.18 1.700 |
| 19 | 48.26 1.900 | 45.72 1.800 |
| 20 | 50.80 2.000 | 48.26 1.900 |
| 21 | 53.34 2.100 | 50.80 2.000 |
| 22 | 55.88 2.200 | 53.34 2.100 |
| 23 | 58.42 2.300 | 55.88 2.200 |
| 24 | 60.96 2.400 | 58.42 2.300 |
| 25 | 63.50 2.500 | 60.96 2.400 |
| 26 | 66.04 2.600 | 63.50 2.500 |
| 27 | 68.58 2.700 | 66.04 2.600 |
| 28 | 71.12 2.800 | 68.58 2.700 |
| 29 | 73.66 2.900 | 71.12 2.800 |
| 30 | 76.20 3.000 | 73.66 2.900 |
| 31 | 78.74 3.100 | 76.20 3.000 |
| 32 | 81.28 3.200 | 78.74 3.100 |
| 33 | 83.82 3.300 | 81.28 3.200 |
| 34 | 86.36 3.400 | 83.82 3.300 |
| 35 | 88.90 3.500 | 86.36 3.400 |
| 36 | 91.44 3.600 | 88.90 3.500 |

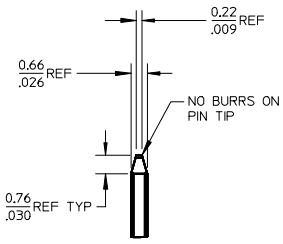

DETAIL X
SCALE 5:1
SEE NOTE 10

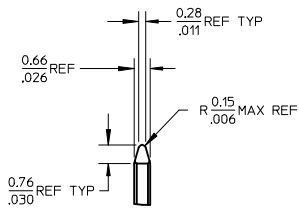

DETAIL Y
SCALE 5:1
SEE NOTE 10

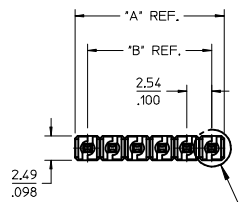

SEE DETAIL Z

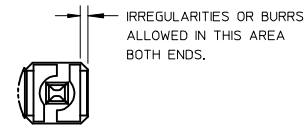

DETAIL Z
SCALE 5:1

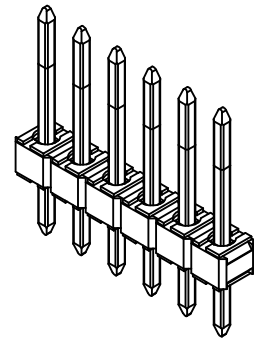

CENTERLINE OF PIN IN AREA SHOWN NOT TO VARY FROM
1.3 CENTERLINE OF PIN AT DATUM -D- BY MORE THAN
.05 (FOR DIM. X OF 12.70/500 OR LESS) 0.20/.008 IN ANY DIRECTION.
(FOR DIM. X OF 12.73/501 OR MORE) 0.30/.012 IN ANY DIRECTION

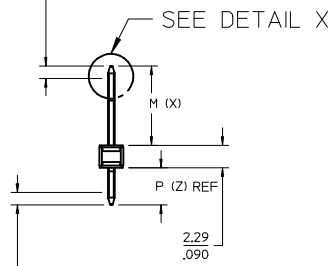

CENTERLINE OF PIN IN AREA SHOWN NOT TO VARY FROM
CENTERLINE OF PIN AT DATUM -E- BY MORE THAN
0.13/.005 IN ANY DIRECTION.

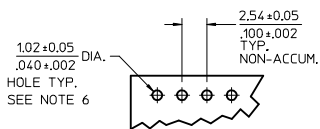

TYP. HOLE PATTERN
FOR 1.57/.062 THK. PCB

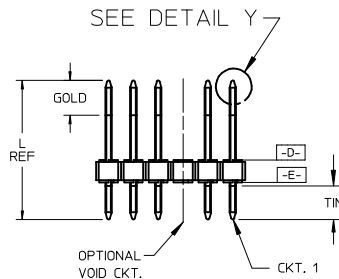

OPTIONAL KINK PIN
SEE NOTE 6

NOTES:

- MATERIAL: GLASS FILLED NYLON, UL94V-0, COLOR: BLACK
- FINISH:
 - (154) OVERALL TIN: 0.00254/.000100 MIN. OVER NICKEL: 0.00127/.000050 MIN.
 - (208) SELECT GOLD: 0.00038/.000015 MIN. SELECT TIN: 0.00254/.000100 MIN. WITH OVERALL NICKEL UNDERPLATE: 0.00127/.000050 MIN.
 - (228) SELECT GOLD: 0.00076/.000030 MIN. SELECT TIN: 0.00254/.000100 MIN. WITH OVERALL NICKEL UNDERPLATE: 0.00127/.000050 MIN.
- PRODUCT SPECIFICATION: PS 10-07.
- PACKAGING INFORMATION: SEE TABLES
- SOLDERABILITY PER SMES-152.
- KINK PIN OPTION NOT RECOMMENDED FOR 2 CIRCUIT PARTS. HOLE SIZE MAY NEED TO BE ADJUSTED FOR 2 CIRCUIT PARTS WITH KINK OPTION FOR PROPER INSERTION INTO THE PCB. SEE SMES-42003 FOR ADDITIONAL INFORMATION ON KINK PIN DIRECTION AND PLACEMENT.
- HEADERS ARE NOT STACKABLE ON 2.54/.100 CENTERS.
- PIN PUSH OUT FORCE: 3 LBS. MIN
- THIS PART CONFORMS TO CLASS B REQUIREMENTS OF COSMETIC SPECIFICATION PS-45499-002.
- PIN TIP DIMENSIONS ARE SHOWN FOR REFERENCE ONLY. DIMENSIONS APPLY PRIOR TO PLATING OR ASSEMBLY.

| | |
|-------|-----|
| 2-w | A13 |
| 1 | A16 |
| SHEET | REV |

| | | | | | | |
|---|---|--|--------------------------------------|---------------------|---|------------------------|
| REVISE NOTE 6 EC NO: UCP2013-1030 DRWN:MMSTROH 2012/09/12 CHKD:KKIPPER 2012/09/14 APPR:FSMITH 2012/10/09 | QUALITY SYMBOLS $\nabla=0$ $\nabla=0$ $\nabla=0$ | GENERAL TOLERANCES (UNLESS SPECIFIED) mm INCH 4 PLACES ± --- ± --- 3 PLACES ± --- ± .010 2 PLACES ± 0.25 ± .015 1 PLACE ± 0.38 ± --- 0 PLACE ± ± | DIMENSION STYLE MM/IN | SCALE 2:1 | DESIGN UNITS INCH | THIRD ANGLE PROJECTION |
| | DRAWN BY DATE SCHAFFER 11/3/03 | | CHECKED BY DATE SAMIEC 2004/02/27 | | TITLE KK 100 HEADER ASSY FLAT VERTICAL BREAKAWAY, LEAD-FREE | |
| | APPROVED BY DATE MARGULIS 2004/02/27 | | MATERIAL NO. SEE CHART | | DOCUMENT NO. SD-42375-002 | |
| | DRAFT WHERE APPLICABLE MUST REMAIN WITHIN DIMENSIONS | | SIZE B | | SHEET NO. 1 OF * | |

ENG. NO: A-42375-0002 / 0036

| | |
|-------------------|-----------------|
| HEADER NUMBER: | 42312-0036 |
| PIN NUMBER: | 42663-ABA154 |
| PIN LENGTH: L | .455 / 11.56 |
| MATING LENGTH: M | .240 / 6.09 |
| GOLD POINT: G | N/A |
| PC TAIL LENGTH: P | .125 / 3.18 |
| TIN: T | OVERALL |
| CKTS: | 2-36 |
| KINKS: | NO |
| VOIDED CKTS: | NONE |
| PACKAGING: | BULK 40873-0041 |

| CKTS | MATERIAL NUMBER | ENG NUMBER | CKTS | MATERIAL NUMBER | ENG NUMBER |
|------|-----------------|--------------|------|-----------------|------------|
| 02 | 50-29-1759 | A-42375-0002 | | | |
| 03 | 50-29-1751 | A-42375-0003 | | | |
| 05 | 42375-0005 | A-42375-0005 | | | |
| 06 | 50-29-1628 | A-42375-0006 | | | |
| 08 | 50-29-1893 | A-42375-0008 | | | |
| 09 | 50-29-1760 | A-42375-0009 | | | |
| 12 | 50-29-1894 | A-42375-0012 | | | |

ENG. NO: A-423275-0037 / 0071

| | |
|-------------------|-----------------|
| HEADER NUMBER: | 42312-0036 |
| PIN NUMBER: | 42663-ABB208 |
| PIN LENGTH: L | .455 / 11.56 |
| MATING LENGTH: M | .240 / 6.09 |
| GOLD POINT: G | .100 / 2.54 |
| PC TAIL LENGTH: P | .125 / 3.18 |
| TIN: T | .100 / 3.18 |
| CKTS: | 2-36 |
| KINKS: | NO |
| VOIDED CKTS: | NONE |
| PACKAGING: | BULK 40873-0041 |

| CKTS | MATERIAL NUMBER | ENG NUMBER | CKTS | MATERIAL NUMBER | ENG NUMBER |
|------|-----------------|--------------|------|-----------------|------------|
| 02 | 50-29-1692 | A-42375-0037 | | | |
| 04 | 50-29-1671 | A-42375-0039 | | | |
| 06 | 50-29-1892 | A-42375-0041 | | | |
| 08 | 42375-0043 | A-42375-0043 | | | |
| 10 | 50-29-1899 | A-42375-0045 | | | |

| | | | |
|--|--|---|-------------------------------|
| REV: A13 | ECR/ECN INFORMATION: EC No.: UCP2007-3196 DATE: 7/18/2007 | TITLE: KK 100 HEADER ASSY FLAT VERTICAL BREAKAWAY, LEAD-FREE | SHEET No. - 2 - |
| DOCUMENT NUMBER: SD- 42375-002 | CREATED / REVISED BY: ADERR | CHECKED BY: LSCHMIDT | APPROVED BY: FSMITH |

ENG. NO: A-42375-0072-0106

| | |
|-------------------|-----------------|
| HEADER NUMBER: | 42312-0036 |
| PIN NUMBER: | 42663-ABB228 |
| PIN LENGTH: L | .455 / 11.56 |
| MATING LENGTH: M | .240 / 6.09 |
| GOLD POINT: G | .100 / 2.54 |
| PC TAIL LENGTH: P | .125 / 3.18 |
| TIN: T | .100 / 2.54 |
| CKTS: | 2-36 |
| KINKS: | NO |
| VOIDED CKTS: | NONE |
| PACKAGING: | BULK 40873-0041 |

| CKTS | MATERIAL NUMBER | ENG NUMBER | CKTS | MATERIAL NUMBER | ENG NUMBER |
|------|-----------------|--------------|------|-----------------|------------|
| 03 | 50-29-1891 | A-42375-0073 | | | |
| | | | | | |
| | | | | | |
| | | | | | |
| 08 | 50-29-1620 | A-42375-0078 | | | |
| | | | | | |
| | | | | | |
| | | | | | |
| | | | | | |
| | | | | | |
| | | | | | |
| | | | | | |
| | | | | | |
| | | | | | |
| | | | | | |
| | | | | | |
| | | | | | |
| | | | | | |
| | | | | | |

ENG. NO: A-42375-0142 / 0176

| | |
|-------------------|-----------------|
| HEADER NUMBER: | 42312-0036 |
| PIN NUMBER: | 42663-ATB208 |
| PIN LENGTH: L | .530 / 13.46 |
| MATING LENGTH: M | .320 / 8.13 |
| GOLD POINT: G | .140 / 3.56 |
| PC TAIL LENGTH: P | .120 / 3.05 |
| TIN: T | .135 / 3.43 |
| CKTS: | 2-36 |
| KINKS: | NO |
| VOIDED CKTS: | NONE |
| PACKAGING: | BULK 40873-0041 |

| CKTS | MATERIAL NUMBER | ENG NUMBER | CKTS | MATERIAL NUMBER | ENG NUMBER |
|------|-----------------|--------------|------|-----------------|------------|
| 02 | 50-29-1882 | A-42375-0142 | | | |
| 03 | 50-29-1890 | A-42375-0143 | | | |
| 04 | 50-29-1748 | A-42375-0144 | | | |
| 05 | 42375-0145 | A-42375-0145 | | | |
| 06 | 50-29-1619 | A-42375-0146 | | | |
| | | | | | |
| 08 | 50-29-1621 | A-42375-0148 | | | |
| 09 | 42375-0149 | A-42375-0149 | | | |
| | | | | | |
| | | | | | |
| | | | | | |
| | | | | | |
| | | | | | |
| | | | | | |
| | | | | | |
| | | | | | |
| | | | | | |
| | | | | | |

| | | | |
|---|--|---|---------------------------------------|
| REV: A13 | <u>ECR/ECN INFORMATION:</u> EC No.: UCP2007-3196 DATE: 7/18/2007 | <u>TITLE:</u> KK 100 HEADER ASSY FLAT VERTICAL BREAKAWAY, LEAD-FREE | <u>SHEET No.</u> - 3 - |
| <u>DOCUMENT NUMBER:</u> SD- 42375-002 | | <u>CREATED / REVISED BY:</u> ADERR | <u>CHECKED BY:</u> LSCHMIDT |
| | | <u>APPROVED BY:</u> FSMITH | |

ENG. NO: A-42375-0352/0386

| | | | | | |
|-------------------|-----------------|--------------|------|-----------------|------------|
| HEADER NUMBER: | 42312-0036 | | | | |
| PIN NUMBER: | 42663-ADB208 | | | | |
| PIN LENGTH: L | .465 / 11.81 | | | | |
| MATING LENGTH: M | .240 / 6.09 | | | | |
| GOLD POINT: G | .100 / 2.54 | | | | |
| PC TAIL LENGTH: P | .135 / 3.43 | | | | |
| TIN: T | .100 / 2.54 | | | | |
| CKTS: | 2-36 | | | | |
| KINKS: | SMES-42003 | | | | |
| VOIDED CKTS: | NONE | | | | |
| PACKAGING: | BULK 40873-0041 | | | | |
| CKTS | MATERIAL NUMBER | ENG NUMBER | CKTS | MATERIAL NUMBER | ENG NUMBER |
| 02 | 50-29-1883 | A-42375-0352 | | | |
| 03 | 50-29-1884 | A-42375-0353 | | | |
| 06 | 42375-0356 | A-42375-0356 | | | |

ENG. NO: 42375-1514/1548

| | | | | | |
|-------------------|-----------------|------------|------|-----------------|------------|
| HEADER NUMBER: | 42312-0036 | | | | |
| PIN NUMBER: | 42663-ABB208 | | | | |
| PIN LENGTH: L | .455 / 11.56 | | | | |
| MATING LENGTH: M | .230 / 5.84 | | | | |
| GOLD POINT: G | .140 / 3.56 | | | | |
| PC TAIL LENGTH: P | .135 / 3.43 | | | | |
| TIN: T | .100 / 2.54 | | | | |
| CKTS: | 3-36 | | | | |
| KINKS: | SMES-42003 | | | | |
| VOIDED CKTS: | 2 | | | | |
| PACKAGING: | BULK 40873-0041 | | | | |
| CKTS | MATERIAL NUMBER | ENG NUMBER | CKTS | MATERIAL NUMBER | ENG NUMBER |
| 05 | 50-29-2005 | 42375-1517 | | | |

| | | | | |
|------------------------|---|--|--------------------------------|-------------------------------|
| REV: A13 | ECR/ECN INFORMATION: EC No.: UCP2007-3196 DATE: 7/18/2007 | TITLE: KK 100 HEADER ASSY FLAT VERTICAL BREAKAWAY, LEAD-FREE | SHEET No. - 4 - | |
| | DOCUMENT NUMBER: SD- 42375-002 | CREATED / REVISED BY: ADERR | CHECKED BY: LSCHMIDT | APPROVED BY: FSMITH |

ENG. NO: A-42375-0457/0491

| | |
|-------------------|-----------------|
| HEADER NUMBER: | 42312-0036 |
| PIN NUMBER: | 42663-AYB208 |
| PIN LENGTH: L | .545 / 13.84 |
| MATING LENGTH: M | .320 / 8.13 |
| GOLD POINT: G | .140 / 3.56 |
| PC TAIL LENGTH: P | .135 / 3.43 |
| TIN: T | .135 / 3.43 |
| CKTS: | 2-36 |
| KINKS: | SMES-42003 |
| VOIDED CKTS: | NONE |
| PACKAGING: | BULK 40873-0041 |

| CKTS | MATERIAL NUMBER | ENG NUMBER | CKTS | MATERIAL NUMBER | ENG NUMBER |
|------|-----------------|--------------|------|-----------------|------------|
| | | | | | |
| | | | | | |
| | | | | | |
| | | | | | |
| | | | | | |
| 09 | 50-29-1737 | A-42375-0464 | | | |
| | | | | | |
| | | | | | |
| | | | | | |
| | | | | | |
| | | | | | |
| | | | | | |
| | | | | | |
| | | | | | |
| | | | | | |
| | | | | | |
| | | | | | |
| | | | | | |
| | | | | | |
| | | | | | |
| | | | | | |

ENG. NO: 42375-3659 / 3693

| | |
|-------------------|-----------------|
| HEADER NUMBER: | 42312-0036 |
| PIN NUMBER: | 42663-AXB208 |
| PIN LENGTH: L | .540 / 13.72 |
| MATING LENGTH: M | .250 / 6.35 |
| GOLD POINT: G | .140 / 3.56 |
| PC TAIL LENGTH: P | .200 / 5.08 |
| TIN: T | .135 / 3.43 |
| CKTS: | 2-36 |
| KINKS: | NO |
| VOIDED CKTS: | NONE |
| PACKAGING: | BULK 40873-0041 |

| CKTS | MATERIAL NUMBER | ENG NUMBER | CKTS | MATERIAL NUMBER | ENG NUMBER |
|------|-----------------|------------|------|-----------------|------------|
| | | | | | |
| | | | | | |
| | | | | | |
| 05 | 68300-5006 | 42375-3662 | | | |
| | | | | | |
| | | | | | |
| | | | | | |
| | | | | | |
| | | | | | |
| | | | | | |
| | | | | | |
| | | | | | |
| | | | | | |
| | | | | | |
| | | | | | |
| | | | | | |
| | | | | | |
| | | | | | |
| | | | | | |
| | | | | | |

| | | | |
|---|--|---|--------------------------------------|
| REV: A13 | ECR/ECN INFORMATION: EC No.: UCP2007-3196 DATE: 7/18/2007 | TITLE: KK 100 HEADER ASSY FLAT VERTICAL BREAKAWAY, LEAD-FREE | SHEET No. - 5 - |
| DOCUMENT NUMBER: SD- 42375-002 | CREATED / REVISED BY: ADERR | CHECKED BY: LSCHMIDT | APPROVED BY: FSMITH |

ENG. NO: A-42375-0107/0141

| | |
|-------------------|-----------------|
| HEADER NUMBER: | 42312-0036 |
| PIN NUMBER: | 42663-ATA154 |
| PIN LENGTH: L | .530 / 13.46 |
| MATING LENGTH: M | .320 / 8.13 |
| GOLD POINT: G | N/A |
| PC TAIL LENGTH: P | .120 / 3.05 |
| TIN: T | OVERALL |
| CKTS: | 2-36 |
| KINKS: | NO |
| VOIDED CKTS: | NONE |
| PACKAGING: | BULK 40873-0041 |

| CKTS | MATERIAL NUMBER | ENG NUMBER | CKTS | MATERIAL NUMBER | ENG NUMBER |
|------|-----------------|--------------|------|-----------------|------------|
| 02 | 42375-0107 | 42375-0107 | | | |
| 03 | 42375-0108 | 42375-0108 | | | |
| | | | | | |
| | | | | | |
| 06 | 42375-0111 | 42375-0111 | | | |
| | | | | | |
| | | | | | |
| | | | | | |
| | | | | | |
| 12 | 50-29-1761 | A-42375-0117 | | | |
| | | | | | |
| | | | | | |
| | | | | | |
| | | | | | |
| | | | | | |
| | | | | | |
| | | | | | |
| | | | | | |

| | | | |
|---|--|---|---------------------------------------|
| REV: A13 | ECR/ECN INFORMATION: EC No.: UCP2007-3196 DATE: 7/18/2007 | <u>TITLE:</u> KK 100 HEADER ASSY FLAT VERTICAL BREAKAWAY, LEAD-FREE | <u>SHEET No.</u> - 6 - |
| <u>DOCUMENT NUMBER:</u> SD- 42375-002 | | <u>CREATED / REVISED BY:</u> ADERR | <u>CHECKED BY:</u> LSCHMIDT |
| | | <u>APPROVED BY:</u> FSMITH | |



Компания «ЭлектроПласт» предлагает заключение долгосрочных отношений при поставках импортных электронных компонентов на взаимовыгодных условиях!

Наши преимущества:

- Оперативные поставки широкого спектра электронных компонентов отечественного и импортного производства напрямую от производителей и с крупнейших мировых складов;
- Поставка более 17-ти миллионов наименований электронных компонентов;
- Поставка сложных, дефицитных, либо снятых с производства позиций;
- Оперативные сроки поставки под заказ (от 5 рабочих дней);
- Экспресс доставка в любую точку России;
- Техническая поддержка проекта, помощь в подборе аналогов, поставка прототипов;
- Система менеджмента качества сертифицирована по Международному стандарту ISO 9001;
- Лицензия ФСБ на осуществление работ с использованием сведений, составляющих государственную тайну;
- Поставка специализированных компонентов (Xilinx, Altera, Analog Devices, Intersil, Interpoint, Microsemi, Aeroflex, Peregrine, Syfer, Eurofarad, Texas Instrument, Miteq, Cobham, E2V, MA-COM, Hittite, Mini-Circuits, General Dynamics и др.);

Помимо этого, одним из направлений компании «ЭлектроПласт» является направление «Источники питания». Мы предлагаем Вам помощь Конструкторского отдела:

- Подбор оптимального решения, техническое обоснование при выборе компонента;
- Подбор аналогов;
- Консультации по применению компонента;
- Поставка образцов и прототипов;
- Техническая поддержка проекта;
- Защита от снятия компонента с производства.



Как с нами связаться

Телефон: 8 (812) 309 58 32 (многоканальный)

Факс: 8 (812) 320-02-42

Электронная почта: org@eplast1.ru

Адрес: 198099, г. Санкт-Петербург, ул. Калинина, дом 2, корпус 4, литера А.