

THIS DRAWING IS UNPUBLISHED. RELEASED FOR PUBLICATION
 © COPYRIGHT 2006 BY TYCO ELECTRONICS CORPORATION. ALL RIGHTS RESERVED.

| | | | | | | | |
|-----|------|-----------|-----|---------------------------|------|-----|------|
| LOC | DIST | REVISIONS | | | | | |
| GP | 00 | P | LTR | DESCRIPTION | DATE | DWN | APVD |
| | | | B | REVISED PER ECO-06-030075 | DO | GIP | DO |

8. ITEMS PROVIDED TO THIS SPECIFICATION TO BE PERMANENTLY IDENTIFIED PER THE FOLLOWING IDENTIFIER:

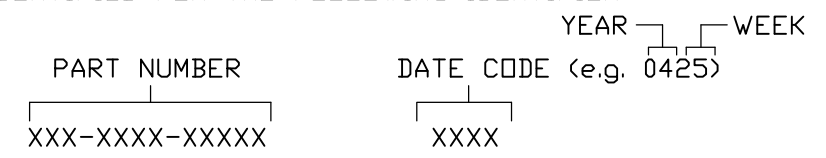

7. RECOMMENDED PRESSING TOOL:
 FIX00058 FOR PART NUMBER 285-0112-01300.
 CONTACT ELCON FOR TOOLING QUOTE OR TO ORDER.

- 6. EXAMPLE PCB CONFIGURATION.
- 5. THIS 2X2 SEGMENT POWER AND SIGNAL CONFIGURATION SHOWN IS FOR REFERENCE ONLY. COMBINATION OF MULTIPLE NUMBERS OF 2 AND 3 SEGMENT MODULES COULD BE USED PER USER PREFERENCE. OVERALL COMBINATION SHOULD NOT EXCEED 8.0" IN LENGTH.
- 4. SOCKETS ACCEPT 1.6 [.062] ±10% THICK PC BOARD.

3. FINISHES:
 CONTACTS: SELECTIVE GOLD .000030" MIN THK OVER NICKEL .000040" MIN THK.
 TERMINALS: TIN PLATE, MATTE FINISH, .000100" MINIMUM THICKNESS

2. MATERIALS:
 INSULATORS: THERMOPLASTIC, GLASS REINFORCED, COLOR-BLACK, UL94V-0 FLAMMABILITY RATED.
 CONTACTS: PHOSPHOR BRONZE ALLOY

1. PART NUMBER CHANGES AND OR DESIGN CHANGES AFFECTING ITEM INTERCHANGEABILITY REQUIRE PRIOR ELCON APPROVAL AND AUTHORIZATION BY REVISION TO THIS DRAWING.

NOTES: UNLESS OTHERWISE SPECIFIED;

9. PART NUMBER INFORMATION

| CONNECTOR | TYCO PART NUMBER | TERMINATION TYPE | PC TAIL LENGTH DIM "A" | RECOMMENDED MOUNTING BOARD | MATING BOARD |
|-----------|------------------|------------------------|----------------------------|----------------------------|------------------|
| SOCKET | 6643460-1 | SOLDER TAIL (SHORT) | 3.56 [.140] 2.54 [.100] | 1.6 [.062] THICK | 1.6 [.062] THICK |
| SOCKET | 6643460-2 | SOLDER TAIL (STANDARD) | 5.08 [.200] 4.06 [.160] | 3.2 [.125] OR THINNER | 1.6 [.062] THICK |
| SOCKET | 6643460-3 | COMPLIANT TAIL | 5.08 [.200] 4.06 [.160] | 2.3 [.093] OR THICKER | 1.6 [.062] THICK |

| | | | | | |
|---|--|-----------------------------------|---|--------------------|-------------------------|
| THIS DRAWING IS A CONTROLLED DOCUMENT. | | DWN G.PETERS 04JAN2007 | Tyco Electronics Corporation Harrisburg, PA 17105-3608 | | |
| DIMENSIONS: mm | | CHK D.ORRIS 04JAN2007 | NAME SOCKET CONNECTOR, CROWN EDGE | | |
| | | APVD S.FLICKINGER 04JAN2007 | PRODUCT SPEC - | | |
| TOLERANCES UNLESS OTHERWISE SPECIFIED: | | APPLICATION SPEC - | | | |
| 0 PLC ± - 1 PLC ± .5 [.010] 2 PLC ± .25 [.020] 3 PLC ± - 4 PLC ± - ANGLES ± .5 | | SIZE A3 | | CAGE CODE 00779 | DRAWING NO G-6643460 |
| MATERIAL - | | WEIGHT - | | RESTRICTED TO - | |
| CUSTOMER DRAWING | | | SCALE 1:1 | SHEET 1 OF 6 | REV B |

THIS DRAWING IS UNPUBLISHED. RELEASED FOR PUBLICATION
 © COPYRIGHT 2006 BY TYCO ELECTRONICS CORPORATION. ALL RIGHTS RESERVED.

| LOC | DIST | REVISIONS | | | | | |
|-----|------|-----------|-----|-------------|------|-----|------|
| GP | 00 | P | LTR | DESCRIPTION | DATE | DWN | APVD |
| | | - | - | SEE SHEET 1 | - | - | - |

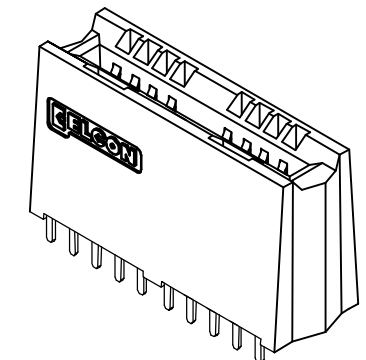
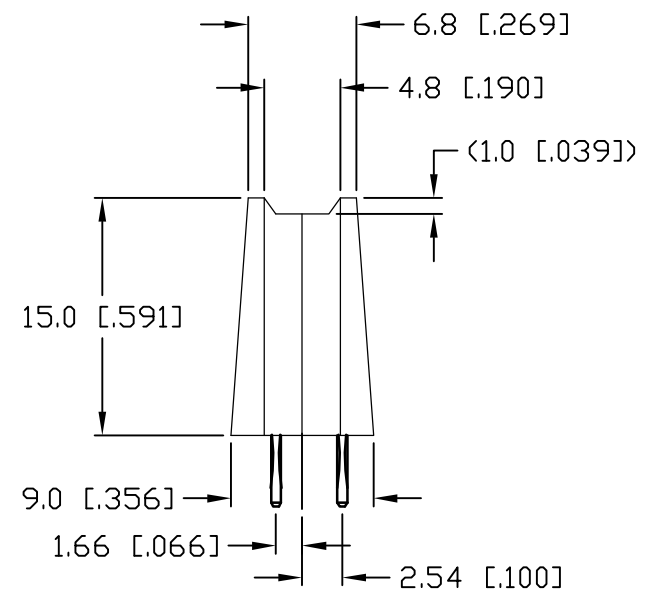
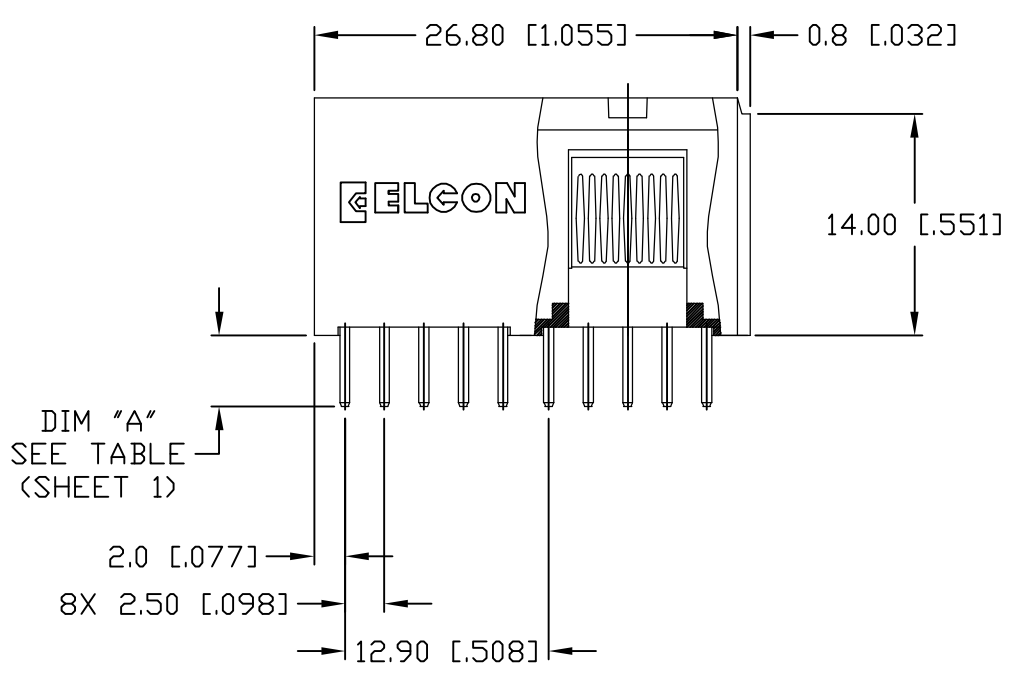
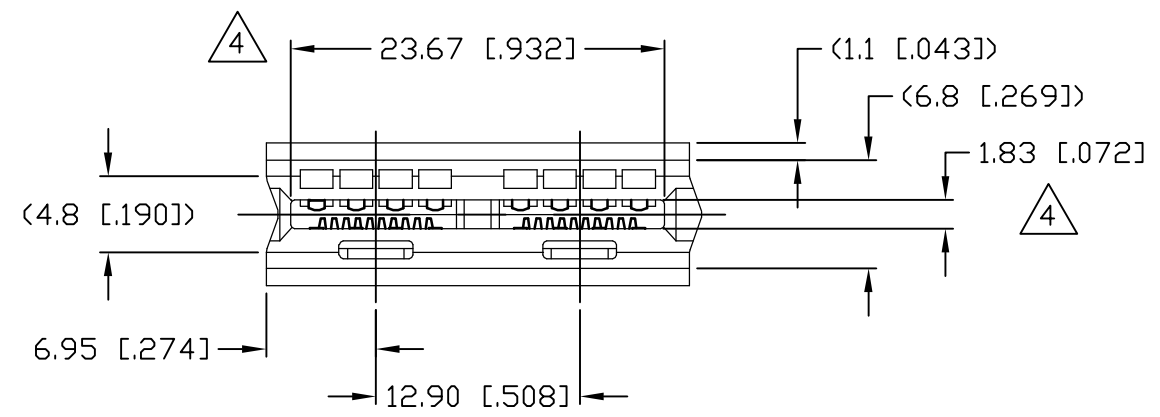
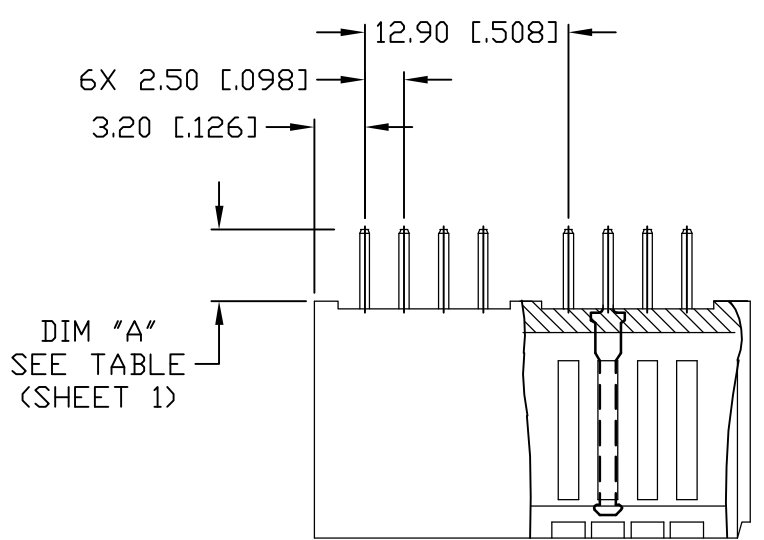

VIEW SHOWN (SOLDER TAILS)
 P/N'S 6643460-1 & -2

| | | | | |
|--|--|-----------------------------|---|--------------|
| THIS DRAWING IS A CONTROLLED DOCUMENT. | | DWN G.PETERS 04JAN2007 | Tyco Electronics Corporation Harrisburg, PA 17105-3608 | |
| DIMENSIONS: mm | | CHK D.ORRIS 04JAN2007 | | |
| TOLERANCES UNLESS OTHERWISE SPECIFIED: | | APVD S.FLICKINGER 04JAN2007 | NAME | |
| 0 PLC ± - | | PRODUCT SPEC | SOCKET CONNECTOR, CROWN EDGE | |
| 1 PLC ± .5 [0.010] | | APPLICATION SPEC | - | |
| 2 PLC ± .25 [0.020] | | SIZE | CAGE CODE | DRAWING NO |
| 3 PLC ± - | | WEIGHT | A3 | 00779 |
| 4 PLC ± - | | CUSTOMER DRAWING | C=6643460 | |
| ANGLES ± .5 | | SCALE | 1:1 | SHEET 2 OF 6 |
| FINISH | | RESTRICTED TO | REV B | |

THIS DRAWING IS UNPUBLISHED. RELEASED FOR PUBLICATION
 © COPYRIGHT 2006 BY TYCO ELECTRONICS CORPORATION. ALL RIGHTS RESERVED.

| LOC | DIST | REVISIONS | | | | | |
|-----|------|-----------|-----|-------------|------|-----|------|
| GP | 00 | P | LTR | DESCRIPTION | DATE | DWN | APVD |
| | | - | - | SEE SHEET 1 | - | - | - |

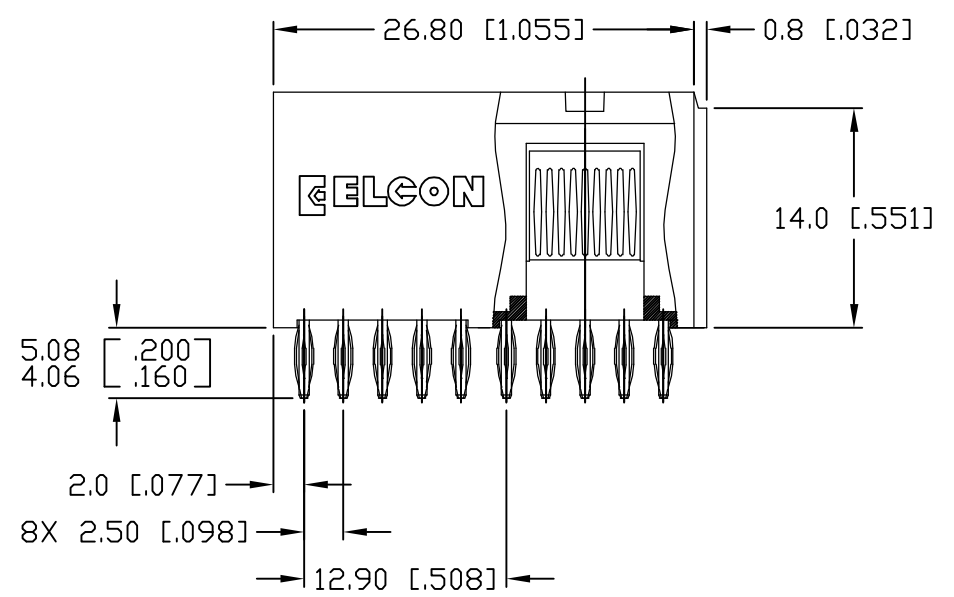
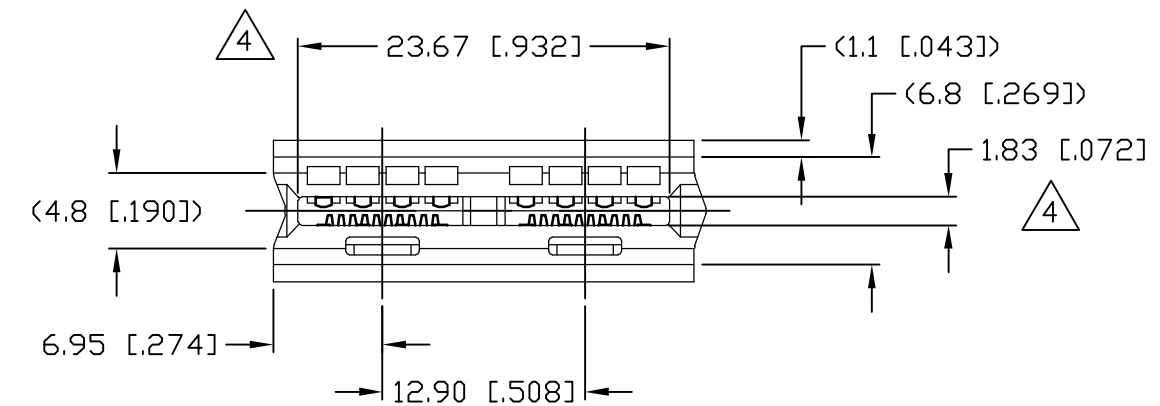
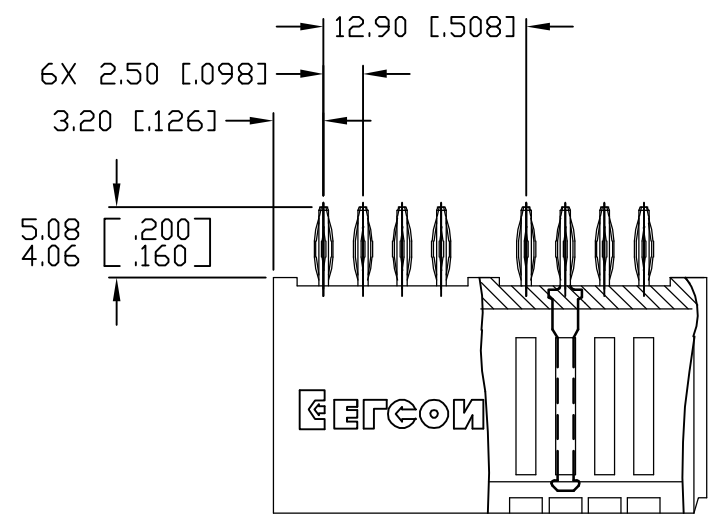

VIEW SHOWN (COMPLIANT TAILS)
 P/N'S 6643460-3

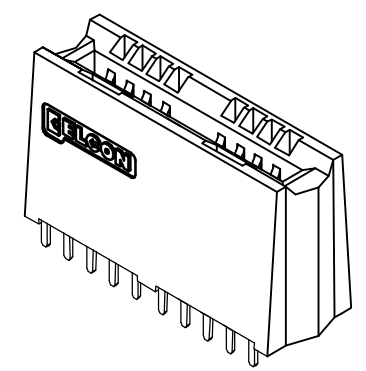
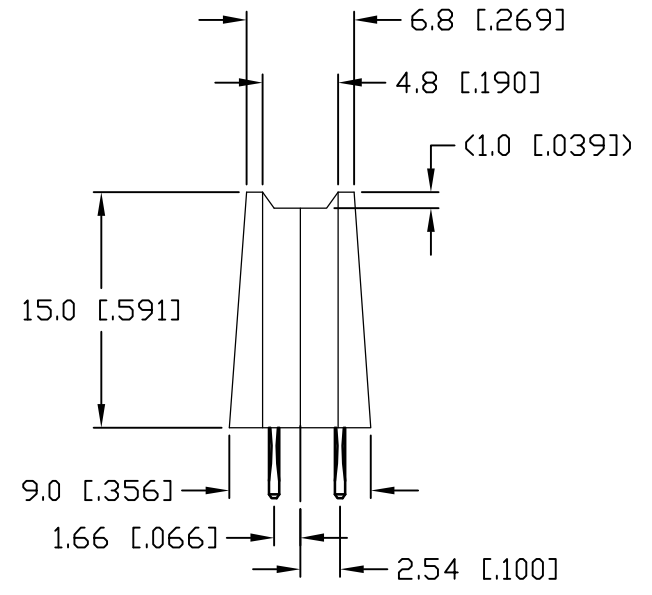

| | | | | |
|---|--|-----------------------------|---|-----------------|
| THIS DRAWING IS A CONTROLLED DOCUMENT. | | DWN G.PETERS 04JAN2007 | Tyco Electronics Corporation Harrisburg, PA 17105-3608 | |
| DIMENSIONS: mm | | CHK D.ORRIS 04JAN2007 | | |
| TOLERANCES UNLESS OTHERWISE SPECIFIED: | | APVD S.FLICKINGER 04JAN2007 | NAME | |
| 0 PLC ± - 1 PLC ± .5 [0.010] 2 PLC ± .25 [0.020] 3 PLC ± - 4 PLC ± - ANGLES ± .5 | | PRODUCT SPEC - | SOCKET CONNECTOR, CROWN EDGE | |
| MATERIAL - | | FINISH - | APPLICATION SPEC - | RESTRICTED TO - |
| | | WEIGHT - | SIZE A3 | CAGE CODE 00779 |
| | | CUSTOMER DRAWING | DRAWING NO C-6643460 | RESTRICTED TO - |
| | | | SCALE 1:1 | SHEET 3 OF 6 |
| | | | | REV B |

THIS DRAWING IS UNPUBLISHED. RELEASED FOR PUBLICATION
 © COPYRIGHT 2006 BY TYCO ELECTRONICS CORPORATION. ALL RIGHTS RESERVED.

| | | | | | | | |
|-----|------|-----------|-----|-------------|------|-----|------|
| LOC | DIST | REVISIONS | | | | | |
| GP | 00 | P | LTR | DESCRIPTION | DATE | DWN | APVD |
| | | | | SEE SHEET 1 | | | |

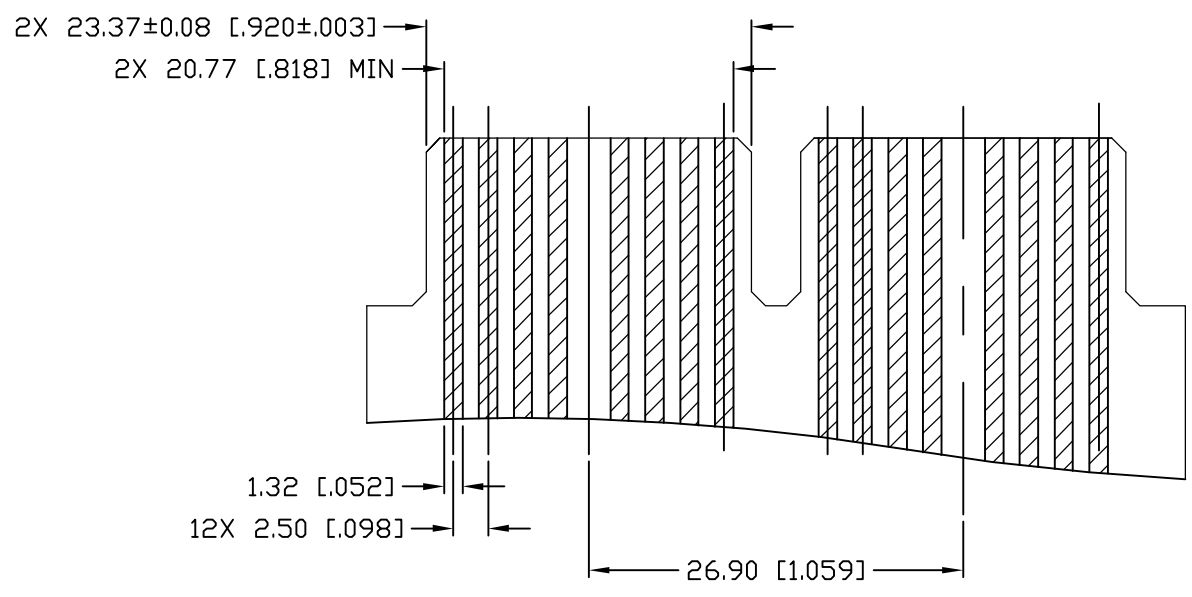
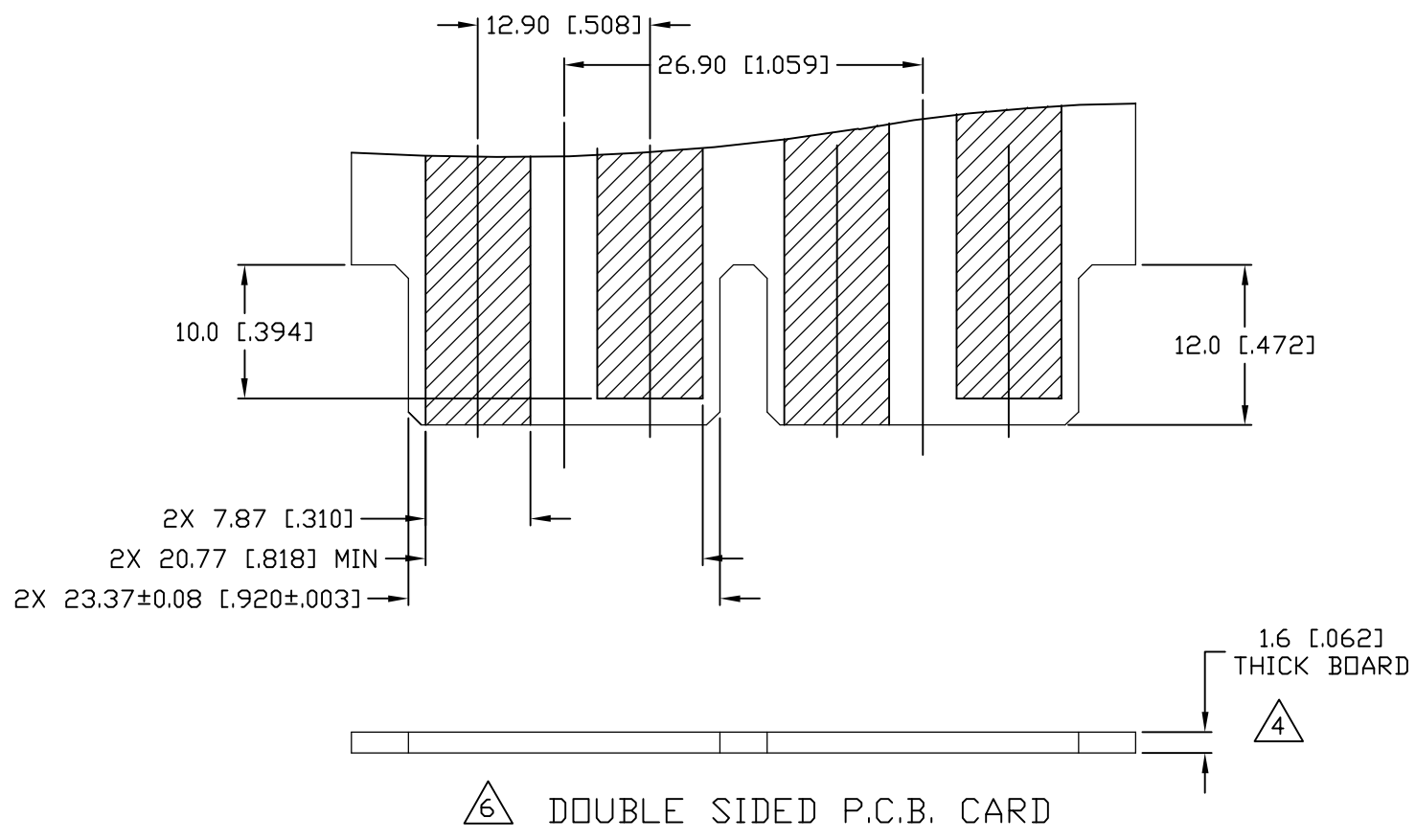

| | | | | | | | | | |
|---|--|------------------|--------------|------------------------------|---|------------|---------------|-----|---|
| THIS DRAWING IS A CONTROLLED DOCUMENT. | | DWN | G.PETERS | 04JAN2007 | Tyco Electronics Corporation Harrisburg, PA 17105-3608 | | | | |
| DIMENSIONS: mm | | CHK | D.ORRIS | 04JAN2007 | | | | | |
| TOLERANCES UNLESS OTHERWISE SPECIFIED: | | APVD | S.FLICKINGER | 04JAN2007 | | | | | |
| 0 PLC ± - 1 PLC ± .5 [.010] 2 PLC ± .25 [.020] 3 PLC ± - 4 PLC ± - ANGLES ± .5 | | PRODUCT SPEC | | NAME | | | | | |
| MATERIAL | | APPLICATION SPEC | | SOCKET CONNECTOR, CROWN EDGE | | | | | |
| FINISH | | WEIGHT | | SIZE | CAGE CODE | DRAWING NO | RESTRICTED TO | | |
| | | - | | A3 | 00779 | C-6643460 | - | | |
| CUSTOMER DRAWING | | | | SCALE | 1:1 | SHEET | 4 OF 6 | REV | B |

THIS DRAWING IS UNPUBLISHED. RELEASED FOR PUBLICATION
 © COPYRIGHT 2006 BY TYCO ELECTRONICS CORPORATION. ALL RIGHTS RESERVED.

| LOC | DIST | REVISIONS | | | |
|-----|------|-------------|------|-----|------|
| P | LTR | DESCRIPTION | DATE | DWN | APVD |
| GP | 00 | SEE SHEET 1 | - | - | - |

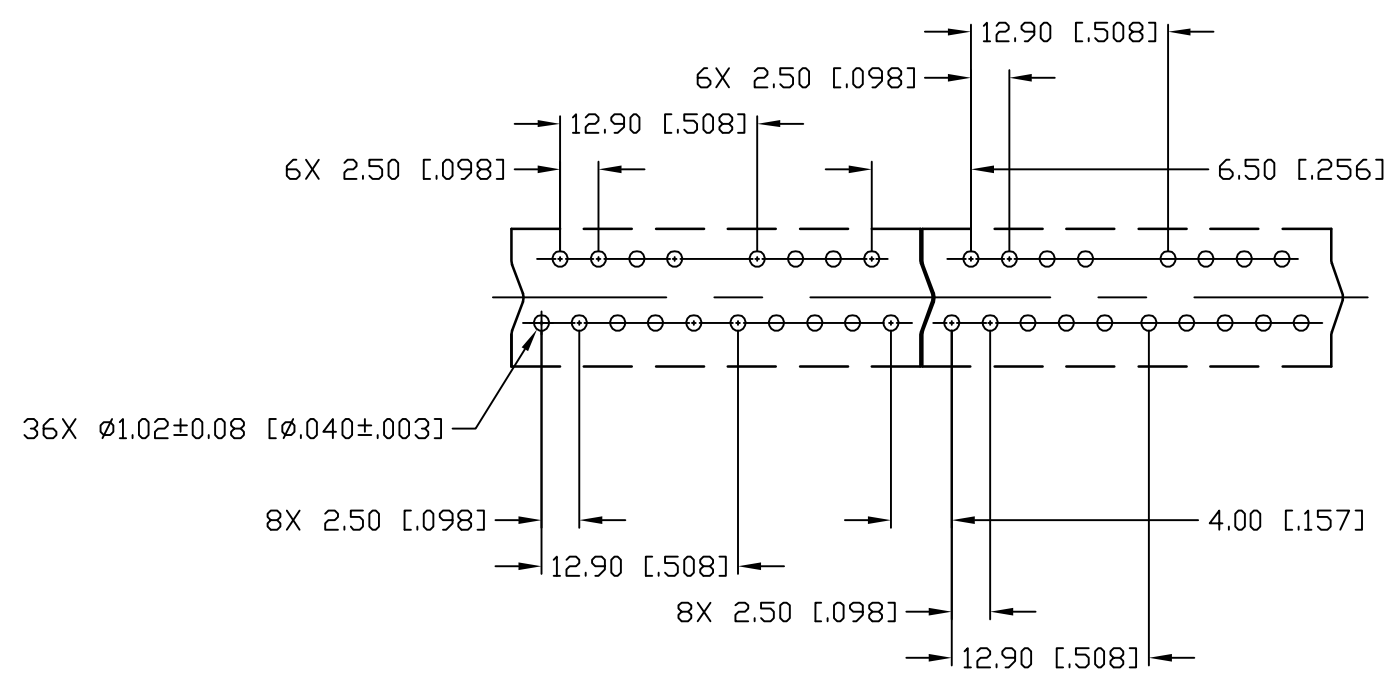

5 RECOMMENDED P.C. BOARD LAYOUT

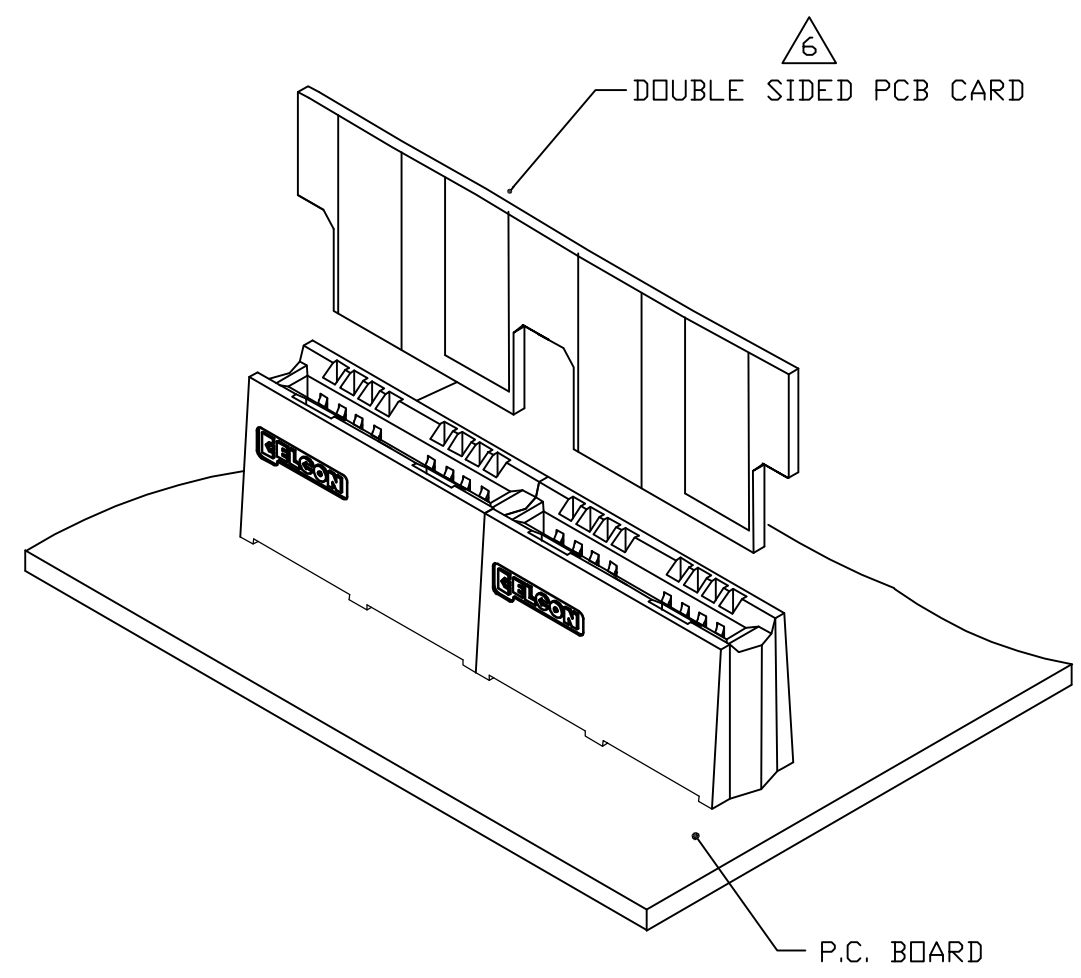

| | | | | | |
|---|--|----------------------|-----------|---|---------------|
| THIS DRAWING IS A CONTROLLED DOCUMENT. | | DWN G.PETERS | 04JAN2007 | Tyco Electronics Corporation Harrisburg, PA 17105-3608 | |
| DIMENSIONS: mm | | CHK D.ORRIS | 04JAN2007 | | |
| TOLERANCES UNLESS OTHERWISE SPECIFIED: | | APVD S.FLICKINGER | 04JAN2007 | NAME | |
| 0 PLC ± - 1 PLC ± .5 [.010] 2 PLC ± .25 [.020] 3 PLC ± - 4 PLC ± - ANGLES ± .5 | | PRODUCT SPEC | | SOCKET CONNECTOR, CROWN EDGE | |
| MATERIAL | | APPLICATION SPEC | | SIZE | RESTRICTED TO |
| FINISH | | WEIGHT | | A3 | - |
| | | CUSTOMER DRAWING | | CAGE CODE | DRAWING NO |
| | | | | 00779 | 6643460 |
| | | | | SCALE | SHEET |
| | | | | 1:1 | 5 OF 6 |
| | | | | REV | B |

THIS DRAWING IS UNPUBLISHED. RELEASED FOR PUBLICATION
 © COPYRIGHT 2006 BY TYCO ELECTRONICS CORPORATION. ALL RIGHTS RESERVED.

| LOC | DIST | REVISIONS | | | |
|-----|------|-------------|------|-----|------|
| P | LTR | DESCRIPTION | DATE | DWN | APVD |
| GP | 00 | SEE SHEET 1 | - | - | - |

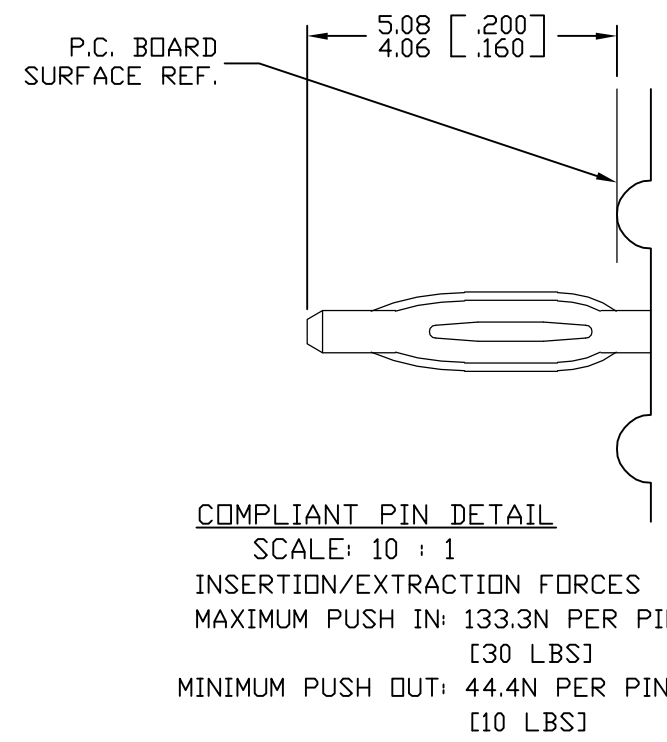
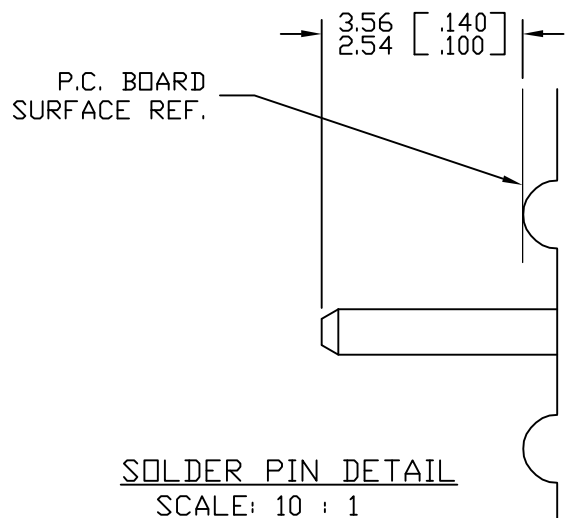
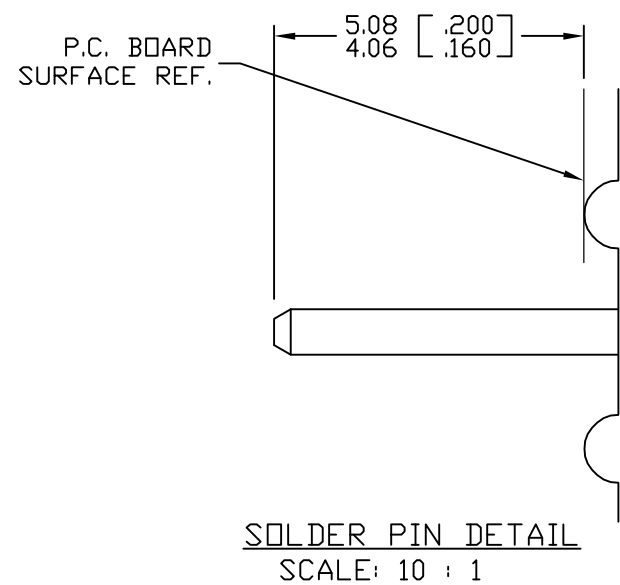

RECOMMENDED PRINTED CIRCUIT HOLE
 SOLDER OR COMPLIANT PRESS FIT
 FINISHED HOLE: $\phi 1.02$ [.040] ± 0.08 [.003]
 DRILLED HOLE: $\phi 1.15$ [.0453] ± 0.013 [.0005]
 COPPER PLATE: .025 [.0010] MINIMUM (PER SURFACE)
 TIN PLATE: .008 [.0003] MINIMUM (PER SURFACE)

| | | | | | |
|---|--|----------------------|-----------|---|---------------|
| THIS DRAWING IS A CONTROLLED DOCUMENT. | | DWN G.PETERS | 04JAN2007 | Tyco Electronics Corporation Harrisburg, PA 17105-3608 | |
| DIMENSIONS: mm | | CHK D.ORRIS | 04JAN2007 | | |
| | | APVD S.FLICKINGER | 04JAN2007 | | |
| TOLERANCES UNLESS OTHERWISE SPECIFIED: | | PRODUCT SPEC | | NAME | |
| 0 PLC $\pm -$ 1 PLC $\pm .5$ [.010] 2 PLC $\pm .25$ [.020] 3 PLC $\pm -$ 4 PLC $\pm -$ ANGLES $\pm .5$ | | APPLICATION SPEC | | SOCKET CONNECTOR, CROWN EDGE | |
| MATERIAL | | WEIGHT | | SIZE | RESTRICTED TO |
| - | | - | | A3 | - |
| | | CUSTOMER DRAWING | | CAGE CODE | REV |
| | | | | 00779 | B |
| | | | | DRAWING NO | SCALE |
| | | | | C-6643460 | 1:1 |
| | | | | SHEET | REV |
| | | | | 6 OF 6 | B |



Компания «ЭлектроПласт» предлагает заключение долгосрочных отношений при поставках импортных электронных компонентов на взаимовыгодных условиях!

Наши преимущества:

- Оперативные поставки широкого спектра электронных компонентов отечественного и импортного производства напрямую от производителей и с крупнейших мировых складов;
- Поставка более 17-ти миллионов наименований электронных компонентов;
- Поставка сложных, дефицитных, либо снятых с производства позиций;
- Оперативные сроки поставки под заказ (от 5 рабочих дней);
- Экспресс доставка в любую точку России;
- Техническая поддержка проекта, помощь в подборе аналогов, поставка прототипов;
- Система менеджмента качества сертифицирована по Международному стандарту ISO 9001;
- Лицензия ФСБ на осуществление работ с использованием сведений, составляющих государственную тайну;
- Поставка специализированных компонентов (Xilinx, Altera, Analog Devices, Intersil, Interpoint, Microsemi, Aeroflex, Peregrine, Syfer, Eurofarad, Texas Instrument, Miteq, Cobham, E2V, MA-COM, Hittite, Mini-Circuits, General Dynamics и др.);

Помимо этого, одним из направлений компании «ЭлектроПласт» является направление «Источники питания». Мы предлагаем Вам помощь Конструкторского отдела:

- Подбор оптимального решения, техническое обоснование при выборе компонента;
- Подбор аналогов;
- Консультации по применению компонента;
- Поставка образцов и прототипов;
- Техническая поддержка проекта;
- Защита от снятия компонента с производства.



Как с нами связаться

Телефон: 8 (812) 309 58 32 (многоканальный)

Факс: 8 (812) 320-02-42

Электронная почта: org@eplast1.ru

Адрес: 198099, г. Санкт-Петербург, ул. Калинина, дом 2, корпус 4, литера А.