

**PLEASE CHECK WWW.MOLEX.COM FOR LATEST PART INFORMATION**

**Part Number:** [0003061038](#)  
**Status:** **Active**  
**Overview:** [standard\\_062](#)  
**Description:** 1.57mm (.062") Diameter Standard .062 Pin and Socket Receptacle Housing, 3 Circuits, With Pre-bent Mounting Ears

**Documents:**

[3D Model](#) [Product Specification PS-02-06 \(PDF\)](#)  
[Drawing \(PDF\)](#) [RoHS Certificate of Compliance \(PDF\)](#)  
[Packaging Specification \(PDF\)](#)

**Agency Certification**

|     |           |
|-----|-----------|
| CSA | LR19980   |
| TUV | R72081037 |
| UL  | E29179    |

**General**

|                |                              |
|----------------|------------------------------|
| Product Family | Crimp Housings               |
| Series         | <a href="#">1625</a>         |
| Comments       | Polarized to Mating Part     |
| MolexKits      | Yes                          |
| Overview       | <a href="#">standard_062</a> |
| Product Name   | Standard .062"               |

**Physical**

|                               |                 |
|-------------------------------|-----------------|
| Breakaway                     | No              |
| Circuits (maximum)            | 3               |
| Circuits Detail               | 1x3             |
| Color - Resin                 | Natural         |
| Flammability                  | 94V-2           |
| Gender                        | Receptacle      |
| Glow-Wire Compliant           | No              |
| Keying to Mating Part         | None            |
| Lock to Mating Part           | Yes             |
| Material - Resin              | Nylon           |
| Number of Rows                | 1               |
| Packaging Type                | Bag             |
| Panel Mount                   | Yes             |
| Pitch - Mating Interface (in) | 0.145 In        |
| Pitch - Mating Interface (mm) | 3.68 mm         |
| Pitch - Term. Interface (in)  | 0.145 In        |
| Pitch - Term. Interface (mm)  | 3.96 mm         |
| Polarized to Mating Part      | Yes             |
| Stackable                     | No              |
| Temperature Range - Operating | -40°C to +105°C |

**Electrical**

|                               |    |
|-------------------------------|----|
| Current - Maximum per Contact | 5A |
|-------------------------------|----|

**Material Info**

|                 |          |
|-----------------|----------|
| Old Part Number | 1625-3R4 |
|-----------------|----------|

**Reference - Drawing Numbers**

|                         |             |
|-------------------------|-------------|
| Packaging Specification | PK-1625-001 |
| Product Specification   | PS-02-06    |
| Sales Drawing           | SD-1625-3*  |

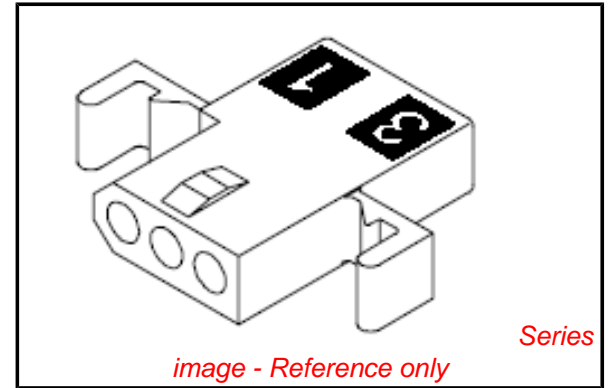

**EU RoHS**

**ELV and RoHS Compliant**  
**REACH SVHC**  
**Contains SVHC: No**  
**Halogen-Free**  
**Status**

**China RoHS**



**Not Reviewed**

**Need more information on product environmental compliance?**

Email [productcompliance@molex.com](mailto:productcompliance@molex.com)  
 For a multiple part number RoHS Certificate of Compliance, [click here](#)

Please visit the [Contact Us](#) section for any non-product compliance questions.

**Search Parts in this Series**

[1625Series](#)

**Mates With**

[1625 Plug](#)

**Use With**

Female Crimp Terminals [1561](#)[Link:4559](#), [4529](#), [2190](#), [2189](#), [1787](#), [1855](#). Male Crimp Terminals [1560](#), [1786](#), [1854](#), [1778](#). Male PC Tail Terminals. [1779](#) Female PC Tail Terminals

This document was generated on 06/07/2010

**PLEASE CHECK [WWW.MOLEX.COM](http://WWW.MOLEX.COM) FOR LATEST PART INFORMATION**

RECEPTACLE

PLUG

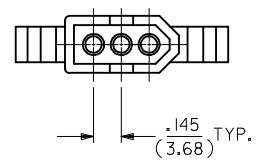
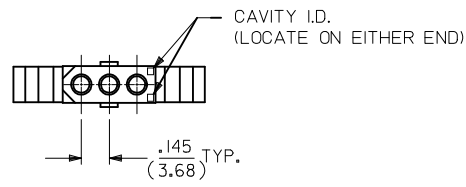
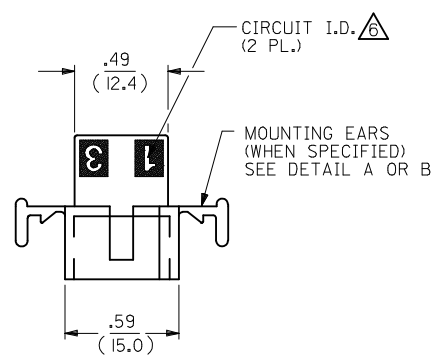
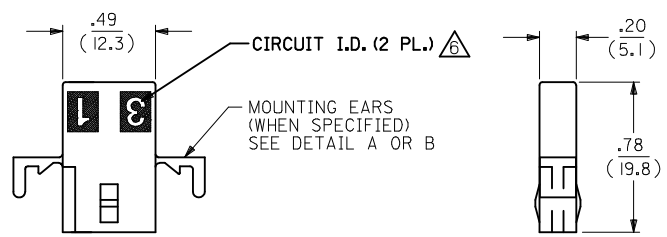
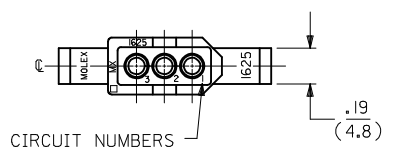
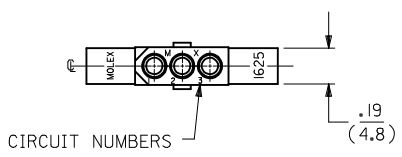

RECEPTACLE HOUSING  
SHOWN WITH STANDARD EARS

PLUG HOUSING  
SHOWN WITH STANDARD EARS

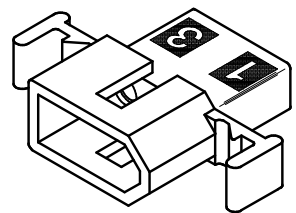

|  |   |   |            |                          |   |   |                            |                     |  |
|--|---|---|------------|--------------------------|---|---|----------------------------|---------------------|--|
| UPDATE REV. LEVEL<br>EC NO: UCP2007-1925<br>DRAWN: PRIDDER<br>CHKD: AELHAG<br>APPR: FSMITH<br>2007/02/08<br>2007/02/12<br>2007/02/12 | QUALITY SYMBOLS<br>$\nabla=0$<br>$\nabla=0$ | GENERAL TOLERANCES (UNLESS SPECIFIED)   |            | DIMENSION STYLE<br>IN/MM | SCALE<br>---  | DESIGN UNITS<br>INCH  | THIRD ANGLE PROJECTION     |                     |  |
|  |   | 4 PLACES $\pm$ --- $\pm$ ---<br>3 PLACES $\pm$ --- $\pm$ .010<br>2 PLACES $\pm$ 0.25 $\pm$ .014<br>1 PLACE $\pm$ 0.35 $\pm$ --- | mm<br>INCH | DRAWN BY<br>KBW          | DATE<br>1/26/89   | TITLE<br>PLUG AND RECEPTACLE HOUSINGS, 3 CIRCUIT, .062 DIA. |                            |                     |  |
|  |   | ANGULAR $\pm$ 1/2°  |            | CHECKED BY<br>RW         | DATE<br>1/26/89   | MOLEX INCORPORATED  |                            |                     |  |
|  |   | DRAFT WHERE APPLICABLE MUST REMAIN WITHIN DIMENSIONS  |            | APPROVED BY<br>RAS       | DATE<br>1/26/89   | MATERIAL NO.<br>SEE CHART                                   | DOCUMENT NO.<br>SD-1625-3* | SHEET NO.<br>1 OF 2 |  |
| M2   | REV   |   |            | SIZE                     | THIS DRAWING CONTAINS INFORMATION THAT IS PROPRIETARY TO MOLEX INCORPORATED AND SHOULD NOT BE USED WITHOUT WRITTEN PERMISSION |   |                            |                     |  |

| PLUG       |            |                 |
|------------|------------|-----------------|
| PART NO.   | ENG. NO.   |                 |
| 03-06-2031 | I625-3P    |                 |
| 03-06-2032 | I625-3P1   |                 |
| 03-06-2034 | I625-3P4BK |                 |
| 03-06-7032 | I625-3P1BK | <b>OBSOLETE</b> |
| 03-06-2033 | I625-3P4   |                 |

| RECEPTACLE |            |                 |
|------------|------------|-----------------|
| PART NO.   | ENG. NO.   |                 |
| 03-06-1033 | I625-3R2   |                 |
| 03-06-1031 | I625-3R    |                 |
| 03-06-1032 | I625-3R1   |                 |
| 03-06-6031 | I625-3RBK  |                 |
| 03-06-6032 | I625-3R1BK | <b>OBSOLETE</b> |
| 03-06-1034 | I625-3R3   |                 |
| 03-06-1038 | I625-3R4   |                 |

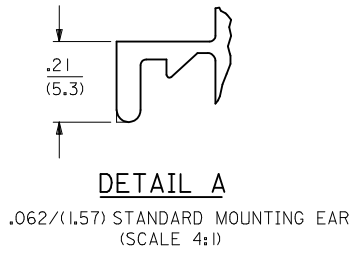

**LEGEND:**  
 I625-3\*\*\*\*

CIRCUIT SIZE

P = PLUG  
 R = RECEPTACLE

BLANK = WITH STANDARD EARS  
 1 = WITHOUT EARS  
 2 = WITHOUT EARS, WITHOUT DETENTS  
 3 = WITH STD. EARS, WITHOUT DETENTS  
 4 = WITH PREBENT EARS

COLOR:

BLANK = NATURAL COLOR  
 AM = AMBER BK = BLACK BU = BLUE  
 BN = BROWN GY = GRAY GN = GREEN  
 OR = ORANGE RD = RED YW = YELLOW

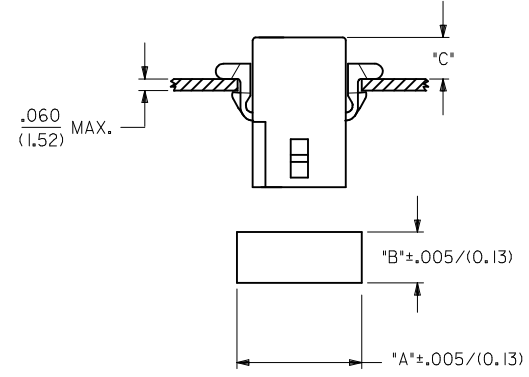

| HOUSING | DIM. "A"     | DIM. "B"    | "C" PREBENT EAR | "C" STANDARD EAR |
|---------|--------------|-------------|-----------------|------------------|
| PLUG    | .754/(19.15) | .318/(8.08) | .19/(4.8)       | .18/(4.6)        |
| RECEPT. | .650/(16.51) | .265/(6.73) | .21/(5.3)       | .20/(5.1)        |

RECOMMENDED PANEL OPENING

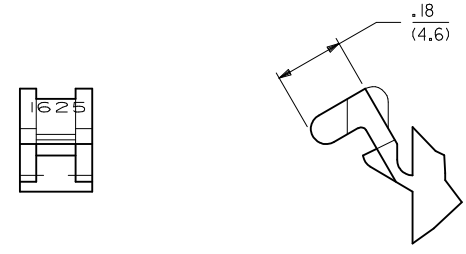

- NOTES:-
1. MATERIAL: NYLON TYPE 6/6, 94V-2.
  2. FINISH: NONE.
  3. PRODUCT SPECIFICATION: PS-02-06.
  4. PACKAGING SPECS: BULK PACK PER PK-1625-001.
  5. ACCEPTS MOLEX .062" SERIES TERMINALS.

ETCHED CIRCUIT I.D. NUMBERS ON HOUSING MAY OR MAY NOT BE PRESENT.

7. PARTS CONFORM TO CLASS B REQUIREMENTS OF COSMETIC SPECIFICATION PS-45499-002.

| <b>REVISE NOTE # 6</b><br>EC NO: UCP2010-0366<br>DRW: AELHAG 2009/08/11<br>CHKD: J.BELL 2009/08/11<br>APPR: F.SMITH 2009/08/11 | QUALITY SYMBOLS<br>▽=0<br>▽=0 | GENERAL TOLERANCES (UNLESS SPECIFIED)<br><table border="1"> <tr> <th></th> <th>mm</th> <th>INCH</th> </tr> <tr> <td>4 PLACES ±</td> <td>---</td> <td>---</td> </tr> <tr> <td>3 PLACES ±</td> <td>---</td> <td>±.010</td> </tr> <tr> <td>2 PLACES ±</td> <td>0.25</td> <td>±.014</td> </tr> <tr> <td>1 PLACE ±</td> <td>0.35</td> <td>±---</td> </tr> </table> |                                   | mm                         | INCH  | 4 PLACES ± | --- | --- | 3 PLACES ± | --- | ±.010 | 2 PLACES ± | 0.25 | ±.014 | 1 PLACE ± | 0.35 | ±--- | DIMENSION STYLE<br><b>IN/MM</b> | SCALE<br><b>1:1</b> | DESIGN UNITS<br><b>INCH</b> | THIRD ANGLE PROJECTION |
|--|-------------------------------|---|-----------------------------------|----------------------------|---|------------|-----|-----|------------|-----|-------|------------|------|-------|-----------|------|------|---------------------------------|---------------------|-----------------------------|------------------------|
|  |                               | mm  | INCH                              |                            |   |            |     |     |            |     |       |            |      |       |           |      |      |                                 |                     |                             |                        |
|  | 4 PLACES ±                    | ---   | ---                               |                            |   |            |     |     |            |     |       |            |      |       |           |      |      |                                 |                     |                             |                        |
|  | 3 PLACES ±                    | ---   | ±.010                             |                            |   |            |     |     |            |     |       |            |      |       |           |      |      |                                 |                     |                             |                        |
| 2 PLACES ±   | 0.25                          | ±.014   |                                   |                            |   |            |     |     |            |     |       |            |      |       |           |      |      |                                 |                     |                             |                        |
| 1 PLACE ±  | 0.35                          | ±---  |                                   |                            |   |            |     |     |            |     |       |            |      |       |           |      |      |                                 |                     |                             |                        |
| DRAWN BY<br>KBW  | DATE<br>01/26/89              | <b>TITLE</b><br>PLUG AND RECEPTACLE HOUSINGS, 3 CIRCUIT, .062 DIA.  |                                   |                            |   |            |     |     |            |     |       |            |      |       |           |      |      |                                 |                     |                             |                        |
| CHECKED BY<br>RW   | DATE<br>01/26/89              | <b>MOLEX INCORPORATED</b>   |                                   |                            |   |            |     |     |            |     |       |            |      |       |           |      |      |                                 |                     |                             |                        |
| APPROVED BY<br>RAS   | DATE<br>01/26/89              | MATERIAL NO.<br><b>SEE CHART</b>  | DOCUMENT NO.<br><b>SD-1625-3*</b> | SHEET NO.<br><b>2 OF 2</b> | THIS DRAWING CONTAINS INFORMATION THAT IS PROPRIETARY TO MOLEX INCORPORATED AND SHOULD NOT BE USED WITHOUT WRITTEN PERMISSION |            |     |     |            |     |       |            |      |       |           |      |      |                                 |                     |                             |                        |



Компания «ЭлектроПласт» предлагает заключение долгосрочных отношений при поставках импортных электронных компонентов на взаимовыгодных условиях!

Наши преимущества:

- Оперативные поставки широкого спектра электронных компонентов отечественного и импортного производства напрямую от производителей и с крупнейших мировых складов;
- Поставка более 17-ти миллионов наименований электронных компонентов;
- Поставка сложных, дефицитных, либо снятых с производства позиций;
- Оперативные сроки поставки под заказ (от 5 рабочих дней);
- Экспресс доставка в любую точку России;
- Техническая поддержка проекта, помощь в подборе аналогов, поставка прототипов;
- Система менеджмента качества сертифицирована по Международному стандарту ISO 9001;
- Лицензия ФСБ на осуществление работ с использованием сведений, составляющих государственную тайну;
- Поставка специализированных компонентов (Xilinx, Altera, Analog Devices, Intersil, Interpoint, Microsemi, Aeroflex, Peregrine, Syfer, Eurofarad, Texas Instrument, Miteq, Cobham, E2V, MA-COM, Hittite, Mini-Circuits, General Dynamics и др.);

Помимо этого, одним из направлений компании «ЭлектроПласт» является направление «Источники питания». Мы предлагаем Вам помощь Конструкторского отдела:

- Подбор оптимального решения, техническое обоснование при выборе компонента;
- Подбор аналогов;
- Консультации по применению компонента;
- Поставка образцов и прототипов;
- Техническая поддержка проекта;
- Защита от снятия компонента с производства.



#### Как с нами связаться

**Телефон:** 8 (812) 309 58 32 (многоканальный)

**Факс:** 8 (812) 320-02-42

**Электронная почта:** [org@eplast1.ru](mailto:org@eplast1.ru)

**Адрес:** 198099, г. Санкт-Петербург, ул. Калинина, дом 2, корпус 4, литера А.