

# General Specifications

## Electrical Capacity

|                        |                                                                      |
|------------------------|----------------------------------------------------------------------|
| <b>Resistive Load:</b> | 10A @ 125V AC or 6A @ 250V AC                                        |
| <b>Motor Load:</b>     | 400W @ 125V AC                                                       |
| <b>Lamp Load:</b>      | 2A @ 125V AC for On-Off-On circuit & 3A @ 125V AC for other circuits |

## Other Ratings

|                               |                                                                                                                            |
|-------------------------------|----------------------------------------------------------------------------------------------------------------------------|
| <b>Contact Resistance:</b>    | 10 milliohms maximum                                                                                                       |
| <b>Insulation Resistance:</b> | 1,000 megohms minimum @ 500V DC                                                                                            |
| <b>Dielectric Strength:</b>   | 2,000V AC minimum between contacts for 1 minute minimum;<br>4,000V AC minimum between contacts & case for 1 minute minimum |
| <b>Mechanical Life:</b>       | 100,000 operations minimum                                                                                                 |
| <b>Electrical Life:</b>       | 25,000 operations minimum                                                                                                  |
| <b>Angle of Throw:</b>        | 25°                                                                                                                        |

## Materials & Finishes

|                             |                                   |
|-----------------------------|-----------------------------------|
| <b>Toggle Cap:</b>          | Brass with nickel plating         |
| <b>Lever:</b>               | Brass with chrome plating         |
| <b>Bushing:</b>             | Brass with nickel plating         |
| <b>Frame:</b>               | Stainless steel                   |
| <b>Case/Base:</b>           | Diallyl phthalate resin (UL94V-0) |
| <b>Movable Contacts:</b>    | Silver alloy with silver plating  |
| <b>Stationary Contacts:</b> | Pure silver with silver plating   |
| <b>Terminals:</b>           | Copper with silver plating        |

## Environmental Data

|                              |                                                                                                                                              |
|------------------------------|----------------------------------------------------------------------------------------------------------------------------------------------|
| <b>Operating Temp Range:</b> | -10°C through +85°C (+14°F through +185°F)                                                                                                   |
| <b>Humidity:</b>             | 90 ~ 95% humidity for 96 hours @ 40°C (104°F)                                                                                                |
| <b>Vibration:</b>            | 10 ~ 55Hz with peak-to-peak amplitude of 1.5mm traversing the frequency range & returning in 1 minute; 3 right angled directions for 2 hours |
| <b>Shock:</b>                | 50G (490m/s <sup>2</sup> ) acceleration (tested in 6 right angled directions, with 5 shocks in each direction)                               |

## Installation

|                                   |                                                                                                                                          |
|-----------------------------------|------------------------------------------------------------------------------------------------------------------------------------------|
| <b>Soldering Time &amp; Temp:</b> | Wave Soldering Recommended (Straight PC): See Profile A in Supplement section.<br>Manual Soldering: See Profile A in Supplement section. |
| <b>Cleaning:</b>                  | These devices are not process sealed. Hand clean locally using alcohol based solution.                                                   |

## Standards & Certifications

|                                |                                                                                                                                                                                                                    |
|--------------------------------|--------------------------------------------------------------------------------------------------------------------------------------------------------------------------------------------------------------------|
| <b>Flammability Standards:</b> | UL94V-0 rated case/base                                                                                                                                                                                            |
| <b>UL:</b>                     | <b>File No. E44145 - Recognized only when ordered with marking on switch.</b><br>Add "/U" or "/CUL" to end of part number to order UL recognized switch.<br>All models recognized at 10A @ 125V AC & 6A @ 250V AC. |
| <b>CSA:</b>                    | <b>File No. 023535_0_000 - Certified only when ordered with marking on switch.</b><br>Add "/C" to end of part number to order CSA certified switch.<br>All models certified at 10A @ 125V AC & 6A @ 250V AC.       |
| <b>VDE:</b>                    | <b>License No. 119174</b><br>All models approved at 10A @ 125V AC & 6A @ 250V AC.<br>Marking on switch is standard. All models meet EN 61058-1 standard.                                                           |

# Distinctive Characteristics

Meets EN 61058-1 standard.

High torque bushing construction prevents rotation or separation from frame during installation.

Stainless steel frame resists corrosion and increases environmental safety.

Case/base of heat resistant resin meets UL94V-0 flammability standard.

Contacts of special silver alloy resist arcing and guarantee stable electrical contact and long life.

High insulating barriers increase isolation of circuits in double pole devices and provide added protection to contact points.

Prominent external insulating barriers increase insulation resistance and dielectric strength.

Epoxy sealed terminals prevent entry of flux, solvents, and other contaminants.

Clinching of the frame to the case well above the base and terminals provides 4,000V dielectric strength.



Actual Size



- A Toggles
- Rockers
- Pushbuttons
- Illuminated PB
- Programmable
- Keylocks
- Rotaries
- Slides
- Tactiles
- Tilt
- Touch
- Indicators
- Accessories
- Supplement

### TYPICAL SWITCH ORDERING EXAMPLE

**P20**

**22**

**B**



| Poles & Circuits |      |    |      |     |
|------------------|------|----|------|-----|
| 11               | SPST | ON | NONE | OFF |
| 12               | SPDT | ON | NONE | ON  |
| 13               | SPDT | ON | OFF  | ON  |
| 21               | DPST | ON | NONE | OFF |
| 22               | DPDT | ON | NONE | ON  |
| 23               | DPDT | ON | OFF  | ON  |

| Toggles & Bushings |                                                      |
|--------------------|------------------------------------------------------|
| No Code            | .512" (13.0mm) White Cap with 6mm Bushing            |
| E                  | .450" (11.4mm) Flatted with 6mm Bushing              |
| B                  | .689" (17.5mm) Large Bat with 12mm Bushing           |
| D                  | .748" (19.0mm) White Capped Column with 12mm Bushing |

| Terminals |                              |
|-----------|------------------------------|
| No Code   | Solder Lug*                  |
| P         | Straight PC                  |
| Z         | .187" (4.75mm) Quick Connect |

### DESCRIPTION FOR TYPICAL ORDERING EXAMPLE

**P2022B**

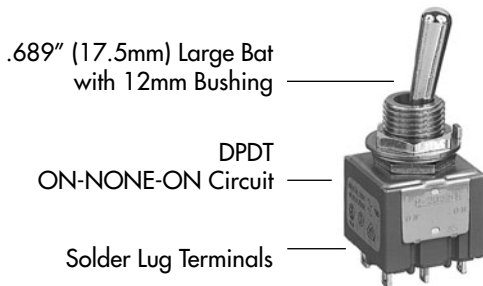

\* Wire harness & cable assemblies offered only in Americas

### IMPORTANT:



VDE is marked on all models. Switches are supplied without UL, cULus & CSA marking unless specified. **UL, cULus & CSA recognized only when ordered with marking on the switch.** Specific models, ratings, & ordering instructions are noted on General Specifications page.

### POLES & CIRCUITS

| Pole | Model          | Toggle Position               |             |          | Connected Terminals           |        |           | Throw & Schematics |
|------|----------------|-------------------------------|-------------|----------|-------------------------------|--------|-----------|--------------------|
|      |                | Down<br><small>Keyway</small> | Center      | Up       | Down<br><small>Keyway</small> | Center | Up        |                    |
| SP   | P2011          | ON                            | NONE        | OFF      | 1-1b                          | OPEN   | OPEN      | SPST<br>           |
| SP   | P2012<br>P2013 | ON<br>ON                      | NONE<br>OFF | ON<br>ON | 1-1b                          | OPEN   | 1-1a      | SPDT<br>           |
| DP   | P2021          | ON                            | NONE        | OFF      | 1-1b 2-2b                     | OPEN   | OPEN      | DPST<br>           |
| DP   | P2022<br>P2023 | ON<br>ON                      | NONE<br>OFF | ON<br>ON | 1-1b 2-2b                     | OPEN   | 1-1a 2-2a | DPDT<br>           |

## TOGGLES & BUSHINGS

**No Code**

**.512" (13.0mm)**  
White Cap with  
6mm Bushing

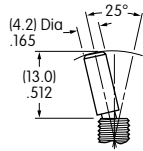

Panel Thickness  
with Keyway  
.134" (3.4mm)  
maximum

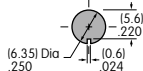

**E**

**.450" (11.4mm)**  
Flatted with  
6mm Bushing

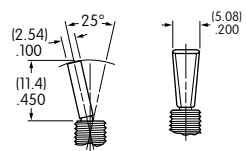

Panel Thickness  
with Locking Ring  
.102" (2.6mm)  
maximum

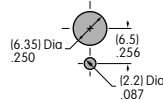

**B**

**.689" (17.5mm)**  
Large Bat with  
12mm Bushing

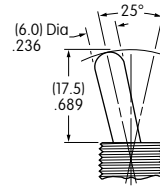

Panel Thickness  
with Keyway  
.256" (6.5mm)  
maximum

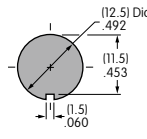

**D**

**.748" (19.0mm)**  
White Capped Column  
with 12mm Bushing

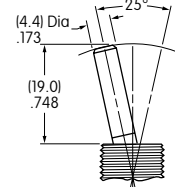

Panel Thickness  
with Locking Ring  
.217" (5.5mm)  
maximum

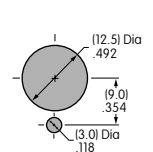

### Panel Cutouts

### Standard Hardware

For 6mm Bushing: 1 Locking Ring AT507M, 1 Internal Tooth Lockwasher AT509, 2 Hex Nuts AT513M

For 12mm Bushing: 1 Hex Face Nut AT503M, 1 Locking Ring AT506M, 1 Internal Tooth Lockwasher AT508, 1 Hex Mounting Nut AT527M

Optional Splashproof Boot Assemblies (for code B): AT401 & AT4181 boots plus hex nut & o-ring; see Accessories & Hardware section.

## TERMINALS

**No Code**

**Solder Lug**

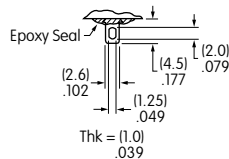

**Z**

**.187" (4.75mm)**  
Quick Connect

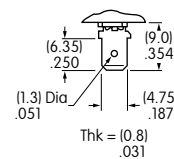

**P**

**Straight PC**

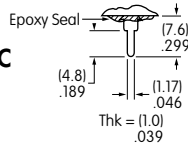

SPST

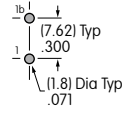

SPDT

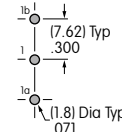

DPST

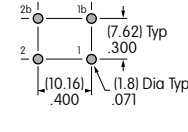

DPDT

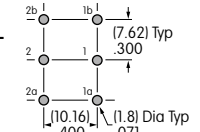

## TYPICAL SWITCH DIMENSIONS

**P2011, P2012, P2013**

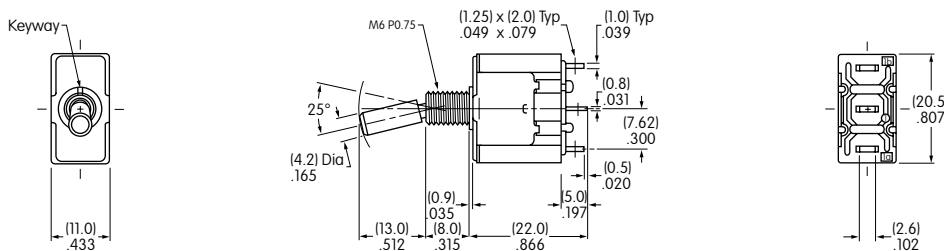

**6mm Bushing**



P2011 models do not have terminal 1a.

**P2012**

**P2021B, P2022B, P2023B**

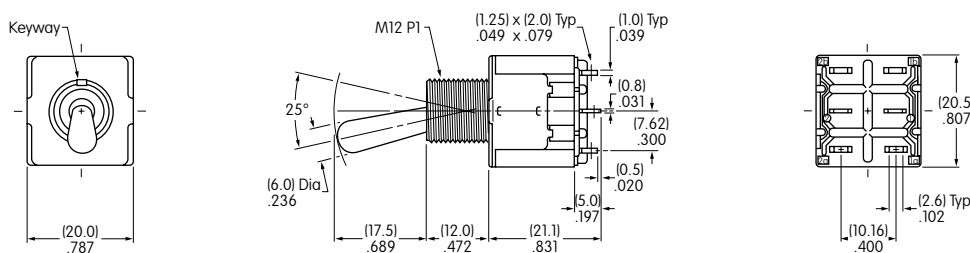

**12mm Bushing**



P2021 models do not have terminals 1a & 2a.

**P2022B**



Компания «ЭлектроПласт» предлагает заключение долгосрочных отношений при поставках импортных электронных компонентов на взаимовыгодных условиях!

Наши преимущества:

- Оперативные поставки широкого спектра электронных компонентов отечественного и импортного производства напрямую от производителей и с крупнейших мировых складов;
- Поставка более 17-ти миллионов наименований электронных компонентов;
- Поставка сложных, дефицитных, либо снятых с производства позиций;
- Оперативные сроки поставки под заказ (от 5 рабочих дней);
- Экспресс доставка в любую точку России;
- Техническая поддержка проекта, помощь в подборе аналогов, поставка прототипов;
- Система менеджмента качества сертифицирована по Международному стандарту ISO 9001;
- Лицензия ФСБ на осуществление работ с использованием сведений, составляющих государственную тайну;
- Поставка специализированных компонентов (Xilinx, Altera, Analog Devices, Intersil, Interpoint, Microsemi, Aeroflex, Peregrine, Syfer, Eurofarad, Texas Instrument, Miteq, Cobham, E2V, MA-COM, Hittite, Mini-Circuits, General Dynamics и др.);

Помимо этого, одним из направлений компании «ЭлектроПласт» является направление «Источники питания». Мы предлагаем Вам помощь Конструкторского отдела:

- Подбор оптимального решения, техническое обоснование при выборе компонента;
- Подбор аналогов;
- Консультации по применению компонента;
- Поставка образцов и прототипов;
- Техническая поддержка проекта;
- Защита от снятия компонента с производства.



#### Как с нами связаться

**Телефон:** 8 (812) 309 58 32 (многоканальный)

**Факс:** 8 (812) 320-02-42

**Электронная почта:** [org@eplast1.ru](mailto:org@eplast1.ru)

**Адрес:** 198099, г. Санкт-Петербург, ул. Калинина, дом 2, корпус 4, литера А.