

**ZMR Series**  
**FIXED 2.5, 3.3 AND 5 VOLT MINIATURE VOLTAGE REGULATORS**

**Description**

The ZMR series of three terminal fixed positive voltage regulators feature internal current limit and will shut down under thermal overload conditions making the devices difficult to destroy.

The circuit design offers an exceptionally low quiescent current, only 30µA for the 2.5V device, ideal for low power applications. The initial devices in the series regulate to 2.5 or 5V with a drive capability up to 50mA.

The device is designed with space saving in mind and is available in the small outline SOT23 package. The ZMR250 has expanded its input voltage range to 22.5V and the ZMR500 has expanded its input voltage range to 25V; equaling that of the ZMR25H and ZMR50H respectively.

The ZMR330 provides a 3.3V output over an input range of 5V to 24V.

**Features**

- Small outline SOT23 package
- 2.5V, 3.3V and 5V output
- Output current up to 50mA
- Very low quiescent current (30µA)
- Unconditionally stable
- Internal short circuit current limit

**Applications**

- Small outline SOT23 package
- 2.5V, 3.3V, 5V output
- Output current up to 50mA
- Very low quiescent current (30µA)
- Unconditionally stable
- Internal short circuit current limit
- "Green" molding compound (No Br, Sb)

**Pin Assignments**

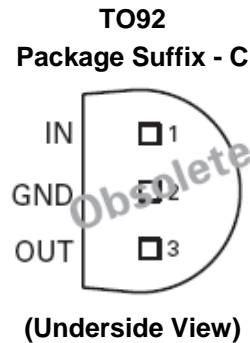
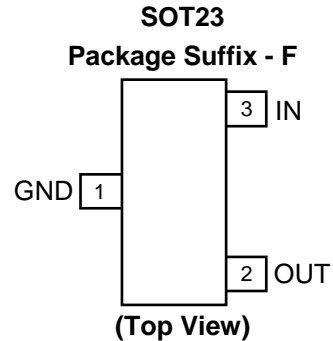

**Typical Application Circuit**

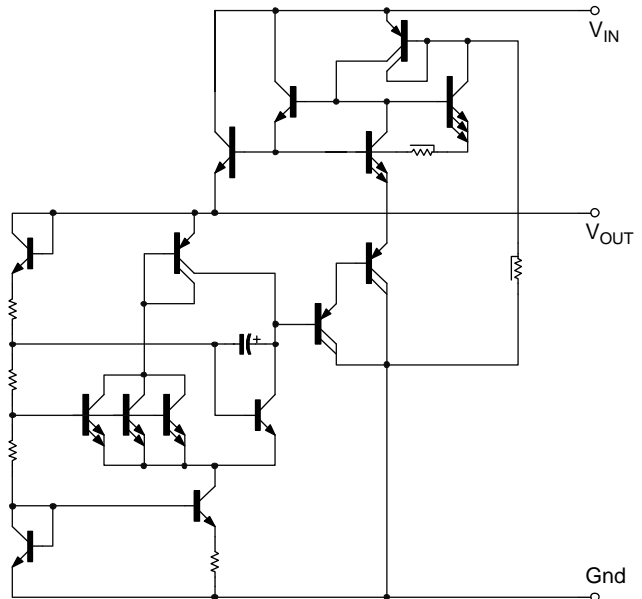

## Absolute Maximum Ratings

Parameter	Rating	Unit
Input Voltage ZMR250 ZMR330 ZMR500	22.5 24 25	V
Power Dissipation ( $T_{AMB} = 25^{\circ}\text{C}$ ) (Note 3) SOT23	500	mW
Output Current ( $I_O$ )	100	mA
Ambient Temperature	-55 to 125	$^{\circ}\text{C}$
Maximum Junction Temperature	125	$^{\circ}\text{C}$
Storage Temperature	-65 to 150	$^{\circ}\text{C}$

- Notes:
1. The maximum operating input voltage and output current of the device will be governed by the maximum power dissipation of the selected package. Maximum package power dissipation is specified at  $25^{\circ}\text{C}$  and must be linearly derated to zero at  $T_{amb} = 125^{\circ}\text{C}$ .
  2. The following data represents pulse test conditions with junction temperatures as indicated at the initiation of the test. Continuous operation of the devices with the stated conditions might exceed the power dissipation limits of the chosen package.
  3. Maximum power dissipation for the SOT23 package, is calculated assuming that the device is mounted on a ceramic substrate measuring  $15 \times 15 \times 0.6\text{mm}$ .

## Recommended Operating Conditions

Input Voltage Range	Min.	Max.	Unit
ZMR250	4.2	22.5	V
ZMR330	4.8	24	V
ZMR500	7.0	25	V

**Electrical Characteristics** (unless otherwise stated):  $T_J = 25^\circ\text{C}$ ,  $I_O = 10\text{mA}$ ,  $V_{IN} = 6.5\text{V}$

**ZMR250**

Symbol	Parameter	Condition	Min.	Typ.	Max.	Unit
$V_O$	Output voltage		2.438	2.5	2.563	V
		$I_O = 0$ to 50mA $T_J = -55$ to $125^\circ\text{C}$	2.360		2.640	V
		$V_{IN} = 4.5$ to 22.5V $I_O = 0$ to 50mA $T_J = -55$ to $125^\circ\text{C}$	2.630		2.640	V
$\Delta V_O$	Line regulation	$V_{IN} = 4.5$ to 22.5V		5	15	mV
$\Delta V_O$	Load regulation	$I_O = 0$ to 50mA $I_O = 0$ to 10mA		20 12	30	mV
$I_S$	Supply current	$T_J = -55$ to $125^\circ\text{C}$		30	40	$\mu\text{A}$
$\Delta I_S$	Supply current change	$I_O = 0$ to 50mA $V_{IN} = 4.5$ to 22.5V		1 2	$\pm 10$ 10	$\mu\text{A}$
$V_N$	Output noise voltage	$f = 10\text{Hz}$ to 10kHz		65		$\mu\text{V rms}$
$\Delta V_{IN} / V_O$	Ripple rejection	$V_{IN} = 6.3$ to 18V $f = 120\text{Hz}$	55	75		dB
$V_{IN}$	Input voltage required to maintain regulation			3.9		V
$\Delta V_O / \Delta T$	Average temperature coefficient of $V_O$	$I_O = 5.0\text{mA}$ $T_J = -55$ to $125^\circ\text{C}$		0.275	0.700	$\text{mV}/^\circ\text{C}$

**Electrical Characteristics** (unless otherwise stated):  $T_J = 25^\circ\text{C}$ ,  $I_O = 10\text{mA}$ ,  $V_{IN} = 7\text{V}$

**ZMR330**

Symbol	Parameter	Condition	Min.	Typ.	Max.	Unit
$V_O$	Output voltage		3.217	3.3	3.383	V
		$I_O = 0$ to 50mA $T_J = -55$ to $125^\circ\text{C}$	3.148		3.393	V
		$V_{IN} = 5$ to 24V $I_O = 0$ to 50mA $T_J = -55$ to $125^\circ\text{C}$	3.148		3.408	V
$\Delta V_O$	Line regulation	$V_{IN} = 5$ to 24V		5	15	mV
$\Delta V_O$	Load regulation	$I_O = 0$ to 50mA $I_O = 0$ to 10mA		20 13	30	mV
$I_S$	Supply current	$T_J = -55$ to $125^\circ\text{C}$		120	170	$\mu\text{A}$
$\Delta I_S$	Supply current change	$I_O = 0$ to 50mA $V_{IN} = 5$ to 20V		5 2	10 10	$\mu\text{A}$
$V_N$	Output noise voltage	$f = 10\text{Hz}$ to $10\text{kHz}$		80		$\mu\text{V rms}$
$\Delta V_{IN} / V_O$	Ripple rejection	$V_{IN} = 6$ to 20V $f = 120\text{Hz}$	55			dB
$V_{IN}$	Input voltage required to maintain regulation	$V_{OUT} = 3.217\text{V}$		4.74		V

**Electrical Characteristics** (unless otherwise stated):  $T_J = 25^\circ\text{C}$ ,  $I_O = 10\text{mA}$ ,  $V_{IN} = 10\text{V}$

**ZMR500**

Symbol	Parameter	Condition	Min.	Typ.	Max.	Unit
$V_O$	Output voltage		4.785	5	5.125	V
		$I_O = 0$ to 50mA $T_J = -55$ to $125^\circ\text{C}$	4.780		5.160	V
		$V_{IN} = 7$ to 25V $I_O = 0$ to 50mA $T_J = -55$ to $125^\circ\text{C}$	4.780		5.175	V
$\Delta V_O$	Line regulation	$V_{IN} = 7$ to 25V		5	15	mV
$\Delta V_O$	Load regulation	$I_O = 0$ to 50mA $I_O = 0$ to 10mA		25 15	40	mV
$I_S$	Supply current	$T_J = -55$ to $125^\circ\text{C}$		50	70	$\mu\text{A}$
$\Delta I_S$	Supply current change	$I_O = 0$ to 50mA $V_{IN} = 7$ to 25V		1 2	$\pm 10$ 10	$\mu\text{A}$
$V_N$	Output noise voltage	$f = 10\text{Hz}$ to 10kHz		90		$\mu\text{V rms}$
$\Delta V_{IN} / V_O$	Ripple rejection	$V_{IN} = 8$ to 18V $f = 120\text{Hz}$	55	72		dB
$V_{IN}$	Input voltage required to maintain regulation			6.7		V
$\Delta V_O / \Delta T$	Average temperature coefficient of $V_O$	$I_O = 5.0\text{mA}$ $T_J = -55$ to $125^\circ\text{C}$		0.275	0.700	$\text{mV}/^\circ\text{C}$

**Typical Characteristics**

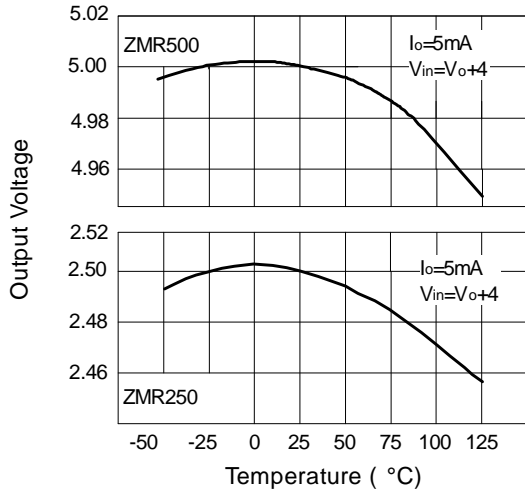

Output Voltage Temperature

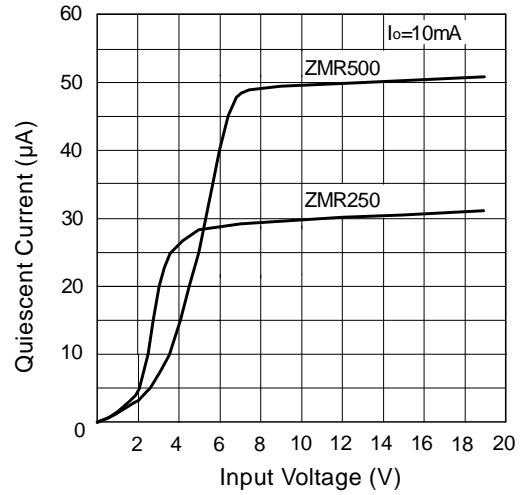

Quiescent Current v Voltage

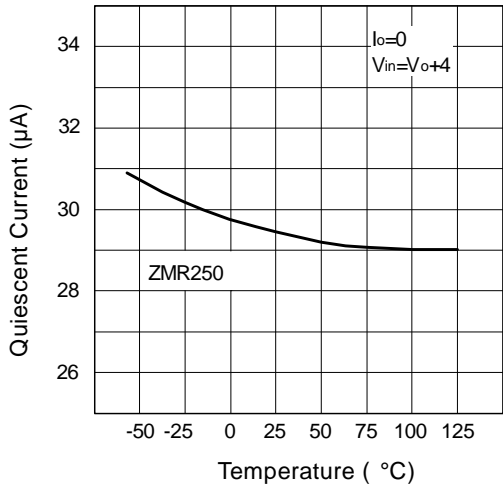

Quiescent Current v Temperature

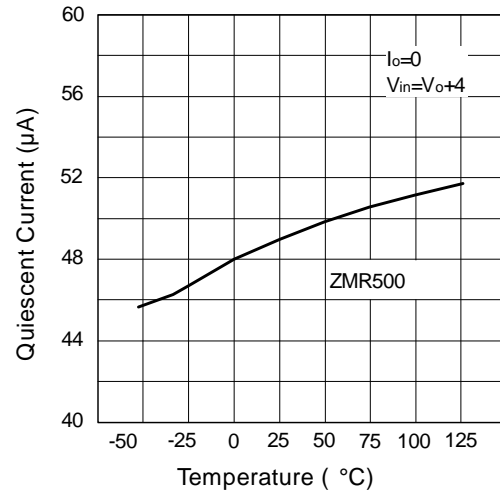

Quiescent Current v Temperature

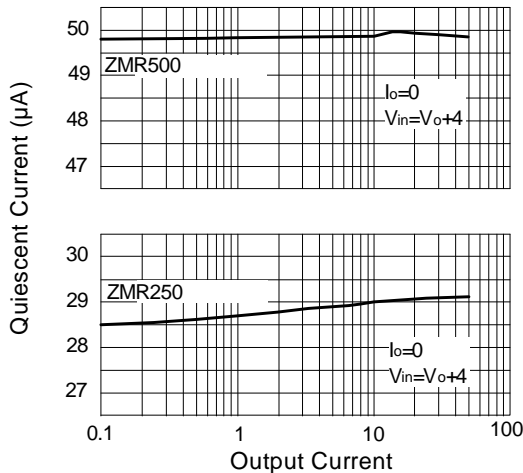

Quiescent Current v Output Current

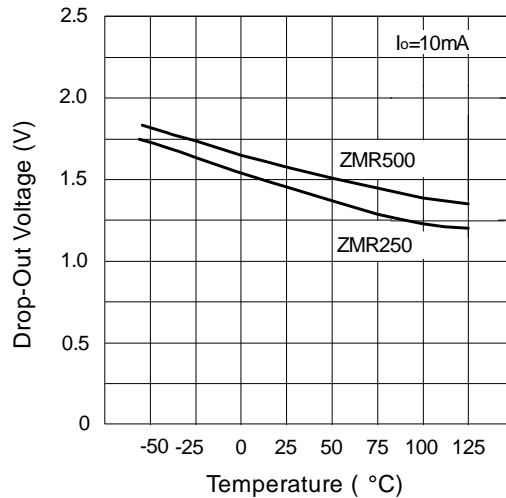

Drop-Out Voltage v Temperature

**Typical Characteristics (cont.)**

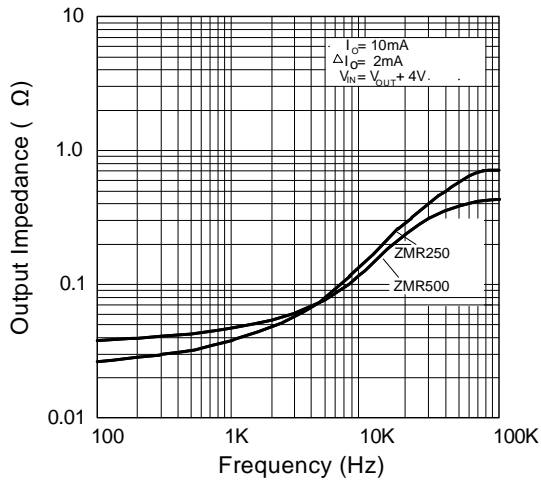

Output Impedance v Frequency

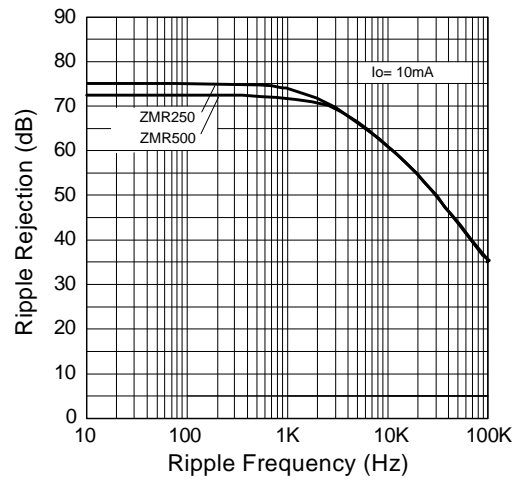

Ripple Rejection v Ripple Frequency

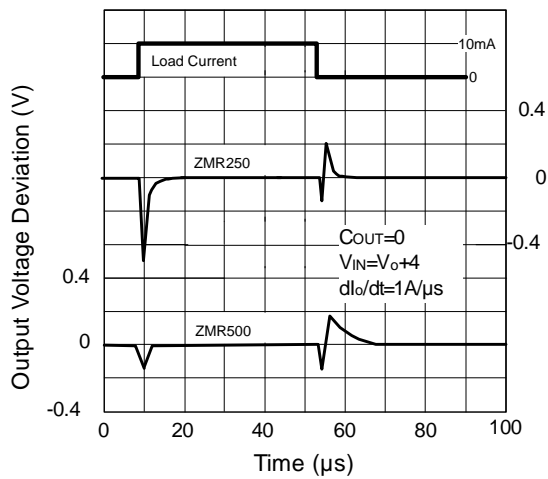

Load Transient Response

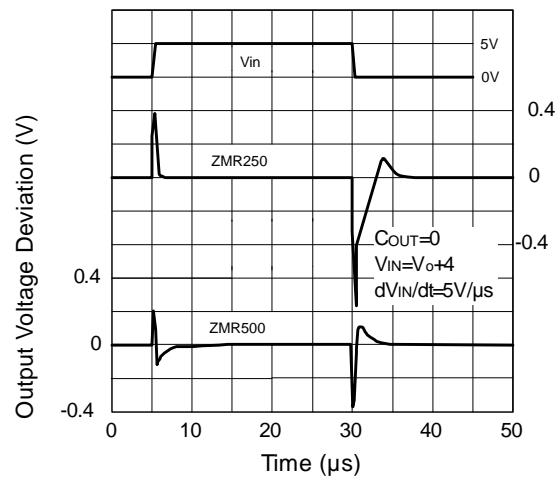

Line Transient Response

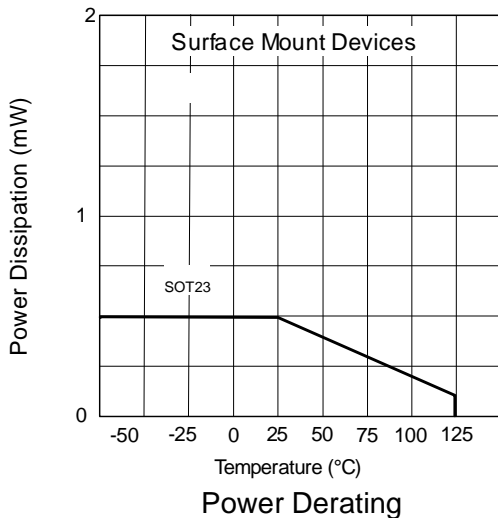

Power Derating

## Ordering Information

Part Number	Package	Part Mark	Status	Reel Size (inches)	Quantity per reel	Tape Width (mm)
ZMR25HFTA	SOT23	25X	Obsolete replaced by ZMR250FTA	7"	3000	8mm
ZMR50HFTA	SOT23	50R	Obsolete replaced by ZMR500FTA	7"	3000	8mm
ZMR250FTA	SOT23	25K	Released	7"	3000	8mm
ZMR330FTA	SOT23	330	Released	7"	3000	8mm
ZMR330F-7*	SOT23	330	Released	7"	3000	8mm
ZMT500FTA	SOT23	50K	Released	7"	3000	8mm

Notes: \*ZMR330F-7 is in Halogen free molding compound  
All TO92 variants (ZMRxxxC) are obsolete. Closest replacements are the ZMRxxxFTA.



**Package Outline Dimensions**

**SOT23**

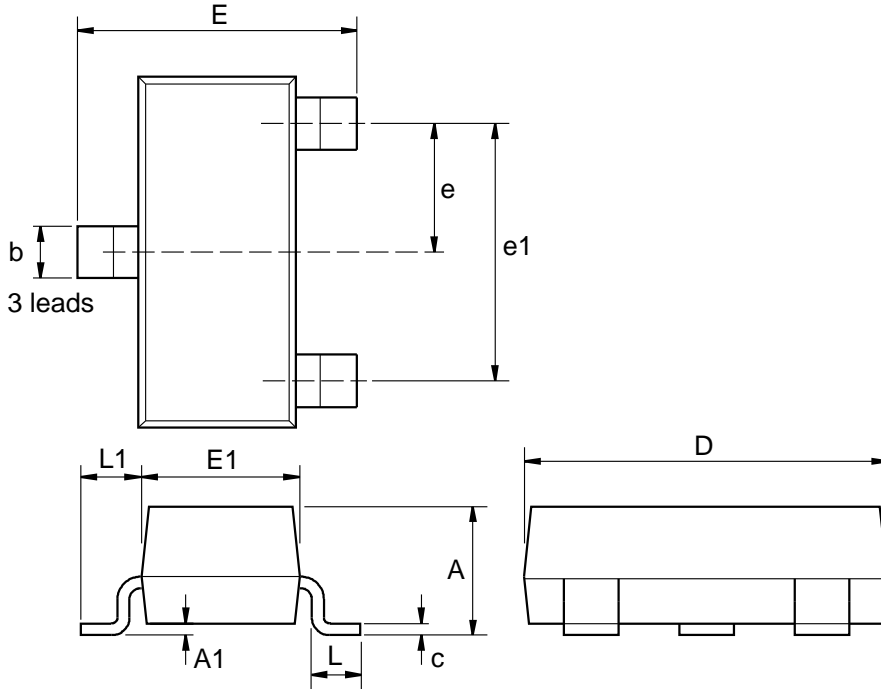

Dim.	Millimeters		Inches		Dim.	Millimeters		Inches	
	Min.	Max.	Min.	Max.		Min.	Max.	Min.	Max.
A	-	1.12	-	0.044	e1	1.90 NOM		0.075 NOM	
A1	0.01	0.10	0.0004	0.004	E	2.10	2.64	0.083	0.104
b	0.30	0.50	0.012	0.020	E1	1.20	1.40	0.047	0.055
c	0.085	0.20	0.003	0.008	L	0.25	0.60	0.0098	0.0236
D	2.80	3.04	0.110	0.120	L1	0.45	0.62	0.018	0.024
e	0.95 NOM		0.037 NOM		-	-	-	-	-

Notes: Controlling dimensions are in millimeters. Approximate dimensions are provided in inches

**Package Outline Dimensions (cont.)**

**T092**

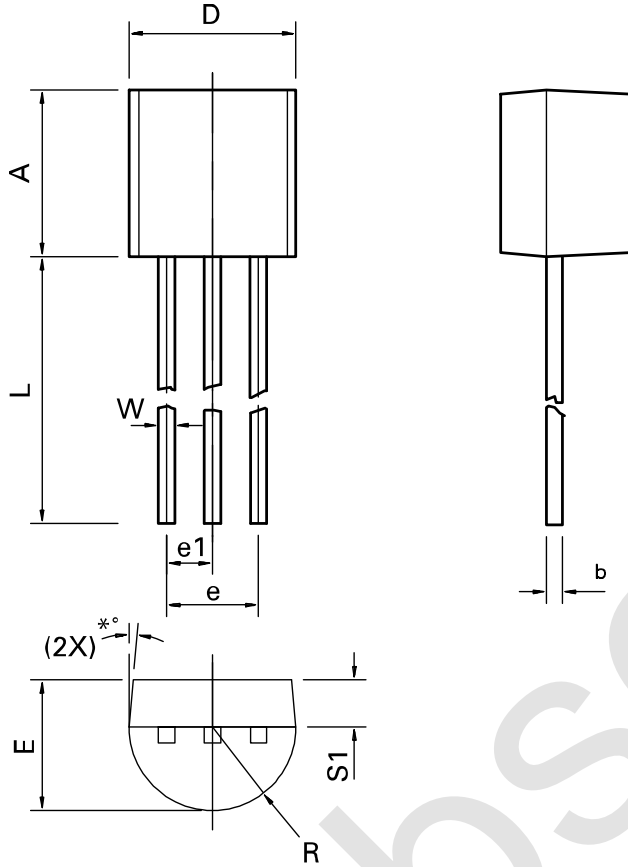

Dim.	Millimeters		Inches		Dim.	Millimeters		Inches	
	Min.	Max.	Min.	Max.		Min.	Max.	Min.	Max.
A	4.32	4.95	0.170	0.195	R	2.16	<b>2.41</b>	0.085	<b>0.095</b>
b	0.36	0.51	0.014	0.020	S1	1.14	1.52	0.045	0.060
E	3.30	3.94	0.130	0.155	W	0.41	0.56	0.016	0.022
e	2.41	2.67	0.095	0.105	D	4.45	4.95	0.175	0.195
e1	1.14	1.40	0.045	0.055	*°	4°	6°	4°	6°
L	12.70	15.49	0.500	0.610					

Notes: Controlling dimensions are in millimeters. Approximate dimensions are provided in inches

#### IMPORTANT NOTICE

DIODES INCORPORATED MAKES NO WARRANTY OF ANY KIND, EXPRESS OR IMPLIED, WITH REGARDS TO THIS DOCUMENT, INCLUDING, BUT NOT LIMITED TO, THE IMPLIED WARRANTIES OF MERCHANTABILITY AND FITNESS FOR A PARTICULAR PURPOSE (AND THEIR EQUIVALENTS UNDER THE LAWS OF ANY JURISDICTION).

Diodes Incorporated and its subsidiaries reserve the right to make modifications, enhancements, improvements, corrections or other changes without further notice to this document and any product described herein. Diodes Incorporated does not assume any liability arising out of the application or use of this document or any product described herein; neither does Diodes Incorporated convey any license under its patent or trademark rights, nor the rights of others. Any Customer or user of this document or products described herein in such applications shall assume all risks of such use and will agree to hold Diodes Incorporated and all the companies whose products are represented on Diodes Incorporated website, harmless against all damages.

Diodes Incorporated does not warrant or accept any liability whatsoever in respect of any products purchased through unauthorized sales channel.

Should Customers purchase or use Diodes Incorporated products for any unintended or unauthorized application, Customers shall indemnify and hold Diodes Incorporated and its representatives harmless against all claims, damages, expenses, and attorney fees arising out of, directly or indirectly, any claim of personal injury or death associated with such unintended or unauthorized application.

Products described herein may be covered by one or more United States, international or foreign patents pending. Product names and markings noted herein may also be covered by one or more United States, international or foreign trademarks.

#### LIFE SUPPORT

Diodes Incorporated products are specifically not authorized for use as critical components in life support devices or systems without the express written approval of the Chief Executive Officer of Diodes Incorporated. As used herein:

A. Life support devices or systems are devices or systems which:

1. are intended to implant into the body, or
2. support or sustain life and whose failure to perform when properly used in accordance with instructions for use provided in the labeling can be reasonably expected to result in significant injury to the user.

B. A critical component is any component in a life support device or system whose failure to perform can be reasonably expected to cause the failure of the life support device or to affect its safety or effectiveness.

Customers represent that they have all necessary expertise in the safety and regulatory ramifications of their life support devices or systems, and acknowledge and agree that they are solely responsible for all legal, regulatory and safety-related requirements concerning their products and any use of Diodes Incorporated products in such safety-critical, life support devices or systems, notwithstanding any devices- or systems-related information or support that may be provided by Diodes Incorporated. Further, Customers must fully indemnify Diodes Incorporated and its representatives against any damages arising out of the use of Diodes Incorporated products in such safety-critical, life support devices or systems.

Copyright © 2010, Diodes Incorporated

[www.diodes.com](http://www.diodes.com)



Компания «ЭлектроПласт» предлагает заключение долгосрочных отношений при поставках импортных электронных компонентов на взаимовыгодных условиях!

Наши преимущества:

- Оперативные поставки широкого спектра электронных компонентов отечественного и импортного производства напрямую от производителей и с крупнейших мировых складов;
- Поставка более 17-ти миллионов наименований электронных компонентов;
- Поставка сложных, дефицитных, либо снятых с производства позиций;
- Оперативные сроки поставки под заказ (от 5 рабочих дней);
- Экспресс доставка в любую точку России;
- Техническая поддержка проекта, помощь в подборе аналогов, поставка прототипов;
- Система менеджмента качества сертифицирована по Международному стандарту ISO 9001;
- Лицензия ФСБ на осуществление работ с использованием сведений, составляющих государственную тайну;
- Поставка специализированных компонентов (Xilinx, Altera, Analog Devices, Intersil, Interpoint, Microsemi, Aeroflex, Peregrine, Syfer, Eurofarad, Texas Instrument, Miteq, Cobham, E2V, MA-COM, Hittite, Mini-Circuits, General Dynamics и др.);

Помимо этого, одним из направлений компании «ЭлектроПласт» является направление «Источники питания». Мы предлагаем Вам помощь Конструкторского отдела:

- Подбор оптимального решения, техническое обоснование при выборе компонента;
- Подбор аналогов;
- Консультации по применению компонента;
- Поставка образцов и прототипов;
- Техническая поддержка проекта;
- Защита от снятия компонента с производства.



#### Как с нами связаться

**Телефон:** 8 (812) 309 58 32 (многоканальный)

**Факс:** 8 (812) 320-02-42

**Электронная почта:** [org@eplast1.ru](mailto:org@eplast1.ru)

**Адрес:** 198099, г. Санкт-Петербург, ул. Калинина, дом 2, корпус 4, литера А.