

VE Series

Features

- 3 ϕ ~ 18 ϕ , 85°C, 2,000 hours assured
- Chip type large capacitance capacitors
- Designed for surface mounting on high density PC board
- RoHS Compliance



Marking color: Black

Specifications

Items	Performance																																																														
Category Temperature Range	-40°C ~ +85°C																																																														
Capacitance Tolerance	±20% (at 120Hz, 20°C)																																																														
Leakage Current (at 20°C)	<table border="1"> <tr> <td>Rated Voltage</td> <td>6.3 ~ 100V</td> <td>160 ~ 450V</td> </tr> <tr> <td>Time</td> <td>after 2 minutes</td> <td>after 5 minutes</td> </tr> <tr> <td>Case size</td> <td>3 ~ 10 ϕ</td> <td>12.5 ~ 18 ϕ</td> <td>12.5 ~ 18 ϕ</td> </tr> <tr> <td>Leakage Current</td> <td>I = 0.01CV or 3μA, whichever is greater</td> <td>I = 0.03CV or 4μA, whichever is greater</td> <td>I = 0.04CV +100μA</td> </tr> </table> <p>Where, C = rated capacitance in μF V = rated DC working voltage in V</p>	Rated Voltage	6.3 ~ 100V	160 ~ 450V	Time	after 2 minutes	after 5 minutes	Case size	3 ~ 10 ϕ	12.5 ~ 18 ϕ	12.5 ~ 18 ϕ	Leakage Current	I = 0.01CV or 3 μ A, whichever is greater	I = 0.03CV or 4 μ A, whichever is greater	I = 0.04CV +100 μ A																																																
	Rated Voltage	6.3 ~ 100V	160 ~ 450V																																																												
	Time	after 2 minutes	after 5 minutes																																																												
	Case size	3 ~ 10 ϕ	12.5 ~ 18 ϕ	12.5 ~ 18 ϕ																																																											
Leakage Current	I = 0.01CV or 3 μ A, whichever is greater	I = 0.03CV or 4 μ A, whichever is greater	I = 0.04CV +100 μ A																																																												
Tan δ (at 120Hz, 20°C)	<table border="1"> <tr> <td>Rated Voltage</td> <td>4</td> <td>6.3</td> <td>10</td> <td>16</td> <td>25</td> <td>35</td> <td>50</td> <td>63</td> <td>100</td> <td>160 ~ 250</td> <td>400 ~ 450</td> </tr> <tr> <td>3 ~ 10 ϕ</td> <td>0.42</td> <td>0.28</td> <td>0.24</td> <td>0.20</td> <td>0.14</td> <td>0.12</td> <td>0.10</td> <td>0.10</td> <td>0.10</td> <td>-</td> <td>-</td> </tr> <tr> <td>12.5 ~ 18 ϕ</td> <td>-</td> <td>0.38</td> <td>0.34</td> <td>0.30</td> <td>0.26</td> <td>0.22</td> <td>0.18</td> <td>0.14</td> <td>0.10</td> <td>0.20</td> <td>0.25</td> </tr> </table> <p>When the capacitance exceeds 1,000μF, 0.02 shall be added every 1,000μF increase.</p>	Rated Voltage	4	6.3	10	16	25	35	50	63	100	160 ~ 250	400 ~ 450	3 ~ 10 ϕ	0.42	0.28	0.24	0.20	0.14	0.12	0.10	0.10	0.10	-	-	12.5 ~ 18 ϕ	-	0.38	0.34	0.30	0.26	0.22	0.18	0.14	0.10	0.20	0.25																										
	Rated Voltage	4	6.3	10	16	25	35	50	63	100	160 ~ 250	400 ~ 450																																																			
3 ~ 10 ϕ	0.42	0.28	0.24	0.20	0.14	0.12	0.10	0.10	0.10	-	-																																																				
12.5 ~ 18 ϕ	-	0.38	0.34	0.30	0.26	0.22	0.18	0.14	0.10	0.20	0.25																																																				
Low Temperature Characteristics (at 120Hz)	<p>Impedance ratio shall not exceed the values given in the table below.</p> <table border="1"> <tr> <td colspan="2">Rated Voltage</td> <td>4.0</td> <td>6.3</td> <td>10</td> <td>16</td> <td>25</td> <td>35</td> <td>50</td> <td>63</td> <td>100</td> <td>160 ~ 250</td> <td>400 ~ 450</td> </tr> <tr> <td rowspan="4">Impedance Ratio</td> <td>Z(-25°C)</td> <td>$\phi D < 12.5$</td> <td>7</td> <td>4</td> <td>4</td> <td>3</td> <td>2</td> <td>2</td> <td>2</td> <td>2</td> <td>-</td> <td>-</td> </tr> <tr> <td>Z(+20°C)</td> <td>$\phi D \geq 12.5$</td> <td>-</td> <td>5</td> <td>5</td> <td>4</td> <td>2</td> <td>2</td> <td>2</td> <td>2</td> <td>3</td> <td>6</td> </tr> <tr> <td>Z(-40°C)</td> <td>$\phi D < 12.5$</td> <td>15</td> <td>8</td> <td>5</td> <td>4</td> <td>3</td> <td>3</td> <td>3</td> <td>3</td> <td>-</td> <td>-</td> </tr> <tr> <td>Z(+20°C)</td> <td>$\phi D \geq 12.5$</td> <td>-</td> <td>14</td> <td>12</td> <td>10</td> <td>5</td> <td>4</td> <td>3</td> <td>3</td> <td>6</td> <td>10</td> </tr> </table>	Rated Voltage		4.0	6.3	10	16	25	35	50	63	100	160 ~ 250	400 ~ 450	Impedance Ratio	Z(-25°C)	$\phi D < 12.5$	7	4	4	3	2	2	2	2	-	-	Z(+20°C)	$\phi D \geq 12.5$	-	5	5	4	2	2	2	2	3	6	Z(-40°C)	$\phi D < 12.5$	15	8	5	4	3	3	3	3	-	-	Z(+20°C)	$\phi D \geq 12.5$	-	14	12	10	5	4	3	3	6	10
	Rated Voltage		4.0	6.3	10	16	25	35	50	63	100	160 ~ 250	400 ~ 450																																																		
	Impedance Ratio	Z(-25°C)	$\phi D < 12.5$	7	4	4	3	2	2	2	2	-	-																																																		
		Z(+20°C)	$\phi D \geq 12.5$	-	5	5	4	2	2	2	2	3	6																																																		
Z(-40°C)		$\phi D < 12.5$	15	8	5	4	3	3	3	3	-	-																																																			
Z(+20°C)		$\phi D \geq 12.5$	-	14	12	10	5	4	3	3	6	10																																																			
Endurance	<table border="1"> <tr> <td>Test Time</td> <td>2,000 Hrs</td> </tr> <tr> <td>Capacitance Change</td> <td>Within ±20% of initial value (4V: ±30%)</td> </tr> <tr> <td>Tanδ</td> <td>Less than 200% of specified value (4V: <300%)</td> </tr> <tr> <td>Leakage Current</td> <td>Within specified value</td> </tr> </table> <p>* The above specifications shall be satisfied when the capacitors are restored to 20°C after the rated voltage applied for 2,000 hours at 85°C.</p>	Test Time	2,000 Hrs	Capacitance Change	Within ±20% of initial value (4V: ±30%)	Tan δ	Less than 200% of specified value (4V: <300%)	Leakage Current	Within specified value																																																						
	Test Time	2,000 Hrs																																																													
	Capacitance Change	Within ±20% of initial value (4V: ±30%)																																																													
	Tan δ	Less than 200% of specified value (4V: <300%)																																																													
Leakage Current	Within specified value																																																														
Shelf Life Test	Test time: 1,000 hours; other items are the same as those for the Endurance. The rated voltage shall be applied to the capacitors before the measurements for 160 ~ 450V (Refer to JIS C 5101-4 4.1).																																																														
Ripple Current & Frequency Multipliers	<table border="1"> <tr> <td rowspan="2">Cap. (μF)</td> <td>Freq. (Hz)</td> <td>50</td> <td>120</td> <td>1k</td> <td>10k up</td> </tr> <tr> <td>Under 1,000</td> <td>0.80</td> <td>1.00</td> <td>1.25</td> <td>1.40</td> </tr> <tr> <td>1,000 < C ≤ 10,000</td> <td></td> <td>0.85</td> <td>1.00</td> <td>1.15</td> <td>1.25</td> </tr> </table>	Cap. (μ F)	Freq. (Hz)	50	120	1k	10k up	Under 1,000	0.80	1.00	1.25	1.40	1,000 < C ≤ 10,000		0.85	1.00	1.15	1.25																																													
Cap. (μ F)	Freq. (Hz)		50	120	1k	10k up																																																									
	Under 1,000	0.80	1.00	1.25	1.40																																																										
1,000 < C ≤ 10,000		0.85	1.00	1.15	1.25																																																										

Diagram of Dimensions

Fig. 1

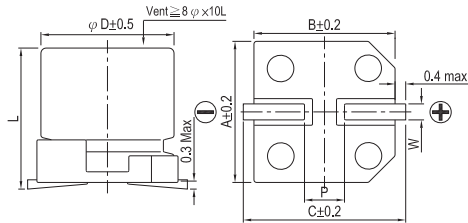
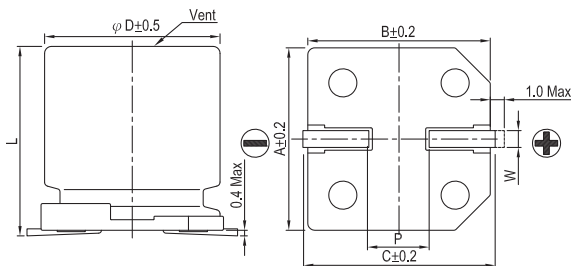

Fig. 2



Lead Spacing and Diameter

Unit: mm

ϕD	L	A	B	C	W	P ± 0.2	Fig. No.
3	5.3 ± 0.2	3.3	3.3	4.1	0.45 ~ 0.75	0.8	1
4	5.3 ± 0.2	4.3	4.3	5.1	0.5 ~ 0.8	1.0	1
5	5.3 ± 0.2	5.3	5.3	5.9	0.5 ~ 0.8	1.5	1
6.3	5.3 ± 0.2	6.6	6.6	7.2	0.5 ~ 0.8	2.0	1
6.3	7.7 ± 0.3	6.6	6.6	7.2	0.5 ~ 0.8	2.0	1
8	6.5 ± 0.3	8.4	8.4	9.0	0.5 ~ 0.8	2.3	1
8	10 ± 0.5	8.4	8.4	9.0	0.7 ~ 1.1	3.1	1
10	7.7 ± 0.3	10.4	10.4	11.0	0.7 ~ 1.3	4.7	1
10	10 ± 0.5	10.4	10.4	11.0	0.7 ~ 1.3	4.7	1
12.5	13.5 ± 0.5	13.0	13.0	13.7	1.1 ~ 1.4	4.4	2
12.5	16 ± 0.5	13.0	13.0	13.7	1.1 ~ 1.4	4.4	2
16	16.5 ± 0.5	17.0	17.0	18.0	1.1 ~ 1.4	6.4	2
16	21.5 ± 0.5	17.0	17.0	18.0	1.1 ~ 1.4	6.4	2
18	16.5 ± 0.5	19.0	19.0	20.0	1.1 ~ 1.4	6.4	2
18	21.5 ± 0.5	19.0	19.0	20.0	1.1 ~ 1.4	6.4	2

Marking

$\phi D = 3 \text{ mm}$

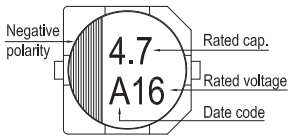

$\phi D = 4 \sim 6.3 \text{ mm}$

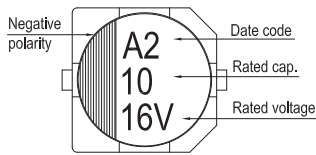

$\phi D = 8 \sim 10 \text{ mm}$

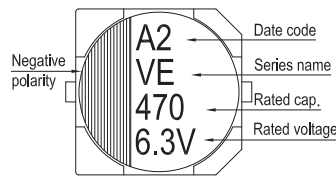

$\phi D \geq 12.5 \text{ mm}$

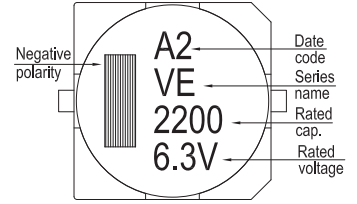

Dimension: $\phi D \times L(\text{mm})$

Ripple Current: mA/rms at 120 Hz, 85°C

Dimension & Permissible Ripple Current

V. DC μF	Contents	4V (0G)		6.3V (0J)		10V (1A)		16V (1C)		25V (1E)		35V (1V)		50V (1H)		63 (1J)	
		$\phi D \times L$	mA	$\phi D \times L$	mA	$\phi D \times L$	mA	$\phi D \times L$	mA	$\phi D \times L$	mA	$\phi D \times L$	mA	$\phi D \times L$	mA	$\phi D \times L$	mA
1	010													4×5.3	10	4×5.3	8
2.2	2R2													4×5.3	14	4×5.3	12
3.3	3R3									3×5.3	14	3×5.3	14	4×5.3	17	5×5.3	22
4.7	4R7					3×5.3	14	3×5.3	14	4×5.3	26	4×5.3	26	4×5.3	20	5×5.3	25
10	100			3×5.3	16	4×5.3	26	4×5.3	26	5×5.3	44	5×5.3	44	5×5.3	35	6.3×5.3 8×6.5	40 46
22	220	3×5.3	16	4×5.3	26	5×5.3	44	4×5.3 5×5.3	30 44	5×5.3 6.3×5.3	47 59	5×5.3 6.3×5.3	47 59	6.3×5.3 6.3×7.7	50 65	8×10	139
33	330	4×5.3	31	4×5.3	31	4×5.3 5×5.3	31 55	5×5.3	55	5×5.3 6.3×5.3	55 67	6.3×5.3 6.3×7.7	67 85	6.3×7.7 8×6.5	75 95	8×10	139
47	470	4×5.3	34	4×5.3 5×5.3	34 55	6.3×5.3	75	5×5.3 6.3×5.3	55 75	6.3×5.3 6.3×7.7	75 98	6.3×7.7 8×6.5	98 105	6.3×7.7 8×10	75 190	10×10	200
68	680	5×5.3	58	5×5.3 6.3×5.3	58 89	5×5.3 6.3×5.3	58 89	6.3×5.3	89	6.3×7.7	109	6.3×7.7	109	8×10	190	10×10	226
100	101	5×5.3 6.3×5.3	58 89	6.3×5.3	89	6.3×5.3 6.3×7.7	89 109	6.3×5.3 6.3×7.7 8×6.5	89 109 125	6.3×7.7 8×6.5	109 145	8×10	252	8×10	190	10×10	226
150	151											10×7.7	252				
220	221	6.3×5.3 6.3×7.7	89 124	6.3×5.3 6.3×7.7	89 124	6.3×7.7 8×6.5 8×10	124 175 270	6.3×7.7 8×10	124 270	8×10 10×7.7	270 270	8×10 10×10	270 370	10×10	320	12.5×13.5	500
330	331	6.3×7.7	124	6.3×7.7 8×6.5	124 190	8×10	290	8×10 10×7.7	290 290	10×10	400	10×10	400	12.5×13.5	600	12.5×16	600
470	471	8×10	290	8×10	290	10×7.7 10×10	290 400	10×10	400	10×10	400	12.5×13.5	680	12.5×16	740	16×16.5	850
680	681			10×7.7	290	10×10	410	10×10	410	12.5×13.5	680	12.5×13.5	680	16×16.5	1,000	18×16.5	1,100
1,000	102			10×10	430	10×10	430	12.5×13.5	750	12.5×13.5	750	16×16.5	1,100	18×16.5 16×21.5	1,350 1,400		
2,200	222			12.5×13.5	890	12.5×13.5	890	16×16.5	1,100	16×16.5	1,100	18×16.5 16×21.5	1,450 1,500				
3,300	332			12.5×16	1,000	16×16.5	1,300	16×16.5	1,300	18×16.5 16×21.5	1,450 1,500	18×21.5	1,750				
4,700	472			16×16.5	1,400	16×16.5	1,400	18×16.5 16×21.5	1,600 1,650	18×21.5	1,750						
6,800	682			18×16.5 16×21.5	1,700 1,750	18×16.5 16×21.5	1,700 1,750	18×21.5	2,000								
10,000	103			18×21.5	2,000	18×21.5	2,000										

V. DC μF	Contents	100V (2A)		160V (2C)		200V (2D)		250V (2E)		400V (2G)		450V (2W)	
		$\phi D \times L$	mA	$\phi D \times L$	mA	$\phi D \times L$	mA	$\phi D \times L$	mA	$\phi D \times L$	mA	$\phi D \times L$	mA
4.7	4R7									12.5×13.5	120	12.5×13.5	120
10	100	8×10	90					12.5×13.5	150	12.5×13.5	120	12.5×16	130
22	220	8×10	90			12.5×13.5	240	12.5×13.5	150	16×16.5	140	16×16.5	140
33	330	10×10	120	12.5×13.5	290	12.5×16	310	12.5×16	240	16×16.5	140	18×16.5	180
47	470	10×10	120	12.5×16	370	16×16.5	420	16×16.5	340	18×16.5	280	18×21.5	250
68	680	12.5×13.5	380	16×16.5	500	16×16.5	420	18×16.5 16×21.5	440 450	18×21.5	350		
100	101	12.5×13.5	440	18×16.5 16×21.5	650 690	18×16.5 16×21.5	550 590	18×21.5	490				
220	221	16×16.5	600										
330	331	18×16.5 16×21.5	780 850										

Part Numbering System

VE series 470 μF $\pm 20\%$ 6.3V Carrier Tape 8 $\phi \times 10L$ Pb-free and PET coating case

VE- **471** **M** **0J** **TR** - **0810**

Series name Capacitance Capacitance Tolerance Rated Voltage Package Type Terminal Type Case size Lead Wire and Coating Type

Note: For more details, please refer to "Part Numbering System (SMD Type)" on page 13.

All product specifications in the catalog are subject to change without notice. (CAT. 2016E1)

SMD



Компания «ЭлектроПласт» предлагает заключение долгосрочных отношений при поставках импортных электронных компонентов на взаимовыгодных условиях!

Наши преимущества:

- Оперативные поставки широкого спектра электронных компонентов отечественного и импортного производства напрямую от производителей и с крупнейших мировых складов;
- Поставка более 17-ти миллионов наименований электронных компонентов;
- Поставка сложных, дефицитных, либо снятых с производства позиций;
- Оперативные сроки поставки под заказ (от 5 рабочих дней);
- Экспресс доставка в любую точку России;
- Техническая поддержка проекта, помощь в подборе аналогов, поставка прототипов;
- Система менеджмента качества сертифицирована по Международному стандарту ISO 9001;
- Лицензия ФСБ на осуществление работ с использованием сведений, составляющих государственную тайну;
- Поставка специализированных компонентов (Xilinx, Altera, Analog Devices, Intersil, Interpoint, Microsemi, Aeroflex, Peregrine, Syfer, Eurofarad, Texas Instrument, Miteq, Cobham, E2V, MA-COM, Hittite, Mini-Circuits, General Dynamics и др.);

Помимо этого, одним из направлений компании «ЭлектроПласт» является направление «Источники питания». Мы предлагаем Вам помощь Конструкторского отдела:

- Подбор оптимального решения, техническое обоснование при выборе компонента;
- Подбор аналогов;
- Консультации по применению компонента;
- Поставка образцов и прототипов;
- Техническая поддержка проекта;
- Защита от снятия компонента с производства.



Как с нами связаться

Телефон: 8 (812) 309 58 32 (многоканальный)

Факс: 8 (812) 320-02-42

Электронная почта: org@eplast1.ru

Адрес: 198099, г. Санкт-Петербург, ул. Калинина, дом 2, корпус 4, литера А.