

KS-SERIES

Single output 5W ~15W
AC-DC on-board type power supply



Model name

KS 15-5

Name of series: KS
Nominal output voltage: 15
Nominal output power: 5

Features

- Compact on-board type AC-DC power supply
- Input 85 ~ 132VAC
- Wide Variation
Output power: 5W, 10W, 15W types
Output voltage: 5V, 12V, 15V types
- Over current and Over voltage protection
- 1 year warranty

Specifications

1. Input voltage range	85 ~ 132VAC(47 ~ 440Hz), 110 ~ 175VDC
2. Output voltage range	Fixed
3. Cooling	Convection cooling
4. Operating temperature (Standard mounting)	-10 ~ +70°C -10°C: 80%, 0 ~ +50°C: 100%, +60°C: 60%, +70°C: 25%
5. Withstand voltage	Input-output, input-FG: 2kVAC, output-FG: 500VAC for 1 min.
6. Safety standard	Approved by UL1950, CSA950 (KS10: Approved by CSA234)
7. EMI	Conforms to FCC class B and VCCI-class A
8. Functions	Over voltage protection (Zener diode clamp), Over current protection

Product lineup

Model	Type	Output voltage	Output current	Output power	UL	CSA
KS5	KS5-5	5V	1.0A	5.0W	○	○
	KS5-12	12V	0.45A	5.4W	○	○
KS10	KS10-5	5V	2.0A	10.0W	○	○
	KS10-12	12V	0.9A	10.8W	○	○
KS15	KS15-5	5V	3.0A	15.0W	○	○
	KS15-12	12V	1.3A	15.6W	○	○

● Request customer specification for further details of specifications, outline, characteristics, etc.
Read the instruction manual before usage.

○ : Safety standard approved

● Contact us about delivery before ordering.

Outline drawing

KS5

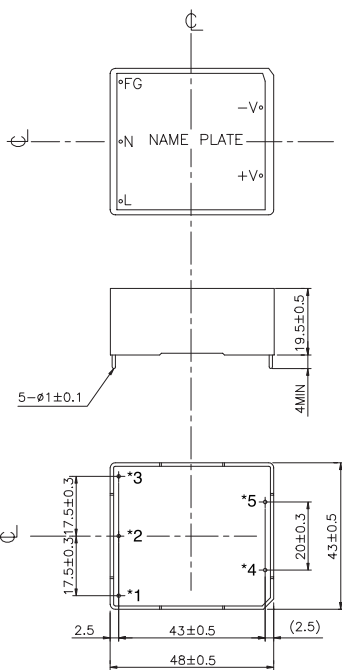

KS10

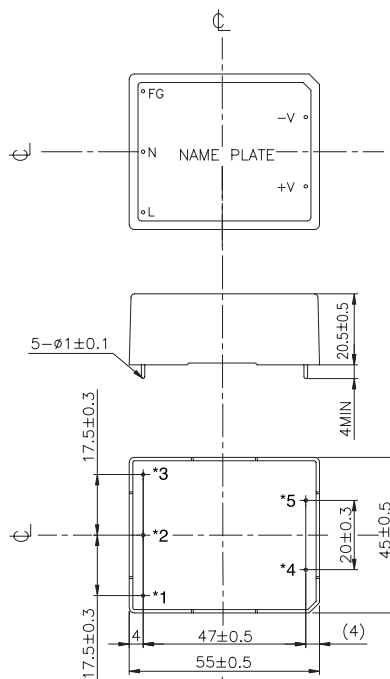

KS15

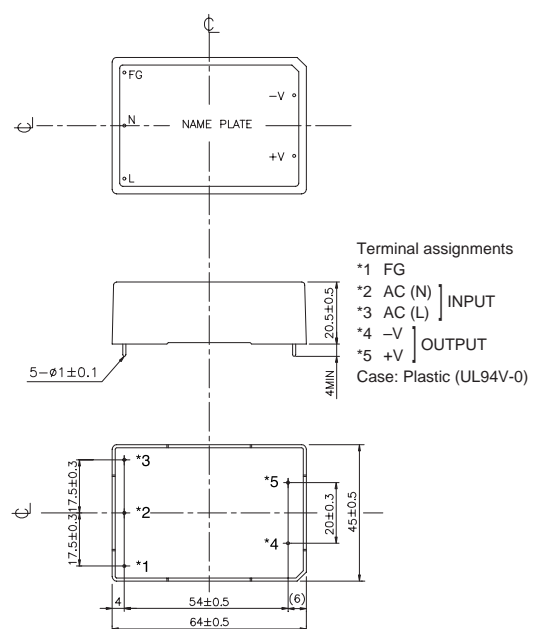

Terminal assignments
*1 FG
*2 AC (N)] INPUT
*3 AC (L)]
*4 -V] OUTPUT
*5 +V]
Case: Plastic (UL94V-0)

(Unit: mm)

KWS-SERIES

Single output 5W ~15W
AC-DC on-board type power supply

LAMBDA
DENSEI-LAMBDA



Model name

KWS 5-5

Name of series: KWS
Nominal output voltage: 5
Nominal output power: 5

Features

- CE marking (Low Voltage Directive)
- Compact on-board type AC-DC power
Input 85 ~ 265VAC universal input
- Wide Variation
Output power: 5W, 10W, 15W types
Output voltage: 5V, 12V, 15V types
- Over current and Over voltage protection
- 1 year warranty

Specifications

1. Input voltage range	85 ~ 265VAC(47 ~ 440Hz), 110 ~ 340VDC
2. Output voltage range	Fixed
3. Cooling	Convection cooling
4. Operating temperature (Standard mounting)	-10 ~ +70°C -10°C: 80%, 0 ~ +50°C: 100%, +60°C: 60%, +70°C: 25%
5. Withstand voltage	Input-output: 3kVAC, Input-FG: 2kVAC, Output-FG: 500VAC for 1 min.
6. Safety standard	Approved by UL1950, CSA950 (KWS5: Approved by CSA234) and EN60950(TÜV)
7. EMI	Conforms to FCC class B and VCCI-class A
8. Functions	Over voltage protection (Zener diode clamp), Over current protection

Product lineup

Model	Type	Output voltage	Output current	Output power	UL	CSA	EN
KWS5	KWS5-5	5V	1.0A	5.0W	○	○	○
	KWS5-12	12V	0.45A	5.4W	○	○	○
	KWS5-15	15V	0.35A	5.25W	○	○	○
KWS10	KWS10-5	5V	2.0A	10.0W	○	○	○
	KWS10-12	12V	0.9A	10.8W	○	○	○
	KWS10-15	15V	0.7A	10.5W	○	○	○
KWS15	KWS15-5	5V	3.0A	15.0W	○	○	○
	KWS15-12	12V	1.3A	15.6W	○	○	○
	KWS15-15	15V	1.0A	15.0W	○	○	○

- Request customer specification for further details of specifications, outline, characteristics, etc.
Read the instruction manual before usage.
- Contact us about delivery before ordering.

○ : Safety standard approved

Outline drawing

KWS5

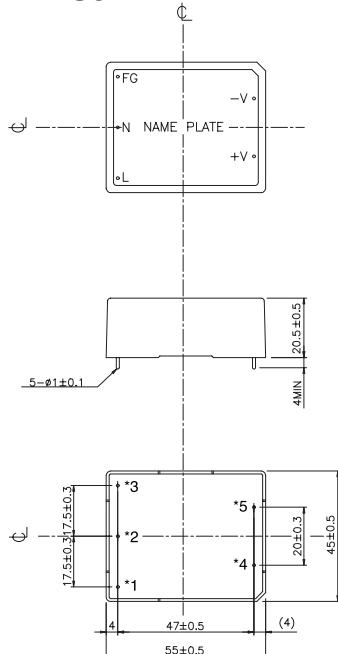

KWS10

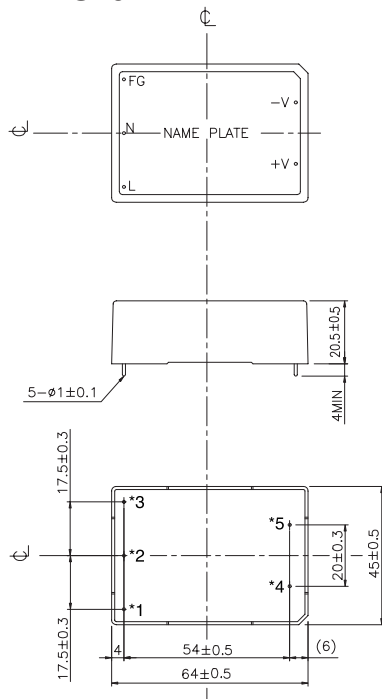

KWS15

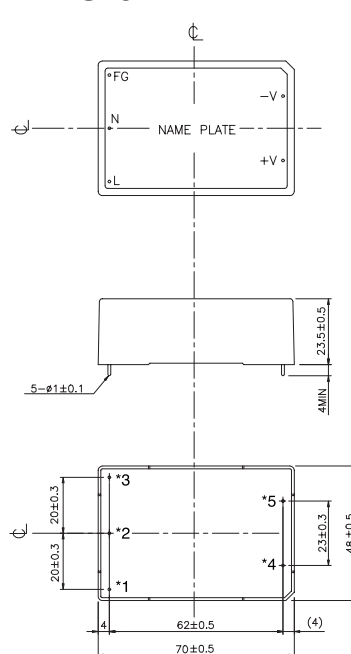

Terminal assignments

- *1 FG
 - *2 AC (N)
 - *3 AC (L)] INPUT
 - *4 -V] OUTPUT
 - *5 +V
- Case: Plastic (UL94V-0)

(Unit: mm)

KWD-SERIES

Dual output 5W ~15W
AC-DC on-board type power supply

LAMBDA
DENSEI-LAMBDA



CE (Low Voltage Directive)

1 year warranty



Model name KWD 15-1515

Name of series Nominal output power Nominal output voltage
1212: ±12V
1515: ±15V

Features

- CE marking (Low Voltage Directive)
- Compact on-board type AC-DC power
Input 85 ~ 265VAC universal input
- Wide Variation
Output power: 5W, 10W, 15W types
Output voltage: ±12V, ±15V types
- Over current and Over voltage protection
- 1 year warranty

Specifications

1. Input voltage range	85 ~ 265VAC(47 ~ 440Hz), 110 ~ 340VDC
2. Output voltage range	Fixed
3. Cooling	Convection cooling
4. Operating temperature (Standard mounting)	-10 ~ +70°C -10°C: 80%, 0 ~ +50°C: 100%, +60°C: 60%, +70°C: 25%
5. Withstand voltage	Input-output: 3kVA, Input-FG: 2kVAC, Output-FG: 500VAC for 1 min.
6. Safety standard	Approved by UL1950  , CSA950  (KWD5: Approved by CSA234 )
7. EMI	Conforms to FCC class B and VCCI-class B
8. Functions	Over voltage protection (CH2 only: Zener diode clamp), Over current protection

Product lineup

Model name		CH	Output voltage	Output current	Output power	UL	CSA	EN
KWD5	KWD5-1212	1	+12V	0.22A	5.3W	○	○	○
		2	-12V	0.22A				
	KWD5-1515	1	+15V	0.18A	5.4W	○	○	○
		2	-15V	0.18A				
KWD10	KWD10-1212	1	+12V	0.45A	10.6W	○	○	○
		2	-12V	0.45A				
	KWD10-1515	1	+15V	0.36A	10.8W	○	○	○
		2	-15V	0.36A				
KWD15	KWD15-1212	1	+12V	0.65A	15.6W	○	○	○
		2	-12V	0.65A				
	KWD15-1515	1	+15V	0.52A	15.6W	○	○	○
		2	-15V	0.52A				

- Request customer specification for further details of specifications, outline, characteristics, etc.
Read the instruction manual before usage.
- Contact us about delivery before ordering.

○ : Safety standard approved

Outline drawing

KWD5

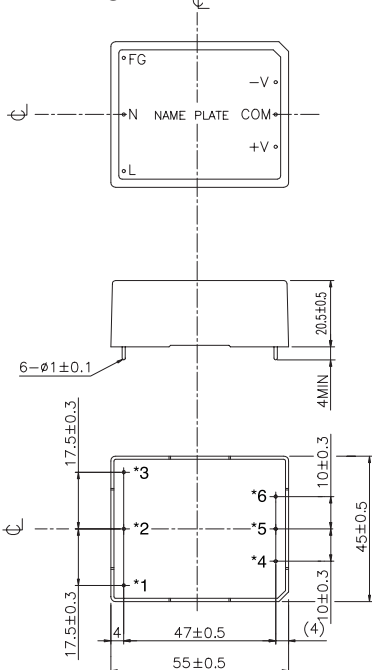

KWD10

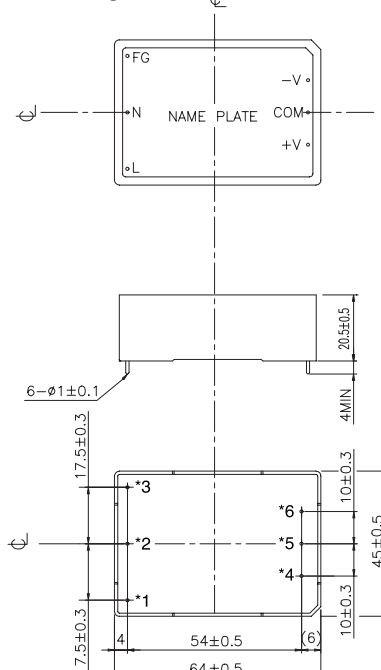

KWD15

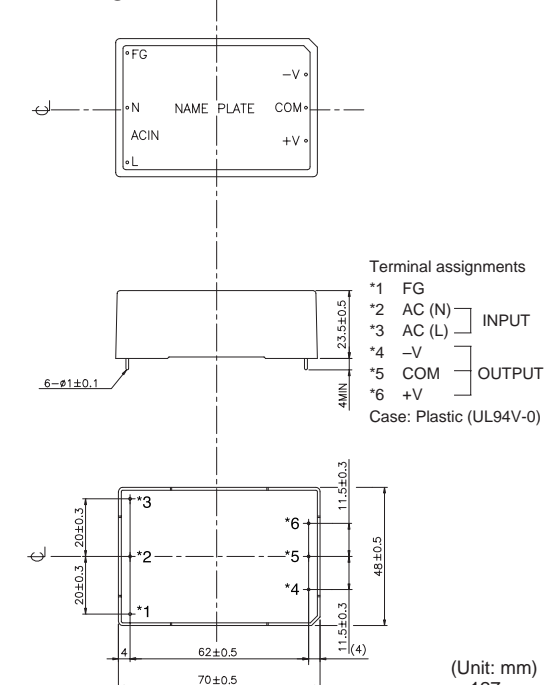

Terminal assignments
*1 FG
*2 AC (N)
*3 AC (L) } INPUT
*4 -V
*5 COM } OUTPUT
*6 +V
Case: Plastic (UL94V-0)

(Unit: mm)
127

Mouser Electronics

Authorized Distributor

Click to View Pricing, Inventory, Delivery & Lifecycle Information:

TDK-Lambda:

[KS10-5](#) [KS15-12](#) [KS5-12](#) [KS5-5](#) [KWD10-1212](#) [KWD10-1515](#) [KWD15-1212](#) [KWD5-1212](#) [KWD5-1515](#) [KWS10-12](#)
[KWS15-12](#) [KWS15-15](#) [KWS15-5](#) [KWS5-12](#) [KWS5-15](#) [KWS10-5](#) [KWS10-15](#) [KWD15-1515](#) [KS15-5](#) [KS10-12](#)
[KWS5-5](#)



Компания «ЭлектроПласт» предлагает заключение долгосрочных отношений при поставках импортных электронных компонентов на взаимовыгодных условиях!

Наши преимущества:

- Оперативные поставки широкого спектра электронных компонентов отечественного и импортного производства напрямую от производителей и с крупнейших мировых складов;
- Поставка более 17-ти миллионов наименований электронных компонентов;
- Поставка сложных, дефицитных, либо снятых с производства позиций;
- Оперативные сроки поставки под заказ (от 5 рабочих дней);
- Экспресс доставка в любую точку России;
- Техническая поддержка проекта, помощь в подборе аналогов, поставка прототипов;
- Система менеджмента качества сертифицирована по Международному стандарту ISO 9001;
- Лицензия ФСБ на осуществление работ с использованием сведений, составляющих государственную тайну;
- Поставка специализированных компонентов (Xilinx, Altera, Analog Devices, Intersil, Interpoint, Microsemi, Aeroflex, Peregrine, Syfer, Eurofarad, Texas Instrument, Miteq, Cobham, E2V, MA-COM, Hittite, Mini-Circuits, General Dynamics и др.);

Помимо этого, одним из направлений компании «ЭлектроПласт» является направление «Источники питания». Мы предлагаем Вам помощь Конструкторского отдела:

- Подбор оптимального решения, техническое обоснование при выборе компонента;
- Подбор аналогов;
- Консультации по применению компонента;
- Поставка образцов и прототипов;
- Техническая поддержка проекта;
- Защита от снятия компонента с производства.



Как с нами связаться

Телефон: 8 (812) 309 58 32 (многоканальный)

Факс: 8 (812) 320-02-42

Электронная почта: org@eplast1.ru

Адрес: 198099, г. Санкт-Петербург, ул. Калинина, дом 2, корпус 4, литера А.