

DRAWING MADE IN THIRD ANGLE PROJECTION

1855004 1855004

REV/KSR/ep/UFtb

PART NUMBER	REV	FIRST USED	TERMINATOR	FEED TYPE	DESCRIPTION
9-1855004-2	A	-	BENCH	MECH PRE FEED 40mm	CUTS CARRIER
9-1855004-3	A	-	BENCH	MECH PRE FEED 30mm	CUTS CARRIER
9-1855004-5	A	-	LEADMAKER	MECH POST FEED	CUTS CARRIER
9-1855004-6	A	-	LEADMAKER	MECH POST FEED	CONTINUOUS CARRIER
7-1855004-2	A	-	-	-	SPARE PARTS KIT
7-1855004-5	A	-	-	-	SPARE PARTS & SHEAR HOLDER (CUT)
7-1855004-6	A	-	-	-	SPARE PARTS & SHEAR HOLDER (NO-CUT)

TERMINAL NAME: RECEPTACLE PLUS		GROTE & HARTMANN TERMINAL, 6 & H CRIMP SPECS		
TYCO TERM PN 1572673	REF SETTING	* CRIMP HEIGHT		WIRE SIZE
GROTE & HARTMANN 25710.213.009	C1	1.60 ±0.05mm [0.063 ±.002]		1.5mm ²
		NOT		USED
		NOT		USED
		NOT		USED

TYCO SEAL PN	CRIMP	SIZE	TYPE	RANGE
1572675	WIRE	2.75mm [1.10]	F	1.5mm ²
	INSUL	6.60mm [2.60]	0	2.41mm MAX

WIRE STRIP LENGTH	TERM APPL SPEC	FEED	APPL INSTRUCTION	SET UP GAGE	LAYOUT
6.10mm-6.60mm	NONE	20.04mm	408-8040 & 408-B490	458637-1	L3090

QTY REQD PER ASSY	QTY REQD PER ASSY	PART NO	DESCRIPTION	ITEM NO	
				129	
				128	
				127	
				126	
				125	
		217238-1	GENERAL INSTRUCTION PACKAGE	124	
		4088040	APPL INST 408-8040	123	
		4088490	APPL INST 408-8490	122	
				121	
		1-21030-1	PIN, DOWEL (Ø.187x.50) LEVER	120	
		1-21030-6	PIN, DOWEL (Ø.187x.25) HOUSING	119	
		21045-3	RING, RET "C" (Ø.187) FD FING PIN	118	
		21024-5	WASHER, LOCK (Ø.10) ADJ BLOCK	117	
		21024-5	WASHER, LOCK (Ø.10) ADJ PLATE	116	
		21024-5	WASHER, LOCK (Ø.10) FEED GDE ROD	115	
				114	
		5-21028-1	PIN, SLT SPR (Ø.125x.50) ADJ ROD	113	
				112	
		21024-4	WASHER, LOCK (Ø.8) STRIPPER	111	
		21899-4	WASHER, FLAT (Ø5/16) SCREW ADJ	110	
				109	
		21018-5	NUT, HEX (NO. 6) HOLDDOWN	108	
		21068-5	NUT, HEX (6-32) FEED ADJ	107	
				106	
				105	
				104	
		21009-2	SCR, SKT SET (1/4-20x.25 LW) RAM	103	
		21017-2	SCR, DRIVE (Ø.2x.19) ID PLATE	102	
		6-23715-5	SCR, PAN HD (6-32x1.50) FEED ADJ	101	
		461264-5	PLATE, IDENTIFICATION	100	
				99	
		22733-8	SCR, BHC (8-32x.38 LH) ANVIL	98	
		2-21002-9	SCR, BHC (10-32x.75) CAP	97	
		2-22733-8	SCR, BHC (1/4-20x.62) HOUSING	96	
		2-21002-7	SCR, BHC (10-32x.50) SG ADJ BLOCK	95	
		2-21002-2	SCR, BHC (8-32x.50) TERM H DWN	94	
		2-21002-4	SCR, BHC (8-32x.75) RRR STRP GDE	93	
		1-21003-9	SCR, FHC (6-32x.38) DEP	92	
		1-21002-7	SCR, BHC (6-32x.38) CAM	91	
		2-23147-2	SPRING, DEPRESSOR	90	
				89	
				88	
		2-21000-7	SCR, SHC (8-32x.50) HOLD DWN	87	
		2-22603-0	SCR, HEX HD (8-32x.25) FEED FINGER	86	
				85	
		2-21000-7	SCR, SHC (8-32x.50) STRIPPER	84	
		3-21000-7	SCR, SHC (10-32x.75) FEED ROD GD	83	
		3-21000-6	SCR, SHC (10-32x.62) FD ADJ BLK	82	
		3-21000-4	SCR, SHC (10-32x.38) SG ADJ BL	81	
		3-21000-4	SCR, SHC (10-32x.38) PIVOT BLK	80	
		REF	455749-1	GUARD, WINDOW	79
		REF	679532-1	INSERT, GUARD	78
				77	
				76	
				75	
				74	
				73	
				72	
		458108-1	WASHER, SPECIAL	71	
		690517-1	SPACER	70	

QTY REQD PER ASSY	QTY REQD PER ASSY	PART NO	DESCRIPTION	ITEM NO							
-76	-75	-72	-96	-95	-93	-92	U/H	DWG SIZE	PART NO	DESCRIPTION	ITEM NO
QTY REQD PER ASSY QTY REQD PER ASSY											
PARTS LIST											

												22594-8	NUT, HEX (1/2-20)	70
												240628-1	PLATE, ADJUSTMENT	69
												240626-1	SHAFT, PIVOT	68
												240633-1	BUSHING	67
												45580-1	LEVER, INTERMEDIATE	66
												240629-1	BLOCK, PIVOT	65
												240632-2	SCREW, ADJ FEED ROD	64
												240659-3	PIN, CAM ROLLER	63
												240658-1	ROLLER, CAM	62
												454398-2	ROD, FEED	61
												454178-1	GUIDE, FEED ROD	60
												454220-1	CAP, RAM	59
												454485-1	HOUSING	58
														57
												458537-2	PAWL, FEED	56
												240624-1	PIN, FEED FINGER	55
												691499-1	SPRING, FEED FINGER	54
												690541-1	HOLDER, FEED FINGER	53
												455679-1	LEVER, TERMINAL FEED ARM	52
												811242-2	BUMPER, HOLDDOWN	51
												690753-1	SPACER, TONKER	50
												690602-6	CAM, PRE-FEED 1 5/8 ST	49
												690602-5	CAM, PRE-FEED 1 1/8 ST	48
												690501-4	CAM, POST-FEED 1 5/8 ST	47
												459456-1	APPLICATOR, BASIC (SUBASSY)	46
												690191-1	PLUG, NYLON	45
												455673-1	RAM	44
														43
														42
												690686-1	BOLT, CRIMPER (5/16x1.00)	41
														40
												690125-1	SHIM SUBASSY	39
												469367-9	SPACER, FINE ADJUST	38
												879103-3	FINE ADJUST HEAD SUBASSY	37
														36
														35
												690786-6	SUPPORT, TERMINAL	34
												318055-4	PLATE, BASE	33
														32
														31
												455689-1	BLOCK, STRIP GUIDE ADJ	30
												1633091-7	STRIP GUIDE ASSY	29
												455888-7	SPACER, FRONT SHEAR DEP	28
														27
														26
														25
														24
												1320928-3	PLATE, STRIP GUIDE (REAR)	23
														22
												690472-2	STRIPPER	21
												4-22284-9	SPRING, FEED RETURN	20
												690472-1	STRIPPER WIRE STOP ASSY	19
														18
												1320908-3	SPACER, STRIP GUIDE	17
												679625-2	HOLDER, SHEAR, FRONT (NO-CUT)	16
												318563-1	GUARD, CHIP, FRONT	15
														14
														13
												4-22280-8	SPRING, SHEAR	12
												690461-1	SCR, BHC (6-32x.38) SHEAR STOP	11
												2-690459-2	HOLDER, SHEAR, FRONT (CUT)	10
												318059-4	SHEAR, FLOAT (FRONT)	9
												2-318088-8	ANVIL	8
														7
														6
														5
												122399-4	DEPRESSOR, SHEAR (FRONT)	4
												2-238011-1	SPACER, BLOCK CRIMPER	3
												1-1583690-2	CRIMPER, INSULATION	2
												1-455888-8	SPACER, CRIMPER	1
												3-456408-3	CRIMPER, WIRE	1

QTY REQD PER ASSY	QTY REQD PER ASSY	PART NO	DESCRIPTION	ITEM NO							
-76	-75	-72	-96	-95	-93	-92	U/H	DWG SIZE	PART NO	DESCRIPTION	ITEM NO
QTY REQD PER ASSY QTY REQD PER ASSY											
PARTS LIST											

THIS DRAWING IS A CONTROLLED DOCUMENT.

THIS DRAWING IS UNCLASSIFIED DATE 03/04/00 BY 60313/UC/JEL/STW

- ▲ RECOMMENDED SPARE PARTS.
▲ GREASE LIGHTLY.
3 GUARD MUST BE IN PLACE WHEN OPERATING APPLICATOR IN A BENCH MACHINE.
▲ LUBRICATE DAILY USING NO. 20 MACHINE OIL.
S. ITEMS WITH QTY OF REF SPECIFIED (EXCEPT ITEMS 78 AND 79) ARE USED ON ITEM 46.
▲ THIS APPLICATOR APPLIES TERMINAL WITH A SEAL.
▲ APPLY TORQ-SEAL IN ALLEN SOCKET TO FILL HOLE AFTER FLAT HD HAS BEEN ADJUSTED TO CORRECT HEIGHT AT QUALIFICATION. APPLY PN 1-23419-5 LOC-TITE TO THREADS.

* WARNING: ON INSTALLATION, SET WIRE DISC TO LARGEST WIRE SIZE SETTING. USE OF SETTINGS BELOW MIN REQUIRED CRIMP HEIGHT SETTING WILL CAUSE DAMAGE TO CRIMP TOOLING.

APPROVED: [Signature]
DATE: [Date]
BY: [Name]

DIMENSIONS IN INCHES. DO NOT SCALE PRINT. TOLERANCES UNLESS OTHERWISE SPECIFIED:
2 PLC DEC ±
3 PLC DEC ±
4 PLC DEC ±
ANGLES ±
SURF TEXTURE: 7

REMOVE BURRS, SHARP EDGES 0.015 MAX

SCALE: [Scale]
SHEET 1 OF 2
REV [Rev]
RESISTED TO [Rev]

SIDE FEED HDM APPLICATOR
1855004
CUSTOMER AND ASSEMBLY DRAWING

THIS DRAWING IS A CONTROLLED DOCUMENT.

THIS DRAWING IS UNCLASSIFIED
DATE 05/13/2013 BY 60322 UCBAW/SJS/STP/STP

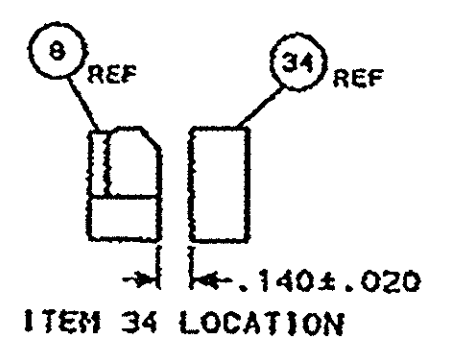
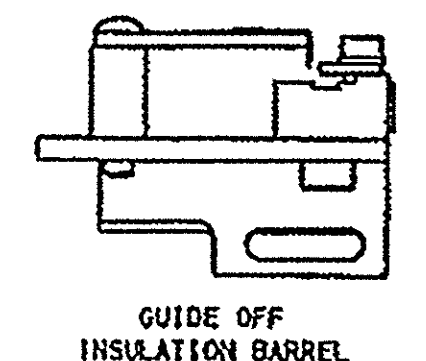
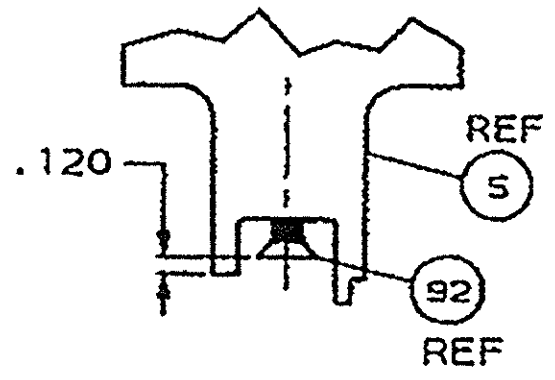
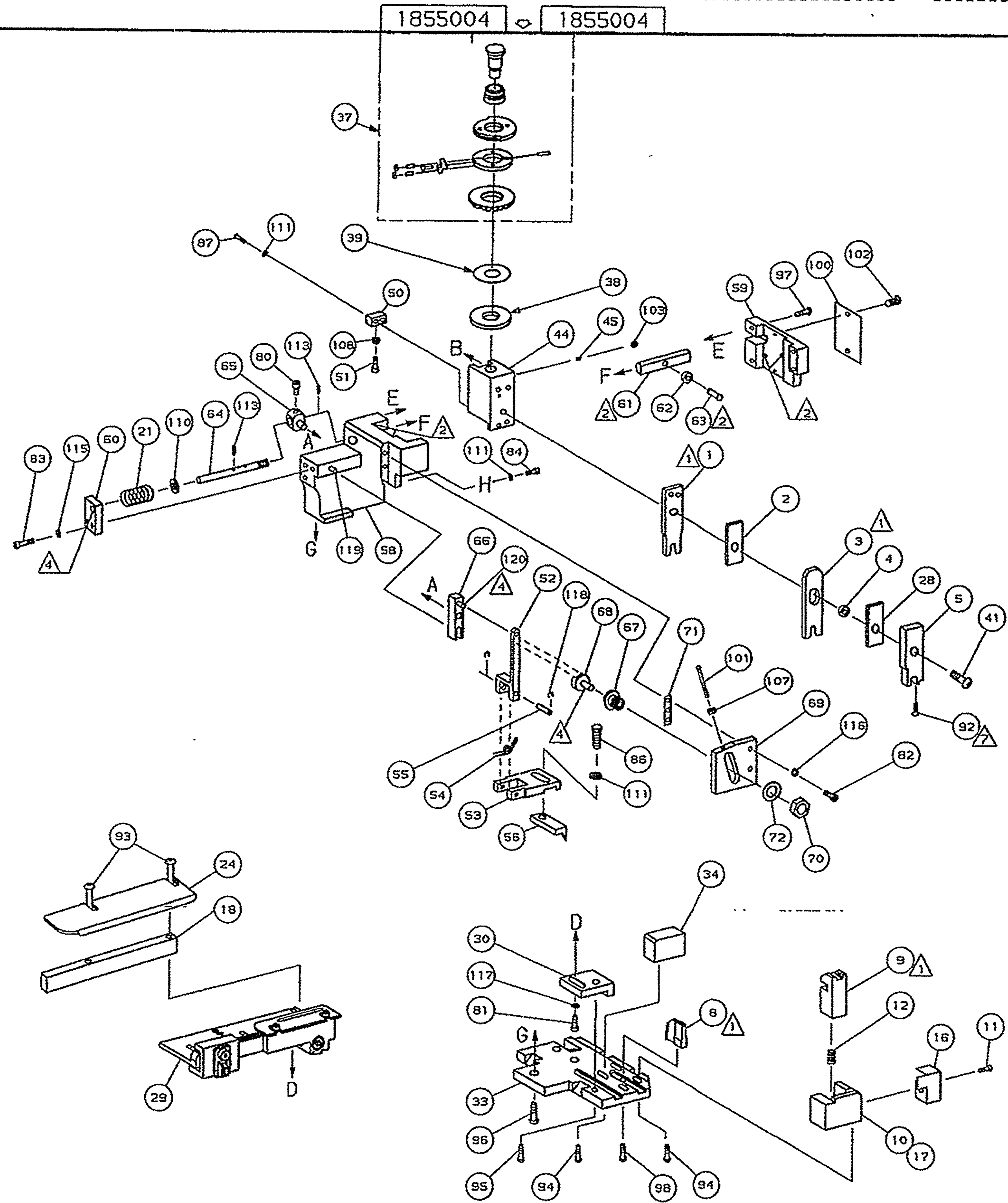

<p>POST FEED 1/8 STROKE</p> <p>44 (REF) 47 91</p> <p>ROTATED 180°</p>	<p>PRE FEED 1/8 STROKE</p> <p>44 (REF) 48 91</p> <p>ROTATED 180°</p>	<p>PRE FEED 5/8 STROKE</p> <p>44 (REF) 49 91</p> <p>ROTATED 180°</p>
---	--	--

<p>22</p> <p>LEADMAKER</p>	<p>20</p> <p>BENCH MACHINE</p>
----------------------------	--------------------------------

21-KVR-05 13/05/48 us018246 7

REV	DATE	BY	CHKD	APP

DWG SIZE	PART NO	DESCRIPTION	ITEM NO
QTY REQD PER ASSY			
PARTS LIST			
MATL	HT TR	FIN	
DIMENSIONS IN INCHES, DO NOT SCALE PRINT. TOLERANCES UNLESS OTHERWISE SPECIFIED.		AMP Type Electronics Harrisburg, PA 17105-3608	
2 PLC DEC ±	3 PLC DEC ±	4 PLC DEC ±	ANGLES ±
REMOVE BURRS, BREAK SHARP EDGES R.015 MAX			
SCALE	DWG NO	1855004	SHEET 2 of 2
CUSTOMER AND ASSEMBLY DRAWING			



Компания «ЭлектроПласт» предлагает заключение долгосрочных отношений при поставках импортных электронных компонентов на взаимовыгодных условиях!

Наши преимущества:

- Оперативные поставки широкого спектра электронных компонентов отечественного и импортного производства напрямую от производителей и с крупнейших мировых складов;
- Поставка более 17-ти миллионов наименований электронных компонентов;
- Поставка сложных, дефицитных, либо снятых с производства позиций;
- Оперативные сроки поставки под заказ (от 5 рабочих дней);
- Экспресс доставка в любую точку России;
- Техническая поддержка проекта, помощь в подборе аналогов, поставка прототипов;
- Система менеджмента качества сертифицирована по Международному стандарту ISO 9001;
- Лицензия ФСБ на осуществление работ с использованием сведений, составляющих государственную тайну;
- Поставка специализированных компонентов (Xilinx, Altera, Analog Devices, Intersil, Interpoint, Microsemi, Aeroflex, Peregrine, Syfer, Eurofarad, Texas Instrument, Miteq, Cobham, E2V, MA-COM, Hittite, Mini-Circuits, General Dynamics и др.);

Помимо этого, одним из направлений компании «ЭлектроПласт» является направление «Источники питания». Мы предлагаем Вам помощь Конструкторского отдела:

- Подбор оптимального решения, техническое обоснование при выборе компонента;
- Подбор аналогов;
- Консультации по применению компонента;
- Поставка образцов и прототипов;
- Техническая поддержка проекта;
- Защита от снятия компонента с производства.



Как с нами связаться

Телефон: 8 (812) 309 58 32 (многоканальный)

Факс: 8 (812) 320-02-42

Электронная почта: org@eplast1.ru

Адрес: 198099, г. Санкт-Петербург, ул. Калинина, дом 2, корпус 4, литера А.