

| CONNECTOR P1 DESCRIPTION/ PART NO | CONNECTOR P2 DESCRIPTION/ PART NO | CABLE GROUPS; WRENCH CRIMP, (TDDL CRIMP) | | | | | | | | CKT CODE |
|---|---|--|----------|-------------|-----------------------|------------|------------|--------|--------|-------------|
| | | 1(011) | 2(013A) | 2(013/013B) | 3(012) | 1(011) | 2(013) | 1(012) | 2(011) | |
| | | TCC-50-2 | TCC-75-2 | RG62 | M17/167-00001 (RG223) | RG58 BLACK | RG59 BLACK | RG142 | RG303 | |
| 11-01 DASH NUMBERS | | | | | | | | | | |
| (PL1C-) 1-0453- | (PL1C-) 1-0453- | -1 | -3 | -4 | -2 | -88 | -189 | -203 | -228 | K1 |
| (PL1WC-) 1-0453-W | (PL1WC-) 1-0453-W | -5 | -7 | -8 | -6 | -89 | -204 | -205 | -206 | K1 |
| (PL1C-) 1-0453- | (PL71-1 FIS) 305-0562-1 | -9 | | | | | -90 | | -207 | E2 |
| (PL1C-) 1-0453- | (PL71-2 FIS) 305-0562-3 | | -10 | -11 | | | | -208 | | E2 |
| (PL1WC-) 1-0453-W | (PL71-1 FIS) 305-0562-1 | -12 | | | | | -91 | | -209 | E2 |
| (PL1WC-) 1-0453-W | (PL71-2 FIS) 305-0562-3 | | -13 | -14 | | | -236 | | | E2 |
| (PL20-) 1-0369- | (PL1C-) 1-0453- | -15 | -17 | -18 | -16 | -92 | -238 | -239 | -240 | K1 |
| (PL20-) 1-0369- | (PL1WC-) 1-0453-W | -19 | -22 | -23 | -20 | -93 | -241 | -242 | -243 | K1 |
| (PL3C-) 1-0045- | (PL3C-) 1-0045- | -244 | -245 | -246 | -21 | -247 | -248 | -249 | -250 | K1 |
| (PL20-) 1-0369- | (PL20-) 1-0369- | -24 | -26 | -27 | -25 | -251 | -190 | -252 | -253 | K1 |
| (PL20-) 1-0369- | (PL40-) 1-0014- | -28 | -254 | -255 | -29 | -94 | -256 | -257 | -258 | K1 |
| (CJ20-) 1-0134- | (CJ40-) 1-0135- | -30 | -259 | -260 | -31 | -95 | -261 | -262 | -263 | K1 |
| (PL40-) 1-0014- | (CJ40-) 1-0135- | -32 | -33 | -34 | -264 | -96 | -265 | -266 | -267 | K1 |
| (PL95-) 1-0370- | (PL95-) 1-0370- | -35 | -77 | -268 | -195 | -97 | -269 | -270 | -271 | K1 |
| (PL95-) 1-0370- | (PL1C-) 1-0453- | -36 | -272 | -273 | -274 | -98 | -275 | -276 | -277 | K1 |
| (PL1WC-) 1-0453-W | (J3WE) 1-0378-W | -278 | -37 | -279 | -280 | -281 | -282 | -283 | | K1 |
| UG111/U | UG111/U | | -38 | | | | | | | K1 |
| (PL20-) 1-0369- | (CJ20-) 1-0134- | -62 | -63 | -64 | -39 | -106 | -284 | -285 | -286 | K1 |
| (BJ26-) 1-0341- | (PL40-) 1-0014- | -40 | -287 | -288 | -289 | -99 | -290 | -291 | -292 | K1 |
| (PL11C-) 1-0326- | (PL11C-) 1-0326- | -293 | -82 | -41 | -294 | -295 | -296 | -297 | -298 | K1 |
| (PL94-) 1-0029- | (PL20-) 1-0369- | -42 | -299 | -300 | -301 | -100 | -302 | -303 | -304 | K1 |
| (PL123-) 1-0390- | (PL1C-) 1-0453- | -43 | -44 | -45 | -305 | -101 | -306 | -307 | -308 | K1 |
| (UPL123-) 1-0390-U | (PL1WC-) 1-0453-W | -46 | -47 | -48 | -309 | -102 | -310 | -311 | -312 | K1 |
| (MP2W) 1-0398 | (PL1WC-) 1-0453-W | | -49 | -313 | | | -314 | | | K1 |
| (CJ40-) 1-0135- | (PL60-) 1-0353- | -50 | | | -315 | -103 | | -316 | -317 | K1 |
| (PL20-) 1-0369- | (PL50-) 1-0016- | -170 | -172 | -51 | -231 | -318 | -319 | -320 | | K1 |
| (PL20-) 1-0369- | (BANANA PLUG) 210-103 | -52 | | | | -104 | | | | X1 |
| (PL20-) 1-0369- | (BANANA PLUG) 210-102 | | -53 | | | | | | | X1 |
| (J12-) 1-0258 | (PL1WC-) 1-0453-W | -321 | -54 | -322 | -323 | -324 | -325 | -326 | | K1 |
| (PL11C-) 1-0326- | (J3WE) 1-0378-W | -327 | -55 | -328 | -329 | -330 | -340 | -350 | | K1 |
| (UPL20-) 1-0369-U | (UPL20-) 1-0369-U | -351 | -66 | -56 | -352 | -353 | -354 | -355 | -356 | K1 |
| (PL94-) 1-0029- | (PL1C-) 1-0326- | -357 | -358 | -359 | -57 | -360 | -361 | -362 | -363 | K1 |
| (PL11C-) 1-0326- | (UPL20-) 1-0369-U | -364 | -58 | -365 | -366 | -367 | -368 | -369 | -370 | K1 |
| (PL40-) 1-0014- | (PL40-) 1-0014- | -84 | -371 | -372 | -59 | -112 | -373 | -192 | -374 | K1 |
| (PL20-) 1-0369- | (RT ANG SMA) DMS531-2 | -60 | | | | -105 | | -382 | | K1 |
| (PL1WC-) 1-0453-W | (PL11C-) 1-0326- | -375 | -61 | -376 | -377 | -378 | -379 | -380 | -381 | K1 |
| (PL20-) 1-0369- | (RT ANG BNC(M)) 31-335 | -65 | | | | -107 | | -383 | | K1 |
| (MP3W-) 1-0410-W | (MP3W-) 1-0410-W | -67 | -68 | -384 | | -108 | -385 | -386 | | K1 |
| (J3WE-) 1-0378-W | | -387 | -69 | -388 | -389 | -390 | -391 | -392 | | K2 |
| (PL20-) 1-0369- | (F59A) | | -70 | -393 | | | | | | K1 |
| (PL40-) 1-0014- | (PL60-) 1-0353- | -71 | | | -394 | -109 | | -396 | -397 | K1 |
| (PL123-) 1-0390- | (PL123-) 1-0390- | -72 | -73 | -75 | -212 | -110 | -398 | -399 | -400 | K1 |
| (UPL123-) 1-0390-U | (UPL123-) 1-0390-U | -401 | -74 | -76 | -402 | -403 | -404 | -405 | -406 | K1 |
| (PL95-) 1-0370- | (PL20-) 1-0369- | -120 | -78 | -407 | -201 | -408 | -409 | -410 | -411 | K1 |
| (PL95-) 1-0370- | (PL1WC-) 1-0453-W | -412 | -79 | -413 | -414 | -415 | -416 | -417 | -418 | K1 |
| (PL60-) 1-0353- | (BJ69-) 1-0355- | -80 | | | -395 | -111 | | -419 | -420 | K1 |
| (PL11C-) 1-0326- | (PL50-) 1-0016- | -421 | -81 | -422 | -423 | -424 | -425 | -426 | | K1 |
| (PL20-) 1-0369- | | -214 | -427 | -83 | -233 | -428 | -429 | -430 | -431 | K2 |
| (PL95-) 1-0370- | (PL130-) 105-0181- | -432 | -85 | -433 | -434 | -435 | -436 | -437 | | K1 |

| CONNECTOR P1 DESCRIPTION/ PART NO | CONNECTOR P2 DESCRIPTION/ PART NO | CABLE GROUPS; WRENCH CRIMP, (TDDL CRIMP) | | | | | | | | CKT CODE |
|---|---|--|----------|-------------|-----------------------|------------|------------|--------|--------|-------------|
| | | 1(011) | 2(013A) | 2(013/013B) | 3(012) | 1(011) | 2(013) | 1(012) | 2(011) | |
| | | TCC-50-2 | TCC-75-2 | RG62 | M17/167-00001 (RG223) | RG58 BLACK | RG59 BLACK | RG142 | RG303 | |
| 11-01 DASH NUMBERS | | | | | | | | | | |
| (PL1C-) 1-0453- | (UG536 B/U) 1-0453- | -86 | | | | | -113 | | | K1 |
| (BJ29-) 1-0126- | (PL20-) 1-0369- | -128 | -438 | -439 | -440 | -87 | -441 | -442 | -443 | K1 |
| (UPL20-) 1-0369-U | (PL1C-) 1-0453- | -444 | -114 | -115 | -445 | -446 | -447 | -448 | -449 | K1 |
| (UPL20-) 1-0369-U | (PL1WC-) 1-0453-W | -450 | -116 | -117 | -451 | -452 | -453 | -454 | -455 | K1 |
| (UPL123-) 1-0390-U | (PL1C-) 1-0453- | -456 | -118 | -119 | -457 | -458 | -459 | -460 | -461 | K1 |
| (PL20-) 1-0369- | (BJ95-) 1-0175- | -121 | -462 | -463 | -464 | -465 | -466 | -467 | -468 | K1 |
| (PL20-) 1-0369- | (PL11C-) 1-0326- | -469 | -122 | -470 | -471 | -472 | -473 | -474 | -475 | K1 |
| (UPL40-) 1-0014-U | (PL11C-) 1-0326- | -476 | -123 | -477 | -478 | -479 | -480 | -481 | -482 | K1 |
| (UPL40-) 1-0014-U | (PL1WC-) 1-0453-W | -483 | -124 | -484 | -485 | -486 | -487 | -488 | -489 | K1 |
| (J12NM-) 105-0910- | (PL1WC-) 1-0453-W | -490 | -125 | -491 | -492 | -493 | -494 | -495 | | K1 |
| (J3E-) 1-0378- | (PL20-) 1-0369- | -496 | -497 | -126 | -498 | -499 | -500 | -501 | | K1 |
| (PL20-) 1-0369- | (PL75-1 FIS) 305-0111-1 | -127 | | | | -502 | | -503 | | E1 |
| (UPL95-) 1-0370-U | (PL11C-) 1-0326- | -504 | -129 | -505 | -506 | -507 | -508 | -509 | -510 | K1 |
| (UPL95-) 1-0370-U | (PL1WC-) 1-0453-W | -511 | -130 | -512 | -513 | -514 | -515 | -516 | -517 | K1 |
| (PL220-) 1-0442- | (PL1C-) 1-0453- | -131 | -132 | -133 | -518 | -519 | -520 | -521 | | K1 |
| (PL220-) 1-0442- | (PL1WC-) 1-0453-W | -134 | -135 | -136 | -522 | -160 | -523 | -524 | -525 | K1 |
| (PL220-) 1-0442- | (PL220-) 1-0442- | -137 | -138 | -139 | -197 | -161 | -526 | -527 | -528 | K1 |
| (PL223-) 1-0009- | (PL1C-) 1-0453- | -140 | -141 | -142 | -529 | -162 | -530 | -531 | -532 | K1 |
| (UPL223-) 1-0050- | (PL1WC-) 1-0453-W | -143 | -144 | -145 | -533 | -163 | -534 | -535 | -536 | K1 |
| (UPL220-) 1-0468- | (UPL220-) 1-0468- | -537 | -147 | -146 | -538 | -539 | -540 | -541 | -542 | K1 |
| (PL223-) 1-0009- | (PL223-) 1-0009- | -148 | -149 | -151 | -543 | -164 | -544 | -545 | -546 | K1 |
| (UPL223-) 1-0050- | (UPL223-) 1-0050- | -547 | -150 | -152 | -548 | -549 | -550 | -551 | -552 | K1 |
| (UPL220-) 1-0468- | (PL1C-) 1-0453- | -553 | -153 | -154 | -554 | -555 | -556 | -557 | -558 | K1 |
| (UPL220-) 1-0468- | (PL1WC-) 1-0453-W | -559 | -155 | -156 | -560 | -561 | -562 | -563 | -564 | K1 |

| | | | | | | | | |
|---|-------|-------------|--|-----------|-----------|---------|-------|------|
| DATA CONTAINED IN THIS DOCUMENT IS PROPRIETARY TO TROMPETER ELECTRONICS INC AND SHALL NOT BE DISCLOSED, COPIED OR USED FOR PROCUREMENT OR MANUFACTURE WITHOUT EXPRESS WRITTEN PERMISSION. | | | | REVISIONS | | | 11-01 | SH 1 |
| REV | ED | DESCRIPTION | | DWN | APPROVED | DATE | | |
| CB | 12871 | ADDED -1164 | | DAR | NAVARETTE | 1/03/03 | | |

| MARKING TABLE 3 | | MARKING TABLE 3 | | MARKING TABLE 3 | |
|---|--------------|---|-------------|---|-------------|
| MARK MODEL NO ONLY ON CABLES LISTED-MARK PART NO. ON ALL OTHERS | | MARK MODEL NO ONLY ON CABLES LISTED-MARK PART NO. ON ALL OTHERS | | MARK MODEL NO ONLY ON CABLES LISTED-MARK PART NO. ON ALL OTHERS | |
| DASH NO | MODEL NO | DASH NO | MODEL NO | DASH NO | MODEL NO |
| -1 | PC-75-50 | -67 | PPCW-75-50 | -148 | PCPC-75-50 |
| -3 | PC-75-75 | -68 | PPCW-75-75 | -149 | PCPC-75-75 |
| -4 | PC-75-93 | -72 | PCP-75-50 | -150 | UPCPC-75-75 |
| -5 | PCW-75-50 | -73 | PCP-75-75 | -151 | UPCPC-75-93 |
| -7 | PCW-75-75 | -74 | UPCP-75-75 | -152 | UPCPC-75-93 |
| -8 | PCV-75-93 | -75 | PCP-75-93 | -153 | UPCXC-75-75 |
| -9 | PCV-75-50 | -76 | UPCP-75-93 | -154 | UPCXC-75-93 |
| -10 | PCV-75-75 | -114 | UPCX-75-75 | -155 | UPCXC-75-75 |
| -11 | PCV-75-93 | -115 | UPCX-75-93 | -156 | UPCXC-75-93 |
| -12 | PCWV-75-50 | -116 | UPCW-75-75 | -157 | UPCXC-75-75 |
| -13 | PCWV-75-75 | -117 | UPCW-75-93 | -158 | UPCXC-75-93 |
| -14 | PCWV-75-93 | -118 | UPCPX-75-75 | -166 | PCPW-75-50 |
| -15 | PCX-75-50 | -119 | UPCPX-75-93 | -167 | PCPW-75-75 |
| -17 | PCX-75-75 | -131 | PCXC-75-50 | -168 | PCPW-75-93 |
| -18 | PCX-75-93 | -132 | PCXC-75-75 | | |
| -19 | PCW-75-50 | -133 | PCXC-75-93 | | |
| -22 | PCW-75-75 | -134 | PCWXC-75-50 | | |
| -23 | PCW-75-93 | -135 | PCWXC-75-75 | | |
| -24 | PCY-75-50 | -136 | PCWXC-75-93 | | |
| -26 | PCY-75-75 | -137 | PCYC-75-50 | | |
| -27 | PCY-75-93 | -138 | PCYC-75-75 | | |
| -43 | PCPX-75-50 | -139 | PCYC-75-93 | | |
| -44 | PCPX-75-75 | -140 | PCPXC-75-50 | | |
| -45 | PCPX-75-93 | -141 | PCPXC-75-75 | | |
| -46 | UPCPWX-75-50 | -142 | PCPXC-75-93 | | |
| -47 | UPCPWX-75-75 | -143 | PCPWX-75-50 | | |
| -48 | UPCPWX-75-93 | -144 | PCPWX-75-75 | | |
| -49 | MPCW-75-75 | -145 | PCPWX-75-93 | | |
| -56 | UPCY-75-93 | -146 | UPCYC-75-93 | | |
| -66 | UPCY-75-75 | -147 | UPCYC-75-75 | | |

25 PIGTAIL UNTERMINATED END USING 6 INCH EACH 700-0604 PLUS 700-0605 WIRE

24 AMP COAX SOCKET TO BE TERMINATED W/AMP 330478 FERRULE + 201142-2 SPRING.

11 IF PLASTIC STRAIN RELIEF IS REQUIRED, SUFFIX PART NO WITH BT, ADD 1 STRAIN RELIEF EACH CONNECTOR AS FOLLOWS:

ACA1
ACA2
ACB013-7 FOR VIOLET CABLE ALL OTHERS USE -0 BLACK
ACC011
ACC013

10 WHEN ASSEMBLY IS ORDERED BY MODEL NO ADD ACB013-7 PLASTIC STRAIN RELIEF 2 PER EACH CABLE ASSY

9. EXAMPLE OF COMPLETE PART NO:
11-01-X-1-YEL
DASH NO

8. SEE 11-08 FOR CABLE ASSEMBLIES WITH BEND RELIEF SPRING(S)

7 JERROLD
6 BELL IND
5 H.H SMITH
4 AMPHENDL

3 IDENTIFY PER MARKING TABLE CENTER ONLY ON CABLES 60 INCHES OR LESS; AT BOTH ENDS ON CABLES OVER 60 INCHES LONG

2. SEE CONN DVG FOR CABLE STRIPPING & ASSY INSTRUCTIONS

1 LENGTH IN INCHES TOL PER 11-03

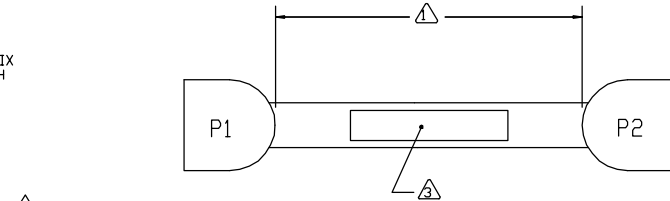

23 INSTALL ACA1 -0 BOOT OVER CONNECTOR CRIMP.

22 PIGTAIL UN-TERMINATED END USING 3' EACH 700-0094 + 700-0095 HOOK-UP WIRE.

21 SWITCHCRAFT

20 MALE 'F' CONN (PL120HB-AUGAT LRC)

19 CUSTOMER FURNISHED CONNECTORS (ALLIED SIGNAL)

18 SMB CONNECTOR, IIT CANNON RF PRODUCTS OR EQUIV

17 EF JOHNSON

16 IF ALTERNATIVE COLOR IS REQUIRED, SUFFIX P/N WITH COLOR DESIGNATION AND REPLACE TCC-75-2 WITH APPROPRIATE CABLE AS FOLLOWS:

BLK FOR TCC-75-2 BLACK
BLU FOR TCC-75-2 BLUE
GRN FOR TCC-75-2 GREEN
RED FOR TCC-75-2 RED
YEL FOR TCC-75-2 YELLOW

IF COLORED 50 OHM CABLE IS REQUIRED, REPLACE TCC-50-2 WITH THE FOLLOWING:
RED: RG58/RED
BLUE: RG58/BLU

15 MAY SUBSTITUTE (UPL220-) (1-0504-)

14 SEE CONNECTOR TOP ASSEMBLY FOR CORRECT CABLE GROUP DASH NUMBER

13 'BT' SUFFIX WILL NOT BE UTILIZED ON ASSEMBLIES LISTED IN NOTES 10 AND 24

12 WHEN ASSEMBLY IS ORDERED BY MODEL NO, ADD ACB013-7 PLASTIC STRAIN RELIEF 1 PER EACH PATCH CORD END

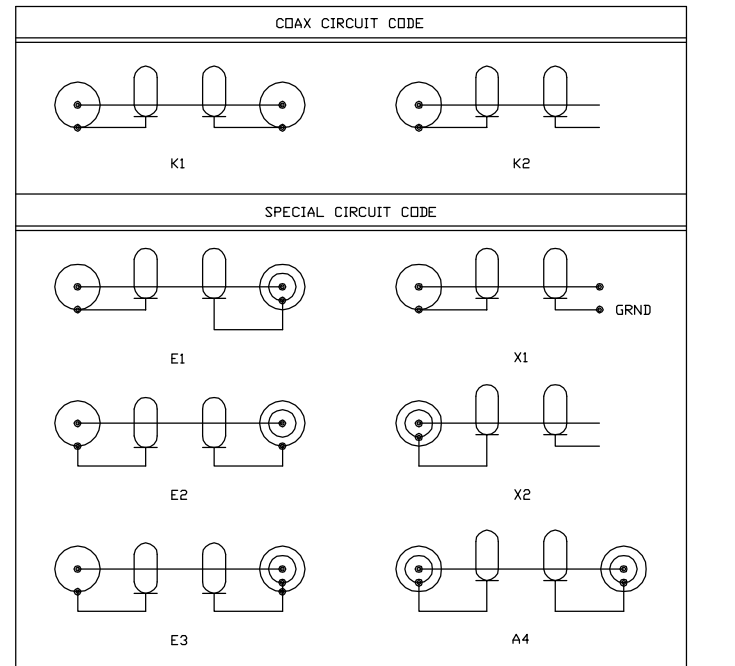

| QTY | DESCRIPTION | PART NUMBER | ITEM |
|----------------------|-------------|-------------|---------------|
| TOL UNLESS SPECIFIED | | | |
| .xx ± | | | |
| .xxx ± | | | |
| xxxx ± | | | |
| ANGLE± | | | |
| DWN | DAR | 5/24/99 | MATERIAL |
| GA | MG | 1/27/03 | CODE IDENT |
| MANU | A F | 1/29/03 | 14949 |
| ENG | R T | 1/30/03 | SCALE |
| | | | DATE 10-10-83 |
| | | | SHEET 1 OF 2 |

| CONNECTOR P1 DESCRIPTION/ PART NO | CONNECTOR P2 DESCRIPTION/ PART NO | CABLE GROUPS: WRENCH CRIMP, (TOOL CRIMP) | | | | | | | | CKT CODE | CONNECTOR P1 DESCRIPTION/ PART NO | CONNECTOR P2 DESCRIPTION/ PART NO | CABLE GROUPS: WRENCH CRIMP, (TOOL CRIMP) | | | | | | | | CKT CODE | REVISIONS | | | | SH 2 | | | | | | | | | |
|--------------------------------------|--------------------------------------|--|----------|---------|----------------------|------------|------------|--------|--------|----------|--------------------------------------|--------------------------------------|--|---------|----------------------|------------|------------|--------|--------|--------|----------|----------------------------|---|-------------|----------------------|------------|------------|-------|-------|-------|-------|-------------|-----|----------|----|
| | | 1(011) | 2(013A) | 2(013B) | 3(012) | 1(011) | 2(013) | 1(012) | 2(011) | | | | 1(011) | 2(013A) | 2(013B) | 3(012) | 1(011) | 2(013) | 1(012) | 2(011) | | REV | ED | DESCRIPTION | 11-01 | | DATE | | | | | | | | |
| | | TCC-50-2 | TCC-75-2 | RG62 | M17/167-0001 (RG223) | RG58 BLACK | RG59 BLACK | RG142 | RG303 | | | TCC-50-2 | TCC-75-2 | RG62 | M17/167-0001 (RG223) | RG58 BLACK | RG59 BLACK | RG142 | RG303 | | | TCC-50-2 | TCC-75-2 | RG62 | M17/167-0001 (RG223) | RG58 BLACK | RG59 BLACK | RG142 | RG303 | | | SEE SHEET 1 | DWN | APPROVED | |
| (UPL223-) 1-0050 | (PL1C-) 1-0453 | -565 | -157 | -158 | -566 | -567 | -568 | -569 | -570 | K1 | (PL1C-) 1-0453 | (CJ220-) 1-0443 | -839 | -840 | -841 | -842 | -843 | -844 | -845 | -846 | K1 | (UPL95-) 1-0370-U | (BJ139-2) 105-0293 | -1099 | -1100 | | | -1101 | | | | | | K1 | |
| (UPL40-) 1-0014-U | (UPL40-) 1-0014-U | -571 | -165 | -572 | -573 | -574 | -575 | -576 | -577 | K1 | (PL2-) 1-0002 | (PL2-) 1-0002 | -848 | -849 | -850 | -851 | -852 | -853 | -854 | -855 | K1 | (PL80-FDS) 305-0321-1 | (PL80-FDS) 305-0321-1 | -1102 | | | | -1103 | | | | | | | A4 |
| (PL123-) 1-0390 | (PL1WC-) 1-0453-W | -166 | -167 | -168 | -578 | -579 | -580 | -581 | -582 | K1 | (UPL20-) 1-0369-U | (UBJ29-) 1-0126-U | -852 | -853 | -854 | -855 | -856 | -857 | -858 | -859 | K1 | (PL11C-) 1-0326 | (PL95-) 1-0390 | -1104 | | | | | | | | | | | K1 |
| (UPL220-) 1-0468 | (MP3-) 1-0410 | -583 | -169 | -584 | | -585 | -586 | -587 | | K1 | (UPL1WC-) 1-0453-W | (CJ20-) 1-0134 | -860 | -861 | -862 | -863 | -864 | -865 | -866 | -867 | K1 | (PL94-) 1-0029 | (PL20-) 1-0369 | -1105 | | | | | | | | | | | K1 |
| (PL50-) 1-0016 | (PL130-) 105-0181 | -588 | -171 | -589 | -590 | -591 | -592 | -593 | | K1 | (CJ20-) 1-0134-U | (UBJ29-) 1-0126-U | -868 | -869 | -870 | -871 | -872 | -873 | -874 | -875 | K1 | (SMA-) 1420408-011 | (SMA-) 1420408-011 | -1106 | | | | 1130 | -1107 | | -1108 | | | | K1 |
| (UPL95-) 1-0370-U | (UPL95-) 1-0370-U | -594 | -173 | -595 | -596 | -597 | -598 | -599 | -600 | K1 | (UPL20-) 1-0369-U | (UBJ96-) 105-0185-U | -876 | -877 | -878 | -879 | -880 | -881 | -882 | -883 | K1 | (PL220-011) 1-0442 | (PL75-IFIS) 305-0229-1 | -1109 | | | | | | | | | | | E2 |
| (PL20-) 1-0369 | (BJ26-) 1-0341 | -174 | -175 | -176 | -177 | -178 | -601 | -602 | -603 | K1 | (BJ79 FDS) 305-0189-3 | (PL20-) 1-0369-2 | -884 | -885 | -886 | -887 | -888 | -889 | -890 | -891 | E1 | (BJ95-) 1-0175 | (SMA-) 1420408-011 | -1110 | | | | | | | | | | | K1 |
| (PL1C-) 1-0453 | (PL1WC-) 1-0453-W | -179 | -180 | -181 | -182 | -183 | -604 | -605 | -606 | K1 | (PL130-) 105-0181 | (PL130-) 105-0181 | -887 | -888 | -889 | -890 | -891 | -892 | -893 | -894 | K1 | (SMA-) 1420408-011 | (SMA-) 1420408-011 | -1106 | | | | | | | | | | | K1 |
| (PL75-1 FDS) 305-0111-1 | | -184 | | | | -607 | | -608 | | X2 | (CJ29-) 1-0126 | (CJ20-) 1-0134 | -895 | -896 | -897 | -898 | -899 | -900 | -901 | -902 | K1 | (SMA-) 1420408-011 | (SMA-) 1420408-011 | -1109 | | | | | | | | | | K1 | |
| (PL75-1 FDS) 305-0111-1 | (PL75-1 FDS) 305-0111-1 | -185 | | | | -609 | | -610 | | A4 | (PL1C) 1-0453 | (PL3C) 1-0045 | -903 | -904 | -905 | -906 | -907 | -908 | -909 | -910 | K1 | (SMA-) 1420408-011 | (SMA-) 1420408-011 | -1111 | | | | | | | | | | K1 | |
| (UPL20-) 1-0369-U | | -611 | -186 | -612 | -613 | -614 | -615 | -616 | -617 | K2 | (UBJ29) 1-0126-U | (UBJ29) 1-0126-U | -911 | -912 | -913 | -914 | -915 | -916 | -917 | -918 | K1 | (UBJ26GF-) 1-0477 | (UPL20-) 1-0369 | -1113 | | | | -1114 | | | | | | K1 | |
| (J3E-) 1-0378 | (J3E-) 1-0378 | -618 | -619 | -187 | -620 | -621 | -622 | -623 | | K1 | (UPL223) 1-0050 | (UPL220) 1-0468 | -919 | -920 | -921 | -922 | -923 | -924 | -925 | -926 | K1 | (PL220-) 1-0442 | 50-607-3141-310 | -1115 | | | | | | | | | | K1 | |
| (PL20-) 1-0369 | (PL123-) 1-0390 | -624 | -188 | -625 | -211 | -219 | -626 | -627 | -628 | K1 | (PL130-) 105-0181 | (UPL20-) 1-0369-U | -927 | -928 | -929 | -930 | -931 | -932 | -933 | -934 | K1 | (PL220-) 1-0442 | SMA 1420408-011 | -1117 | | | | 1134 | -1118 | | | | | K1 | |
| (PL50-) 1-0016 | (CJ20-) 1-0134-U | -629 | -630 | -191 | -631 | -632 | -633 | -634 | | K1 | (BJ79 FDS) 305-0111-3 | (PL20-) 1-0369 | -935 | | | | -936 | | -937 | | E1 | (UPL220-) 1-0468 | 019-912-2011 | -1119 | | | | | -1120 | | | | | K1 | |
| (BJ46-) 1-0448 | (PL40-) 1-0014 | -635 | -636 | -637 | -638 | -639 | -640 | -193 | -641 | K1 | (UPL95-) 1-0370-U | (UPL20-) 1-0369-U | -938 | -939 | -940 | -941 | -942 | -943 | | -950 | K1 | (UPL220-) 1-0468 | M39029/75-416 | -1121 | | | | | -1122 | | | | | K1 | |
| (BJ246GF-) 1-0480 | | -194 | -642 | -643 | -644 | -645 | -646 | -647 | -648 | K2 | (PL3C-) 1-0045 | (PL220-) 1-0442 | -951 | -952 | -953 | -954 | -955 | -956 | -957 | -958 | K1 | 142-0408-011 | 142-0308-011 | -1123 | | | | | | | | | | K1 | |
| (PL95-) 1-0370 | (BJ95-) 1-0175 | -229 | -649 | -650 | -196 | -651 | -652 | -653 | -654 | K1 | (PL1C) 1-0453 | (UPLRN220) 105-1252 | -959 | -960 | | | | -961 | | | K1 | (UPL20-) 1-0369-U | PL130-2 105-0181 | -1125 | | | | | -1126 | | | | | K1 | |
| (PL223-) 1-0009 | (PL95-) 1-0390 | -198 | -655 | -656 | -657 | -658 | -659 | -660 | -661 | K1 | (UPLRN220) 105-1252 | (UPLRN220) 105-1252 | -962 | -963 | | | | -964 | | | K1 | (PL220-) 1-0442 | SMA 1420408-011 | -1127 | | | | | | | | | | K1 | |
| (PL223-) 1-0009 | (BJ95-) 1-0175 | -199 | -662 | -663 | -664 | -665 | -666 | -667 | -668 | K1 | (UPL20-) 1-0369-U | (PL75-FDS) 305-0189-1 | -965 | -966 | | | | -967 | | | E1 | (PL1WC-) 1-0453 | (AUDIO PLUG) PJ051R | -1131 | -1132 | | | | | | | | | E2 | |
| (PL220-) 1-0442 | | -202 | -669 | -670 | -671 | -672 | -673 | -674 | -675 | K2 | (PL40-) 1-0014 | (BJ95-) 1-0175 | -968 | -969 | -970 | -971 | -972 | -973 | -974 | -975 | K1 | (PL40-3) 1-0014 | SMA 1420408-011 | -1135 | | | | | | | | | | K1 | |
| (PL40-) 1-0014 | (PL1C-) 1-0453 | -210 | -676 | -677 | -678 | -679 | -680 | -681 | -682 | K1 | (PL130-) 105-0181 | (PL75SC) 305-0692-1 | -976 | -977 | | | | -978 | | | E3 | (PL95-) 1-0370 | SMA 1420408-011 | -1136 | | | | | | | | | K1 | | |
| (PL240-) 1-0446 | (PL240-) 1-0446 | -213 | -683 | -684 | -685 | -686 | -687 | -688 | -689 | K1 | (PL1WC) 1-0453-W | (PL130-) 105-0181 | -979 | -980 | -981 | -982 | -983 | -984 | -985 | | K1 | (PL40-1) 1-0014-1 | 50-628-9142-310 RT SMA | -1137 | | | | | | | | | | K1 | |
| (PL95-) 1-0370 | (PL40-) 1-0014 | -690 | -691 | -692 | -693 | -215 | -694 | -695 | -696 | K1 | (BJ79 FDS) 305-0111-7 | (PL20-) 1-0369 | -986 | | | | -987 | | -988 | | E1 | (PL95-1) 1-0370-1 | 50-628-9142-310 RT SMA | -1138 | | | | | | | | | | K1 | |
| (PL95-) 1-0370 | (BJ26-) 1-0341 | -697 | -698 | -699 | -700 | -216 | -701 | -702 | -703 | K1 | (CJ220-) 1-0494 | (UPL220-) 1-0468 | -989 | -990 | -991 | -992 | -993 | -994 | -995 | -996 | K1 | (PL20-1) 1-0369 | | -1139 | | | | | | | | | | K1 | |
| (BJ21-) 1-0010-1 | | -704 | -217 | -705 | -706 | -707 | -708 | -709 | -710 | K2 | (UPL20-) 1-0369-U | (UPL123-) 1-0390-U | -997 | -998 | -999 | -1000 | -1001 | -1002 | -1003 | -1004 | K1 | (PL123-1BR) 1-0390-1 BR | 50-607-3141-310 ST. MALE. CLAMP SMA | -1140 | | | | | | | | | | K1 | |
| (UBJ26-) 1-0341 | | -711 | -218 | -712 | -713 | -714 | -715 | -716 | -717 | K2 | (PL123-) 1-0390-1 | (CJ20-) 1-0134 | -1005 | -1006 | -1007 | -1008 | -1009 | -1010 | -1011 | -1012 | K1 | (PL123-1) 1-0390 | 50-607-3141-310 ST. MALE. CLAMP SMA | -1141 | | | | | | | | | | | K1 |
| (PL11C-) 1-0326 | (UPL220-) 1-0468 | -718 | -220 | -719 | -720 | -721 | -722 | -723 | -724 | K1 | (UPL220-) 1-0468 | (UPLRN220-) 105-1252 | -1013 | -1014 | | | | -1015 | | | K1 | (PL220-012) 1-0442 | 201146-4 SOCKET, COAX AMP 201142-2 SPRING AMP 330478 FERRULE AMP | -1142 | | | | | | | | | | K1 | |
| (PL1C-) 1-0453 | (PL71-1 FDS) 305-0643 | -221 | | | | -725 | | -726 | | E1 | (PL130-) 105-0181 | (UBJ29-) 1-0126-U | -1016 | -1017 | -1018 | -1019 | -1020 | -1021 | -1022 | -1023 | K1 | (UPL20-) 1-0369 | (AUDIO PLUG) PJ051R | -1143 | -1144 | -1145 | -1146 | -1147 | -1148 | -1149 | -1150 | | | K1 | |
| (PL50-) 1-0016 | (PL40-) 1-0014 | -222 | -727 | -728 | -729 | -730 | -731 | -732 | | K1 | (UPL220-) 1-0468 | (UBJ96-) 105-0185-U | -1032 | -1033 | -1034 | -1035 | -1036 | -1037 | -1038 | -1039 | K1 | (PL123-1BR) 1-0390-1BR | SMA-1420408-011 CRIMP | -1151 | | | | | | | | | | K1 | |
| (PL223-) 1-0009 | | -223 | -733 | -734 | -735 | -736 | -737 | -738 | -739 | K2 | (PL20-) 1-0369 | (CJ70TLSC) 305-0561-10 | -1040 | | | | | -1041 | | -1042 | E3 | (UPL20-) 1-0369 | (AUDIO PLUG) PJ051R | -1143 | -1144 | -1145 | -1146 | -1147 | -1148 | -1149 | -1150 | | | K1 | |
| (PL20-) 1-0369 | (MP3-) 1-0410 | -224 | -740 | -741 | | -742 | -743 | -744 | | K1 | (PL11C-) 1-0326 | (PL75SC) 305-0561-1 | -1043 | | | | | -1044 | | -1045 | E3 | (PL123-1BR) 1-0390-1BR | SMA-1420408-011 CRIMP | -1151 | | | | | | | | | | K1 | |
| (PL20-) 1-0369 | (MP3W-) 1-0410-W | -745 | -225 | -746 | | -747 | -748 | -749 | | K1 | (PL2W) 1-0002-2W | (PL2W) 1-0002-2W | -1046 | | | | | -1047 | | | K1 | (PL123-1) 1-0390-1 | SMA-1420408-011 CRIMP | -1154 | | | | | | | | | | K1 | |
| (PL1C-) 1-0453 | (MP3-) 1-0410 | -226 | -750 | -751 | | -752 | -753 | -754 | | K1 | (UPL220-) 1-0468 | AMPHENOL # 34475 (FDS) | -1048 | | | | | | | | E1 | (UPL20) 1-0369 | TT-253 | -1158 | | | | | | | | | | E1 | |
| (PL1WC-) 1-0453-W | (MP3W-) 1-0410-W | -755 | -227 | -756 | | -757 | -758 | -759 | | K1 | (PL50-) 1-0016 | (CJ20-) 1-0134 | -1049 | -1050 | -1051</ | | | | | | | | | | | | | | | | | | | | |



Компания «ЭлектроПласт» предлагает заключение долгосрочных отношений при поставках импортных электронных компонентов на взаимовыгодных условиях!

Наши преимущества:

- Оперативные поставки широкого спектра электронных компонентов отечественного и импортного производства напрямую от производителей и с крупнейших мировых складов;
- Поставка более 17-ти миллионов наименований электронных компонентов;
- Поставка сложных, дефицитных, либо снятых с производства позиций;
- Оперативные сроки поставки под заказ (от 5 рабочих дней);
- Экспресс доставка в любую точку России;
- Техническая поддержка проекта, помощь в подборе аналогов, поставка прототипов;
- Система менеджмента качества сертифицирована по Международному стандарту ISO 9001;
- Лицензия ФСБ на осуществление работ с использованием сведений, составляющих государственную тайну;
- Поставка специализированных компонентов (Xilinx, Altera, Analog Devices, Intersil, Interpoint, Microsemi, Aeroflex, Peregrine, Syfer, Eurofarad, Texas Instrument, Miteq, Cobham, E2V, MA-COM, Hittite, Mini-Circuits, General Dynamics и др.);

Помимо этого, одним из направлений компании «ЭлектроПласт» является направление «Источники питания». Мы предлагаем Вам помощь Конструкторского отдела:

- Подбор оптимального решения, техническое обоснование при выборе компонента;
- Подбор аналогов;
- Консультации по применению компонента;
- Поставка образцов и прототипов;
- Техническая поддержка проекта;
- Защита от снятия компонента с производства.



Как с нами связаться

Телефон: 8 (812) 309 58 32 (многоканальный)

Факс: 8 (812) 320-02-42

Электронная почта: org@eplast1.ru

Адрес: 198099, г. Санкт-Петербург, ул. Калинина, дом 2, корпус 4, литера А.