

## ZXTP03200BG

### 200V PNP Low $V_{CE(sat)}$ transistor in SOT223

#### Summary

$BV_{CEO} > -200V$

$BV_{ECO} > -2V$

$I_{C(cont)} = 2A$

$V_{CE(sat)} < -160mV @ -1A$

$R_{CE(sat)} = 135m\Omega$

$P_D = 3W$

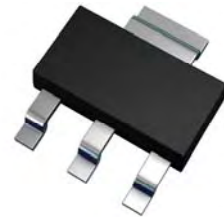

#### Description

Packaged in the SOT223 outline this new 5<sup>th</sup> generation low saturation 200V PNP transistor offers extremely low on state losses making it ideal for use in DC-DC circuits and various driving and power management functions

#### Features

- 2 Amps continuous current
- Up to 5 Amps peak current
- Very low saturation voltage
- Enhanced switching performance

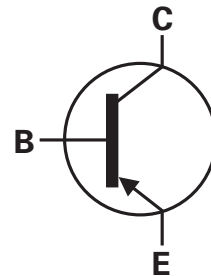

#### Applications

- DC-DC conversion

#### Ordering Information

Device	Reel size (inches)	Tape width (mm)	Quantity per reel
ZXTP03200BGTA	7	12	1000

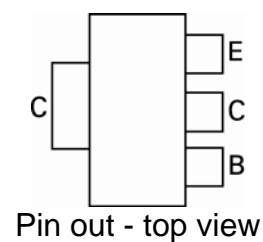

#### Device Marking

ZXTP03200BG

## Absolute Maximum Ratings

Parameter	Symbol	Limit	Unit
Collector-Base Voltage	$V_{CBO}$	-220	V
Collector-Emitter Voltage	$V_{CEO}$	-200	V
Emitter-Base Voltage	$V_{EBO}$	-7	V
Continuous Collector Current <sup>(a)</sup>	$I_C$	-2	A
Base Current	$I_B$	-1	A
Peak Pulse Current	$I_{CM}$	-5	A
Power Dissipation at $T_A=25^\circ\text{C}$ <sup>(a)</sup> Linear Derating Factor	$P_D$	1.25 10	W mW/°C
Power Dissipation at $T_A=25^\circ\text{C}$ <sup>(b)</sup> Linear Derating Factor	$P_D$	1.65 13.2	W mW/°C
Power Dissipation at $T_A=25^\circ\text{C}$ <sup>(c)</sup> Linear Derating Factor	$P_D$	3 24	W mW/°C
Power Dissipation at $T_A=25^\circ\text{C}$ <sup>(d)</sup> Linear Derating Factor	$P_D$	5.8 46.5	W mW/°C
Power Dissipation at $T_C=25^\circ\text{C}$ <sup>(e)</sup> Linear Derating Factor	$P_D$	11.9 95.2	W mW/°C
Operating and Storage Temperature Range	$T_j, T_{stg}$	-55 to 150	°C

## Thermal Resistance

Parameter	Symbol	Value	Unit
Junction to Ambient <sup>(a)</sup>	$R_{\theta JA}$	100	°C/W
Junction to Ambient <sup>(b)</sup>	$R_{\theta JA}$	76	°C/W
Junction to Ambient <sup>(c)</sup>	$R_{\theta JA}$	41.6	°C/W
Junction to Ambient <sup>(d)</sup>	$R_{\theta JA}$	21.5	°C/W
Junction to Lead <sup>(e)</sup>	$R_{\theta JL}$	10.5	°C/W

### NOTES:

- (a) For a device surface mounted on 15mm x 15mm x 1.6mm FR4 PCB with high coverage of single sided 1oz copper, in still air conditions.
- (b) Mounted on 25mm x 25mm x 1.6mm FR4 PCB with high coverage of single sided 1oz copper, in still air conditions.
- (c) Mounted on 50mm x 50mm x 1.6mm FR4 PCB with high coverage of single sided 2oz copper, in still air conditions.
- (d) As (c) above measured at  $t < 5$  seconds.
- (e) Junction to Lead from Collector Tab. Typical

Thermal Characteristics

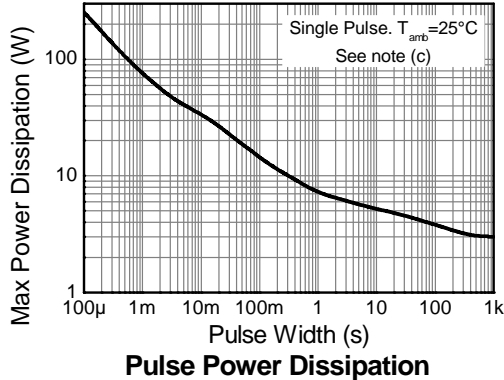
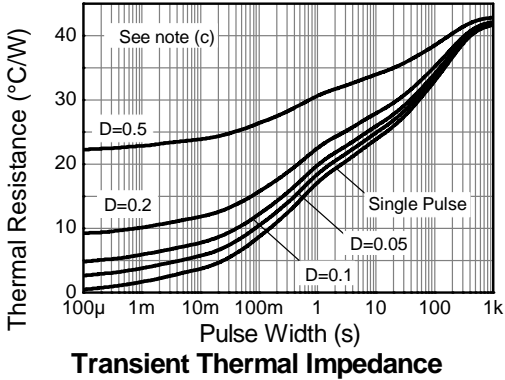
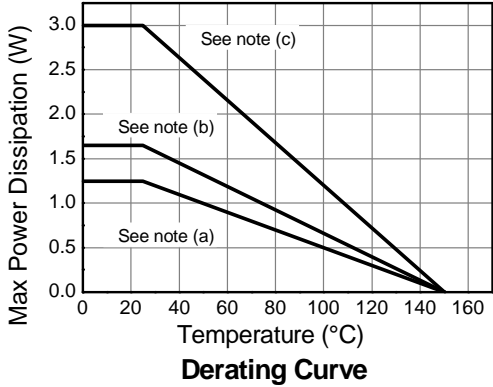
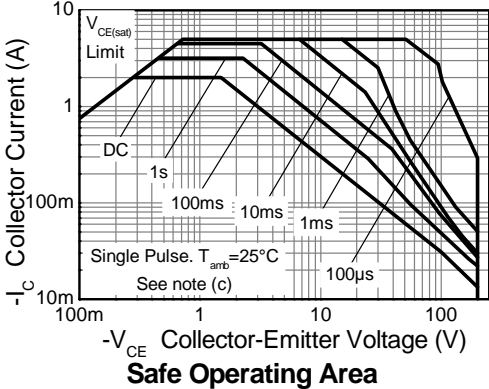

# ZXTP03200BG

## Electrical Characteristics (at $T_{amb} = 25^{\circ}\text{C}$ unless otherwise stated)

Parameter	Symbol	Min.	Typ.	Max.	Unit	Conditions
Collector-Base Breakdown Voltage	$BV_{CBO}$	-220	-245		V	$I_C = -100\mu\text{A}$
Collector-Emitter Breakdown Voltage	$BV_{CER}$	-220	-245		V	$I_C = -1\mu\text{A}$ , $R_{BE} \leq 1\text{k}\Omega$
Collector-Emitter Breakdown voltage	$BV_{CEO}$	-200	-225		V	$I_C = -10\text{mA}$ (*)
Emitter-Base Breakdown Voltage	$BV_{EBO}$	-7	-8.4		V	$I_E = -100\mu\text{A}$
Collector-Base Cut-off Current	$I_{CBO}$		<1	-50 -0.5	nA $\mu\text{A}$	$V_{CB} = -200\text{V}$ $V_{CB} = -200\text{V}$ , $T_{amb} = 100^{\circ}\text{C}$
Emitter Cut-off Current	$I_{EBO}$		<1	-10	nA	$V_{EB} = -6\text{V}$
Collector-Emitter Saturation Voltage	$V_{CE(sat)}$		-37 -130 -135 -180	-50 -155 -160 -275	mV mV mV mV	$I_C = -0.1\text{A}$ , $I_B = -10\text{mA}$ (*) $I_C = -0.5\text{A}$ , $I_B = -25\text{mA}$ (*) $I_C = -1\text{A}$ , $I_B = -100\text{mA}$ (*) $I_C = -2\text{A}$ , $I_B = -400\text{mA}$ (*)
Base-Emitter Saturation Voltage	$V_{BE(sat)}$		-955	-1100	mV	$I_C = -2\text{A}$ , $I_B = -400\text{mA}$ (*)
Base-Emitter Turn-On Voltage	$V_{BE(on)}$		-860	-1000	mV	$I_C = -2\text{A}$ , $V_{CE} = -5\text{V}$ (*)
Static Forward Current Transfer Ratio	$h_{FE}$	100 100 20	195 170 50 5	300		$I_C = -10\text{mA}$ , $V_{CE} = -5\text{V}$ (*) $I_C = -1\text{A}$ , $V_{CE} = -5\text{V}$ (*) $I_C = -2\text{A}$ , $V_{CE} = -5\text{V}$ (*) $I_C = -5\text{A}$ , $V_{CE} = -5\text{V}$ (*)
Transition Frequency	$f_T$		105		MHz	$I_C = -100\text{mA}$ , $V_{CE} = -10\text{V}$ $f = 50\text{MHz}$
Output Capacitance	$C_{obo}$		31		pF	$V_{CB} = -10\text{V}$ , $f = 1\text{MHz}$ (*)
Delay Time	$t_d$		21		ns	$I_C = -1\text{A}$ , $V_{CC} = -50\text{V}$ , $I_{B1} = -I_{B2} = -100\text{mA}$
Rise Time	$t_r$		18		ns	
Storage Time	$t_s$		680		ns	
Fall Time	$t_f$		75		ns	

### NOTES:

(\*) Measured under pulsed conditions. Pulse width  $\leq 300\mu\text{s}$ ; duty cycle  $\leq 2\%$ .

Typical Characteristics

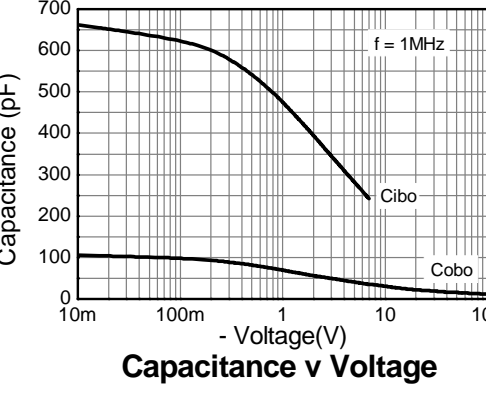
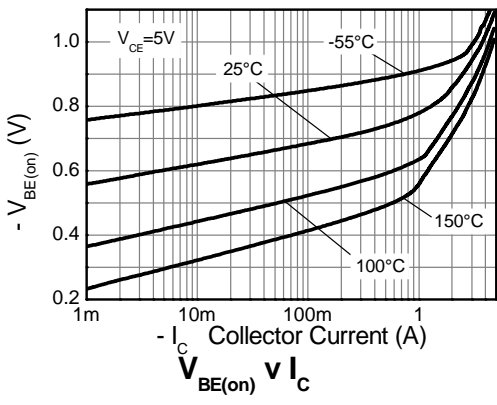
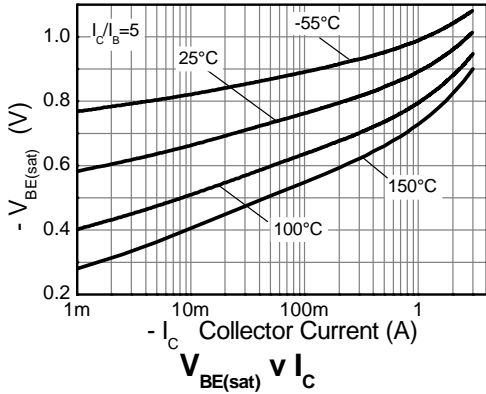
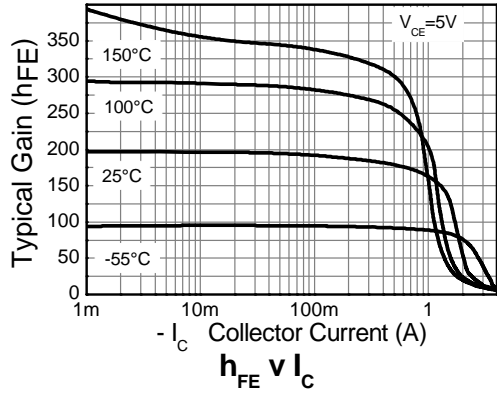
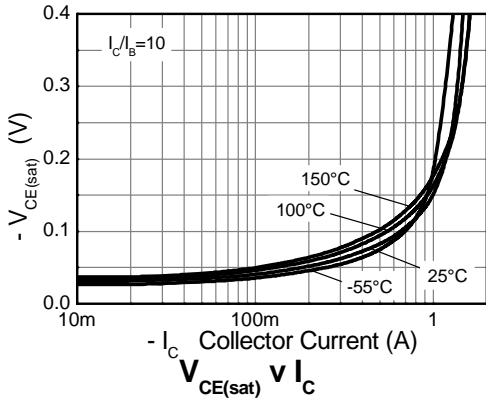
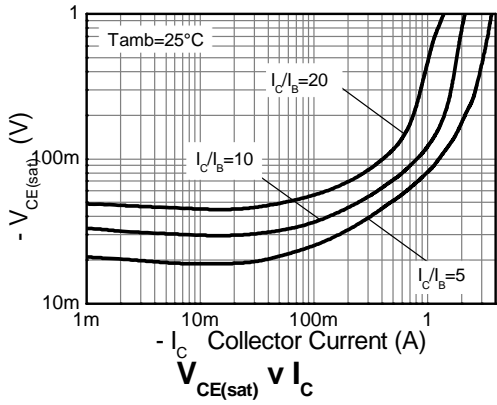

**Intentionally left blank**

# ZXTP03200BG

## Package Information – SOT223

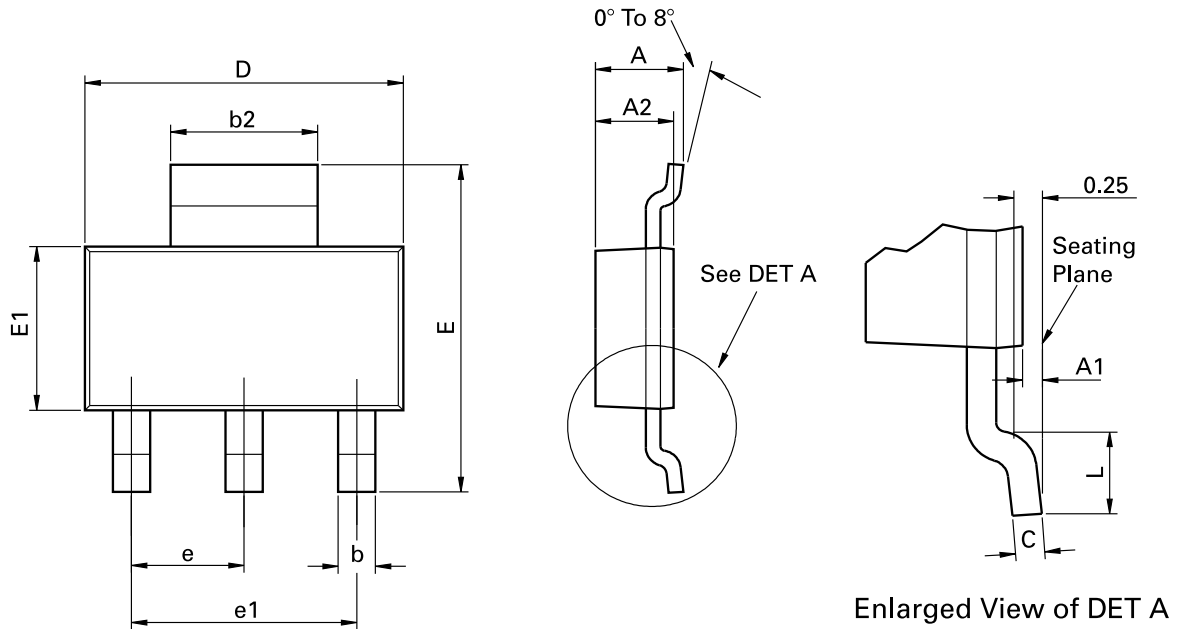

Conforms to JEDEC TO-261 AA Issue B

DIM	Millimeters		Inches		DIM	Millimeters		Inches	
	Min	Max	Min	Max		Min	Max	Min	Max
A	-	1.80	-	0.071	e	2.30 BSC		0.0905 BSC	
A1	0.02	0.10	0.0008	0.004	e1	4.60 BSC		0.181 BSC	
b	0.66	0.84	0.026	0.033	E	6.70	7.30	0.264	0.287
b2	2.90	3.10	0.114	0.122	E1	3.30	3.70	0.130	0.146
C	0.23	0.33	0.009	0.013	L	0.90	-	0.355	-
D	6.30	6.70	0.248	0.264	-	-	-	-	-

## Definitions

### Product change

Diodes Incorporated reserves the right to alter, without notice, specifications, design, price or conditions of supply of any product or service. Customers are solely responsible for obtaining the latest relevant information before placing orders.

### Applications disclaimer

The circuits in this design/application note are offered as design ideas. It is the responsibility of the user to ensure that the circuit is fit for the user's application and meets with the user's requirements. No representation or warranty is given and no liability whatsoever is assumed by Diodes Inc. with respect to the accuracy or use of such information, or infringement of patents or other intellectual property rights arising from such use or otherwise. Diodes Inc. does not assume any legal responsibility or will not be held legally liable (whether in contract, tort (including negligence), breach of statutory duty, restriction or otherwise) for any damages, loss of profit, business, contract, opportunity or consequential loss in the use of these circuit applications, under any circumstances.

### Life support

Diodes Zetex products are specifically not authorized for use as critical components in life support devices or systems without the express written approval of the Chief Executive Officer of Diodes Incorporated. As used herein:

- A. Life support devices or systems are devices or systems which:
1. are intended to implant into the body
- or
2. support or sustain life and whose failure to perform when properly used in accordance with instructions for use provided in the labeling can be reasonably expected to result in significant injury to the user.
- B. A critical component is any component in a life support device or system whose failure to perform can be reasonably expected to cause the failure of the life support device or to affect its safety or effectiveness.

### Reproduction

The product specifications contained in this publication are issued to provide outline information only which (unless agreed by the company in writing) may not be used, applied or reproduced for any purpose or form part of any order or contract or be regarded as a representation relating to the products or services concerned.

### Terms and Conditions

All products are sold subjects to Diodes Inc. terms and conditions of sale, and this disclaimer (save in the event of a conflict between the two when the terms of the contract shall prevail) according to region, supplied at the time of order acknowledgement.

For the latest information on technology, delivery terms and conditions and prices, please contact your nearest Zetex sales office.

### Quality of product

Diodes Zetex Semiconductors Limited is an ISO 9001 and TS16949 certified semiconductor manufacturer.

To ensure quality of service and products we strongly advise the purchase of parts directly from Zetex Semiconductors or one of our regionally authorized distributors. For a complete listing of authorized distributors please visit: [www.zetex.com](http://www.zetex.com) or [www.diodes.com](http://www.diodes.com)

Diodes Inc. does not warrant or accept any liability whatsoever in respect of any parts purchased through unauthorized sales channels.

### ESD (Electrostatic discharge)

Semiconductor devices are susceptible to damage by ESD. Suitable precautions should be taken when handling and transporting devices. The possible damage to devices depends on the circumstances of the handling and transporting, and the nature of the device. The extent of damage can vary from immediate functional or parametric malfunction to degradation of function or performance in use over time. Devices suspected of being affected should be replaced.

### Green compliance

Diodes Inc. is committed to environmental excellence in all aspects of its operations which includes meeting or exceeding regulatory requirements with respect to the use of hazardous substances. Numerous successful programs have been implemented to reduce the use of hazardous substances and/or emissions.

All Diodes Zetex components are compliant with the RoHS directive, and through this it is supporting its customers in their compliance with WEEE and ELV directives.

### Product status key:

"Preview"	Future device intended for production at some point. Samples may be available
"Active"	Product status recommended for new designs
"Last time buy (LTB)"	Device will be discontinued and last time buy period and delivery is in effect
"Not recommended for new designs"	Device is still in production to support existing designs and production
"Obsolete"	Production has been discontinued

### Datasheet status key:

"Draft version"	This term denotes a very early datasheet version and contains highly provisional information, which may change in any manner without notice.
"Provisional version"	This term denotes a pre-release datasheet. It provides a clear indication of anticipated performance. However, changes to the test conditions and specifications may occur, at any time and without notice.
"Issue"	This term denotes an issued datasheet containing finalized specifications. However, changes to specifications may occur, at any time and without notice.

## Diodes sales offices

### Sales offices

#### The Americas

3050 E. Hillcrest Drive  
Westlake Village,  
CA 91362-3154  
Tel: (+1) 805 446 4800  
Fax: (+1) 805 446 4850

#### Europe

Kustermannpark  
Balanstraße 59,  
D-81541 München  
Germany  
Tel: (+49) 894 549 490  
Fax: (+49) 894 549 4949

#### Taiwan

7F, No. 50,  
Min Chuan Road  
Hsin-Tien  
Taipei, Taiwan  
Tel: (+886) 289 146 000  
Fax: (+886) 289 146 639

#### Shanghai

Rm. 606, No.1158  
Changning Road  
Shanghai, China  
Tel: (+86) 215 241 4882  
Fax (+86) 215 241 4891

#### Shenzhen

Room A1103-04,  
ANLIAN Plaza, #4018  
Jintian Road  
Futian CBD,  
Shenzhen, China  
Tel: (+86) 755 882 849 88  
Fax: (+86) 755 882 849 99

#### Korea

6 Floor, Changhwa B/D,  
1005-5 Yeongtong-dong,  
Yeongtong-gu, Suwon-si,  
Gyeonggi-do, Korea 443-813  
Tel: (+82) 312 731 884  
Fax: (+82) 312 731 885





Компания «ЭлектроПласт» предлагает заключение долгосрочных отношений при поставках импортных электронных компонентов на взаимовыгодных условиях!

Наши преимущества:

- Оперативные поставки широкого спектра электронных компонентов отечественного и импортного производства напрямую от производителей и с крупнейших мировых складов;
- Поставка более 17-ти миллионов наименований электронных компонентов;
- Поставка сложных, дефицитных, либо снятых с производства позиций;
- Оперативные сроки поставки под заказ (от 5 рабочих дней);
- Экспресс доставка в любую точку России;
- Техническая поддержка проекта, помощь в подборе аналогов, поставка прототипов;
- Система менеджмента качества сертифицирована по Международному стандарту ISO 9001;
- Лицензия ФСБ на осуществление работ с использованием сведений, составляющих государственную тайну;
- Поставка специализированных компонентов (Xilinx, Altera, Analog Devices, Intersil, Interpoint, Microsemi, Aeroflex, Peregrine, Syfer, Eurofarad, Texas Instrument, Miteq, Cobham, E2V, MA-COM, Hittite, Mini-Circuits, General Dynamics и др.);

Помимо этого, одним из направлений компании «ЭлектроПласт» является направление «Источники питания». Мы предлагаем Вам помощь Конструкторского отдела:

- Подбор оптимального решения, техническое обоснование при выборе компонента;
- Подбор аналогов;
- Консультации по применению компонента;
- Поставка образцов и прототипов;
- Техническая поддержка проекта;
- Защита от снятия компонента с производства.



#### Как с нами связаться

**Телефон:** 8 (812) 309 58 32 (многоканальный)

**Факс:** 8 (812) 320-02-42

**Электронная почта:** [org@eplast1.ru](mailto:org@eplast1.ru)

**Адрес:** 198099, г. Санкт-Петербург, ул. Калинина, дом 2, корпус 4, литера А.