

9mm Rotary Type, Snap-In, Insulated Shaft

Application

- ✓ TV/Video, Audio, Home appliance, Industrial control

Feature

- ✓ Smooth rotation feeling



■Specification

| | |
|---------------------------------------|--|
| Total Rotational Angle | RV09A series: 280±5° , RV09B series: 300±5° |
| Maximum Operating Voltage | 50V AC |
| Insulation Resistance | 100MΩ at DC250V |
| Dielectric Strength | AC250V for 1 minute |
| Rotational Torque | 10-100 gf.cm |
| Click Torque | 20-120 gf.cm |
| Rotational Stop Strength of the Shaft | 3 kgs.cm min |
| Push/Pull Strength of the Shaft | 5kgs for 3 sec |
| Operating Temperature Range | -10 °C~70°C |
| Rotation Life | With click: 5,000 cycles, without click: 10,000 cycles |

■How to order

RV09AF-20 – 15F - B10K - 0C

[Model](#)

[Shaft Type](#)

Taper and Resistance Value

| Order Code | Taper | Resistance Value |
|------------|-----------|------------------|
| A100K | Log/A | 100KΩ |
| B1M | Linear/B | 1MΩ |
| C500K | Rev-log/C | 500KΩ |

Taper: A, B and C

Resistance Value: 1KΩ to 500KΩ and 1MΩ

*Contact us for other requirements.

Click

| Order Code | Description |
|------------|-------------------|
| Blank | No click |
| 0C | With center click |

9mm Rotary Type, Snap-In, Insulated Shaft

■ Model Description

| Model | Number of Unit | Terminal Type | With Sleeve or Bushing | Rotational Angle | Mounting Height |
|------------------------------|----------------|---------------|------------------------|------------------|-----------------|
| RV09ACF-20 | Single unit | Horizontal | Sleeve | 280°±5° | 10 mm |
| RV09BCF-20 | Single unit | Horizontal | Sleeve | 300°±5° | 10 mm |
| RV09ACF-40 | Single unit | Vertical | Sleeve | 280°±5° | 7.0 mm |
| RV09BCF-40 | Single unit | Vertical | Sleeve | 300°±5° | 7.0 mm |
| RV09AF-20 | Single unit | Horizontal | N/A | 280°±5° | 10 mm |
| RV09AF-21 | Single unit | Horizontal | N/A | 280°±5° | 6.5 mm |
| RV09BF-20 | Single unit | Horizontal | N/A | 300°±5° | 10 mm |
| RV09BF-21 | Single unit | Horizontal | N/A | 300°±5° | 6.5 mm |
| RV09AF-40 | Single unit | Vertical | N/A | 280°±5° | 7.0 mm |
| RV09BF-40 | Single unit | Vertical | N/A | 300°±5° | 7.0 mm |
| RV09AF-20E1N | Single unit | Horizontal | Plastic bushing | 280°±5° | 10 mm |
| RV09AF-21E1N | Single unit | Horizontal | Plastic bushing | 280°±5° | 6.5 mm |
| RV09BF-20E1N | Single unit | Horizontal | Plastic bushing | 300°±5° | 10 mm |
| RV09BF-21E1N | Single unit | Horizontal | Plastic bushing | 300°±5° | 6.5 mm |
| RV09AF-40E1N | Single unit | Vertical | Plastic bushing | 280°±5° | 7.0 mm |
| RV09BF-40E1N | Single unit | Vertical | Plastic bushing | 300°±5° | 7.0 mm |
| RV09AF-20E1 | Single unit | Horizontal | Metal bushing | 280°±5° | 10 mm |
| RV09BF-20E1 | Single unit | Horizontal | Metal bushing | 300°±5° | 10 mm |
| RV09AF-21E1 | Single unit | Horizontal | Metal bushing | 280°±5° | 6.5 mm |
| RV09BF-21E1 | Single unit | Horizontal | Metal bushing | 300±5° | 6.5 mm |
| RV09AF-40E1 | Single unit | Vertical | Metal bushing | 280°±5° | 7.0 mm |
| RV09BF-40E1 | Single unit | Vertical | Metal bushing | 300°±5° | 7.0 mm |

[Back to top](#)

POTENTIOMETERS



9mm Rotary Type, Snap-In, Insulated Shaft

| Order Code | Outline Drawing | | | | | | | | |
|---|---|---|--|-------|---|-------------|------|-------------|-----|
| RV09ACF-20 RV09BCF-20  |  | SHAFT SHOWN IN FULL C.C.W. POSITION  |  P.C.B.MOUNTING HOLE DETAIL | | | | | | |
| RV09ACF-40 RV09BCF-40  |  | SHAFT SHOWN IN FULL C.C.W. POSITION  |  P.C.B.MOUNTING HOLE DETAIL | | | | | | |
| RV09AF-20,RV09BF-20 RV09AF-21,RV09BF-21  |  | SHAFT SHOWN IN FULL C.C.W. POSITION  |  P.C.B.MOUNTING HOLE DETAIL <table border="1" data-bbox="1228 1489 1492 1579"> <thead> <tr> <th>MODEL</th> <th>H</th> </tr> </thead> <tbody> <tr> <td>RV09A(B)-20</td> <td>10.0</td> </tr> <tr> <td>RV09A(B)-21</td> <td>6.5</td> </tr> </tbody> </table> | MODEL | H | RV09A(B)-20 | 10.0 | RV09A(B)-21 | 6.5 |
| MODEL | H | | | | | | | | |
| RV09A(B)-20 | 10.0 | | | | | | | | |
| RV09A(B)-21 | 6.5 | | | | | | | | |
| RV09AF-40 RV09BF-40  |  | SHAFT SHOWN IN FULL C.C.W. POSITION  |  P.C.B.MOUNTING HOLE DETAIL | | | | | | |

[Back to top](#)

POTENTIOMETERS



9mm Rotary Type, Snap-In, Insulated Shaft

| Order code | Outline Drawing | | | | | | | |
|---|---|--|-------|---|----------------|------|----------------|-----|
| RV09AF-20E1N, RV09AF-21E1N RV09BF-20E1N, RV09BF-21E1N  |  | <p>SHAFT SHOWN IN FULL C.C.W. POSITION</p>  <p>SHAFT SHOWN IN FULL C.C.W. POSITION</p>  <p>P.C.B.MOUNTING HOLE DETAIL</p> <table border="1" data-bbox="1220 638 1492 728"> <thead> <tr> <th>MODEL</th> <th>H</th> </tr> </thead> <tbody> <tr> <td>RV09A(B)-20E1N</td> <td>10.0</td> </tr> <tr> <td>RV09A(B)-21E1N</td> <td>6.5</td> </tr> </tbody> </table> | MODEL | H | RV09A(B)-20E1N | 10.0 | RV09A(B)-21E1N | 6.5 |
| MODEL | H | | | | | | | |
| RV09A(B)-20E1N | 10.0 | | | | | | | |
| RV09A(B)-21E1N | 6.5 | | | | | | | |
| RV09AF-40E1N RV09BF-40E1N  |  | <p>SHAFT SHOWN IN FULL C.C.W. POSITION</p>  <p>SHAFT SHOWN IN FULL C.C.W. POSITION</p>  <p>P.C.B.MOUNTING HOLE DETAIL</p> | | | | | | |
| RV09AF-20E1, RV09BF-20E1 RV09AF-21E1, RV09BF-21E1  |  | <p>SHAFT SHOWN IN FULL C.C.W. POSITION</p>  <p>SHAFT SHOWN IN FULL C.C.W. POSITION</p>  <p>P.C.B.MOUNTING HOLE DETAIL</p> <table border="1" data-bbox="1220 1489 1492 1579"> <thead> <tr> <th>MODEL</th> <th>H</th> </tr> </thead> <tbody> <tr> <td>RV09A(B)-20E1</td> <td>10.0</td> </tr> <tr> <td>RV09A(B)-21E1</td> <td>6.5</td> </tr> </tbody> </table> | MODEL | H | RV09A(B)-20E1 | 10.0 | RV09A(B)-21E1 | 6.5 |
| MODEL | H | | | | | | | |
| RV09A(B)-20E1 | 10.0 | | | | | | | |
| RV09A(B)-21E1 | 6.5 | | | | | | | |
| RV09AF-40E1 RV09BF-40E1  |  | <p>SHAFT SHOWN IN FULL C.C.W. POSITION</p>  <p>SHAFT SHOWN IN FULL C.C.W. POSITION</p>  <p>P.C.B. MOUNTING HOLE DETAIL</p> | | | | | | |

[Back to top](#)

9mm Rotary Type, Snap-In, Insulated Shaft

■ K TYPE

| | | | |
|--|---|--|---|
| RV09AF-20(21)-(L)K RV09BF-20(21)-(L)K | RV09AF-40-(L)K RV09BF-40-(L)K | RV09ACF-20-(L)K RV09BCF-20-(L)K | RV09ACF-40-(L)K RV09BCF-40-(L)K |
|  |  |  |  |

RV09AF, RV09ACF

| Order Code | 15K | 20K | 25K | 30K |
|------------|-----|-----|-----|-----|
| L | 15 | 20 | 25 | 30 |
| T | 7 | 7 | 7 | 7 |

RV09BF, RV09BCF

| Order Code | 20K | 25K | 30K |
|------------|-----|-----|-----|
| L | 20 | 25 | 30 |
| T | 7 | 7 | 7 |

**15 mm shaft is not available for RV09ACF/BCF models.

RV09AF-20E1N(21E1N)-(L)K
RV09BF-20E1N(21E1N)-(L)K
RV09AF-20E1(21E1)-(L)K
RV09BF-20E1(21E1)-(L)K

RV09AF-40E1N-(L)K
RV09BF-40E1N-(L)K
RV09AF-40E1-(L)K
RV09BF-40E1-(L)K

| | | | |
|--|---|--|---|
|  |  |  |  |
|--|---|--|---|

| Order Code | 165K | 25K |
|------------|------|------|
| L | 16.5 | 21.5 |
| T | 7 | 7 |

[Back to top](#)

9mm Rotary Type, Snap-In, Insulated Shaft

■ F TYPE



RV09AF, RV09ACF

| Order Code | *15F | 20F | 21F | 25F | 26F | 30F | 31F | 375F |
|------------|------|-----|-----|-----|-----|-----|-----|------|
| L | 15 | 20 | 21 | 25 | 26 | 30 | 31 | 37.5 |
| F | 6 | 7 | 7 | 7 | 12 | 12 | 12 | 12 |

RV09BF, RV09BCF

| Order Code | *15F | 20F | 21F | 235F | 25F | 26F | 30F | 31F | 335F | 35F | 375F |
|------------|------|-----|-----|------|-----|------|-----|-----|------|-----|------|
| L | 15 | 20 | 21 | 23.5 | 25 | 26 | 30 | 31 | 33.5 | 35 | 37.5 |
| F | 6 | 7 | 7 | 7 | 7 | 8.25 | 12 | 12 | 12 | 12 | 12 |

**15 mm shaft is not available for RV09ACF/BCF models.

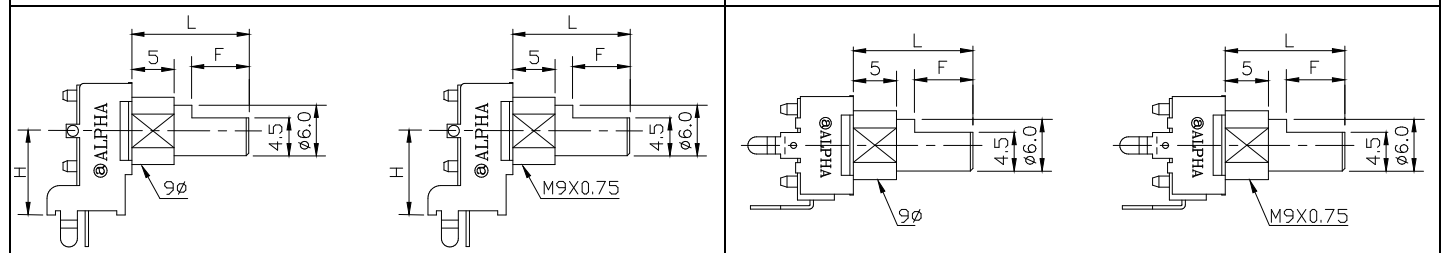
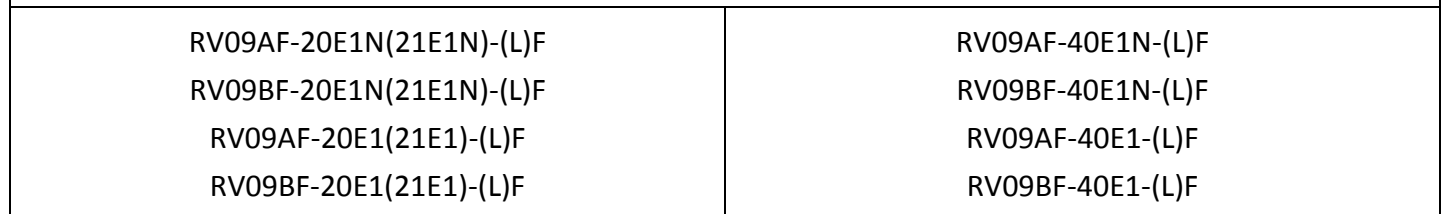

RV09AF

| Order Code | 115F | 125F | 165F | 175F | 215F | 225F | 29F |
|------------|------|------|------|------|------|------|-----|
| L | 11.5 | 12.5 | 16.5 | 17.5 | 21.5 | 22.5 | 29 |
| F | 7 | 7 | 7 | 12 | 12 | 12 | 12 |

RV09BF

| Order Code | 115F | 125F | 15F | 165F | 165F | 165F | 175F | 215F | 225F | 25F | 265F | 29F |
|------------|------|------|-----|------|------|------|------|------|------|-----|------|-----|
| L | 11.5 | 12.5 | 15 | 16.5 | 16.5 | 16.5 | 17.5 | 21.5 | 22.5 | 25 | 26.5 | 29 |
| F | 7 | 7 | 7 | 7 | 8.25 | 12 | 12 | 12 | 12 | 12 | 12 | 12 |

[Back to top](#)

9mm Rotary Type, Snap-In, Insulated Shaft

■ B TYPE



RV09AF, RV09ACF

| Order Code | 15B | 20F | 25B | 30B |
|------------|-----|-----|-----|-----|
| L | 15 | 20 | 25 | 30 |
| T | 7 | 7 | 7 | 7 |

RV09BF, RV09BCF

| Order Code | 20B | 25B | 30B | 33B |
|------------|-----|-----|-----|-----|
| L | 20 | 25 | 30 | 33 |
| T | 7 | 7 | 7 | 7 |

**15 mm shaft is not available for RV09ACF/BCF models.



RV09AF

| Order Code | 115B | 165B | 215B |
|------------|------|------|------|
| L | 11.5 | 16.5 | 21.5 |
| T | 7 | 7 | 7 |

RV09BF

| Order Code | 115B | 165B | 215B | 25B |
|------------|------|------|------|-----|
| L | 11.5 | 16.5 | 21.5 | 25 |
| T | 7 | 7 | 7 | 7 |

Design and specifications presented here are for the standard parts only. Please kindly contact us for your special requests and ask for the current technical specifications before purchase and/or use.

[Back to top](#)

Mouser Electronics

Authorized Distributor

Click to View Pricing, Inventory, Delivery & Lifecycle Information:

Alpha (Taiwan):

[RV09AF-40-20K-A10K](#) [RV09AF-40-20K-B10K](#) [RV09AF-40-20K-A55](#) [RV09AF-20-20K-A55](#) [RV09AF-20-20K-B55](#)
[RV09AF-40-20K-B55](#) [RV09AF-40-20K-B50K](#) [RV09AF-40-20K-A54](#) [RV09AF-20-20K-B16](#) [RV09AF-20-20K-B13](#)
[RV09AF-20-20K-B53](#) [RV09AF-20-20K-B23](#) [RV09AF-40-20K-A53](#) [RV09AF-40-20K-A16](#) [RV09AF-40-20K-A13](#)
[RV09AF-40-20K-A23](#) [RV09AF-40-20K-B100K](#) [RV09AF-20-20K-B100K](#) [RV09AF-20-20K-B10K](#) [RV09AF-20-20K-A14](#)
[RV09AF-40-20K-A100K](#) [RV09AF-20-20K-A15](#) [RV09AF-20-20K-A54](#) [RV09AF-20-20K-B50K](#) [RV09AF-40-20K-B1K](#)
[RV09AF-40-20K-B1M](#) [RV09AF-40-20K-B5K](#) [RV09AF-40-20K-B23](#) [RV09AF-20-20K-A23](#) [RV09AF-20-20K-A13](#)
[RV09AF-20-20K-A53](#) [RV09AF-20-20K-A16](#) [RV09AF-20-20K-B20](#) [RV09AF-40-30K-C10K](#) [RV09AF-40-30K-C100K](#)
[RV09AF-40-30K-B500K](#) [RV09AF-40-20K-A500K](#) [RV09AF-40-30K-A10K](#) [RV09AF-40-30K-B10K](#) [RV09AF-40-30K-](#)
[B100K](#) [RV09AF-40-30K-A500K](#) [RV09AF-40-30K-B50K](#) [RV09AF-40-30K-B5K](#) [RV09AF-40-30K-B1K](#) [RV09AF-40-30K-](#)
[B1M](#) [RV09AF-40-30K-A100K](#) [RV09AF-20-20K-A10K](#) [RV09AF-20-20K-B5K](#) [RV09AF-20-20K-A1M](#) [RV09AF-20-20K-](#)
[A50K](#) [RV09AF-20-20K-A5K](#) [RV09AF-40-20K-A2K](#) [RV09AF-20-20K-A2K](#) [RV09AF-40-20K-A5K](#) [RV09AF-40-20K-B2K](#)
[RV09AF-40-20K-A1M](#)



Компания «ЭлектроПласт» предлагает заключение долгосрочных отношений при поставках импортных электронных компонентов на взаимовыгодных условиях!

Наши преимущества:

- Оперативные поставки широкого спектра электронных компонентов отечественного и импортного производства напрямую от производителей и с крупнейших мировых складов;
- Поставка более 17-ти миллионов наименований электронных компонентов;
- Поставка сложных, дефицитных, либо снятых с производства позиций;
- Оперативные сроки поставки под заказ (от 5 рабочих дней);
- Экспресс доставка в любую точку России;
- Техническая поддержка проекта, помощь в подборе аналогов, поставка прототипов;
- Система менеджмента качества сертифицирована по Международному стандарту ISO 9001;
- Лицензия ФСБ на осуществление работ с использованием сведений, составляющих государственную тайну;
- Поставка специализированных компонентов (Xilinx, Altera, Analog Devices, Intersil, Interpoint, Microsemi, Aeroflex, Peregrine, Syfer, Eurofarad, Texas Instrument, Miteq, Cobham, E2V, MA-COM, Hittite, Mini-Circuits, General Dynamics и др.);

Помимо этого, одним из направлений компании «ЭлектроПласт» является направление «Источники питания». Мы предлагаем Вам помощь Конструкторского отдела:

- Подбор оптимального решения, техническое обоснование при выборе компонента;
- Подбор аналогов;
- Консультации по применению компонента;
- Поставка образцов и прототипов;
- Техническая поддержка проекта;
- Защита от снятия компонента с производства.



Как с нами связаться

Телефон: 8 (812) 309 58 32 (многоканальный)

Факс: 8 (812) 320-02-42

Электронная почта: org@eplast1.ru

Адрес: 198099, г. Санкт-Петербург, ул. Калинина, дом 2, корпус 4, литера А.