



SMA COAXIAL CONNECTORS

The Connex SMA connectors are semi-precision, sub-miniature, high-frequency connectors which offer reliable broadband performance DC to 18GHz with low reflection and constant 50 ohm impedance.

The main features are high mechanical strength, high durability and low VSWR. Matured design principles, careful manufacturing at all stages and a thorough quality assurance organization are the bases for the well-known quality of Connex SMA connectors.

ELECTRICAL SPECIFICATIONS

| | | |
|------------------------------------|--|--|
| Impedance | 50 ohm | |
| Frequency range | *Semi-rigid cable for .141" or .085" O.D. copper jacket: 0–18 GHz *Flexible cable: 0–12.4 GHz | |
| Voltage rating | *RG–58, 141, 142, 223: 500v peak *RG–174, 188, 316: 375V peak | |
| Dielectric withstanding voltage | *.141" & RG–58 cable group: 1000V RMS * .085" & RG–316 cable group: 750V RMS | |
| VSWR—straight Connectors *f in GHz | *.141" semi-rigid cable group: 1.05 + .005f *RG–174 cable group: 1.15 + .02f | *RG–58 cable group: 1.15 + .01f *RG–178 cable group: 1.20 + .025f |
| Contact resistance | Center: 2.0 milliohms Body: 2.0 milliohms Braid to body: 0.5 milliohms | |
| Insulation resistance | 5000 Megohms | |
| RF leakage | -90 db min. at 2–3 GHz | |
| Insertion loss | db max. = .06√freq. GHz.. Test frequency @6.0 GHz | |

MILITARY SPECIFICATIONS
MIL–C–39012 & MIL–C–83517 SMA

MATERIAL SPECIFICATIONS

| PARTS NAME | | MIL STANDARD | ECONOMIC TYPE |
|---------------------------------------|--------|--|--|
| Body, coupling nut, other metal parts | | Non-magnetic stainless steel per QQ–S–764 #303 finish: passivated | Brass per QQ–B–626 finish: nickel or gold per requirement |
| Contacts | Male | Brass per QQ–B–626 | Brass per QQ–B–626 |
| | Female | Beryllium copper per QQ–C–530 heat treated per MIL–H–7199 | Beryllium copper per QQ–C–530 heat treated per MIL–H–7199 |
| | | Finish: .00005" min gold plated per MIL–G–45204 type 1, Grade C. | Finish: .00005" min gold plated per MIL–G–45204 type 1, Grade C. |
| Insulator | | PTFE | PTFE |
| Gasket | | Silicone rubber | Silicone rubber |
| Crimp ferrule | | Seamless copper tubing alloy | Seamless copper tubing alloy |
| Selection Guide | | *Suitable for direct mounting on aluminium panels *Lowest cost | *For commercial application only *Lower cost |



SMA COAXIAL CONNECTORS

INTERFACE MATING DIMENSIONS

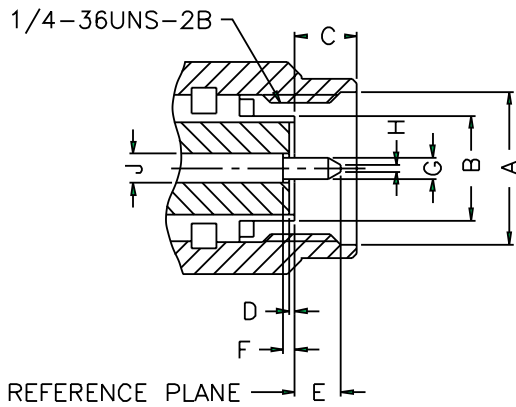

PLUG

| Letter | Millimeters [Inches] | |
|--------|----------------------|-------------|
| | Minimum | Maximum |
| A | 6.35 [.250] | 6.73 [.265] |
| B | 4.53 [.178] | 4.59 [.181] |
| C | 2.54 [.100] | 3.43 [.135] |
| D | 0.00 | 0.25 [.010] |
| E | 1.91 [.075] | 2.54 [.100] |
| F | 0.00 | 0.25 [.010] |
| G | 0.90 [.035] | 0.94 [.037] |
| H | 0.00 | 0.38 [.015] |
| J | 1.24 [.049] | 1.30 [.051] |

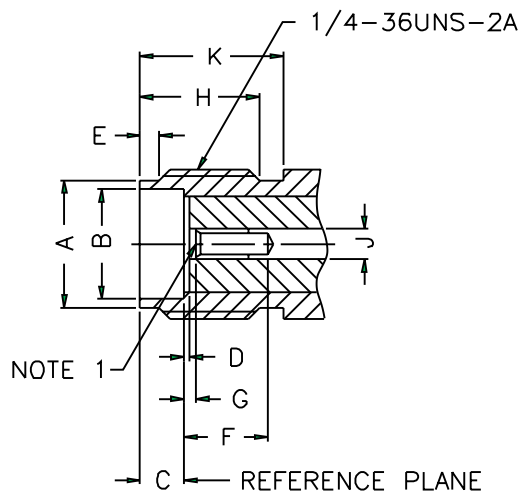

JACK

| Letter | Millimeters [Inches] | |
|--------|----------------------|-------------|
| | Minimum | Maximum |
| A | 5.28 [.208] | 5.49 [.216] |
| B | 4.60 [.181] | 4.67 [.184] |
| C | 1.88 [.074] | 1.98 [.078] |
| D | 0.00 | 0.25 [.010] |
| E | 0.38 [.015] | 1.14 [.045] |
| F | 2.92 [.115] | – |
| G | 0.00 | 0.25 [.010] |
| H | 4.32 [.170] | – |
| J | 1.24 [.049] | 1.30 [.051] |
| K | 5.54 [.218] | – |

NOTE: 1. I.D. TO MEET VSWR AND CONTACT RESISTANCE WHEN MATED WITH 1.32/1.37 MM DIA. PIN.

SMA COAXIAL CONNECTORS

All connectors listed, unless otherwise noted, are Commercial Grade construction, gold-plated brass bodies with 50 μ " gold contacts. All insulators are teflon. All other parameters are equal to Mil Standard construction.

Mil Standard connectors, i.e. Stainless Steel body, available upon request as per material specifications listed in Material section on preceding page.

All dimensions in millimeters and [inches].

| C A B L E G R O U P L E G E N D | | | | | |
|---------------------------------|---|-----|--|-----|-------------------------------------|
| 01 | 58/ 58A/ 58C/ 141/ 303/ LMR195™/ B7806A | 06A | 179/ U DOUBLE BRAIDED | 09 | B8227/ 89207 |
| 01A | 55/ 142/ 223/ 400 | 07 | 8/ 8A/ 213/ 393 | 10 | .141 SEMI-RIGID/ 402/U |
| 01B | LMR200™/ B7807A | 07A | 214 | 11 | .085 SEMI-RIGID/ 405/U |
| 02 | 58 PLENUM/THINNET/ 122U/ B88240/ B89907 | 07B | 8X/ LMR240™/ B7808A | 12 | .250 SEMI-RIGID |
| 03 | 59/ 62/ 140/ 210 | 07C | B9913/ LMR400™/ B7810A/ B8214 | 13 | .047 SEMI-RIGID/ B1674A |
| 03A | 59/ U-20AWG | 07D | B89913 | 14 | 178/ 196 |
| 04 | 59/ U PLENUM | 07E | 11 | 15 | B8281/ B9231/ B9141 |
| 04A | 59/ U PLENUM-20AWG | 07F | 11/ U-14AWG/ B8213/ B9292/ B7731/ B1859A | 15A | B88281 |
| 05 | 174/ 188A/ 316/ B7805A | 08 | 6/ 143/ 212 | 16 | 180/ 195/ 122/ B8218/ B1865A/ B1855 |
| 05A | 316/ U DOUBLE BRAIDED | 08A | B1694A/ B9248 | 17 | LMR600™ |
| 06 | 179/ 187/ B9221 | 08B | 6 PLENUM/ B1695A | 18 | AT&T734A/ B1505A |
| | | | | 19 | AT&T735A/ B735A1 |

DIRECT SOLDER FOR SEMI-RIGID .047", .085" AND .141" CABLE

STRAIGHT CABLE PLUG — CABLE CENTER CONTACT

| P.N. | Cable Group | Finish | Insulation | Impedance | Crimp Tool |
|----------|-------------|------------------------------------|------------|-----------|------------|
| 132100 | 10 | Gold | N/A | 50 | N/A |
| 132100SS | 10 | S/S STAINLESS STEEL | N/A | 50 | N/A |
| 132266 | 10 | Gold SHORT PROFILE | N/A | 50 | N/A |
| 132266SS | 10 | S/S STAINLESS STEEL, SHORT PROFILE | N/A | 50 | N/A |

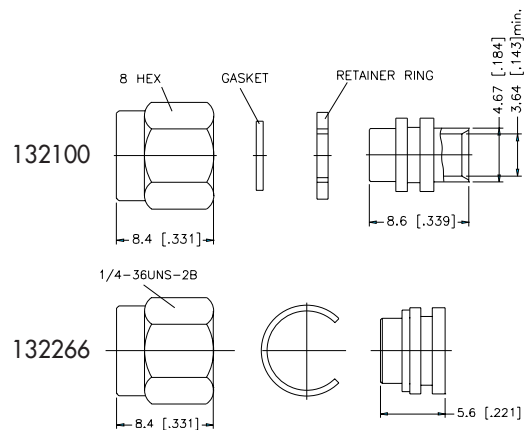

STRAIGHT CABLE PLUG — WITH CONTACT

| P.N. | Cable Group | Finish | Insulation | Impedance | Crimp Tool |
|--------|-------------|--------------------------|------------|-----------|------------|
| 132101 | 11 | Gold | Teflon | 50 | N/A |
| 132102 | 10 | Gold | Teflon | 50 | N/A |
| 132200 | 10 | Gold STAINLESS STEEL | Teflon | 50 | N/A |
| 132248 | 11 | Gold STAINLESS STEEL NUT | Teflon | 50 | N/A |
| 132296 | 12 | Gold | Teflon | 50 | N/A |
| 132249 | 13 | Gold | Teflon | 50 | N/A |

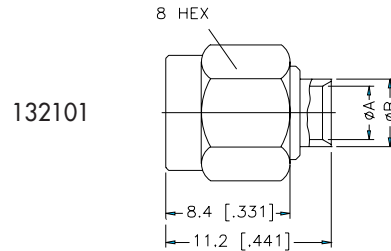

| | | | | | |
|-----------|----|----------------------|--------|----|-----|
| 132290 | 10 | Gold CONTACT IN BODY | Teflon | 50 | N/A |
| 132294 | 11 | Gold CONTACT IN BODY | Teflon | 50 | N/A |
| 132290-10 | 10 | Gold EXTENDED BODY | Teflon | 50 | N/A |
| 132294-10 | 11 | Gold EXTENDED BODY | Teflon | 50 | N/A |

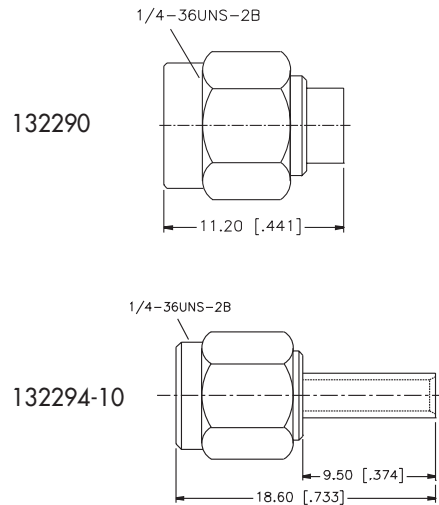

Cable: .047" Cable, A = 1.24 mm [.049"] min,
 B = 3.0 mm [.118"] min
 .085" Cable, A = 2.2 mm [.087"] min,
 B = 3.0 mm [.118"] min
 .141" Cable, A = 3.6 mm [.142"] min,
 B = 4.6 mm [.181"] min

For Reverse Polarized connectors, add RP to standard part number. Contact Connex marketing for availability.
 For Reverse Threaded connectors, add RT to standard part number. Contact Connex marketing for availability.
 For Crimp Tool information, see page 183.

DIRECT SOLDER FOR SEMI-RIGID .047", .085" AND .141" CABLE

For Cable Group Legend, see page 27

STRAIGHT CABLE PLUG — WITH CONTACT — TORQUE NUT

| P.N. | Cable Group | Finish | Insulation | Impedance | Crimp Tool |
|------|-------------|--------|------------|-----------|------------|
|------|-------------|--------|------------|-----------|------------|

| | | | | | |
|---------------------|----|------|--------|----|-----|
| 132179 | 10 | Gold | Teflon | 50 | N/A |
| STAINLESS STEEL NUT | | | | | |

| | | | | | |
|---------------------|----|------|--------|----|-----|
| 132188 | 11 | Gold | Teflon | 50 | N/A |
| STAINLESS STEEL NUT | | | | | |

Cable: .047" Cable, A = 1.24 mm [.049"] min,
B = 3.0 mm [.118"] min
.085" Cable, A = 2.2 mm [.087"] min,
B = 3.0 mm [.118"] min
.141" Cable, A = 3.6 mm [.142"] min,
B = 4.6 mm [.181"] min

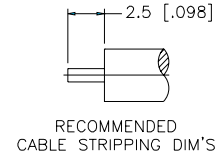
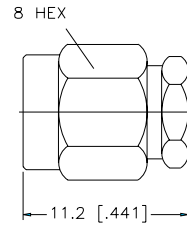
**RIGHT ANGLE CABLE PLUG DC — 12.4 GHz**

| P.N. | Cable Group | Finish | Insulation | Impedance | Crimp Tool |
|------|-------------|--------|------------|-----------|------------|
|------|-------------|--------|------------|-----------|------------|

| | | | | | |
|--------|----|------|--------|----|-----|
| 132112 | 10 | Gold | Teflon | 50 | N/A |
|--------|----|------|--------|----|-----|

| | | | | | |
|---------------------|----|------|--------|----|-----|
| 132201 | 10 | Gold | Teflon | 50 | N/A |
| STAINLESS STEEL NUT | | | | | |

| | | | | | |
|--------|----|------|--------|----|-----|
| 132111 | 11 | Gold | Teflon | 50 | N/A |
| 132250 | 13 | Gold | Teflon | 50 | N/A |

Cable: .047" Cable, A = 1.24 mm [.049"] min,
B = 3.0 mm [.118"] min
.085" Cable, A = 2.2 mm [.087"] min,
B = 3.0 mm [.118"] min
.141" Cable, A = 3.6 mm [.142"] min,
B = 4.6 mm [.181"] min

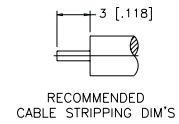
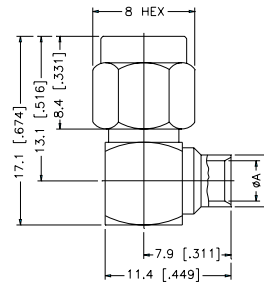
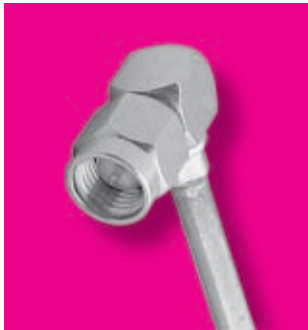
**STRAIGHT CABLE JACK**

| P.N. | Cable Group | Finish | Insulation | Impedance | Crimp Tool |
|------|-------------|--------|------------|-----------|------------|
|------|-------------|--------|------------|-----------|------------|

| | | | | | |
|--------|----|------|--------|----|-----|
| 132104 | 10 | Gold | Teflon | 50 | N/A |
| 132103 | 11 | Gold | Teflon | 50 | N/A |
| 132257 | 13 | Gold | Teflon | 50 | N/A |

Cable: .047" Cable, A = 1.24 mm [.049"] min,
B = 3.0 mm [.118"] min
.085" Cable, A = 2.2 mm [.087"] min,
B = 3.0 mm [.118"] min
.141" Cable, A = 3.6 mm [.142"] min,
B = 4.6 mm [.181"] min

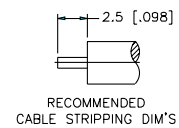
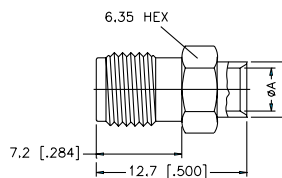
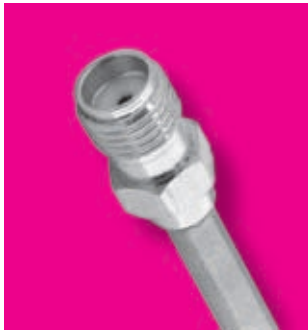
**BULKHEAD FEEDTHROUGH CABLE JACK — O-RING SEAL**

| P.N. | Cable Group | Finish | Insulation | Impedance | Crimp Tool |
|------|-------------|--------|------------|-----------|------------|
|------|-------------|--------|------------|-----------|------------|

| | | | | | |
|--------|----|------|--------|----|-----|
| 132106 | 10 | Gold | Teflon | 50 | N/A |
| 132105 | 11 | Gold | Teflon | 50 | N/A |
| 132251 | 13 | Gold | Teflon | 50 | N/A |

| | | | | | |
|---------------------|----|------|--------|----|-----|
| 132273 | 13 | Gold | Teflon | 50 | N/A |
| EXTENDED BODY .725" | | | | | |

Cable: .047" Cable, A = 1.24 mm [.049"] min,
B = 3.0 mm [.118"] min
.085" Cable, A = 2.2 mm [.087"] min,
B = 3.0 mm [.118"] min
.141" Cable, A = 3.6 mm [.142"] min,
B = 4.6 mm [.181"] min

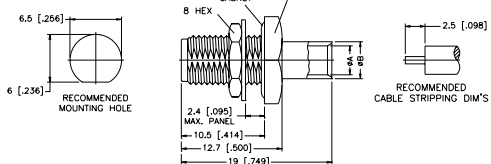
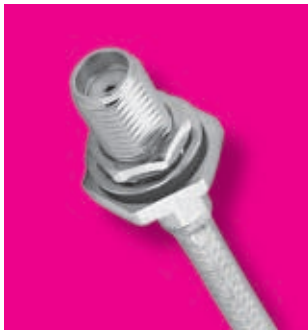

DIRECT SOLDER FOR SEMI-RIGID .047", .085" AND .141" CABLE

For Cable Group Legend, see page 27

PANEL MOUNT CABLE JACK — 4 HOLE SQUARE FLANGE

| P.N. | Cable Group | Finish | Insulation | Impedance | Crimp Tool |
|--------|-------------|--------|------------|-----------|------------|
| 132107 | 11 | Gold | Teflon | 50 | N/A |
| 132108 | 10 | Gold | Teflon | 50 | N/A |
| 132252 | 13 | Gold | Teflon | 50 | N/A |

Cable: .047" Cable, A = 1.24 mm [.049"] min,
B = 3.0 mm [.118"] min
.085" Cable, A = 2.2 mm [.087"] min,
B = 3.0 mm [.118"] min
.141" Cable, A = 3.6 mm [.142"] min,
B = 4.6 mm [.181"] min

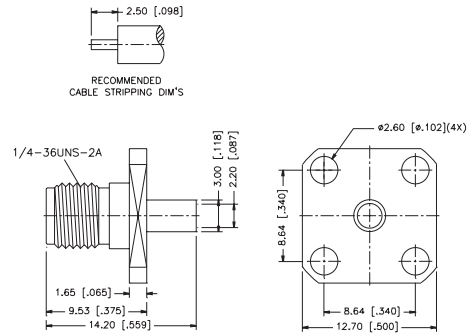
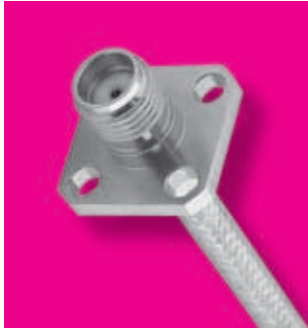

PANEL MOUNT CABLE JACK — 2 HOLE FLANGE

| P.N. | Cable Group | Finish | Insulation | Impedance | Crimp Tool |
|--------|-------------|--------|------------|-----------|------------|
| 132109 | 11 | Gold | Teflon | 50 | N/A |
| 132110 | 10 | Gold | Teflon | 50 | N/A |
| 132253 | 13 | Gold | Teflon | 50 | N/A |

Cable: .047" Cable, A = 1.24 mm [.049"] min,
B = 3.0 mm [.118"] min
.085" Cable, A = 2.2 mm [.087"] min,
B = 3.0 mm [.118"] min
.141" Cable, A = 3.6 mm [.142"] min,
B = 4.6 mm [.181"] min

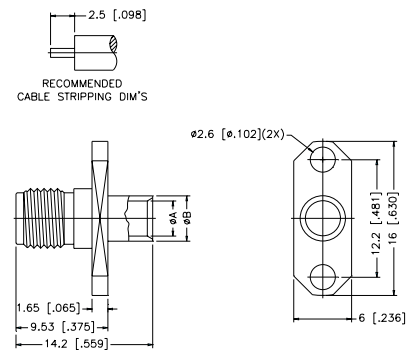

RIGHT ANGLE PANEL MOUNT CABLE JACK — 4-HOLE SQUARE FLANGE

| P.N. | Cable Group | Finish | Insulation | Impedance | Crimp Tool |
|--------|-------------|--------|------------|-----------|------------|
| 132293 | 11 | Gold | Teflon | 50 | N/A |
| 132292 | 10 | Gold | Teflon | 50 | N/A |

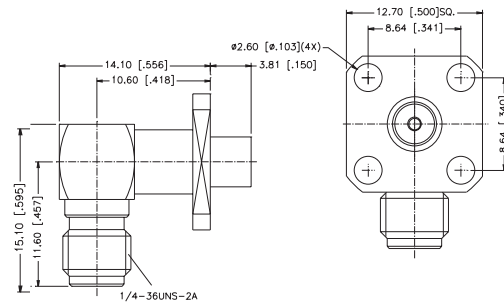
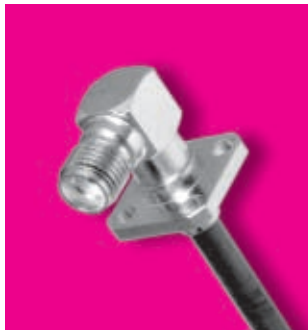

RIGHT ANGLE PANEL MOUNT CABLE JACK — 2-HOLE FLANGE

| P.N. | Cable Group | Finish | Insulation | Impedance | Crimp Tool |
|--------|-------------|--------|------------|-----------|------------|
| 132325 | 11 | Gold | Teflon | 50 | N/A |
| 132324 | 10 | Gold | Teflon | 50 | N/A |

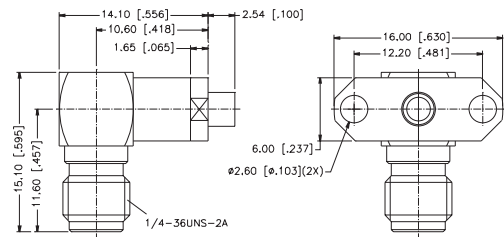
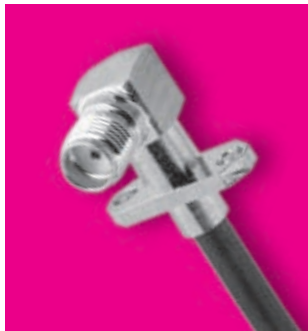

For Reverse Polarized connectors, add RP to standard part number. Contact Connex marketing for availability.
For Reverse Threaded connectors, add RT to standard part number. Contact Connex marketing for availability.
For Crimp Tool information, see page 183.

CRIMP TERMINATIONS FOR FLEXIBLE CABLE

For Cable Group Legend, see page 27

STRAIGHT CRIMP PLUG — STANDARD CABLE

| P.N. | Cable Group | Finish | Insulation | Impedance | Crimp Tool |
|--------|-------------|--------|------------|-----------|------------|
| 132113 | 01 | Gold | Teflon | 50 | A |
| 132195 | 01A | Gold | Teflon | 50 | A |
| 132234 | 01B | Gold | Teflon | 50 | A |
| 132231 | 07B | Gold | Teflon | 50 | A |
| 132298 | 07C | Gold | Teflon | 50 | L |

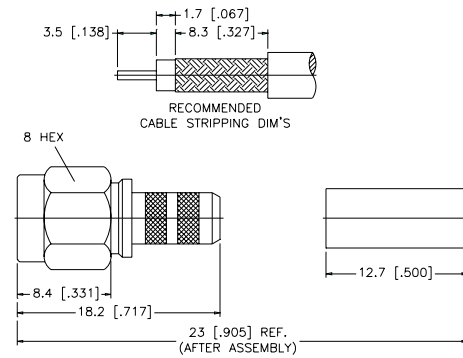

STRAIGHT CRIMP PLUG — MINIATURE CABLE

| P.N. | Cable Group | Finish | Insulation | Impedance | Crimp Tool |
|----------|---------------------|--------|------------|-----------|------------|
| 132114 | 05 | Gold | Teflon | 50 | B |
| 132114SS | 05 | Gold | Teflon | 50 | B |
| | STAINLESS STEEL | | | | |
| 132174 | 05 | Gold | Teflon | 50 | B |
| | STAINLESS STEEL NUT | | | | |
| 132178 | 05A | Gold | Teflon | 50 | C |
| 132193 | 14 | Gold | Teflon | 50 | B |
| 132242 | 16 | Gold | Teflon | 50 | B |

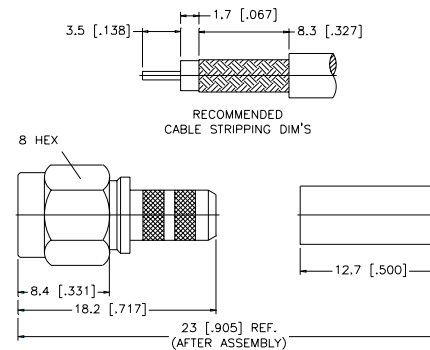

RIGHT ANGLE CRIMP PLUG — STANDARD CABLE

| P.N. | Cable Group | Finish | Insulation | Impedance | Crimp Tool |
|----------|-----------------|--------|------------|-----------|------------|
| 132122 | 01 | Gold | Teflon | 50 | A |
| 132122SS | 01 | Gold | Teflon | 50 | A |
| | STAINLESS STEEL | | | | |
| 132194 | 01A | Gold | Teflon | 50 | A |
| 132235 | 01B | Gold | Teflon | 50 | A |
| 132239 | 07B | Gold | Teflon | 50 | A |
| 132299 | 07C | Gold | Teflon | 50 | L |

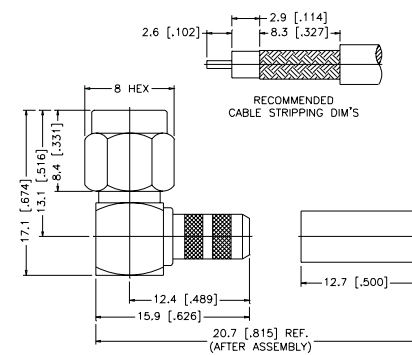

RIGHT ANGLE CRIMP PLUG — MINIATURE CABLE

| P.N. | Cable Group | Finish | Insulation | Impedance | Crimp Tool |
|--------|-------------|--------|------------|-----------|------------|
| 132123 | 05 | Gold | Teflon | 50 | B |
| 132182 | 05A | Gold | Teflon | 50 | C |
| 132173 | 14 | Gold | Teflon | 50 | B |
| 132272 | 16 | Gold | Teflon | 50 | B |

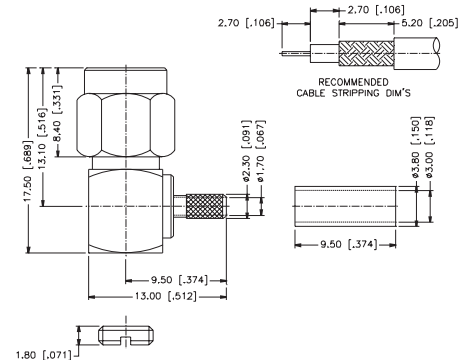

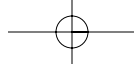

CRIMP TERMINATIONS FOR FLEXIBLE CABLE

For Cable Group Legend, see page 27

STRAIGHT CRIMP JACK — STANDARD & MINIATURE CABLE

| P.N. | Cable Group | Finish | Insulation | Impedance | Crimp Tool |
|------------------------|-------------|--------|------------|-----------|------------|
| STANDARD CABLE | | | | | |
| 132116 | 01 | Gold | Teflon | 50 | A |
| 132197 | 01A | Gold | Teflon | 50 | A |
| 132236 | 01B | Gold | Teflon | 50 | A |
| 132240 | 07B | Gold | Teflon | 50 | A |
| 132332 | 07C | Gold | Teflon | 50 | L |
| MINIATURE CABLE | | | | | |
| 132117 | 05 | Gold | Teflon | 50 | B |
| 132198 | 05A | Gold | Teflon | 50 | C |
| 132229 | 05 | Gold | Teflon | 50 | B |
| SHORT BODY | | | | | |
| 132279 | 14 | Gold | Teflon | 50 | B |

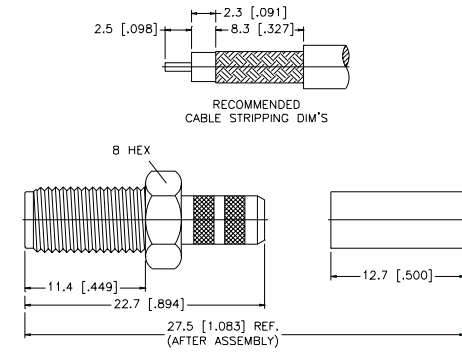

BULKHEAD CRIMP JACK — STANDARD & MINIATURE CABLE

| P.N. | Cable Group | Finish | Insulation | Impedance | Crimp Tool |
|------------------------|-------------|--------|------------|-----------|------------|
| STANDARD CABLE | | | | | |
| 132118 | 01 | Gold | Teflon | 50 | A |
| 132191 | 01A | Gold | Teflon | 50 | A |
| 132237 | 01B | Gold | Teflon | 50 | A |
| 132241 | 07B | Gold | Teflon | 50 | A |
| 132333 | 07C | Gold | Teflon | 50 | L |
| MINIATURE CABLE | | | | | |
| 132119 | 05 | Gold | Teflon | 50 | B |
| 132176 | 05A | Gold | Teflon | 50 | C |
| 132220 | 14 | Gold | Teflon | 50 | B |

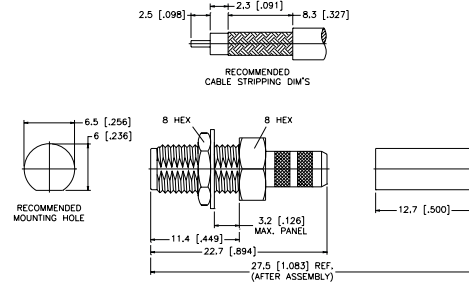

BULKHEAD CRIMP JACK — O-RING SEAL — STANDARD & MINIATURE CABLE

| P.N. | Cable Group | Finish | Insulation | Impedance | Crimp Tool |
|------------------------|-------------|--------|------------|-----------|------------|
| STANDARD CABLE | | | | | |
| 132280 | 01 | Gold | Teflon | 50 | A |
| 132281 | 01A | Gold | Teflon | 50 | A |
| 132282 | 01B | Gold | Teflon | 50 | A |
| 132283 | 07B | Gold | Teflon | 50 | A |
| MINIATURE CABLE | | | | | |
| 132284 | 05 | Gold | Teflon | 50 | B |
| 132285 | 05A | Gold | Teflon | 50 | C |
| 132286 | 14 | Gold | Teflon | 50 | B |

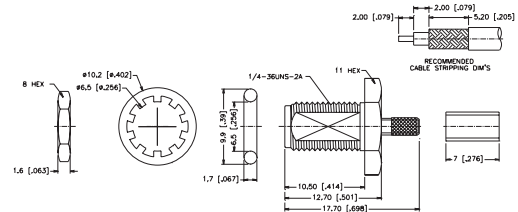
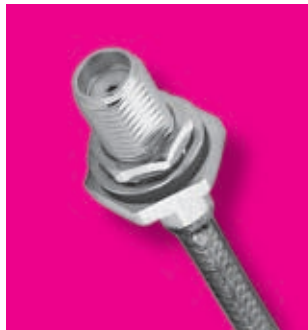

RIGHT ANGLE BULKHEAD CRIMP JACK — STANDARD & MINIATURE CABLE

| P.N. | Cable Group | Finish | Insulation | Impedance | Crimp Tool |
|--------|-------------|--------|------------|-----------|------------|
| 132246 | 01 | Gold | Teflon | 50 | A |
| 132260 | 01A | Gold | Teflon | 50 | A |
| 132245 | 05 | Gold | Teflon | 50 | B |
| 132259 | 05A | Gold | Teflon | 50 | C |

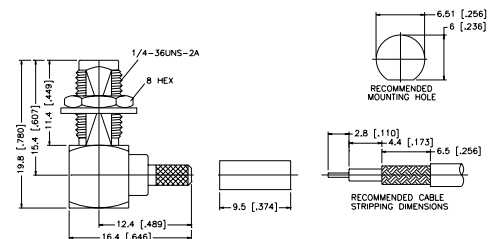
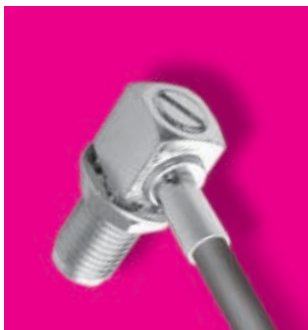

For Reverse Polarized connectors, add RP to standard part number. Contact Connex marketing for availability.
 For Reverse Threaded connectors, add RT to standard part number. Contact Connex marketing for availability.
 For Crimp Tool information, see page 183.

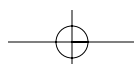

CRIMP TERMINATIONS FOR FLEXIBLE CABLE

For Cable Group Legend, see page 27

PANEL CRIMP JACK — STANDARD CABLE

| P.N. | Cable Group | Finish | Insulation | Impedance | Crimp Tool |
|--------|-------------|--------|------------|-----------|------------|
| 132120 | 01 | Gold | Teflon | 50 | A |
| 132254 | 01A | Gold | Teflon | 50 | A |

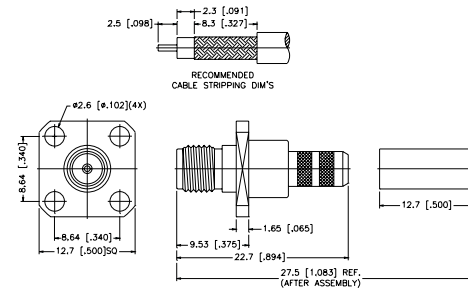

PANEL CRIMP JACK — MINIATURE CABLE

| P.N. | Cable Group | Finish | Insulation | Impedance | Crimp Tool |
|--------|-------------|--------|------------|-----------|------------|
| 132121 | 05 | Gold | Teflon | 50 | B |
| 132199 | 05A | Gold | Teflon | 50 | C |

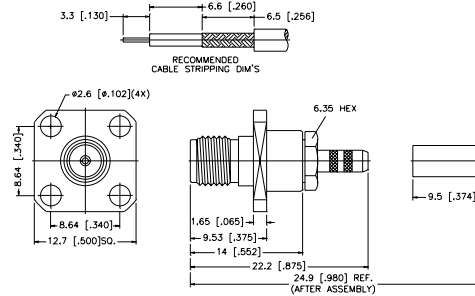

RIGHT ANGLE PANEL JACK — 4-HOLE FLANGE

| P.N. | Cable Group | Finish | Insulation | Impedance | Crimp Tool |
|--------|-------------|--------|------------|-----------|------------|
| 132326 | 05 | Gold | Teflon | 50 | B |
| 132321 | 05A | Gold | Teflon | 50 | C |
| 132327 | 14 | Gold | Teflon | 50 | B |

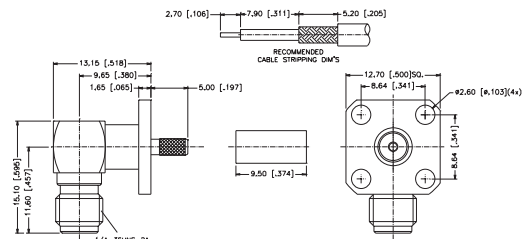

RIGHT ANGLE PANEL JACK — 2-HOLE FLANGE

| P.N. | Cable Group | Finish | Insulation | Impedance | Crimp Tool |
|--------|-------------|--------|------------|-----------|------------|
| 132328 | 05 | Gold | Teflon | 50 | B |
| 132329 | 05A | Gold | Teflon | 50 | C |
| 132330 | 14 | Gold | Teflon | 50 | B |

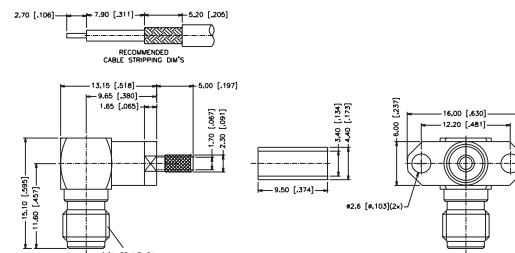
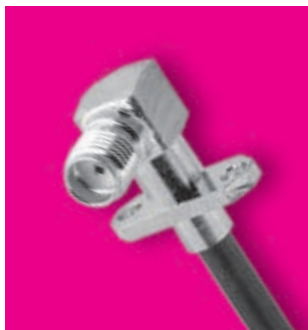

CLAMP TERMINATIONS FOR FLEXIBLE CABLE

For Cable Group Legend, see page 27

STRAIGHT CLAMP PLUG — STANDARD CABLE

| P.N. | Cable Group | Finish | Insulation | Impedance | Crimp Tool |
|--------|-------------|--------|------------|-----------|------------|
| 132125 | 01 | Gold | Teflon | 50 | N/A |

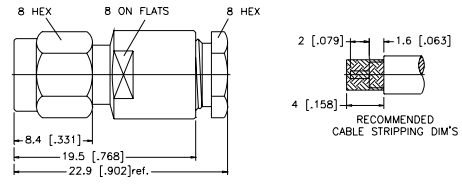

STRAIGHT CLAMP PLUG — MINIATURE CABLE

| P.N. | Cable Group | Finish | Insulation | Impedance | Crimp Tool |
|--------|-------------|--------|------------|-----------|------------|
| 132124 | 05 | Gold | Teflon | 50 | N/A |

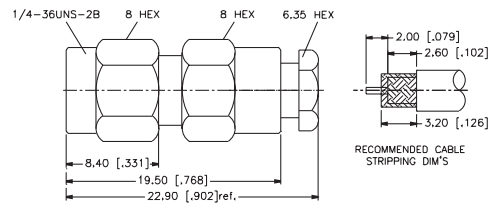
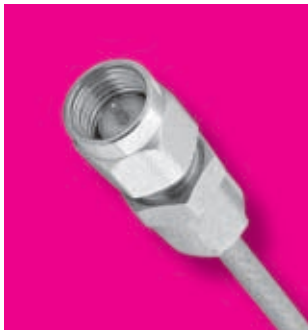

For Reverse Polarized connectors, add RP to standard part number. Contact Connex marketing for availability.
 For Reverse Threaded connectors, add RT to standard part number. Contact Connex marketing for availability.
 For Crimp Tool information, see page 183.

CLAMP TERMINATIONS FOR FLEXIBLE CABLE

For Cable Group Legend, see page 27

STRAIGHT CLAMP JACK — STANDARD CABLE

| P.N. | Cable Group | Finish | Insulation | Impedance | Crimp Tool |
|--------|-------------|--------|------------|-----------|------------|
| 132127 | 01 | Gold | Teflon | 50 | N/A |

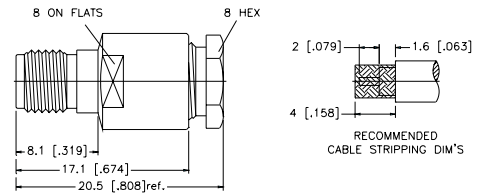
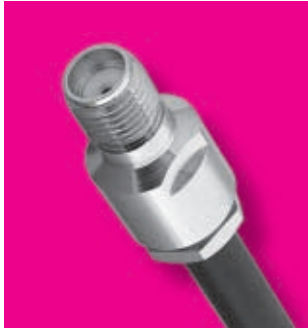

STRAIGHT CLAMP JACK — MINIATURE CABLE

| P.N. | Cable Group | Finish | Insulation | Impedance | Crimp Tool |
|--------|-------------|--------|------------|-----------|------------|
| 132126 | 05 | Gold | Teflon | 50 | N/A |

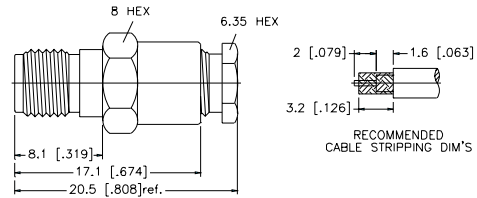

BULKHEAD CLAMP JACK — STANDARD CABLE

| P.N. | Cable Group | Finish | Insulation | Impedance | Crimp Tool |
|--------|-------------|--------|------------|-----------|------------|
| 132129 | 01 | Gold | Teflon | 50 | N/A |

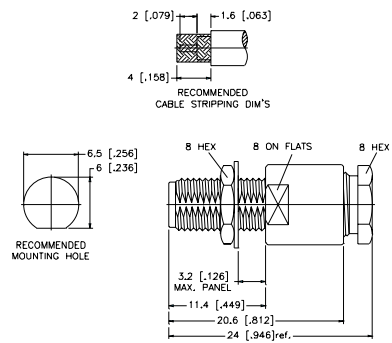

BULKHEAD CLAMP JACK — MINIATURE CABLE

| P.N. | Cable Group | Finish | Insulation | Impedance | Crimp Tool |
|--------|-------------|--------|------------|-----------|------------|
| 132128 | 05 | Gold | Teflon | 50 | N/A |

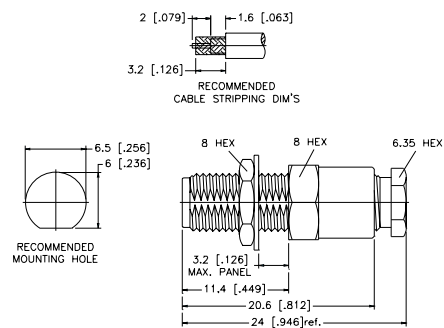

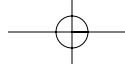

CLAMP TERMINATIONS FOR FLEXIBLE CABLE

For Cable Group Legend, see page 27

PANEL CLAMP JACK — MINIATURE CABLE

| P.N. | Cable Group | Finish | Insulation | Impedance | Crimp Tool |
|--------|-------------|--------|------------|-----------|------------|
| 132130 | 05 | Gold | Teflon | 50 | N/A |

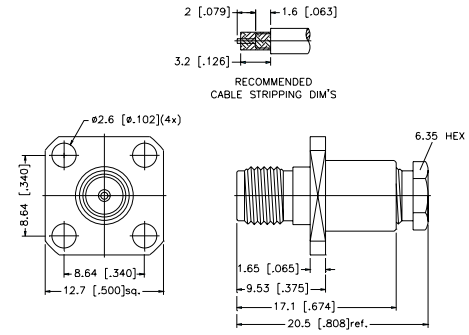

RIGHT ANGLE CLAMP PLUG — STANDARD CABLE

| P.N. | Cable Group | Finish | Insulation | Impedance | Crimp Tool |
|--------|-------------|--------|------------|-----------|------------|
| 132132 | 01 | Gold | Teflon | 50 | N/A |

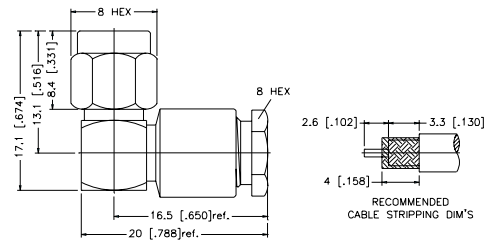
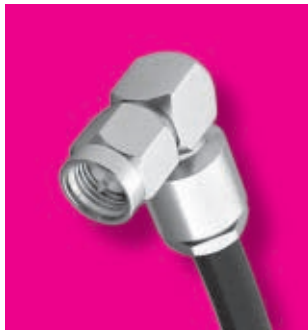

RIGHT ANGLE CLAMP PLUG — MINIATURE CABLE

| P.N. | Cable Group | Finish | Insulation | Impedance | Crimp Tool |
|--------|-------------|--------|------------|-----------|------------|
| 132131 | 05 | Gold | Teflon | 50 | N/A |

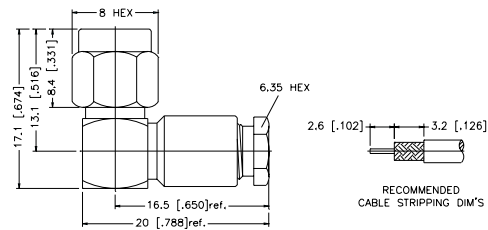
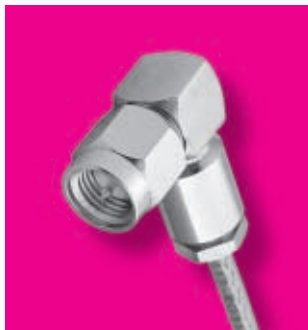

For Reverse Polarized connectors, add RP to standard part number. Contact Connex marketing for availability.
 For Reverse Threaded connectors, add RT to standard part number. Contact Connex marketing for availability.
 For Crimp Tool information, see page 183.

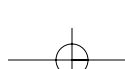

PRINTED CIRCUIT BOARD/STRAIGHT TERMINALS

For Cable Group Legend, see page 27

STRAIGHT PLUG FOR P.C. BOARD

| P.N. | Cable Group | Finish | Insulation | Impedance | Crimp Tool |
|--------|-------------|--------|------------|-----------|------------|
| 132133 | N/A | Gold | Teflon | 50 | N/A |

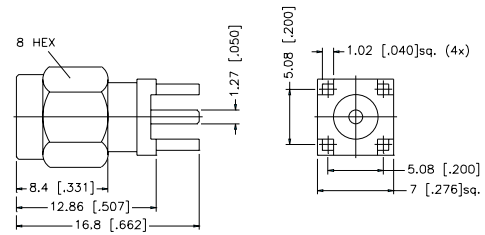

STRAIGHT JACK FOR P.C. BOARD

| P.N. | Cable Group | Finish | Insulation | Impedance | Crimp Tool |
|-----------|------------------|--------|------------|-----------|------------|
| 132134 | N/A | Gold | Teflon | 50 | N/A |
| 132134-10 | N/A | Gold | Teflon | 50 | N/A |
| | SURFACE MOUNT | | | | |
| 132319 | N/A | Gold | Teflon | 50 | N/A |
| | EXTENDED BOCY | | | | |
| 132320 | N/A | Gold | Teflon | 50 | N/A |
| | 2-HOLE PCB MOUNT | | | | |
| 132291 | N/A | Gold | Teflon | 50 | N/A |
| | BULKHEAD MOUNT | | | | |

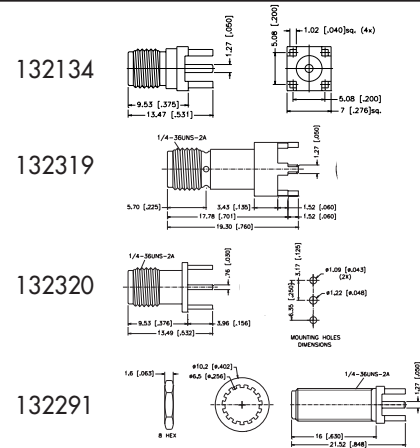

RIGHT ANGLE PLUG FOR P.C. BOARD

| P.N. | Cable Group | Finish | Insulation | Impedance | Crimp Tool |
|--------|-------------|--------|------------|-----------|------------|
| 132135 | N/A | Gold | Teflon | 50 | N/A |

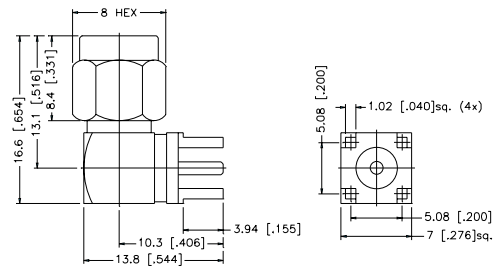

RIGHT ANGLE JACK FOR P.C. BOARD

| P.N. | Cable Group | Finish | Insulation | Impedance | Crimp Tool |
|--------|--------------|--------|------------|-----------|------------|
| 132136 | N/A | Gold | Teflon | 50 | N/A |
| 132225 | N/A | Gold | Teflon | 50 | N/A |
| | DIECAST BODY | | | | |

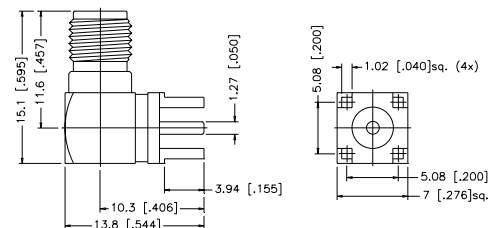

BULKHEAD MOUNT/SOLDER POT TERMINALS

For Cable Group Legend, see page 27

BULKHEAD JACK RECEPTACLE — FRONT MOUNT

| P.N. | Cable Group | Finish | Insulation | Impedance | Crimp Tool |
|--------|-------------|--------|------------|-----------|------------|
| 132137 | N/A | Gold | Teflon | 50 | N/A |



132137

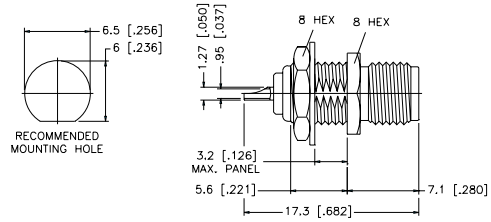

| | | | | | |
|--------|-----|------|--------|----|-----|
| 132271 | N/A | Gold | Teflon | 50 | N/A |
|--------|-----|------|--------|----|-----|

EXTENDED BODY, BLUNT POST

132271

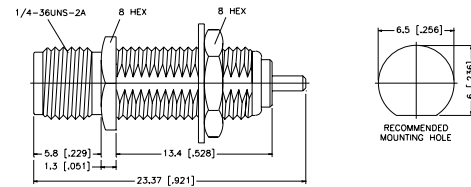

BULKHEAD JACK RECEPTACLE — REAR MOUNT

| P.N. | Cable Group | Finish | Insulation | Impedance | Crimp Tool |
|--------|-------------|--------|------------|-----------|------------|
| 132138 | N/A | Gold | Teflon | 50 | N/A |

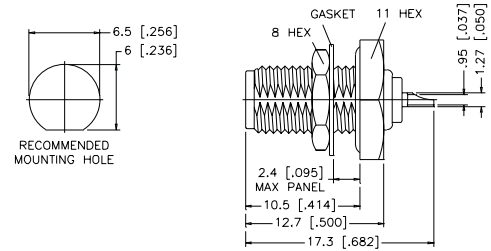

BULKHEAD JACK RECEPTACLE — REAR MOUNT

| P.N. | Cable Group | Finish | Insulation | Impedance | Crimp Tool |
|--------|-------------|--------|------------|-----------|------------|
| 132139 | N/A | Gold | Teflon | 50 | N/A |
| 132227 | N/A | Gold | Teflon | 50 | N/A |

FLATWASHER

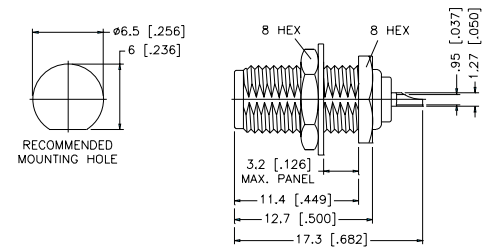

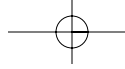

PANEL MOUNT/SOLDER POT TERMINALS

For Cable Group Legend, see page 27

PANEL MOUNT PLUG RECEPTACLE — 4-HOLE SQUARE FLANGE

| P.N. | Cable Group | Finish | Insulation | Impedance | Crimp Tool |
|--------|-------------|--------|------------|-----------|------------|
| 132140 | N/A | Gold | Teflon | 50 | N/A |

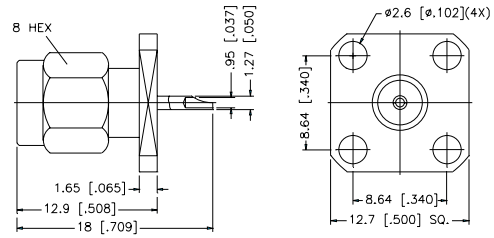

PANEL MOUNT PLUG RECEPTACLE — 2-HOLE FLANGE

| P.N. | Cable Group | Finish | Insulation | Impedance | Crimp Tool |
|--------|-------------|--------|------------|-----------|------------|
| 132141 | N/A | Gold | Teflon | 50 | N/A |

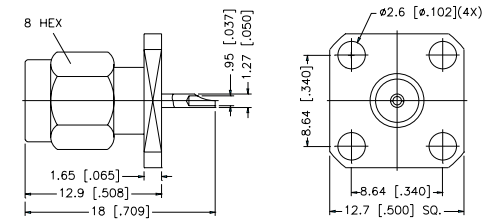

PANEL MOUNT JACK RECEPTACLE — 4-HOLE SQUARE FLANGE

| P.N. | Cable Group | Finish | Insulation | Impedance | Crimp Tool |
|--------------------------------|-------------|--------|------------|-----------|------------|
| 132142 | N/A | Gold | Teflon | 50 | N/A |
| 132215 | N/A | Gold | Teflon | 50 | N/A |
| 12.7 mm [.500"] MOUNTING HOLES | | | | | |
| 132304 | N/A | Gold | Teflon | 50 | N/A |
| 18.2 mm [.718"] MOUNTING HOLES | | | | | |

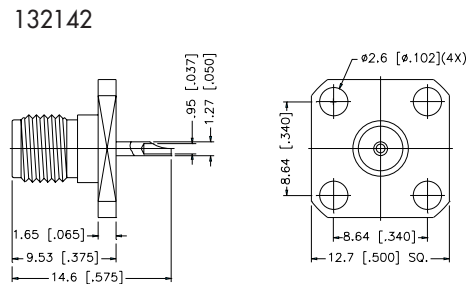

PANEL MOUNT JACK RECEPTACLE — 2-HOLE FLANGE

| P.N. | Cable Group | Finish | Insulation | Impedance | Crimp Tool |
|--------|-------------|--------|------------|-----------|------------|
| 132143 | N/A | Gold | Teflon | 50 | N/A |

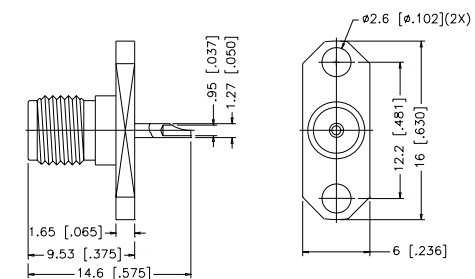

For Reverse Polarized connectors, add RP to standard part number. Contact Connex marketing for availability.
 For Reverse Threaded connectors, add RT to standard part number. Contact Connex marketing for availability.
 For Crimp Tool information, see page 183.

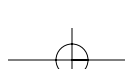

PANEL MOUNT/SOLDER POT TERMINALS

For Cable Group Legend, see page 27

RIGHT ANGLE PANEL MOUNT JACK RECEPTACLE — 4 HOLE SQUARE FLANGE

| P.N. | Cable Group | Finish | Insulation | Impedance | Crimp Tool |
|--------|-------------|--------|------------|-----------|------------|
| 132267 | N/A | Gold | Teflon | 50 | N/A |

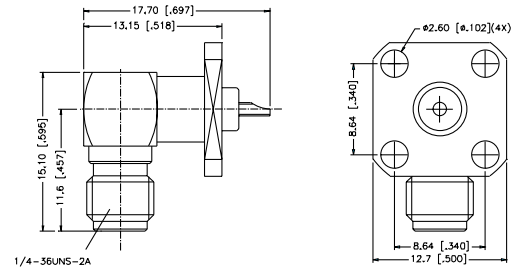

RIGHT ANGLE PANEL MOUNT JACK RECEPTACLE — 2-HOLE 90% FLANGE — EXPOSED TFE TYPE

| P.N. | Cable Group | Finish | Insulation | Impedance | Crimp Tool |
|--------|-------------|--------|------------|-----------|------------|
| 132275 | N/A | Gold | Teflon | 50 | N/A |

Remark: Extended teflon insulation available in various lengths. Contact Connex marketing department for part number and availability.

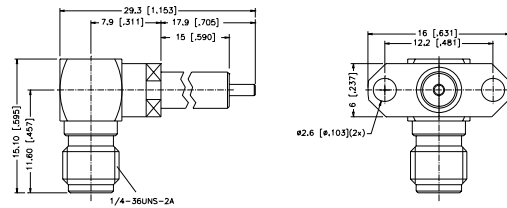

RIGHT ANGLE PANEL MOUNT JACK RECEPTACLE — 2-HOLE 45% FLANGE — EXPOSED TFE TYPE

| P.N. | Cable Group | Finish | Insulation | Impedance | Crimp Tool |
|--------|-------------|--------|------------|-----------|------------|
| 132276 | N/A | Gold | Teflon | 50 | N/A |
| 132288 | N/A | Gold | Teflon | 50 | N/A |

Remark: Extended teflon insulation available in various lengths. Contact Connex marketing department for part number and availability.

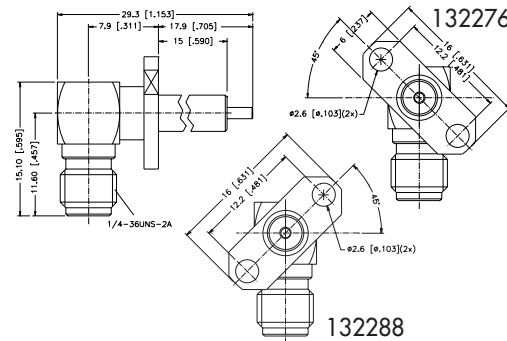

RIGHT ANGLE PANEL MOUNT RECEPTACLE — 4-HOLE FLANGE — EXPOSED TFE TYPE

| P.N. | Cable Group | Finish | Insulation | Impedance | Crimp Tool |
|--------|-------------|--------|------------|-----------|------------|
| 132318 | N/A | Gold | Teflon | 50 | N/A |

Remark: Extended teflon insulation available in various lengths. Contact Connex marketing department for part number and availability.

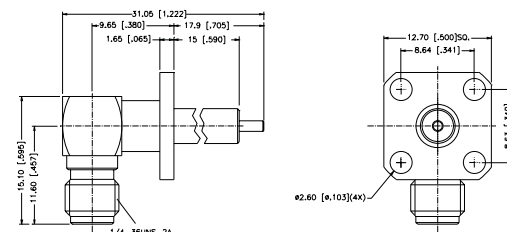

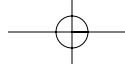

PANEL MOUNT/SOLDER POT TERMINALS

For Cable Group Legend, see page 27

PANEL MOUNT PLUG RECEPTACLE — 4-HOLE SQUARE FLANGE — EXPOSED TFE TYPE

| P.N. | Cable Group | Finish | Insulation | Impedance | Crimp Tool |
|--|-------------|--------|------------|-----------|------------|
| 132144 | N/A | Gold | Teflon | 50 | N/A |
| 132300 | N/A | Gold | Teflon | 50 | N/A |
| 0.25 (.010") contact, 3.17 (.125") Teflon diameter | | | | | |

Remark: Extended teflon insulation available in various lengths. Contact Connex marketing department for part number and availability.

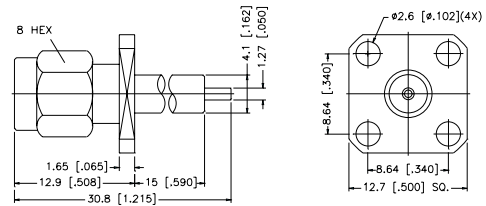

PANEL MOUNT PLUG RECEPTACLE — 2-HOLE FLANGE — EXPOSED TFE TYPE

| P.N. | Cable Group | Finish | Insulation | Impedance | Crimp Tool |
|--|-------------|--------|------------|-----------|------------|
| 132145 | N/A | Gold | Teflon | 50 | N/A |
| 132301 | N/A | Gold | Teflon | 50 | N/A |
| 0.25 (.010") contact, 3.17 (.125") Teflon diameter | | | | | |

Remark: Extended teflon insulation available in various lengths. Contact Connex marketing department for part number and availability.

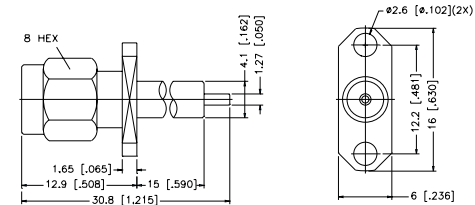

PANEL MOUNT JACK RECEPTACLE — 4-HOLE SQUARE FLANGE — EXPOSED TFE TYPE

| P.N. | Cable Group | Finish | Insulation | Impedance | Crimp Tool |
|--|-------------|--------|------------|-----------|------------|
| 132146 | N/A | Gold | Teflon | 50 | N/A |
| 132302 | N/A | Gold | Teflon | 50 | N/A |
| 0.25 (.010") contact, 3.17 (.125") Teflon diameter | | | | | |

Remark: Extended teflon insulation available in various lengths. Contact Connex marketing department for part number and availability.

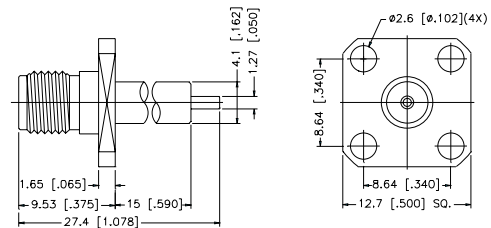

PANEL MOUNT JACK RECEPTACLE — 2-HOLE FLANGE — EXPOSED TFE TYPE

| P.N. | Cable Group | Finish | Insulation | Impedance | Crimp Tool |
|--|-------------|--------|------------|-----------|------------|
| 132147 | N/A | Gold | Teflon | 50 | N/A |
| 132224 | N/A | Gold | Teflon | 50 | N/A |
| 0.25 (.010") contact, 3.17 (.125") Teflon diameter | | | | | |

Remark: Extended teflon insulation available in various lengths. Contact Connex marketing department for part number and availability.

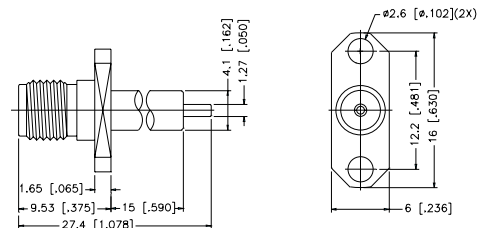

For Reverse Polarized connectors, add RP to standard part number. Contact Connex marketing for availability.
 For Reverse Threaded connectors, add RT to standard part number. Contact Connex marketing for availability.
 For Crimp Tool information, see page 183.

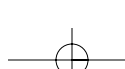

PANEL MOUNT/SOLDER POT TERMINALS

For Cable Group Legend, see page 27

PANEL MOUNT PLUG RECEPTACLE — 4 HOLE SQUARE FLANGE — BLUNT POST

| P.N. | Cable Group | Finish | Insulation | Impedance | Crimp Tool |
|--------|-------------|--------|------------|-----------|------------|
| 132148 | N/A | Gold | Teflon | 50 | N/A |

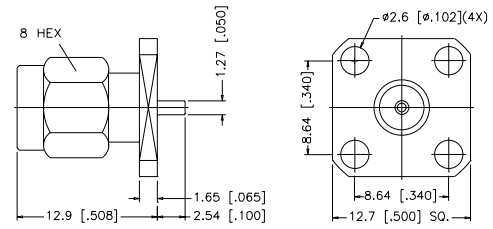

PANEL MOUNT PLUG RECEPTACLE — 2 HOLE FLANGE — BLUNT POST

| P.N. | Cable Group | Finish | Insulation | Impedance | Crimp Tool |
|--------|-------------|--------|------------|-----------|------------|
| 132149 | N/A | Gold | Teflon | 50 | N/A |

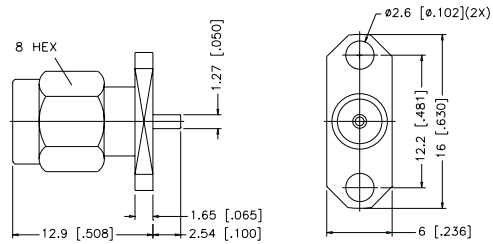

PANEL MOUNT JACK RECEPTACLE — 4 HOLE SQUARE FLANGE — BLUNT POST

| P.N. | Cable Group | Finish | Insulation | Impedance | Crimp Tool |
|---------------------|-------------|--------|------------|-----------|------------|
| 132150 | N/A | Gold | Teflon | 50 | N/A |
| 132204 | N/A | Gold | Teflon | 50 | N/A |
| 6.6 mm [.260"] POST | | | | | |

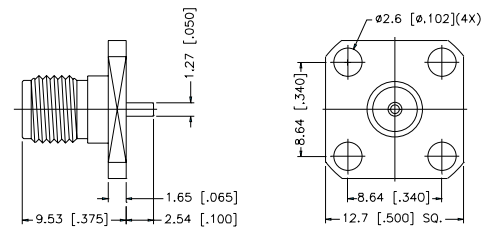

PANEL MOUNT JACK RECEPTACLE — 2 HOLE FLANGE — BLUNT POST

| P.N. | Cable Group | Finish | Insulation | Impedance | Crimp Tool |
|----------------------|-------------|--------|------------|-----------|------------|
| 132151 | N/A | Gold | Teflon | 50 | N/A |
| 132262 | N/A | Gold | Teflon | 50 | N/A |
| 8.37 mm [.330"] POST | | | | | |

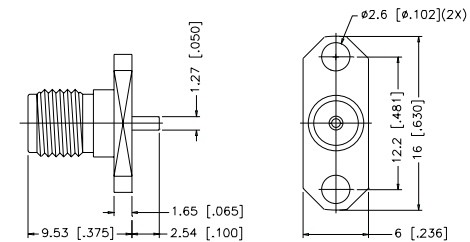

PANEL MOUNT/SOLDER POT TERMINALS

For Cable Group Legend, see page 27

PANEL MOUNT PLUG RECEPTACLE — 4-HOLE SQUARE FLANGE

| P.N. | Cable Group | Finish | Insulation | Impedance | Crimp Tool |
|--------|-------------|--------|------------|-----------|------------|
| 132152 | N/A | Gold | Teflon | 50 | N/A |

Remark: Size of slot width = 0.3 mm [.01"],
0.5 mm [.02"],
0.7 mm [.03"],

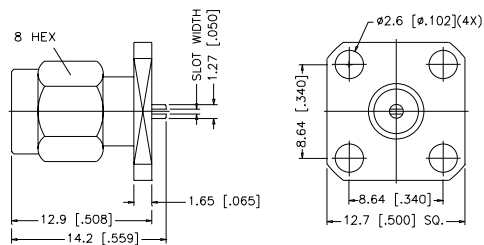

PANEL MOUNT PLUG RECEPTACLE — 2-HOLE FLANGE

| P.N. | Cable Group | Finish | Insulation | Impedance | Crimp Tool |
|--------|-------------|--------|------------|-----------|------------|
| 132153 | N/A | Gold | Teflon | 50 | N/A |

Remark: Size of slot width = 0.3 mm [.01"],
0.5 mm [.02"],
0.7 mm [.03"],

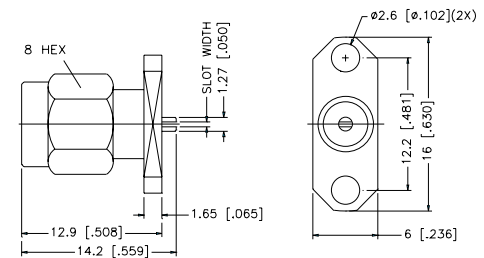

PANEL MOUNT JACK RECEPTACLE — 4-HOLE SQUARE FLANGE

| P.N. | Cable Group | Finish | Insulation | Impedance | Crimp Tool |
|--------|-------------|--------|------------|-----------|------------|
| 132154 | N/A | Gold | Teflon | 50 | N/A |

132214 N/A Gold Teflon 50 N/A
12.7 mm [.500"] MOUNTING HOLES

Remark: Size of slot width = 0.3 mm [.01"],
0.5 mm [.02"],
0.7 mm [.03"],

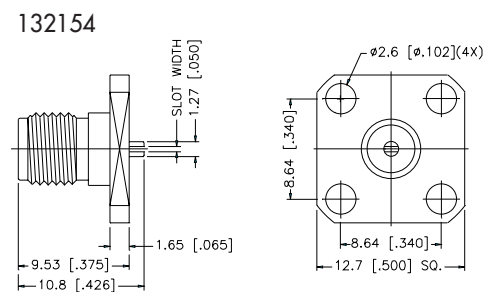

PANEL MOUNT JACK RECEPTACLE — 2-HOLE FLANGE

| P.N. | Cable Group | Finish | Insulation | Impedance | Crimp Tool |
|--------|-------------|--------|------------|-----------|------------|
| 132155 | N/A | Gold | Teflon | 50 | N/A |

Remark: Size of slot width = 0.3 mm [.01"],
0.5 mm [.02"],
0.7 mm [.03"],

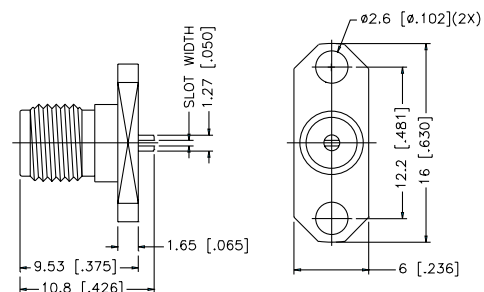

For Reverse Polarized connectors, add RP to standard part number. Contact Connex marketing for availability.
For Reverse Threaded connectors, add RT to standard part number. Contact Connex marketing for availability.
For Crimp Tool information, see page 183.

PANEL MOUNT/HALF ROUND POT TERMINALS

For Cable Group Legend, see page 27

PANEL MOUNT PLUG RECEPTACLE — 4 HOLE SQUARE FLANGE — HALF ROUND TERMINAL

| P.N. | Cable Group | Finish | Insulation | Impedance | Crimp Tool |
|--------|-------------|--------|------------|-----------|------------|
| 132156 | N/A | Gold | Teflon | 50 | N/A |

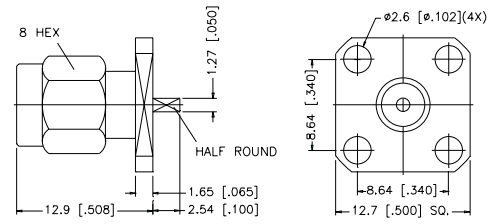

PANEL MOUNT PLUG RECEPTACLE — 2 HOLE FLANGE — HALF ROUND TERMINAL

| P.N. | Cable Group | Finish | Insulation | Impedance | Crimp Tool |
|--------|-------------|--------|------------|-----------|------------|
| 132157 | N/A | Gold | Teflon | 50 | N/A |

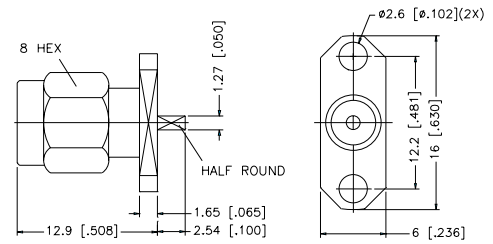

PANEL MOUNT JACK RECEPTACLE — 4 HOLE SQUARE FLANGE — HALF ROUND TERMINAL

| P.N. | Cable Group | Finish | Insulation | Impedance | Crimp Tool |
|--------|-------------|--------|------------|-----------|------------|
| 132158 | N/A | Gold | Teflon | 50 | N/A |

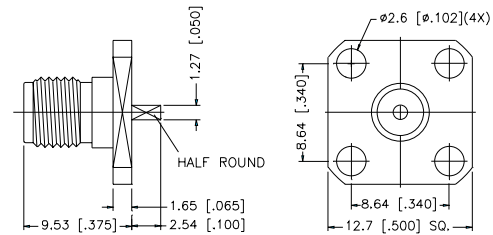

PANEL MOUNT JACK RECEPTACLE — 2 HOLE FLANGE — HALF ROUND TERMINAL

| P.N. | Cable Group | Finish | Insulation | Impedance | Crimp Tool |
|--------|-------------|--------|------------|-----------|------------|
| 132159 | N/A | Gold | Teflon | 50 | N/A |

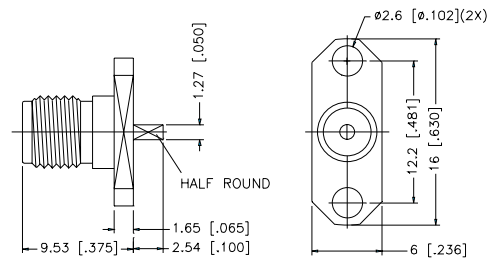

PANEL MOUNT/TERMINALS FLUSH TO BELOW FLANGE

For Cable Group Legend, see page 27

PANEL MOUNT PLUG RECEPTACLE — 4 HOLE SQ. FLANGE — TERMINAL FLUSH TO BELOW FLANGE

| P.N. | Cable Group | Finish | Insulation | Impedance | Crimp Tool |
|--------|-------------|--------|------------|-----------|------------|
| 132160 | N/A | Gold | Teflon | 50 | N/A |

Remark: Pin size of d = .305 mm [.012"],
.381 mm [.015"],
.457 mm [.018"]

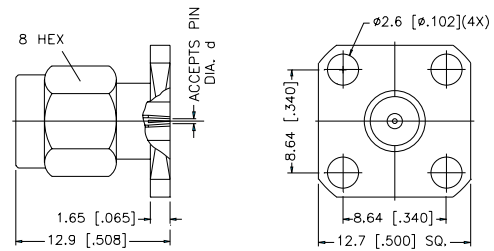

PANEL MOUNT PLUG RECEPTACLE — 2 HOLE FLANGE — TERMINAL FLUSH TO BELOW FLANGE

| P.N. | Cable Group | Finish | Insulation | Impedance | Crimp Tool |
|--------|-------------|--------|------------|-----------|------------|
| 132161 | N/A | Gold | Teflon | 50 | N/A |

Remark: Pin size of d = .305 mm [.012"],
.381 mm [.015"],
.457 mm [.018"]

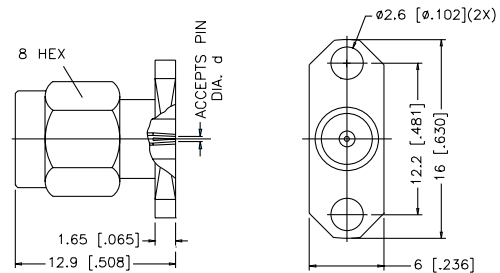

PANEL MOUNT JACK RECEPTACLE — 4 HOLE SQ. FLANGE — TERMINAL FLUSH TO BELOW FLANGE

| P.N. | Cable Group | Finish | Insulation | Impedance | Crimp Tool |
|--------|-------------|--------|------------|-----------|------------|
| 132162 | N/A | Gold | Teflon | 50 | N/A |

Remark: Pin size of d = .305 mm [.012"],
.381 mm [.015"],
.457 mm [.018"]

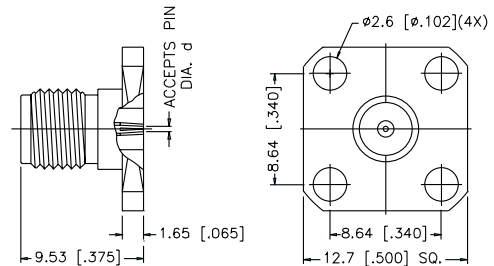

PANEL MOUNT JACK RECEPTACLE — 2 HOLE FLANGE — TERMINAL FLUSH TO BELOW FLANGE

| P.N. | Cable Group | Finish | Insulation | Impedance | Crimp Tool |
|--------|-------------|--------|------------|-----------|------------|
| 132163 | N/A | Gold | Teflon | 50 | N/A |

Remark: Pin size of d = .305 mm [.012"],
.381 mm [.015"],
.457 mm [.018"]

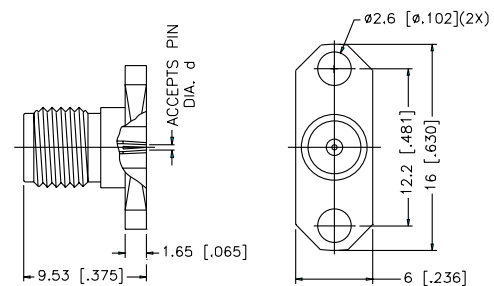

For Reverse Polarized connectors, add RP to standard part number. Contact Connex marketing for availability.
For Reverse Threaded connectors, add RT to standard part number. Contact Connex marketing for availability.
For Crimp Tool information, see page 183.

PANEL MOUNT/TAB TERMINALS

For Cable Group Legend, see page 27

PANEL MOUNT PLUG RECEPTACLE — 4 HOLE SQUARE FLANGE — TAB TERMINAL

| P.N. | Cable Group | Finish | Insulation | Impedance | Crimp Tool |
|--------|-------------|--------|------------|-----------|------------|
| 132164 | N/A | Gold | Teflon | 50 | N/A |

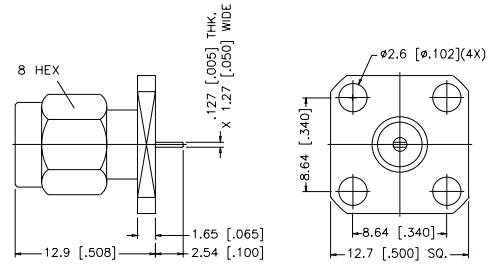

PANEL MOUNT PLUG RECEPTACLE — 2 HOLE FLANGE — TAB TERMINAL

| P.N. | Cable Group | Finish | Insulation | Impedance | Crimp Tool |
|--------|-------------|--------|------------|-----------|------------|
| 132165 | N/A | Gold | Teflon | 50 | N/A |

Remark: Specify horizontal or vertical tab when ordering

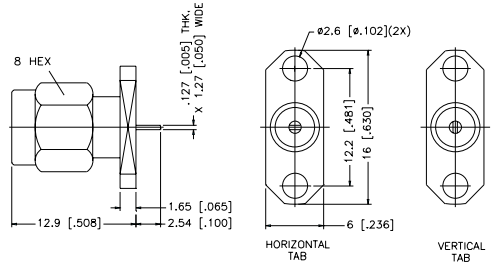

PANEL MOUNT JACK RECEPTACLE — 4 HOLE SQUARE FLANGE — TAB TERMINAL

| P.N. | Cable Group | Finish | Insulation | Impedance | Crimp Tool |
|--------|-------------|--------|------------|-----------|------------|
| 132166 | N/A | Gold | Teflon | 50 | N/A |

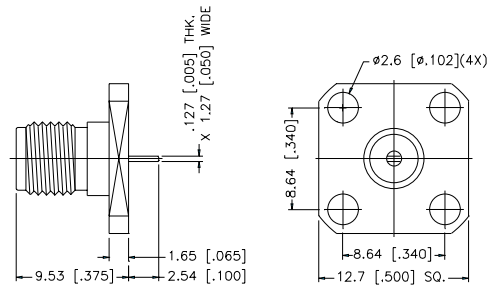

PANEL MOUNT JACK RECEPTACLE — 2 HOLE FLANGE — TAB TERMINAL

| P.N. | Cable Group | Finish | Insulation | Impedance | Crimp Tool |
|--------|-------------|--------|------------|-----------|------------|
| 132167 | N/A | Gold | Teflon | 50 | N/A |

Remark: Specify horizontal or vertical tab when ordering

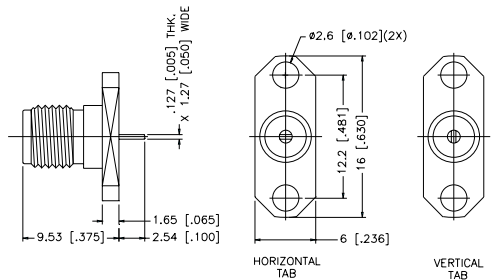

MINIATURE IN-SERIES ADAPTERS

For Cable Group Legend, see page 27

PLUG-TO-PLUG ADAPTER

| P.N. | Cable Group | Finish | Insulation | Impedance | Crimp Tool |
|----------------------|-------------|--------|------------|-----------|------------|
| 132168 | N/A | Gold | Teflon | 50 | N/A |
| 132168SS | N/A | S/S | Teflon | 50 | N/A |
| STAINLESS STEEL BODY | | | | | |

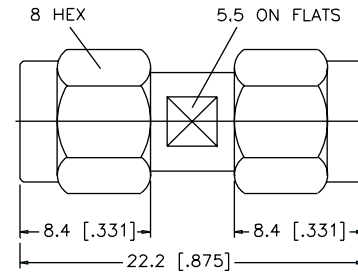

JACK-TO-JACK ADAPTER

| P.N. | Cable Group | Finish | Insulation | Impedance | Crimp Tool |
|----------------------|-------------|--------|------------|-----------|------------|
| 132169 | N/A | Gold | Teflon | 50 | N/A |
| 132169SS | N/A | S/S | Teflon | 50 | N/A |
| STAINLESS STEEL BODY | | | | | |

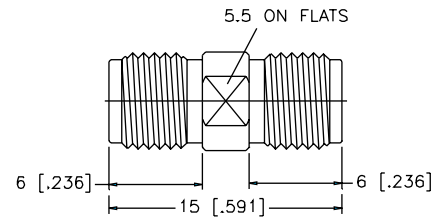

JACK-TO-JACK ADAPTER — BULKHEAD FEEDTHROUGH

| P.N. | Cable Group | Finish | Insulation | Impedance | Crimp Tool |
|-------------|-------------|--------|------------|-----------|------------|
| 132170 | N/A | Gold | Teflon | 50 | N/A |
| 132170-11 | N/A | Gold | Teflon | 50 | N/A |
| O-RING SEAL | | | | | |

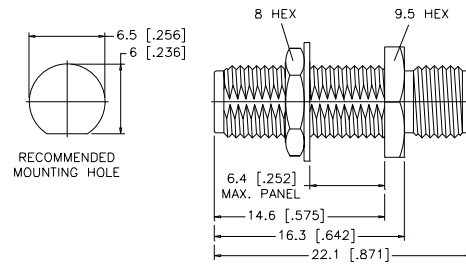

PLUG-TO-JACK ADAPTER

| P.N. | Cable Group | Finish | Insulation | Impedance | Crimp Tool |
|--------|-------------|--------|------------|-----------|------------|
| 132171 | N/A | Gold | Teflon | 50 | N/A |

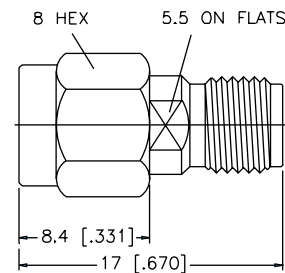

For Reverse Polarized connectors, add RP to standard part number. Contact Connex marketing for availability.
 For Reverse Threaded connectors, add RT to standard part number. Contact Connex marketing for availability.
 For Crimp Tool information, see page 183.

MINIATURE IN-SERIES ADAPTERS

For Cable Group Legend, see page 27

PLUG-TO-JACK ADAPTER — RIGHT ANGLE

| P.N. | Cable Group | Finish | Insulation | Impedance | Crimp Tool |
|--------|-------------|--------|------------|-----------|------------|
| 132172 | N/A | Gold | Teflon | 50 | N/A |

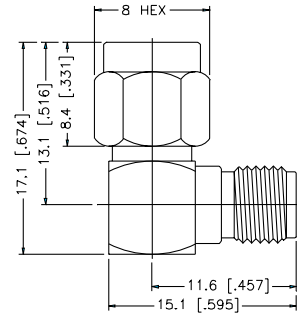
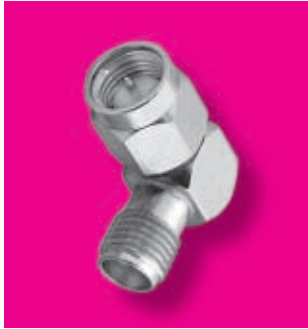

JACK-TO-JACK ADAPTER — RIGHT ANGLE

| P.N. | Cable Group | Finish | Insulation | Impedance | Crimp Tool |
|--------|-------------|--------|------------|-----------|------------|
| 132274 | N/A | Gold | Teflon | 50 | N/A |

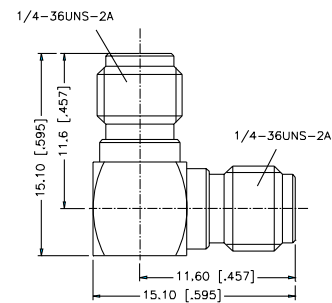

JACK-TO-JACK-TO-JACK TEE ADAPTER

| P.N. | Cable Group | Finish | Insulation | Impedance | Crimp Tool |
|--------|-------------|--------|------------|-----------|------------|
| 132216 | N/A | Gold | Teflon | 50 | N/A |

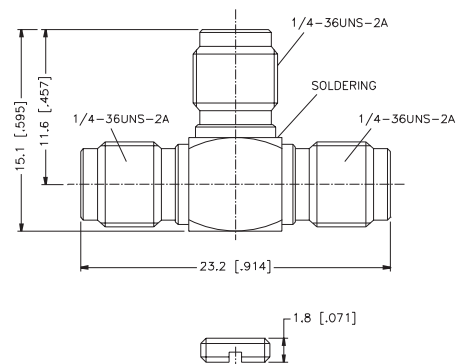

JACK-TO-PLUG-TO-JACK TEE ADAPTER

| P.N. | Cable Group | Finish | Insulation | Impedance | Crimp Tool |
|--------|-------------|--------|------------|-----------|------------|
| 132217 | N/A | Gold | Teflon | 50 | N/A |

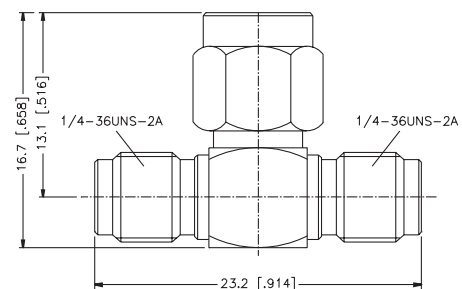

ACCESSORIES

For Cable Group Legend, see page 27

MALE CAP

| P.N. | Cable Group | Finish | Insulation | Impedance | Crimp Tool |
|-----------|-------------------------------|----------------------|------------|-----------|------------|
| 202112 | N/A | Gold | Teflon | 50 | N/A |
| 202112SS | N/A S/S STAINLESS STEEL | | Teflon | 50 | N/A |
| 202112-10 | N/A | Gold CAP & CHAIN | Teflon | 50 | N/A |
| 132331 | N/A | Gold SHORTING CAP | Teflon | 50 | N/A |

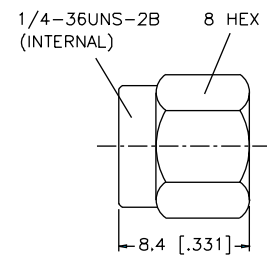

For Reverse Polarized connectors, add RP to standard part number. Contact Connex marketing for availability.
For Reverse Threaded connectors, add RT to standard part number. Contact Connex marketing for availability.
For Crimp Tool information, see page 183.

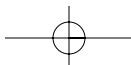
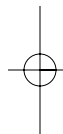
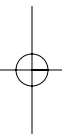
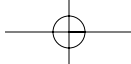



Компания «ЭлектроПласт» предлагает заключение долгосрочных отношений при поставках импортных электронных компонентов на взаимовыгодных условиях!

Наши преимущества:

- Оперативные поставки широкого спектра электронных компонентов отечественного и импортного производства напрямую от производителей и с крупнейших мировых складов;
- Поставка более 17-ти миллионов наименований электронных компонентов;
- Поставка сложных, дефицитных, либо снятых с производства позиций;
- Оперативные сроки поставки под заказ (от 5 рабочих дней);
- Экспресс доставка в любую точку России;
- Техническая поддержка проекта, помощь в подборе аналогов, поставка прототипов;
- Система менеджмента качества сертифицирована по Международному стандарту ISO 9001;
- Лицензия ФСБ на осуществление работ с использованием сведений, составляющих государственную тайну;
- Поставка специализированных компонентов (Xilinx, Altera, Analog Devices, Intersil, Interpoint, Microsemi, Aeroflex, Peregrine, Syfer, Eurofarad, Texas Instrument, Miteq, Cobham, E2V, MA-COM, Hittite, Mini-Circuits, General Dynamics и др.);

Помимо этого, одним из направлений компании «ЭлектроПласт» является направление «Источники питания». Мы предлагаем Вам помощь Конструкторского отдела:

- Подбор оптимального решения, техническое обоснование при выборе компонента;
- Подбор аналогов;
- Консультации по применению компонента;
- Поставка образцов и прототипов;
- Техническая поддержка проекта;
- Защита от снятия компонента с производства.



Как с нами связаться

Телефон: 8 (812) 309 58 32 (многоканальный)

Факс: 8 (812) 320-02-42

Электронная почта: org@eplast1.ru

Адрес: 198099, г. Санкт-Петербург, ул. Калинина, дом 2, корпус 4, литера А.