

D2MQ

Subminiature Basic Switch

Ultra Slim Snap-action Switch with 2.7 mm in depth

- Excellent electrical characteristics and snap action mechanism in spite of its ultra small size.
- Ideal for applications where size is extremely limited and high reliability is demanded.

RoHS Compliant

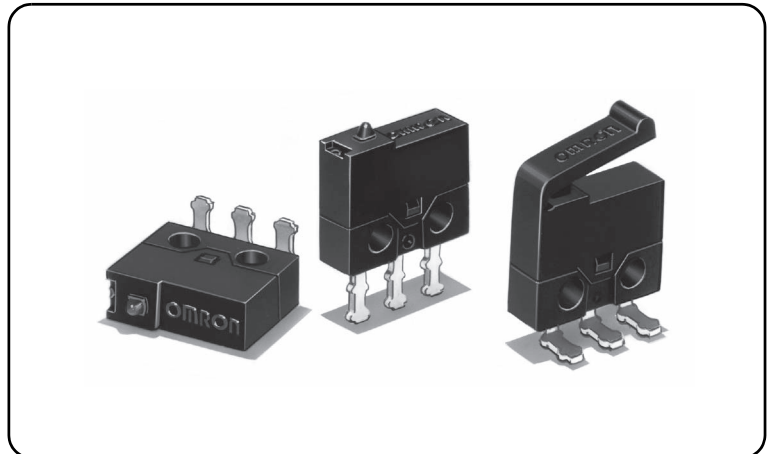

D
2
M
Q

Model Number Legend

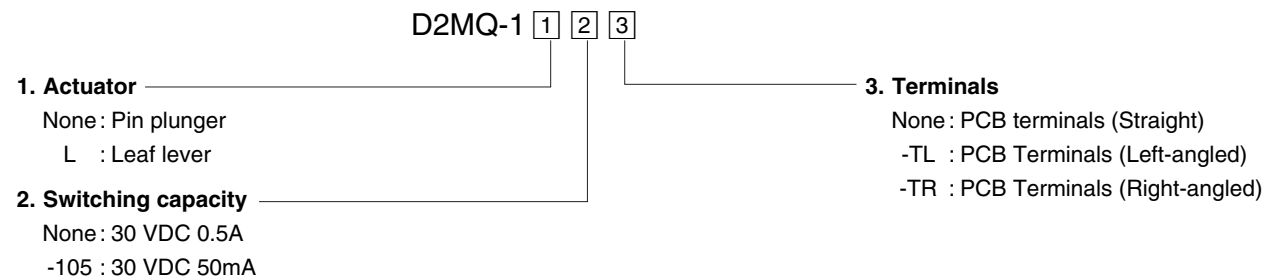

<Hinge lever>

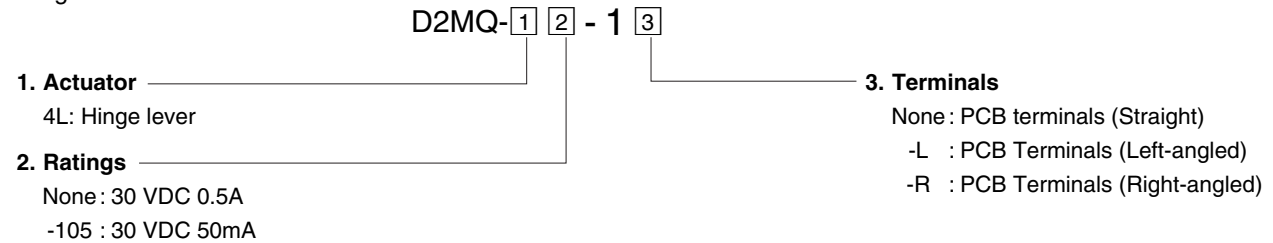

List of Models

| Ratings Terminals * | 0.5 A | | | 50 mA | | |
|------------------------|--------------------|-------------------------|--------------------------|--------------------|-------------------------|--------------------------|
| | Straight terminals | Left-angled terminals * | Right angled terminals * | Straight terminals | Left-angled terminals * | Right angled terminals * |
| Actuator | | | | | | |
| Pin plunger | D2MQ-1 | D2MQ-1-TL | D2MQ-1-TR | D2MQ-1-105 | - | - |
| Leaf lever | D2MQ-1L | D2MQ-1L-TL | D2MQ-1L-TR | D2MQ-1L-105 | - | - |
| Hinge lever | D2MQ-4L-1 | D2MQ-4L-1-L | D2MQ-4L-1-R | D2MQ-4L-105-1 | D2MQ-4L-105-1-L | D2MQ-4L-105-1-R |

* The terminal shape drawings indicate the shape when the Switch is viewed from the direction of the arrow in the drawing below.

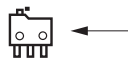

Contact Form

●SPDT

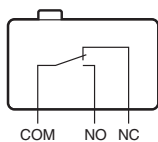

Contact Specifications

| Item | Model | 0.5 A models | 50 mA models |
|------------------------------------|----------------------|---------------|--------------|
| Contact | Specification | Rivet | |
| | Material | Silver plated | Gold plated |
| | Gap (standard value) | 0.15 mm | |
| Minimum applicable load (see note) | | 5 VDC 50 mA | 5 VDC 5 mA |

Ratings

| Type | 0.5A models | 50mA models |
|---------------|----------------|-------------|
| Rated voltage | Resistive load | |
| Item | 0.5A | 50 mA |
| 30 VDC | | |

Note. The above rating values apply under the following test conditions.

- (1) Ambient temperature: 20±2°C
- (2) Ambient humidity: 65±5%
- (3) Operating frequency: 30 operations/min

Characteristics

| | | |
|------------------------------------|--|--|
| Permissible operating speed | 0.1 mm to 0.5 mm/s (for pin plunger models) | |
| Permissible operating frequency | Mechanical | 60 operations/min |
| | Electrical | 30 operations/min |
| Insulation resistance | 100 MΩ min. (at 250 VDC with insulation tester) | |
| Contact resistance (initial value) | 100 mΩ max. | |
| Dielectric strength | Between terminals of the same polarity | 500 VAC 50/60 Hz 1min |
| | Between current-carrying metal parts and ground | 500 VAC 50/60 Hz 1min |
| Vibration resistance * 1 | Malfunction | 10 to 55 Hz, 1.5 mm double amplitude |
| Shock resistance | Durability | 1,000 m/s ² {approx. 100G} max. |
| | Malfunction * 1 | 300 m/s ² {approx. 30G} max. |
| Durability * 2 | Mechanical | 30,000 operations min. (60 operations/min) |
| | Electrical | 10,000 operations min. (30 operations/min) |
| Degree of protection | IEC IP40 | |
| Ambient operating temperature | -15°C to +70°C (at ambient humidity of 60% max.) (with no icing or condensation) | |
| Ambient operating humidity | 35% to 85% (for +5°C to +35°C) | |
| Weight | Approx. 0.3g | |

Note. The data given above are initial values.

- *1. For the pin plunger models, the above values apply for use at the free position and total travel position. For the lever models, they apply at the total travel position. Close or open circuit of the contact is 1ms max.
- *2. For testing conditions, consult your OMRON sales representative.

Terminals/Apearances (Unit:mm)

●PCB terminals (Straight)

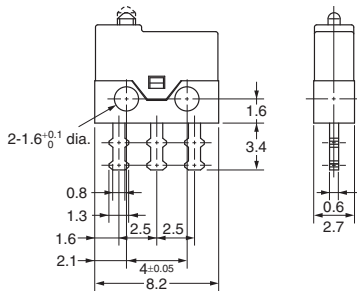

●PCB terminals (Left-angled)

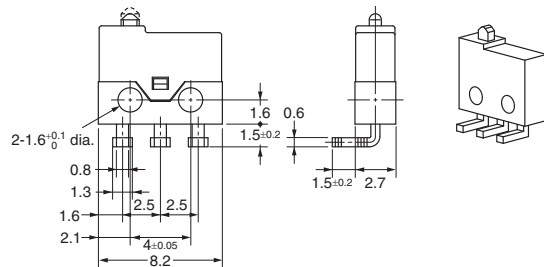

●PCB terminals (Right-angled)

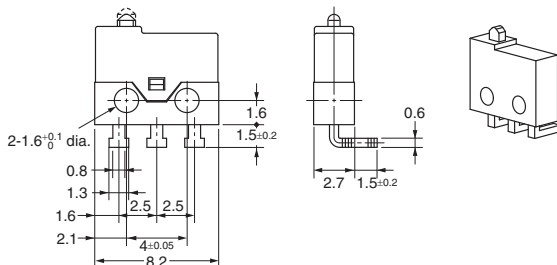

<PCB Mounting Dimensions (Reference)>

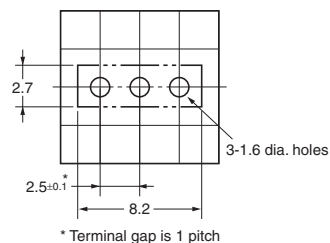

Mounting Holes (Unit: mm)

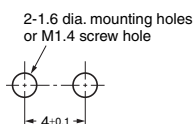

Dimensions (Unit: mm) / Operating Characteristics

The illustrations and drawings are for PCB terminals (straight) models.

Refer to "Terminals/Appearances" of the previous page for details on models with PCB terminals (Right-angled) and PCB terminals (Left-angled).

● Pin plunger Models

D2MQ-1 **D2MQ-1-TR**
D2MQ-1-TL **D2MQ-1-105**

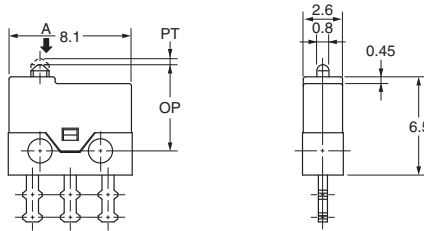
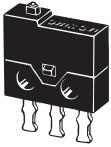

| | | |
|-----------------------|---------|----------------|
| Operating Force | OF Max. | 1.18N {120 gf} |
| Releasing Force | RF Min. | 0.20N {21 gf} |
| Pretravel | PT Max. | 0.4 mm |
| Overtravel | OT Min. | 0.1 mm |
| Movement Differential | MD Max. | 0.1 mm |
| Operating Position | OP | 5.7±0.2 mm |

● Leaf lever Models

D2MQ-1L **D2MQ-1L-TR**
D2MQ-1L-TL **D2MQ-1L-105**

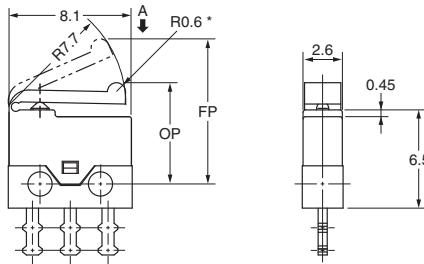
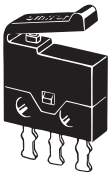

| | | |
|-----------------------|---------|---------------|
| Operating Force | OF Max. | 0.59N {60 gf} |
| Releasing Force | RF Min. | 0.08N {8 gf} |
| Pretravel | PT Max. | 2.4 mm |
| Overtravel | OT Min. | 0.3 mm |
| Movement Differential | MD Max. | 0.7 mm |
| Free Position | FP Max. | 9.6 mm |
| Operating Position | OP | 6.7±0.5 mm |

* Plastic lever

● Hinge lever Models

D2MQ-4L-1 **D2MQ-4L-105-1**
D2MQ-4L-1-L **D2MQ-4L-105-1-L**
D2MQ-4L-1-R **D2MQ-4L-105-1-R**

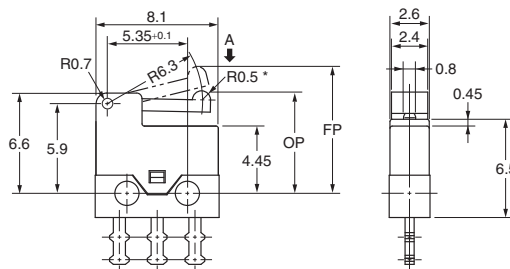
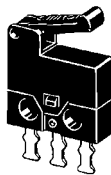

| | | |
|-----------------------|---------|---------------|
| Operating Force | OF Max. | 0.39N {40 gf} |
| Releasing Force | RF Min. | 0.04N {4 gf} |
| Pretravel | PT Max. | 2.1 mm |
| Overtravel | OT Min. | 0.3 mm |
| Movement Differential | MD Max. | 0.7 mm |
| Free Position | FP Max. | 8.7 mm |
| Operating Position | OP | 7.1±0.5 mm |

* Plastic lever

Note 1. Unless otherwise specified, a tolerance of ±0.15 mm applies to all dimensions.

Note 2. The operating characteristics are for operation in the A direction (↓).

Precautions

★ Please refer to "Basic Switches Common Precautions" for correct use.

Cautions

● Soldering

- Terminal connections
 When soldering terminals manually, perform soldering within 3 seconds at iron tip temperature no higher than 300°C. Do not apply any external force for 1 minute after soldering. When applying solder, keep the solder away from the case of the Switch and do not allow solder or flux to flow into the case. It is recommended that you apply flux guard to the mounting surface of the Switch.

Correct Use

● Mounting

Use M1.4 mounting screw with plane washers or spring washers to securely mount the Switch. Tighten the screws to a torque of 0.08 to 0.1 N·m {0.8 to 1 kgf·cm}.

● Operation

- Do not apply a force more than two times the rated operating force to the actuator and leaf lever.
- Provide an amount of OT that equals or exceeds the standard.
- Do not change the operating position by modifying the actuator.
- Do not use the Switch in an application where the operating speed is extremely slow or the actuator is set in the midpoint between the free position and operating position.
- Mount the pin plunger so that the operating force is applied in perpendicular alignment with the stroke of the actuator.
- Do not apply a shock to the actuator, otherwise, the Switch may be damaged.
- Do not apply excessive force to the actuator of the Leaf Lever Switch in the operating, releasing, and horizontal directions.

• Application examples provided in this document are for reference only. In actual applications, confirm equipment functions and safety before using the product.
• Consult your OMRON representative before using the product under conditions which are not described in the manual or applying the product to nuclear control systems, railroad systems, aviation systems, vehicles, combustion systems, medical equipment, amusement machines, safety equipment, and other systems or equipment that may have a serious influence on lives and property if used improperly. Make sure that the ratings and performance characteristics of the product provide a margin of safety for the system or equipment, and be sure to provide the system or equipment with double safety mechanisms.

Note: Do not use this document to operate the Unit.

OMRON Corporation

ELECTRONIC AND MECHANICAL COMPONENTS COMPANY

Contact: www.omron.com/ecb

Cat. No. B034-E1-08
0812(0207)(O)



Компания «ЭлектроПласт» предлагает заключение долгосрочных отношений при поставках импортных электронных компонентов на взаимовыгодных условиях!

Наши преимущества:

- Оперативные поставки широкого спектра электронных компонентов отечественного и импортного производства напрямую от производителей и с крупнейших мировых складов;
- Поставка более 17-ти миллионов наименований электронных компонентов;
- Поставка сложных, дефицитных, либо снятых с производства позиций;
- Оперативные сроки поставки под заказ (от 5 рабочих дней);
- Экспресс доставка в любую точку России;
- Техническая поддержка проекта, помощь в подборе аналогов, поставка прототипов;
- Система менеджмента качества сертифицирована по Международному стандарту ISO 9001;
- Лицензия ФСБ на осуществление работ с использованием сведений, составляющих государственную тайну;
- Поставка специализированных компонентов (Xilinx, Altera, Analog Devices, Intersil, Interpoint, Microsemi, Aeroflex, Peregrine, Syfer, Eurofarad, Texas Instrument, Miteq, Cobham, E2V, MA-COM, Hittite, Mini-Circuits, General Dynamics и др.);

Помимо этого, одним из направлений компании «ЭлектроПласт» является направление «Источники питания». Мы предлагаем Вам помощь Конструкторского отдела:

- Подбор оптимального решения, техническое обоснование при выборе компонента;
- Подбор аналогов;
- Консультации по применению компонента;
- Поставка образцов и прототипов;
- Техническая поддержка проекта;
- Защита от снятия компонента с производства.



Как с нами связаться

Телефон: 8 (812) 309 58 32 (многоканальный)

Факс: 8 (812) 320-02-42

Электронная почта: org@eplast1.ru

Адрес: 198099, г. Санкт-Петербург, ул. Калинина, дом 2, корпус 4, литера А.