

OVG Series

Features

- 105°C, 15,000 hours assured
- Ultra low ESR with large permissible ripple current
- RoHS Compliance



Marking color: Blue

Specifications

| Items | Performance | | | | | | | | | | |
|--|---|-----------------------------------|------------------------------|--------------------|-----------------------------------|-----------------|-----------------------------------|-----------------|-----------------------------------|-----------------|------------------------|
| Category Temperature Range | -55°C ~ +105°C | | | | | | | | | | |
| Capacitance Tolerance | ±20% (at 120Hz, 20°C) | | | | | | | | | | |
| Leakage Current (at 20°C)* | Rated voltage applied, after 2 minutes at 20°C. See Standard Ratings | | | | | | | | | | |
| Tanδ (at 120Hz, 20°C) | See Standard Ratings | | | | | | | | | | |
| ESR (at 100k ~ 300k Hz, 20°C) | See Standard Ratings | | | | | | | | | | |
| Endurance | <table border="1"> <tr> <td>Test Time</td> <td>15,000 Hrs</td> </tr> <tr> <td>Capacitance Change</td> <td>Within ±20% of initial value</td> </tr> <tr> <td>Tanδ</td> <td>Less than 150% of specified value</td> </tr> <tr> <td>ESR</td> <td>Less than 150% of specified value</td> </tr> <tr> <td>Leakage Current</td> <td>Within specified value</td> </tr> </table> | Test Time | 15,000 Hrs | Capacitance Change | Within ±20% of initial value | Tanδ | Less than 150% of specified value | ESR | Less than 150% of specified value | Leakage Current | Within specified value |
| | Test Time | 15,000 Hrs | | | | | | | | | |
| | Capacitance Change | Within ±20% of initial value | | | | | | | | | |
| | Tanδ | Less than 150% of specified value | | | | | | | | | |
| | ESR | Less than 150% of specified value | | | | | | | | | |
| Leakage Current | Within specified value | | | | | | | | | | |
| * The above specifications shall be satisfied when the capacitors are restored to 20°C after the rated voltage applied for 15,000 hours at 105°C. | | | | | | | | | | | |
| Moisture Resistance | <table border="1"> <tr> <td>Test Time</td> <td>1,000 Hrs</td> </tr> <tr> <td>Capacitance Change</td> <td>Within ±20% of initial value</td> </tr> <tr> <td>Tanδ</td> <td>Less than 150% of specified value</td> </tr> <tr> <td>ESR</td> <td>Less than 150% of specified value</td> </tr> <tr> <td>Leakage Current</td> <td>Within specified value</td> </tr> </table> | Test Time | 1,000 Hrs | Capacitance Change | Within ±20% of initial value | Tanδ | Less than 150% of specified value | ESR | Less than 150% of specified value | Leakage Current | Within specified value |
| | Test Time | 1,000 Hrs | | | | | | | | | |
| | Capacitance Change | Within ±20% of initial value | | | | | | | | | |
| | Tanδ | Less than 150% of specified value | | | | | | | | | |
| | ESR | Less than 150% of specified value | | | | | | | | | |
| Leakage Current | Within specified value | | | | | | | | | | |
| * The above specifications shall be satisfied when the capacitors are restored to 20°C after subjecting them at 60°C, 90 to 95% RH for 1,000 hours. Leakage current should be tested after voltage treatment*. | | | | | | | | | | | |
| Resistance to Soldering Heat * (Please refer to page 25 for reflow soldering conditions) | <table border="1"> <tr> <td>Capacitance Change</td> <td>Within ±10% of initial value</td> </tr> <tr> <td>Tanδ</td> <td>Less than 130% of specified value</td> </tr> <tr> <td>ESR</td> <td>Less than 130% of specified value</td> </tr> <tr> <td>Leakage Current</td> <td>Within specified value</td> </tr> </table> | Capacitance Change | Within ±10% of initial value | Tanδ | Less than 130% of specified value | ESR | Less than 130% of specified value | Leakage Current | Within specified value | | |
| | Capacitance Change | Within ±10% of initial value | | | | | | | | | |
| | Tanδ | Less than 130% of specified value | | | | | | | | | |
| | ESR | Less than 130% of specified value | | | | | | | | | |
| Leakage Current | Within specified value | | | | | | | | | | |
| | | | | | | | | | | | |
| Ripple Current and Frequency Multipliers | <table border="1"> <tr> <td>Frequency (Hz)</td> <td>120 ≤ f < 1k</td> <td>1k ≤ f < 10k</td> <td>10k ≤ f < 100k</td> <td>100k ≤ f < 500k</td> </tr> <tr> <td>Multiplier</td> <td>0.05</td> <td>0.3</td> <td>0.7</td> <td>1.0</td> </tr> </table> | Frequency (Hz) | 120 ≤ f < 1k | 1k ≤ f < 10k | 10k ≤ f < 100k | 100k ≤ f < 500k | Multiplier | 0.05 | 0.3 | 0.7 | 1.0 |
| | Frequency (Hz) | 120 ≤ f < 1k | 1k ≤ f < 10k | 10k ≤ f < 100k | 100k ≤ f < 500k | | | | | | |
| Multiplier | 0.05 | 0.3 | 0.7 | 1.0 | | | | | | | |
| | | | | | | | | | | | |

* For any doubt about measured values, measure the leakage current again after the following voltage treatment.
Voltage treatment: DC rated voltage is applied to the capacitors for 2 hours at 105°C.

Diagram of Dimensions

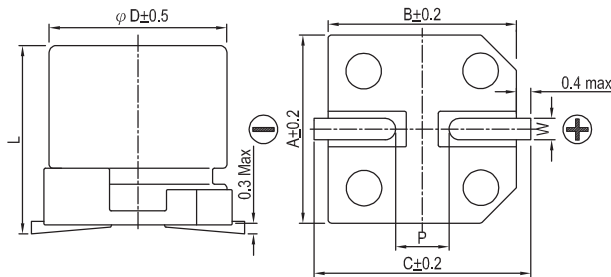

Lead Spacing and Diameter

| φ D | L | A | B | C | W | P ± 0.2 |
|-----|----------------|------|------|------|-----------|---------|
| 5 | 5.8 ± 0.3 | 5.3 | 5.3 | 5.9 | 0.5 ~ 0.8 | 1.5 |
| 6.3 | 5.8 ± 0.3 | 6.6 | 6.6 | 7.2 | 0.5 ~ 0.8 | 2.0 |
| 6.3 | 7.7 ± 0.3 | 6.6 | 6.6 | 7.2 | 0.5 ~ 0.8 | 2.0 |
| 8 | 6.7 ± 0.3 | 8.4 | 8.4 | 9.0 | 0.7 ~ 1.1 | 3.1 |
| 8 | 10.0 ± 0.5 | 8.4 | 8.4 | 9.0 | 0.7 ~ 1.1 | 3.1 |
| 10 | 7.7 ± 0.3 | 10.4 | 10.4 | 11.0 | 0.7 ~ 1.3 | 4.7 |
| 10 | 10.0 ± 0.5 | 10.4 | 10.4 | 11.0 | 0.7 ~ 1.3 | 4.7 |
| 10 | 12.6 +0.1/-0.4 | 10.4 | 10.4 | 11.0 | 0.7 ~ 1.3 | 4.7 |

Marking

φ D = 5 ~ 6.3

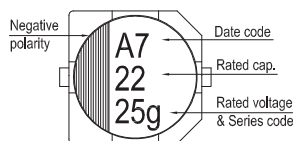

φ D = 8 ~ 10

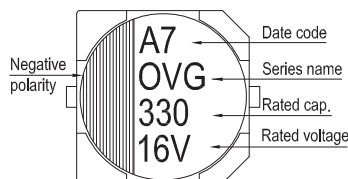



Dimension: ϕ D×L(mm)
Ripple Current: mA/rms at 100k Hz, 105°C

Standard Ratings

| W. V. (V) | Surge Voltage (V) | Capacitance (μF) | Size ϕ D×L(mm) | Tan δ (120Hz, 20°C) | L C (μA) | E S R (mΩ/at 100k ~ 300k Hz, 20°C Max) | Rated R. C. (mA/rms at 100k Hz, 105°C) |
|-----------|-------------------|------------------|---------------------|----------------------------|----------|--|--|
| 16V (1C) | 18.0 | 220 | 6.3 × 7.7 | 0.12 | 704 | 22 | 3,300 |
| | | 270 | 8 × 6.7 | 0.12 | 864 | 22 | 3,300 |
| | | 330 | 8 × 10 | 0.12 | 1,050 | 21 | 3,400 |
| | | 820 | 10 × 12.6 | 0.12 | 2,620 | 12 | 5,400 |
| | | 1,000 | 10 × 12.6 | 0.12 | 3,200 | 12 | 5,400 |
| 20V(1D) | 23.0 | 47 | 5 × 5.8 | 0.12 | 188 | 30 | 2,800 |
| | | 56 | 5 × 5.8 | 0.12 | 224 | 30 | 2,800 |
| | | 120 | 6.3 × 5.8 | 0.12 | 480 | 25 | 3,200 |
| | | 150 | 6.3 × 7.7 | 0.12 | 600 | 25 | 3,200 |
| | | 180 | 8 × 6.7 | 0.12 | 720 | 25 | 3,200 |
| | | 220 | 8 × 10 | 0.12 | 880 | 23 | 3,400 |
| 25V(1E) | 29.0 | 560 | 10 × 10 | 0.12 | 2,240 | 18 | 4,100 |
| | | 22 | 5 × 5.8 | 0.12 | 110 | 40 | 2,450 |
| | | 27 | 5 × 5.8 | 0.12 | 135 | 40 | 2,450 |
| | | 39 | 6.3 × 5.8 | 0.12 | 195 | 30 | 2,800 |
| | | 47 | 6.3 × 5.8 | 0.12 | 235 | 30 | 2,800 |
| | | 56 | 6.3 × 5.8 | 0.12 | 280 | 30 | 2,800 |
| | | | 6.3 × 7.7 | 0.12 | 280 | 28 | 2,800 |
| | | 68 | 8 × 6.7 | 0.12 | 340 | 28 | 3,000 |
| | | 100 | 8 × 10 | 0.12 | 500 | 24 | 3,300 |
| | | 120 | 8 × 10 | 0.12 | 600 | 22 | 3,500 |
| 150 | 10 × 7.7 | 0.12 | 750 | 25 | 3,400 | | |
| 220 | 10 × 10 | 0.12 | 1,100 | 20 | 3,800 | | |

OP-CAP

Part Numbering System

OVG Series 150μF ±20% 25V Carrier Tape 10 ϕ × 7.7L Pb-free and PET coating case

OVG **151** **M** **1E** **TR** - **1008**

Series Name Capacitance Capacitance Tolerance Rated Voltage Package Type Terminal Type Case size Lead Wire and Coating Type

Note: For more details, please refer to "Part Numbering System (SMD Type)" on page 15.



Компания «ЭлектроПласт» предлагает заключение долгосрочных отношений при поставках импортных электронных компонентов на взаимовыгодных условиях!

Наши преимущества:

- Оперативные поставки широкого спектра электронных компонентов отечественного и импортного производства напрямую от производителей и с крупнейших мировых складов;
- Поставка более 17-ти миллионов наименований электронных компонентов;
- Поставка сложных, дефицитных, либо снятых с производства позиций;
- Оперативные сроки поставки под заказ (от 5 рабочих дней);
- Экспресс доставка в любую точку России;
- Техническая поддержка проекта, помощь в подборе аналогов, поставка прототипов;
- Система менеджмента качества сертифицирована по Международному стандарту ISO 9001;
- Лицензия ФСБ на осуществление работ с использованием сведений, составляющих государственную тайну;
- Поставка специализированных компонентов (Xilinx, Altera, Analog Devices, Intersil, Interpoint, Microsemi, Aeroflex, Peregrine, Syfer, Eurofarad, Texas Instrument, Miteq, Cobham, E2V, MA-COM, Hittite, Mini-Circuits, General Dynamics и др.);

Помимо этого, одним из направлений компании «ЭлектроПласт» является направление «Источники питания». Мы предлагаем Вам помощь Конструкторского отдела:

- Подбор оптимального решения, техническое обоснование при выборе компонента;
- Подбор аналогов;
- Консультации по применению компонента;
- Поставка образцов и прототипов;
- Техническая поддержка проекта;
- Защита от снятия компонента с производства.



Как с нами связаться

Телефон: 8 (812) 309 58 32 (многоканальный)

Факс: 8 (812) 320-02-42

Электронная почта: org@eplast1.ru

Адрес: 198099, г. Санкт-Петербург, ул. Калинина, дом 2, корпус 4, литера А.