

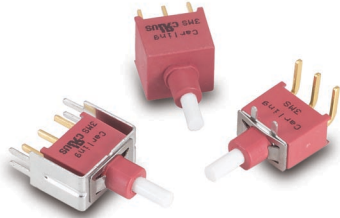

3MN-Series
Snap-Action Miniature Pushbutton Switch

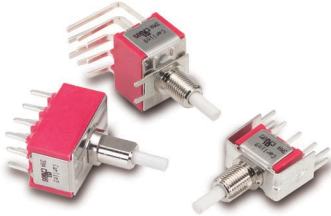

3MS-Series
Sealed Snap-Action Miniature Pushbutton Switch



3MA-Series
Alternate Action Miniature Pushbutton Switch

Specifications

Contact Rating	refer to ordering scheme
Electrical Life	50,000 make & break cycles @ full load
Contact Resistance.	<i>3MN & 3MA-Series:</i> 10 mΩ max. initial @ 2-4 VDC 100mA for both silver & gold plated contacts. <i>3MS-Series:</i> 50 mΩ max. initial @ 2-4 VDC 100mA for both silver & gold plated contacts.
Insulation Resistance . . .	1000 MΩ min.
Dielectric Strength	1500 Volts RMS @ sea level
Operating Temperature . . .	-30°C to +85°C
Index of Protection	<i>3MS -Series:</i> IP68
Cap Installation Support . .	<i>3MS-Series:</i> 10 lbs. max.
Solder Heat Resistance. . .	MIL-STD-202, Method 210
Actuator Travel25°

Materials

Case	<i>3MN & 3MA-Series:</i> Diallyl phthalate (DAP) (UL 94V-0) <i>3MS-Series:</i> Glass filled nylon 6/6, flame retardant, heat stabilized (UL 94V-0)
Plunger.	<i>3MN-Series:</i> Thermoplastic polyester, black <i>3MS & 3MA-Series:</i> Glass filled nylon or glass filled polyester (UL 94V-0)
Bushing	<i>3MN-Series:</i> Brass, nickel plated <i>3MA-Series:</i> Zinc, nickel plated
Housing.	<i>3MN & 3MA-Series:</i> Stainless Steel
Switch Support Retainer . .	<i>3MS-Series:</i> Stainless Steel
Terminal Seal	Epoxy

3M-Series Optional Cap

To order a cap assembled on a switch, specify the switch number followed by the cap part number and the word "assembled".

Ex: 3MN-SP-7-P2-B6-M6QE-C13ASSEMBLED

To order caps in bulk, specify the Series, followed by the cap. Ex.) 3MN-C13



<p>1 SERIES OR SWITCH CATALOG NUMBER 3MN, 3MS or 3MA</p>	<p>3 CAP COLOR</p> <table border="0" style="width: 100%;"> <tr> <td>1 white</td> <td>5 yellow</td> </tr> <tr> <td>2 black</td> <td>6 green</td> </tr> <tr> <td>3 red</td> <td>7 blue</td> </tr> <tr> <td>4 orange</td> <td></td> </tr> </table> <p><small>1 Black, white & red standard. Other colors available. Consult factory.</small></p>	1 white	5 yellow	2 black	6 green	3 red	7 blue	4 orange	
1 white	5 yellow								
2 black	6 green								
3 red	7 blue								
4 orange									
<p>2 CAP SIZE</p> <table border="0" style="width: 100%;"> <tr> <td>C1 round 7.6mm dia.</td> <td>C5 round 14.5mm dia.</td> </tr> <tr> <td>C2 round 9.35 mm dia.</td> <td>(for 3MA w/ PL bushing)</td> </tr> <tr> <td>C3 square 11.7 x 11.7mm</td> <td>C6 brass chrome plated</td> </tr> <tr> <td>C4 round 5mm dia.</td> <td>(for 3MA w/ PD bushing)</td> </tr> </table>	C1 round 7.6mm dia.	C5 round 14.5mm dia.	C2 round 9.35 mm dia.	(for 3MA w/ PL bushing)	C3 square 11.7 x 11.7mm	C6 brass chrome plated	C4 round 5mm dia.	(for 3MA w/ PD bushing)	
C1 round 7.6mm dia.	C5 round 14.5mm dia.								
C2 round 9.35 mm dia.	(for 3MA w/ PL bushing)								
C3 square 11.7 x 11.7mm	C6 brass chrome plated								
C4 round 5mm dia.	(for 3MA w/ PD bushing)								

3MN-Series Ordering Scheme
with Square Actuator

with Plunger Actuator

1 SERIES 3MN Snap-Action Miniature Pushbutton Switch									
2 POLES SP single pole DP double pole									
3 CIRCUIT () - momentary 7 ON (ON)									
4 ACTUATOR¹ SQUARE ACTUATOR (use with Color Options in Selection 5A & 5B.) AP1 square with no frame AP2 square raised above frame AP3 square flush with frame PLUNGER ACTUATOR (use with Bushing Options in Selection 5) P0 2.5mm short plunger(for B6 bushing only) P1 5.2mm plunger(for bushing B10,B11,B20,B21; 7.5mm for B6) P2 2.0mm plunger(for bushing B10,B11,B20,B21; 4.2mm for B6)									
5A ACTUATOR COLOR & 5B FRAME COLOR^{1,2} <table style="width: 100%; border: none;"> <tr> <td style="width: 33%;">1 white</td> <td style="width: 33%;">4 orange</td> <td style="width: 33%;">7 blue</td> </tr> <tr> <td>2 black</td> <td>5 yellow</td> <td>8 brown</td> </tr> <tr> <td>3 red</td> <td>6 green</td> <td>9 gray</td> </tr> </table> <p>1 Black, white and red are standard. Other colors available, consult factory for details. 2 Selection 5B is blank if actuator style is AP1 (no frame)</p> <p style="text-align: center;">OR</p> 5 BUSHING B6 Unthreaded (for terminations VS6-VS9 only) B10 Threaded keyway B11 Threaded with flat B20 Unthreaded keyway B21 Unthreaded with flat NOTE: If ordering optional CAP with bushings B10, B11, B20 or B21, specify actuator P1. For CAP with bushing B6, specify actuator P2. For CAP options, see ordering scheme on page 35.	1 white	4 orange	7 blue	2 black	5 yellow	8 brown	3 red	6 green	9 gray
1 white	4 orange	7 blue							
2 black	5 yellow	8 brown							
3 red	6 green	9 gray							

6 TERMINATION				
M1	Solder Lug			
M2	PCB			
M5-1	Wire Wrap .750 [19.05]			
M5-3	Wire Wrap .425 [10.80]			
M6	PC Mount, 90° horizontal			
M7	PC Mount, 90° vertical			
VS2	PC Mount, U bracket, .620 mounting x .460 high			
VS3	PC Mount, U bracket, .620 mounting x .630 high			
VS4	PC Mount, U bracket, .750 mounting x .460 high			
VS5	PC Mount, U bracket, .750 mounting x .630 high			
VS6	PC Mount, U bracket, .460 high (for B6 bushing only)			
VS7	PC Mount, U bracket, .630 high (for B6 bushing only)			
VS8	PC Mount, U bracket, .460 high (for B6 bushing only)			
VS9	PC Mount, U bracket, .630 high (for B6 bushing only)			
7 CONTACT				
G	Material silver ¹	Terminal Plating gold over silver ³	Rating 1A@120VAC or 28VDC	Approvals UL, CUL
Q	silver ¹	silver ¹	1A@120VAC or 28VDC	UL, CUL
R	gold ²	gold ²	0.4VA max. @20V max (AC/DC)	
NOTE: Tin-lead option available with PC type terminations only.				
1 Moveable contact & terminals: copper alloy, silver plate				
2 Moveable contact & terminals: copper alloy with gold plate over nickel plate				
3 Terminals: silver plate with outer layer in gold plating				
8 EPOXY SEAL				
E epoxy seal				

3MS-Series Ordering Scheme

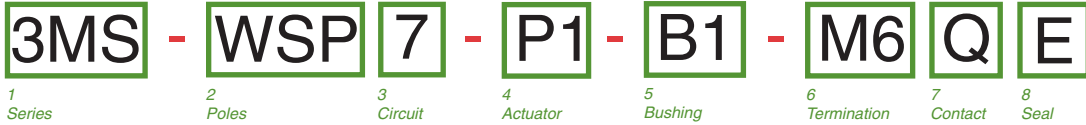

<p>1 SERIES 3MS Sealed Snap-Action Miniature Pushbutton Switch</p> <p>2 POLES WSP single pole WDP double pole</p> <p>3 CIRCUIT () - momentary 7 ON (ON)</p> <p>4 ACTUATOR P1 .173" plunger (for B1 bushing); .276" (for B4 bushing) P2 .220" plunger (for B1 bushing); .327" (for B4 bushing) P3 .087" plunger (for B1 bushing); .193" (for B4 bushing)</p> <p>5 BUSHING B1 Threaded B4 Unthreaded</p>	<p>6 TERMINATION</p> <table style="width: 100%; border-collapse: collapse;"> <tr> <td style="width: 33%;">M1 Solder Lug</td> <td style="width: 33%;">VS21 Snap-In, U bracket, .620 mounting x .460 high</td> </tr> <tr> <td>M2 PCB</td> <td>VS3 PC Mount, U bracket, .620 mounting x .630 high</td> </tr> <tr> <td>M6 PC Mount, 90° horizontal</td> <td>VS4 PC Mount, U bracket, .750 mounting x .460 high</td> </tr> <tr> <td>M61 Snap-In, 90° horizontal</td> <td>VS5 PC Mount, U bracket, .750 mounting x .630 high</td> </tr> <tr> <td>M7 PC Mount, 90° vertical</td> <td></td> </tr> <tr> <td>M71 Snap-In, 90° vertical</td> <td></td> </tr> <tr> <td>VS2 PC Mount, U bracket, .620 mounting x .460 high</td> <td></td> </tr> </table> <p>7 CONTACT</p> <table style="width: 100%; border-collapse: collapse;"> <thead> <tr> <th style="text-align: left;">Material</th> <th style="text-align: left;">Terminal Plating</th> <th style="text-align: left;">Rating</th> <th style="text-align: left;">Approvals</th> </tr> </thead> <tbody> <tr> <td>G silver¹</td> <td>gold over silver³</td> <td>1A@120VAC or 28VDC 1A@120VAC or 28VDC</td> <td>UL, CUL IP68</td> </tr> <tr> <td>Q silver¹</td> <td>silver¹</td> <td>0.4VA max. @20V max (AC/DC)</td> <td>UL, CUL IP68</td> </tr> <tr> <td>R gold²</td> <td>gold²</td> <td></td> <td>IP68</td> </tr> </tbody> </table> <p>NOTE: Tin-lead option available with PC type terminations only. 1 Moveable contact & terminals: copper alloy, silver plate 2 Moveable contact & terminals: copper alloy with gold plate over nickel plate 3 Terminals: silver plate with outer layer in gold plating</p>	M1 Solder Lug	VS21 Snap-In, U bracket, .620 mounting x .460 high	M2 PCB	VS3 PC Mount, U bracket, .620 mounting x .630 high	M6 PC Mount, 90° horizontal	VS4 PC Mount, U bracket, .750 mounting x .460 high	M61 Snap-In, 90° horizontal	VS5 PC Mount, U bracket, .750 mounting x .630 high	M7 PC Mount, 90° vertical		M71 Snap-In, 90° vertical		VS2 PC Mount, U bracket, .620 mounting x .460 high		Material	Terminal Plating	Rating	Approvals	G silver ¹	gold over silver ³	1A@120VAC or 28VDC 1A@120VAC or 28VDC	UL, CUL IP68	Q silver ¹	silver ¹	0.4VA max. @20V max (AC/DC)	UL, CUL IP68	R gold ²	gold ²		IP68
M1 Solder Lug	VS21 Snap-In, U bracket, .620 mounting x .460 high																														
M2 PCB	VS3 PC Mount, U bracket, .620 mounting x .630 high																														
M6 PC Mount, 90° horizontal	VS4 PC Mount, U bracket, .750 mounting x .460 high																														
M61 Snap-In, 90° horizontal	VS5 PC Mount, U bracket, .750 mounting x .630 high																														
M7 PC Mount, 90° vertical																															
M71 Snap-In, 90° vertical																															
VS2 PC Mount, U bracket, .620 mounting x .460 high																															
Material	Terminal Plating	Rating	Approvals																												
G silver ¹	gold over silver ³	1A@120VAC or 28VDC 1A@120VAC or 28VDC	UL, CUL IP68																												
Q silver ¹	silver ¹	0.4VA max. @20V max (AC/DC)	UL, CUL IP68																												
R gold ²	gold ²		IP68																												
<p>7 EPOXY SEAL E epoxy seal</p>																															

3MA-Series Ordering Scheme

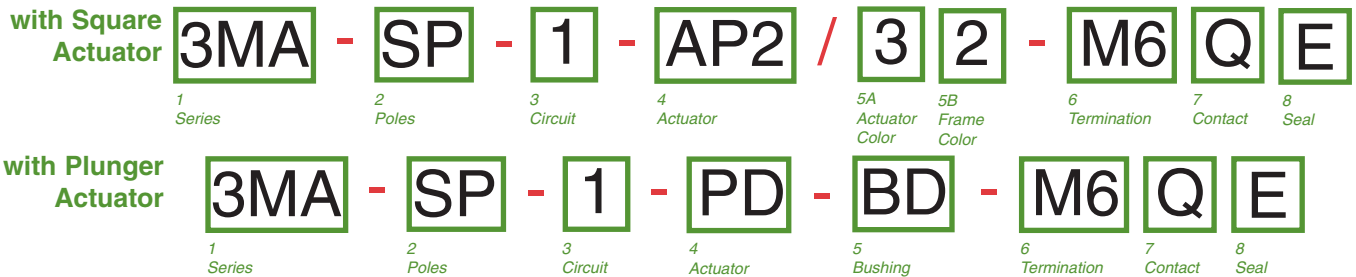

<p>1 SERIES 3MA Alternate-Action Miniature Pushbutton Switch</p> <p>2 POLES SP single pole DP double pole 3P three pole 4P four pole</p> <p>3 CIRCUIT () - momentary Switching Position:</p> <table style="width: 100%; border-collapse: collapse;"> <tr> <td style="width: 25%;">1 ON</td> <td style="width: 25%;">2-3, 5-6, 8-9, 11-12 OPEN NONE</td> <td style="width: 25%;">2 ON</td> <td style="width: 25%;">2-1, 5-4, 8-7, 11-10 ON (ON)</td> </tr> </table> <p>4 ACTUATOR SQUARE ACTUATOR (use with Color Options in Selection 5A & 5B.) AP1 square with no frame AP2 square raised above frame</p> <p>PLUNGER ACTUATOR (use with Bushing Options in Selection 5) PA .118 dia. x .299" plunger length PI .118 dia. x .244" plunger length PL .118 dia. x .327" plunger length PC .315" dia. brass chrome plated plunger (for BD bushing only) PD .242" dia. brass chrome plated plunger (for BD bushing only)</p>	1 ON	2-3, 5-6, 8-9, 11-12 OPEN NONE	2 ON	2-1, 5-4, 8-7, 11-10 ON (ON)	<p>6 TERMINATION</p> <table style="width: 100%; border-collapse: collapse;"> <tr> <td style="width: 33%;">M1 Solder Lug</td> <td style="width: 33%;">VS2 PC Mount, U bracket, .620 mounting x .460 high</td> </tr> <tr> <td>M2 PCB</td> <td>VS3 PC Mount, U bracket, .620 mounting x .630 high</td> </tr> <tr> <td>M5-1 Wire Wrap .750 [19.05]</td> <td>VS4 PC Mount, U bracket, .750 mounting x .460 high</td> </tr> <tr> <td>M5-2 Wire Wrap .964 [24.48]</td> <td>VS5 PC Mount, U bracket, .750 mounting x .630 high</td> </tr> <tr> <td>M5-3 Wire Wrap .425 [10.80]</td> <td></td> </tr> <tr> <td>M5-4 Wire Wrap 1.062 [26.87]</td> <td></td> </tr> <tr> <td>M6 PC Mount, 90° horizontal</td> <td></td> </tr> <tr> <td>M7 PC Mount, 90° vertical</td> <td></td> </tr> </table> <p>7 CONTACT</p> <table style="width: 100%; border-collapse: collapse;"> <thead> <tr> <th style="text-align: left;">Material</th> <th style="text-align: left;">Terminal Plating</th> <th style="text-align: left;">Rating</th> <th style="text-align: left;">Approvals</th> </tr> </thead> <tbody> <tr> <td>G silver¹</td> <td>gold over silver³</td> <td>6A@125VAC or 28VDC, 3A@250VAC</td> <td>UL, CUL</td> </tr> <tr> <td>K gold²</td> <td>tin-lead⁴</td> <td>6A@125VAC or 28VDC</td> <td>UL, CUL</td> </tr> <tr> <td>P silver¹</td> <td>tin-lead⁴</td> <td>6A@125VAC or 28VDC, 3A@250VAC</td> <td>UL, CUL</td> </tr> <tr> <td>Q silver¹</td> <td>silver¹</td> <td>6A@125VAC or 28VDC 3A@250VAC</td> <td>UL, CUL</td> </tr> <tr> <td>R gold²</td> <td>gold²</td> <td>0.4VA max. @20V max (AC/DC)</td> <td></td> </tr> </tbody> </table> <p>NOTE: Tin-lead option available with PC type terminations only. 1 Moveable contact & terminals: copper alloy, silver plate 2 Moveable contact & terminals: copper alloy with gold plate over nickel plate 3 Terminals: silver plate with outer layer in gold plating 4 Outer terminals: copper alloy with tin-lead over nickel plate</p>	M1 Solder Lug	VS2 PC Mount, U bracket, .620 mounting x .460 high	M2 PCB	VS3 PC Mount, U bracket, .620 mounting x .630 high	M5-1 Wire Wrap .750 [19.05]	VS4 PC Mount, U bracket, .750 mounting x .460 high	M5-2 Wire Wrap .964 [24.48]	VS5 PC Mount, U bracket, .750 mounting x .630 high	M5-3 Wire Wrap .425 [10.80]		M5-4 Wire Wrap 1.062 [26.87]		M6 PC Mount, 90° horizontal		M7 PC Mount, 90° vertical		Material	Terminal Plating	Rating	Approvals	G silver ¹	gold over silver ³	6A@125VAC or 28VDC, 3A@250VAC	UL, CUL	K gold ²	tin-lead ⁴	6A@125VAC or 28VDC	UL, CUL	P silver ¹	tin-lead ⁴	6A@125VAC or 28VDC, 3A@250VAC	UL, CUL	Q silver ¹	silver ¹	6A@125VAC or 28VDC 3A@250VAC	UL, CUL	R gold ²	gold ²	0.4VA max. @20V max (AC/DC)	
1 ON	2-3, 5-6, 8-9, 11-12 OPEN NONE	2 ON	2-1, 5-4, 8-7, 11-10 ON (ON)																																										
M1 Solder Lug	VS2 PC Mount, U bracket, .620 mounting x .460 high																																												
M2 PCB	VS3 PC Mount, U bracket, .620 mounting x .630 high																																												
M5-1 Wire Wrap .750 [19.05]	VS4 PC Mount, U bracket, .750 mounting x .460 high																																												
M5-2 Wire Wrap .964 [24.48]	VS5 PC Mount, U bracket, .750 mounting x .630 high																																												
M5-3 Wire Wrap .425 [10.80]																																													
M5-4 Wire Wrap 1.062 [26.87]																																													
M6 PC Mount, 90° horizontal																																													
M7 PC Mount, 90° vertical																																													
Material	Terminal Plating	Rating	Approvals																																										
G silver ¹	gold over silver ³	6A@125VAC or 28VDC, 3A@250VAC	UL, CUL																																										
K gold ²	tin-lead ⁴	6A@125VAC or 28VDC	UL, CUL																																										
P silver ¹	tin-lead ⁴	6A@125VAC or 28VDC, 3A@250VAC	UL, CUL																																										
Q silver ¹	silver ¹	6A@125VAC or 28VDC 3A@250VAC	UL, CUL																																										
R gold ²	gold ²	0.4VA max. @20V max (AC/DC)																																											
<p>5A ACTUATOR COLOR & 5B FRAME COLOR^{1,2}</p> <table style="width: 100%;"> <tr> <td>1 white</td> <td>4 orange</td> <td>7 blue</td> </tr> <tr> <td>2 black</td> <td>5 yellow</td> <td>8 brown</td> </tr> <tr> <td>3 red</td> <td>6 green</td> <td>9 gray</td> </tr> </table> <p>1 Black, red and white are standard. Other colors available, consult factory for details. 2 Selection 5B is blank if actuator style AP1 (no frame)</p> <p style="text-align: center;">OR</p>		1 white	4 orange	7 blue	2 black	5 yellow	8 brown	3 red	6 green	9 gray																																			
1 white	4 orange	7 blue																																											
2 black	5 yellow	8 brown																																											
3 red	6 green	9 gray																																											
<p>5 BUSHING BD Big bushing for PC, PD actuator 15/32" B10 Threaded 1/4 - 40 B20 Unthreaded B21 Unthreaded with flat</p>																																													
<p>NOTE: For CAP options, see ordering scheme on page 35.</p>																																													

3MN-Series Dimensional Specifications: in. [mm]

PLUNGER

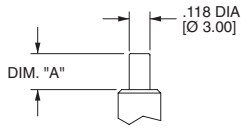

OPTION CODE	DIM. "A"
P0	.000 [0.00]
P1	.205 [5.20]
P2	.079 [2.00]

FOR B10,B11,B20,B21 ONLY

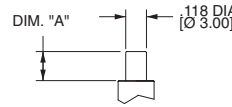

OPTION CODE	DIM. "A"
P0	.098 [2.50]
P1	.295 [7.50]
P2	.165 [4.20]

FOR B6 ONLY

ACTUATOR

AP1

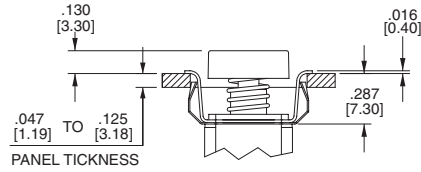
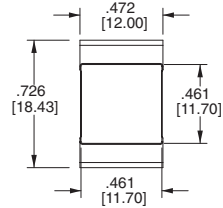

PANEL MOUNTING

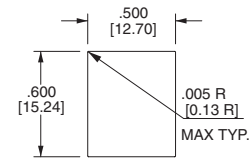

AP2

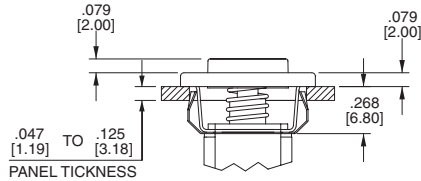
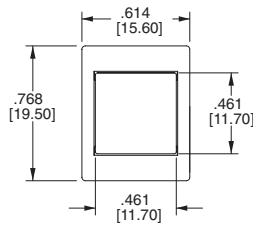

PANEL MOUNTING

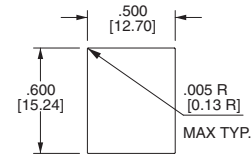

AP3

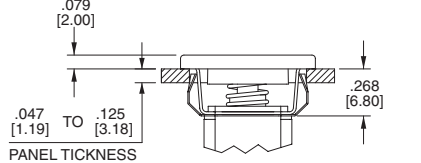
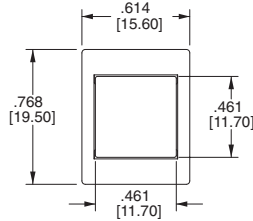

BUSHING

B10
STANDARD KEYWAY
THREADED SHOWN

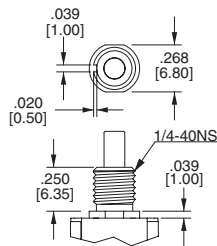

B20
STANDARD KEYWAY
NON-THREADED

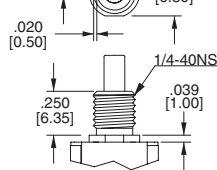

B11
THREADED SHOWN
WITH FLAT

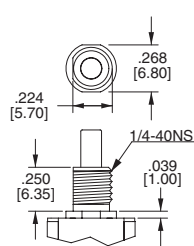

B21
NON-THREADED
WITH FLAT

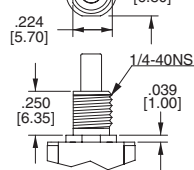

B6
NON-THREADED
(FOR TERMINATION
OPTIONS VS6-VS9 ONLY)

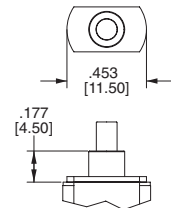

CAP

C1

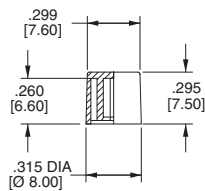

C2

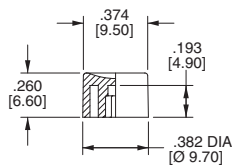

C3

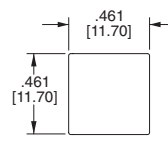

C4

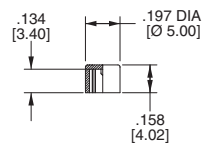

3MN-Series Dimensional Specifications: in. [mm]

TERMINATION

M1

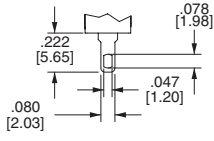

THK .030 [0.75]

M2

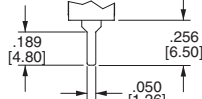

THK .030 [0.75]

M5

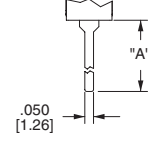

THK .030 [0.75]

OPTION CODE	DIM. "A"
M5-1	.750 [19.05]
M5-3	.425 [10.80]

SINGLE POLE

DOUBLE POLE

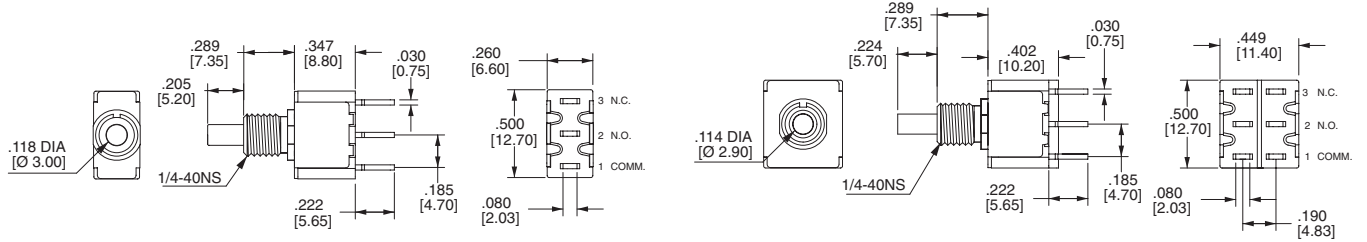

M6

SINGLE POLE

PC MOUNTING

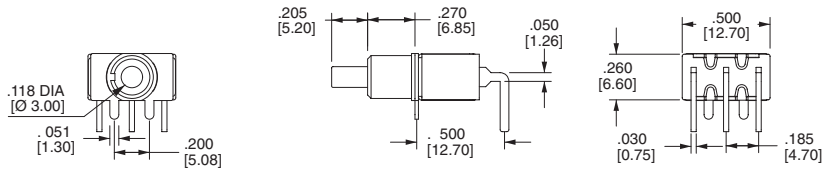

DOUBLE POLE

PC MOUNTING

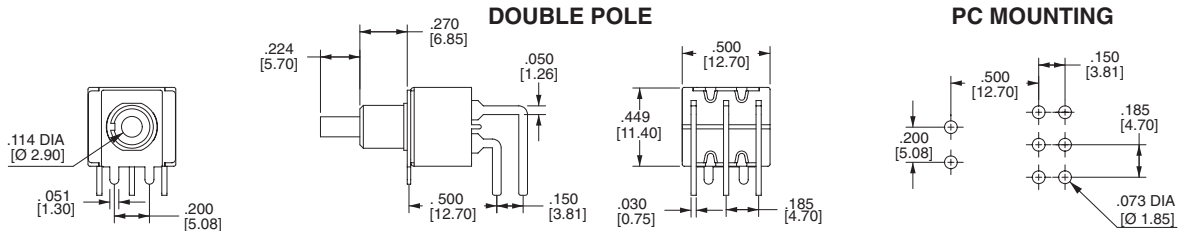

M7

SINGLE POLE

PC MOUNTING

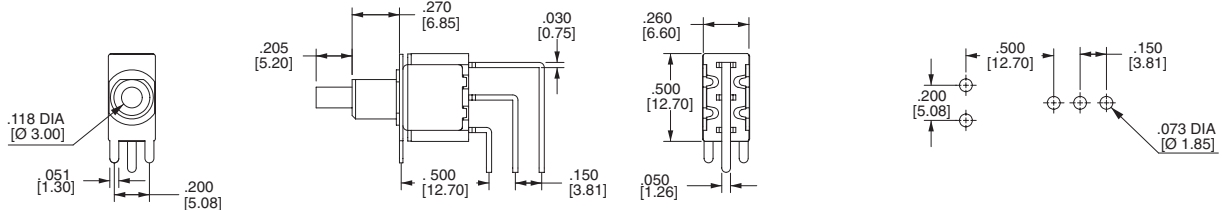

DOUBLE POLE

PC MOUNTING

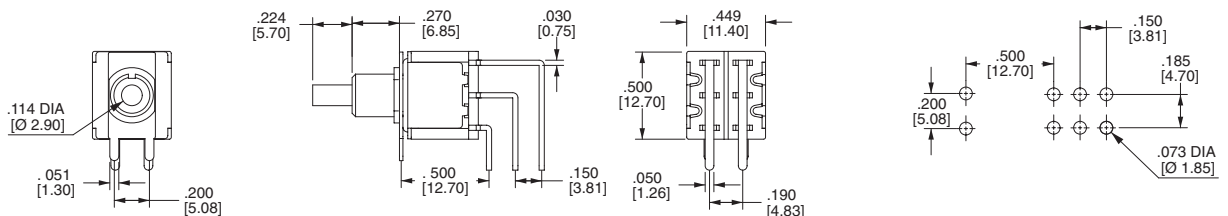

3MN-Series Dimensional Specifications: in. [mm]
TERMINATION
SINGLE POLE

OPTION CODE	DIM. "A"
VS2	.460 [11.68]
VS3	.630 [16.00]
VS7	[16.00]

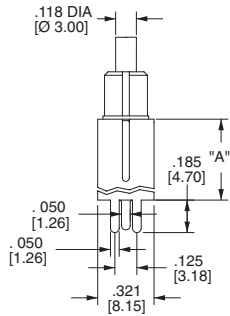
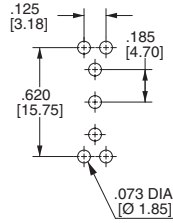
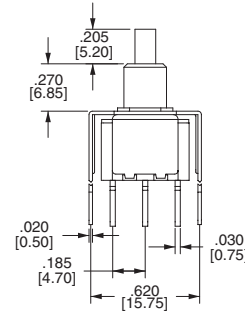
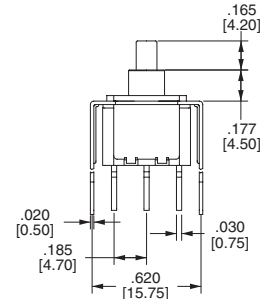
PC MOUNTING

VS2-VS3

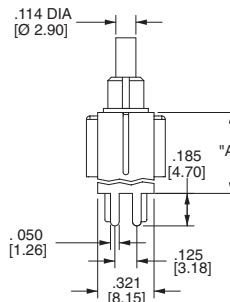
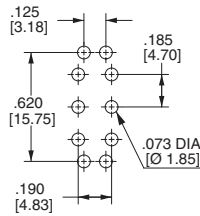
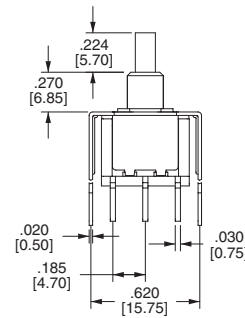
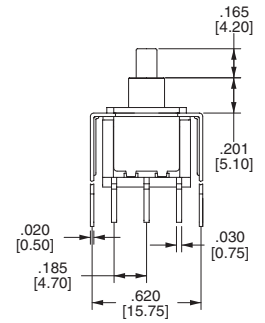
**VS6-VS7
(For B6 Bushing Only)**

DOUBLE POLE

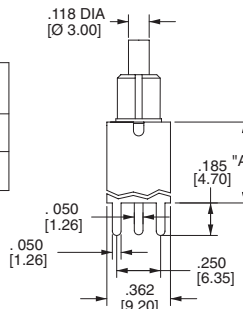
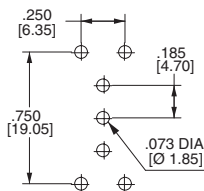
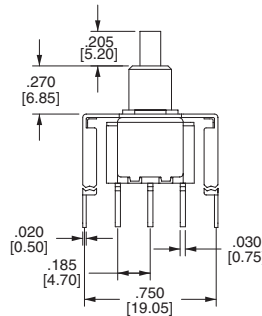
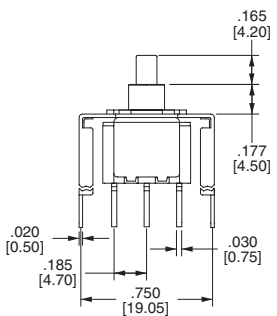
OPTION CODE	DIM. "A"
VS2	.460 [11.68]
VS6	[11.68]
VS3	.630 [16.00]
VS7	[16.00]

PC MOUNTING

VS2-VS3

**VS6-VS7
(For B6 Bushing Only)**

SINGLE POLE

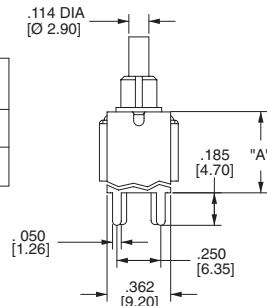
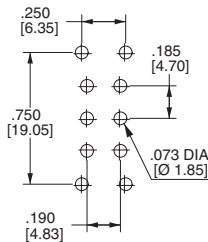
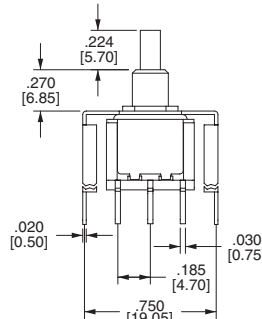
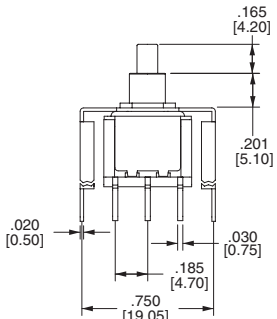
OPTION CODE	DIM. "A"
VS4	.460 [11.68]
VS8	[11.68]
VS5	.630 [16.00]
VS9	[16.00]

PC MOUNTING

VS4-VS5

**VS8-VS9
(For B6 Bushing Only)**

DOUBLE POLE

OPTION CODE	DIM. "A"
VS4	.460 [11.68]
VS8	[11.68]
VS5	.630 [16.00]
VS9	[16.00]

PC MOUNTING

VS4-VS5

**VS8-VS9
(For B6 Bushing Only)**

3MS-Series Dimensional Specifications: in. [mm]

PLUNGER

OPTION CODE	DIM. "A"
P1	.173 [4.40]
P2	.220 [5.60]
P3	.087 [2.20]

FOR B1 BUSHING

OPTION CODE	DIM. "A"
P1	.276 [7.00]
P2	.327 [8.30]
P3	.193 [4.90]

FOR B4 BUSHING

BUSHING

B1

1/4-40NS
.350 [8.90]

B4

.250 [6.35]

TERMINATION

M1

EPOXY SEAL
THK .030 [0.75]

M2

EPOXY SEAL
THK .030 [0.75]

SINGLE POLE

EPOXY SEAL

DOUBLE POLE

EPOXY SEAL

M6

.236 DIA [Ø 6.00]
.200 [5.08]
.050 [1.26]

SINGLE POLE

EPOXY SEAL

PC MOUNTING

.185 [4.70]
.500 [12.70]
.200 [5.08]
.073 DIA [Ø 1.85]

DOUBLE POLE

EPOXY SEAL

PC MOUNTING

.185 [4.70]
.150 [3.81]
.500 [12.70]
.200 [5.08]
.073 DIA [Ø 1.85]

3MS-Series Dimensional Specifications: in. [mm]

TERMINATION

M7

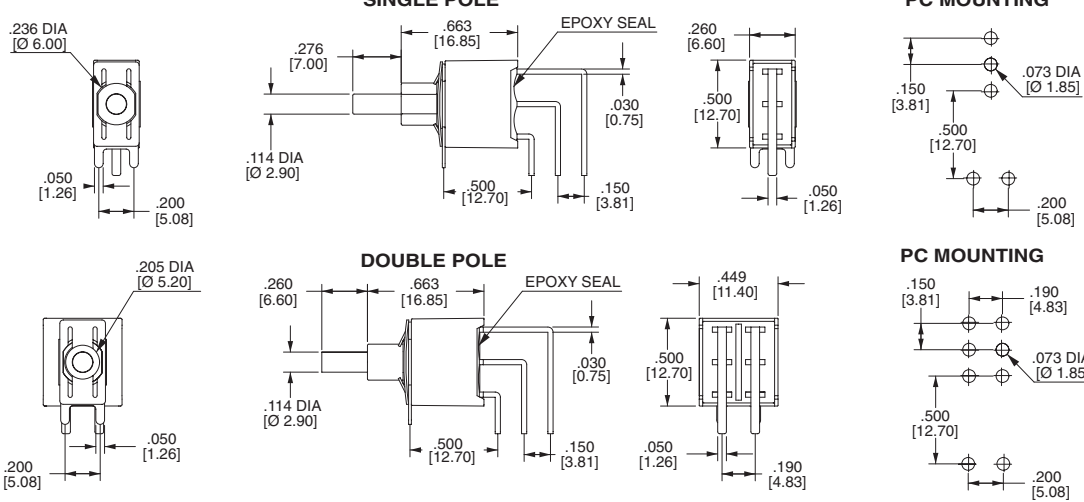

VS2-VS3

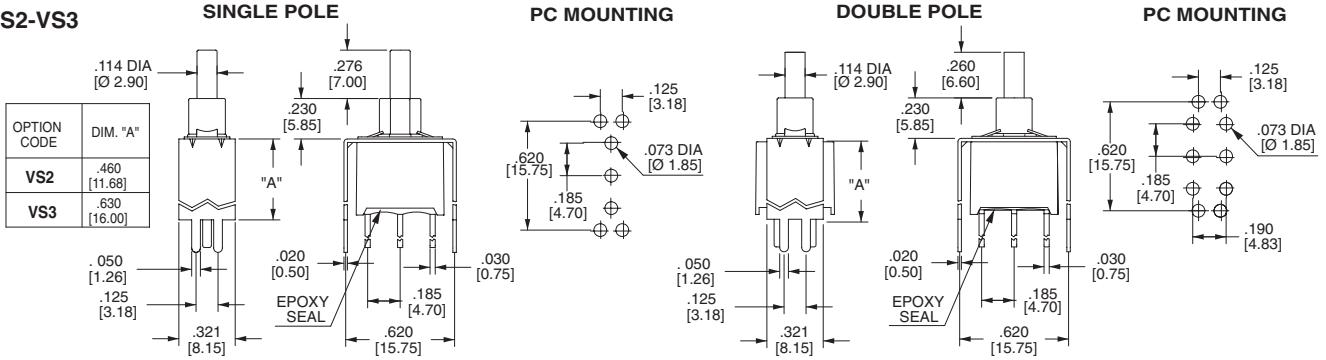

VS4-VS5

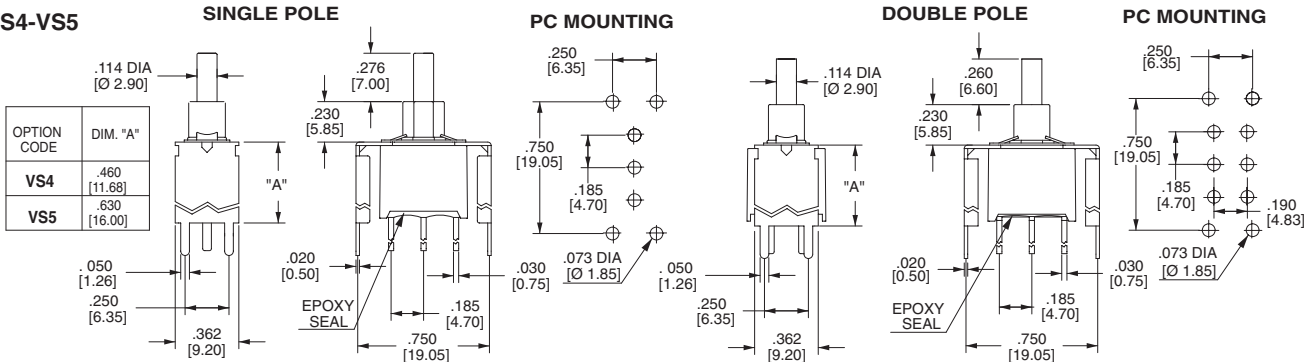

SNAP-IN TERMINATION OPTIONS

M61



M71

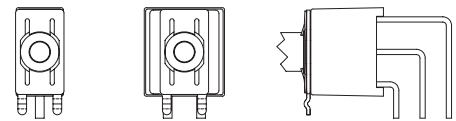

VS21,VS31

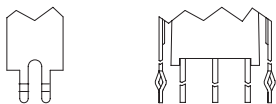

VS41,VS51

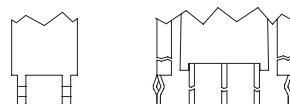

M61,M71,VS21,VS31,VS41,VS51 have the same P.C. mounting but with snap-in bracket.

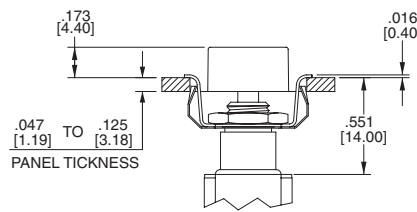
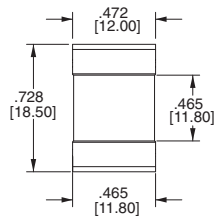
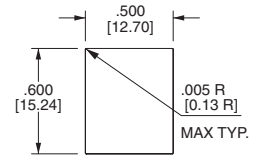
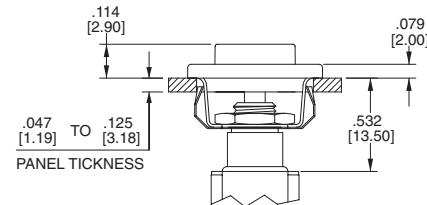
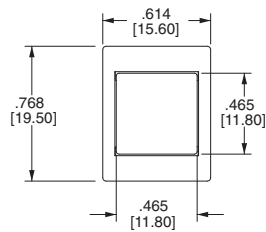
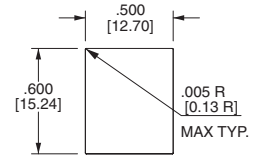
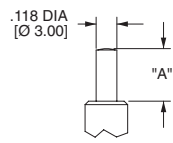
3MA-Series Dimensional Specifications: in. [mm]
ACTUATOR
AP1

PANEL MOUNTING

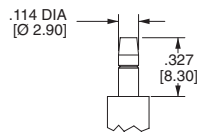
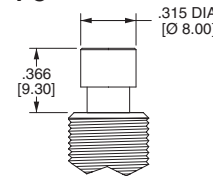
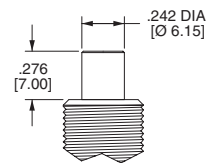
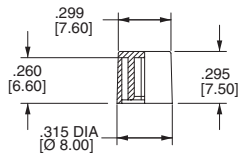
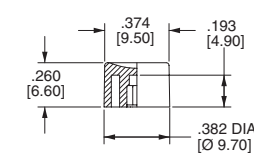
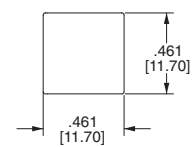
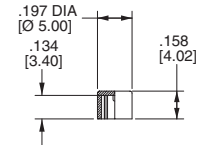
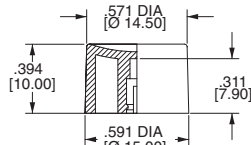
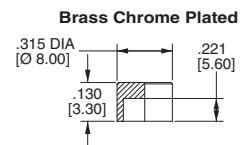
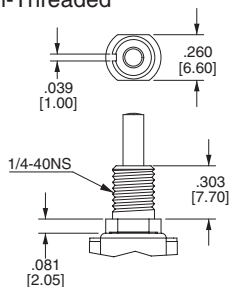
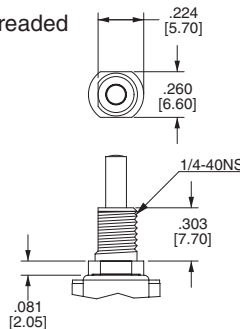
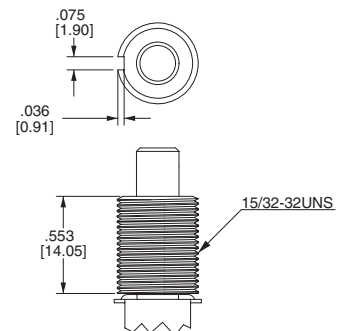
AP2

PANEL MOUNTING

PLUNGER
PA,PI

OPTION CODE	DIM. "A"
PA	.299 [7.60]
PI	.244 [6.20]

PL

PC

PD

PC, PD Plunger must fit with BD bushing
CAP
C1

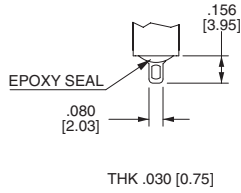
C2

C3

C4

C5

C6

BUSHING
**B10 Threaded
B20 Non-Threaded**

B21 Non-Threaded

BD

3MA-Series Dimensional Specifications: in. [mm]

TERMINATION

M1



M2

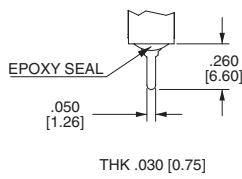

M5

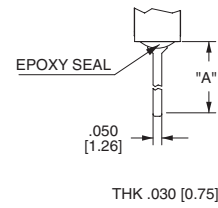

OPTION CODE	DIM. "A"
M5-1	.750 [19.05]
M5-2	.964 [24.48]
M5-3	.425 [10.80]
M5-4	1.062 [26.97]

SINGLE POLE

DOUBLE POLE

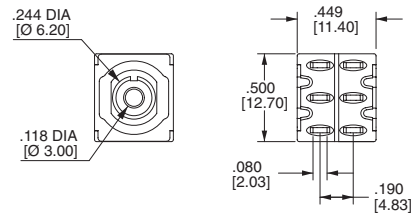
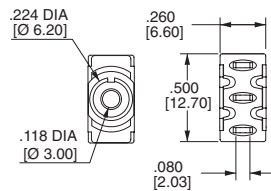
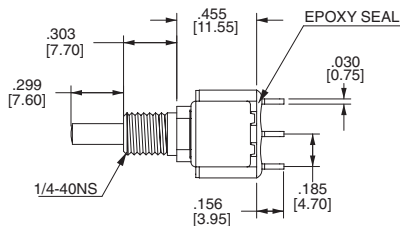

3 POLE

4 POLE

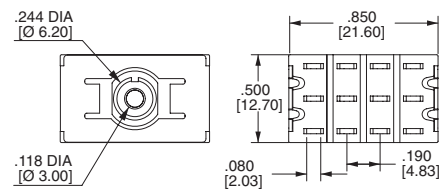
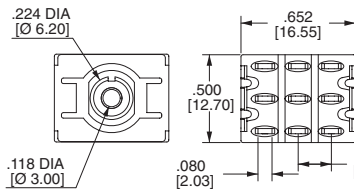
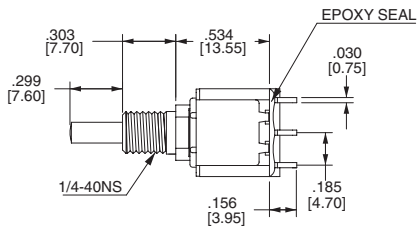

M6

SINGLE POLE

PC MOUNTING

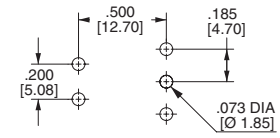
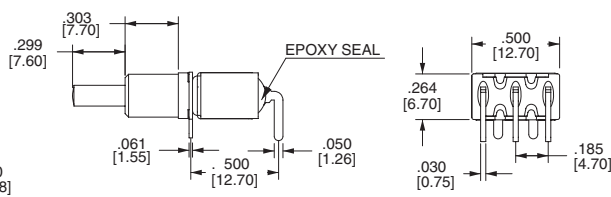
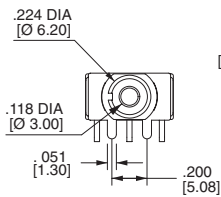

DOUBLE POLE

PC MOUNTING

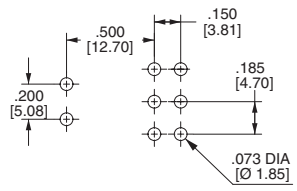
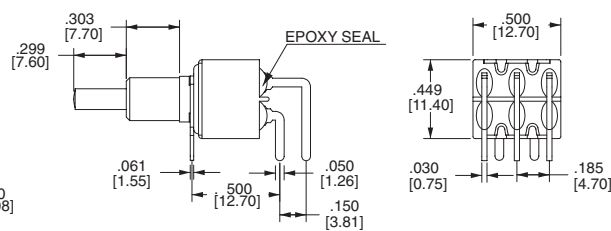
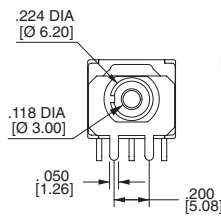

3MA-Series Dimensional Specifications: in. [mm]

TERMINATION

M7

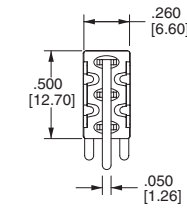
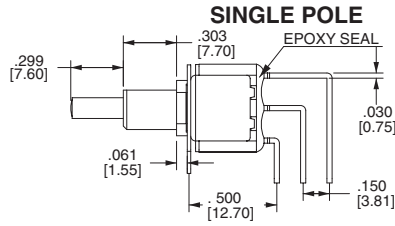
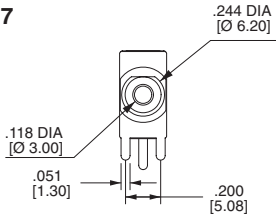

PC MOUNTING

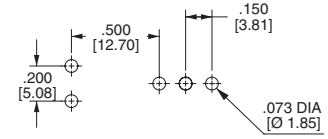

DOUBLE POLE

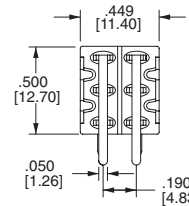
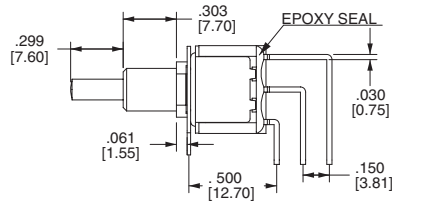
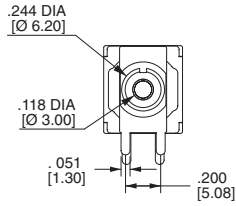

PC MOUNTING

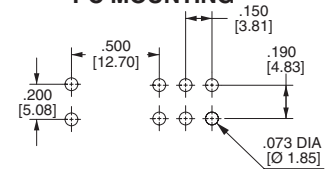

THREE POLE

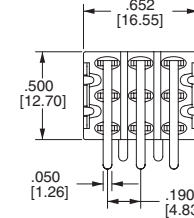
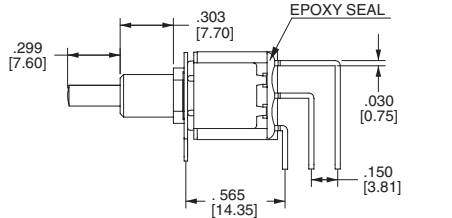
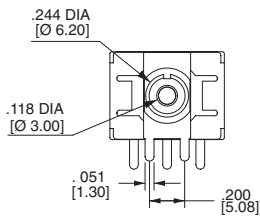

PC MOUNTING

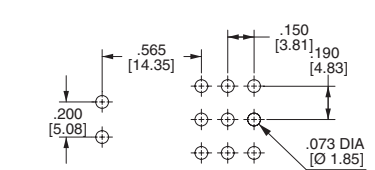

FOUR POLE

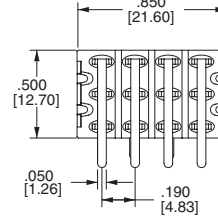
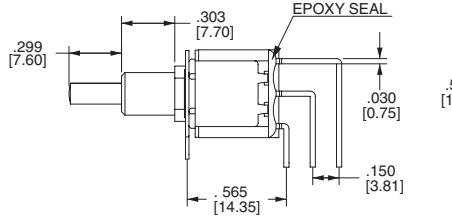
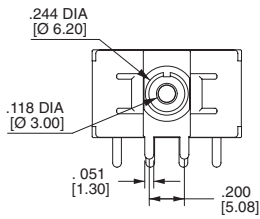

PC MOUNTING

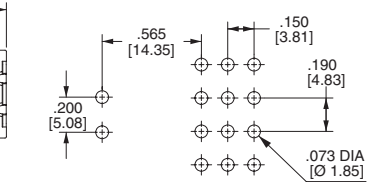

VS2-VS3

OPTION CODE	DIM. "A"
VS2	.460 [11.68]
VS3	.630 [16.00]

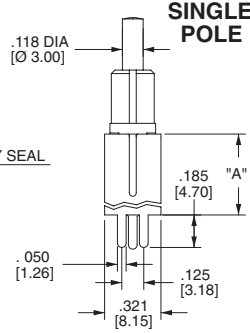
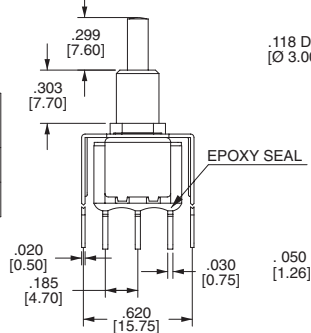

SINGLE POLE PC MOUNTING

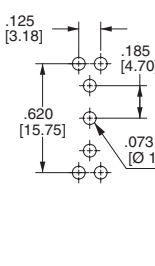

DOUBLE POLE PC MOUNTING

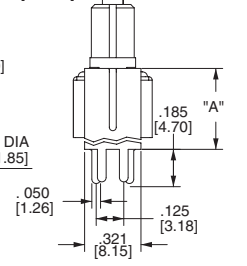

VS4-VS5

OPTION CODE	DIM. "A"
VS4	.460 [11.68]
VS5	.630 [16.00]

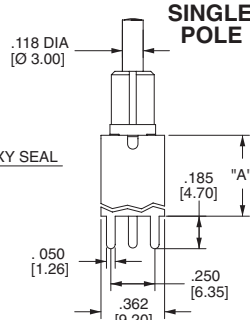
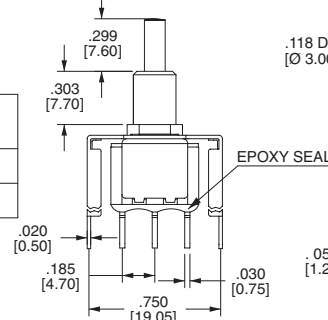

SINGLE POLE PC MOUNTING

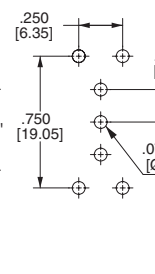

DOUBLE POLE PC MOUNTING

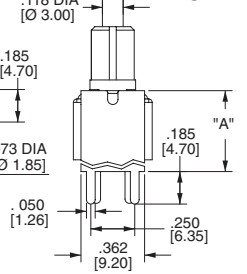



Компания «ЭлектроПласт» предлагает заключение долгосрочных отношений при поставках импортных электронных компонентов на взаимовыгодных условиях!

Наши преимущества:

- Оперативные поставки широкого спектра электронных компонентов отечественного и импортного производства напрямую от производителей и с крупнейших мировых складов;
- Поставка более 17-ти миллионов наименований электронных компонентов;
- Поставка сложных, дефицитных, либо снятых с производства позиций;
- Оперативные сроки поставки под заказ (от 5 рабочих дней);
- Экспресс доставка в любую точку России;
- Техническая поддержка проекта, помощь в подборе аналогов, поставка прототипов;
- Система менеджмента качества сертифицирована по Международному стандарту ISO 9001;
- Лицензия ФСБ на осуществление работ с использованием сведений, составляющих государственную тайну;
- Поставка специализированных компонентов (Xilinx, Altera, Analog Devices, Intersil, Interpoint, Microsemi, Aeroflex, Peregrine, Syfer, Eurofarad, Texas Instrument, Miteq, Cobham, E2V, MA-COM, Hittite, Mini-Circuits, General Dynamics и др.);

Помимо этого, одним из направлений компании «ЭлектроПласт» является направление «Источники питания». Мы предлагаем Вам помощь Конструкторского отдела:

- Подбор оптимального решения, техническое обоснование при выборе компонента;
- Подбор аналогов;
- Консультации по применению компонента;
- Поставка образцов и прототипов;
- Техническая поддержка проекта;
- Защита от снятия компонента с производства.



Как с нами связаться

Телефон: 8 (812) 309 58 32 (многоканальный)

Факс: 8 (812) 320-02-42

Электронная почта: org@eplast1.ru

Адрес: 198099, г. Санкт-Петербург, ул. Калинина, дом 2, корпус 4, литера А.