

59075 Heavy Duty Stainless Steel Threaded Barrel Features and Benefits



Features

- 2 part magnetically operated proximity sensor
- Heavy duty stainless steel threaded barrel with retaining nuts
- M12 by 1.00mm thread
- Choice of normally open, high voltage or change over contacts
- Customer defined sensitivity
- Choice of cable length and connector

Benefits

- Robust construction makes this sensor well suited to harsh industrial environments
- Simple installation and adjustment using supplied retaining nuts
- No standby power requirement
- Operates through non-ferrous materials such as wood, plastic or aluminium

Applications

- Off road and heavy vehicles
- Farm machinery

DIMENSIONS (in) mm

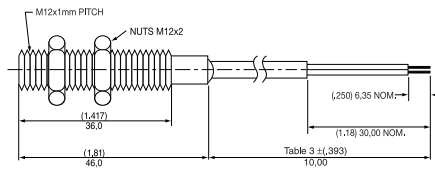
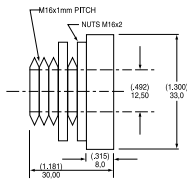

SCHEMATICS	Switch Type
	Blue Brown 1 & 2
	Black Blue Red 3
	Blue Brown 4

CUSTOMER OPTIONS - Switching Specifications

TABLE 1			Normally Open	Normally Open High Voltage	Change Over	Normally Closed
Contact Type			1	2	3	4
Switch Type	Power	Watt - max.	10	10	5	5
Voltage	Switching	Vdc - max.	200	300	175	175
	Breakdown	Vdc - min.	250	450	200	200
Current	Switching	A - max.	0.5	0.5	0.25	0.25
	Carry	A - max.	1.2	1.5	1.5	1.5
Resistance	Contact, Initial	Ω - max.	0.2	0.2	0.2	0.2
	Insulation	Ω - min.	10 ¹⁰	10 ¹⁰	10 ⁷	10 ⁷
Capacitance	Contact	pF - typ.	0.3	0.2	0.3	0.3
	Temperature	Operating	°C	-40 to +85	-20 to +85	-40 to +85
Time	Storage	°C	-65 to +85	-65 to +85	-65 to +85	-65 to +85
	Operate	ms - max.	1.0	1.0	3.0	3.0
Shock	Release	ms - max.	1.0	1.0	3.0	3.0
	11ms 1/2 sine	G - max.	100	100	50	50
Vibration	50-2000 Hz	G - max.	30	30	30	30

CUSTOMER OPTIONS - Sensitivity, Cable Length and Termination Specification

TABLE 2								TABLE 3		TABLE 4																																																																	
Sensitivity Options:- Activate Distances are approximate using Hamlin 57075 actuator as illustrated Switch AT before modification								Cable Type:- BS 6500 3A 16/0.2 PVC DOUBLE INSULATED		Termination Options:-																																																																	
								Standard Lengths		SELECT OPTION DESCRIPTION (2 WIRE VERSIONS ILLUSTRATED)																																																																	
<table border="1"> <thead> <tr> <th>Switch Type</th> <th>Pull In AT Range</th> <th>Activate Distance d (in) mm</th> <th>Pull In AT Range</th> <th>Activate Distance d (in) mm</th> <th>Pull In AT Range</th> <th>Activate Distance d (in) mm</th> <th>Pull In AT Range</th> <th>Activate Distance d (in) mm</th> </tr> </thead> <tbody> <tr> <td>1 Normally Open</td> <td>12-18</td> <td>(.984)</td> <td>17-23</td> <td>(.827)</td> <td>22-28</td> <td>(.748)</td> <td>27-33</td> <td>(.689)</td> </tr> <tr> <td>2 High Voltage</td> <td></td> <td>25.0</td> <td></td> <td>21.0</td> <td></td> <td>19.0</td> <td></td> <td>17.5</td> </tr> <tr> <td>3 Change Over</td> <td></td> <td>(.906)</td> <td></td> <td>(.787)</td> <td></td> <td>(.709)</td> <td></td> <td></td> </tr> <tr> <td>4 Normally Closed</td> <td>15-20</td> <td>23.0</td> <td>20-25</td> <td>20.0</td> <td>25-30</td> <td>18.0</td> <td></td> <td></td> </tr> </tbody> </table>								Switch Type	Pull In AT Range	Activate Distance d (in) mm	Pull In AT Range	Activate Distance d (in) mm	Pull In AT Range	Activate Distance d (in) mm	Pull In AT Range	Activate Distance d (in) mm	1 Normally Open	12-18	(.984)	17-23	(.827)	22-28	(.748)	27-33	(.689)	2 High Voltage		25.0		21.0		19.0		17.5	3 Change Over		(.906)		(.787)		(.709)			4 Normally Closed	15-20	23.0	20-25	20.0	25-30	18.0			<table border="1"> <thead> <tr> <th>SELECT OPTION</th> <th>CABLE LENGTH (in) mm</th> </tr> </thead> <tbody> <tr> <td>01</td> <td>(3.94) 100</td> </tr> <tr> <td>02</td> <td>(11.81) 300</td> </tr> <tr> <td>03</td> <td>(19.69) 500</td> </tr> <tr> <td>04</td> <td>(29.53) 750</td> </tr> <tr> <td>05</td> <td>(39.37) 1000</td> </tr> </tbody> </table>		SELECT OPTION	CABLE LENGTH (in) mm	01	(3.94) 100	02	(11.81) 300	03	(19.69) 500	04	(29.53) 750	05	(39.37) 1000	<table border="1"> <tbody> <tr> <td>A or F</td> <td>Tinned or untinned leads</td> <td></td> </tr> <tr> <td>C</td> <td>6.35mm fastons</td> <td></td> </tr> </tbody> </table>			A or F	Tinned or untinned leads		C	6.35mm fastons	
Switch Type	Pull In AT Range	Activate Distance d (in) mm	Pull In AT Range	Activate Distance d (in) mm	Pull In AT Range	Activate Distance d (in) mm	Pull In AT Range	Activate Distance d (in) mm																																																																			
1 Normally Open	12-18	(.984)	17-23	(.827)	22-28	(.748)	27-33	(.689)																																																																			
2 High Voltage		25.0		21.0		19.0		17.5																																																																			
3 Change Over		(.906)		(.787)		(.709)																																																																					
4 Normally Closed	15-20	23.0	20-25	20.0	25-30	18.0																																																																					
SELECT OPTION	CABLE LENGTH (in) mm																																																																										
01	(3.94) 100																																																																										
02	(11.81) 300																																																																										
03	(19.69) 500																																																																										
04	(29.53) 750																																																																										
05	(39.37) 1000																																																																										
A or F	Tinned or untinned leads																																																																										
C	6.35mm fastons																																																																										

ORDERING INFORMATION

N.B. 57075 actuator sold separately

59075 - X - X - XX - X

Series 59075

Switch Type

Sensitivity

Cable Length

Termination

Table 1

Table 2

Table 3

Table 4

Hamlin USA Tel: +1 920 648 3000 • Fax: +1 920 648 3001 • Email: sales.us@hamlin.com
 Hamlin UK Tel: +44 (0)1379 649700 • Fax: +44 (0)1379 649702 • Email: sales.uk@hamlin.com
 Hamlin Germany Tel: +49 (0) 6142 923920 • Fax: +49 (0) 6142923921 • Email: sales.de@hamlin.com
 Hamectrol France Tel: +33 (0) 1 6047 3000 • Fax: +33 (0) 1 6015 9136 • Email: sales.fr@hamlin.com

DETAILS PROVIDED ON THIS DATA SHEET ARE PROVIDED FOR INFORMATION PURPOSES ONLY AND SHOULD NOT BE RELIED UPON AS BEING ACCURATE FOR ANY PARTICULAR PURPOSE. Product performance may be affected by the application to which the product is put. Upon request, HAMLIN will assist purchasers by providing information specific to any particular application. HAMLIN disclaims any and all liability whatsoever for any purchaser's reliance upon the information contained on this data sheet without further consultation with authorised representatives of HAMLIN.



Компания «ЭлектроПласт» предлагает заключение долгосрочных отношений при поставках импортных электронных компонентов на взаимовыгодных условиях!

Наши преимущества:

- Оперативные поставки широкого спектра электронных компонентов отечественного и импортного производства напрямую от производителей и с крупнейших мировых складов;
- Поставка более 17-ти миллионов наименований электронных компонентов;
- Поставка сложных, дефицитных, либо снятых с производства позиций;
- Оперативные сроки поставки под заказ (от 5 рабочих дней);
- Экспресс доставка в любую точку России;
- Техническая поддержка проекта, помощь в подборе аналогов, поставка прототипов;
- Система менеджмента качества сертифицирована по Международному стандарту ISO 9001;
- Лицензия ФСБ на осуществление работ с использованием сведений, составляющих государственную тайну;
- Поставка специализированных компонентов (Xilinx, Altera, Analog Devices, Intersil, Interpoint, Microsemi, Aeroflex, Peregrine, Syfer, Eurofarad, Texas Instrument, Miteq, Cobham, E2V, MA-COM, Hittite, Mini-Circuits, General Dynamics и др.);

Помимо этого, одним из направлений компании «ЭлектроПласт» является направление «Источники питания». Мы предлагаем Вам помощь Конструкторского отдела:

- Подбор оптимального решения, техническое обоснование при выборе компонента;
- Подбор аналогов;
- Консультации по применению компонента;
- Поставка образцов и прототипов;
- Техническая поддержка проекта;
- Защита от снятия компонента с производства.



Как с нами связаться

Телефон: 8 (812) 309 58 32 (многоканальный)

Факс: 8 (812) 320-02-42

Электронная почта: org@eplast1.ru

Адрес: 198099, г. Санкт-Петербург, ул. Калинина, дом 2, корпус 4, литера А.