

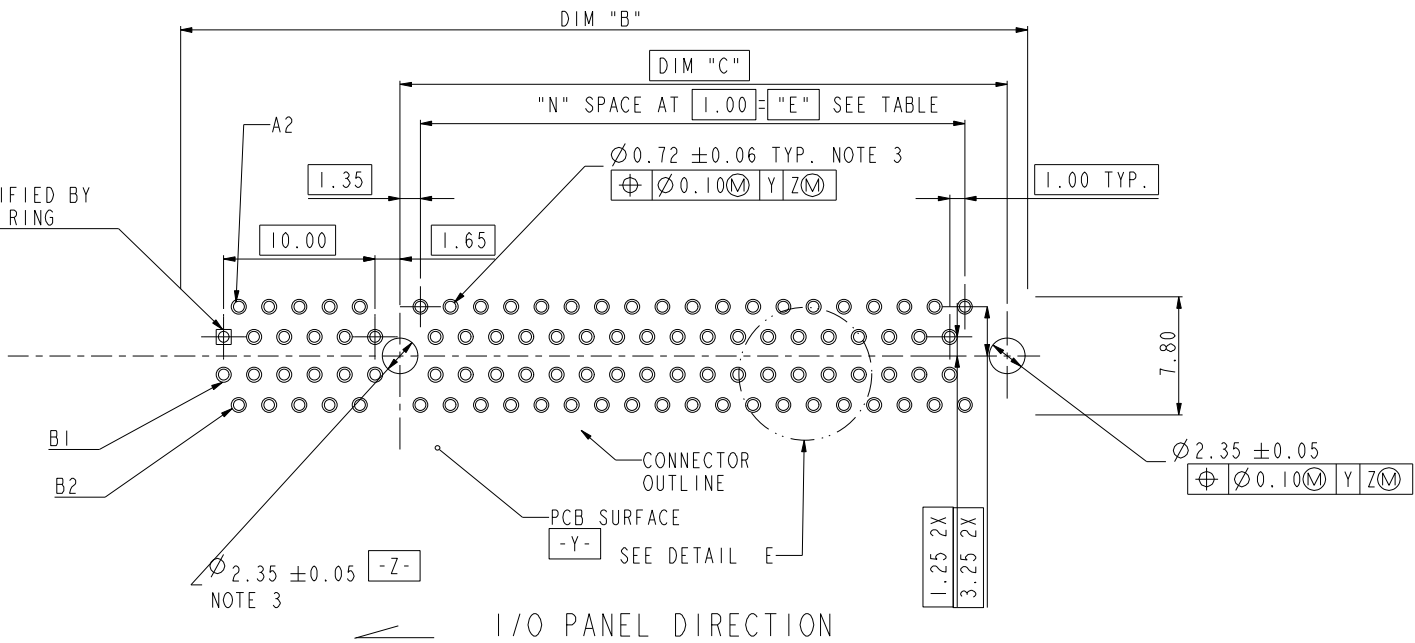



Copyright FCI.

PIN #A1 IDENTIFIED BY SQUARE ANNULAR RING



RECOMMENDED FOOTPRINT

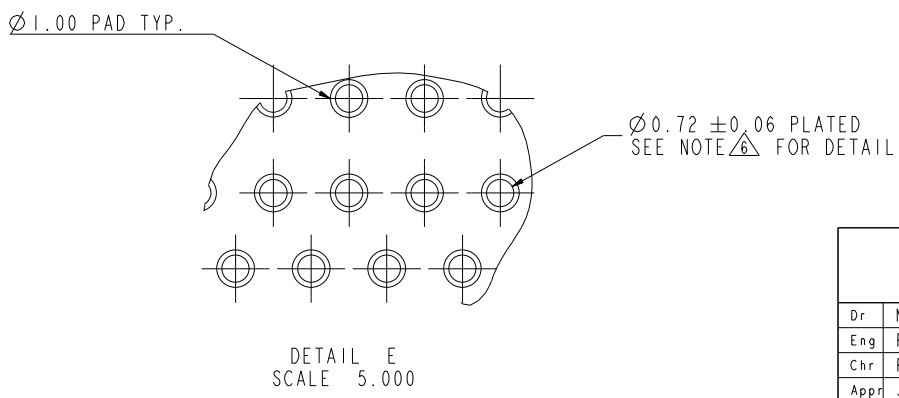

DETAIL E  
SCALE 5.000

|                                      |                                  |
|--------------------------------------|----------------------------------|
| tolerance unless otherwise specified |                                  |
| linear                               | .X ± .3<br>.XX ± .2<br>.XXX ± .1 |
| angles                               | 0° ± 2°                          |

|                    |             |                             |                |              |             |
|--------------------|-------------|-----------------------------|----------------|--------------|-------------|
| www.fciconnect.com |             |                             | tolerance      | projection   | MM          |
| Dr                 | MAGGIE WU   | 07/23/04                    | Product family | size A4      | Scale 1.000 |
| Eng                | R Y LIU     | 07/23/04                    | Spec ref       | ECN          | DG09-0045   |
| Chr                | PAUL WANG   | 07/23/04                    | Material       |              |             |
| Appr               | JOSEPH HSIA | 07/23/04                    |                |              |             |
| FCI                |             | PCI EXPRESS PRESS-FIT ASS'Y |                | dwg no       | 10039755    |
| catalog no         |             | * CUSTOMER DRAWING          |                | sheet 2 of 6 | Rev. K      |

A

B

C

D

A

B

C

D

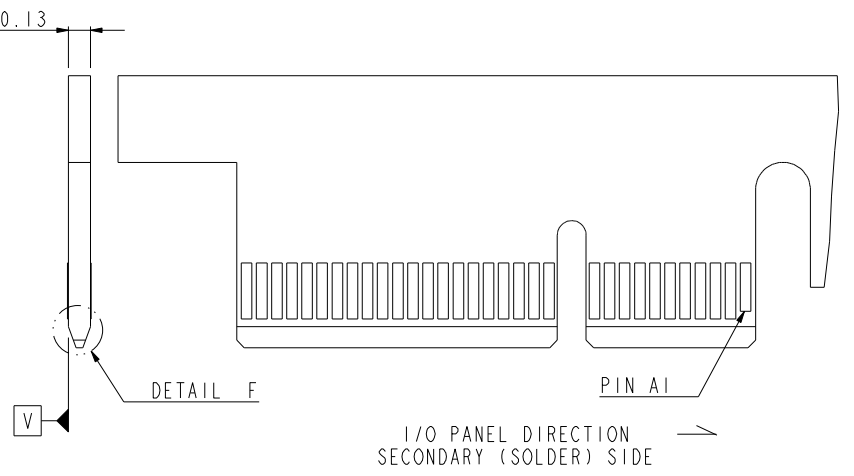
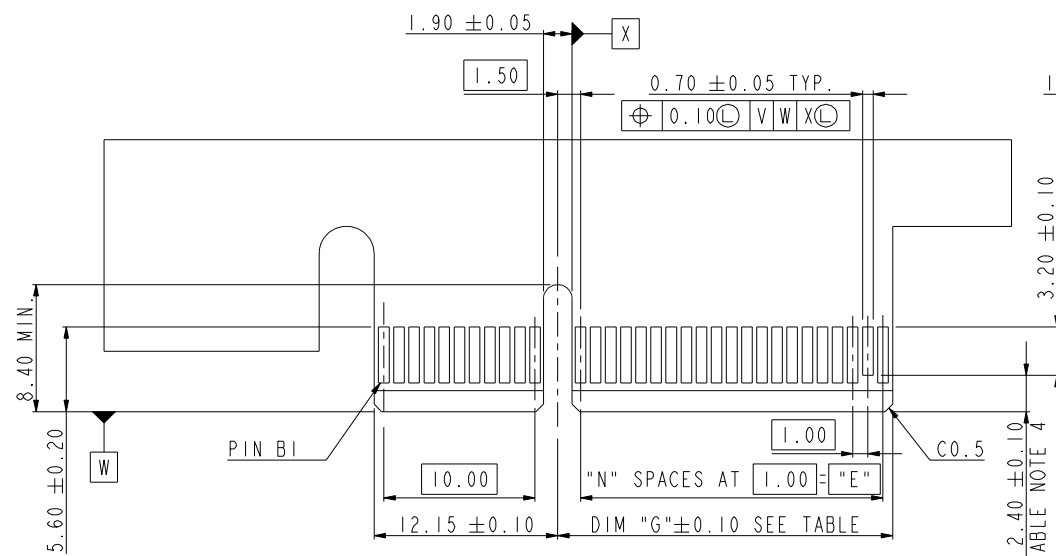

← I/O PANEL DIRECTION  
PRIMARY (COMPONENT) SIDE

I/O PANEL DIRECTION  
SECONDARY (SOLDER) SIDE →

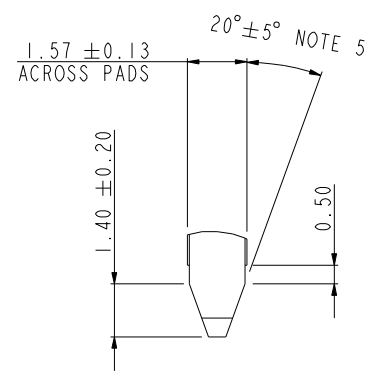

DETAIL F  
SCALE 5.000

| # POS REF. | N  | DIM "G" | "F" |
|------------|----|---------|-----|
| 98         | 37 | 39.15   | B48 |
| 164        | 70 | 72.15   | B81 |

|                                      |                                  |
|--------------------------------------|----------------------------------|
| tolerance unless otherwise specified |                                  |
| linear                               | .X ± .3<br>.XX ± .2<br>.XXX ± .1 |
| angles                               | 0° ± 2°                          |

|                                 |             |          |                                 |            |           |
|---------------------------------|-------------|----------|---------------------------------|------------|-----------|
| www.fciconnect.com              |             |          | tolerance                       | projection | MM        |
| Dr                              | MAGGIE WU   | 07/23/04 | Product family                  | size       | A4        |
| Eng                             | R Y LIU     | 07/23/04 | Spec ref                        | Scale      | 1.000     |
| Chr                             | PAUL WANG   | 07/23/04 | Material                        | ECN        | DG09-0045 |
| Appr                            | JOSEPH HSIA | 07/23/04 |                                 |            |           |
| FCI PCI EXPRESS PRESS-FIT ASS'Y |             |          | dwg no                          | 10039755   | Rev. K    |
| catalog no                      |             |          | * CUSTOMER DRAWING sheet 3 of 6 |            |           |



Copyright FCI.

1

2

3

4

A

B

C

D

A

B

C

D

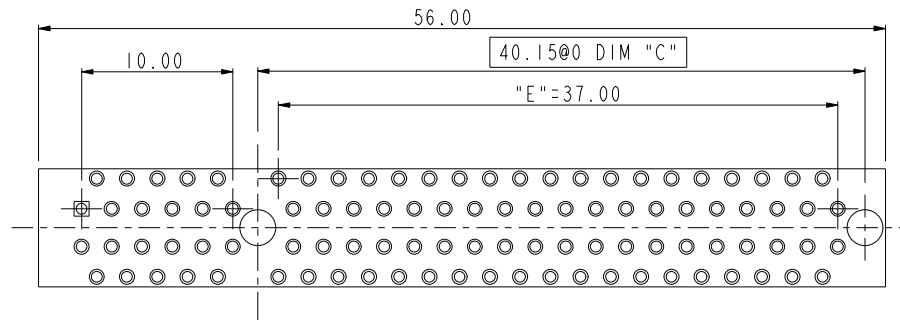

98p  
SCALE 2.000

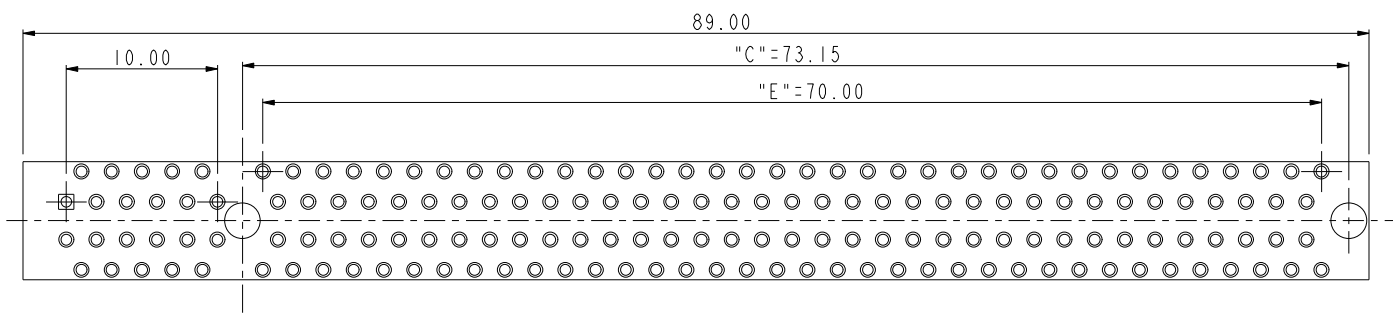

164P  
SCALE 2.000

# RECOMMENDED FOOTPRINT LAYOUT

|                    |             |                             |                |            |               |
|--------------------|-------------|-----------------------------|----------------|------------|---------------|
| www.fciconnect.com |             |                             | ✓ tolerance    | projection | MM            |
| Dr                 | MAGGIE WU   | 07/23/04                    | Product family | 3G10       | size A4       |
| Eng                | R Y LIU     | 07/23/04                    | Spec ref       | *          | Scale 1.000   |
| Chr                | PAUL WANG   | 07/23/04                    | Material       | *          | ECN DG09-0045 |
| Appr               | JOSEPH HSIA | 07/23/04                    |                |            |               |
| FCI                |             | PCI EXPRESS PRESS-FIT ASS'Y |                | dwg no     | 10039755      |
| catalog no         |             | *                           |                | CUSTOMER   | sheet 4 of 6  |

2



Copyright FCI.

NOTES:

1. MATERIAL:

HOUSING: HIGH TEMPERATURE NYLON, GLASS FILLED UL94V-0 RATED. SUITABLE FOR REFLOW SOLDERING.

TERMINAL: COPPER ALLOY

PLATING: 50u" NICKEL UNDERPLATE ALL OVER

CONTACT AREA PLATING - SEE PRODUCT NUMBER CODE

SOLDER TAIL: TIN - 100u" MIN. OVER 50u" NICKEL OR TIN/LEAD

100u" MIN. SEE PRODUCT NUMBER CODE

2. PRODUCT SPECIFICATION: GS-12-319

THE HORIZONTAL AXIS FOR THE HOLE PATTERN IS ESTABLISHED BY A LINE THROUGH THE CENTER OF THE TWO Ø2.35 HOLES. THE VERTICAL AXIS IS 90° TO THE HORIZONTAL AXIS, THROUGH THE CENTER OF DATUM Z.

NO TIE BAR PERMITTED FROM CARD EDGE TO LEADING EDGE OF PAD FOR PINS A1 AND PIN NUMBERS "F".

CHAMFER EDGES MUST BE FREE OF CUTTING BURRS.

ALL PTH SHOULD BE 0.76~0.83 mm DIA DRILLED AND 0.025~0.05 mm.

ELECTRO-DEPOSITED COPPER THK ON THROUGH HOLE WALL.

7. RoHS COMPATIBLE PRODUCT SPECIFICATIONS

a-PLATING:

- "LF" MEANS THE PRODUCT IS LEAD-FREE, 2um MINIMUM MATTE TIN OVER 1.27um MINIMUM NICKEL UNDERPLATE.

b-MANUFACTURING PROCESS COMPATIBILITY

- THE HOUSING WILL WITHSTAND EXPOSURE TO 260°C±5°C SOLDER BATH TEMPERATURE FOR 5 SECONDS IN A REFLOW SOLDER APPLICATION WITH A 1.6mm MIN THICK CIRCUIT BOARD.

| CONNECTOR | # POS | REF. | N  | DIM "A" | DIM "B" | DIM "C" | DIM "E" |
|-----------|-------|------|----|---------|---------|---------|---------|
| 1 PORT    | 36    |      | 6  | 7.65    | 25.00   | 9.15    | 6.00    |
| 4 PORT    | 64    |      | 20 | 21.65   | 39.00   | 23.15   | 20.00   |
| 8 PORT    | 98    |      | 37 | 38.65   | 56.00   | 40.15   | 37.00   |
| 16 PORT   | 164   |      | 70 | 71.65   | 89.00   | 73.15   | 70.00   |

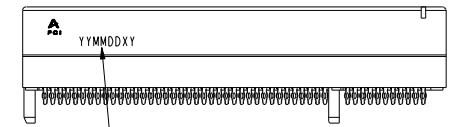

Date code:  
 "YY" means year number  
 "MM" means month number  
 "DD" means day number  
 "X" means manufacture location  
 "D" means made in Dongguan site  
 "Y" means shift number  
 If date code is 060626D1, it means this part is made by shift 1 in 2006/06/26 and manufactured in Dongguan site  
 Date code should be laser mark

PRODUCT NUMBER CODE

10039755 - X X X X X X X X

HOUSING COLOR OPTIONS  
1-BLACK

PEGS OPTIONS  
0-PLASTIC PEGS

TERMINAL PLATING OPTIONS

- 0-50u" Ni UNDERPLATE  
30u" Au CONTACT AREA  
100u" TIN TAIL AREA -----COMPATIBLE RoHS
- 1-50u" Ni UNDERPLATE  
15u" Au CONTACT AREA  
100u" TIN TAIL AREA -----COMPATIBLE RoHS
- 2-50u" Ni UNDERPLATE  
GOLD FLASH CONTACT AREA  
100u" TIN TAIL AREA -----COMPATIBLE RoHS
- 3-50u" Ni UNDERPLATE  
30u" Au CONTACT AREA  
100u" TIN/LEAD TAIL AREA -----RoHS COMPLIANT EXCEPT Pb
- 4-50u" Ni UNDERPLATE  
15u" Au CONTACT AREA  
100u" TIN/LEAD TAIL AREA -----RoHS COMPLIANT EXCEPT Pb
- 5-50u" Ni UNDERPLATE  
GOLD FLASH CONTACT AREA  
100u" TIN/LEAD TAIL AREA -----RoHS COMPLIANT EXCEPT Pb

LEAD FREE OPTION  
"LF" FOR TERMINAL PLATING OPTION 0,1,2  
LEAVE BLANK FOR TERMINAL PLATING 3,4,5

PACKAGING OPTIONS  
T-TRAY PACKAGING

POS OPTIONS

- 0-36
- 1-64
- 2-98
- 3-164

TAIL LENGTH OPTIONS

|   | DIM "D"   | SUGGESTED PCB THICKNESS |
|---|-----------|-------------------------|
| 0 | 2.00±0.20 | 2.36                    |
| 1 | 3.25±0.20 | 4.19                    |

tolerance unless otherwise specified

|        |           |
|--------|-----------|
| linear | .X ± .3   |
|        | .XX ± .2  |
| angles | .XXX ± .1 |
|        | 0° ± 2°   |

|                    |             |          |                                 |                 |             |
|--------------------|-------------|----------|---------------------------------|-----------------|-------------|
| www.fciconnect.com |             |          | tolerance                       | projection      | MM          |
| Dr                 | MAGGIE WU   | 07/23/04 | Product family                  | size A4         | Scale 1.000 |
| Eng                | R Y LIU     | 07/23/04 | Spec ref                        | ECN             | DG09-0045   |
| Chr                | PAUL WANG   | 07/23/04 | Material                        |                 |             |
| Appr               | JOSEPH HSIA | 07/23/04 |                                 |                 |             |
| FCI                |             |          | PCI EXPRESS PRESS-FIT ASS'Y     | dwg no 10039755 | Rev. K      |
| catalog no         |             |          | * CUSTOMER DRAWING sheet 5 of 6 |                 |             |



Copyright FCI.

1

2

3

4

A

B

C

D

A

B

C

D

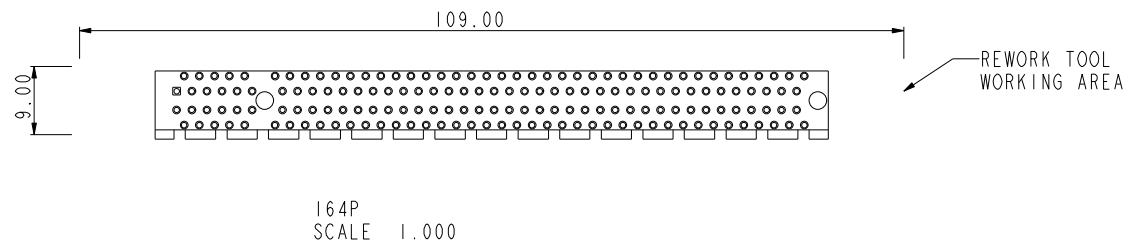
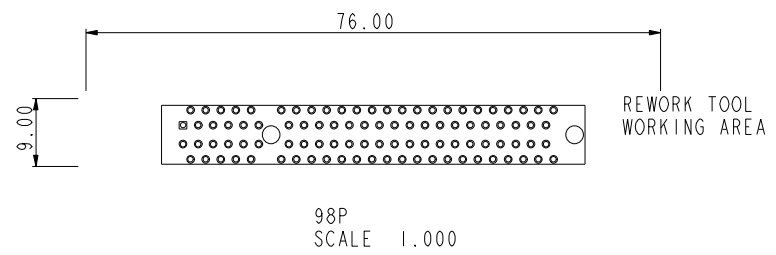
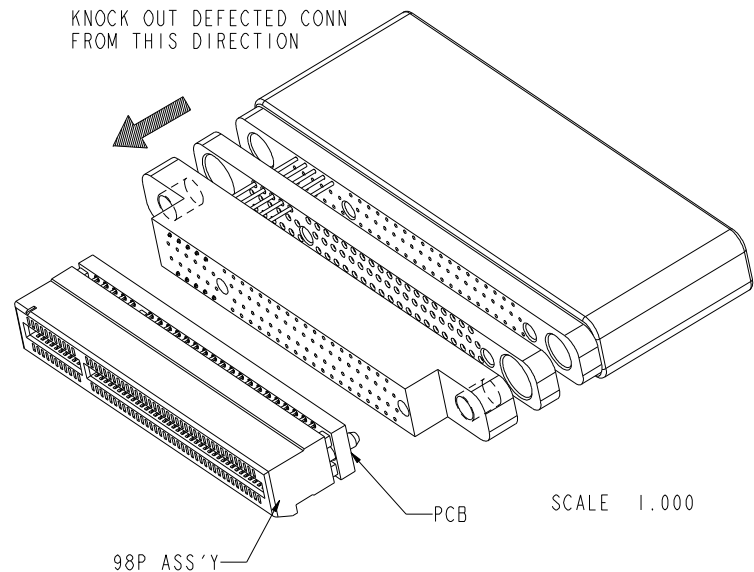

|                                      |                                  |
|--------------------------------------|----------------------------------|
| tolerance unless otherwise specified |                                  |
| linear                               | .X ± .3<br>.XX ± .2<br>.XXX ± .1 |
| angles                               | 0° ± 2°                          |

|                    |             |          |                             |           |                    |              |
|--------------------|-------------|----------|-----------------------------|-----------|--------------------|--------------|
| www.fciconnect.com |             |          | ✓                           | tolerance | projection         | MM           |
| Dr                 | MAGGIE WU   | 07/23/04 | Product family              |           | size               | A4           |
| Eng                | R Y LIU     | 07/23/04 | Spec ref                    |           | Scale              | 1.000        |
| Chr                | PAUL WANG   | 07/23/04 | Material                    |           | ECN                | DG09-0045    |
| Appr               | JOSEPH HSIA | 07/23/04 |                             |           |                    |              |
| FCI                |             |          | PCI EXPRESS PRESS-FIT ASS'Y |           | dwg no             | 10039755     |
| catalog no         |             |          |                             |           | * CUSTOMER DRAWING | sheet 6 of 6 |



Copyright FCI.

2



Компания «ЭлектроПласт» предлагает заключение долгосрочных отношений при поставках импортных электронных компонентов на взаимовыгодных условиях!

Наши преимущества:

- Оперативные поставки широкого спектра электронных компонентов отечественного и импортного производства напрямую от производителей и с крупнейших мировых складов;
- Поставка более 17-ти миллионов наименований электронных компонентов;
- Поставка сложных, дефицитных, либо снятых с производства позиций;
- Оперативные сроки поставки под заказ (от 5 рабочих дней);
- Экспресс доставка в любую точку России;
- Техническая поддержка проекта, помощь в подборе аналогов, поставка прототипов;
- Система менеджмента качества сертифицирована по Международному стандарту ISO 9001;
- Лицензия ФСБ на осуществление работ с использованием сведений, составляющих государственную тайну;
- Поставка специализированных компонентов (Xilinx, Altera, Analog Devices, Intersil, Interpoint, Microsemi, Aeroflex, Peregrine, Syfer, Eurofarad, Texas Instrument, Miteq, Cobham, E2V, MA-COM, Hittite, Mini-Circuits, General Dynamics и др.);

Помимо этого, одним из направлений компании «ЭлектроПласт» является направление «Источники питания». Мы предлагаем Вам помощь Конструкторского отдела:

- Подбор оптимального решения, техническое обоснование при выборе компонента;
- Подбор аналогов;
- Консультации по применению компонента;
- Поставка образцов и прототипов;
- Техническая поддержка проекта;
- Защита от снятия компонента с производства.



#### Как с нами связаться

**Телефон:** 8 (812) 309 58 32 (многоканальный)

**Факс:** 8 (812) 320-02-42

**Электронная почта:** [org@eplast1.ru](mailto:org@eplast1.ru)

**Адрес:** 198099, г. Санкт-Петербург, ул. Калинина, дом 2, корпус 4, литера А.