

Multi-Turn Precision Potentiometer

Model 7380 Series



Features:

- 7/8" diameter
- 3-turn
- Wirewound



Model Styles

| | |
|---|--------------------------|
| 7381 | 1/8" Shaft, 1/4" Bushing |
| 7383 | 1/8" Shaft, Servo |
| 7386 | 1/4" Shaft, 3/8" Bushing |
| 7388 (for heavy side load applications) | 1/4" Shaft, 3/8" Bushing |

Electrical

| | |
|---|--|
| Resistance Range | 100 to 30K ohms |
| Standard Resistance Tolerance | ±5% |
| Minimum Practical Resistance Tolerance | ±1% |
| Independent Linearity ² | ±0.30% (<500 ohms), ±0.25% (≥500 ohms) |
| Minimum Practical Independent Linearity | ±0.30% (<500 ohms), ±0.20% (≥500 ohms) |
| Power Rating | 1.5 Watts at 70°C, derating to 0 at 125°C |
| Dielectric Strength | 1,000 V rms |
| Insulation Resistance | 1,000 Megohms minimum |
| Noise | 100 ohms maximum |
| Actual Electrical Travel | 1080° +10° -0° (>100 ohms), 1080° +10° -5° (≤100 ohms) |
| End Voltage | maximum 0.25% of input voltage |
| Tap Tolerance | ±3° |

Environmental

| | |
|--|---|
| Operating Temperature Range | -40°C to +125°C dynamic, -55°C to +125°C static |
| Temperature Cycling | 5 cycles, -55°C to +125°C, maximum 5% ΔR |
| Shock | 6 ms Saw-tooth, 100 G's, 0.1 ms maximum discontinuity |
| Vibration | 15 G's, 10 to 2,000 Hz, maximum 5% ΔR, 0.1 ms maximum discontinuity |
| Moisture Resistance | Five 24 hour cycles, maximum 3% ΔR |
| High Temperature Exposure | 1,000 hours at 125°C, maximum 5% ΔR |
| Rotational Load Life (1 lb side load for 7388) | 300K shaft revolutions + 900 hours at 1.5 Watts & 70°C, maximum 5% ΔR |
| Ingress Protection Rating (IP Code) | IP50, IP66 available as option (feature code ES) |

General Note
TT Electronics reserves the right to make changes in product specification without notice or liability. All information is subject to TT Electronics' own data and is considered accurate at time of going to print.

TT Electronics | BI Technologies
413 Rood RD, Suite 7
Calexico, CA 92231
Ph: +1 714 447 2345
www.ttelectronics.com/bi-technologies

Multi-Turn Precision Potentiometer

Model 7380 Series



Mechanical

| | | |
|---|-------------------|---------------------------|
| Total Mechanical Travel | | 1080° +15° -0° |
| Number of Gangs | | 2 maximum |
| Weight (single gang) | | 0.75 oz. nominal |
| Backlash | | 1° maximum |
| | 7381, 7386 | 7383 |
| Static Stop Strength | maximum | 48 oz.-in. / 36 oz.-in. |
| Panel Nut Tightening Torque | maximum | 25 lb.-in. / n/a |
| Shaft End Play | maximum | 0.010" / 0.005" |
| Shaft Runout | maximum T.I.R. | 0.003" / 0.002" |
| Pilot Diameter Runout | maximum T.I.R. | 0.004" / 0.002" |
| Lateral Runout | maximum T.I.R. | 0.005" / 0.004" |
| Shaft Radial Play | maximum | 0.003" / 0.002" |
| Start/Run Torque (per gang, ES option adds 0.5 oz.-in.) | maximum | 1.2 oz.-in. / 0.9 oz.-in. |

Ordering Information

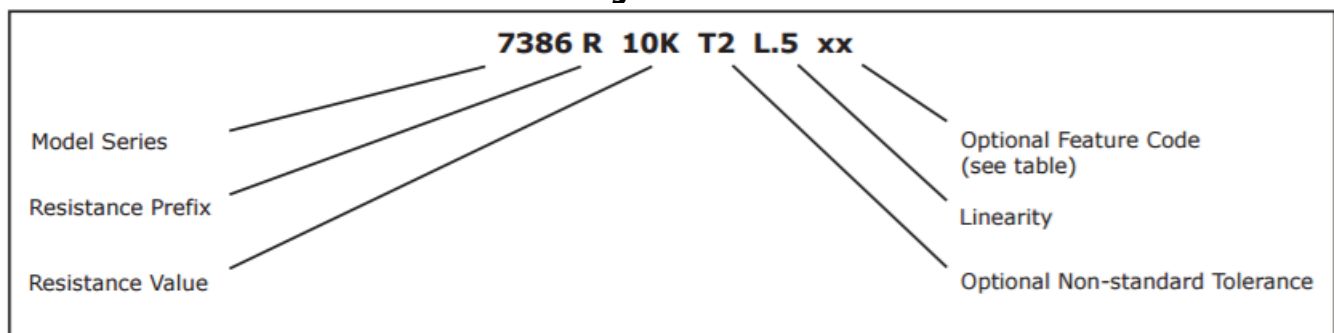

FEATURE CODES

| | |
|--|----|
| Center Tap | CT |
| Linearity Tape | LT |
| Flatted Shaft | FS |
| Slotted Shaft (standard on single cup 7386 without RS feature) | SS |
| Rear Shaft Extension (7381, 7386 single cup only) | RS |
| Shaft Lock (7386 only) | SL |
| High Torque 2-6 oz.-in. (7386 only) | HT |
| Additional Gang | 2G |
| Gold Plated Solder Lug Terminals (see optional terminal configuration) | FT |
| Seal (IP66) 7386 or 7388 only | ES |

When multiple Feature codes are used the P/N shall be in the same sequence as listed in this table (top to bottom).

STANDARD RESISTANCE VALUES

| Total Resistance (Ohms) | Theoretical Resolution (% nominal) | Tempco of wire (ppm/°C) |
|-------------------------|------------------------------------|-------------------------|
| 100 | 0.059 | ±20 |
| 200 | 0.037 | ±20 |
| 500 | 0.030 | ±20 |
| 1K | 0.024 | ±20 |
| 2K | 0.020 | ±20 |
| 5K | 0.018 | ±20 |
| 10K | 0.017 | ±20 |
| 20K | 0.016 | ±20 |

General Note

TT Electronics reserves the right to make changes in product specification without notice or liability. All information is subject to TT Electronics' own data and is considered accurate at time of going to print.

Multi-Turn Precision Potentiometer

Model 7380 Series



CIRCUIT DIAGRAM

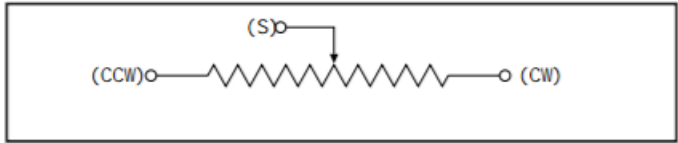

MATCHING TURNS COUNTING DIALS

7381: RBJ, 2601, 2641
7386: RB, 2126, 2606, 2606S, 2607, 2607S, 2626, 2627, 2646, 2646S, 2647, 2647S

OUTLINE DRAWINGS

Models 7381 & 7386
Bushing Mount with Sleeve Bearing

| Dim. | 7381 | 7386 |
|------|--|--|
| A | $\frac{.688 \pm .013}{17.475 \pm 0.787}$ | $\frac{.812 \pm .031}{20.625 \pm 0.787}$ |
| B | $\frac{.1248 \pm .0000}{3.1699 \pm 0.0076}$ Dia. | $\frac{.2500 \pm .0000}{6.3500 \pm 0.0127}$ Dia. |
| C | $\frac{.281 \pm .000}{7.137 \pm 0.051}$ Dia. | $\frac{.406 \pm .000}{10.312 \pm 0.051}$ Dia. |
| D | 1/4-32 UNEF Thread | 3/8-32 UNEF Thread |

Slot: $.032 \pm .005 / 0.813 \pm 0.127$ Wide X $.032 \pm .010 - .000 / 0.813 \pm 0.254 - 0.000$ Deep (Not on Rear Shaft Models)

General Note
 TT Electronics reserves the right to make changes in product specification without notice or liability. All information is subject to TT Electronics' own data and is considered accurate at time of going to print.

TT Electronics | BI Technologies
 413 Rood RD, Suite 7
 Calexico, CA 92231
 Ph: +1 714 447 2345
www.ttelectronics.com/bi-technologies

Multi-Turn Precision Potentiometer

Model 7380 Series



Optional Terminal Configuration

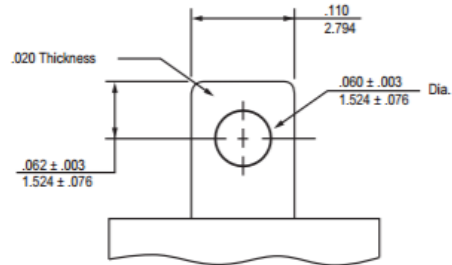
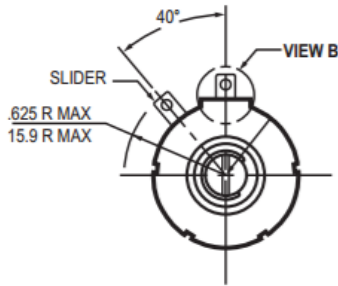

Enlarged View B

Use Special Feature Code "FT" to order.

Model 7383 Servo Mount with Ball Bearing

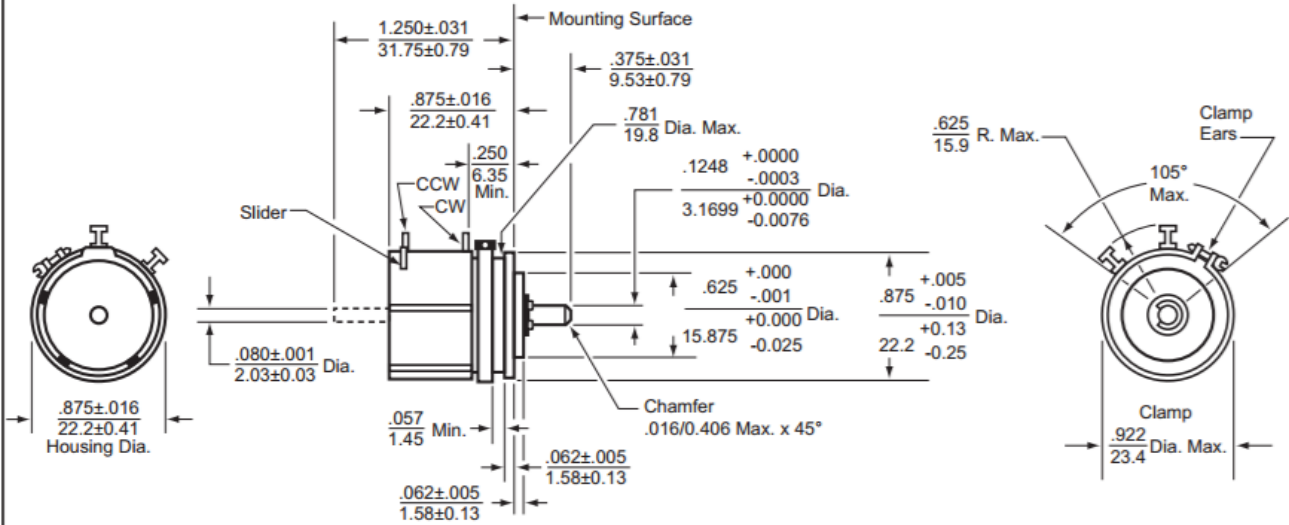

Optional Terminal Configuration

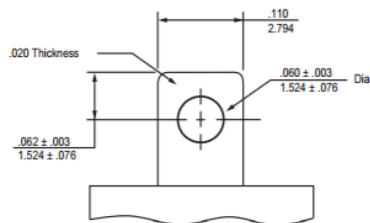
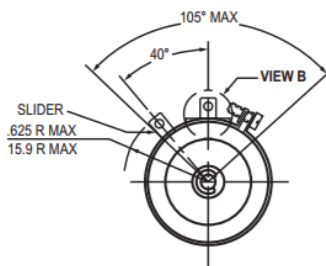

Enlarged View B

Use Special Feature Code "FT" to order.

General Note

TT Electronics reserves the right to make changes in product specification without notice or liability. All information is subject to TT Electronics' own data and is considered accurate at time of going to print.

© TT electronics plc

TT Electronics | BI Technologies
 413 Rood RD, Suite 7
 Calexico, CA 92231
 Ph: +1 714 447 2345
www.ttelectronics.com/bi-technologies



Компания «ЭлектроПласт» предлагает заключение долгосрочных отношений при поставках импортных электронных компонентов на взаимовыгодных условиях!

Наши преимущества:

- Оперативные поставки широкого спектра электронных компонентов отечественного и импортного производства напрямую от производителей и с крупнейших мировых складов;
- Поставка более 17-ти миллионов наименований электронных компонентов;
- Поставка сложных, дефицитных, либо снятых с производства позиций;
- Оперативные сроки поставки под заказ (от 5 рабочих дней);
- Экспресс доставка в любую точку России;
- Техническая поддержка проекта, помощь в подборе аналогов, поставка прототипов;
- Система менеджмента качества сертифицирована по Международному стандарту ISO 9001;
- Лицензия ФСБ на осуществление работ с использованием сведений, составляющих государственную тайну;
- Поставка специализированных компонентов (Xilinx, Altera, Analog Devices, Intersil, Interpoint, Microsemi, Aeroflex, Peregrine, Syfer, Eurofarad, Texas Instrument, Miteq, Cobham, E2V, MA-COM, Hittite, Mini-Circuits, General Dynamics и др.);

Помимо этого, одним из направлений компании «ЭлектроПласт» является направление «Источники питания». Мы предлагаем Вам помощь Конструкторского отдела:

- Подбор оптимального решения, техническое обоснование при выборе компонента;
- Подбор аналогов;
- Консультации по применению компонента;
- Поставка образцов и прототипов;
- Техническая поддержка проекта;
- Защита от снятия компонента с производства.



Как с нами связаться

Телефон: 8 (812) 309 58 32 (многоканальный)

Факс: 8 (812) 320-02-42

Электронная почта: org@eplast1.ru

Адрес: 198099, г. Санкт-Петербург, ул. Калинина, дом 2, корпус 4, литера А.