

# Flush-type connector - SACC-DSI-M12MSS-4P-M16XL/0,5PE - 1411603

Please be informed that the data shown in this PDF Document is generated from our Online Catalog. Please find the complete data in the user's documentation. Our General Terms of Use for Downloads are valid (<http://phoenixcontact.com/download>)



Flush-type connector, Power, 4-position, PlugLink:M12, S power, Rear mounting, M16 x 1.5, Individual wires, Cable length: 0.5 m

## Why buy this product

- For compact devices: transmit high power in a confined space
- Easy-to-install, optimized XL housing contour with wrench size 19
- Tightening limitation for the O-ring gasket
- Pre-assembled with litz wires for immediate use
- Customer-specific assemblies and litz wire lengths available
- Sealed on the litz wire side for optimum leak-tightness
- For high transmission safety: shield connection to the housing with optional EMC nut

## Key Commercial Data

|                                      |   |
|--------------------------------------|---|
| Packing unit                         | 1 STK   |
| GTIN                                 | <br>4 046356 936170 |
| Weight per Piece (excluding packing) | 52.3 g  |
| Weight per piece (including packing) | 52.3 g  |
| Country of origin                    | Germany   |
| Note                                 | Made to Order (non-returnable)  |

## Technical data

### Dimensions

|                 |       |
|-----------------|-------|
| Length of cable | 0.5 m |
|-----------------|-------|

### Ambient conditions

|                                 |   |
|---------------------------------|---|
| Ambient temperature (operation) | -25 °C ... 85 °C (Plug / socket)                |
|                                 | -40 °C ... 85 °C (without mechanical actuation) |
| Degree of protection            | IP67  |

### General

|      |   |
|------|---|
| Note | The electrical and mechanical data specified assume that the connector pair is correctly locked and mounted. If the connector is unlocked and if there is a danger of contamination, the connector must be sealed using |
|------|---|

# Flush-type connector - SACC-DSI-M12MSS-4P-M16XL/0,5PE - 1411603

## Technical data

### General

|                             |  |
|-----------------------------|--|
|                             | a protective cap > IP54. Influences arising from litz wires, cables or PCB assembly must also be taken into consideration. |
| Rated current at 40°C       | 12 A   |
| Rated voltage               | 630 V  |
| Rated surge voltage         | 6 kV   |
| Number of positions         | 4  |
| Insulation resistance       | ≥ 100 MΩ   |
| Coding                      | S power  |
| Standards/regulations       | M12 connector  |
| Signal type/category        | Power  |
| Status display              | No   |
| Overvoltage category        | III  |
| Degree of pollution         | 3  |
| Connection method           | Individual wires   |
| Insertion/withdrawal cycles | > 100  |
| Torque                      | 0.8 Nm ... 1.3 Nm (Installation-side)  |
| Mounting type               | Rear mounting M16 x 1.5 With flat nut  |
| Assembly instructions       | Tightening limitation  |

### Material

|  |                              |
|--|------------------------------|
| Flammability rating according to UL 94 | V0                           |
| Contact material                       | CuZn                         |
| Contact surface material               | Au                           |
| Contact carrier material               | PA                           |
| Material, knurls                       | Zinc die-cast, nickel-plated |
| Sealing material                       | FKM                          |

### Cable

|                                 |   |
|---------------------------------|---|
| Cable type                      | PP litz wire                                    |
| Conductor cross section         | 1.5 mm <sup>2</sup>                             |
| AWG signal line                 | 16  |
| Wire colors                     | Black 1, black 2, black 3, green/yellow         |
| Conductor material              | Bare Cu litz wires                              |
| Standards/specifications        | M12 connector                                   |
| Ambient temperature (operation) | -40 °C ... 90 °C (cable, fixed installation)    |
|                                 | -30 °C ... 90 °C (cable, flexible installation) |

### Standards and Regulations

|  |               |
|--|---------------|
| Standard designation                   | M12 connector |
| Flammability rating according to UL 94 | V0            |

# Flush-type connector - SACC-DSI-M12MSS-4P-M16XL/0,5PE - 1411603

## Classifications

### eCl@ss

|            |          |
|------------|----------|
| eCl@ss 5.1 | 27143423 |
| eCl@ss 6.0 | 27143423 |
| eCl@ss 8.0 | 27440103 |
| eCl@ss 9.0 | 27440102 |

### ETIM

|          |          |
|----------|----------|
| ETIM 4.0 | EC002061 |
| ETIM 5.0 | EC002061 |

## Approvals

### Approvals

#### Approvals

UL Listed / cUL Listed / EAC / cULus Listed

#### Ex Approvals

#### Approvals submitted

### Approval details

|   |       |
|---|-------|
| UL Listed  |       |
| mm <sup>2</sup> /AWG/kcmil  | 16    |
| Nominal current I <sub>N</sub>  | 12 A  |
| Nominal voltage U <sub>N</sub>  | 600 V |

|  |       |
|--|-------|
| cUL Listed  |       |
| mm <sup>2</sup> /AWG/kcmil   | 16    |
| Nominal current I <sub>N</sub>   | 12 A  |
| Nominal voltage U <sub>N</sub>   | 600 V |

|     |
|-----|
| EAC |
|-----|

# Flush-type connector - SACC-DSI-M12MSS-4P-M16XL/0,5PE - 1411603

## Approvals



## Drawings

Schematic diagram



Connector pin assignment of M12 plug, 4-pos., S-coded, view of pin side

Dimensional drawing

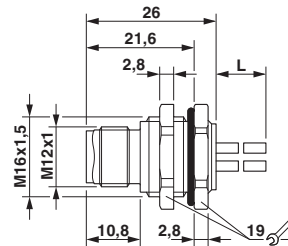

M12 flush-type plug

Circuit diagram



## Contact assignment

Phoenix Contact 2016 © - all rights reserved  
<http://www.phoenixcontact.com>

PHOENIX CONTACT GmbH & Co. KG  
Flachsmarktstr. 8  
32825 Blomberg  
Germany  
Tel. +49 5235 300  
Fax +49 5235 3 41200  
<http://www.phoenixcontact.com>



Компания «ЭлектроПласт» предлагает заключение долгосрочных отношений при поставках импортных электронных компонентов на взаимовыгодных условиях!

Наши преимущества:

- Оперативные поставки широкого спектра электронных компонентов отечественного и импортного производства напрямую от производителей и с крупнейших мировых складов;
- Поставка более 17-ти миллионов наименований электронных компонентов;
- Поставка сложных, дефицитных, либо снятых с производства позиций;
- Оперативные сроки поставки под заказ (от 5 рабочих дней);
- Экспресс доставка в любую точку России;
- Техническая поддержка проекта, помощь в подборе аналогов, поставка прототипов;
- Система менеджмента качества сертифицирована по Международному стандарту ISO 9001;
- Лицензия ФСБ на осуществление работ с использованием сведений, составляющих государственную тайну;
- Поставка специализированных компонентов (Xilinx, Altera, Analog Devices, Intersil, Interpoint, Microsemi, Aeroflex, Peregrine, Syfer, Eurofarad, Texas Instrument, Miteq, Cobham, E2V, MA-COM, Hittite, Mini-Circuits, General Dynamics и др.);

Помимо этого, одним из направлений компании «ЭлектроПласт» является направление «Источники питания». Мы предлагаем Вам помощь Конструкторского отдела:

- Подбор оптимального решения, техническое обоснование при выборе компонента;
- Подбор аналогов;
- Консультации по применению компонента;
- Поставка образцов и прототипов;
- Техническая поддержка проекта;
- Защита от снятия компонента с производства.



#### Как с нами связаться

**Телефон:** 8 (812) 309 58 32 (многоканальный)

**Факс:** 8 (812) 320-02-42

**Электронная почта:** [org@eplast1.ru](mailto:org@eplast1.ru)

**Адрес:** 198099, г. Санкт-Петербург, ул. Калинина, дом 2, корпус 4, литера А.