

10 x 38, 14 x 51, 22 x 58

CH Series



Features:

- 10 ≈ 38 Dovetail design provides maximum flexibility in assembling multiple poles
- Touchsafe design - No exposed contacts
- DIN rail mount (35mm)
- Optional open fuse indication lights
- Excellent for switchboard panel, control consoles, small motors, transformers, and similar applications
- Handle/fusepuller to install and remove fuses easily
- Available in single and multi-pole configurations
- Circuit marking system (P/N CH10CL and CH10CM)
- Wire ready: Saves time as terminals are ready to accept wires.
- CE marking

Specifications

| Fuse Size (mm) | | 10 x 38 | 14 x 51 | 22 x 56 |
|-----------------------------|--------------------|------------------------|-------------------------------|--------------------------------|
| Voltage | U.L./CSA*** IEC | 600V 690V | 750V*** 660V | 750V*** 660V |
| Amperage | U.L./CSA*** IEC | 30A 32A | 30A*** 50A(See Watts Loss) | 50A*** 125A(See Watts Loss) |
| Wire Size | | #8 - #18 Cu only | #6 - #14 Cu only | #1 - #14 Cu only |
| Wire Type (& Temp.) | | Solid/Stranded (75°) | Solid/Stranded (75°) | Solid/Stranded (75°) |
| Torque (in-lbs) | | 12 in-lbs | 17.7 in-lbs | 22.1 in-lbs |
| IP Rating | | IP 20 | IP 20 | IP 20 |
| Contact Material (fuseclip) | | Tin-plated copper | Tin-plated copper | Tin-plated copper |
| Connector Material | | Steel | Steel | Steel |
| Maximum Watts Loss of Fuse | | 3W‡ | 5W‡ | 9.5W‡ |
| Dual Wire Rating | | Please consult factory | | |

| 10 x 38 | 30A, 600V | 30A, 600V | 32A, 690V |
|--------------------------|------------------------------------|----------------------------------|-----------------------------|
| Description | North American Class CC Fuseholder | North American Midget Fuseholder | European 10 ≈ 38 Fuseholder |
| 1 Pole | CHCC1 | CHM1 | CH101 |
| 1 Pole w/Indication | CHCC1I | CHM1I | CH101I |
| 2 Pole | CHCC2 | CHM2 | CH102 |
| 2 Pole w/Indication | CHCC2I | CHM2I | CH102I |
| 3 Pole | CHCC3 | CHM3 | CH103 |
| 3 Pole w/Indication | CHCC3I | CHM3I | CH103I |
| *Assembly Pins - 2 Poles | CH102AP | CH102AP | CH102AP |
| *Assembly Pins - 3 Poles | CH103AP | CH103AP | CH103AP |
| **Circuit markers | CH10CM | CH10CM | CH10CM |
| **Circuit marker labels | CH10CL | CH10CL | CH10CL |
| Spare Fuseholder | 5TPH | 5TPH | 5TPH |

‡Refer to BIF documents 720003, 720008, 720025 and 720028 for watts loss of applicable fuses.
 *CH102AP and CH103AP are packaged in quantities of ten pins. One pin is required to gang units together, and rating multiple poles.
 **CH10CM are packaged in quantities of ten. CH10CL are packaged in quantities of ten sheets of labels.
 ***U.L./CSA part numbers include U.L. suffix.

Standards:

North American 10 x 38 Class CC

Listed U.L. 512, Guide IZLT, File E14853
 Certified CSA Std. C22.2 No. 39, Class 6225-01,
 File LR47235

North American 10 x 38 Midget

U.L. Recognized 512, Guide IZLT2, File E14853
 CSA Certified, Std. C22.2 No. 39, Class 6225-01,
 File LR47235

European 10 x 38 IEC 269-21

14 x 51 IEC 269-2***

U.L. Recognized, CSA Certified

22 x 58 IEC 269-2***

U.L. Recognized, CSA Certified

Recommended Buss® Fuse Types:

- 10 ≈ 38 North American Class CC Fuses - LP-CC, FNQ-R, KTK-R
- 10 ≈ 38 North American Midget Fuses - FNQ, KTK, AGU, KLM, BAF, BAN, FNM, FWA, FWC, & FNQ
- 14 ≈ 51 Fuses - FWX, FWH, FWP & NON
- 22 ≈ 58 Fuses - FWP

| | 14 x 51 | | 22 x 58 | |
|--------------------------|----------|-----------|----------|-----------|
| Description | Part No. | Ctn. Qty. | Part No. | Ctn. Qty. |
| 1 Pole | CH141G | 6 | CH221G | 6 |
| 1 Pole w/U.L. markings | CH141GUL | 6 | CH221GUL | 6 |
| 1 Pole w/microswitch | CH141MSG | 6 | CH221MSG | 6 |
| 2 Pole | CH142G | 3 | CH222G | 3 |
| 3 Pole | CH143G | 2 | CH223G | 2 |
| 3 Pole w/U.L. markings | CH143GUL | 2 | CH223GUL | 2 |
| 3 Pole w/microswitch | CH143MSG | 2 | CH223MSG | 2 |
| Handle Profile - 2 Poles | CH142HCG | 10 | CH222HCG | 10 |
| Handle Profile - 3 Poles | CH143HCG | 10 | CH223HCG | 10 |

CE CE logo denotes compliance with European Union Low Voltage Directive (50-1000 Vac, 75-1500 Vdc). Refer to BIF document #8002 or contact Bussmann Application Engineering at 636-527-1270 for more information.

10 × 38, 14 × 51, 22 × 58

CH Series

Size: 10 × 38 Fuseholder

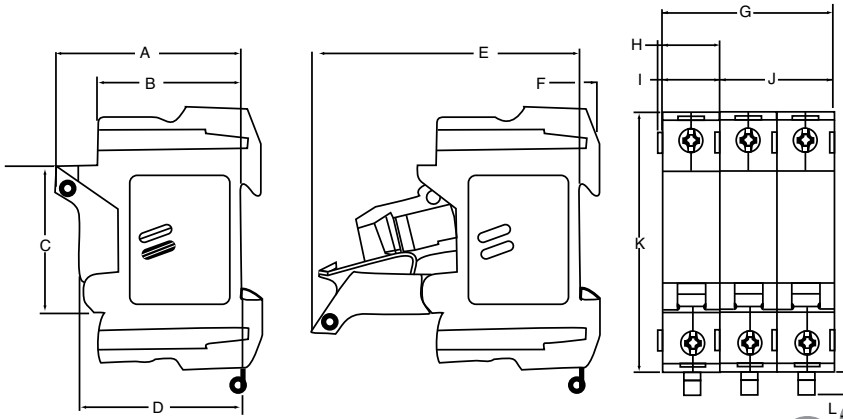

| | in | (mm) | | in | (mm) |
|----------|------|--------|----------|------|--------|
| A | 2.26 | (57.5) | G | 2.07 | (52.5) |
| B | 1.73 | (44.0) | H | 0.75 | (19.0) |
| C | 1.78 | (45.2) | I | 0.69 | (17.5) |
| D | 1.97 | (49.9) | J | 1.38 | (35.0) |
| E | 3.24 | (82.2) | K | 3.18 | (80.7) |
| F | 0.24 | (6.0) | L | 0.30 | (7.6) |

Size: 14 × 51 Fuseholder

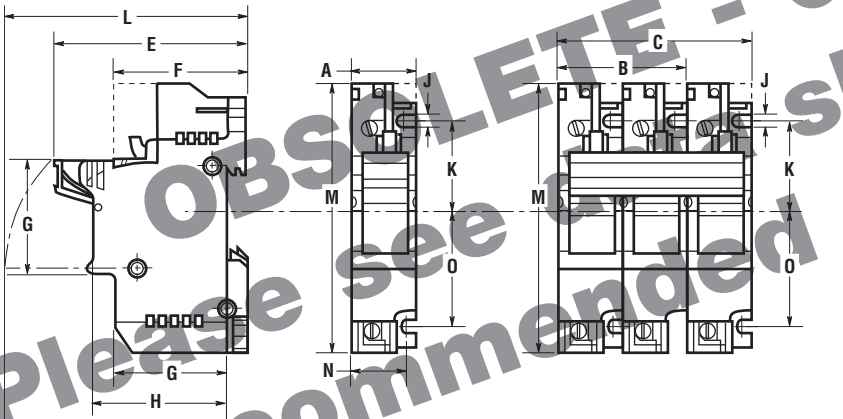

| | in | (mm) | | in | (mm) |
|----------|------|--------|----------|------|---------|
| A | 0.98 | (26.0) | I | 3.50 | (89.0) |
| B | 2.05 | (52.0) | J | 0.20 | (5.0) |
| C | 3.07 | (78.0) | K | 1.28 | (32.5) |
| E | 3.19 | (81.0) | L | 3.86 | (98.0) |
| F | 2.11 | (53.5) | M | 4.17 | (106.0) |
| G | 1.75 | (44.5) | N | 0.83 | (21.0) |
| H | 2.07 | (52.6) | O | 1.72 | (43.8) |

Size: 22 × 58 Fuseholder

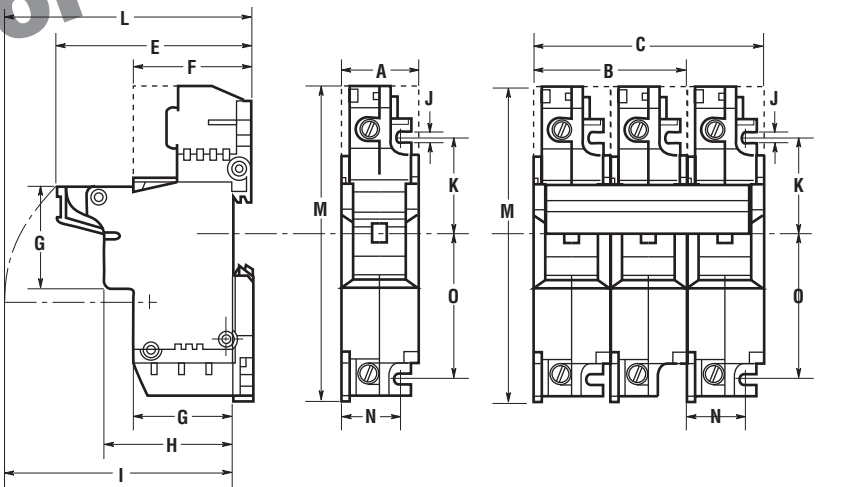

| | in | (mm) | | in | (mm) |
|----------|------|---------|----------|------|---------|
| A | 1.38 | (35.0) | I | 4.06 | (103.0) |
| B | 2.76 | (70.0) | J | 0.18 | (4.5) |
| C | 4.13 | (105.0) | K | 1.77 | (45.0) |
| E | 3.46 | (88.0) | L | 4.41 | (112.0) |
| F | 2.09 | (53.0) | M | 5.51 | (140.0) |
| G | 1.77 | (45.0) | N | 1.04 | (26.5) |
| H | 2.28 | (58.0) | O | 2.48 | (63.0) |

The only controlled copy of this BIF document is the electronic read-only version located on the Bussmann Network Drive. All other copies of this document are by definition uncontrolled. This bulletin is intended to clearly present comprehensive product data and provide technical information that will help the end user with design applications. Bussmann reserves the right, without notice, to change design or construction of any products and to discontinue or limit distribution of any products. Bussmann also reserves the right to change or update, without notice, any technical information contained in this bulletin. Once a product has been selected, it should be tested by the user in all possible applications.



Компания «ЭлектроПласт» предлагает заключение долгосрочных отношений при поставках импортных электронных компонентов на взаимовыгодных условиях!

Наши преимущества:

- Оперативные поставки широкого спектра электронных компонентов отечественного и импортного производства напрямую от производителей и с крупнейших мировых складов;
- Поставка более 17-ти миллионов наименований электронных компонентов;
- Поставка сложных, дефицитных, либо снятых с производства позиций;
- Оперативные сроки поставки под заказ (от 5 рабочих дней);
- Экспресс доставка в любую точку России;
- Техническая поддержка проекта, помощь в подборе аналогов, поставка прототипов;
- Система менеджмента качества сертифицирована по Международному стандарту ISO 9001;
- Лицензия ФСБ на осуществление работ с использованием сведений, составляющих государственную тайну;
- Поставка специализированных компонентов (Xilinx, Altera, Analog Devices, Intersil, Interpoint, Microsemi, Aeroflex, Peregrine, Syfer, Eurofarad, Texas Instrument, Miteq, Cobham, E2V, MA-COM, Hittite, Mini-Circuits, General Dynamics и др.);

Помимо этого, одним из направлений компании «ЭлектроПласт» является направление «Источники питания». Мы предлагаем Вам помощь Конструкторского отдела:

- Подбор оптимального решения, техническое обоснование при выборе компонента;
- Подбор аналогов;
- Консультации по применению компонента;
- Поставка образцов и прототипов;
- Техническая поддержка проекта;
- Защита от снятия компонента с производства.



Как с нами связаться

Телефон: 8 (812) 309 58 32 (многоканальный)

Факс: 8 (812) 320-02-42

Электронная почта: org@eplast1.ru

Адрес: 198099, г. Санкт-Петербург, ул. Калинина, дом 2, корпус 4, литера А.