

THIS COPY IS PROVIDED ON A RESTRICTED BASIS AND IS NOT TO BE USED IN ANY WAY DETRIMENTAL TO THE INTERESTS OF PANDUIT CORP.

Example: T25E-C16



COLOR AVAILABILITY

COLOR	COLOR SUFFIX	MATERIAL						
		POLYETHYLENE	WEATHER RESISTANT POLYETHYLENE	FLAME RETARDANT POLYETHYLENE V2 RATING	FLAME RETARDANT POLYETHYLENE VO RATING	NYLON	WEATHER RESISTANT NYLON	TEFLON
NATURAL (CLEAR)	LEAVE BLANK	X		NATURAL COLOR IS WHITE	NATURAL COLOR IS WHITE	X		X
WEATHER RESISTANT BLACK	0		X				X	
BROWN	1	X						
RED	2							
ORANGE	3	X						
YELLOW	4	X						
GREEN	5	X						
BLUE	6	X						
PURPLE	7	X						
GRAY	8	X						
WHITE	10	X						
PINK	16	X						
BLACK	20			X	X			



CAD FILENAME/LAYERS G00239HA_DC_SPIRALWRP_00

PANDUIT CORP. TINLEY PARK, ILLINOIS

SPIRAL WRAP

UNLESS OTHERWISE SPECIFIED, DIMENSIONAL TOLERANCES ARE:
 (.X) ±0.05 (1.3) (.XXX) ±0.010 (0.25)
 (.XX) ±0.02 (0.5) ANGLES ± 5°

UNLESS OTHERWISE SPECIFIED, ALL DIMENSIONS ARE GIVEN IN INCHES, THIRD ANGLE PROJECTION.

DRAWN BY JAD MAT'L: SEE TABLE SCALE NONE

DATE 12-4-00 DRAWING NO. G00239HA DWG SIZE A

- Notes:
1. Refer to Panduit Catalogs for any additional information.
 2. For roll sizes larger than 10 ft., splicing may occur. For additional information, contact Product Management at 1-800-777-3300 ext. 7432.
 3. Refer to Panduit Catalogs for dimensional data.
 4. Colors are stocked for 1/4" and 1/2" Polyethylene. Other sizes available, consult factory.

R	12-4-00	JAD		INITIAL RELEASE	GB0239HA	R			
REV	DATE	BY	CHK	DESCRIPTION	ECN	R	CUST	SUP	

Spiral Wrapping

Ordering Information — Spiral Wrapping



Ordering Information — Spiral Wrapping

Part Number	Material	Color	A In. (mm)	B In. (mm)	T In. (mm)	Bundle Size In. (mm)	Length	Std. Pkg. Qty*
T12F-C	Polyethylene	Natural	0.125" (3.2)	0.218" (5.5)	0.03" (.76)	1/16" (1.6) – 1/2" (12.7)	100' (30.5M)	1 Pkg.
T19F-C		Natural	0.188" (4.8)	0.250" (6.4)	0.035" (0.89)	1/8" (3.2) - 1" (25.4)	100' (30.5M)	1 Pkg.
T25F-X		Natural	0.25" (6.4)	0.375" (9.5)	0.04" (1.02)	3/16" (4.8) – 2" (50.8)	10' (3.0M)	1 Pkg.
T25F-C		Natural	0.25" (6.4)	0.375" (9.5)	0.04" (1.02)	3/16" (4.8) – 2" (50.8)	100' (30.5M)	1 Pkg.
T25F-C1		Brown	0.25" (6.4)	0.375" (9.5)	0.04" (1.02)	3/16" (4.8) – 2" (50.8)	100' (30.5M)	1 Pkg.
T25F-C10		White	0.25" (6.4)	0.375" (9.5)	0.04" (1.02)	3/16" (4.8) – 2" (50.8)	100' (30.5M)	1 Pkg.
T25F-C16		Pink	0.25" (6.4)	0.375" (9.5)	0.04" (1.02)	3/16" (4.8) – 2" (50.8)	100' (30.5M)	1 Pkg.
T25F-C2		Red	0.25" (6.4)	0.375" (9.5)	0.04" (1.02)	3/16" (4.8) – 2" (50.8)	100' (30.5M)	1 Pkg.
T25F-C3		Orange	0.25" (6.4)	0.375" (9.5)	0.04" (1.02)	3/16" (4.8) – 2" (50.8)	100' (30.5M)	1 Pkg.
T25F-C4		Yellow	0.25" (6.4)	0.375" (9.5)	0.04" (1.02)	3/16" (4.8) – 2" (50.8)	100' (30.5M)	1 Pkg.
T25F-C5		Green	0.25" (6.4)	0.375" (9.5)	0.04" (1.02)	3/16" (4.8) – 2" (50.8)	100' (30.5M)	1 Pkg.
T25F-C6		Blue	0.25" (6.4)	0.375" (9.5)	0.04" (1.02)	3/16" (4.8) – 2" (50.8)	100' (30.5M)	1 Pkg.
T25F-C7		Purple	0.25" (6.4)	0.375" (9.5)	0.04" (1.02)	3/16" (4.8) – 2" (50.8)	100' (30.5M)	1 Pkg.
T25F-C8		Gray	0.25" (6.4)	0.375" (9.5)	0.04" (1.02)	3/16" (4.8) – 2" (50.8)	100' (30.5M)	1 Pkg.
T38F-C		Natural	0.375" (9.5)	0.437" (11.1)	0.055" (1.4)	5/16" (7.9) – 3" (76.2)	100' (30.5M)	1 Pkg.
T50F-X		Natural	0.5" (12.7)	0.5" (12.7)	0.06" (1.5)	3/8" (9.5) – 4" (101.6)	10' (3.0M)	1 Pkg.
T50F-C		Natural	0.5" (12.7)	0.5" (12.7)	0.06" (1.5)	3/8" (9.5) – 4" (101.6)	100' (30.5M)	1 Pkg.
T50F-C1		Brown	0.5" (12.7)	0.5" (12.7)	0.06" (1.5)	3/8" (9.5) – 4" (101.6)	100' (30.5M)	1 Pkg.
T50F-C10		White	0.5" (12.7)	0.5" (12.7)	0.06" (1.5)	3/8" (9.5) – 4" (101.6)	100' (30.5M)	1 Pkg.
T50F-C16		Pink	0.5" (12.7)	0.5" (12.7)	0.06" (1.5)	3/8" (9.5) – 4" (101.6)	100' (30.5M)	1 Pkg.
T50F-C2		Red	0.5" (12.7)	0.5" (12.7)	0.06" (1.5)	3/8" (9.5) – 4" (101.6)	100' (30.5M)	1 Pkg.
T50F-C3		Orange	0.5" (12.7)	0.5" (12.7)	0.06" (1.5)	3/8" (9.5) – 4" (101.6)	100' (30.5M)	1 Pkg.
T50F-C4		Yellow	0.5" (12.7)	0.5" (12.7)	0.06" (1.5)	3/8" (9.5) – 4" (101.6)	100' (30.5M)	1 Pkg.
T50F-C5		Green	0.5" (12.7)	0.5" (12.7)	0.06" (1.5)	3/8" (9.5) – 4" (101.6)	100' (30.5M)	1 Pkg.
T50F-C6		Blue	0.5" (12.7)	0.5" (12.7)	0.06" (1.5)	3/8" (9.5) – 4" (101.6)	100' (30.5M)	1 Pkg.
T50F-C7	Purple	0.5" (12.7)	0.5" (12.7)	0.06" (1.5)	3/8" (9.5) – 4" (101.6)	100' (30.5M)	1 Pkg.	
T50F-C8	Gray	0.5" (12.7)	0.5" (12.7)	0.06" (1.5)	3/8" (9.5) – 4" (101.6)	100' (30.5M)	1 Pkg.	
T62F-C	Natural	0.625" (15.9)	0.625" (15.9)	0.062" (1.57)	1/2" (12.7) – 4 1/2" (114.3)	100' (30.5M)	1 Pkg.	
T75F-C	Natural	0.75" (19.1)	0.875" (22.2)	0.065" (1.65)	5/8" (15.9) – 5" (127)	100' (30.5M)	1 Pkg.	
T100F-C	Natural	1" (25.4)	1.125" (28.6)	0.07" (1.78)	7/8" (22.2) – 6" (152.4)	100' (30.5M)	1 Pkg.	
T12F-C0	Weather Resistant Polyethylene	Black	0.125" (3.2)	0.218" (5.5)	0.03" (.76)	1/16" (1.6) – 1/2" (12.7)	100' (30.5M)	1 Pkg.
T19F-X0		Black	0.188" (4.8)	0.250" (6.4)	0.035" (0.89)	1/8" (3.2) - 1" (25.4)	10' (3.0M)	1 Pkg.
T25F-X0		Black	0.25" (6.4)	0.375" (9.5)	0.04" (1.02)	3/16" (4.8) – 2" (50.8)	10' (3.0M)	1 Pkg.
T25F-C0		Black	0.25" (6.4)	0.375" (9.5)	0.04" (1.02)	3/16" (4.8) – 2" (50.8)	100' (30.5M)	1 Pkg.
T38F-C0		Black	0.375" (9.5)	0.437" (11.1)	0.055" (1.4)	5/16" (7.9) – 3" (76.2)	100' (30.5M)	1 Pkg.
T50F-X0		Black	0.5" (12.7)	0.5" (12.7)	0.06" (1.5)	3/8" (9.5) – 4" (101.6)	10' (3.0M)	1 Pkg.
T50F-C0		Black	0.5" (12.7)	0.5" (12.7)	0.06" (1.5)	3/8" (9.5) – 4" (101.6)	100' (30.5M)	1 Pkg.
T62F-C0		Black	0.625" (15.9)	0.625" (15.9)	0.062" (1.57)	1/2" (12.7) – 4 1/2" (114.3)	100' (30.5M)	1 Pkg.
T75F-C0		Black	0.75" (19.1)	0.875" (22.2)	0.065" (1.65)	5/8" (15.9) – 5" (127)	100' (30.5M)	1 Pkg.
T100F-C0		Black	1" (25.4)	1.125" (28.6)	0.07" (1.78)	7/8" (22.2) – 6" (152.4)	100' (30.5M)	1 Pkg.

*Order in multiples of Std. Pkg. Qty.

NOTE: Custom cut-to-length sizes are available upon request. Contact factory for details.

Spiral Wrapping

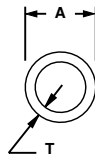

Ordering Information — Spiral Wrapping

Part Number	Material	Color	A In. (mm)	B In. (mm)	T In. (mm)	Bundle Size In. (mm)	Length	Std. Pkg. Qty*
T12R-C	Flame Retardant Polyethylene (U.L. V2)	White	0.125" (3.2)	0.218" (5.5)	0.03" (.76)	1/16" (1.6) – 1/2" (12.7)	100' (30.5M)	1 Pkg.
T19R-C		White	0.188" (4.8)	0.250" (6.4)	0.035" (0.89)	1/8" (3.2) – 1" (25.4)	100' (30.5M)	1 Pkg.
T25R-C		White	0.25" (6.4)	0.375" (9.5)	0.04" (1.02)	3/16" (4.8) – 2" (50.8)	100' (30.5M)	1 Pkg.
T25R-C20		Black	0.25" (6.4)	0.375" (9.5)	0.04" (1.02)	3/16" (4.8) – 2" (50.8)	100' (30.5M)	1 Pkg.
T38R-C		White	0.375" (9.5)	0.437" (11.1)	0.055" (1.4)	5/16" (7.9) – 3" (76.2)	100' (30.5M)	1 Pkg.
T50R-C		White	0.5" (12.7)	0.5" (12.7)	0.06" (1.5)	3/8" (9.5) – 4" (101.6)	100' (30.5M)	1 Pkg.
T62R-C		White	0.625" (15.9)	0.625" (15.9)	0.062" (1.57)	1/2" (12.7) – 4 1/2" (114.3)	100' (30.5M)	1 Pkg.
T75R-C		White	0.75" (19.1)	0.875" (22.2)	0.065" (1.65)	5/8" (15.9) – 5" (127)	100' (30.5M)	1 Pkg.
T100R-C		White	1" (25.4)	1.125" (28.6)	0.07" (1.78)	7/8" (22.2) – 6" (152.4)	100' (30.5M)	1 Pkg.
T12FR-C		Flame Retardant Polyethylene (U.L. V0)	White	0.125" (3.2)	0.218" (5.5)	0.03" (.76)	1/16" (1.6) – 1/2" (12.7)	100' (30.5M)
T12FR-C20	Black		0.125" (3.2)	0.218" (5.5)	0.03" (.76)	1/16" (1.6) – 1/2" (12.7)	100' (30.5M)	1 Pkg.
T19FR-C	White		0.188" (4.8)	0.250" (6.4)	0.032" (0.81)	1/8" (3.2) – 1" (25.4)	100' (30.5M)	1 Pkg.
T19FR-C20	Black		0.188" (4.8)	0.250" (6.4)	0.032" (0.81)	1/8" (3.2) – 1" (25.4)	100' (30.5M)	1 Pkg.
T25FR-C	White		0.25" (6.4)	0.375" (9.5)	0.04" (1.02)	3/16" (4.8) – 2" (50.8)	100' (30.5M)	1 Pkg.
T25FR-C20	Black		0.25" (6.4)	0.375" (9.5)	0.04" (1.02)	3/16" (4.8) – 2" (50.8)	100' (30.5M)	1 Pkg.
T38FR-C	White		0.375" (9.5)	0.437" (11.1)	0.055" (1.4)	5/16" (7.9) – 3" (76.2)	100' (30.5M)	1 Pkg.
T38FR-C20	Black		0.375" (9.5)	0.437" (11.1)	0.055" (1.4)	5/16" (7.9) – 3" (76.2)	100' (30.5M)	1 Pkg.
T50FR-C	White		0.5" (12.7)	0.5" (12.7)	0.06" (1.5)	3/8" (9.5) – 4" (101.6)	100' (30.5M)	1 Pkg.
T50FR-C20	Black		0.5" (12.7)	0.5" (12.7)	0.06" (1.5)	3/8" (9.5) – 4" (101.6)	100' (30.5M)	1 Pkg.
T62FR-C	White	0.625" (15.9)	0.625" (15.9)	0.062" (1.57)	1/2" (12.7) – 4 1/2" (114.3)	100' (30.5M)	1 Pkg.	
T62FR-C20	Black	0.625" (15.9)	0.625" (15.9)	0.062" (1.57)	1/2" (12.7) – 4 1/2" (114.3)	100' (30.5M)	1 Pkg.	
T75FR-C	White	0.75" (19.1)	0.875" (22.2)	0.065" (1.65)	5/8" (15.9) – 5" (127)	100' (30.5M)	1 Pkg.	
T75FR-C20	Black	0.75" (19.1)	0.875" (22.2)	0.065" (1.65)	5/8" (15.9) – 5" (127)	100' (30.5M)	1 Pkg.	
T100FR-C	White	1" (25.4)	1.125" (28.6)	0.07" (1.78)	7/8" (22.2) – 6" (152.4)	100' (30.5M)	1 Pkg.	
T100FR-C20	Black	1" (25.4)	1.125" (28.6)	0.07" (1.78)	7/8" (22.2) – 6" (152.4)	100' (30.5M)	1 Pkg.	
T12N-C	Nylon (Black Nylon is weather resistant)	Natural	0.125" (3.2)	0.218" (5.5)	0.015" (.38)	1/16" (1.6) – 1/2" (12.7)	100' (30.5M)	1 Pkg.
T12N-C0		Black	0.125" (3.2)	0.218" (5.5)	0.015" (.38)	1/16" (1.6) – 1/2" (12.7)	100' (30.5M)	1 Pkg.
T19N-C		Natural	0.188" (4.8)	0.250" (6.4)	0.020" (0.51)	1/8" (3.2) – 1" (25.4)	100' (30.5M)	1 Pkg.
T19N-C0		Black	0.188" (4.8)	0.250" (6.4)	0.020" (0.51)	1/8" (3.2) – 1" (25.4)	100' (30.5M)	1 Pkg.
T25N-C		Natural	0.25" (6.4)	0.375" (9.5)	0.023" (.58)	3/16" (4.8) – 2" (50.8)	100' (30.5M)	1 Pkg.
T25N-C0		Black	0.25" (6.4)	0.375" (9.5)	0.023" (.58)	3/16" (4.8) – 2" (50.8)	100' (30.5M)	1 Pkg.
T38N-C		Natural	0.375" (9.5)	0.437" (11.1)	0.03" (.76)	5/16" (7.9) – 3" (76.2)	100' (30.5M)	1 Pkg.
T38N-C0		Black	0.375" (9.5)	0.437" (11.1)	0.03" (.76)	5/16" (7.9) – 3" (76.2)	100' (30.5M)	1 Pkg.
T50N-C		Natural	0.5" (12.7)	0.5" (12.7)	0.032" (.81)	3/8" (9.5) – 4" (101.6)	100' (30.5M)	1 Pkg.
T50N-C0		Black	0.5" (12.7)	0.5" (12.7)	0.032" (.81)	3/8" (9.5) – 4" (101.6)	100' (30.5M)	1 Pkg.
T62N-C	Natural	0.625" (15.9)	0.625" (15.9)	0.035" (.89)	1/2" (12.7) – 4 1/2" (114.3)	100' (30.5M)	1 Pkg.	
T62N-C0	Black	0.625" (15.9)	0.625" (15.9)	0.035" (.89)	1/2" (12.7) – 4 1/2" (114.3)	100' (30.5M)	1 Pkg.	
T75N-C	Natural	0.75" (19.1)	0.875" (22.2)	0.4" (1.01)	5/8" (15.9) – 5" (127)	100' (30.5M)	1 Pkg.	
T75N-C0	Black	0.75" (19.1)	0.875" (22.2)	0.4" (1.01)	5/8" (15.9) – 5" (127)	100' (30.5M)	1 Pkg.	
T100N-C	Natural	1" (25.4)	1.125" (28.6)	0.045" (1.0)	7/8" (22.2) – 6" (152.4)	100' (30.5M)	1 Pkg.	
T100N-C0	Black	1" (25.4)	1.125" (28.6)	0.045" (1.0)	7/8" (22.2) – 6" (152.4)	100' (30.5M)	1 Pkg.	
T12T-C	TEFLON‡	Natural	0.125" (3.2)	0.218" (5.5)	0.02" (.5)	1/16" (1.6) – 1/2" (12.7)	100' (30.5M)	1 Pkg.
T19T-C		Natural	0.188" (4.8)	0.250" (6.4)	0.03" (.76)	1/8" (3.2) – 1" (25.4)	100' (30.5M)	1 Pkg.
T25T-L		Natural	0.25" (6.4)	0.375" (9.5)	0.03" (.76)	3/16" (4.8) – 2" (50.8)	50' (15.2M)	1 Pkg.
T50T-Q		Natural	0.5" (12.7)	0.5" (12.7)	0.03" (.76)	3/8" (9.5) – 4" (101.6)	25' (7.6M)	1 Pkg.
T62T-Q		Natural	0.625" (15.9)	0.625" (15.9)	0.03" (.76)	1/2" (12.7) – 4 1/2" (114.3)	25' (7.6M)	1 Pkg.
T75T-X		Natural	0.75" (19.1)	0.875" (22.2)	0.03" (.76)	5/8" (15.9) – 5" (127)	10' (3.0M)	1 Pkg.
T100T-X		Natural	1" (25.4)	1.125" (28.6)	0.04" (1.01)	7/8" (22.2) – 6" (152.4)	10' (3.0M)	1 Pkg.

*Order in multiples of Std. Pkg. Qty.

‡ TEFLON or equivalent fluorocarbon PTFE material is used. TEFLON is a registered trademark of E.I. DuPont Co.

NOTE: Custom cut-to-length sizes are available upon request. Contact factory for details.



Компания «ЭлектроПласт» предлагает заключение долгосрочных отношений при поставках импортных электронных компонентов на взаимовыгодных условиях!

Наши преимущества:

- Оперативные поставки широкого спектра электронных компонентов отечественного и импортного производства напрямую от производителей и с крупнейших мировых складов;
- Поставка более 17-ти миллионов наименований электронных компонентов;
- Поставка сложных, дефицитных, либо снятых с производства позиций;
- Оперативные сроки поставки под заказ (от 5 рабочих дней);
- Экспресс доставка в любую точку России;
- Техническая поддержка проекта, помощь в подборе аналогов, поставка прототипов;
- Система менеджмента качества сертифицирована по Международному стандарту ISO 9001;
- Лицензия ФСБ на осуществление работ с использованием сведений, составляющих государственную тайну;
- Поставка специализированных компонентов (Xilinx, Altera, Analog Devices, Intersil, Interpoint, Microsemi, Aeroflex, Peregrine, Syfer, Eurofarad, Texas Instrument, Miteq, Cobham, E2V, MA-COM, Hittite, Mini-Circuits, General Dynamics и др.);

Помимо этого, одним из направлений компании «ЭлектроПласт» является направление «Источники питания». Мы предлагаем Вам помощь Конструкторского отдела:

- Подбор оптимального решения, техническое обоснование при выборе компонента;
- Подбор аналогов;
- Консультации по применению компонента;
- Поставка образцов и прототипов;
- Техническая поддержка проекта;
- Защита от снятия компонента с производства.



Как с нами связаться

Телефон: 8 (812) 309 58 32 (многоканальный)

Факс: 8 (812) 320-02-42

Электронная почта: org@eplast1.ru

Адрес: 198099, г. Санкт-Петербург, ул. Калинина, дом 2, корпус 4, литера А.