

Type 550C 105 °C High Ripple, Inverter Grade, Aluminum

Ultra-Ripple, Long Life Screw Terminal Type



Type 550C is the standard for motor drive and other high-ripple, long-life applications. It boasts more than 25% extra ripple capability per can size, but less capacitance than Type 520C. Expected operating life is more than 100,000 hours in typical applications. Type 550C is rated for 10,000 h life with full ripple current, rated voltage, 85 °C and 100 lfm airflow while mounted horizontally. Horizontal mounting is more severe than vertical mounting. The extended cathode foil of the 550C assures heat flow from the capacitor element to the can in all orientations.

Highlights

- 10,000 hour load life
- Ripple current to 105 amps
- ESRs to 7 mΩ

Specifications

| Temperature Range | -40 °C to +105 °C | | | | | | | | | | | | | | | | | | | | | | | | | | | | | | | | | | | | | | | | | | | | | | | | | | | | | | | | | | | | | | | | | | | | | | |
|--------------------------------------|--|-------|--------|--------|-------|--------|-------------|--------|------|------|------|------|------|------|------|--|-------|-------|--------|--------|-------|-------|-------------|--------------------------------------|--|--|--|--|--|--|--|---------------------|------|------|------|------|------|------|------|---------------------|------|------|------|------|------|------|------|----------------------------------|--|--|--|--|--|--|--|---------------------|------|------|------|------|------|------|------|---------------------|------|------|------|------|------|------|------|
| Rated Voltage Range | 200 Vdc to 500 Vdc | | | | | | | | | | | | | | | | | | | | | | | | | | | | | | | | | | | | | | | | | | | | | | | | | | | | | | | | | | | | | | | | | | | | | | |
| Capacitance Range | 91 μF to 35,000 μF | | | | | | | | | | | | | | | | | | | | | | | | | | | | | | | | | | | | | | | | | | | | | | | | | | | | | | | | | | | | | | | | | | | | | | |
| Capacitance Tolerance | -10% +50% | | | | | | | | | | | | | | | | | | | | | | | | | | | | | | | | | | | | | | | | | | | | | | | | | | | | | | | | | | | | | | | | | | | | | | |
| Leakage Current | ≤3 \sqrt{CV} μA, 4 mA max, 5 minutes | | | | | | | | | | | | | | | | | | | | | | | | | | | | | | | | | | | | | | | | | | | | | | | | | | | | | | | | | | | | | | | | | | | | | | |
| Ripple Current Multipliers | <p>Ambient Temperature</p> <table border="1"> <thead> <tr> <th>45 °C</th> <th>55 °C</th> <th>65 °C</th> <th>75 °C</th> <th>85 °C</th> <th>95 °C</th> <th>105 °C</th> </tr> </thead> <tbody> <tr> <td>1.66</td> <td>1.52</td> <td>1.37</td> <td>1.20</td> <td>1.00</td> <td>0.75</td> <td>0.36</td> </tr> </tbody> </table> <p>Frequency</p> <table border="1"> <thead> <tr> <th></th> <th>50 Hz</th> <th>60 Hz</th> <th>120 Hz</th> <th>360 Hz</th> <th>1 kHz</th> <th>5 kHz</th> <th>10 kHz & up</th> </tr> </thead> <tbody> <tr> <td colspan="8" style="text-align:center">1 3/8" & 2 1/2" Diameters</td> </tr> <tr> <td>200 to 350 V</td> <td>0.77</td> <td>0.82</td> <td>1.00</td> <td>1.21</td> <td>1.32</td> <td>1.37</td> <td>1.38</td> </tr> <tr> <td>400 to 500 V</td> <td>0.73</td> <td>0.78</td> <td>1.00</td> <td>1.33</td> <td>1.53</td> <td>1.66</td> <td>1.68</td> </tr> <tr> <td colspan="8" style="text-align:center">3" & 3 1/2" Diameters</td> </tr> <tr> <td>200 to 350 V</td> <td>0.80</td> <td>0.85</td> <td>1.00</td> <td>1.17</td> <td>1.24</td> <td>1.28</td> <td>1.29</td> </tr> <tr> <td>400 to 500 V</td> <td>0.73</td> <td>0.79</td> <td>1.00</td> <td>1.31</td> <td>1.51</td> <td>1.63</td> <td>1.65</td> </tr> </tbody> </table> | 45 °C | 55 °C | 65 °C | 75 °C | 85 °C | 95 °C | 105 °C | 1.66 | 1.52 | 1.37 | 1.20 | 1.00 | 0.75 | 0.36 | | 50 Hz | 60 Hz | 120 Hz | 360 Hz | 1 kHz | 5 kHz | 10 kHz & up | 1 3/8" & 2 1/2" Diameters | | | | | | | | 200 to 350 V | 0.77 | 0.82 | 1.00 | 1.21 | 1.32 | 1.37 | 1.38 | 400 to 500 V | 0.73 | 0.78 | 1.00 | 1.33 | 1.53 | 1.66 | 1.68 | 3" & 3 1/2" Diameters | | | | | | | | 200 to 350 V | 0.80 | 0.85 | 1.00 | 1.17 | 1.24 | 1.28 | 1.29 | 400 to 500 V | 0.73 | 0.79 | 1.00 | 1.31 | 1.51 | 1.63 | 1.65 |
| 45 °C | 55 °C | 65 °C | 75 °C | 85 °C | 95 °C | 105 °C | | | | | | | | | | | | | | | | | | | | | | | | | | | | | | | | | | | | | | | | | | | | | | | | | | | | | | | | | | | | | | | | | |
| 1.66 | 1.52 | 1.37 | 1.20 | 1.00 | 0.75 | 0.36 | | | | | | | | | | | | | | | | | | | | | | | | | | | | | | | | | | | | | | | | | | | | | | | | | | | | | | | | | | | | | | | | | |
| | 50 Hz | 60 Hz | 120 Hz | 360 Hz | 1 kHz | 5 kHz | 10 kHz & up | | | | | | | | | | | | | | | | | | | | | | | | | | | | | | | | | | | | | | | | | | | | | | | | | | | | | | | | | | | | | | | | |
| 1 3/8" & 2 1/2" Diameters | | | | | | | | | | | | | | | | | | | | | | | | | | | | | | | | | | | | | | | | | | | | | | | | | | | | | | | | | | | | | | | | | | | | | | | |
| 200 to 350 V | 0.77 | 0.82 | 1.00 | 1.21 | 1.32 | 1.37 | 1.38 | | | | | | | | | | | | | | | | | | | | | | | | | | | | | | | | | | | | | | | | | | | | | | | | | | | | | | | | | | | | | | | | |
| 400 to 500 V | 0.73 | 0.78 | 1.00 | 1.33 | 1.53 | 1.66 | 1.68 | | | | | | | | | | | | | | | | | | | | | | | | | | | | | | | | | | | | | | | | | | | | | | | | | | | | | | | | | | | | | | | | |
| 3" & 3 1/2" Diameters | | | | | | | | | | | | | | | | | | | | | | | | | | | | | | | | | | | | | | | | | | | | | | | | | | | | | | | | | | | | | | | | | | | | | | | |
| 200 to 350 V | 0.80 | 0.85 | 1.00 | 1.17 | 1.24 | 1.28 | 1.29 | | | | | | | | | | | | | | | | | | | | | | | | | | | | | | | | | | | | | | | | | | | | | | | | | | | | | | | | | | | | | | | | |
| 400 to 500 V | 0.73 | 0.79 | 1.00 | 1.31 | 1.51 | 1.63 | 1.65 | | | | | | | | | | | | | | | | | | | | | | | | | | | | | | | | | | | | | | | | | | | | | | | | | | | | | | | | | | | | | | | | |
| Low Temperature Characteristics | Impedance ratio: $Z_{-20^{\circ}\text{C}}/Z_{+25^{\circ}\text{C}}$ ≤ 3 (200–500 Vdc) | | | | | | | | | | | | | | | | | | | | | | | | | | | | | | | | | | | | | | | | | | | | | | | | | | | | | | | | | | | | | | | | | | | | | | |
| Endurance Life Test | 10,000 h at full load at 105 °C Δ Capacitance ±20% ESR 200% of limit DCL 100% of limit | | | | | | | | | | | | | | | | | | | | | | | | | | | | | | | | | | | | | | | | | | | | | | | | | | | | | | | | | | | | | | | | | | | | | | |
| Shelf Life Test | 500 h at 105 °C Capacitance 100% of limit ESR 100% of limit DCL 100% of limit | | | | | | | | | | | | | | | | | | | | | | | | | | | | | | | | | | | | | | | | | | | | | | | | | | | | | | | | | | | | | | | | | | | | | | |
| Vibration | 10 to 55 Hz, 0.06" and 10 g max, 1.5 h each of two axis | | | | | | | | | | | | | | | | | | | | | | | | | | | | | | | | | | | | | | | | | | | | | | | | | | | | | | | | | | | | | | | | | | | | | | |
| RoHS Compliant | | | | | | | | | | | | | | | | | | | | | | | | | | | | | | | | | | | | | | | | | | | | | | | | | | | | | | | | | | | | | | | | | | | | | | | |

Type 550C 105 °C High Ripple, Inverter Grade, Aluminum

Ultra-Ripple, Long Life Screw Terminal Type

Part Numbering System

| | | | | | | | |
|---------------------------------|--|--|--|------------------------------------|---|--|--|
| 550C Type | 812 Capacitance 812 = 8100 µF | T Tolerance M = ±20% U = -10%+75% T = 10%+50% | 450 Voltage 200 = 200 Vdc | FG Case Code | 2 Insulation 0= None 1= Polyester 2= PVC | D Terminal A = Low Post B = High Post D = High Current, Low Post E = High Current, High Post F = M5 Post M = M5 Post, Small G = M6 Low Post H = M6 High Post | S Can Style Blank= Standard Can S= Stud Bottom P= Stud with Thermal Pad |
|---------------------------------|--|--|--|------------------------------------|---|--|--|

Standard insulation is 0.008-in PVC sleeve with 0.01-in polypropylene end disk.
Polyester insulation is not available for 3.5 inch diameter units.

Outline Drawing

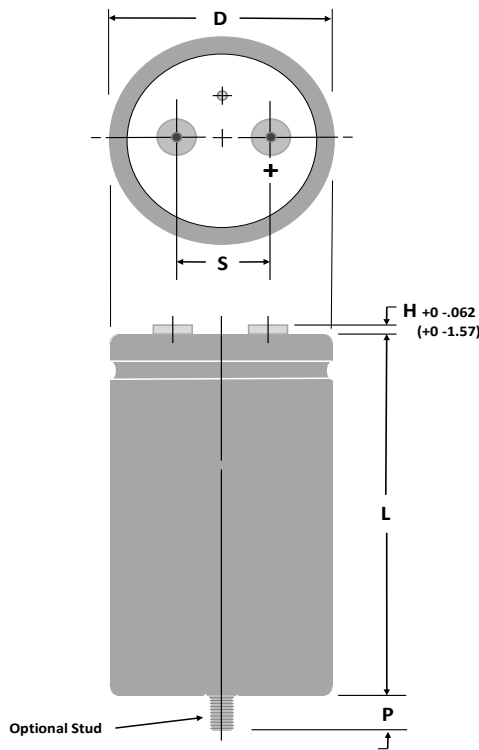

Stud Dimensions

| Case Diam. | Stud Thread | P ± 0.039" (±1.0 mm) |
|------------|-------------|----------------------|
| 1.375 | M8 | 0.470" (12.0) |
| 1.750 | M8 | 0.470" (12.0) |
| 2.000 | M12 | 0.630" (16.0) |
| 2.500 | M12 | 0.630" (16.0) |
| 3.000 | M12 | 0.630" (16.0) |
| 3.500 | M12 | 0.630" (16.0) |

NOTE: With the stud-mount feature, a thermally-conductive disk can be inserted in the bottom flush with the outer insulating sleeve. This reduces the thermal resistance through the can bottom by 0.3 °C/W. Can Style P.

Terminal Dimensions

| Terminal Style | For Case Diameters | Code | Post Diameter | | H max | | Thread | min Full Thread | | Torque | |
|--------------------|--------------------|------|---------------|------|-------|-----|--------|-----------------|------|--------|------|
| | | | in | mm | in | mm | | in | mm | in-lb | N-m |
| Low Post | 1 3/8 to 3 | A | 0.314 | 8.0 | 0.094 | 2.4 | 10-32 | 0.218 | 5.5 | 25 | 2.82 |
| High Post | 1 3/8 to 3 | B | 0.314 | 8.0 | 0.281 | 7.1 | 10-32 | 0.375 | 9.5 | 25 | 2.82 |
| High Current, Low | 2 1/2 to 3 1/2 | D | 0.684 | 17.4 | 0.125 | 3.2 | 1/4-28 | 0.344 | 8.7 | 50 | 5.65 |
| High Current, High | 2 1/2 to 3 1/2 | E | 0.684 | 17.4 | 0.281 | 7.1 | 1/4-28 | 0.469 | 11.9 | 60 | 6.78 |
| M5 Post, Small | 1 3/8 to 2 | M | 0.314 | 8.0 | 0.281 | 7.1 | M5 | 0.375 | 9.5 | 25 | 2.82 |
| M5 Post | 2 1/2 & 3 | F | 0.512 | 13.0 | 0.230 | 5.8 | M5 | 0.344 | 8.7 | 25 | 2.82 |
| M6 Low Post | 2 1/2 to 3 1/2 | G | 0.684 | 17.4 | 0.125 | 3.2 | M6 | 0.344 | 8.7 | 50 | 5.65 |
| M6 High Post | 2 1/2 to 3 1/2 | H | 0.684 | 17.4 | 0.281 | 7.1 | M6 | 0.469 | 11.9 | 60 | 6.78 |

NOTE: Only high post and M5 post terminals are available at 550 Vdc as they meet the required creepage distance.

Type 550C 105 °C High Ripple, Inverter Grade, Aluminum

Ultra-Ripple, Long Life Screw Terminal Type

Uninsulated Case Dimensions

For insulated case, add 0.024"(0.610 mm) to "D" and 0.030"(0.762 mm) to length.

| Case Code | Diam. (D) | | Length (L) | | Terminals (S) | | Typical Weight | |
|-----------|--------------|---------|--------------|----------|---------------|---------|----------------|------|
| | ±.031 Inches | ±.78 mm | ±.062 Inches | ±1.57 mm | ±0.015 Inches | ±.38 mm | oz | g |
| AK | 1.375 | 34.93 | 1.625 | 41.28 | 0.50 | 12.70 | 1.9 | 54 |
| AA | 1.375 | 34.93 | 2.125 | 53.98 | 0.50 | 12.70 | 2.0 | 57 |
| AH | 1.375 | 34.93 | 2.625 | 66.68 | 0.50 | 12.70 | 2.7 | 77 |
| AB | 1.375 | 34.93 | 3.125 | 79.38 | 0.50 | 12.70 | 3.3 | 94 |
| AJ | 1.375 | 34.93 | 3.625 | 92.08 | 0.50 | 12.70 | 3.8 | 108 |
| AC | 1.375 | 34.93 | 4.125 | 104.78 | 0.50 | 12.70 | 4.4 | 125 |
| AD | 1.375 | 34.93 | 4.625 | 117.48 | 0.50 | 12.70 | 5.1 | 145 |
| AE | 1.375 | 34.93 | 5.125 | 130.18 | 0.50 | 12.70 | 6.8 | 193 |
| AF | 1.375 | 34.93 | 5.625 | 142.88 | 0.50 | 12.70 | 8.1 | 230 |
| EA | 1.750 | 44.45 | 2.125 | 53.98 | 0.75 | 19.05 | 2.7 | 76 |
| EH | 1.750 | 44.45 | 2.625 | 66.68 | 0.75 | 19.05 | 3.8 | 108 |
| EB | 1.750 | 44.45 | 3.125 | 79.38 | 0.75 | 19.05 | 5.1 | 145 |
| EJ | 1.750 | 44.45 | 3.625 | 92.08 | 0.75 | 19.05 | 6.8 | 193 |
| EC | 1.750 | 44.45 | 4.125 | 104.78 | 0.75 | 19.05 | 8.1 | 230 |
| ED | 1.750 | 44.45 | 4.625 | 117.48 | 0.75 | 19.05 | 9.0 | 255 |
| EE | 1.750 | 44.45 | 5.125 | 130.18 | 0.75 | 19.05 | 9.5 | 269 |
| EF | 1.750 | 44.45 | 5.625 | 142.88 | 0.75 | 19.05 | 10.5 | 298 |
| BA | 2.000 | 50.80 | 2.125 | 53.98 | 0.88 | 22.23 | 5.4 | 153 |
| BH | 2.000 | 50.80 | 2.625 | 66.68 | 0.88 | 22.23 | 6.1 | 173 |
| BB | 2.000 | 50.80 | 3.125 | 79.38 | 0.88 | 22.23 | 6.8 | 193 |
| BJ | 2.000 | 50.80 | 3.625 | 92.08 | 0.88 | 22.23 | 8.2 | 232 |
| BC | 2.000 | 50.80 | 4.125 | 104.78 | 0.88 | 22.23 | 9.5 | 269 |
| BD | 2.000 | 50.80 | 4.625 | 117.48 | 0.88 | 22.23 | 10.3 | 292 |
| BE | 2.000 | 50.80 | 5.125 | 130.18 | 0.88 | 22.23 | 10.7 | 303 |
| BF | 2.000 | 50.80 | 5.625 | 142.88 | 0.88 | 22.23 | 13.0 | 369 |
| CH | 2.500 | 63.50 | 2.625 | 66.68 | 1.13 | 28.58 | 9.2 | 261 |
| CB | 2.500 | 63.50 | 3.125 | 79.38 | 1.13 | 28.58 | 10.4 | 295 |
| CJ | 2.500 | 63.50 | 3.625 | 92.08 | 1.13 | 28.58 | 12.7 | 361 |
| CC | 2.500 | 63.50 | 4.125 | 104.78 | 1.13 | 28.58 | 15.0 | 425 |
| CD | 2.500 | 63.50 | 4.625 | 117.48 | 1.13 | 28.58 | 17.2 | 488 |
| CE | 2.500 | 63.50 | 5.125 | 130.18 | 1.13 | 28.58 | 19.3 | 547 |
| CF | 2.500 | 63.50 | 5.625 | 142.88 | 1.13 | 28.58 | 21.4 | 607 |
| DB | 3.000 | 76.20 | 3.125 | 79.38 | 1.25 | 31.75 | 16.7 | 473 |
| DJ | 3.000 | 76.20 | 3.625 | 92.08 | 1.25 | 31.75 | 20.0 | 567 |
| DC | 3.000 | 76.20 | 4.125 | 104.78 | 1.25 | 31.75 | 22.2 | 629 |
| DD | 3.000 | 76.20 | 4.625 | 117.48 | 1.25 | 31.75 | 25.5 | 723 |
| DE | 3.000 | 76.20 | 5.125 | 130.18 | 1.25 | 31.75 | 30.0 | 850 |
| DF | 3.000 | 76.20 | 5.625 | 142.88 | 1.25 | 31.75 | 31.9 | 904 |
| DP | 3.000 | 76.20 | 5.875 | 149.23 | 1.25 | 31.75 | 32.8 | 931 |
| DN | 3.000 | 76.20 | 7.625 | 193.68 | 1.25 | 31.75 | 39.5 | 1119 |
| DG | 3.000 | 76.20 | 8.625 | 219.08 | 1.25 | 31.75 | 43.3 | 1227 |
| FC | 3.500 | 88.90 | 4.125 | 104.78 | 1.25 | 31.75 | 30.0 | 850 |
| FD | 3.500 | 88.90 | 4.625 | 117.48 | 1.25 | 31.75 | 34.4 | 976 |
| FE | 3.500 | 88.90 | 5.125 | 130.18 | 1.25 | 31.75 | 40.5 | 1148 |
| FF | 3.500 | 88.90 | 5.625 | 142.88 | 1.25 | 31.75 | 43.1 | 1221 |
| FP | 3.500 | 88.90 | 5.875 | 149.23 | 1.25 | 31.75 | 44.3 | 1257 |
| FN | 3.500 | 88.90 | 7.625 | 193.68 | 1.25 | 31.75 | 53.3 | 1512 |
| FG | 3.500 | 88.90 | 8.625 | 219.08 | 1.25 | 31.75 | 58.5 | 1658 |

Type 550C 105 °C High Ripple, Inverter Grade, Aluminum

Ultra-Ripple, Long Life Screw Terminal Type

Ratings

| Cap. (µF) | Catalog Part Number | ESR Max. @ 25 °C 120 Hz (mΩ) | Ripple Max. @ 85 °C 120 Hz (A) | Nominal Size D x L (inches) | Cap. (µF) | Catalog Part Number | ESR Max. @ 25 °C 120 Hz (mΩ) | Ripple Max. @ 85 °C 120 Hz (A) | Nominal Size D x L (inches) |
|--------------------------------|---------------------|------------------------------|--------------------------------|-----------------------------|--------------------------------|---------------------|------------------------------|--------------------------------|-----------------------------|
| 200 Vdc (250 Vdc Surge) | | | | | | | | | |
| 380 | 550C381T200AK2B | 262.0 | 2.3 | 1 3/8 x 1 5/8 | 11000 | 550C113T200DD2B | 13.0 | 24.5 | 3 x 4 5/8 |
| 690 | 550C691T200AA2B | 146.0 | 3.5 | 1 3/8 x 2 1/8 | 12000 | 550C123T200DE2B | 11.5 | 27.0 | 3 x 5 1/8 |
| 850 | 550C851T200AH2B | 120.0 | 4.1 | 1 3/8 x 2 5/8 | 13000 | 550C133T200FC2B | 15.5 | 23.8 | 3 1/2 x 4 1/8 |
| 1200 | 550C122T200AB2B | 88.5 | 5.1 | 1 3/8 x 3 1/8 | 14000 | 550C143T200DF2B | 10.3 | 29.4 | 3 x 5 5/8 |
| 1200 | 550C122T200EA2B | 87.9 | 5.2 | 1 3/4 x 2 1/8 | 15000 | 550C153T200DP2D | 9.8 | 30.6 | 3 x 5 7/8 |
| 1200 | 550C122T200BA2B | 86.0 | 5.7 | 2 x 2 1/8 | 16000 | 550C163T200FD2B | 13.2 | 26.8 | 3 1/2 x 4 5/8 |
| 1400 | 550C142T200EH2B | 72.0 | 6.2 | 1 3/4 x 2 5/8 | 18000 | 550C183T200FE2B | 11.7 | 29.4 | 3 1/2 x 5 1/8 |
| 1500 | 550C152T200AJ2B | 70.3 | 6.1 | 1 3/8 x 3 5/8 | 20000 | 550C203T200FF2D | 10.5 | 31.9 | 3 1/2 x 5 5/8 |
| 1800 | 550C182T200AC2B | 58.5 | 7.0 | 1 3/8 x 4 1/8 | 21000 | 550C213T200DN2D | 8.2 | 36.8 | 3 x 7 5/8 |
| 1800 | 550C182T200BH2B | 60.2 | 7.4 | 2 x 2 5/8 | 22000 | 550C223T200FP2D | 10.0 | 33.2 | 3 1/2 x 5 7/8 |
| 1900 | 550C192T200EB2B | 53.1 | 7.7 | 1 3/4 x 3 1/8 | 24000 | 550C243T200DG2D | 7.1 | 40.4 | 3 x 8 5/8 |
| 2100 | 550C212T200AD2B | 50.2 | 7.9 | 1 3/8 x 4 5/8 | 30000 | 550C303T200FN2D | 8.0 | 40.6 | 3 1/2 x 7 5/8 |
| 2400 | 550C242T200AE2B | 44.1 | 8.8 | 1 3/8 x 5 1/8 | 35000 | 550C353T200FG2D | 6.8 | 44.9 | 3 1/2 x 8 5/8 |
| 2400 | 550C242T200EJ2B | 42.2 | 9.1 | 1 3/4 x 3 5/8 | 250 Vdc (300 Vdc Surge) | | | | |
| 2500 | 550C252T200BB2B | 43.3 | 9.2 | 2 x 3 1/8 | 280 | 550C281T250AK2B | 339.0 | 2.1 | 1 3/8 x 1 5/8 |
| 2700 | 550C272T200AF2B | 39.4 | 9.6 | 1 3/8 x 5 5/8 | 510 | 550C511T250AA2B | 186.0 | 3.1 | 1 3/8 x 2 1/8 |
| 2800 | 550C282T200CH2B | 39.1 | 10.5 | 2 1/2 x 2 5/8 | 620 | 550C621T250AH2B | 153.0 | 3.7 | 1 3/8 x 2 5/8 |
| 3000 | 550C302T200EC2B | 35.1 | 10.4 | 1 3/4 x 4 1/8 | 850 | 550C851T250AB2B | 113.0 | 4.6 | 1 3/8 x 3 1/8 |
| 3200 | 550C322T200BJ2B | 34.0 | 11.0 | 2 x 3 5/8 | 850 | 550C851T250EA2B | 120.0 | 4.5 | 1 3/4 x 2 1/8 |
| 3500 | 550C352T200ED2B | 30.2 | 11.7 | 1 3/4 x 4 5/8 | 910 | 550C911T250BA2B | 117.0 | 4.9 | 2 x 2 1/8 |
| 3900 | 550C392T200BC2B | 28.1 | 12.6 | 2 x 4 1/8 | 1000 | 550C102T250EH2B | 101.0 | 5.3 | 1 3/4 x 2 5/8 |
| 4000 | 550C402T200EE2B | 26.6 | 13.0 | 1 3/4 x 5 1/8 | 1100 | 550C112T250AJ2B | 89.3 | 5.4 | 1 3/8 x 3 5/8 |
| 4000 | 550C402T200CB2B | 28.1 | 13.2 | 2 1/2 x 3 1/8 | 1300 | 550C132T250AC2B | 74.1 | 6.2 | 1 3/8 x 4 1/8 |
| 4500 | 550C452T200EF2B | 23.8 | 14.2 | 1 3/4 x 5 5/8 | 1300 | 550C132T250BH2B | 82.1 | 6.3 | 2 x 2 5/8 |
| 4600 | 550C462T200BD2B | 24.0 | 14.2 | 2 x 4 5/8 | 1400 | 550C142T250EB2B | 71.3 | 6.6 | 1 3/4 x 3 1/8 |
| 5100 | 550C512T200CJ2B | 22.0 | 15.6 | 2 1/2 x 3 5/8 | 1500 | 550C152T250AD2B | 63.5 | 7.0 | 1 3/8 x 4 5/8 |
| 5300 | 550C532T200BE2B | 21.1 | 15.7 | 2 x 5 1/8 | 1800 | 550C182T250AE2B | 55.0 | 7.8 | 1 3/8 x 5 1/8 |
| 5700 | 550C572T200DB2B | 23.4 | 16.1 | 3 x 3 1/8 | 1800 | 550C182T250EJ2B | 55.9 | 7.9 | 1 3/4 x 3 5/8 |
| 6100 | 550C612T200BF2B | 18.9 | 17.2 | 2 x 5 5/8 | 1800 | 550C182T250BB2B | 59.0 | 7.9 | 2 x 3 1/8 |
| 6200 | 550C622T200CC2B | 17.8 | 18.1 | 2 1/2 x 4 1/8 | 2000 | 550C202T250AF2B | 49.7 | 8.5 | 1 3/8 x 5 5/8 |
| 7300 | 550C732T200CD2B | 15.2 | 20.3 | 2 1/2 x 4 5/8 | 2100 | 550C212T250CH2B | 50.5 | 9.3 | 2 1/2 x 2 5/8 |
| 7300 | 550C732T200DJ2B | 18.3 | 19.1 | 3 x 3 5/8 | 2200 | 550C222T250EC2B | 45.8 | 9.1 | 1 3/4 x 4 1/8 |
| 8500 | 550C852T200CE2B | 13.4 | 22.5 | 2 1/2 x 5 1/8 | 2400 | 550C242T250BJ2B | 45.3 | 9.5 | 2 x 3 5/8 |
| 9000 | 550C902T200DC2B | 15.2 | 21.9 | 3 x 4 1/8 | 2600 | 550C262T250ED2B | 39.3 | 10.3 | 1 3/4 x 4 5/8 |
| 9600 | 550C962T200CF2B | 11.9 | 24.5 | 2 1/2 x 5 5/8 | 2900 | 550C292T250EE2B | 34.5 | 11.4 | 1 3/4 x 5 1/8 |
| | | | | | 2900 | 550C292T250BC2B | 37.4 | 10.9 | 2 x 4 1/8 |

Type 550C 105 °C High Ripple, Inverter Grade, Aluminum

Ultra-Ripple, Long Life Screw Terminal Type

| Cap. (µF) | Catalog Part Number | ESR Max. @ 25 °C 120 Hz (mΩ) | Ripple Max. @ 85 °C 120 Hz (A) | Nominal Size D x L (inches) |
|--------------------------------|---------------------|------------------------------|--------------------------------|-----------------------------|
| 2900 | 550C292T250CB2B | 36.9 | 11.5 | 2 1/2 x 3 1/8 |
| 3300 | 550C332T250EF2B | 30.8 | 12.4 | 1 3/4 x 5 5/8 |
| 3400 | 550C342T250BD2B | 31.9 | 12.3 | 2 x 4 5/8 |
| 3700 | 550C372T250CJ2B | 28.7 | 13.7 | 2 1/2 x 3 5/8 |
| 3900 | 550C392T250BE2B | 27.9 | 13.6 | 2 x 5 1/8 |
| 4200 | 550C422T250DB2B | 28.9 | 14.5 | 3 x 3 1/8 |
| 4500 | 550C452T250BF2B | 24.9 | 14.9 | 2 x 5 5/8 |
| 4600 | 550C462T250CC2B | 23.4 | 15.8 | 2 1/2 x 4 1/8 |
| 5400 | 550C542T250CD2B | 19.9 | 17.8 | 2 1/2 x 4 5/8 |
| 5400 | 550C542T250DJ2B | 22.3 | 17.3 | 3 x 3 5/8 |
| 6200 | 550C622T250CE2B | 17.1 | 19.9 | 2 1/2 x 5 1/8 |
| 6600 | 550C662T250DC2B | 18.5 | 19.9 | 3 x 4 1/8 |
| 7100 | 550C712T250CF2B | 15.2 | 21.7 | 2 1/2 x 5 5/8 |
| 7800 | 550C782T250DD2B | 15.8 | 22.3 | 3 x 4 5/8 |
| 9000 | 550C902T250DE2B | 13.9 | 24.6 | 3 x 5 1/8 |
| 9700 | 550C972T250FC2D | 16.5 | 23.1 | 3 1/2 x 4 1/8 |
| 10000 | 550C103T250DF2B | 12.4 | 26.8 | 3 x 5 5/8 |
| 11000 | 550C113T250DP2B | 11.4 | 28.2 | 3 x 5 7/8 |
| 11000 | 550C113T250FD2D | 14.3 | 25.8 | 3 1/2 x 4 5/8 |
| 13000 | 550C133T250FE2D | 12.5 | 28.4 | 3 1/2 x 5 1/8 |
| 15000 | 550C153T250DN2D | 9.4 | 34.4 | 3 x 7 5/8 |
| 15000 | 550C153T250FF2D | 11.0 | 31.2 | 3 1/2 x 5 5/8 |
| 16000 | 550C163T250FP2D | 10.5 | 32.3 | 3 1/2 x 5 7/8 |
| 17000 | 550C173T250DG2D | 7.9 | 38.3 | 3 x 8 5/8 |
| 22000 | 550C223T250FN2D | 8.5 | 39.5 | 3 1/2 x 7 5/8 |
| 25000 | 550C253T250FG2D | 7.2 | 43.7 | 3 1/2 x 8 5/8 |
| 300 Vdc (350 Vdc Surge) | | | | |
| 200 | 550C201T300AK2B | 591.0 | 1.6 | 1 3/8 x 1 5/8 |
| 320 | 550C321T300AA2B | 378.0 | 2.2 | 1 3/8 x 2 1/8 |
| 480 | 550C481T300AH2B | 254.0 | 2.9 | 1 3/8 x 2 5/8 |
| 490 | 550C491T300EA2B | 252.0 | 3.1 | 1 3/4 x 2 1/8 |
| 640 | 550C641T300AB2B | 190.0 | 3.5 | 1 3/8 x 3 1/8 |
| 640 | 550C641T300BA2B | 188.0 | 3.9 | 2 x 2 1/8 |
| 710 | 550C711T300EH2B | 176.0 | 4.0 | 1 3/4 x 2 5/8 |
| 800 | 550C801T300AJ2B | 156.0 | 4.1 | 1 3/8 x 3 5/8 |
| 910 | 550C911T300BH2B | 131.0 | 5.0 | 2 x 2 5/8 |
| 960 | 550C961T300AC2B | 131.0 | 4.7 | 1 3/8 x 4 1/8 |
| 990 | 550C991T300EB2B | 126.0 | 5.0 | 1 3/4 x 3 1/8 |
| 1100 | 550C112T300AD2B | 110.0 | 5.3 | 1 3/8 x 4 5/8 |
| 1300 | 550C132T300AE2B | 96.9 | 5.9 | 1 3/8 x 5 1/8 |
| 1300 | 550C132T300EJ2B | 96.2 | 6.0 | 1 3/4 x 3 5/8 |
| 1300 | 550C132T300BB2B | 94.2 | 6.3 | 2 x 3 1/8 |
| 1400 | 550C142T300AF2B | 83.4 | 6.6 | 1 3/8 x 5 5/8 |
| 1600 | 550C162T300EC2B | 77.2 | 7.0 | 1 3/4 x 4 1/8 |
| 1600 | 550C162T300BJ2B | 73.7 | 7.5 | 2 x 3 5/8 |
| 1600 | 550C162T300CH2B | 78.2 | 7.4 | 2 1/2 x 2 5/8 |
| 1800 | 550C182T300ED2B | 67.3 | 7.8 | 1 3/4 x 4 5/8 |
| 2000 | 550C202T300BC2B | 60.7 | 8.6 | 2 x 4 1/8 |

| Cap. (µF) | Catalog Part Number | ESR Max. @ 25 °C 120 Hz (mΩ) | Ripple Max. @ 85 °C 120 Hz (A) | Nominal Size D x L (inches) |
|--------------------------------|---------------------|------------------------------|--------------------------------|-----------------------------|
| 2100 | 550C212T300EE2B | 58.7 | 8.7 | 1 3/4 x 5 1/8 |
| 2200 | 550C222T300CB2B | 56.1 | 9.3 | 2 1/2 x 3 1/8 |
| 2400 | 550C242T300EF2B | 52.2 | 9.6 | 1 3/4 x 5 5/8 |
| 2400 | 550C242T300BD2B | 51.7 | 9.7 | 2 x 4 5/8 |
| 2700 | 550C272T300BE2B | 45.1 | 10.7 | 2 x 5 1/8 |
| 2800 | 550C282T300CJ2B | 43.8 | 11.1 | 2 1/2 x 3 5/8 |
| 3100 | 550C312T300BF2B | 40.2 | 11.8 | 2 x 5 5/8 |
| 3400 | 550C342T300DB2B | 37.7 | 12.7 | 3 x 3 1/8 |
| 3500 | 550C352T300CC2B | 35.9 | 12.8 | 2 1/2 x 4 1/8 |
| 4100 | 550C412T300CD2B | 30.6 | 14.4 | 2 1/2 x 4 5/8 |
| 4400 | 550C442T300DJ2B | 29.5 | 15.1 | 3 x 3 5/8 |
| 4700 | 550C472T300CE2B | 26.7 | 15.9 | 2 1/2 x 5 1/8 |
| 5300 | 550C532T300CF2B | 23.4 | 17.5 | 2 1/2 x 5 5/8 |
| 5400 | 550C542T300DC2B | 24.4 | 17.3 | 3 x 4 1/8 |
| 6400 | 550C642T300DD2B | 20.8 | 19.4 | 3 x 4 5/8 |
| 7200 | 550C722T300FC2D | 18.8 | 21.7 | 3 1/2 x 4 1/8 |
| 7400 | 550C742T300DE2B | 18.2 | 21.5 | 3 x 5 1/8 |
| 8300 | 550C832T300DF2B | 16.2 | 23.4 | 3 x 5 5/8 |
| 8600 | 550C862T300FD2D | 16.0 | 24.3 | 3 1/2 x 4 5/8 |
| 8800 | 550C882T300DP2B | 15.4 | 24.3 | 3 x 5 7/8 |
| 9900 | 550C992T300FE2D | 14.0 | 26.8 | 3 1/2 x 5 1/8 |
| 11000 | 550C113T300FF2D | 12.1 | 29.6 | 3 1/2 x 5 5/8 |
| 12000 | 550C123T300FP2D | 11.5 | 30.8 | 3 1/2 x 5 7/8 |
| 12000 | 550C123T300DN2D | 12.4 | 30.0 | 3 x 7 5/8 |
| 14000 | 550C143T300DG2D | 10.5 | 33.3 | 3 x 8 5/8 |
| 16000 | 550C163T300FN2D | 9.2 | 38.1 | 3 1/2 x 7 5/8 |
| 18000 | 550C183T300FG2D | 7.7 | 42.3 | 3 1/2 x 8 5/8 |
| 350 Vdc (400 Vdc Surge) | | | | |
| 160 | 550C161T350AK2B | 662.0 | 1.5 | 1 3/8 x 1 5/8 |
| 260 | 550C261T350AA2B | 414.0 | 2.1 | 1 3/8 x 2 1/8 |
| 390 | 550C391T350AH2B | 284.0 | 2.7 | 1 3/8 x 2 5/8 |
| 400 | 550C401T350EA2B | 281.0 | 2.9 | 1 3/4 x 2 1/8 |
| 510 | 550C511T350BA2B | 209.0 | 3.7 | 2 x 2 1/8 |
| 520 | 550C521T350AB2B | 213.0 | 3.3 | 1 3/8 x 3 1/8 |
| 570 | 550C571T350EH2B | 196.0 | 3.8 | 1 3/4 x 2 5/8 |
| 640 | 550C641T350AJ2B | 175.0 | 3.9 | 1 3/8 x 3 5/8 |
| 740 | 550C741T350BH2B | 146.0 | 4.7 | 2 x 2 5/8 |
| 770 | 550C771T350AC2B | 146.0 | 4.4 | 1 3/8 x 4 1/8 |
| 800 | 550C801T350EB2B | 141.0 | 4.7 | 1 3/4 x 3 1/8 |
| 900 | 550C901T350AD2B | 123.0 | 5.0 | 1 3/8 x 4 5/8 |
| 1000 | 550C102T350AE2B | 111.0 | 5.5 | 1 3/8 x 5 1/8 |
| 1000 | 550C102T350EJ2B | 110.0 | 5.6 | 1 3/4 x 3 5/8 |
| 1000 | 550C102T350BB2B | 105.0 | 5.9 | 2 x 3 1/8 |
| 1200 | 550C122T350AF2B | 93.1 | 6.2 | 1 3/8 x 5 5/8 |
| 1300 | 550C132T350EC2B | 86.0 | 6.7 | 1 3/4 x 4 1/8 |
| 1300 | 550C132T350BJ2B | 81.7 | 7.1 | 2 x 3 5/8 |
| 1300 | 550C132T350CH2B | 86.7 | 7.1 | 2 1/2 x 2 5/8 |
| 1500 | 550C152T350ED2B | 74.9 | 7.4 | 1 3/4 x 4 5/8 |

Type 550C 105 °C High Ripple, Inverter Grade, Aluminum

Ultra-Ripple, Long Life Screw Terminal Type

| Cap. (µF) | Catalog Part Number | ESR Max. @ 25 °C 120 Hz (mΩ) | Ripple Max. @ 85 °C 120 Hz (A) | Nominal Size D x L (inches) |
|--------------------------------|---------------------|------------------------------|--------------------------------|-----------------------------|
| 1600 | 550C162T350BC2B | 67.2 | 8.2 | 2 x 4 1/8 |
| 1700 | 550C172T350EE2B | 65.3 | 8.3 | 1 3/4 x 5 1/8 |
| 1800 | 550C182T350CB2B | 62.1 | 8.8 | 2 1/2 x 3 1/8 |
| 1900 | 550C192T350EF2B | 58.0 | 9.1 | 1 3/4 x 5 5/8 |
| 1900 | 550C192T350BD2B | 57.3 | 9.2 | 2 x 4 5/8 |
| 2200 | 550C222T350BE2B | 50.0 | 10.2 | 2 x 5 1/8 |
| 2300 | 550C232T350CJ2B | 48.5 | 10.5 | 2 1/2 x 3 5/8 |
| 2500 | 550C252T350BF2B | 44.4 | 11.2 | 2 x 5 5/8 |
| 2800 | 550C282T350CC2B | 40.0 | 12.1 | 2 1/2 x 4 1/8 |
| 2800 | 550C282T350DB2B | 41.2 | 12.2 | 3 x 3 1/8 |
| 3300 | 550C332T350CD2B | 34.0 | 13.6 | 2 1/2 x 4 5/8 |
| 3600 | 550C362T350DJ2B | 32.2 | 14.5 | 3 x 3 5/8 |
| 3600 | 550C362T350DJ2B | 32.2 | 14.5 | 3 x 3 5/8 |
| 3800 | 550C382T350CE2B | 29.7 | 15.1 | 2 1/2 x 5 1/8 |
| 4300 | 550C432T350CF2B | 25.8 | 16.7 | 2 1/2 x 5 5/8 |
| 4400 | 550C442T350DC2B | 26.6 | 16.6 | 3 x 4 1/8 |
| 5100 | 550C512T350DD2B | 22.7 | 18.6 | 3 x 4 5/8 |
| 5800 | 550C582T350FC2D | 20.5 | 20.8 | 3 1/2 x 4 1/8 |
| 5900 | 550C592T350DE2B | 19.8 | 20.6 | 3 x 5 1/8 |
| 6700 | 550C672T350DF2B | 17.7 | 22.4 | 3 x 5 5/8 |
| 6900 | 550C692T350FD2d | 17.5 | 23.3 | 3 1/2 x 4 5/8 |
| 7100 | 550C712T350DP2B | 16.8 | 23.3 | 3 x 5 7/8 |
| 8000 | 550C802T350FE2D | 15.3 | 25.7 | 3 1/2 x 5 1/8 |
| 9000 | 550C902T350FF2D | 13.2 | 28.4 | 3 1/2 x 5 5/8 |
| 9500 | 550C952T350FP2D | 12.5 | 29.6 | 3 1/2 x 5 7/8 |
| 9600 | 550C962T350DN2D | 13.3 | 29.0 | 3 x 7 5/8 |
| 11000 | 550C113T350DG2D | 11.1 | 32.3 | 3 x 8 5/8 |
| 13000 | 550C133T350FN2D | 9.9 | 36.6 | 3 1/2 x 7 5/8 |
| 15000 | 550C153T350FG2D | 8.3 | 40.7 | 3 1/2 x 8 5/8 |
| 400 Vdc (450 Vdc Surge) | | | | |
| 130 | 550C131T400AK2B | 733.0 | 1.4 | 1 3/8 x 1 5/8 |
| 200 | 550C201T400AA2B | 458.0 | 2.0 | 1 3/8 x 2 1/8 |
| 300 | 550C301T400AH2B | 328.0 | 2.5 | 1 3/8 x 2 5/8 |
| 310 | 550C311T400EA2B | 310.0 | 2.8 | 1 3/4 x 2 1/8 |
| 400 | 550C401T400AB2B | 241.0 | 3.1 | 1 3/8 x 3 1/8 |
| 400 | 550C401T400BA2B | 247.0 | 3.4 | 2 x 2 1/8 |
| 450 | 550C451T400EH2B | 216.0 | 3.6 | 1 3/4 x 2 5/8 |
| 510 | 550C511T400AJ2B | 194.0 | 3.7 | 1 3/8 x 3 5/8 |
| 580 | 550C581T400BH2B | 168.0 | 4.4 | 2 x 2 5/8 |
| 610 | 550C611T400AC2B | 162.0 | 4.2 | 1 3/8 x 4 1/8 |
| 630 | 550C631T400EB2B | 155.0 | 4.5 | 1 3/4 x 3 1/8 |
| 710 | 550C711T400AD2B | 139.0 | 4.7 | 1 3/8 x 4 5/8 |
| 800 | 550C801T400EJ2B | 121.0 | 5.4 | 1 3/4 x 3 5/8 |
| 810 | 550C811T400AE2B | 122.0 | 5.3 | 1 3/8 x 5 1/8 |
| 810 | 550C811T400BB2B | 121.0 | 5.5 | 2 x 3 1/8 |
| 910 | 550C911T400AF2B | 109.0 | 5.8 | 1 3/8 x 5 5/8 |
| 980 | 550C981T400EC2B | 99.3 | 6.2 | 1 3/4 x 4 1/8 |
| 990 | 550C991T400CH2B | 95.2 | 6.7 | 2 1/2 x 2 5/8 |

| Cap. (µF) | Catalog Part Number | ESR Max. @ 25 °C 120 Hz (mΩ) | Ripple Max. @ 85 °C 120 Hz (A) | Nominal Size D x L (inches) |
|--------------------------------|---------------------|------------------------------|--------------------------------|-----------------------------|
| 1000 | 550C102T400BJ2B | 94.2 | 6.6 | 2 x 3 5/8 |
| 1200 | 550C122T400ED2B | 82.5 | 7.1 | 1 3/4 x 4 5/8 |
| 1300 | 550C132T400EE2B | 71.9 | 7.9 | 1 3/4 x 5 1/8 |
| 1300 | 550C132T400BC2B | 77.4 | 7.6 | 2 x 4 1/8 |
| 1400 | 550C142T400CB2B | 68.2 | 8.4 | 2 1/2 x 3 1/8 |
| 1500 | 550C152T400EF2B | 63.8 | 8.6 | 1 3/4 x 5 5/8 |
| 1500 | 550C152T400BD2B | 64.3 | 8.7 | 2 x 4 5/8 |
| 1700 | 550C172T400BE2B | 57.5 | 9.5 | 2 x 5 1/8 |
| 1800 | 550C182T400CJ2B | 53.2 | 10.0 | 2 1/2 x 3 5/8 |
| 2000 | 550C202T400BF2B | 48.6 | 10.7 | 2 x 5 5/8 |
| 2200 | 550C222T400CC2B | 43.8 | 11.6 | 2 1/2 x 4 1/8 |
| 2200 | 550C222T400DB2B | 45.7 | 11.6 | 3 x 3 1/8 |
| 2600 | 550C262T400CD2B | 37.3 | 13.0 | 2 1/2 x 4 5/8 |
| 2800 | 550C282T400DJ2B | 35.7 | 13.7 | 3 x 3 5/8 |
| 3000 | 550C302T400CE2B | 32.5 | 14.4 | 2 1/2 x 5 1/8 |
| 3400 | 550C342T400CF2B | 28.9 | 15.8 | 2 1/2 x 5 5/8 |
| 3400 | 550C342T400DC2B | 29.3 | 15.8 | 3 x 4 1/8 |
| 4000 | 550C402T400DD2B | 25.0 | 17.7 | 3 x 4 5/8 |
| 4600 | 550C462T400FC2D | 22.2 | 20.0 | 3 1/2 x 4 1/8 |
| 4700 | 550C472T400DE2B | 21.4 | 19.8 | 3 x 5 1/8 |
| 5300 | 550C532T400DF2B | 19.0 | 21.6 | 3 x 5 5/8 |
| 5400 | 550C542T400FD2D | 18.9 | 22.4 | 3 1/2 x 4 5/8 |
| 5600 | 550C562T400DP2B | 18.1 | 22.4 | 3 x 5 7/8 |
| 6200 | 550C622T400FE2D | 16.5 | 24.7 | 3 1/2 x 5 1/8 |
| 7100 | 550C712T400FF2D | 14.3 | 27.3 | 3 1/2 x 5 5/8 |
| 7500 | 550C752T400FP2D | 13.5 | 28.4 | 3 1/2 x 5 7/8 |
| 7800 | 550C782T400DN2D | 14.6 | 27.6 | 3 x 7 5/8 |
| 9000 | 550C902T400DG2D | 12.4 | 30.6 | 3 x 8 5/8 |
| 9700 | 550C972T400FN2D | 10.9 | 34.9 | 3 1/2 x 7 5/8 |
| 11000 | 550C113T400FG2D | 9.2 | 38.7 | 3 1/2 x 8 5/8 |
| 450 Vdc (500 Vdc Surge) | | | | |
| 90 | 550C900T450AK2B | 827.0 | 1.3 | 1 3/8 x 1 5/8 |
| 140 | 550C141T450AA2B | 521.0 | 1.8 | 1 3/8 x 2 1/8 |
| 210 | 550C211T450AH2B | 353.0 | 2.4 | 1 3/8 x 2 5/8 |
| 220 | 550C221T450EA2B | 333.0 | 2.7 | 1 3/4 x 2 1/8 |
| 280 | 550C281T450BA2B | 265.0 | 3.3 | 2 x 2 1/8 |
| 290 | 550C291T450AB2B | 260.0 | 3.0 | 1 3/8 x 3 1/8 |
| 320 | 550C321T450EH2B | 232.0 | 3.5 | 1 3/4 x 2 5/8 |
| 360 | 550C361T450AJ2B | 208.0 | 3.5 | 1 3/8 x 3 5/8 |
| 410 | 550C411T450BH2B | 180.0 | 4.3 | 2 x 2 5/8 |
| 430 | 550C431T450AC2B | 174.0 | 4.1 | 1 3/8 x 4 1/8 |
| 440 | 550C441T450EB2B | 166.0 | 4.3 | 1 3/4 x 3 1/8 |
| 500 | 550C501T450AD2B | 150.0 | 4.6 | 1 3/8 x 4 5/8 |
| 570 | 550C571T450AE2B | 132.0 | 5.1 | 1 3/8 x 5 1/8 |
| 570 | 550C571T450EJ2B | 130.0 | 5.2 | 1 3/4 x 3 5/8 |
| 570 | 550C571T450BB2B | 129.0 | 5.3 | 2 x 3 1/8 |
| 640 | 550C641T450AF2B | 118.0 | 5.6 | 1 3/8 x 5 5/8 |
| 700 | 550C701T450EC2B | 107.0 | 6.0 | 1 3/4 x 4 1/8 |

Type 550C 105 °C High Ripple, Inverter Grade, Aluminum

Ultra-Ripple, Long Life Screw Terminal Type

| Cap. (µF) | Catalog Part NTmber | ESR Max. @ 25 °C 120 Hz (mΩ) | Ripple Max. @ 85 °C 120 Hz (A) | Nominal Size D x L (inches) | Cap. (µF) | Catalog Part NTmber | ESR Max. @ 25 °C 120 Hz (mΩ) | Ripple Max. @ 85 °C 120 Hz (A) | Nominal Size D x L (inches) |
|--------------------------------|---------------------|------------------------------|--------------------------------|-----------------------------|-----------|---------------------|------------------------------|--------------------------------|-----------------------------|
| 700 | 550C701T450CH2B | 108.0 | 6.3 | 2 1/2 x 2 5/8 | 410 | 550C411T500BH2B | 323.3 | 3.2 | 2 x 2 5/8 |
| 740 | 550C741T450BJ2B | 101.0 | 6.4 | 2 x 3 5/8 | 430 | 550C431T500AC2B | 307.4 | 3.1 | 1 3/8 x 4 1/8 |
| 820 | 550C821T450ED2B | 90.7 | 6.8 | 1 3/4 x 4 5/8 | 460 | 550C461T500EB2B | 303.7 | 3.2 | 1 3/4 x 3 1/8 |
| 900 | 550C901T450BC2B | 82.9 | 7.3 | 2 x 4 1/8 | 510 | 550C511T500AD2B | 263.9 | 3.4 | 1 3/8 x 4 5/8 |
| 950 | 550C951T450EE2B | 77.1 | 7.6 | 1 3/4 x 5 1/8 | 580 | 550C581T500BB2B | 231.3 | 4.0 | 2 x 3 1/8 |
| 980 | 550C981T450CB2B | 77.3 | 7.9 | 2 1/2 x 3 1/8 | 580 | 550C581T500AE2B | 231.4 | 3.8 | 1 3/8 x 5 1/8 |
| 1100 | 550C112T450EF2B | 68.4 | 8.3 | 1 3/4 x 5 5/8 | 590 | 550C591T500EJ2B | 236.6 | 3.8 | 1 3/4 x 3 5/8 |
| 1100 | 550C112T450BD2B | 68.8 | 8.4 | 2 x 4 5/8 | 650 | 550C651T500AF2B | 206.2 | 4.2 | 1 3/8 x 5 5/8 |
| 1200 | 550C122T450BE2B | 61.5 | 9.2 | 2 x 5 1/8 | 680 | 550C681T500CH2B | 196.9 | 4.7 | 2 1/2 x 2 5/8 |
| 1300 | 550C132T450CJ2B | 57.3 | 9.7 | 2 1/2 x 3 5/8 | 720 | 550C721T500EC2B | 193.9 | 4.4 | 1 3/4 x 4 1/8 |
| 1400 | 550C142T450BF2B | 53.3 | 10.2 | 2 x 5 5/8 | 740 | 550C741T500BJ2B | 180.3 | 4.8 | 2 x 3 5/8 |
| 1500 | 550C152T450CC2B | 49.6 | 10.9 | 2 1/2 x 4 1/8 | 850 | 550C851T500ED2B | 164.5 | 5.0 | 1 3/4 x 4 5/8 |
| 1500 | 550C152T450DB2B | 47.4 | 11.3 | 3 x 3 1/8 | 910 | 550C911T500BC2B | 155.6 | 5.4 | 2 x 4 1/8 |
| 1800 | 550C182T450CD2B | 42.2 | 12.2 | 2 1/2 x 4 5/8 | 960 | 550C961T500CB2B | 140.8 | 5.9 | 2 1/2 x 3 1/8 |
| 2000 | 550C202T450DJ2B | 37.0 | 13.5 | 3 x 3 5/8 | 980 | 550C981T500EE2B | 142.9 | 5.6 | 1 3/4 x 5 1/8 |
| 2100 | 550C212T450CE2B | 34.9 | 13.9 | 2 1/2 x 5 1/8 | 1100 | 550C112T500BD2B | 122.8 | 6.3 | 2 x 4 5/8 |
| 2400 | 550C242T450CF2B | 30.5 | 15.3 | 2 1/2 x 5 5/8 | 1100 | 550C112T500EF2B | 126.4 | 6.1 | 1 3/4 x 5 5/8 |
| 2400 | 550C242T450DC2B | 30.6 | 15.5 | 3 x 4 1/8 | 1200 | 550C122T500CJ2B | 109.1 | 7.0 | 2 1/2 x 3 5/8 |
| 2900 | 550C292T450DD2B | 26.1 | 17.4 | 3 x 4 5/8 | 1200 | 550C122T500BE2B | 109.1 | 6.9 | 2 x 5 1/8 |
| 3200 | 550C322T450FC2D | 22.9 | 19.6 | 3 1/2 x 4 1/8 | 1400 | 550C142T500DB2B | 86.2 | 8.4 | 3 x 3 1/8 |
| 3300 | 550C332T450DE2B | 22.7 | 19.2 | 3 x 5 1/8 | 1400 | 550C142T500BF2B | 91.5 | 7.8 | 2 x 5 5/8 |
| 3700 | 550C372T450DF2B | 20.2 | 20.9 | 3 x 5 5/8 | 1500 | 550C152T500CC2B | 85.3 | 8.3 | 2 1/2 x 4 1/8 |
| 3800 | 550C382T450FD2D | 19.5 | 22.1 | 3 1/2 x 4 5/8 | 1800 | 550C182T500CD2B | 72.4 | 9.3 | 2 1/2 x 4 5/8 |
| 4000 | 550C402T450DP2B | 19.2 | 21.8 | 3 x 5 7/8 | 1900 | 550C192T500DJ2B | 66.0 | 10.1 | 3 x 3 5/8 |
| 4400 | 550C442T450FE2D | 17.0 | 24.3 | 3 1/2 x 5 1/8 | 2000 | 550C202T500CE2B | 66.4 | 10.1 | 2 1/2 x 5 1/8 |
| 5000 | 550C502T450FF2D | 15.1 | 26.5 | 3 1/2 x 5 5/8 | 2300 | 550C232T500DC2B | 53.9 | 11.6 | 3 x 4 1/8 |
| 5300 | 550C532T450FP2D | 14.3 | 27.6 | 3 1/2 x 5 7/8 | 2300 | 550C232T500CF2B | 55.7 | 11.4 | 2 1/2 x 5 5/8 |
| 5500 | 550C552T450DN2B | 15.5 | 26.8 | 3 x 7 5/8 | 2700 | 550C272T500DD2B | 45.2 | 13.2 | 3 x 4 5/8 |
| 6400 | 550C642T450DG2B | 13.1 | 29.8 | 3 x 8 5/8 | 3100 | 550C312T500DE2B | 38.9 | 14.7 | 3 x 5 1/8 |
| 7100 | 550C712T450FN2D | 11.3 | 34.3 | 3 1/2 x 7 5/8 | 3200 | 550C322T500FC2D | 38.8 | 15.1 | 3 1/2 x 4 1/8 |
| 8100 | 550C812T450FG2D | 9.5 | 38.2 | 3 1/2 x 8 5/8 | 3500 | 550C352T500DF2B | 34.5 | 16.1 | 3 x 5 5/8 |
| 500 Vdc (550 Vdc STrge) | | | | | 3700 | 550C372T500DP2B | 32.4 | 16.8 | 3 x 5 7/8 |
| 91 | 550C910T500AK2B | 1482.2 | 1.0 | 1 3/8 x 1 5/8 | 3800 | 550C382T500FD2D | 32.3 | 17.1 | 3 1/2 x 4 5/8 |
| 150 | 550C151T500AA2B | 865.7 | 1.4 | 1 3/8 x 2 1/8 | 4300 | 550C432T500FE2D | 28.4 | 18.8 | 3 1/2 x 5 1/8 |
| 220 | 550C221T500AH2B | 612.3 | 1.8 | 1 3/8 x 2 5/8 | 4900 | 550C492T500FF2D | 24.3 | 20.9 | 3 1/2 x 5 5/8 |
| 230 | 550C231T500EA2B | 609.4 | 2.0 | 1 3/4 x 2 1/8 | 5200 | 550C522T500FP2D | 23.0 | 21.8 | 3 1/2 x 5 7/8 |
| 290 | 550C291T500BA2B | 463.9 | 2.5 | 2 x 2 1/8 | 5400 | 550C542T500DN2B | 26.1 | 20.9 | 3 x 7 5/8 |
| 290 | 550C291T500AB2B | 459.7 | 2.3 | 1 3/8 x 3 1/8 | 6000 | 550C602T500DG2B | 19.7 | 24.2 | 3 x 8 5/8 |
| 330 | 550C331T500EH2B | 424.5 | 2.6 | 1 3/4 x 2 5/8 | 7000 | 550C702T500FN2D | 17.0 | 27.9 | 3 1/2 x 7 5/8 |
| 360 | 550C361T500AJ2B | 368.3 | 2.7 | 1 3/8 x 3 5/8 | 8400 | 550C842T500FG2D | 14.3 | 31.0 | 3 1/2 x 8 5/8 |

Type 550C 105 °C High Ripple, Inverter Grade, Aluminum

Ultra-Ripple, Long Life Screw Terminal Type

Typical Performance Curves

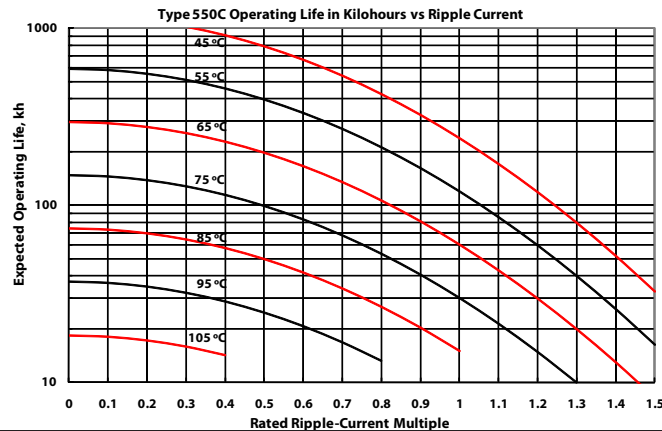
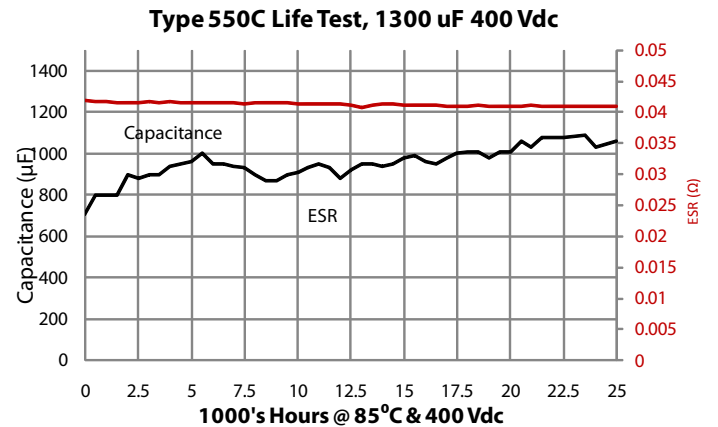
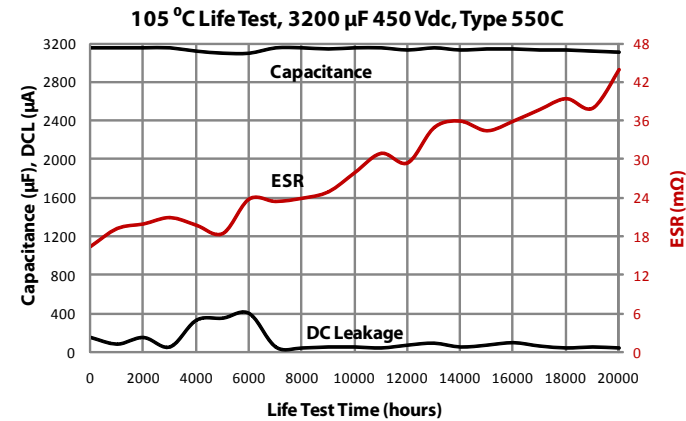
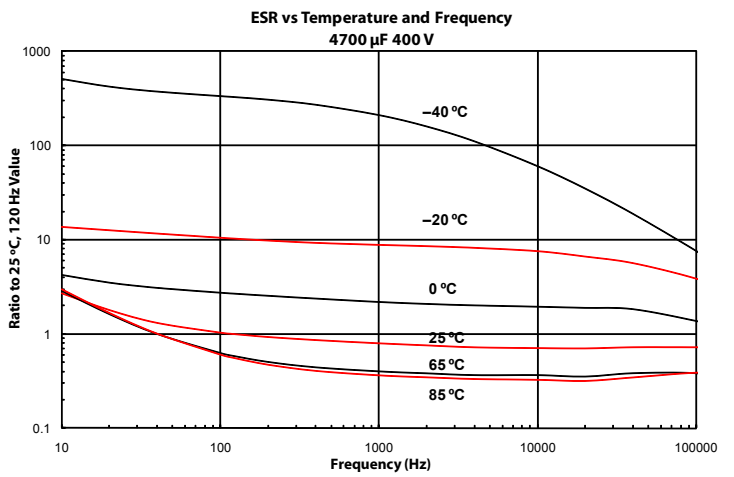
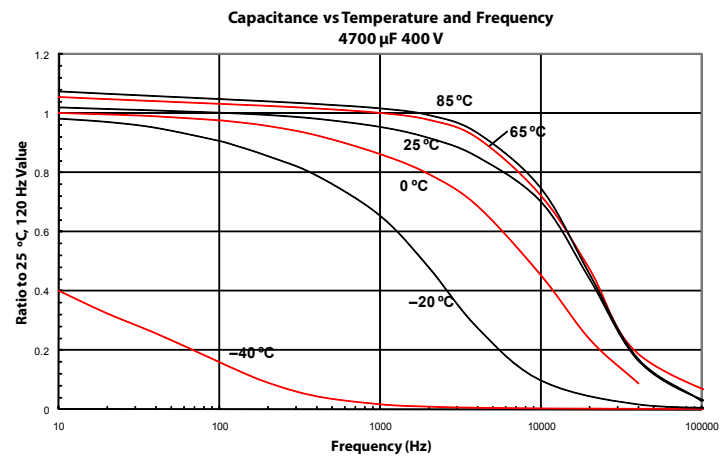
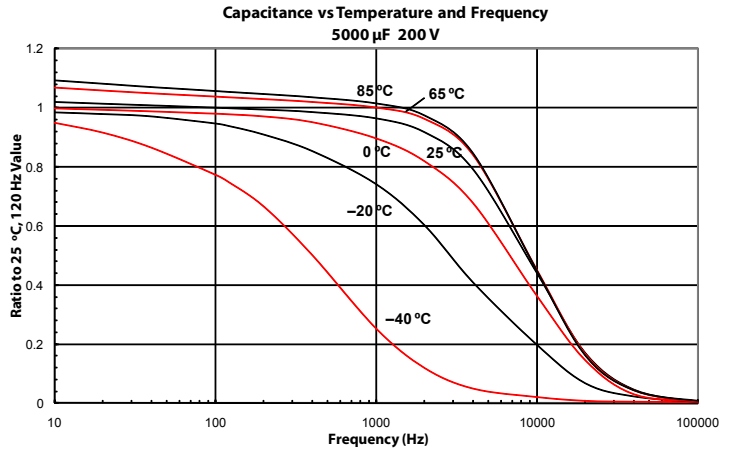
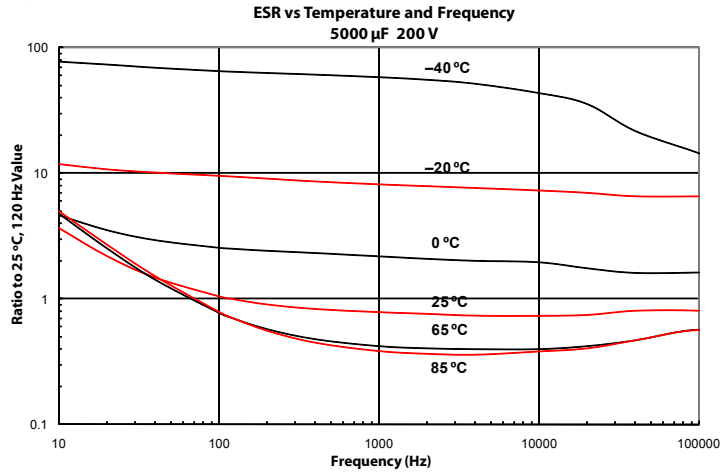



Компания «ЭлектроПласт» предлагает заключение долгосрочных отношений при поставках импортных электронных компонентов на взаимовыгодных условиях!

Наши преимущества:

- Оперативные поставки широкого спектра электронных компонентов отечественного и импортного производства напрямую от производителей и с крупнейших мировых складов;
- Поставка более 17-ти миллионов наименований электронных компонентов;
- Поставка сложных, дефицитных, либо снятых с производства позиций;
- Оперативные сроки поставки под заказ (от 5 рабочих дней);
- Экспресс доставка в любую точку России;
- Техническая поддержка проекта, помощь в подборе аналогов, поставка прототипов;
- Система менеджмента качества сертифицирована по Международному стандарту ISO 9001;
- Лицензия ФСБ на осуществление работ с использованием сведений, составляющих государственную тайну;
- Поставка специализированных компонентов (Xilinx, Altera, Analog Devices, Intersil, Interpoint, Microsemi, Aeroflex, Peregrine, Syfer, Eurofarad, Texas Instrument, Miteq, Cobham, E2V, MA-COM, Hittite, Mini-Circuits, General Dynamics и др.);

Помимо этого, одним из направлений компании «ЭлектроПласт» является направление «Источники питания». Мы предлагаем Вам помощь Конструкторского отдела:

- Подбор оптимального решения, техническое обоснование при выборе компонента;
- Подбор аналогов;
- Консультации по применению компонента;
- Поставка образцов и прототипов;
- Техническая поддержка проекта;
- Защита от снятия компонента с производства.



Как с нами связаться

Телефон: 8 (812) 309 58 32 (многоканальный)

Факс: 8 (812) 320-02-42

Электронная почта: org@eplast1.ru

Адрес: 198099, г. Санкт-Петербург, ул. Калинина, дом 2, корпус 4, литера А.