

## MODEL 805M1 ACCELEROMETER

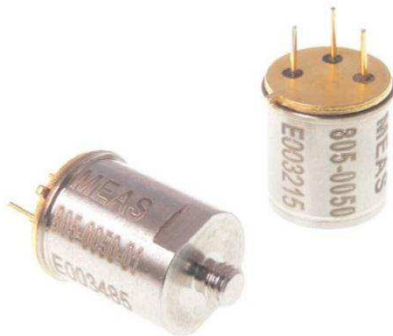

### SPECIFICATIONS

- ◆ **TO-5 Series Accelerometer**
- ◆ **3-Wire Voltage Output**
- ◆ **Low-Cost, Embedded Applications**
- ◆ **<0.80mA Power Consumption**

The Model 805M1 is a miniature adhesive mount voltage output accelerometer built on a 3-pin TO-5 header. It is available in  $\pm 20g$  to  $\pm 500g$  dynamic ranges and offers a flat frequency response to 12kHz. The accelerometer features a hermetic construction in a TO-5 header configuration. The model 805M1 incorporates a stable piezo-ceramic crystal with low power electronics in a 100% shielded housing suitable for many embedded OEM applications.

The model 805M1 accelerometer is offered in two configurations; one for adhesive mounting and one for stud mounting. An isolating cover option is also included for the standard model.

### FEATURES

- ◆  $\pm 20g$  to  $\pm 500g$  Range
- ◆ Wide bandwidth up to 12kHz
- ◆ TO-5 Configuration
- ◆ Hermetically Sealed
- ◆  $-40^{\circ}\text{C}$  to  $+100^{\circ}\text{C}$  Operating Range
- ◆ Case Grounded Design
- ◆ 3.0-5.5 Excitation Voltage

### APPLICATIONS

- ◆ Machine Monitoring
- ◆ Embedded Preventive Maintenance
- ◆ Low-Cost OEM Installation
- ◆ Permanent Structural Study
- ◆ Embedded Sensing Solution

**PERFORMANCE SPECIFICATIONS**

All values are typical at +24°C, 80Hz and 5Vdc excitation unless otherwise stated. TE Connectivity reserves the right to update and change these specifications without notice.

**Parameters**

**DYNAMIC**

|                            | ±20       | ±50       | ±100      | ±200      | ±500      | <b>Notes</b>           |
|----------------------------|-----------|-----------|-----------|-----------|-----------|------------------------|
| Range (g)                  |           |           |           |           |           |                        |
| Sensitivity (mV/g)         | 100       | 40        | 20        | 10        | 4         | ±10%                   |
| Frequency Response (Hz)    | 1-8000    | 1-8000    | 1-8000    | 1-8000    | 1-8000    | ±1dB                   |
| Frequency Response (Hz)    | 0.4-10000 | 0.4-10000 | 0.4-12000 | 0.4-12000 | 0.4-12000 | ±3dB                   |
| Natural Frequency (Hz)     | 34000     | 34000     | 34000     | 34000     | 34000     |                        |
| Non-Linearity (%FSO)       | ±1        | ±1        | ±1        | ±1        | ±1        |                        |
| Transverse Sensitivity (%) | 5         | 5         | 5         | 5         | 5         |                        |
| Shock Limit (g)            | 5000      | 5000      | 5000      | 5000      | 5000      |                        |
| Residual Noise (g RMS)     | 0.001     | 0.001     | 0.003     | 0.003     | 0.005     | Broadband 1Hz to 10kHz |

**ELECTRICAL**

|                                       |                                   |  |  |  |  |        |
|---------------------------------------|-----------------------------------|--|--|--|--|--------|
| Bias Voltage (Vdc)                    | Exc Voltage / 2                   |  |  |  |  |        |
| Total Supply Current (mA)             | <0.80                             |  |  |  |  |        |
| Excitation Voltage (Vdc) <sup>1</sup> | 3.0 to 5.5                        |  |  |  |  |        |
| Output Impedance (Ω)                  | <100                              |  |  |  |  |        |
| Insulation Resistance (MΩ)            | >100                              |  |  |  |  | @50Vdc |
| Full Scale Output Voltage (V)         | ±2                                |  |  |  |  |        |
| Grounding                             | Case grounded to mounting surface |  |  |  |  |        |

**ENVIRONMENTAL**

|                            |             |
|----------------------------|-------------|
| Temperature Response (%)   | ±10         |
| Operating Temperature (°C) | -40 to +100 |
| Storage Temperature (°C)   | -54 to +125 |

**PHYSICAL**

|                 |   |
|-----------------|---|
| Sensing Element | Piezo-Ceramic   |
| Case Material   | Stainless Steel   |
| Weight (grams)  | 5.0   |
| Mounting        | Adhesive or Circuit Board (M3 Stud Mounting for -01 Option) |

<sup>1</sup> The model 805M1 can be operated with 2.8V excitation but the full-scale range will be limited.

**Calibration supplied:** CS-SENS-0100 NIST Traceable Amplitude Calibration at 80Hz

The information in this sheet has been carefully reviewed and is believed to be accurate; however, no responsibility is assumed for inaccuracies. Furthermore, this information does not convey to the purchaser of such devices any license under the patent rights to the manufacturer. TE Connectivity reserves the right to make changes without further notice to any product herein. TE Connectivity makes no warranty, representation or guarantee regarding the suitability of its product for any particular purpose, nor does TE Connectivity assume any liability arising out of the application or use of any product or circuit and specifically disclaims any and all liability, including without limitation consequential or incidental damages. Typical parameters can and do vary in different applications. All operating parameters must be validated for each customer application by customer's technical experts. TE Connectivity does not convey any license under its patent rights nor the rights of others.

# MODEL 805M1 ACCELEROMETER

## DIMENSIONS

### Standard Model 805M1

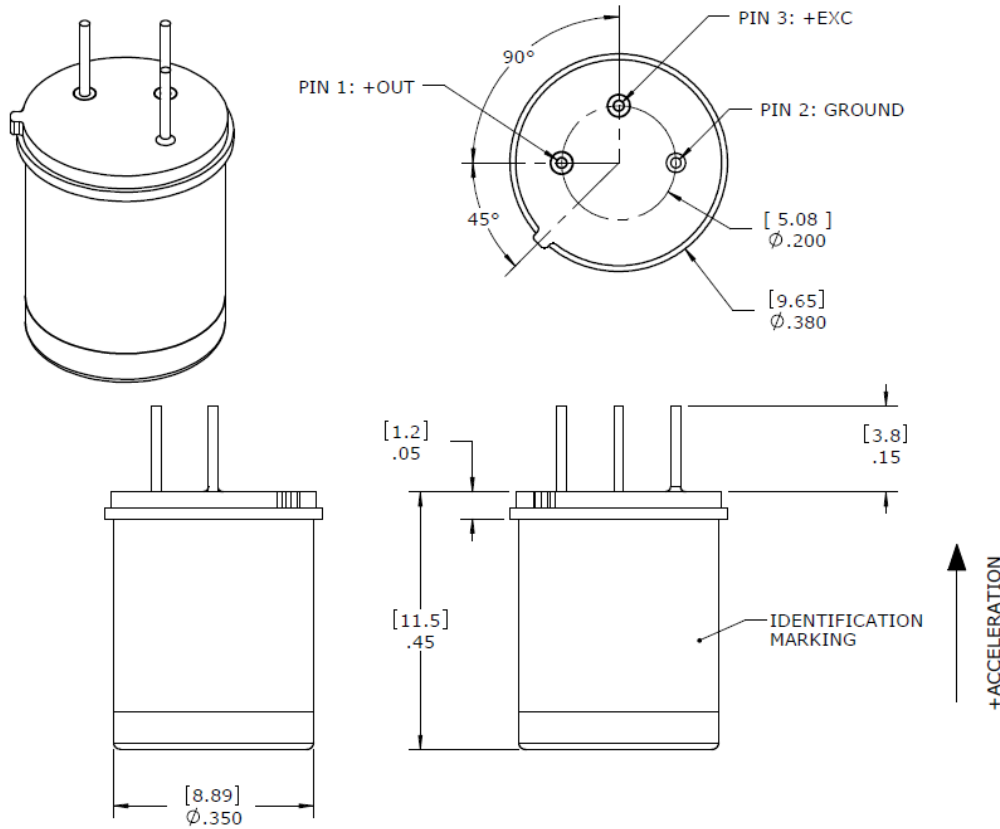

### Model 805M1 with M3 Mounting Stud Option

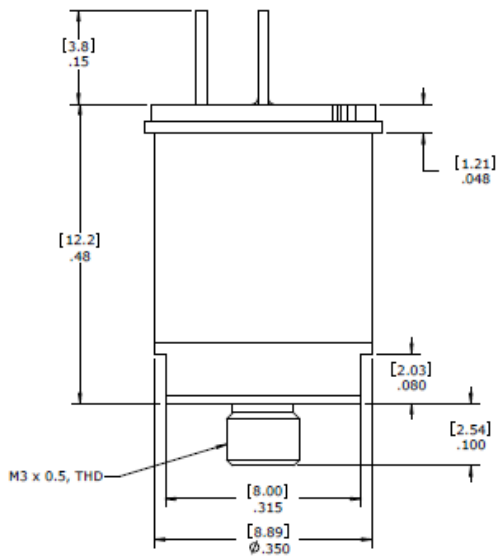

# MODEL 805M1 ACCELEROMETER

## SCHEMATIC

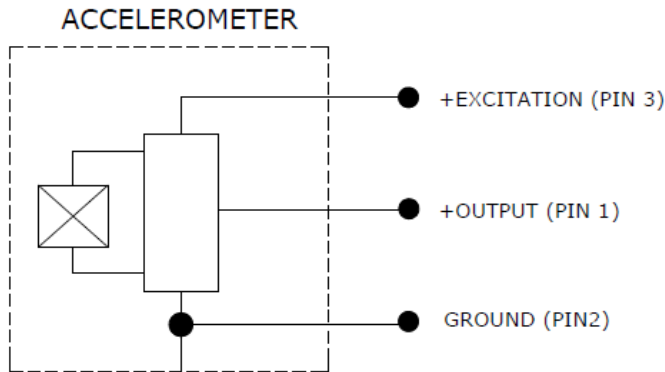

## ORDERING INFORMATION

|   |             |           |
|---|-------------|-----------|
| <b>805M1</b>  | <b>GGGG</b> | <b>XX</b> |
| <b>Range</b><br>0020=20g<br>0050=50g<br>0100=100g<br>0200=200g<br>0500=500g                                   |             |           |
| <b>Options</b><br>01=M3 x 0.5 Mounting Stud<br>02=Standard 805M1 unit with Isolating Mounting Cover Installed |             |           |



Isolating Cover Option

Examples;  
805M1-0020  
Model 805M1, 20g range

805M1-0200-01  
Model 805M1 with M3 mounting stud, 200g range

### NORTH AMERICA

Measurement Specialties, Inc.,  
a TE Connectivity Company  
Tel: 800-522-6752  
[customercare.hmpt@te.com](mailto:customercare.hmpt@te.com)

### EUROPE

MEAS France SAS  
a TE Connectivity Company  
Tel: +31 73 624 6999  
[customercare.lcsb@te.com](mailto:customercare.lcsb@te.com)

### ASIA

Measurement Specialties (China), Ltd.,  
a TE Connectivity Company  
Tel: 0400-820-6015  
[customercare.shzn@te.com](mailto:customercare.shzn@te.com)

### [TE.com/sensorsolutions](http://TE.com/sensorsolutions)

MEAS France SAS and Measurement Specialties (China), Inc., are TE Connectivity companies.

TE Connectivity, TE, TE connectivity (logo) are trademarks. All other logos, products and/or company names referred to herein might be trademarks of their respective owners.

The information given herein, including drawings, illustrations and schematics which are intended for illustration purposes only, is believed to be reliable. However, TE Connectivity makes no warranties as to its accuracy or completeness and disclaims any liability in connection with its use. TE Connectivity's obligations shall only be as set forth in TE Connectivity's Standard Terms and Conditions of Sale for this product and in no case will TE Connectivity be liable for any incidental, indirect or consequential damages arising out of the sale, resale, use or misuse of the product. Users of TE Connectivity products should make their own evaluation to determine the suitability of each such product for the specific application.

© 2017 TE Connectivity Ltd. All Rights Reserved.



Компания «ЭлектроПласт» предлагает заключение долгосрочных отношений при поставках импортных электронных компонентов на взаимовыгодных условиях!

Наши преимущества:

- Оперативные поставки широкого спектра электронных компонентов отечественного и импортного производства напрямую от производителей и с крупнейших мировых складов;
- Поставка более 17-ти миллионов наименований электронных компонентов;
- Поставка сложных, дефицитных, либо снятых с производства позиций;
- Оперативные сроки поставки под заказ (от 5 рабочих дней);
- Экспресс доставка в любую точку России;
- Техническая поддержка проекта, помощь в подборе аналогов, поставка прототипов;
- Система менеджмента качества сертифицирована по Международному стандарту ISO 9001;
- Лицензия ФСБ на осуществление работ с использованием сведений, составляющих государственную тайну;
- Поставка специализированных компонентов (Xilinx, Altera, Analog Devices, Intersil, Interpoint, Microsemi, Aeroflex, Peregrine, Syfer, Eurofarad, Texas Instrument, Miteq, Cobham, E2V, MA-COM, Hittite, Mini-Circuits, General Dynamics и др.);

Помимо этого, одним из направлений компании «ЭлектроПласт» является направление «Источники питания». Мы предлагаем Вам помощь Конструкторского отдела:

- Подбор оптимального решения, техническое обоснование при выборе компонента;
- Подбор аналогов;
- Консультации по применению компонента;
- Поставка образцов и прототипов;
- Техническая поддержка проекта;
- Защита от снятия компонента с производства.



#### Как с нами связаться

**Телефон:** 8 (812) 309 58 32 (многоканальный)

**Факс:** 8 (812) 320-02-42

**Электронная почта:** [org@eplast1.ru](mailto:org@eplast1.ru)

**Адрес:** 198099, г. Санкт-Петербург, ул. Калинина, дом 2, корпус 4, литера А.