

Type PSU AC Motor Start Capacitors

Non-polarized, Aluminum Electrolytic AC Motor Start Capacitors



The Type PSU is a compact non-polar, dual voltage rated, AC motor start capacitor constructed in a round rugged bakelite case. To extend the life of relay contact switches, the PSU can be purchased with optional bleeder resistors assembled with 1/4" quick-connect terminals. An optional mounting system consisting of a bracket that is attached to the capacitor case with one end cap is available. The PL end caps are for use with wiring through the bracket to the motor and the PLA end caps are for off motor mounting.

Optional Enhancements

End Caps

Mounting Bracket



Motor Start Resistor



Highlights

- ◆ Dual quick-connect terminals
- ◆ Rugged bakelite case
- ◆ Compact Size
- ◆ Resistor options
- ◆ Mounting options
- ◆ Non-polar
- ◆ Meets EIA RS-463 Type 2 (Normal Performance)
- ◆ Listed under UL file no. E128034

Specifications



Complies with the EU Directive 2002/95/EC requirement restricting the use of Lead (Pb), Mercury (Hg), Cadmium (Cd), Hexavalent chromium (Cr(VI)), PolyBrominated Biphenyls (PBB) and PolyBrominated Diphenyl Ethers (PBDE).

| | |
|-------------------------------------|---------------------------------|
| Capacitance Range: | 21 μ F to 1280 μ F |
| Voltage Range: | 110 Vac to 330 Vac |
| Capacitance Tolerance: | See ratings table |
| Operating Temperature Range: | -40 °C to 65 °C |
| Storage Temperature Range: | -55 °C to 85 °C |
| Operating Frequency: | 50 Hz to 60 Hz |
| Power Factor: | 10% max (12% \leq 30 μ F) |

Ratings

| Cap (μ F) | Catalog Part Number | Voltage (Vac) | Case Code | Diameter \pm .015 (Inches) | Length \pm .06 (Inches) |
|-------------------|------------------------|------------------|--------------|------------------------------------|---------------------------------|
| 21-25 | PSU2115 | 110/125 | 1 | 1 7/16 | 2 3/4 |
| 25-30 | PSU2515 | 110/125 | 1 | 1 7/16 | 2 3/4 |
| 30-36 | PSU3015 | 110/125 | 1 | 1 7/16 | 2 3/4 |
| 36-43 | PSU3615 | 110/125 | 1 | 1 7/16 | 2 3/4 |
| 43-52 | PSU4315 | 110/125 | 1 | 1 7/16 | 2 3/4 |
| 47-56 | PSU4715 | 110/125 | 1 | 1 7/16 | 2 3/4 |
| 53-64 | PSU5315 | 110/125 | 1 | 1 7/16 | 2 3/4 |
| 64-77 | PSU6415 | 110/125 | 1 | 1 7/16 | 2 3/4 |
| 72-86 | PSU7215 | 110/125 | 1 | 1 7/16 | 2 3/4 |
| 88-106 | PSU8815 | 110/125 | 1 | 1 7/16 | 2 3/4 |
| 108-130 | PSU10815 | 110/125 | 1 | 1 7/16 | 2 3/4 |
| 124-149 | PSU12415 | 110/125 | 1 | 1 7/16 | 2 3/4 |
| 130-156 | PSU13015 | 110/125 | 1 | 1 7/16 | 2 3/4 |
| 145-174 | PSU14515 | 110/125 | 1 | 1 7/16 | 2 3/4 |
| 161-193 | PSU16115 | 110/125 | 1 | 1 7/16 | 2 3/4 |
| 189-227 | PSU18915A | 110/125 | 1 | 1 7/16 | 2 3/4 |
| 200-240 | PSU20015 | 110/125 | 2 | 1 7/16 | 3 3/8 |

| Cap (μ F) | Catalog Part Number | Voltage (Vac) | Case Code | Diameter \pm .015 (Inches) | Length \pm .06 (Inches) |
|-------------------|------------------------|------------------|--------------|------------------------------------|---------------------------------|
| 216-259 | PSU21615 | 110/125 | 2 | 1 7/16 | 3 3/8 |
| 216-259 | PSU21615A | 110/125 | 1 | 1 7/16 | 2 3/4 |
| 233-280 | PSU23315A | 110/125 | 2 | 1 7/16 | 3 3/8 |
| 233-280 | PSU23315B | 110/125 | 1 | 1 7/16 | 2 3/4 |
| 243-292 | PSU24315A | 110/125 | 2 | 1 7/16 | 3 3/8 |
| 243-292 | PSU24315B | 110/125 | 1 | 1 7/16 | 2 3/4 |
| 270-324 | PSU27015A | 110/125 | 2 | 1 7/16 | 3 3/8 |
| 270-324 | PSU27015B | 110/125 | 1 | 1 7/16 | 2 3/4 |
| 300-360 | PSU30015 | 110/125 | 4 | 1 13/16 | 3 3/8 |
| 324-389 | PSU32415A | 110/125 | 3 | 1 7/16 | 4 3/8 |
| 324-389 | PSU32415B | 110/125 | 1 | 1 7/16 | 2 3/4 |
| 340-408 | PSU34015 | 110/125 | 4 | 1 13/16 | 3 3/8 |
| 340-408 | PSU34015A | 110/125 | 2 | 1 7/16 | 3 3/8 |
| 378-454 | PSU37815 | 110/125 | 4 | 1 13/16 | 3 3/8 |
| 378-454 | PSU37815A | 110/125 | 2 | 1 7/16 | 3 3/8 |
| 400-480 | PSU40015 | 110/125 | 4 | 1 13/16 | 3 3/8 |
| 400-480 | PSU40015A | 110/125 | 2 | 1 7/16 | 3 3/8 |

See page 5.00 for capacitor hardware and resistor options.

Type PSU AC Motor Start Capacitors

Ratings

| Cap (μ F) | Catalog Part Number | Voltage (Vac) | Case Code | Diameter ± 0.15 (Inches) | Length ± 0.06 (Inches) |
|-------------------|------------------------|------------------|--------------|------------------------------------|----------------------------------|
| 430-516 | PSU43015A | 110/125 | 4 | 1 13/16 | 3 3/8 |
| 430-516 | PSU43015B | 110/125 | 2 | 1 7/16 | 3 3/8 |
| 460-552 | PSU46015A | 110/125 | 4 | 1 13/16 | 3 3/8 |
| 460-552 | PSU46015B | 110/125 | 2 | 1 7/16 | 3 3/8 |
| 540-648 | PSU54015A | 110/125 | 4 | 1 13/16 | 3 3/8 |
| 540-648 | PSU54015B | 110/125 | 5 | 1 13/16 | 4 3/8 |
| 590-708 | PSU59015A | 110/125 | 5 | 1 13/16 | 4 3/8 |
| 590-708 | PSU59015B | 110/125 | 4 | 1 13/16 | 3 3/8 |
| 645-774 | PSU64515 | 110/125 | 5 | 1 13/16 | 4 3/8 |
| 645-774 | PSU64515A | 110/125 | 4 | 1 13/16 | 3 3/8 |
| 708-850 | PSU70815 | 110/125 | 5 | 1 13/16 | 4 3/8 |
| 708-850 | PSU70815A | 110/125 | 4 | 1 13/16 | 3 3/8 |
| 720-864 | PSU72015 | 110/125 | 5 | 1 13/16 | 4 3/8 |
| 720-864 | PSU72015A | 110/125 | 4 | 1 13/16 | 3 3/8 |
| 800-960 | PSU80015 | 110/125 | 5 | 1 13/16 | 4 3/8 |
| 800-960 | PSU80015A | 110/125 | 4 | 1 13/16 | 3 3/8 |
| 815-978 | PSU81515 | 110/125 | 5 | 1 13/16 | 4 3/8 |
| 815-978 | PSU81515A | 110/125 | 4 | 1 13/16 | 3 3/8 |
| 829-995 | PSU82915A | 110/125 | 5 | 1 13/16 | 4 3/8 |
| 829-995 | PSU82915B | 110/125 | 4 | 1 13/16 | 3 3/8 |
| 850-1020 | PSU85015 | 110/125 | 5 | 1 13/16 | 4 3/8 |
| 850-1020 | PSU85015A | 110/125 | 4 | 1 13/16 | 3 3/8 |
| 1000-1200 | PSU100015A | 110/125 | 7 | 2 1/16 | 4 3/8 |
| 1020-1224 | PSU102015 | 110/125 | 7 | 2 1/16 | 4 3/8 |
| 1175-1410 | PSU117515 | 110/125 | 7 | 2 1/16 | 4 3/8 |
| 1280-1536 | PSU128015 | 110/125 | 7 | 2 1/16 | 4 3/8 |
| 21-25 | PSU2165A | 165 | 1 | 1 7/16 | 2 3/4 |
| 25-30 | PSU2565A | 165 | 1 | 1 7/16 | 2 3/4 |
| 30-36 | PSU3065A | 165 | 1 | 1 7/16 | 2 3/4 |
| 36-43 | PSU3665A | 165 | 1 | 1 7/16 | 2 3/4 |
| 43-52 | PSU4365A | 165 | 1 | 1 7/16 | 2 3/4 |
| 47-56 | PSU4765A | 165 | 1 | 1 7/16 | 2 3/4 |
| 53-64 | PSU5365A | 165 | 1 | 1 7/16 | 2 3/4 |
| 64-77 | PSU6465A | 165 | 1 | 1 7/16 | 2 3/4 |
| 72-86 | PSU7265A | 165 | 1 | 1 7/16 | 2 3/4 |
| 88-106 | PSU8865 | 165 | 2 | 1 7/16 | 3 3/8 |
| 88-106 | PSU8865A | 165 | 1 | 1 7/16 | 2 3/4 |
| 108-130 | PSU10865 | 165 | 2 | 1 7/16 | 3 3/8 |
| 108-130 | PSU10865A | 165 | 1 | 1 7/16 | 2 3/4 |
| 124-149 | PSU12465 | 165 | 2 | 1 7/16 | 3 3/8 |
| 124-149 | PSU12465A | 165 | 1 | 1 7/16 | 2 3/4 |
| 130-156 | PSU13065 | 165 | 2 | 1 7/16 | 3 3/8 |
| 130-156 | PSU13065A | 165 | 1 | 1 7/16 | 2 3/4 |
| 145-174 | PSU14565 | 165 | 2 | 1 7/16 | 3 3/8 |
| 145-174 | PSU14565A | 165 | 1 | 1 7/16 | 2 3/4 |
| 161-193 | PSU16165 | 165 | 2 | 1 7/16 | 3 3/8 |
| 161-193 | PSU16165A | 165 | 1 | 1 7/16 | 2 3/4 |

| Cap (μ F) | Catalog Part Number | Voltage (Vac) | Case Code | Diameter ± 0.15 (Inches) | Length ± 0.06 (Inches) |
|-------------------|------------------------|------------------|--------------|------------------------------------|----------------------------------|
| 189-227 | PSU18965B | 165 | 2 | 1 7/16 | 3 3/8 |
| 189-227 | PSU18965C | 165 | 1 | 1 7/16 | 2 3/4 |
| 216-259 | PSU21665A | 165 | 4 | 1 13/16 | 3 3/8 |
| 233-280 | PSU23365 | 165 | 3 | 1 7/16 | 4 3/8 |
| 233-280 | PSU23365A | 165 | 4 | 1 13/16 | 3 3/8 |
| 243-292 | PSU24365 | 165 | 3 | 1 7/16 | 4 3/8 |
| 243-292 | PSU24365A | 165 | 4 | 1 13/16 | 3 3/8 |
| 270-324 | PSU27065A | 165 | 3 | 1 7/16 | 4 3/8 |
| 270-324 | PSU27065B | 165 | 4 | 1 13/16 | 3 3/8 |
| 324-389 | PSU32465 | 165 | 5 | 1 13/16 | 4 3/8 |
| 324-389 | PSU32465A | 165 | 4 | 1 13/16 | 3 3/8 |
| 340-408 | PSU34065 | 165 | 5 | 1 13/16 | 4 3/8 |
| 340-408 | PSU34065A | 165 | 4 | 1 13/16 | 3 3/8 |
| 378-454 | PSU37865 | 165 | 5 | 1 13/16 | 4 3/8 |
| 378-454 | PSU37865A | 165 | 4 | 1 13/16 | 3 3/8 |
| 400-480 | PSU40065 | 165 | 5 | 1 13/16 | 4 3/8 |
| 400-480 | PSU40065A | 165 | 4 | 1 13/16 | 3 3/8 |
| 430-516 | PSU43065 | 165 | 5 | 1 13/16 | 4 3/8 |
| 430-516 | PSU43065A | 165 | 4 | 1 13/16 | 3 3/8 |
| 460-552 | PSU46065 | 165 | 5 | 1 13/16 | 4 3/8 |
| 460-552 | PSU46065A | 165 | 4 | 1 13/16 | 3 3/8 |
| 540-648 | PSU54065 | 165 | 7 | 2 1/16 | 4 3/8 |
| 540-648 | PSU54065A | 165 | 4 | 1 13/16 | 3 3/8 |
| 21-25 | PSU2135 | 220/250 | 1 | 1 7/16 | 2 3/4 |
| 25-30 | PSU2535 | 220/250 | 1 | 1 7/16 | 2 3/4 |
| 30-36 | PSU3035 | 220/250 | 1 | 1 7/16 | 2 3/4 |
| 36-43 | PSU3635 | 220/250 | 1 | 1 7/16 | 2 3/4 |
| 43-52 | PSU4335B | 220/250 | 2 | 1 7/16 | 3 3/8 |
| 43-52 | PSU4335C | 220/250 | 1 | 1 7/16 | 2 3/4 |
| 47-56 | PSU4735 | 220/250 | 2 | 1 7/16 | 3 3/8 |
| 47-56 | PSU4735A | 220/250 | 1 | 1 7/16 | 2 3/4 |
| 53-64 | PSU5335 | 220/250 | 2 | 1 7/16 | 3 3/8 |
| 53-64 | PSU5335A | 220/250 | 1 | 1 7/16 | 2 3/4 |
| 64-77 | PSU6435 | 220/250 | 2 | 1 7/16 | 3 3/8 |
| 64-77 | PSU6435A | 220/250 | 1 | 1 7/16 | 2 3/4 |
| 72-86 | PSU7235 | 220/250 | 4 | 1 13/16 | 3 3/8 |
| 88-106 | PSU8835 | 220/250 | 4 | 1 13/16 | 3 3/8 |
| 108-130 | PSU10835A | 220/250 | 4 | 1 13/16 | 3 3/8 |
| 124-149 | PSU12435 | 220/250 | 5 | 1 13/16 | 4 3/8 |
| 124-149 | PSU12435A | 220/250 | 4 | 1 13/16 | 3 3/8 |
| 130-156 | PSU13035 | 220/250 | 5 | 1 13/16 | 4 3/8 |
| 130-156 | PSU13035A | 220/250 | 4 | 1 13/16 | 3 3/8 |
| 145-174 | PSU14535 | 220/250 | 5 | 1 13/16 | 4 3/8 |
| 145-174 | PSU14535A | 220/250 | 4 | 1 13/16 | 3 3/8 |
| 161-193 | PSU16135A | 220/250 | 7 | 2 1/16 | 4 3/8 |
| 189-227 | PSU18935A | 220/250 | 7 | 2 1/16 | 4 3/8 |
| 189-227 | PSU18935B | 220/250 | 6 | 2 1/16 | 3 3/8 |

See page 5.000 for capacitor hardware and resistor options.

Type PSU AC Motor Start Capacitors

Ratings

| Cap (μ F) | Catalog Part Number | Voltage (Vac) | Case Code | Diameter ± 0.015 (Inches) | Length ± 0.06 (Inches) |
|-------------------|------------------------|------------------|--------------|-------------------------------------|----------------------------------|
| 216-259 | PSU21635A | 220/250 | 7 | 2 1/16 | 4 3/8 |
| 216-259 | PSU21635B | 220/250 | 6 | 2 1/16 | 3 3/8 |
| 233-280 | PSU23335A | 220/250 | 7 | 2 1/16 | 4 3/8 |
| 233-280 | PSU23335B | 220/250 | 6 | 2 1/16 | 3 3/8 |
| 243-292 | PSU24335 | 220/250 | 7 | 2 1/16 | 4 3/8 |
| 243-292 | PSU24335A | 220/250 | 6 | 2 1/16 | 3 3/8 |
| 270-324 | PSU27035A | 220/250 | 7 | 2 1/16 | 4 3/8 |
| 270-324 | PSU27035B | 220/250 | 6 | 2 1/16 | 3 3/8 |
| 16-20 | PSU1630 | 330 | 2 | 1 7/16 | 3 3/8 |
| 18-22 | PSU1830 | 330 | 4 | 1 13/16 | 3 3/8 |
| 21-25 | PSU2130 | 330 | 1 | 1 7/16 | 2 3/4 |
| 21-25 | PSU2130A | 330 | 2 | 1 7/16 | 3 3/8 |
| 25-30 | PSU2530 | 330 | 2 | 1 7/16 | 3 3/8 |
| 30-36 | PSU3030 | 330 | 2 | 1 7/16 | 3 3/8 |
| 36-43 | PSU3630 | 330 | 2 | 1 7/16 | 3 3/8 |
| 43-52 | PSU4330 | 330 | 2 | 1 7/16 | 3 3/8 |
| 43-52 | PSU4330A | 330 | 4 | 1 13/16 | 3 3/8 |
| 47-56 | PSU4730 | 330 | 4 | 1 13/16 | 3 3/8 |
| 53-64 | PSU5330B | 330 | 4 | 1 13/16 | 3 3/8 |
| 64-77 | PSU6430 | 330 | 4 | 1 13/16 | 3 3/8 |

| Cap (μ F) | Catalog Part Number | Voltage (Vac) | Case Code | Diameter ± 0.015 (Inches) | Length ± 0.06 (Inches) |
|-------------------|------------------------|------------------|--------------|-------------------------------------|----------------------------------|
| 72-86 | PSU7230B | 330 | 5 | 1 13/16 | 4 3/8 |
| 72-86 | PSU7230C | 330 | 4 | 1 13/16 | 3 3/8 |
| 88-106 | PSU8830A | 330 | 5 | 1 13/16 | 4 3/8 |
| 88-106 | PSU8830B | 330 | 4 | 1 13/16 | 3 3/8 |
| 108-130 | PSU10830B | 330 | 7 | 2 1/16 | 4 3/8 |
| 124-149 | PSU12430 | 330 | 8 | 2 9/16 | 4 3/8 |
| 124-149 | PSU12430A | 330 | 7 | 2 1/16 | 4 3/8 |
| 130-156 | PSU13030 | 330 | 7 | 2 1/16 | 4 3/8 |
| 145-174 | PSU14530A | 330 | 7 | 2 1/16 | 4 3/8 |
| 161-193 | PSU16130 | 330 | 8 | 2 9/16 | 4 3/8 |
| 161-193 | PSU16130A | 330 | 7 | 2 1/16 | 4 3/8 |
| 189-227 | PSU18930 | 330 | 8 | 2 9/16 | 4 3/8 |
| 189-227 | PSU18930A | 330 | 7 | 2 1/16 | 4 3/8 |
| 216-259 | PSU21630 | 330 | 8 | 2 9/16 | 4 3/8 |
| 216-259 | PSU21630A | 330 | 7 | 2 1/16 | 4 3/8 |
| 270-324 | PSU27030 | 330 | 8 | 2 9/16 | 4 3/8 |
| 270-324 | PSU27030A | 330 | 7 | 2 1/16 | 4 3/8 |
| 378-454 | PSU37830 | 330 | 8 | 2 9/16 | 4 3/8 |
| 460-552 | PSU46030 | 330 | 8 | 2 9/16 | 4 3/8 |

See page 5.000 for capacitor hardware and resistor options.

| Case Code | Inches | | |
|--------------|----------------------|-----------------------|-------------|
| | D (± 0.015) | L (+0.020, -0.030) | C (Ref.) |
| 1 | 1-7/16 (1.4375) | 2-3/4 (2.750) | 1/2 (.500) |
| 2 | 1-7/16 (1.4375) | 3-3/8 (3.375) | 1/2 (.500) |
| 3 | 1-7/16 (1.4375) | 4-3/8 (4.375) | 1/2 (.500) |
| 4 | 1-13/16 (1.8125) | 3-3/8 (3.375) | 5/8 (.625) |
| 5 | 1-13/16 (1.8125) | 4-3/8 (4.375) | 5/8 (.625) |
| 6 | 2-1/16 (2.0625) | 3-3/8 (3.375) | 7/8 (.875) |
| 7 | 2-1/16 (2.0625) | 4-3/8 (4.375) | 7/8 (.875) |
| 8 | 2-9/16 (2.5625) | 4-3/8 (4.375) | 7/8 (.875) |

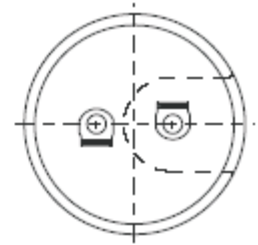

Single Disconnect Terminals
(SQC)
(All Cases)





Компания «ЭлектроПласт» предлагает заключение долгосрочных отношений при поставках импортных электронных компонентов на взаимовыгодных условиях!

Наши преимущества:

- Оперативные поставки широкого спектра электронных компонентов отечественного и импортного производства напрямую от производителей и с крупнейших мировых складов;
- Поставка более 17-ти миллионов наименований электронных компонентов;
- Поставка сложных, дефицитных, либо снятых с производства позиций;
- Оперативные сроки поставки под заказ (от 5 рабочих дней);
- Экспресс доставка в любую точку России;
- Техническая поддержка проекта, помощь в подборе аналогов, поставка прототипов;
- Система менеджмента качества сертифицирована по Международному стандарту ISO 9001;
- Лицензия ФСБ на осуществление работ с использованием сведений, составляющих государственную тайну;
- Поставка специализированных компонентов (Xilinx, Altera, Analog Devices, Intersil, Interpoint, Microsemi, Aeroflex, Peregrine, Syfer, Eurofarad, Texas Instrument, Miteq, Cobham, E2V, MA-COM, Hittite, Mini-Circuits, General Dynamics и др.);

Помимо этого, одним из направлений компании «ЭлектроПласт» является направление «Источники питания». Мы предлагаем Вам помощь Конструкторского отдела:

- Подбор оптимального решения, техническое обоснование при выборе компонента;
- Подбор аналогов;
- Консультации по применению компонента;
- Поставка образцов и прототипов;
- Техническая поддержка проекта;
- Защита от снятия компонента с производства.



Как с нами связаться

Телефон: 8 (812) 309 58 32 (многоканальный)

Факс: 8 (812) 320-02-42

Электронная почта: org@eplast1.ru

Адрес: 198099, г. Санкт-Петербург, ул. Калинина, дом 2, корпус 4, литера А.