

THIS DRAWING IS UNPUBLISHED. RELEASED FOR PUBLICATION  
 © COPYRIGHT - TE Connectivity ALL RIGHTS RESERVED.

| REVISIONS |     |                       |        |     |      |
|-----------|-----|-----------------------|--------|-----|------|
| P         | LTR | DESCRIPTION           | DATE   | DWN | APVD |
|           | C   | REV PER ECO 17-004921 | 6-6-17 | CT  | EH   |

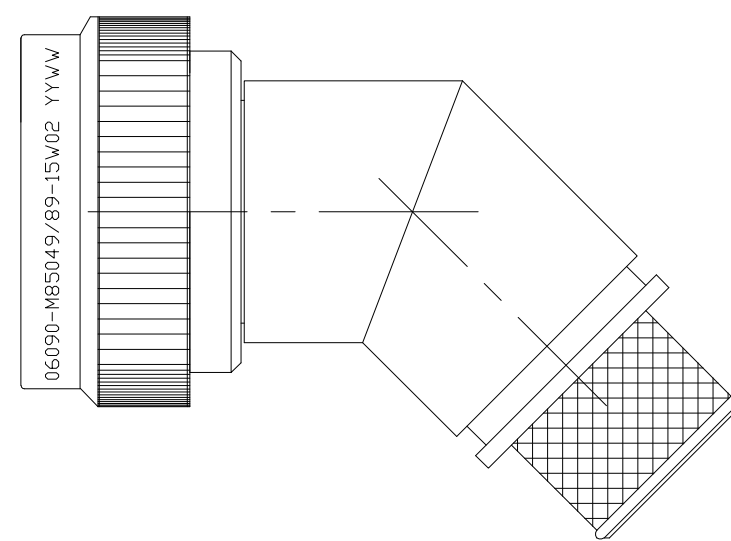

SELF-LOCKING  
 SHIELD BAND TERMINATION  
 SHRINK BOOT ACCOMMODATION 45°  
 ADAPTER

1. THIS PRODUCT IS DESIGNED TO TERMINATE A BRAIDED CABLE SHIELD AND A HEAT SHRINKABLE LIPPED BOOT TO A CONNECTOR, AND DESIGNED TO MEET PERFORMANCE REQUIREMENT OF AS85049/89.
2. ALL COMPONENTS SHALL BE PACKAGED AND SUPPLIED IN A PLASTIC BAG AND LABELED WITH M85049/89 DESIGNATION e. g. M85049/89-15W02.
3. PART SUPPLIED WITH STANDARD DETENTED SELF-LOCKING WHICH PROVIDES A POSITIVE AUDIBLE DETENTED COUPLING.
4. THIS ADAPTER MATES TO CONNECTOR MIL-DTL-38999 SERIES III AND MIL-DTL-38999 SERIES IV.
5. FOR MATERIAL AND FINISH INFORMATION REFER TO R85049.  
 FOR ALTERNATIVE MATERIALS AND PLATING FINISHES CONTACT TE CONNECTIVITY.

|   |  |                                |   |                    |                           |
|---|--|--------------------------------|---|--------------------|---------------------------|
| THIS DRAWING IS A CONTROLLED DOCUMENT.                                      |  | DWN<br>C.C.THOMAS<br>06JUN2017 |   |                    |                           |
| DIMENSIONS:<br>INCHES   |  | CHK<br>E.HALEY<br>6-6-17       |   |                    |                           |
|   |  | APVD<br>E.HALEY<br>6-6-17      | NAME<br>BACKSHELL, 45°, SELF-LOCKING, SHIELD BAND<br>TERMINATION, SHRINK BOOT ADAPTER |                    |                           |
| TOLERANCES UNLESS OTHERWISE SPECIFIED:                                      |  | PRODUCT SPEC                   | APPLICATION SPEC  |                    |                           |
| 0 PLC ± -<br>1 PLC ± -<br>2 PLC ± -<br>3 PLC ± -<br>4 PLC ± -<br>ANGLES ± - |  | WEIGHT<br>0                    | SIZE<br>A3  | CAGE CODE<br>06090 | DRAWING NO<br>C-R85049/89 |
| MATERIAL<br>-   |  | FINISH<br>-                    |   | RESTRICTED TO<br>- |                           |
| CUSTOMER DRAWING  |  |                                | SCALE<br>NTS  | SHEET<br>1 OF 3    | REV<br>C                  |

THIS DRAWING IS UNPUBLISHED.

RELEASED FOR PUBLICATION

REVISIONS

© COPYRIGHT - TE Connectivity

ALL RIGHTS RESERVED.

| P | LTR | DESCRIPTION | DATE | DWN | APVD |
|---|-----|-------------|------|-----|------|
| - | -   | SEE SHEET 1 | -    | -   | -    |



PART NUMBERING

R85049/89 - 15 W 02

- SPECIFICATION SHEET \_\_\_\_\_
- CONFIGURATION: \_\_\_\_\_
  - (DASH) DETENTED SELF-LOCKING
- ORDER NO. \_\_\_\_\_
- FINISH \_\_\_\_\_
- ENTRY SIZE \_\_\_\_\_

|  |             |                                |   |                    |                           |                    |     |       |     |       |     |        |     |                   |                       |  |  |
|--|-------------|--------------------------------|---|--------------------|---------------------------|--------------------|-----|-------|-----|-------|-----|--------|-----|-------------------|-----------------------|--|--|
| THIS DRAWING IS A CONTROLLED DOCUMENT.   |             | DWN<br>C.C.THOMAS<br>06JUN2017 | <b>TE Connectivity</b>  |                    |                           |                    |     |       |     |       |     |        |     |                   |                       |  |  |
| DIMENSIONS:<br>INCHES  |             | CHK<br>E.HALEY<br>6-6-17       |   |                    |                           |                    |     |       |     |       |     |        |     |                   |                       |  |  |
| TOLERANCES UNLESS OTHERWISE SPECIFIED:   |             | APVD<br>E.HALEY<br>6-6-17      | NAME<br>BACKSHELL, 45°, SELF-LOCKING, SHIELD BAND<br>TERMINATION, SHRINK BOOT ADAPTER |                    |                           |                    |     |       |     |       |     |        |     |                   |                       |  |  |
| <table border="0"> <tr> <td>0 PLC</td><td>± -</td> </tr> <tr> <td>1 PLC</td><td>± -</td> </tr> <tr> <td>2 PLC</td><td>± -</td> </tr> <tr> <td>3 PLC</td><td>± -</td> </tr> <tr> <td>4 PLC</td><td>± -</td> </tr> <tr> <td>ANGLES</td><td>± -</td> </tr> </table> |             | 0 PLC                          | ± -   | 1 PLC              | ± -                       | 2 PLC              | ± - | 3 PLC | ± - | 4 PLC | ± - | ANGLES | ± - | PRODUCT SPEC<br>- | APPLICATION SPEC<br>- |  |  |
| 0 PLC  | ± -         |                                |   |                    |                           |                    |     |       |     |       |     |        |     |                   |                       |  |  |
| 1 PLC  | ± -         |                                |   |                    |                           |                    |     |       |     |       |     |        |     |                   |                       |  |  |
| 2 PLC  | ± -         |                                |   |                    |                           |                    |     |       |     |       |     |        |     |                   |                       |  |  |
| 3 PLC  | ± -         |                                |   |                    |                           |                    |     |       |     |       |     |        |     |                   |                       |  |  |
| 4 PLC  | ± -         |                                |   |                    |                           |                    |     |       |     |       |     |        |     |                   |                       |  |  |
| ANGLES   | ± -         |                                |   |                    |                           |                    |     |       |     |       |     |        |     |                   |                       |  |  |
| MATERIAL<br>-  | FINISH<br>- | WEIGHT<br>-                    | SIZE<br>A3  | CAGE CODE<br>06090 | DRAWING NO<br>C-R85049/89 | RESTRICTED TO<br>- |     |       |     |       |     |        |     |                   |                       |  |  |
| CUSTOMER DRAWING   |             |                                | SCALE<br>NTS  | SHEET<br>2 OF 3    | REV<br>C                  |                    |     |       |     |       |     |        |     |                   |                       |  |  |

THIS DRAWING IS UNPUBLISHED.

RELEASED FOR PUBLICATION

© COPYRIGHT - TE Connectivity

ALL RIGHTS RESERVED.

REVISIONS

| P | LTR | DESCRIPTION | DATE | DWN | APVD |
|---|-----|-------------|------|-----|------|
| - | -   | SEE SHEET 1 | -    | -   | -    |

TABLE I - SHELL SIZE AND DIMENSIONS

| ORDER NUMBER | SHELL SIZE | ØA MAX      | ØB ±.010 ENTRY SIZE |             | ØC REF     |             |
|--------------|------------|-------------|---------------------|-------------|------------|-------------|
|              |            |             | 02                  | 03          | 02         | 03          |
| 9            | A          | .86 (21.8)  | N/A                 | .25 (6.4)   | N/A        | .39 (10.0)  |
| 11           | B          | .98 (25.0)  | N/A                 | .31 (7.9)   | N/A        | .46 (11.6)  |
| 13           | C          | 1.16 (29.4) | .31 (7.9)           | .44 (11.1)  | .46 (11.6) | .58 (14.8)  |
| 15           | D          | 1.28 (32.5) | .44 (11.1)          | .56 (14.3)  | .58 (14.8) | .71 (18.0)  |
| 17           | E          | 1.41 (35.7) | .50 (12.7)          | .62 (15.9)  | .64 (16.4) | .77 (19.6)  |
| 19           | F          | 1.52 (38.5) | .62 (15.9)          | .75 (19.1)  | .77 (19.6) | .89 (22.7)  |
| 21           | G          | 1.64 (41.7) | .62 (15.9)          | .81 (20.6)  | .77 (19.6) | .96 (24.3)  |
| 23           | H          | 1.77 (44.9) | .69 (17.5)          | .94 (23.8)  | .83 (21.1) | 1.08 (27.5) |
| 25           | J          | 1.89 (48.0) | .75 (19.1)          | 1.00 (25.4) | .89 (22.7) | 1.14 (29.1) |

TABLE I - SHELL SIZE AND DIMENSIONS (CONTINUED)

| ORDER NUMBER | SHELL SIZE | D MAX       | E MAX       | G MAX       |             | F REF       |             |
|--------------|------------|-------------|-------------|-------------|-------------|-------------|-------------|
|              |            |             |             | 02          | 03          | 02          | 03          |
| 9            | A          | 1.01 (25.7) | 1.16 (29.5) | N/A         | 1.97 (50.0) | N/A         | 2.22 (56.3) |
| 11           | B          | 1.03 (26.2) | 1.19 (30.2) | N/A         | 2.03 (51.6) | N/A         | 2.28 (57.9) |
| 13           | C          | 1.06 (26.9) | 1.21 (30.7) | 2.08 (52.8) | 2.12 (53.9) | 2.33 (59.1) | 2.37 (60.2) |
| 15           | D          | 1.08 (27.4) | 1.24 (31.5) | 2.16 (54.9) | 2.21 (56.1) | 2.41 (61.2) | 2.46 (62.4) |
| 17           | E          | 1.11 (28.2) | 1.26 (32.0) | 2.23 (56.6) | 2.27 (57.7) | 2.48 (62.9) | 2.52 (64.0) |
| 19           | F          | 1.12 (28.4) | 1.27 (32.3) | 2.29 (58.2) | 2.33 (59.3) | 2.54 (64.5) | 2.58 (65.6) |
| 21           | G          | 1.15 (29.2) | 1.30 (33.0) | 2.34 (59.5) | 2.41 (61.2) | 2.59 (65.8) | 2.66 (67.5) |
| 23           | H          | 1.17 (29.7) | 1.33 (33.8) | 2.40 (61.1) | 2.49 (63.3) | 2.65 (67.4) | 2.74 (69.6) |
| 25           | J          | 1.20 (30.5) | 1.35 (34.3) | 2.47 (62.8) | 2.56 (65.0) | 2.72 (69.1) | 2.81 (71.3) |

THIS DRAWING IS A CONTROLLED DOCUMENT.

DWN C.C.THOMAS 06JUN2017

CHK E.HALEY 6-6-17

APVD E.HALEY 6-6-17

PRODUCT SPEC

APPLICATION SPEC

WEIGHT -

CUSTOMER DRAWING

DIMENSIONS:  
INCHES

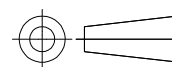

TOLERANCES UNLESS OTHERWISE SPECIFIED:

- 0 PLC ± -
- 1 PLC ± -
- 2 PLC ± -
- 3 PLC ± -
- 4 PLC ± -
- ANGLES ± -

MATERIAL -

FINISH -

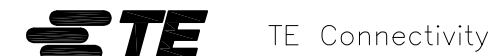

NAME BACKSHELL, 45°, SELF-LOCKING, SHIELD BAND TERMINATION, SHRINK BOOT ADAPTER

SIZE A3 CAGE CODE 06090 DRAWING NO C-R85049/89 RESTRICTED TO -

SCALE NTS SHEET 3 OF 3 REV C



Компания «ЭлектроПласт» предлагает заключение долгосрочных отношений при поставках импортных электронных компонентов на взаимовыгодных условиях!

Наши преимущества:

- Оперативные поставки широкого спектра электронных компонентов отечественного и импортного производства напрямую от производителей и с крупнейших мировых складов;
- Поставка более 17-ти миллионов наименований электронных компонентов;
- Поставка сложных, дефицитных, либо снятых с производства позиций;
- Оперативные сроки поставки под заказ (от 5 рабочих дней);
- Экспресс доставка в любую точку России;
- Техническая поддержка проекта, помощь в подборе аналогов, поставка прототипов;
- Система менеджмента качества сертифицирована по Международному стандарту ISO 9001;
- Лицензия ФСБ на осуществление работ с использованием сведений, составляющих государственную тайну;
- Поставка специализированных компонентов (Xilinx, Altera, Analog Devices, Intersil, Interpoint, Microsemi, Aeroflex, Peregrine, Syfer, Eurofarad, Texas Instrument, Miteq, Cobham, E2V, MA-COM, Hittite, Mini-Circuits, General Dynamics и др.);

Помимо этого, одним из направлений компании «ЭлектроПласт» является направление «Источники питания». Мы предлагаем Вам помощь Конструкторского отдела:

- Подбор оптимального решения, техническое обоснование при выборе компонента;
- Подбор аналогов;
- Консультации по применению компонента;
- Поставка образцов и прототипов;
- Техническая поддержка проекта;
- Защита от снятия компонента с производства.



#### Как с нами связаться

**Телефон:** 8 (812) 309 58 32 (многоканальный)

**Факс:** 8 (812) 320-02-42

**Электронная почта:** [org@eplast1.ru](mailto:org@eplast1.ru)

**Адрес:** 198099, г. Санкт-Петербург, ул. Калинина, дом 2, корпус 4, литера А.