

High-current terminal block - PTPOWER 50-3L/FE-F - 3260059

Please be informed that the data shown in this PDF Document is generated from our Online Catalog. Please find the complete data in the user's documentation. Our General Terms of Use for Downloads are valid (<http://phoenixcontact.com/download>)



High-current terminal block, Blocked, Connection method: Power-Turn connection, Cross section: 10 mm² - 70 mm², AWG: 8 - 2/0, Width: 80 mm, Height: 96 mm, Color: gray/black-yellow, Mounting type: NS 35/15

The figure shows a version of the article

Product Features

- ✓ Quick and easy connection is now also possible for large conductors with the high-current terminal block
- ✓ The Push-in connection terminal blocks are characterized by the system features of the CLIPLINE complete system and by easy and tool-free wiring of conductors with ferrules or solid conductors
- ✓ The compact design enables wiring in a confined space
- ✓ In addition to using the existing test connection, pick-off terminal blocks can be connected, each of which can also accommodate two test cables



Key Commercial Data

| | |
|--------------------------------------|----------|
| Packing unit | 1 pc |
| Minimum order quantity | 3 pc |
| Weight per Piece (excluding packing) | 680.0 g |
| Custom tariff number | 85369010 |
| Country of origin | Poland |

Technical data

General

| | |
|--|--------------------|
| Number of levels | 1 |
| Number of connections | 8 |
| Nominal cross section | 50 mm ² |
| Color | gray/black-yellow |
| Insulating material | PA |
| Flammability rating according to UL 94 | V0 |
| Rated surge voltage | 8 kV |
| Degree of pollution | 3 |

High-current terminal block - PTPOWER 50-3L/FE-F - 3260059

Technical data

General

| | |
|----------------------------------|---|
| Overvoltage category | III |
| Insulating material group | I |
| Connection in acc. with standard | IEC 60947-7-1 |
| Maximum load current | 150 A (with 50 mm ² conductor cross section) |
| Nominal current I _N | 150 A |
| Nominal voltage U _N | 1500 V |
| Open side panel | No |

Dimensions

| | |
|--------------------|-----------|
| Width | 80 mm |
| Length | 101 mm |
| Height | 96 mm |
| Hole diameter | 6.5 mm |
| Drill hole spacing | 123.40 mm |

Connection data

| | |
|--|-----------------------|
| Connection method | Power-Turn connection |
| Connection in acc. with standard | IEC 60947-7-1 |
| Conductor cross section solid min. | 10 mm ² |
| Conductor cross section solid max. | 70 mm ² |
| Conductor cross section AWG min. | 8 |
| Conductor cross section AWG max. | 2/0 |
| Conductor cross section flexible min. | 10 mm ² |
| Conductor cross section flexible max. | 70 mm ² |
| Min. AWG conductor cross section, flexible | 8 |
| Max. AWG conductor cross section, flexible | 2/0 |
| Conductor cross section flexible, with ferrule without plastic sleeve min. | 10 mm ² |
| Conductor cross section flexible, with ferrule without plastic sleeve max. | 50 mm ² |
| Conductor cross section flexible, with ferrule with plastic sleeve min. | 10 mm ² |
| Conductor cross section flexible, with ferrule with plastic sleeve max. | 50 mm ² |
| Cross section with insertion bridge solid min. | 10 mm ² |
| Cross section with insertion bridge, solid max. | 50 mm ² |
| Cross section with insertion bridge stranded min. | 10 mm ² |
| Cross section with insertion bridge, stranded max. | 50 mm ² |
| Cross section with insertion bridge stranded, with ferrule without plastic sleeve min. | 10 mm ² |
| Cross section with insertion bridge stranded, with ferrule without plastic sleeve max. | 50 mm ² |

High-current terminal block - PTPOWER 50-3L/FE-F - 3260059

Technical data

Connection data

| | |
|---|--------------------|
| Cross section with insertion bridge stranded, with ferrule without plastic sleeve min. | 10 mm ² |
| Cross section with insertion bridge stranded, with ferrule with plastic sleeve max. | 50 mm ² |
| 2 conductors with same cross section, stranded, TWIN ferrules with plastic sleeve, min. | 10 mm ² |
| 2 conductors with same cross section, stranded, TWIN ferrules with plastic sleeve, max. | 16 mm ² |
| Cross section with insertion bridge, solid max. | 50 mm ² |
| Cross section with insertion bridge, stranded max. | 50 mm ² |
| Stripping length | 30 mm |
| Internal cylindrical gage | A10 |

Standards and Regulations

| | |
|--|---------------|
| Connection in acc. with standard | IEC 60947-7-1 |
| Flammability rating according to UL 94 | V0 |

Classifications

eCl@ss

| | |
|------------|----------|
| eCl@ss 5.1 | 27141120 |
| eCl@ss 6.0 | 27141120 |
| eCl@ss 8.0 | 27141120 |
| eCl@ss 9.0 | 27141120 |

ETIM

| | |
|----------|----------|
| ETIM 5.0 | EC000897 |
|----------|----------|

Approvals

Approvals

Approvals

CSA / UL Recognized / cUL Recognized / cULus Recognized

Ex Approvals

Approvals submitted

High-current terminal block - PTPOWER 50-3L/FE-F - 3260059

Approvals

Approval details

| | | |
|--------------------------------|-------|--------|
| CSA | | |
| | B | C |
| mm ² /AWG/kcmil | 8-1/0 | 8-1/0 |
| Nominal current I _N | 140 A | 140 A |
| Nominal voltage U _N | 600 V | 1000 V |

| | |
|--------------------------------|--------|
| UL Recognized | |
| | C |
| mm ² /AWG/kcmil | 8-1/0 |
| Nominal current I _N | 140 A |
| Nominal voltage U _N | 1000 V |

| | |
|--------------------------------|--------|
| cUL Recognized | |
| | C |
| mm ² /AWG/kcmil | 8-1/0 |
| Nominal current I _N | 140 A |
| Nominal voltage U _N | 1000 V |

| | |
|------------------|--|
| cULus Recognized | |
|------------------|--|

Drawings

High-current terminal block - PTPOWER 50-3L/FE-F - 3260059

Circuit diagram



Dimensional drawing

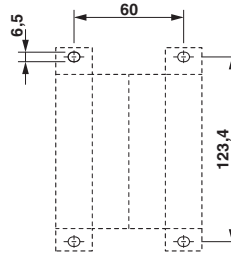



Компания «ЭлектроПласт» предлагает заключение долгосрочных отношений при поставках импортных электронных компонентов на взаимовыгодных условиях!

Наши преимущества:

- Оперативные поставки широкого спектра электронных компонентов отечественного и импортного производства напрямую от производителей и с крупнейших мировых складов;
- Поставка более 17-ти миллионов наименований электронных компонентов;
- Поставка сложных, дефицитных, либо снятых с производства позиций;
- Оперативные сроки поставки под заказ (от 5 рабочих дней);
- Экспресс доставка в любую точку России;
- Техническая поддержка проекта, помощь в подборе аналогов, поставка прототипов;
- Система менеджмента качества сертифицирована по Международному стандарту ISO 9001;
- Лицензия ФСБ на осуществление работ с использованием сведений, составляющих государственную тайну;
- Поставка специализированных компонентов (Xilinx, Altera, Analog Devices, Intersil, Interpoint, Microsemi, Aeroflex, Peregrine, Syfer, Eurofarad, Texas Instrument, Miteq, Cobham, E2V, MA-COM, Hittite, Mini-Circuits, General Dynamics и др.);

Помимо этого, одним из направлений компании «ЭлектроПласт» является направление «Источники питания». Мы предлагаем Вам помощь Конструкторского отдела:

- Подбор оптимального решения, техническое обоснование при выборе компонента;
- Подбор аналогов;
- Консультации по применению компонента;
- Поставка образцов и прототипов;
- Техническая поддержка проекта;
- Защита от снятия компонента с производства.



Как с нами связаться

Телефон: 8 (812) 309 58 32 (многоканальный)

Факс: 8 (812) 320-02-42

Электронная почта: org@eplast1.ru

Адрес: 198099, г. Санкт-Петербург, ул. Калинина, дом 2, корпус 4, литера А.