



Choose one component from each of the colored sections to assemble a complete switch.
For other options or further information please contact EAO Switch directly.

Product Profile

The Series 22 is a high quality switch range that includes pushbuttons, indicators, mushroom headed switches and key switches.

Options include:

Technical drawings see page 39

- IP65 Protection
- Switch Rating, 10A, 400VAC/DC
- Self cleaning snap-action switching elements.
- Mounting into 22 x 30mm cut out
- Illumination using T-1^{3/4} Lamps or LED's
- The standard lenses are available in many different versions, transparent, opaque or translucent
- Screw terminal or plug-in connections

Indicator



Indicator body raised, rectangular, black plastic

Part No.
22-040.001

Illuminated pushbutton



Illuminated pushbutton actuator, raised, rectangular, black plastic, screw terminals

Part No.	Action	Contact type
22-211.011	Momentary	1NO
22-212.011	Momentary	1NC
22-213.011	Momentary	2NO
22-214.011	Momentary	2NC
22-215.011	Momentary	1NO/1NC
22-221.011	Maintained	1NO
22-222.011	Maintained	1NC
22-223.011	Maintained	2NO
22-224.011	Maintained	2NC
22-225.011	Maintained	1NO/1NC

For complete switch also order **A**

For complete switch also order **A**

Keylock switch



Keylock switch actuator, 2 position raised, rectangular, screw terminals

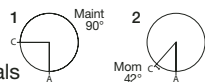

Drawing	Part No.	Contact type	Key rem.
1	22-331.111D	1NO	A
1	22-331.311D	1NO	C
1	22-331.511D	1NO	A+C
1	22-333.111D	2NO	A
1	22-333.311D	2NO	C
1	22-333.511D	2NO	A+C
1	22-335.111D	1NC/1NO	A
1	22-335.311D	1NC/1NO	C
1	22-335.511D	1NC/1NO	A+C
2	22-351.111D	1NO	A
2	22-353.111D	2NO	A
2	22-355.111D	1NC/1NO	A

LED



LED, T-1 3/4 MG, single chip, 12 Volt and 28 Volt. Also available in 6 Volt, 24 Volt and 48 Volt.

Color	Part No.	Voltage
Red	10-2J09.1062	12VAC/DC, 7/14mA
Yellow	10-2J09.1064	12VAC/DC, 7/14mA
Green	10-2J09.1065	12VAC/DC, 4/7mA
Blue	10-2J09.1066	12VAC/DC, 7/14mA
White	10-2J09.1069	12VAC/DC, 7/14mA
Red	10-2J13.1062	28VAC/DC, 7/14mA
Yellow	10-2J13.1064	28VAC/DC, 7/14mA
Green	10-2J13.1065	28VAC/DC, 4/7mA
Blue	10-2J13.1066	28VAC/DC, 7/14mA
White	10-2J13.1069	28VAC/DC, 7/14mA

Accessories



Translucent lens, flat with white translucent diffuser for rectangular indicator and pushbutton actuators



Color	Part No.
Red	22-901.2
Yellow	22-901.4
Green	22-901.5
Blue	22-901.6
White	22-901.9

For complete switch also order **A**



Choose one component from each of the colored sections to assemble a complete switch.
For other options or further information please contact EAO Switch directly.



A Accessories

																																																																		
<p>Lens, opaque for rectangular pushbutton actuators, not for illumination</p>	<p>Transparent lens, flat with white translucent diffuser for rectangular indicator and pushbutton actuators</p>	<p>Transparent lens, flat with white translucent diffuser for rectangular indicator and pushbutton actuators</p>																																																																
<table border="1"> <thead> <tr> <th>Color</th> <th>Part No.</th> </tr> </thead> <tbody> <tr> <td>● Grey</td> <td>22-901.8</td> </tr> <tr><td> </td><td> </td></tr> <tr><td> </td><td> </td></tr> <tr><td> </td><td> </td></tr> <tr><td> </td><td> </td></tr> <tr><td> </td><td> </td></tr> <tr><td> </td><td> </td></tr> <tr><td> </td><td> </td></tr> <tr><td> </td><td> </td></tr> <tr><td> </td><td> </td></tr> </tbody> </table>	Color	Part No.	● Grey	22-901.8																			<table border="1"> <thead> <tr> <th>Color</th> <th>Part No.</th> </tr> </thead> <tbody> <tr> <td>● Red</td> <td>22-903.2</td> </tr> <tr> <td>● Yellow</td> <td>22-903.4</td> </tr> <tr> <td>● Green</td> <td>22-903.5</td> </tr> <tr> <td>● Blue</td> <td>22-903.6</td> </tr> <tr> <td>○ Clear</td> <td>22-903.7</td> </tr> <tr><td> </td><td> </td></tr> <tr><td> </td><td> </td></tr> <tr><td> </td><td> </td></tr> <tr><td> </td><td> </td></tr> <tr><td> </td><td> </td></tr> </tbody> </table>	Color	Part No.	● Red	22-903.2	● Yellow	22-903.4	● Green	22-903.5	● Blue	22-903.6	○ Clear	22-903.7											<table border="1"> <thead> <tr> <th>Color</th> <th>Part No.</th> </tr> </thead> <tbody> <tr> <td>● Red</td> <td>22-905.2</td> </tr> <tr> <td>● Yellow</td> <td>22-905.4</td> </tr> <tr> <td>● Green</td> <td>22-905.5</td> </tr> <tr> <td>○ Clear</td> <td>22-905.7</td> </tr> <tr><td> </td><td> </td></tr> <tr><td> </td><td> </td></tr> <tr><td> </td><td> </td></tr> <tr><td> </td><td> </td></tr> <tr><td> </td><td> </td></tr> </tbody> </table>	Color	Part No.	● Red	22-905.2	● Yellow	22-905.4	● Green	22-905.5	○ Clear	22-905.7										
Color	Part No.																																																																	
● Grey	22-901.8																																																																	
Color	Part No.																																																																	
● Red	22-903.2																																																																	
● Yellow	22-903.4																																																																	
● Green	22-903.5																																																																	
● Blue	22-903.6																																																																	
○ Clear	22-903.7																																																																	
Color	Part No.																																																																	
● Red	22-905.2																																																																	
● Yellow	22-905.4																																																																	
● Green	22-905.5																																																																	
○ Clear	22-905.7																																																																	

A Accessories

																																																												
<p>Mushroom head cap, not for illumination, opaque, red</p>	<p>Front bezel flat and raised, black plastic</p>	<p>Flap guard, raised, rectangular</p>																																																										
<table border="1"> <thead> <tr> <th>Part No.</th> </tr> </thead> <tbody> <tr> <td>22-930.2</td> </tr> <tr><td> </td></tr> <tr><td> </td></tr> <tr><td> </td></tr> <tr><td> </td></tr> <tr><td> </td></tr> <tr><td> </td></tr> <tr><td> </td></tr> <tr><td> </td></tr> <tr><td> </td></tr> </tbody> </table>	Part No.	22-930.2										<table border="1"> <thead> <tr> <th>Image</th> <th>Part No.</th> <th>Product description</th> </tr> </thead> <tbody> <tr> <td>1</td> <td>02-965.0</td> <td>Front bezel flat</td> </tr> <tr> <td>2</td> <td>02-967.0</td> <td>Front bezel raised</td> </tr> <tr><td> </td><td> </td><td> </td></tr> <tr><td> </td><td> </td><td> </td></tr> <tr><td> </td><td> </td><td> </td></tr> <tr><td> </td><td> </td><td> </td></tr> <tr><td> </td><td> </td><td> </td></tr> <tr><td> </td><td> </td><td> </td></tr> <tr><td> </td><td> </td><td> </td></tr> <tr><td> </td><td> </td><td> </td></tr> <tr><td> </td><td> </td><td> </td></tr> </tbody> </table> <p>Must be ordered to complete switch/indicator</p>	Image	Part No.	Product description	1	02-965.0	Front bezel flat	2	02-967.0	Front bezel raised																												<table border="1"> <thead> <tr> <th>Part No.</th> </tr> </thead> <tbody> <tr> <td>22-925</td> </tr> <tr><td> </td></tr> <tr><td> </td></tr> <tr><td> </td></tr> <tr><td> </td></tr> <tr><td> </td></tr> <tr><td> </td></tr> <tr><td> </td></tr> <tr><td> </td></tr> <tr><td> </td></tr> </tbody> </table>	Part No.	22-925									
Part No.																																																												
22-930.2																																																												
Image	Part No.	Product description																																																										
1	02-965.0	Front bezel flat																																																										
2	02-967.0	Front bezel raised																																																										
Part No.																																																												
22-925																																																												



Choose one component from each of the colored sections to assemble a complete switch.
For other options or further information please contact EAO Switch directly.

A Accessories



Blanking plate



Lens remover for flat bezel, lens remover for raised bezel and LED and lamp remover

Part No.	Image	Part No.	Product description
22-949.0	1	02-905	Lens remover for flat bezel
	2	98-968	Lens remover for raised bezel
	3	51-996	LED remover
	4	02-906	Lamp remover



22 Indicator

Raised

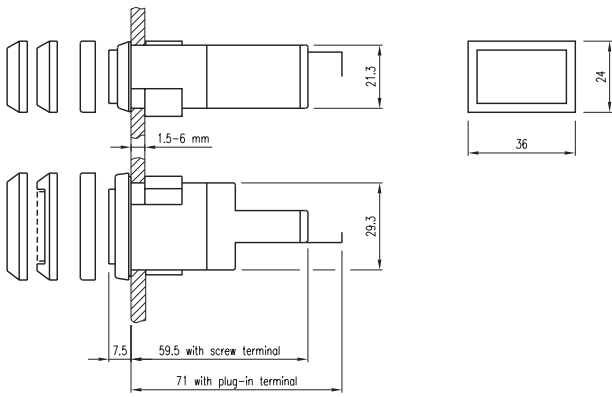

22 Pushbutton

Illuminated, Raised

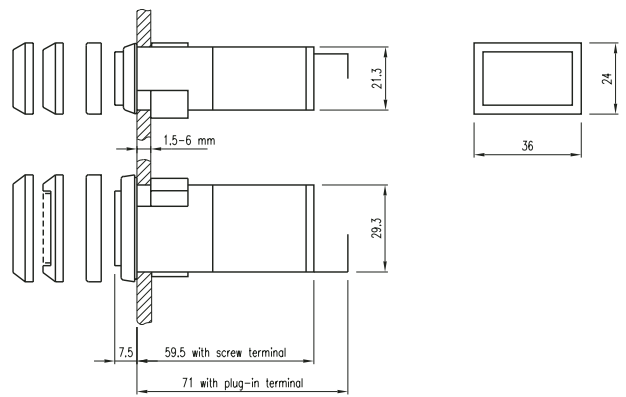

22 Keylock

2-Position, Raised

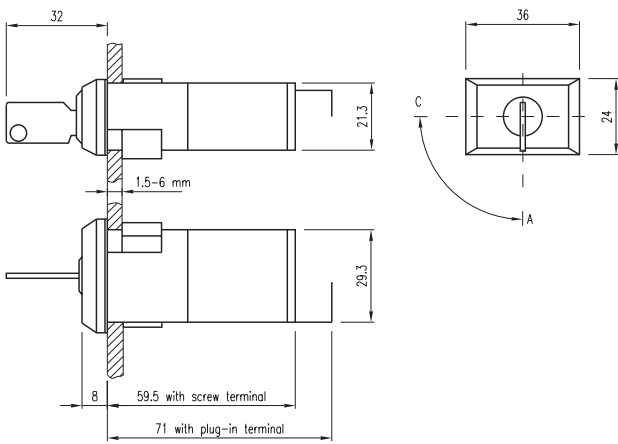

22 Cut-outs

For all Series 22

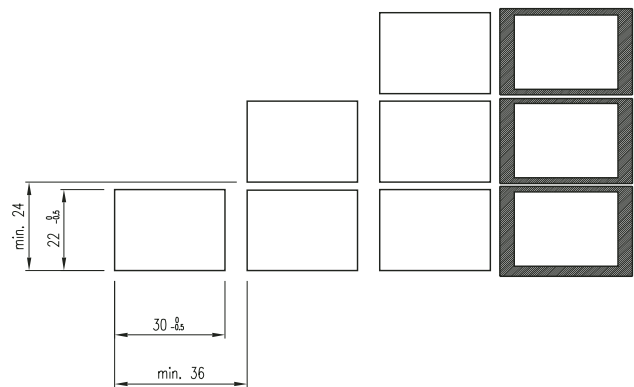



Компания «ЭлектроПласт» предлагает заключение долгосрочных отношений при поставках импортных электронных компонентов на взаимовыгодных условиях!

Наши преимущества:

- Оперативные поставки широкого спектра электронных компонентов отечественного и импортного производства напрямую от производителей и с крупнейших мировых складов;
- Поставка более 17-ти миллионов наименований электронных компонентов;
- Поставка сложных, дефицитных, либо снятых с производства позиций;
- Оперативные сроки поставки под заказ (от 5 рабочих дней);
- Экспресс доставка в любую точку России;
- Техническая поддержка проекта, помощь в подборе аналогов, поставка прототипов;
- Система менеджмента качества сертифицирована по Международному стандарту ISO 9001;
- Лицензия ФСБ на осуществление работ с использованием сведений, составляющих государственную тайну;
- Поставка специализированных компонентов (Xilinx, Altera, Analog Devices, Intersil, Interpoint, Microsemi, Aeroflex, Peregrine, Syfer, Eurofarad, Texas Instrument, Miteq, Cobham, E2V, MA-COM, Hittite, Mini-Circuits, General Dynamics и др.);

Помимо этого, одним из направлений компании «ЭлектроПласт» является направление «Источники питания». Мы предлагаем Вам помощь Конструкторского отдела:

- Подбор оптимального решения, техническое обоснование при выборе компонента;
- Подбор аналогов;
- Консультации по применению компонента;
- Поставка образцов и прототипов;
- Техническая поддержка проекта;
- Защита от снятия компонента с производства.



Как с нами связаться

Телефон: 8 (812) 309 58 32 (многоканальный)

Факс: 8 (812) 320-02-42

Электронная почта: org@eplast1.ru

Адрес: 198099, г. Санкт-Петербург, ул. Калинина, дом 2, корпус 4, литера А.