

Overview

The C4G Series is a polypropylene metallized film with polyester tape wrapping filled with resin and tinned copper wires.

Applications

Typical applications include clamping, blocking, coupling/decoupling, AC harmonic filtering and low power.

Benefits

- Self-healing
- Low losses
- High ripple current
- High contact reliability
- Suitable for high frequency applications
- PP metallized

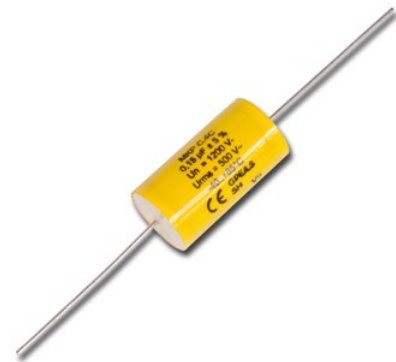

Part Number System

C4	G	A	D	U	B	4100	AA	4	J
Series	Type	Fire Protection	Rated Voltage (VDC)	Insulation	Lead Diameter (mm)	Capacitance Code (pF)	Lead and Packaging Code	Capacitor Length (mm)	Tolerance
C4 = MKP capacitors	G = Round body, switching application	A = No fire retardant S = Fire retardant (on request)	D = 250 F = 400 H = 600 J = 700 M = 850	U = Polyester tape & resin protection 0 = Uninsulated (on request)	B = 0.8 C = 1.0 D = 1.2	Digits 2 – 4 indicate the first three digits of the capacitance value. First digit indicates the number of zeros to be added.	AA (Standard)	4 = 20.5 5 = 28 0 = 33 1 = 44 3 = 58	J = 5% K = 10%

Dimensions – Millimeters

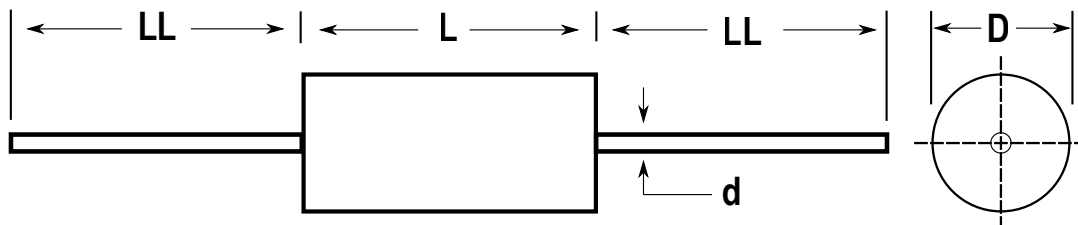

D	L	d	LL
Maximum	Maximum	Nominal	± 5
11	20.5	0.8	40
9.5	28	0.8	40
10 – 13	33	0.8	40
13.5 – 20.5	33	1	40
18 – 22.5	44	1	40
23.5 – 33	44	1.2	40
28 – 35	58	1.2	40

Qualification

Reference Standards	VDE 0560, IEC 61071, EN 61071
Application Class (DIN 40040)	GPE/LS
Vibration Strength	DIN 40040, Table 6, Class V

Performance Characteristics

Temperature Range	-40°C to +85°C
Maximum Permissible Ambient Temperature	+70°C
IEC Climatic Category	40/85/56 according to IEC 68-1
Peak Non-Repetitive Maximum Current	$I_{PKR} \times 1.5$
Test Voltage Terminal to Terminal (VTT)	2 V_n for 10 seconds
Test Voltage Terminal to Case (VTC)	3 k VDC 50 Hz for 60 seconds
Insulation Resistance Test Conditions	Temperature: +25°C ±5% Voltage charge time: 1 minute Test voltage: 100 VDC Typical value ($R_{is} \times C$): 3,000 seconds
Dissipation Factor (DF)	$\leq 5 \times 10^{-4}$ at 1 kHz and 20°C
Capacitance Deviation in Operating Temperature Range of -40°C to +85°C	±1.5% maximum on capacitance value measured at +20°C
Life Expectancy	$\geq 30,000$ hours at V_{RMS} , $\geq 100,000$ hours at V_n
Failure Quota	300/10 ⁹ components per hour
Change of Capacitance vs. Operating Time	-3% after 30,000 hours at V_{RMS} or after 100,000 hours at V_n
Protection	Polyester wrapping with epoxy resin fill
Flame Retardant (IEC 384-1)	Standard execution: non-flame retardant On request: flame retardant execution Category C
Leads	Tinned copper (lead content = 5%)
Installation	Any position
Damp Heat Test	Test Conditions
	Relative humidity: 93% ± 2%
	Temperature: +40°C
	Test duration: 56 days
	Capacitance change: $\leq \pm 5\%$
	DF change: $\leq 50\%$ of nominal value at 1 kHz
	Insulation resistance: $\geq 50\%$ of limit value

Table 1 – Ratings & Part Number Reference

Cap Value (μ F)	VDC	VAC	Peak VDC	Maximum Dimensions (mm)		Ripple Current 100 kHz 70°C (A)	Peak Current (A)	ESR (Maximum) 100 kHz (m Ω)	dV/dt (V/ μ s)	Packaging Quantity	Part Number
				D	L						
1	250	160	400	11	20.5	6	60	6.7	60	500	C4G(1)D(2)B4100AA4(3)
2.2	250	160	400	11.5	33	6	66	10.9	30	300	C4G(1)D(2)B4220AA0(3)
2.5	250	160	400	12	33	7	75	9.8	30	300	C4G(1)D(2)B4250AA0(3)
3	250	160	400	13.5	33	8	90	8.2	30	250	C4G(1)D(2)C4300AA0(3)
3.3	250	160	400	14	33	9	99	7.5	30	250	C4G(1)D(2)C4330AA0(3)
4	250	160	400	15.5	33	9	120	6.4	30	200	C4G(1)D(2)C4400AA0(3)
5	250	160	400	17	33	9	150	5.4	30	150	C4G(1)D(2)C4500AA0(3)
6.8	250	160	400	19.5	33	9	204	4.4	30	100	C4G(1)D(2)C4680AA0(3)
10	250	160	400	20	44	9	200	5.3	20	100	C4G(1)D(2)C5100AA1(3)
15	250	160	400	24.5	44	12	300	3.9	20	50	C4G(1)D(2)D5150AA1(3)
20	250	160	400	28	44	12	400	3.4	20	50	C4G(1)D(2)D5200AA1(3)
25	250	160	400	31	44	12	500	3.1	20	50	C4G(1)D(2)D5250AA1(3)
30	250	160	400	29	58	12	450	4	15	30	C4G(1)D(2)D5300AA3(3)
40	250	160	400	33.5	58	12	600	3.5	15	30	C4G(1)D(2)D5400AA3(3)
0.47	400	250	600	9.5	28	6	28	11.1	60	600	C4G(1)F(2)B3470AA5(3)
0.68	400	250	600	10	33	6	31	11.7	45	400	C4G(1)F(2)B3680AA0(3)
1	400	250	600	12	33	7	45	8.3	45	300	C4G(1)F(2)B4100AA0(3)
1.5	400	250	600	14.5	33	9	68	5.8	45	200	C4G(1)F(2)C4150AA0(3)
2	400	250	600	16.5	33	9	90	4.7	45	200	C4G(1)F(2)C4200AA0(3)
2.2	400	250	600	17.5	33	9	99	4.4	45	150	C4G(1)F(2)C4220AA0(3)
2.5	400	250	600	18.5	33	9	113	4	45	150	C4G(1)F(2)C4250AA0(3)
3	400	250	600	20	33	9	135	3.6	45	100	C4G(1)F(2)C4300AA0(3)
3.3	400	250	600	18	44	9	99	5.2	30	100	C4G(1)F(2)C4330AA1(3)
4	400	250	600	19.5	44	9	120	4.6	30	100	C4G(1)F(2)C4400AA1(3)
4.7	400	250	600	21	44	9	141	4.1	30	100	C4G(1)F(2)C4470AA1(3)
5	400	250	600	21.5	44	9	150	4	30	100	C4G(1)F(2)C4500AA1(3)
6.8	400	250	600	25	44	12	204	3.2	30	50	C4G(1)F(2)D4680AA1(3)
10	400	250	600	30	44	12	300	2.7	30	50	C4G(1)F(2)D5100AA1(3)
15	400	250	600	31.5	58	12	300	4.8	20	30	C4G(1)F(2)D5150AA3(3)
20	400	250	600	35	58	12	400	4	20	30	C4G(1)F(2)D5200AA3(3)
0.47	600	330	800	11	33	6	28	13.1	60	300	C4G(1)H(2)B3470AA0(3)
0.68	600	330	800	13	33	7	41	9.4	60	300	C4G(1)H(2)B3680AA0(3)
1	600	330	800	15.5	33	9	60	6.6	60	200	C4G(1)H(2)C4100AA0(3)
2	600	330	800	18.5	44	9	80	6.3	40	100	C4G(1)H(2)C4200AA1(3)
2.2	600	330	800	19.5	44	9	88	5.2	40	100	C4G(1)H(2)C4220AA1(3)
3	600	330	800	22.5	44	9	120	4.8	40	70	C4G(1)H(2)C4300AA1(3)
3.3	600	330	800	23.5	44	12	132	4.3	40	70	C4G(1)H(2)D4330AA1(3)
4	600	330	800	25.5	44	12	160	3.8	40	50	C4G(1)H(2)D4400AA1(3)
4.7	600	330	800	27.5	44	12	188	3.5	40	50	C4G(1)H(2)D4470AA1(3)
5	600	330	800	28.5	44	12	200	3.4	40	50	C4G(1)H(2)D4500AA1(3)
6.8	600	330	800	28.5	58	12	204	6.8	30	30	C4G(1)H(2)D4680AA3(3)
10	600	330	800	34.5	58	12	300	5.3	30	30	C4G(1)H(2)D5100AA3(3)
0.47	700	400	1000	14.5	33	8	38	9.5	80	200	C4G(1)J(2)C3470AA0(3)
0.68	700	400	1000	17	33	9	55	7	80	150	C4G(1)J(2)C3680AA0(3)
1	700	400	1000	20.5	33	9	80	5.2	80	100	C4G(1)J(2)C4100AA0(3)
1.5	700	400	1000	20.5	44	9	90	6.4	60	100	C4G(1)J(2)C4150AA1(3)
2	700	400	1000	23.5	44	12	120	5	60	70	C4G(1)J(2)D4200AA1(3)
2.2	700	400	1000	24.5	44	12	132	4.7	60	50	C4G(1)J(2)D4220AA1(3)
3	700	400	1000	28.5	44	12	180	3.9	60	50	C4G(1)J(2)D4300AA1(3)
3.3	700	400	1000	30	44	12	198	3.7	60	50	C4G(1)J(2)D4330AA1(3)
4	700	400	1000	33	44	12	240	3.5	60	50	C4G(1)J(2)D4400AA1(3)
4.7	700	400	1000	29.5	58	12	188	7.9	40	30	C4G(1)J(2)D4470AA3(3)
5	700	400	1000	30.5	58	12	200	7.5	40	30	C4G(1)J(2)D4500AA3(3)
6.8	700	400	1000	35	58	12	272	6.1	40	30	C4G(1)J(2)D4680AA3(3)
Capacitance Value (μ F)	VDC	VAC	D (mm)	D (mm)	L (mm)	Ripple Current	Peak Current	ESR	dV/dt (V/ μ s)	Packaging Quantity	Part Number

(1) A = No fire retardant; S = fire retardant (on request)

(2) U = Tape and resin protection; 0 = unprotected (on request)

(3) K = $\pm 10\%$, J = $\pm 5\%$

Table 1 – Ratings & Part Number Reference cont'd

Cap Value (μF)	VDC	VAC	Peak VDC	Maximum Dimensions (mm)		Ripple Current 100 kHz 70°C (A)	Peak Current (A)	ESR (Maximum) 100 kHz (m Ω)	dV/dt (V/ μs)	Packaging Quantity	Part Number
				D	L						
0.15	850	450	1200	10	33	5	32	14.5	210	400	C4G(1)M(2)B3150AA0(3)
0.22	850	450	1200	12	33	7	46	10.3	210	300	C4G(1)M(2)B3220AA0(3)
0.33	850	450	1200	14.5	33	9	69	7.1	210	200	C4G(1)M(2)C3330AA0(3)
0.47	850	450	1200	17	33	9	99	5.4	210	150	C4G(1)M(2)C3470AA0(3)
0.68	850	450	1200	20.5	33	9	143	4.2	210	100	C4G(1)M(2)C3680AA0(3)
1	850	450	1200	20.5	44	9	140	4.7	140	100	C4G(1)M(2)C4100AA1(3)
1.5	850	450	1200	24.5	44	12	210	3.5	140	70	C4G(1)M(2)D4150AA1(3)
2	850	450	1200	28.5	44	12	280	3.1	140	50	C4G(1)M(2)D4200AA1(3)
2.2	850	450	1200	29.5	44	12	308	3	140	50	C4G(1)M(2)D4220AA1(3)
2.5	850	450	1200	31.5	44	12	350	2.9	140	50	C4G(1)M(2)D4250AA1(3)
3	850	450	1200	28	58	12	270	3.6	90	30	C4G(1)M(2)D4300AA3(3)
3.3	850	450	1200	29.5	58	12	297	3.5	90	30	C4G(1)M(2)D4330AA3(3)
4	850	450	1200	32.5	58	12	360	3.2	90	30	C4G(1)M(2)D4400AA3(3)
Capacitance Value (μF)	VDC	VAC	D (mm)	D (mm)	L (mm)	Ripple Current	Peak Current	ESR	dV/dt (V/ μs)	Packaging Quantity	Part Number

(1) A = No fire retardant; S = fire retardant (on request)

(2) U = Tape and resin protection; 0 = unprotected (on request)

(3) K = $\pm 10\%$, J = $\pm 5\%$

Environmental Compliance

As an environmentally conscious company, KEMET is working continuously with improvements concerning the environmental effects of both our capacitors and the production of them.



RoHS Compliant

In Europe (RoHS Directive) and in some other geographical areas like China, legislation has been put in place to prevent the use of some hazardous materials, like Lead (Pb), in electronic equipment. All products in this catalog are produced to help our customers' obligations to guarantee their products to fulfill these legislative requirements. The only material of concern in our products has been Lead (Pb), which has been removed from all designs to fulfill the requirement of containing less than 0.1% of Lead in any homogeneous material.

KEMET will closely follow any changes in legislation world wide and makes any necessary changes in its products, whenever needed. Some customer segments like Medical, Military and Automotive Electronics may still require the use of Lead in electrode coatings. To clarify the situation and distinguish products from each other, a special symbol is used on the packaging labels for RoHS compatible capacitors.

Because of customer requirements there may appear additional markings like LF = Lead Free or LFW = Lead Free Wires on the label.

Materials & Environment

The selection of materials used by KEMET for the production of capacitors is the result of extensive experience and constant attention to environmental protection. KEMET selects its suppliers according to ISO 9001 standards and carries out statistical analysis on the materials purchased before acceptance. All materials are, to the company's present knowledge, non-toxic and free from Cadmium, Mercury, Chrome and compounds, PCB (Polychlorine Triphenyl), Bromide and Chlorine Dioxins Bromurate Chlorurate, CFC and HCFC and Asbestos.

Green Products

All KEMET power film products are ROHS Compliant.

Insulation Resistance

When the capacitor temperature increases, the insulation resistance decreases. This is due to increased electron activity. Low insulation resistance can also be the result of moisture trapped in the windings, caused by a prolonged exposure to excessive humidity.

Dissipation Factor

Dissipation factor is a complex function involved with the inefficiency of the capacitor. The $\tan \delta$ may change up and down with increased temperature. For more information, please refer to Performance Characteristics.

Sealing

Hermetically Sealed Capacitors

When the temperature increases, the pressure inside the capacitor increases. If the internal pressure is high enough, it can cause a breach in the capacitor which can result in leakage, impregnation, filling fluid or moisture susceptibility.

Resin Encased/Wrap & Fill Capacitors

The resin seals on resin encased and wrap and fill capacitors will withstand short-term exposure to high humidity environments without degradation. Resins and plastic tapes will form a pseudo-impervious barrier to humidity and chemicals. These case materials are somewhat porous and through osmosis can cause contaminants to enter the capacitor. The second area of contaminated absorption is the lead-wire/resin interface. Since resins cannot bond 100% to tinned wires, there can be a path formed up to the lead wire into the capacitor section. Aqueous cleaning of circuit boards can aggravate this condition.

Barometric Pressure

The altitude at which hermetically sealed capacitors are operated controls the voltage rating of the capacitor. As the barometric pressure decreases, the susceptibility to terminal arc-over increases. Non-hermetic capacitors can be affected by internal stresses due to pressure changes. This can be in the form of capacitance changes or dielectric arc-over as well as low insulation resistance. Heat transfer can also be affected by altitude operation. Heat generated in operation cannot be dissipated properly and can result in high R12 losses and eventual failure.

Radiation

Radiation capabilities of capacitors must be taken into consideration. Electrical degradation in the form of dielectric embitterment can take place causing shorts or opens.

Soldering Process

The implementation of the RoHS Directive has required the selection SnAgCu (SAC) alloys or SnCu alloys as primary solder. This has increased the liquidus temperature from that of 183°C for SnPb eutectic alloy to 217°C – 221°C for the new alloys. As a result, the heat stress to components, even in wave soldering, has increased considerably due to higher pre-heat and wave temperatures. Polypropylene capacitors are especially sensitive to heat (melting point of polypropylene is 160°C – 170°C). Wave soldering can be destructive especially for mechanically small polypropylene capacitors (lead spacings 5 – 10 mm) and great care must be taken during soldering. The solder profiles from KEMET are highly recommended. You may also refer to the wave soldering curve from IEC Publication 61760 – 1 Edition 2. Please consult KEMET with any questions.

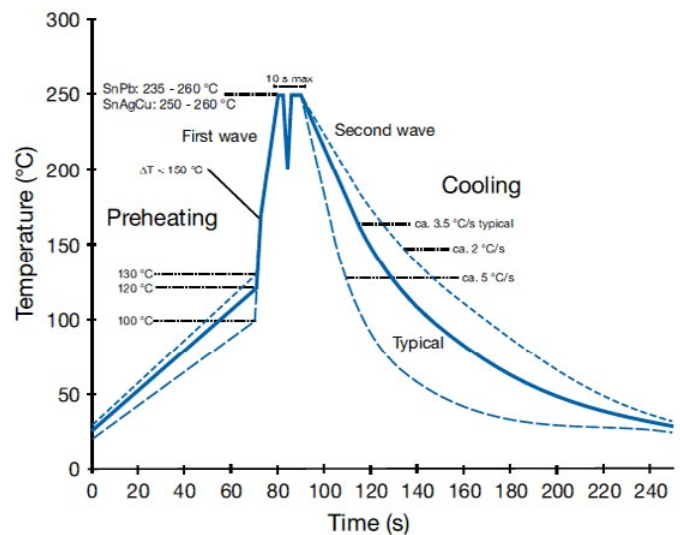

**KEMET Corporation
World Headquarters**

2835 KEMET Way
Simpsonville, SC 29681

Mailing Address:
P.O. Box 5928
Greenville, SC 29606

www.kemet.com
Tel: 864-963-6300
Fax: 864-963-6521

Corporate Offices
Fort Lauderdale, FL
Tel: 954-766-2800

North America**Southeast**

Lake Mary, FL
Tel: 407-855-8886

Northeast

Wilmington, MA
Tel: 978-658-1663

Central

Novi, MI
Tel: 248-306-9353

West

Milpitas, CA
Tel: 408-433-9950

Mexico

Guadalajara, Jalisco
Tel: 52-33-3123-2141

Europe**Southern Europe**

Paris, France
Tel: 33-1-4646-1006

Sasso Marconi, Italy
Tel: 39-051-939111

Central Europe

Landsberg, Germany
Tel: 49-8191-3350800

Kamen, Germany
Tel: 49-2307-438110

Northern Europe

Bishop's Stortford, United Kingdom
Tel: 44-1279-460122

Espoo, Finland
Tel: 358-9-5406-5000

Asia**Northeast Asia**

Hong Kong
Tel: 852-2305-1168

Shenzhen, China
Tel: 86-755-2518-1306

Beijing, China
Tel: 86-10-5829-1711

Shanghai, China
Tel: 86-21-6447-0707

Taipei, Taiwan
Tel: 886-2-27528585

Southeast Asia

Singapore
Tel: 65-6586-1900

Penang, Malaysia
Tel: 60-4-6430200

Bangalore, India
Tel: 91-806-53-76817

Note: KEMET reserves the right to modify minor details of internal and external construction at any time in the interest of product improvement. KEMET does not assume any responsibility for infringement that might result from the use of KEMET Capacitors in potential circuit designs. KEMET is a registered trademark of KEMET Electronics Corporation.

Prototype Sample Disclaimer

The Customer acknowledges the following limitations of the prototype samples:

- (1) Prototype samples are manufactured from preliminary designs and manufacturing processes; may not represent final designs; have not been released for commercial use and are not subject to the same quality control procedures applicable to released products.*
- (2) Prototype samples are not qualified parts and are provided “as-is” by KEMET Electronics Corporation, which specifically disclaims any and all warranties and guarantees, explicit or implied, including, without limitation, the warranties of merchantability and fitness for a particular purpose or use.*
- (3) Prototype samples are not intended for commercial use; are provided for engineering evaluation only and are not recommended for use in the Customer’s production line.*
- (4) The Customer assumes the risk of any and all uses that the Customer makes of the prototype samples.*

General Disclaimer

“All product specifications, statements, information and data given herein are believed to be accurate and reliable, but are presented without guarantee, warranty, or responsibility of any kind, expressed or implied. Statements of suitability for certain applications are based on our knowledge of typical operating conditions for such applications, but are not intended to constitute – and we specifically disclaim – any warranty concerning suitability for a specific customer application or use. This Information is intended for use only by customers who have the requisite experience and capability to determine the correct products for their application.

KEMET’s product warranty is set forth at www.kemet.com under Terms and Conditions of Sale.”



Компания «ЭлектроПласт» предлагает заключение долгосрочных отношений при поставках импортных электронных компонентов на взаимовыгодных условиях!

Наши преимущества:

- Оперативные поставки широкого спектра электронных компонентов отечественного и импортного производства напрямую от производителей и с крупнейших мировых складов;
- Поставка более 17-ти миллионов наименований электронных компонентов;
- Поставка сложных, дефицитных, либо снятых с производства позиций;
- Оперативные сроки поставки под заказ (от 5 рабочих дней);
- Экспресс доставка в любую точку России;
- Техническая поддержка проекта, помощь в подборе аналогов, поставка прототипов;
- Система менеджмента качества сертифицирована по Международному стандарту ISO 9001;
- Лицензия ФСБ на осуществление работ с использованием сведений, составляющих государственную тайну;
- Поставка специализированных компонентов (Xilinx, Altera, Analog Devices, Intersil, Interpoint, Microsemi, Aeroflex, Peregrine, Syfer, Eurofarad, Texas Instrument, Miteq, Cobham, E2V, MA-COM, Hittite, Mini-Circuits, General Dynamics и др.);

Помимо этого, одним из направлений компании «ЭлектроПласт» является направление «Источники питания». Мы предлагаем Вам помощь Конструкторского отдела:

- Подбор оптимального решения, техническое обоснование при выборе компонента;
- Подбор аналогов;
- Консультации по применению компонента;
- Поставка образцов и прототипов;
- Техническая поддержка проекта;
- Защита от снятия компонента с производства.



Как с нами связаться

Телефон: 8 (812) 309 58 32 (многоканальный)

Факс: 8 (812) 320-02-42

Электронная почта: org@eplast1.ru

Адрес: 198099, г. Санкт-Петербург, ул. Калинина, дом 2, корпус 4, литера А.