

A wide variety of products including dust-proof type



TACT Switch™

Sharp Feeling

Soft Feeling

Snap-in Type

Surface Mount Type

Radial Type

Typical Specifications

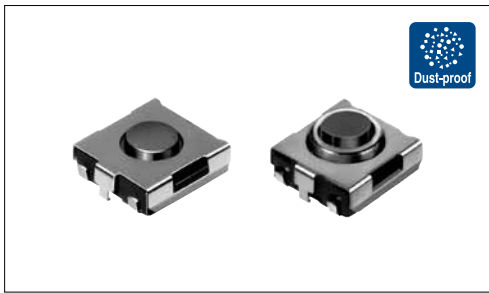

| Items                      | Specifications     |
|----------------------------|--------------------|
| Rating (max.)              | 50mA 12V DC        |
| Rating (min.)              | 10 $\mu$ A 1V DC   |
| Initial contact resistance | 100m $\Omega$ max. |
| Travel (mm)                | 0.25               |

Product Line

Top push type

| Product No. | Operating force | Operating direction | Operating life (5mA 5V DC) | Stem color | Height | Minimum order unit (pcs.) |        | Drawing No. |
|-------------|-----------------|---------------------|----------------------------|------------|--------|---------------------------|--------|-------------|
|             |                 |                     |                            |            |        | Japan                     | Export |             |
| SKHUAKE010  | 0.98N           | Top push            | 300,000 cycles             | Green      | 2.5mm  | 3,000                     | 3,000  | 1           |
| SKHUALE010  | 1.57N           |                     |                            | Black      |        |                           |        |             |
| SKHUAME010  | 2.55N           |                     | 100,000 cycles             | Red        |        |                           |        |             |

With ground terminal type

| Product No. | Operating force | Operating direction | Operating life (5mA 5V DC) | Stem color | Height | Minimum order unit (pcs.) |        | Drawing No. |
|-------------|-----------------|---------------------|----------------------------|------------|--------|---------------------------|--------|-------------|
|             |                 |                     |                            |            |        | Japan                     | Export |             |
| SKHUPKE010  | 0.98N           | Top push            | 300,000 cycles             | Green      | 2.5mm  | 3,000                     | 3,000  | 2           |
| SKHUPLE010  | 1.57N           |                     |                            | Black      |        |                           |        |             |
| SKHUPME010  | 2.55N           |                     | 100,000 cycles             | Red        |        |                           |        |             |

Dust-proof type

| Product No. | Operating force | Operating direction | Operating life (5mA 5V DC) | Stem color | Height | Minimum order unit (pcs.) |        | Drawing No. |
|-------------|-----------------|---------------------|----------------------------|------------|--------|---------------------------|--------|-------------|
|             |                 |                     |                            |            |        | Japan                     | Export |             |
| SKHUBHE010  | 1.57N           | Top push            | 50,000 cycles              | Brown      | 3.1mm  | 3,000                     | 3,000  | 3           |

Dust-proof and with ground terminal type

| Product No. | Operating force | Operating direction | Operating life (5mA 5V DC) | Stem color | Height | Minimum order unit (pcs.) |        | Drawing No. |
|-------------|-----------------|---------------------|----------------------------|------------|--------|---------------------------|--------|-------------|
|             |                 |                     |                            |            |        | Japan                     | Export |             |
| SKHUQHE010  | 1.57N           | Top push            | 50,000 cycles              | Brown      | 3.1mm  | 3,000                     | 3,000  | 4           |
| SKHUQGE010  | 2.55N           |                     |                            | Red        |        |                           |        |             |

Packing Specifications

Taping

| Number of packages (pcs.) |                |                         | Tape width (mm) | Export package measurements (mm) |
|---------------------------|----------------|-------------------------|-----------------|----------------------------------|
| 1 reel                    | 1 case / Japan | 1 case / export packing |                 |                                  |
| 3,000                     | 30,000         | 30,000                  | 12              | 395×395×205                      |

Note

For reels of 330mm diameter, please inquire.

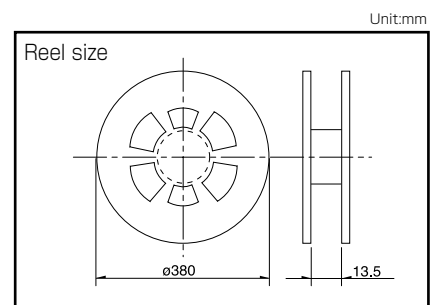

Refer to P.249 for soldering conditions.

# SKHU 6.2 × 6.3mm (Surface Mount Type)

TACT Switch™

Sharp Feeling

Soft Feeling

Snap-In Type

Surface Mount Type

Radial Type

## ■ Dimensions

Unit:mm

| No. | Photo | Style | PC board land dimensions<br>(Viewed from switch mounting face) |
|-----|-------|-------|--|
| 1   |       |       |  |
| 2   |       |       |  |
| 3   |       |       |  |
| 4   |       |       |  |

## ■ Circuit Diagram

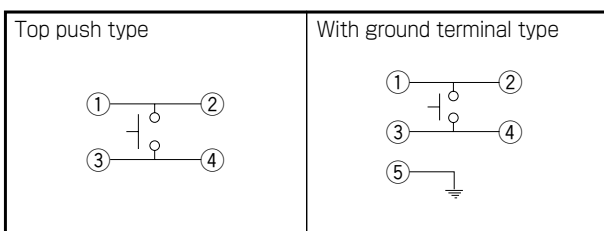

# TACT Switch™

## List of Varieties

TACT Switch™

















Sharp Feeling Type

Soft Feeling Type

Snap-In Type

Surface Mount Type

Radial Type

| Type                        |                                | Sharp Feeling Type   |   |   |   |  |   |   |   |
|-----------------------------|--------------------------------|--|---|---|---|--|---|---|---|
|                             |                                | Surface Mount  |   |   |   |  |   |   |   |
| Series                      |                                | SKST   | SKRA  | SKHM  | SKHU  | SKTD   | SKSN  | SKTG  | SKSL  |
| Photo                       |                                |   |    |    |    |    |    |    |    |
| Features                    |                                | Middle travel  |   | —   | —   | Low-profile  | Mid-mount   | Half-mount  |   |
| Water-proof                 |                                | —  | ○   | —   | ○   | ●  | —   | ●   | —   |
| Dust-proof                  |                                | —  | ○   | —   | ○   | ●  | —   | ●   | —   |
| IP standard                 |                                | —  | 67 equivalent   | —   | —   | 67 equivalent  | —   | 67 equivalent   | —   |
| Operating direction         | Top push                       | ●  | ●   | ●   | ●   | —  | —   | —   | —   |
|                             | Side push                      | —  | —   | —   | —   | ●  | ●   | ●   | ●   |
| Dimensions (mm)             | W                              | □8.5   | □6.2  | 6.2   | 6.2   | 3.9  | 6.2   | 5.2   | 4.5   |
|                             | D                              |  |   | 6.5   | 6.3   | 2.9  | 3   | 3.5   | 2.6   |
|                             | H                              | 3.95   | 3.5/5.2   | 3.1   | 2.5/3.1   | 1.55   | 3.5   | 1.55  | 2.2   |
| Operation force coverage    | 1N max.                        | 4N to 10N  | ↕   | ↕   | ↕   | ↕  | ↕   | ↕   | ↕   |
|                             | 1N to 2N                       |  |   |   |   |  |   |   |   |
|                             | 2N to 3N                       |  |   |   |   |  |   |   |   |
|                             | 3N to 4N                       |  |   |   |   |  |   |   |   |
| 4N to 5N                    |                                |  |   |   |   |  |   |   |   |
| Travel (mm)                 |                                | 0.9  | See the relevant pages for respective product description                           | 0.25  |   | 0.15   | 0.2   | 0.15  |   |
| Ground terminal             |                                | —  | —   | ●   | ●   | ●  | ●   | ●   | ●   |
| Operating temperature range |                                | -40°C to +90°C   |   | -40°C to +85°C  |   | -30°C to +85°C   | -40°C to +85°C  | -30°C to +85°C  |   |
| Automotive use              |                                | ●  | ○   | —   | ○   | —  | —   | —   | —   |
| Life Cycle                  |                                |   |  |  |  |  |  |  |  |
| Electrical performance      | Rating (max.) (Resistive load) | 50mA 16V DC  | 50mA 12V DC   |   |   |  |   |   |   |
|                             | Rating (min.) (Resistive load) | 10μA 1V DC   |   |   |   |  |   |   |   |
|                             | Insulation resistance          | 100MΩ min. 100V DC 1min.   |   |   |   |  |   |   |   |
|                             | Voltage proof                  | 250V AC 1min.  |   |   | 100V AC 1min.   |  | 250V AC 1min.   |   | 100V AC 1min.   |
| Durability                  | Vibration                      | 10 to 55 to 10Hz/min., the amplitude is 1.5mm for all the frequencies, in the 3 direction of X, Y and Z for 2 hours respectively |   |   |   |  |   |   |   |
|                             | Lifetime                       | Shall be in accordance with individual specifications.   |   |   |   |  |   |   |   |
| Environmental performance   | Cold                           | -40°C 1,000h   |   | -40°C 96h   |   |  |   |   |   |
|                             | Dry heat                       | 90°C 1,000h  |   | 90°C 96h  | 85°C 96h  | 90°C 96h   | 85°C 96h  | 90°C 96h  |   |
|                             | Damp heat                      | 60°C, 90 to 95%RH 1,000h   |   | 60°C, 90 to 95%RH 96h   |   |  |   |   |   |
| Page                        |                                | 230  | 231   | 232   | 233   | 235  | 236   | 237   | 238   |

W : Width. The most outer dimension excluding terminal portion.  
D : Depth. The most outer dimension excluding terminal portion.  
H : Height. The minimum dimension if there are variances.

TACT Switch™ Soldering Conditions . . . . . 249  
TACT Switch™ Cautions . . . . . 250

### Notes

- The automotive operating temperature range to be individually discussed upon request.
- Indicates applicability to all products in the series, while ○ indicates applicability to some products in the series.

## Condition for Reflow

Available for Surface Mount Type.

Temperature profile

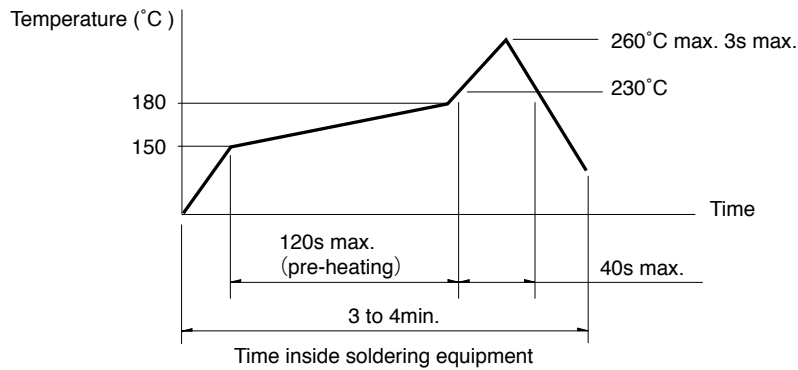

### Notes

1. Please confirm the specifications of our product for the detailed condition.
2. Soldering conditions differ depending on reflow soldering machines. Prior verification of soldering condition is highly recommended.

## Conditions for Auto-dip

Available for Snap-in Type and Radial Type.

| Items                  | Condition   |
|------------------------|---|
| Flux built-up          | Mounting surface should not be exposed to flux                      |
| Preheating temperature | Ambient temperature of the soldered surface of PC board. 100°C max. |
| Preheating time        | 60s max.  |
| Soldering temperature  | 260°C max.  |
| Duration of immersion  | 5s max.   |
| Number of soldering    | 2times max.   |

### SKHH Series

| Items                  | Condition   |
|------------------------|---|
| Flux built-up          | Mounting surface should not be exposed to flux                      |
| Preheating temperature | Ambient temperature of the soldered surface of PC board. 110°C max. |
| Preheating time        | 60s max.  |
| Soldering temperature  | 260°C max.  |
| Duration of immersion  | 5s max.   |
| Number of soldering    | 2times max.   |

### SKHL Top Push Type, SKQJ Series

| Items                  | Condition   |
|------------------------|---|
| Flux built-up          | Mounting surface should not be exposed to flux                      |
| Preheating temperature | Ambient temperature of the soldered surface of PC board. 100°C max. |
| Preheating time        | 45s max.  |
| Soldering temperature  | 255°C max.  |
| Duration of immersion  | 5s max.   |
| Number of soldering    | 2times max.   |

### Notes

1. Prevent flux penetration from the top side of the TACT Switch™.
2. Switch terminals and a PC board should not be coated with flux prior to soldering.
3. The second soldering should be done after the switch is stable with normal temperature.
4. Use the flux with a specific gravity of min 0.81.  
(EC-19S-8 by TAMURA CORPORATION, or equivalents.)

## Manual Soldering

| Items                      | Condition  |
|----------------------------|------------|
| Soldering temperature      | 350°C max. |
| Duration of soldering      | 3s max.    |
| Capacity of soldering iron | 60W max.   |

### SKHH, SKHW Series

| Items                      | Condition  |
|----------------------------|------------|
| Soldering temperature      | 360°C max. |
| Duration of soldering      | 3s max.    |
| Capacity of soldering iron | 60W max.   |

### SKTD, SKTG, SKQJ Series

| Items                      | Condition  |
|----------------------------|------------|
| Soldering temperature      | 350°C max. |
| Duration of soldering      | 3s max.    |
| Capacity of soldering iron | 20W max.   |



Компания «ЭлектроПласт» предлагает заключение долгосрочных отношений при поставках импортных электронных компонентов на взаимовыгодных условиях!

Наши преимущества:

- Оперативные поставки широкого спектра электронных компонентов отечественного и импортного производства напрямую от производителей и с крупнейших мировых складов;
- Поставка более 17-ти миллионов наименований электронных компонентов;
- Поставка сложных, дефицитных, либо снятых с производства позиций;
- Оперативные сроки поставки под заказ (от 5 рабочих дней);
- Экспресс доставка в любую точку России;
- Техническая поддержка проекта, помощь в подборе аналогов, поставка прототипов;
- Система менеджмента качества сертифицирована по Международному стандарту ISO 9001;
- Лицензия ФСБ на осуществление работ с использованием сведений, составляющих государственную тайну;
- Поставка специализированных компонентов (Xilinx, Altera, Analog Devices, Intersil, Interpoint, Microsemi, Aeroflex, Peregrine, Syfer, Eurofarad, Texas Instrument, Miteq, Cobham, E2V, MA-COM, Hittite, Mini-Circuits, General Dynamics и др.);

Помимо этого, одним из направлений компании «ЭлектроПласт» является направление «Источники питания». Мы предлагаем Вам помощь Конструкторского отдела:

- Подбор оптимального решения, техническое обоснование при выборе компонента;
- Подбор аналогов;
- Консультации по применению компонента;
- Поставка образцов и прототипов;
- Техническая поддержка проекта;
- Защита от снятия компонента с производства.



#### Как с нами связаться

**Телефон:** 8 (812) 309 58 32 (многоканальный)

**Факс:** 8 (812) 320-02-42

**Электронная почта:** [org@eplast1.ru](mailto:org@eplast1.ru)

**Адрес:** 198099, г. Санкт-Петербург, ул. Калинина, дом 2, корпус 4, литера А.