

**4S1 & 4SS-Series**  
Sub-Miniature &  
**Sealed** Sub-Miniature  
Slide Switches

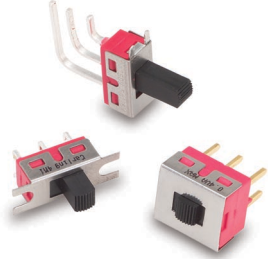

**4M1-Series**  
Miniature Slide Switch

### Specifications

Contact Rating . . . . . refer to ordering scheme  
 Electrical Life . . . . . 30,000 make & break cycles at full load  
 Contact Resistance. . . . . 10 mΩ max. initial @ 2-4 VDC  
 100mA for both silver & gold plated contacts.  
 Insulation Resistance . . . 1000 MΩ min.  
 Dielectric Strength . . . . . 1500 Volts RMS @ sea level  
 Operating Temperature . . . -30°C to +85°C  
 Solder Heat Resistance. . . MIL-STD-202, Method 210  
 Actuator Travel . . . . . 25°

**Materials**

Case . . . . . Diallyl phthalate (DAP) (UL 94V-0)  
 Slide Handle. . . . . Nylon  
 Housing. . . . . Stainless Steel  
 Terminal Seal . . . . . Epoxy

### 4S1-Series Ordering Scheme



<b>1 SERIES</b> <b>4S1</b> Sub-Miniature Slide Switch																
<b>2 POLES</b> <b>FSP</b> single pole																
<b>3 CIRCUIT</b> <table style="width: 100%; border-collapse: collapse;"> <tr> <td colspan="4" style="text-align: center;"><b>Switching Position:</b></td> </tr> <tr> <td style="width: 10%;"></td> <td style="width: 15%;">2-1</td> <td style="width: 15%;">OPEN</td> <td style="width: 10%;">2-3</td> </tr> <tr> <td><b>1</b></td> <td>ON</td> <td>NONE</td> <td>ON</td> </tr> <tr> <td><b>3</b></td> <td>ON</td> <td>OFF</td> <td>ON</td> </tr> </table>	<b>Switching Position:</b>					2-1	OPEN	2-3	<b>1</b>	ON	NONE	ON	<b>3</b>	ON	OFF	ON
<b>Switching Position:</b>																
	2-1	OPEN	2-3													
<b>1</b>	ON	NONE	ON													
<b>3</b>	ON	OFF	ON													
<b>4 TERMINATION</b> <b>M2</b> PCB <b>M6</b> PC Mount, 90° horizontal																

<b>5 CONTACT</b>		
<b>Material</b>	<b>Terminal Plating</b>	<b>Rating</b>
<b>G</b> silver <sup>1</sup>	gold over silver <sup>3</sup>	3A@125VAC or 28VDC; 1.5A @ 250VAC
<b>K</b> gold <sup>2</sup>	tin-lead <sup>4</sup>	0.4VA max. @20V max (AC/DC)
<b>P</b> silver <sup>1</sup>	tin-lead <sup>4</sup>	3A@125VAC or 28VDC; 1.5A @ 250VAC
<b>Q</b> silver <sup>1</sup>	silver <sup>1</sup>	3A@125VAC or 28VDC; 1.5A @ 250VAC
<b>R</b> gold <sup>2</sup>	gold <sup>2</sup>	0.4VA max. @20V max (AC/DC)
NOTE: Tin-lead option available with PC type terminations only. 1 Moveable contact & terminals: copper alloy, silver plate 2 Moveable contact & terminals: copper alloy with gold plate over nickel plate 3 Terminals: silver plate with outer layer in gold plating		

<b>6 EPOXY SEAL</b> <b>E</b> epoxy seal
--

<b>7 PACKAGING</b> Switches are bulk packed, unless T/R is specified at the end of the part number. <b>T/R</b> tape reel - 500 pieces per reel
--

### 4SS-Series Ordering Scheme



<p><b>1 SERIES</b> 4SS Sealed Sub-Miniature Slide Switch</p>															
<p><b>2 POLES</b> FSP single pole</p>															
<p><b>3 CIRCUIT</b></p> <p style="text-align: center;"><i>Switching Position:</i></p> <table style="width: 100%; border-collapse: collapse;"> <tr> <td style="width: 10%;"></td> <td style="width: 15%;"></td> <td style="width: 20%; text-align: center;"><i>OPEN</i></td> <td style="width: 20%;"></td> <td style="width: 20%; text-align: center;"><i>2-3</i></td> </tr> <tr> <td style="text-align: center;"><b>1</b></td> <td style="text-align: center;">ON</td> <td style="text-align: center;">NONE</td> <td></td> <td style="text-align: center;">ON</td> </tr> <tr> <td style="text-align: center;"><b>3</b></td> <td style="text-align: center;">ON</td> <td style="text-align: center;">OFF</td> <td></td> <td style="text-align: center;">ON</td> </tr> </table>			<i>OPEN</i>		<i>2-3</i>	<b>1</b>	ON	NONE		ON	<b>3</b>	ON	OFF		ON
		<i>OPEN</i>		<i>2-3</i>											
<b>1</b>	ON	NONE		ON											
<b>3</b>	ON	OFF		ON											
<p><b>4 TERMINATION</b></p> <p>Termination options for switches with brick color actuators</p> <p>M2 PCB M6 PC Mount, 90° horizontal M7 PC Mount, 90° vertical</p> <p>Termination options for switches with white color actuators</p> <p>L6 Surface Mount, 90° flat S6 Surface Mount, 90° horizontal S7 Surface Mount, 90° vertical</p>															

<b>5 CONTACT</b>		
<b>Material</b>	<b>Terminal Plating</b>	<b>Rating</b>
<b>G</b> silver <sup>1</sup>	gold over silver	3A@125VAC or 28VDC; 1.5A @ 250VAC
<b>K</b> gold <sup>2</sup>	tin-lead <sup>4</sup>	0.4VA max. @20V max (AC/DC)
<b>P</b> silver <sup>1</sup>	tin-lead	3A@125VAC or 28VDC; 1.5A @ 250VAC
<b>R</b> gold <sup>2</sup>	gold <sup>2</sup>	0.4VA max. @20V max (AC/DC)
NOTE:		
Tin-lead option available with PC type terminations only.		
1 Moveable contact & terminals: copper alloy, silver plate		
2 Moveable contact & terminals: copper alloy with gold plate over nickel plate		
3 Terminals: silver plate with outer layer in gold plating		
4 Outer terminals: copper alloy with tin-lead over nickel plate		

<b>6 EPOXY SEAL</b>
<b>E</b> epoxy seal

<b>7 PACKAGING</b>
Switches are bulk packed, unless T/R is specified at the end of the part number.
T/R tape reel - 500 pieces per reel

### 4M1-Series Ordering Scheme

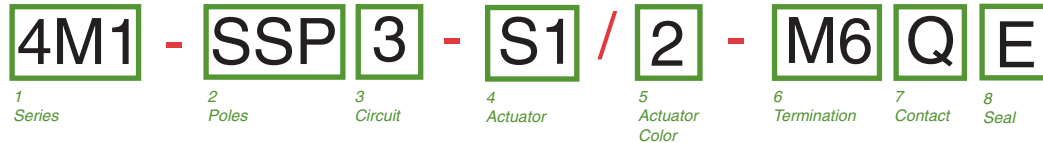

<p><b>1 SERIES</b> 4M1 Miniature Slide Switch</p>															
<p><b>2 POLES</b> SSP single pole <span style="float: right;">SDP double pole</span></p>															
<p><b>3 CIRCUIT</b> <i>Switching Position</i></p> <table style="width: 100%; border-collapse: collapse;"> <tr> <td style="width: 10%;"></td> <td style="width: 15%; text-align: center;"><i>2-1, 5-4</i></td> <td style="width: 20%; text-align: center;"><i>OPEN</i></td> <td style="width: 20%;"></td> <td style="width: 20%; text-align: center;"><i>2-3, 5-6</i></td> </tr> <tr> <td style="text-align: center;"><b>1</b></td> <td style="text-align: center;">ON</td> <td style="text-align: center;">NONE</td> <td></td> <td style="text-align: center;">ON</td> </tr> <tr> <td style="text-align: center;"><b>3</b></td> <td style="text-align: center;">ON</td> <td style="text-align: center;">OFF</td> <td></td> <td style="text-align: center;">ON</td> </tr> </table>		<i>2-1, 5-4</i>	<i>OPEN</i>		<i>2-3, 5-6</i>	<b>1</b>	ON	NONE		ON	<b>3</b>	ON	OFF		ON
	<i>2-1, 5-4</i>	<i>OPEN</i>		<i>2-3, 5-6</i>											
<b>1</b>	ON	NONE		ON											
<b>3</b>	ON	OFF		ON											
<p><b>4 ACTUATOR</b></p> <p>S1 .201 [5.10] high S2 .285 [7.25] high S3 .370 [9.40] high S4 .140 [3.55] high S5 .053 [1.35] high (for DPDT only) S6 .482 [12.25] high S7 .311 [7.90] high T1 .201 [5.10] high (for DPDT only)</p>															
<p><b>5 ACTUATOR COLOR<sup>1</sup></b></p> <table style="width: 100%; border-collapse: collapse;"> <tr> <td style="text-align: center;"><b>1</b> white</td> <td style="text-align: center;"><b>3</b> red</td> <td style="text-align: center;"><b>5</b> yellow</td> <td style="text-align: center;"><b>7</b> blue</td> <td style="text-align: center;"><b>9</b> gray</td> </tr> <tr> <td style="text-align: center;"><b>2</b> black</td> <td style="text-align: center;"><b>4</b> orange</td> <td style="text-align: center;"><b>6</b> green</td> <td style="text-align: center;"><b>8</b> brown</td> <td></td> </tr> </table> <p><small>1 White, black &amp; red are standard. Other colors available for quantities of 5K or more.</small></p>	<b>1</b> white	<b>3</b> red	<b>5</b> yellow	<b>7</b> blue	<b>9</b> gray	<b>2</b> black	<b>4</b> orange	<b>6</b> green	<b>8</b> brown						
<b>1</b> white	<b>3</b> red	<b>5</b> yellow	<b>7</b> blue	<b>9</b> gray											
<b>2</b> black	<b>4</b> orange	<b>6</b> green	<b>8</b> brown												

<b>6 TERMINATION</b>	
<b>M1</b> Solder Lug	<b>M5-3</b> Wire Wrap [10.80]
<b>M2</b> PCB	<b>M5-4</b> Wire Wrap [26.97]
<b>M3</b> Quick Connect	<b>M6</b> PC Mount, 90° horizontal
<b>M5-1</b> Wire Wrap .750 [19.05]	<b>M7</b> PC Mount, 90° vertical
<b>M5-2</b> Wire Wrap [24.48]	<b>VS2</b> PC Mount, U bracket, .620 mounting x .460 high

<b>7 CONTACT</b>			
<b>Material</b>	<b>Terminal Plating</b>	<b>Rating</b>	<b>Approvals</b>
<b>G</b> silver <sup>1</sup>	gold over silver <sup>2</sup>	5A@125VAC or 28VDC; 2A @ 250VAC	UL, CSA
<b>K</b> gold <sup>2</sup>	tin-lead <sup>4</sup>	0.4VA max. @20V max (AC/DC)	
<b>P</b> silver <sup>1</sup>	tin-lead <sup>4</sup>	5A@125VAC or 28VDC; 2A @ 250VAC	UL, CSA
<b>Q</b> silver <sup>1</sup>	silver <sup>1</sup>	5A@125VAC or 28VDC; 2A @ 250VAC	UL, CSA
<b>R</b> gold <sup>2</sup>	gold <sup>2</sup>	0.4VA max. @20V max (AC/DC)	
NOTE:			
Tin-lead option available with PC type terminations only.			
1 Moveable contact & terminals: copper alloy, silver plate			
2 Moveable contact & terminals: copper alloy with gold plate over nickel plate			
3 Terminals: silver plate with outer layer in gold plating			
4 Outer terminals: copper alloy with tin-lead over nickel plate			

<b>8 EPOXY SEAL</b>
<b>E</b> epoxy seal

**4S-Series Dimensional Specifications: in. [mm]**

**4S1-Series**

**TERMINATION**

**PC MOUNTING**

**M2**

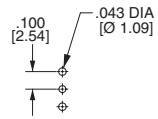
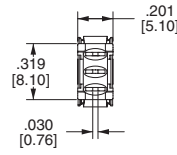
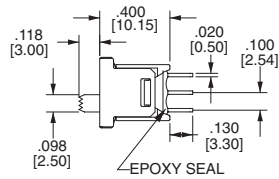
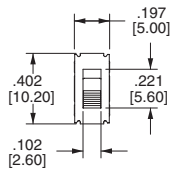

**M6**

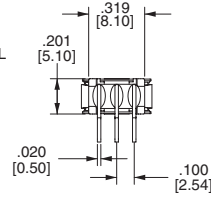
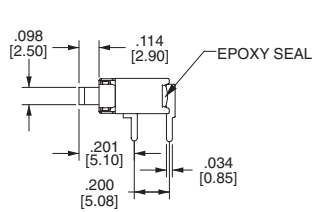
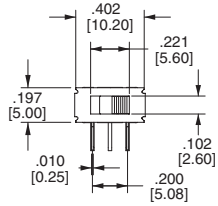

**PC MOUNTING**

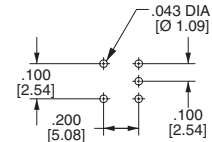

**4SS-Series**

**TERMINATION**

**PC MOUNTING**

**M2**

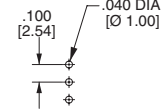
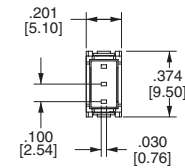
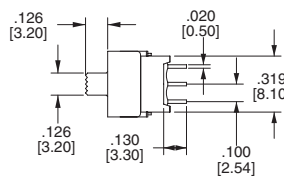
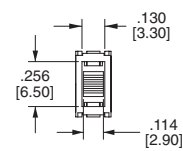

**M6**

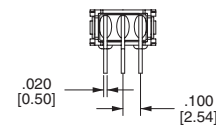
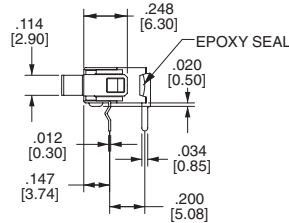
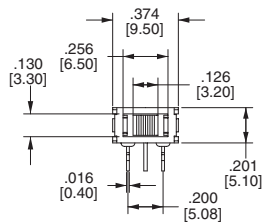

**PC MOUNTING**

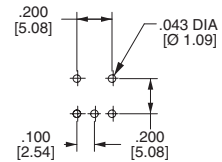

**M7**

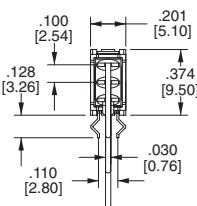
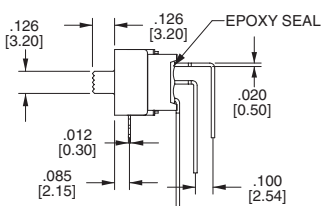
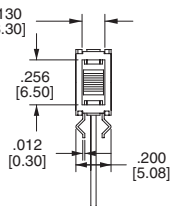

**PC MOUNTING**

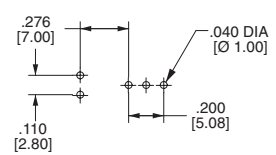

**L6**

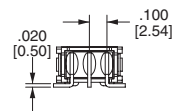
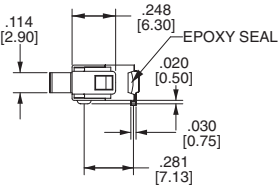
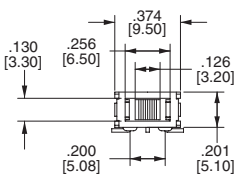

**PC MOUNTING**

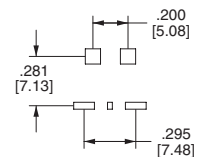

**4SS-Series Dimensional Specifications: in. [mm]**

**TERMINATION**

**S6**

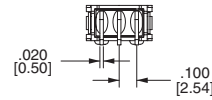
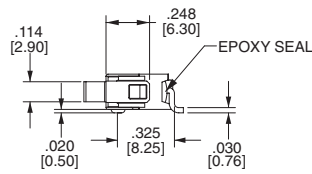
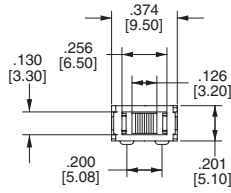

**PC MOUNTING**

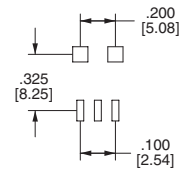

**S7**

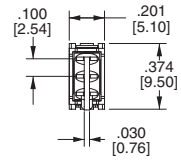
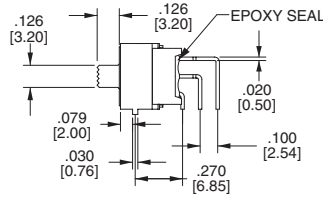
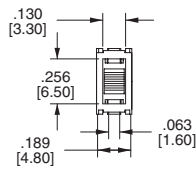

**PC MOUNTING**

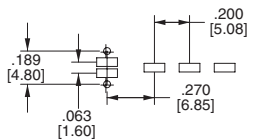

**REEL TAPING**

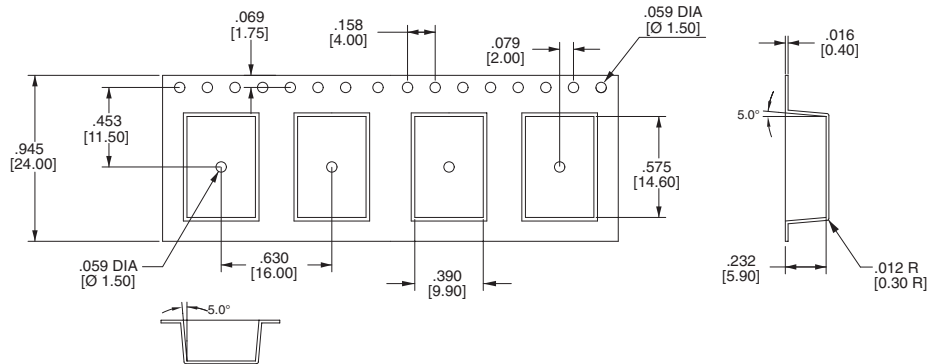

**FOR S6, L6 ONLY**

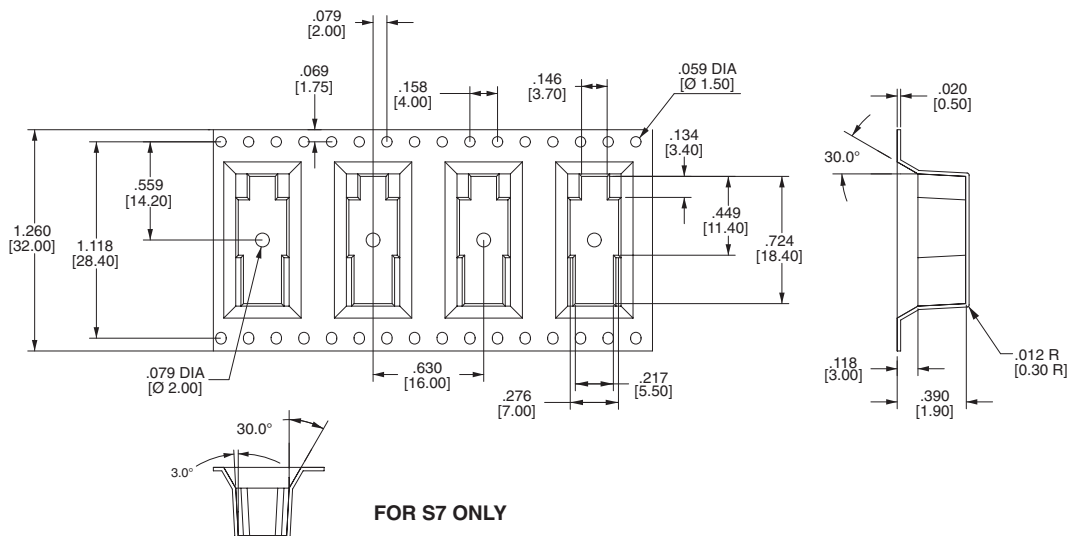

**FOR S7 ONLY**

## 4M1-Series Dimensional Specifications: in. [mm]

### ACTUATOR

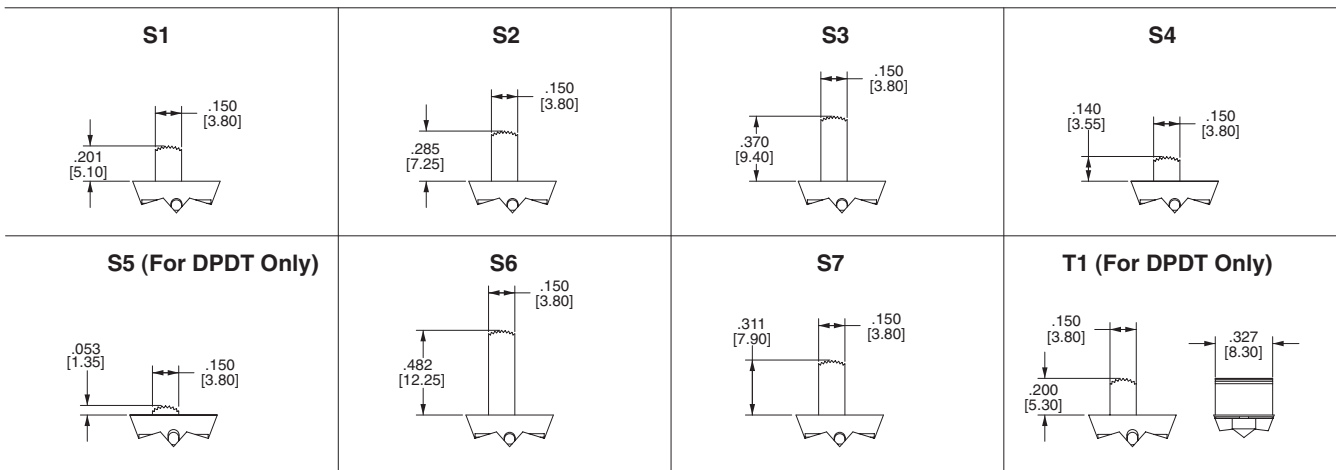

### TERMINATION

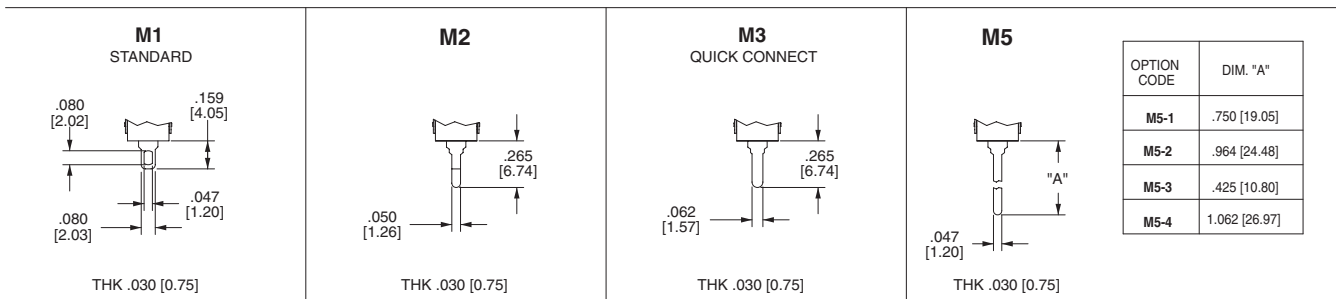

### SINGLE POLE

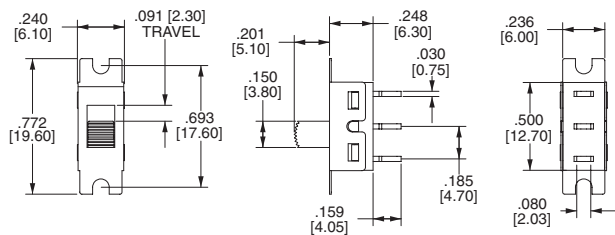

### DOUBLE POLE

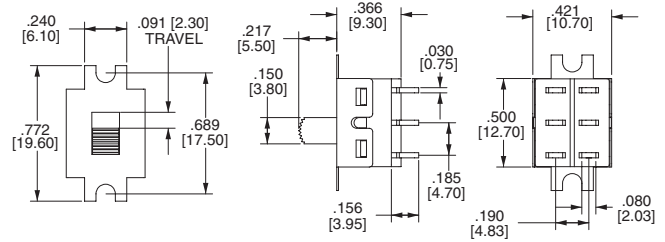

### M6

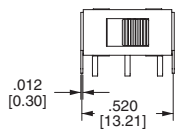

### SINGLE POLE

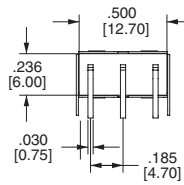
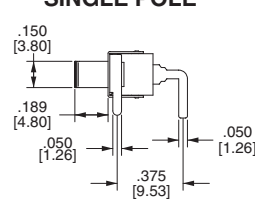

### PC MOUNTING

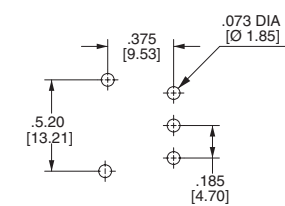

### DOUBLE POLE

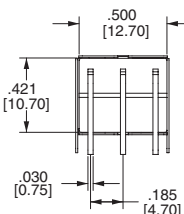
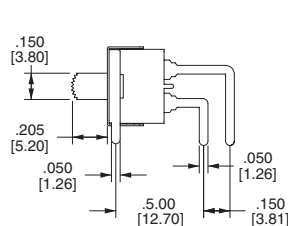

### PC MOUNTING

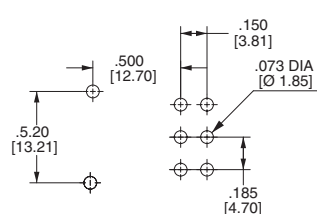

**4M1-Series Dimensional Specifications: in. [mm]**

**TERMINATION**

**M7**

**SINGLE POLE**

**PC MOUNTING**

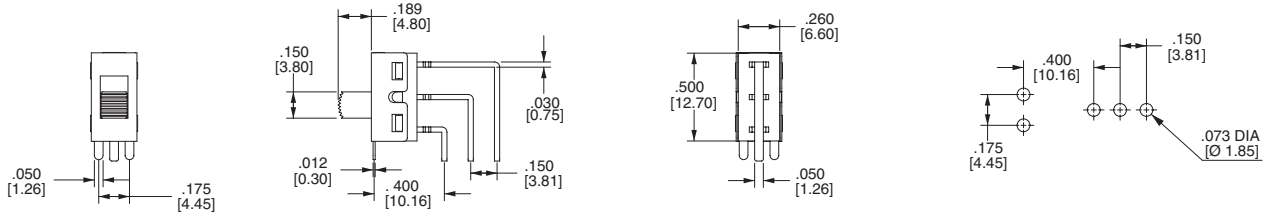

**DOUBLE POLE**

**PC MOUNTING**

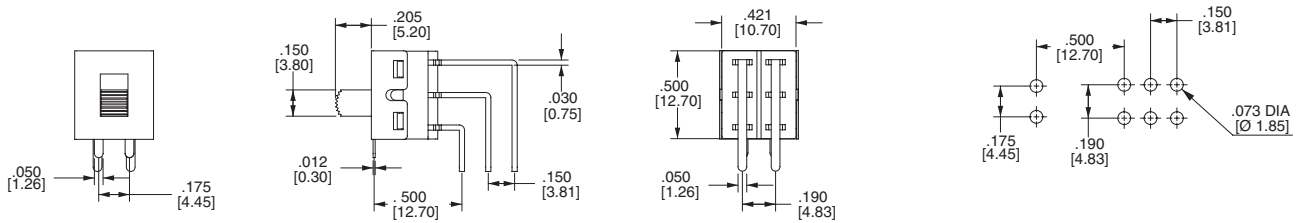

**VS2**

**SINGLE POLE**

**PC MOUNTING**

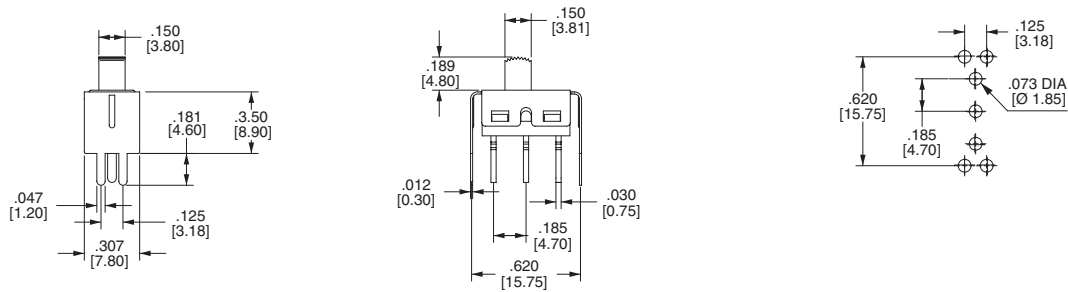

**DOUBLE POLE**

**PC MOUNTING**

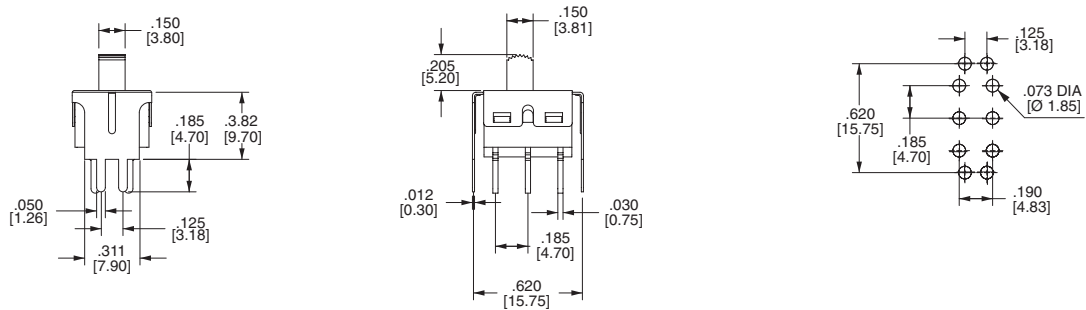



Компания «ЭлектроПласт» предлагает заключение долгосрочных отношений при поставках импортных электронных компонентов на взаимовыгодных условиях!

Наши преимущества:

- Оперативные поставки широкого спектра электронных компонентов отечественного и импортного производства напрямую от производителей и с крупнейших мировых складов;
- Поставка более 17-ти миллионов наименований электронных компонентов;
- Поставка сложных, дефицитных, либо снятых с производства позиций;
- Оперативные сроки поставки под заказ (от 5 рабочих дней);
- Экспресс доставка в любую точку России;
- Техническая поддержка проекта, помощь в подборе аналогов, поставка прототипов;
- Система менеджмента качества сертифицирована по Международному стандарту ISO 9001;
- Лицензия ФСБ на осуществление работ с использованием сведений, составляющих государственную тайну;
- Поставка специализированных компонентов (Xilinx, Altera, Analog Devices, Intersil, Interpoint, Microsemi, Aeroflex, Peregrine, Syfer, Eurofarad, Texas Instrument, Miteq, Cobham, E2V, MA-COM, Hittite, Mini-Circuits, General Dynamics и др.);

Помимо этого, одним из направлений компании «ЭлектроПласт» является направление «Источники питания». Мы предлагаем Вам помощь Конструкторского отдела:

- Подбор оптимального решения, техническое обоснование при выборе компонента;
- Подбор аналогов;
- Консультации по применению компонента;
- Поставка образцов и прототипов;
- Техническая поддержка проекта;
- Защита от снятия компонента с производства.



#### Как с нами связаться

**Телефон:** 8 (812) 309 58 32 (многоканальный)

**Факс:** 8 (812) 320-02-42

**Электронная почта:** [org@eplast1.ru](mailto:org@eplast1.ru)

**Адрес:** 198099, г. Санкт-Петербург, ул. Калинина, дом 2, корпус 4, литера А.