

Q14 series

Ø14 mm panel mount LED indicators



DISTINCTIVE FEATURES

10 mm colored diffused epoxy lens or 10 mm water clear super bright LEDs

Prominent and flush bezel styles

(2.8 x 0.8) solder lug/faston terminals, pins or (200 mm long) wire terminations

Custom engraving available



ENVIRONMENTAL SPECIFICATIONS

- IP67 sealing option (EN60529)
- Operating & Storage Temperature Range:
Rear plastic body: -30 °C to +65° C (-22 °F to +149 °F)
Rear epoxy body: -40 °C to +85° C (-40 °F to +185 °F)



GENERAL SPECIFICATIONS

- Max Reverse Voltage: 5 V
- Viewing Angle: 30–100° (dependant on model)
- Life Expectancy: 100,000 hours
- Torque: 4 cNm (dependent on option)
- Maximum panel thickness 11 mm



MATERIALS

- Plated brass bezel finished in bright chrome, black chrome or satin grey and moulded polycarbonate rear body



MOUNTING

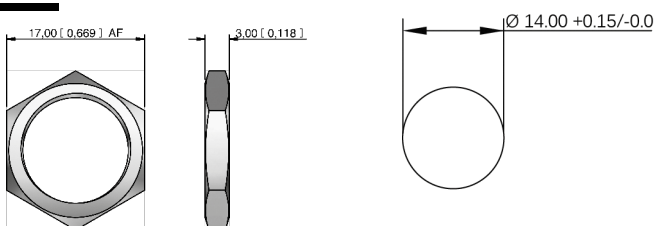

The company reserves the right to change specifications without notice.

All LED characteristics are dependent upon environmental conditions. Therefore published data should be considered nominal and subject to variations.

Q14 series

Ø14 mm panel mount LED indicators



ELECTRICAL SPECIFICATIONS

STANDARD LED INTENSITY

LED COMPONENT SPECIFICATIONS			
	Prominent and Recessed	Flush	Forward Voltage
HE Red	80 mcd	10 mcd	2.0 V
Green	60 mcd	5 mcd	2.2 V
Yellow	50 mcd	4 mcd	2.1 V
Blue	540 mcd	100 mcd	3.3 V
White	1000 mcd	150 mcd	3.3 V
Orange	80 mcd	200 mcd	2.2 V
Bi-color (Typical) (Red/Green)	15/15 mcd	14/10 mcd	2.0V/2.2 V
Tri-color (Typical) (Red/Green/Yellow)	60/50/50mcd	15/10/30 mcd	2.0 V/2.2 V/2.1 V

Bi-color - The color is changed by reversing the polarity of the supply voltage.
Tri-color - The indicator has red and green LEDs, when both connected yellow is produced.

SUPER BRIGHT LED INTENSITY

LED COMPONENT SPECIFICATIONS			
	Prominent and Recessed	Flush	Forward Voltage
HE Red	17,000 mcd	2,000 mcd	2.2 V
Green	11,000 mcd	680 mcd	3.3 V
Yellow	4,000 mcd	350 mcd	2.0 V
Blue	2,500mcd	250 mcd	3.3 V
White	4,400 mcd	250 mcd	3.3 V
Orange	2,800 mcd	300 mcd	2.2 V

HYPER BRIGHT LED INTENSITY

LED COMPONENT SPECIFICATIONS			
	Prominent and Recessed	Flush	Forward Voltage
HE Red	2,800 mcd	800 mcd	2.1 V
Green	2,200 mcd	250 mcd	3.2 V
Yellow	1,300 mcd	250 mcd	2.0 V
Orange	850 mcd	200 mcd	2.1 V

- The operating voltage must not be exceeded by more than 10% as this will result in reduced life expectancy
- Luminous intensity is measured at 20 mA on a discrete led unless otherwise stated.
- Luminous intensities and color shades of white LEDs may vary within a batch.
- Luminous intensity will be reduced with lower operating current.

Voltage	Operating Voltage	Operating Current
	(Min to Max)	(Typical All Types)
02 (No Resistor)	1.8 to 3.3 VDC	20 mA max
6 VDC	5.4 to 6.6 VDC	20 mA
12 VDC	10.8 to 13.2 VDC	20 mA
24 VDC	21.6 to 26.4 VDC	20 mA
28 VDC	25.2 to 30.8 VDC	20 mA
110 VAC	99 to 121 VAC	6 mA
220 VAC	207 to 235 VAC	3 mA

* Customer to supply resistor for desired operating current.

Q14 series

Ø14 mm panel mount LED indicators



BUILD YOUR PART NUMBER

SERIES	MOUNTING HOLE	TERMINALS	BEZEL FINISH																																																																								
Q	14 Ø14mm	<table border="0"> <tr><td>1</td><td>Solder Lug/ Fastons (2.8 x 0.8)</td></tr> <tr><td>2</td><td>Pins</td></tr> <tr><td>3</td><td>Wires</td></tr> <tr><td>4</td><td>Rear epoxy Pins</td></tr> </table>	1	Solder Lug/ Fastons (2.8 x 0.8)	2	Pins	3	Wires	4	Rear epoxy Pins	<table border="0"> <tr><td>5</td><td>Rear epoxy Wires</td></tr> <tr><td>6</td><td>Short body Pins</td></tr> <tr><td>7</td><td>Short body Wires</td></tr> </table>	5	Rear epoxy Wires	6	Short body Pins	7	Short body Wires																																																										
1	Solder Lug/ Fastons (2.8 x 0.8)																																																																										
2	Pins																																																																										
3	Wires																																																																										
4	Rear epoxy Pins																																																																										
5	Rear epoxy Wires																																																																										
6	Short body Pins																																																																										
7	Short body Wires																																																																										
	BEZEL STYLE		<table border="0"> <tr> <td>ANODIZED FLUSH</td> <td></td> <td>OTHERS</td> </tr> <tr> <td>AR</td><td>Red</td> <td>C</td><td>Bright Chrome</td> </tr> <tr> <td>AG</td><td>Green</td> <td>B</td><td>Black Chrome</td> </tr> <tr> <td>AY</td><td>Yellow</td> <td>G</td><td>Satin Grey</td> </tr> <tr> <td>AB</td><td>Blue</td> <td></td><td></td> </tr> <tr> <td>AN</td><td>Black</td> <td></td><td></td> </tr> </table>	ANODIZED FLUSH		OTHERS	AR	Red	C	Bright Chrome	AG	Green	B	Black Chrome	AY	Yellow	G	Satin Grey	AB	Blue			AN	Black																																																			
ANODIZED FLUSH		OTHERS																																																																									
AR	Red	C	Bright Chrome																																																																								
AG	Green	B	Black Chrome																																																																								
AY	Yellow	G	Satin Grey																																																																								
AB	Blue																																																																										
AN	Black																																																																										
	<table border="0"> <tr><td>P</td><td>Prominent</td></tr> <tr><td>R</td><td>Recessed</td></tr> <tr><td>F</td><td>Flush</td></tr> </table>	P	Prominent	R	Recessed	F	Flush																																																																				
P	Prominent																																																																										
R	Recessed																																																																										
F	Flush																																																																										
TYPE OF ILLUMINATION	LED COLOR	VOLTAGE	SEALING																																																																								
<table border="0"> <tr><td>XX</td><td>Fixed Light</td></tr> <tr><td>KK</td><td>Flashing Light (12V – 28VDC)</td></tr> <tr><td>YY</td><td>Bi-color</td></tr> <tr><td>ZZ</td><td>Tri-color</td></tr> </table>	XX	Fixed Light	KK	Flashing Light (12V – 28VDC)	YY	Bi-color	ZZ	Tri-color	<table border="0"> <tr><td>R</td><td>Red</td></tr> <tr><td>G</td><td>Green</td></tr> <tr><td>Y</td><td>Yellow</td></tr> <tr><td>B</td><td>Blue</td></tr> <tr><td>W</td><td>White</td></tr> <tr><td>O</td><td>Orange</td></tr> <tr><td>HR</td><td>Hyper Bright Red</td></tr> </table>	R	Red	G	Green	Y	Yellow	B	Blue	W	White	O	Orange	HR	Hyper Bright Red	<table border="0"> <tr><td>HG</td><td>Hyper Bright Green</td></tr> <tr><td>HY</td><td>Hyper Bright Yellow</td></tr> <tr><td>HO</td><td>Hyper Bright Orange</td></tr> <tr><td>SR</td><td>Super Bright Red</td></tr> <tr><td>SG</td><td>Super Bright Green</td></tr> <tr><td>SY</td><td>Super Bright Yellow</td></tr> </table>	HG	Hyper Bright Green	HY	Hyper Bright Yellow	HO	Hyper Bright Orange	SR	Super Bright Red	SG	Super Bright Green	SY	Super Bright Yellow	<table border="0"> <tr><td>SB</td><td>Super Bright Blue</td></tr> <tr><td>SW</td><td>Super Bright White</td></tr> <tr><td>RG</td><td>Red/Green</td></tr> <tr><td>RY</td><td>Red/Yellow</td></tr> <tr><td>GY</td><td>Green/Yellow</td></tr> <tr><td>RYG</td><td>Red/Yellow/Green</td></tr> </table>	SB	Super Bright Blue	SW	Super Bright White	RG	Red/Green	RY	Red/Yellow	GY	Green/Yellow	RYG	Red/Yellow/Green	<table border="0"> <tr><td>02</td><td>no resistor</td></tr> <tr><td>06</td><td>6VDC</td></tr> <tr><td>12</td><td>12VDC</td></tr> <tr><td>12A</td><td>12VAC/DC</td></tr> <tr><td>24</td><td>24VDC</td></tr> <tr><td>24A</td><td>24VAC/DC</td></tr> <tr><td>28</td><td>28VDC</td></tr> <tr><td>28A</td><td>28VAC/DC</td></tr> <tr><td>110</td><td>110VAC</td></tr> <tr><td>220</td><td>220VAC</td></tr> </table>	02	no resistor	06	6VDC	12	12VDC	12A	12VAC/DC	24	24VDC	24A	24VAC/DC	28	28VDC	28A	28VAC/DC	110	110VAC	220	220VAC	<table border="0"> <tr><td>(Blank)</td><td>Unsealed</td></tr> <tr><td>E</td><td>IP67</td></tr> </table>	(Blank)	Unsealed	E	IP67
XX	Fixed Light																																																																										
KK	Flashing Light (12V – 28VDC)																																																																										
YY	Bi-color																																																																										
ZZ	Tri-color																																																																										
R	Red																																																																										
G	Green																																																																										
Y	Yellow																																																																										
B	Blue																																																																										
W	White																																																																										
O	Orange																																																																										
HR	Hyper Bright Red																																																																										
HG	Hyper Bright Green																																																																										
HY	Hyper Bright Yellow																																																																										
HO	Hyper Bright Orange																																																																										
SR	Super Bright Red																																																																										
SG	Super Bright Green																																																																										
SY	Super Bright Yellow																																																																										
SB	Super Bright Blue																																																																										
SW	Super Bright White																																																																										
RG	Red/Green																																																																										
RY	Red/Yellow																																																																										
GY	Green/Yellow																																																																										
RYG	Red/Yellow/Green																																																																										
02	no resistor																																																																										
06	6VDC																																																																										
12	12VDC																																																																										
12A	12VAC/DC																																																																										
24	24VDC																																																																										
24A	24VAC/DC																																																																										
28	28VDC																																																																										
28A	28VAC/DC																																																																										
110	110VAC																																																																										
220	220VAC																																																																										
(Blank)	Unsealed																																																																										
E	IP67																																																																										



ABOUT THIS SERIES



Notice: please note that not all combinations of above numbers are available.

- Gold faston terminal denotes anode (+), silver terminal denotes cathode (-)
- Standard wire length is 200 mm, 22 AWG UL1061, red wire denotes anode (+), black wire denotes cathode (-) for other wire lengths consult APEM
- For LEDs with alternative voltages and multi-voltage options consult APEM
- 110 VAC and 220 VAC, short body terminal options, 5, 6 and 7 please consult the factory
- Bi-color leds, by connecting the gold faston (+) one color is produced, by reversing the supply voltage another color is produced – bi-colors are available up to 28 VDC

- Take care when soldering to the faston terminals (recommended solder temperature 300 °C - 3 sec)
- Short body pins and wires are only available up to 28 VDC
- The Tri-color LED has red and green LEDs when both are connected yellow is produced
- Standard tri-color faston terminals are two anodes (+) and one cathode (-)
- Tri-color wires are one red (+) and one green (+) anode and one black (-) cathode
- Tri-color pins are center (-) cathode, shortest (+) anode pin green, longest (+) anode pin red
- We recommend using Hyperbright or Superbright LEDs for use at 110 VAC and 220 VAC

Q14 series

Ø14 mm panel mount LED indicators

PROMINENT BEZEL



WIRES

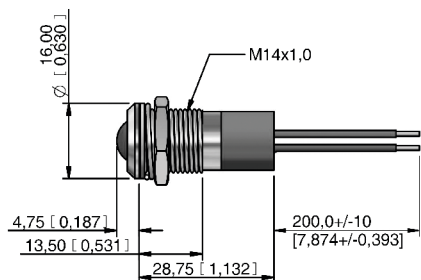

REAR EPOXY WIRES

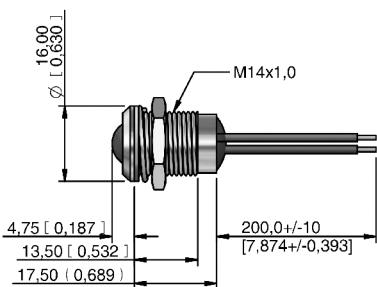

SHORT BODY WIRES

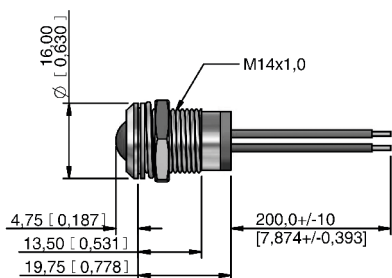

SOLDER LUG/FASTON

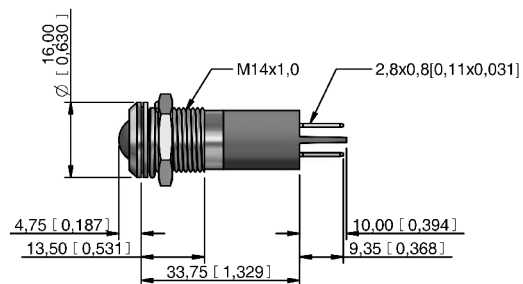

PINS

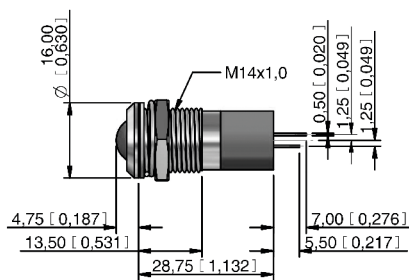

REAR EPOXY PINS

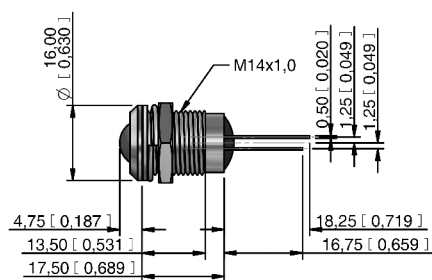

SHORT BODY PINS

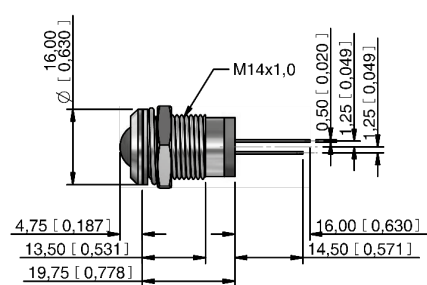

FLUSH BEZEL

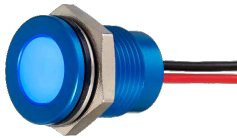

WIRES

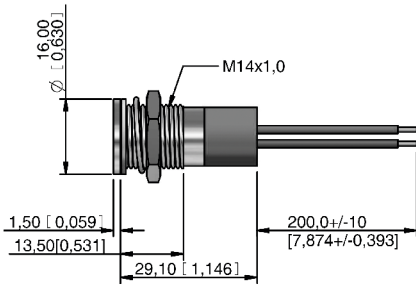

REAR EPOXY WIRES

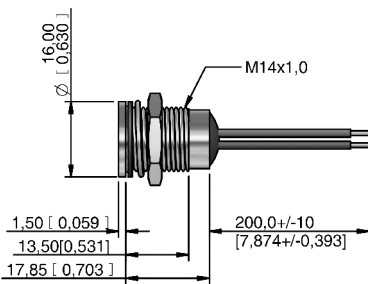

SHORT BODY WIRES

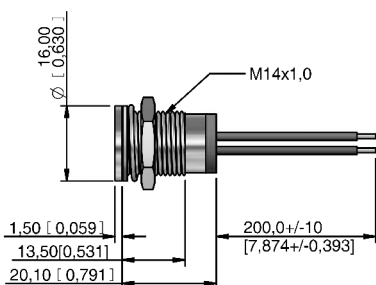

SOLDER LUG/FASTON

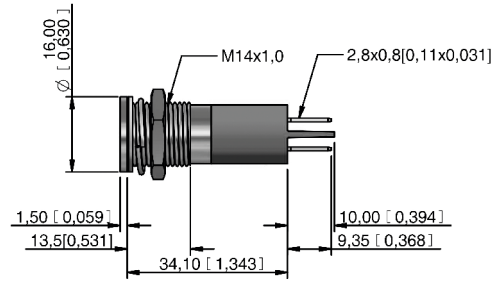

PINS

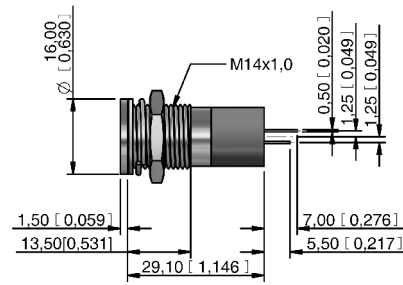

REAR EPOXY PINS

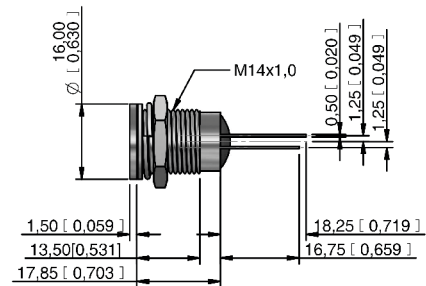

SHORT BODY PINS

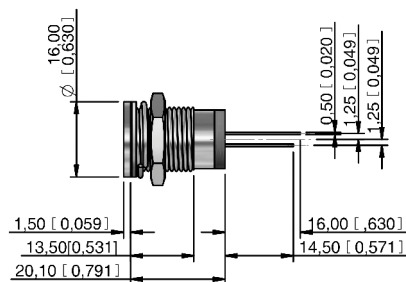

Q14 series

Ø14 mm panel mount LED indicators

RECESSED BEZEL



SOLDER LUG/FASTON

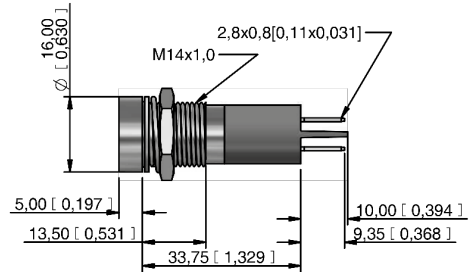

WIRES

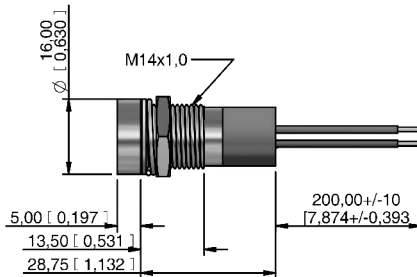

PINS

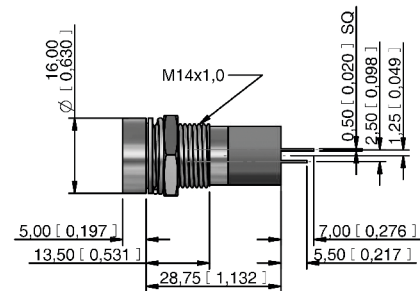

REAR EPOXY WIRES

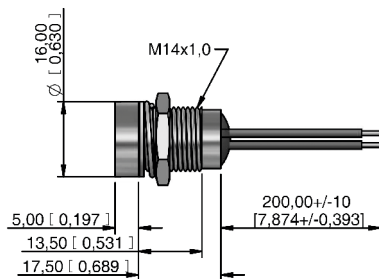

REAR EPOXY PINS

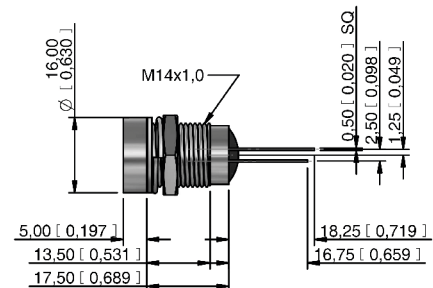

SHORT BODY WIRES

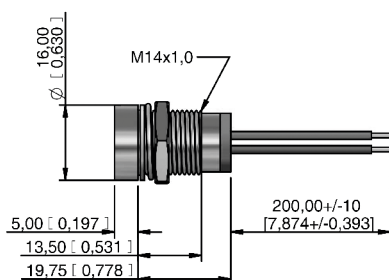

SHORT BODY PINS

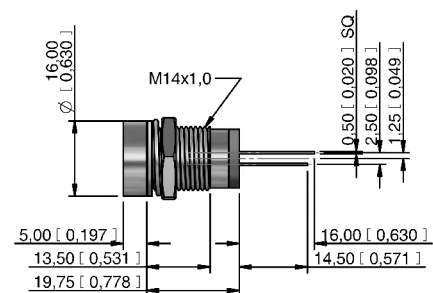





















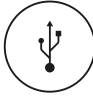

Q14 series

Ø14 mm panel mount LED indicators

CUSTOM ENGRAVING

Some common codes are listed above, for your custom requirements please contact APEM.
Unless specified standard engraving with white infill will be supplied.
Suffix the part number with legend code :

						
High beam -0AJ	Low beam -097	Rear fog -027	Front fog -026	Windscreen wiper -021	Windscreen washer -022	Ventilator fan -023
						
Turn Signal -0AH	Side lights -098	Horn -041	Hazard warning -013	Heating -018	Brake test -0BU	Arrow -0K6
						
Battery -0AG	Oil can -0GP	Windscreen heating -020	ABS -086	Engine coil -0EL	Seat belt -0SB	USB connection -0UB
						
Steam -0ST	ECU -0EU	Side step -0AD	Air con -012	Engine -040	Boot/Trunk Release -0BR	



CABLE LENGTH AND CONNECTOR



For custom cable length and connectors contact APEM.



Компания «ЭлектроПласт» предлагает заключение долгосрочных отношений при поставках импортных электронных компонентов на взаимовыгодных условиях!

Наши преимущества:

- Оперативные поставки широкого спектра электронных компонентов отечественного и импортного производства напрямую от производителей и с крупнейших мировых складов;
- Поставка более 17-ти миллионов наименований электронных компонентов;
- Поставка сложных, дефицитных, либо снятых с производства позиций;
- Оперативные сроки поставки под заказ (от 5 рабочих дней);
- Экспресс доставка в любую точку России;
- Техническая поддержка проекта, помощь в подборе аналогов, поставка прототипов;
- Система менеджмента качества сертифицирована по Международному стандарту ISO 9001;
- Лицензия ФСБ на осуществление работ с использованием сведений, составляющих государственную тайну;
- Поставка специализированных компонентов (Xilinx, Altera, Analog Devices, Intersil, Interpoint, Microsemi, Aeroflex, Peregrine, Syfer, Eurofarad, Texas Instrument, Miteq, Cobham, E2V, MA-COM, Hittite, Mini-Circuits, General Dynamics и др.);

Помимо этого, одним из направлений компании «ЭлектроПласт» является направление «Источники питания». Мы предлагаем Вам помощь Конструкторского отдела:

- Подбор оптимального решения, техническое обоснование при выборе компонента;
- Подбор аналогов;
- Консультации по применению компонента;
- Поставка образцов и прототипов;
- Техническая поддержка проекта;
- Защита от снятия компонента с производства.



Как с нами связаться

Телефон: 8 (812) 309 58 32 (многоканальный)

Факс: 8 (812) 320-02-42

Электронная почта: org@eplast1.ru

Адрес: 198099, г. Санкт-Петербург, ул. Калинина, дом 2, корпус 4, литера А.