

VEJ Series

Features

- 4 ϕ ~ 18 ϕ , 105°C, 2,000 hours assured
- Designed for surface mounting on high density PC board
- RoHS Compliance



Marking color: Black

Specifications

Items	Performance																																																											
Category Temperature Range	6.3 ~ 100V	160 ~ 400V	450V																																																									
	-55°C ~ +105°C	-40°C ~ +105°C	-25°C ~ +105°C																																																									
Capacitance Tolerance	±20% (at 120Hz, 20°C)																																																											
Leakage Current (at 20°C)	<table border="1"> <thead> <tr> <th>Rated voltage</th> <th>6.3 ~ 100V</th> <th>160 ~ 450V</th> </tr> </thead> <tbody> <tr> <td>Time</td> <td colspan="2">after 2 minutes</td> </tr> <tr> <td>Case size</td> <td>4 ~ 10 ϕ</td> <td>12.5 ~ 18 ϕ</td> </tr> <tr> <td>Leakage Current</td> <td>I = 0.01CV or 3μA, whichever is greater</td> <td>I = 0.03CV or 4μA, whichever is greater</td> </tr> </tbody> </table> <p>Where, C = rated capacitance in μF V = rated DC working voltage in V</p>			Rated voltage	6.3 ~ 100V	160 ~ 450V	Time	after 2 minutes		Case size	4 ~ 10 ϕ	12.5 ~ 18 ϕ	Leakage Current	I = 0.01CV or 3 μ A, whichever is greater	I = 0.03CV or 4 μ A, whichever is greater																																													
Rated voltage	6.3 ~ 100V	160 ~ 450V																																																										
Time	after 2 minutes																																																											
Case size	4 ~ 10 ϕ	12.5 ~ 18 ϕ																																																										
Leakage Current	I = 0.01CV or 3 μ A, whichever is greater	I = 0.03CV or 4 μ A, whichever is greater																																																										
Tan δ (at 120Hz, 20°C)	<table border="1"> <thead> <tr> <th>Rated Voltage</th> <th>6.3</th> <th>10</th> <th>16</th> <th>25</th> <th>35</th> <th>50</th> <th>63</th> <th>100</th> <th>160 ~ 250</th> <th>400 ~ 450</th> </tr> </thead> <tbody> <tr> <td>4 ~ 10 ϕ</td> <td>0.45</td> <td>0.35</td> <td>0.28</td> <td>0.18</td> <td>0.16</td> <td>0.14</td> <td>0.12</td> <td>0.12</td> <td>-</td> <td>-</td> </tr> <tr> <td>12.5 ~ 18 ϕ</td> <td>0.40</td> <td>0.38</td> <td>0.34</td> <td>0.26</td> <td>0.22</td> <td>0.18</td> <td>0.14</td> <td>0.10</td> <td>0.20</td> <td>0.25</td> </tr> </tbody> </table> <p>When the capacitance exceeds 1,000μF, 0.02 shall be added every 1,000μF increase.</p>			Rated Voltage	6.3	10	16	25	35	50	63	100	160 ~ 250	400 ~ 450	4 ~ 10 ϕ	0.45	0.35	0.28	0.18	0.16	0.14	0.12	0.12	-	-	12.5 ~ 18 ϕ	0.40	0.38	0.34	0.26	0.22	0.18	0.14	0.10	0.20	0.25																								
Rated Voltage	6.3	10	16	25	35	50	63	100	160 ~ 250	400 ~ 450																																																		
4 ~ 10 ϕ	0.45	0.35	0.28	0.18	0.16	0.14	0.12	0.12	-	-																																																		
12.5 ~ 18 ϕ	0.40	0.38	0.34	0.26	0.22	0.18	0.14	0.10	0.20	0.25																																																		
Low Temperature Characteristics (at 120Hz)	<p>Impedance ratio shall not exceed the values given in the table below.</p> <table border="1"> <thead> <tr> <th colspan="2">Rated Voltage</th> <th>6.3</th> <th>10</th> <th>16</th> <th>25</th> <th>35</th> <th>50</th> <th>63</th> <th>100</th> <th>160 ~ 250</th> <th>400 ~ 450</th> </tr> </thead> <tbody> <tr> <td rowspan="4">Impedance Ratio</td> <td>Z(-25°C)</td> <td>$\phi D < 12.5$</td> <td>4</td> <td>4</td> <td>3</td> <td>2</td> <td>2</td> <td>2</td> <td>2</td> <td>3</td> <td>-</td> </tr> <tr> <td>/Z(+20°C)</td> <td>$\phi D \geq 12.5$</td> <td>5</td> <td>4</td> <td>3</td> <td>2</td> <td>2</td> <td>2</td> <td>2</td> <td>3</td> <td>6</td> </tr> <tr> <td>Z(-55/-40°C)</td> <td>$\phi D < 12.5$</td> <td>12</td> <td>8</td> <td>6</td> <td>4</td> <td>3</td> <td>3</td> <td>3</td> <td>4</td> <td>-</td> </tr> <tr> <td>/Z(+20°C)</td> <td>$\phi D \geq 12.5$</td> <td>10</td> <td>8</td> <td>6</td> <td>4</td> <td>3</td> <td>3</td> <td>3</td> <td>3</td> <td>10</td> </tr> </tbody> </table>			Rated Voltage		6.3	10	16	25	35	50	63	100	160 ~ 250	400 ~ 450	Impedance Ratio	Z(-25°C)	$\phi D < 12.5$	4	4	3	2	2	2	2	3	-	/Z(+20°C)	$\phi D \geq 12.5$	5	4	3	2	2	2	2	3	6	Z(-55/-40°C)	$\phi D < 12.5$	12	8	6	4	3	3	3	4	-	/Z(+20°C)	$\phi D \geq 12.5$	10	8	6	4	3	3	3	3	10
Rated Voltage		6.3	10	16	25	35	50	63	100	160 ~ 250	400 ~ 450																																																	
Impedance Ratio	Z(-25°C)	$\phi D < 12.5$	4	4	3	2	2	2	2	3	-																																																	
	/Z(+20°C)	$\phi D \geq 12.5$	5	4	3	2	2	2	2	3	6																																																	
	Z(-55/-40°C)	$\phi D < 12.5$	12	8	6	4	3	3	3	4	-																																																	
	/Z(+20°C)	$\phi D \geq 12.5$	10	8	6	4	3	3	3	3	10																																																	
Endurance	<table border="1"> <thead> <tr> <th>Test Time</th> <th>2,000 Hrs</th> </tr> </thead> <tbody> <tr> <td>Capacitance Change</td> <td>Within ±25% of initial value for $\phi D \leq 6.3$mm; Within ±20% of initial value for $\phi D \geq 8$mm</td> </tr> <tr> <td>Tanδ</td> <td>Less than 300% of specified value for $\phi D \leq 6.3$mm; Less than 200% of specified value for $\phi D \geq 8$mm</td> </tr> <tr> <td>Leakage Current</td> <td>Within specified value</td> </tr> </tbody> </table> <p>* The above Specifications shall be satisfied when the capacitors are restored to 20°C after the rated voltage applied for 2,000 hours at 105°C.</p>			Test Time	2,000 Hrs	Capacitance Change	Within ±25% of initial value for $\phi D \leq 6.3$ mm; Within ±20% of initial value for $\phi D \geq 8$ mm	Tan δ	Less than 300% of specified value for $\phi D \leq 6.3$ mm; Less than 200% of specified value for $\phi D \geq 8$ mm	Leakage Current	Within specified value																																																	
Test Time	2,000 Hrs																																																											
Capacitance Change	Within ±25% of initial value for $\phi D \leq 6.3$ mm; Within ±20% of initial value for $\phi D \geq 8$ mm																																																											
Tan δ	Less than 300% of specified value for $\phi D \leq 6.3$ mm; Less than 200% of specified value for $\phi D \geq 8$ mm																																																											
Leakage Current	Within specified value																																																											
Shelf Life Test	<p>Test time: 1,000 hours; other items are the same as those for the Endurance. The rated voltage shall be applied to the capacitors before the measurements for 160 ~ 450V (Refer to JIS C 5101-4 4.1).</p>																																																											
Ripple Current & Frequency Multipliers	<table border="1"> <thead> <tr> <th rowspan="2">Cap. (μF)</th> <th colspan="4">Freq. (Hz)</th> </tr> <tr> <th>50</th> <th>120</th> <th>1k</th> <th>10k up</th> </tr> </thead> <tbody> <tr> <td>Under 1,000</td> <td>0.80</td> <td>1.00</td> <td>1.25</td> <td>1.40</td> </tr> <tr> <td>1,000 < C \leq 8,200</td> <td>0.85</td> <td>1.00</td> <td>1.15</td> <td>1.25</td> </tr> </tbody> </table>			Cap. (μ F)	Freq. (Hz)				50	120	1k	10k up	Under 1,000	0.80	1.00	1.25	1.40	1,000 < C \leq 8,200	0.85	1.00	1.15	1.25																																						
Cap. (μ F)	Freq. (Hz)																																																											
	50	120	1k	10k up																																																								
Under 1,000	0.80	1.00	1.25	1.40																																																								
1,000 < C \leq 8,200	0.85	1.00	1.15	1.25																																																								

Diagram of Dimensions

Fig. 1

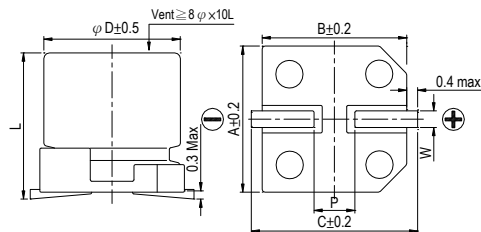

Fig. 2



Lead Spacing and Diameter

Unit: mm

ϕD	L	A	B	C	W	P ± 0.2	Fig. No.
4	5.7 ± 0.3	4.3	4.3	5.1	0.5 ~ 0.8	1.0	1
5	5.7 ± 0.3	5.3	5.3	5.9	0.5 ~ 0.8	1.5	1
6.3	5.7 ± 0.3	6.6	6.6	7.2	0.5 ~ 0.8	2.0	1
6.3	7.7 ± 0.3	6.6	6.6	7.2	0.5 ~ 0.8	2.0	1
8	6.5 ± 0.3	8.4	8.4	9.0	0.5 ~ 0.8	2.3	1
8	10 ± 0.5	8.4	8.4	9.0	0.7 ~ 1.1	3.1	1
10	7.7 ± 0.3	10.4	10.4	11.0	0.7 ~ 1.3	4.7	1
10	10 ± 0.5	10.4	10.4	11.0	0.7 ~ 1.3	4.7	1
12.5	13.5 ± 0.5	13.0	13.0	13.7	1.1 ~ 1.4	4.4	2
12.5	16 ± 0.5	13.0	13.0	13.7	1.1 ~ 1.4	4.4	2
16	16.5 ± 0.5	17.0	17.0	18.0	1.1 ~ 1.4	6.4	2
16	21.5 ± 0.5	17.0	17.0	18.0	1.1 ~ 1.4	6.4	2
18	16.5 ± 0.5	19.0	19.0	20.0	1.1 ~ 1.4	6.4	2
18	21.5 ± 0.5	19.0	19.0	20.0	1.1 ~ 1.4	6.4	2

Marking

$\phi D \leq 6.3 \text{ mm}$

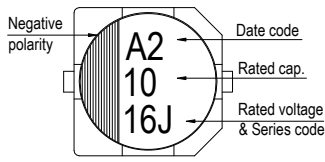

$\phi D = 8 \sim 10 \text{ mm}$



$\phi D \geq 12.5 \text{ mm}$



Dimension & Permissible Ripple Current

Dimension: $\phi D \times L$ (mm)

Ripple Current: mA/rms at 120 Hz, 105°C

V. DC	μF	Contents	6.3V (0J)		10V (1A)		16V (1C)		25V (1E)		35V (1V)		50V (1H)		63V (1J)		100V (2A)		
			$\phi D \times L$	mA	$\phi D \times L$	mA	$\phi D \times L$	mA	$\phi D \times L$	mA	$\phi D \times L$	mA	$\phi D \times L$	mA	$\phi D \times L$	mA	$\phi D \times L$	mA	
1	010												4×5.7	8	4×5.7	8			
2.2	2R2												4×5.7	12	4×5.7	12			
3.3	3R3												4×5.7	14	5×5.7	17			
4.7	4R7								4×5.7	17	4×5.7	17	5×5.7	20	6.3×5.7	22			
10	100					4×5.7	20	4×5.7	20	5×5.7	27	6.3×5.7	32	6.3×5.7	32	8×6.5	51		
22	220	4×5.7	22	4×5.7	22	5×5.7	30	5×5.7	30	6.3×5.7	44	6.3×5.7	38	8×6.5	67	6.3×7.7	58	8×10	100
33	330	5×5.7	34	5×5.7	34	5×5.7	34	6.3×5.7	46	6.3×5.7	46	8×6.5	76	6.3×7.7	65	8×10	140	10×10	150
47	470	5×5.7	38	5×5.7	38	6.3×5.7	48	6.3×5.7	48	8×6.5	79	6.3×7.7	80	6.3×7.7	70	8×10	170	12.5×13.5	250
100	101	6.3×5.7	69	6.3×5.7	69	6.3×5.7	69	6.3×7.7	100	8×10	240	8×10	210	10×10	310	12.5×13.5	380		
220	221	6.3×7.7	120	6.3×7.7	120	6.3×7.7	120	8×10	270	10×7.7	270	8×10	270	10×10	330	12.5×13.5	470	16×16.5	450
330	331	8×10	290	8×10	290	8×10	290	10×7.7	290	8×10	290	10×10	370	12.5×13.5	490	16×16.5	650	18×16.5	590
470	471	8×10	320	8×10	320	10×10	380	10×10	380	12.5×13.5	520	12.5×16	550	16×16.5	700	18×21.5	980		
1,000	102	10×10	410	10×10	410	12.5×13.5	550	12.5×16	550	16×16.5	800	18×16.5	990						
2,200	222	12.5×13.5	680	12.5×13.5	680	16×16.5	900	16×16.5	900	18×16.5	1,050								
3,300	332	12.5×16	850	16×16.5	950	16×16.5	950	18×16.5	1,150	16×21.5									
4,700	472	16×16.5	1,000	16×16.5	1,000	18×16.5	1,225	16×21.5	1,275	18×21.5	1,300								
6,800	682	18×16.5	1,290	18×16.5	1,290														
8,200	822	16×21.5	1,450	18×21.5	1,450														

V. DC	μF	Contents	160V (2C)		200V (2D)		250V (2E)		400V (2G)		450V (2W)	
			$\phi D \times L$	mA	$\phi D \times L$	mA	$\phi D \times L$	mA	$\phi D \times L$	mA	$\phi D \times L$	mA
4.7	4R7					12.5×13.5	65	12.5×13.5	45	12.5×13.5	45	
10	100			12.5×13.5	80	12.5×13.5	70	12.5×13.5	50	12.5×16	75	
22	220			12.5×16	110	12.5×13.5	105	16×16.5	85	16×16.5	85	
33	330	12.5×13.5	95	12.5×16	120	16×16.5	180	18×16.5	100	18×16.5	100	
47	470	16×16.5	240	16×16.5	220	16×16.5	220	18×21.5	130			
100	101	16×16.5	250	18×16.5	280	18×16.5	260					

Part Numbering System

VEJ series 470 μF $\pm 20\%$ 6.3V Carrier Tape 8 $\phi \times 10L$ Pb-free and PET coating case

VEJ **471** **M** **OJ** **TR** - **0810**

Series name Capacitance Capacitance Tolerance Rated Voltage Package Type Terminal Type Case size Lead Wire and Coating Type

Note: For more details, please refer to "Part Numbering System (SMD Type)" on page 12.



Компания «ЭлектроПласт» предлагает заключение долгосрочных отношений при поставках импортных электронных компонентов на взаимовыгодных условиях!

Наши преимущества:

- Оперативные поставки широкого спектра электронных компонентов отечественного и импортного производства напрямую от производителей и с крупнейших мировых складов;
- Поставка более 17-ти миллионов наименований электронных компонентов;
- Поставка сложных, дефицитных, либо снятых с производства позиций;
- Оперативные сроки поставки под заказ (от 5 рабочих дней);
- Экспресс доставка в любую точку России;
- Техническая поддержка проекта, помощь в подборе аналогов, поставка прототипов;
- Система менеджмента качества сертифицирована по Международному стандарту ISO 9001;
- Лицензия ФСБ на осуществление работ с использованием сведений, составляющих государственную тайну;
- Поставка специализированных компонентов (Xilinx, Altera, Analog Devices, Intersil, Interpoint, Microsemi, Aeroflex, Peregrine, Syfer, Eurofarad, Texas Instrument, Miteq, Cobham, E2V, MA-COM, Hittite, Mini-Circuits, General Dynamics и др.);

Помимо этого, одним из направлений компании «ЭлектроПласт» является направление «Источники питания». Мы предлагаем Вам помощь Конструкторского отдела:

- Подбор оптимального решения, техническое обоснование при выборе компонента;
- Подбор аналогов;
- Консультации по применению компонента;
- Поставка образцов и прототипов;
- Техническая поддержка проекта;
- Защита от снятия компонента с производства.



Как с нами связаться

Телефон: 8 (812) 309 58 32 (многоканальный)

Факс: 8 (812) 320-02-42

Электронная почта: org@eplast1.ru

Адрес: 198099, г. Санкт-Петербург, ул. Калинина, дом 2, корпус 4, литера А.