

10119189 - X0C - XXXLF

6-COLUMN
DIFFERENTIAL
SIGNAL

LEAD-FREE DESIGNATION
ONLY WITH APPLICABLE
PLATING CODES

| LETTER | PERFORMANCE-BASED PLATING (SEE NOTE 2) | |
|--------|--|----------------|
| | TARGET APPLICATION | LEAD-FREE (LF) |
| B | TELCORDIA CO | NO |
| C | TELCORDIA UE | NO |
| D | TELCORDIA CO | YES |
| E | TELCORDIA UE | YES |

| NUMBER | GUIDE PIN STYLE, HEIGHT |
|--------|-------------------------------------|
| 0 | STANDARD GUIDE PIN MACHINED, 31.6mm |
| 4 | STANDARD GUIDE PIN MACHINED, 25.7mm |

| NUMBER | CONTACT MATING WIPE LENGTH | | COMPLIANT PIN DRILL SIZE |
|--------|----------------------------|--------|-----------------------------|
| | SIGNAL | GROUND | |
| 1 | 2 | 4 | Ø0.55 [0.0217"] |
| 2 | 3 | 4 | Ø0.55 [0.0217"] |
| 3 | 2 | 4 | Ø0.45 [0.0177"] |
| 4 | 3 | 4 | Ø0.45 [0.0177"] |
| 5 | 2 | 3 | Ø0.55 [0.0217"] |
| 6 | 3 | 3 | Ø0.55 [0.0217"] |
| 7 | 2 | 3 | Ø0.45 [0.0177"] |
| 8 | 3 | 3 | Ø0.45 [0.0177"] |

| MODULE DESCRIPTION | LETTER DESIGNATION REPRESENTED IN DASH NUMBER | | | | | | | | | BASE MODULE |
|--|---|---|---|---|---|---|---|---|---|-------------|
| LEFT POLARIZING GUIDANCE MODULE (SEE SHEET 3) | J | A | B | C | D | E | F | G | H | |
| | | | | | | | | | | |
| RIGHT POLARIZING GUIDANCE MODULE (SEE SHEET 4) | Y | P | Q | R | S | T | U | V | W | |
| | | | | | | | | | | |
| OPEN MODULE (TWO WALL) (SEE SHEET 2) | 0 (ZERO) | | | | | | | | | |
| LEFT WALL MODULE (SEE SHEET 5) | L | | | | | | | | | |
| RIGHT WALL MODULE (SEE SHEET 6) | M | | | | | | | | | |
| FOUR WALL MODULE (SEE SHEET 7) | 1 (ONE) | | | | | | | | | |

TABLE 1: OPTIONAL PCB HOLE SIZE (SEE NOTE 11)

| | GROUNDED | UNGROUNDED |
|---------------|------------|------------|
| FINISHED | Ø2.35-2.55 | Ø2.35-2.55 |
| PAD | Ø5.50 | N/A |
| PLATED | YES | NO |
| DRILL (mm/in) | 2.58/.1015 | 2.44/.096 |

TABLE 2: OPTIONAL SCREW TYPE (SEE NOTE 10)

| SCREW P/N | DESCRIPTION | BOARD THICKNESS |
|----------------|---|-----------------|
| 10091790-002LF | #2.56 X .375" PHILIPS PANHEAD W/SQ CONICAL WASHER | 1.60 - 5.00 |
| 10091790-003LF | #2.56 X .500" PHILIPS PANHEAD W/SQ CONICAL WASHER | 5.00 - 10.00 |

| | | | | | | | | | | |
|---------------|------------|------|---------------|------------|----------------|-------|----------|------------------------|--------------|----------|
| spec ref | - | dr | Roger Ng | 2011/1/22 | projection | MM | size | A2 | scale | 4:1 |
| tolerance std | ASME Y14.5 | eng | Sandar Soe | 2014/10/02 | chr | - | ecn no | ELX-S-18843-1 | rel level | Released |
| surface | ✓ | appr | Chen-Hong Tan | 2014/12/10 | product family | XCEDE | cat. no. | Product - Customer Drw | sheet 1 of 8 | rev |
| ASME Y14.5 | linear | 0.X | ±0.2 | 0.XX | ±0.10 | 0.XXX | ±0.050 | angular | 0° | ±2° |

MODULE ASSEMBLY
 VERTICAL HEADER, 6 COLUMN, 3 PAIR
 10119189
B

Copyright FCI.

OPEN (2- WALL) MODULE

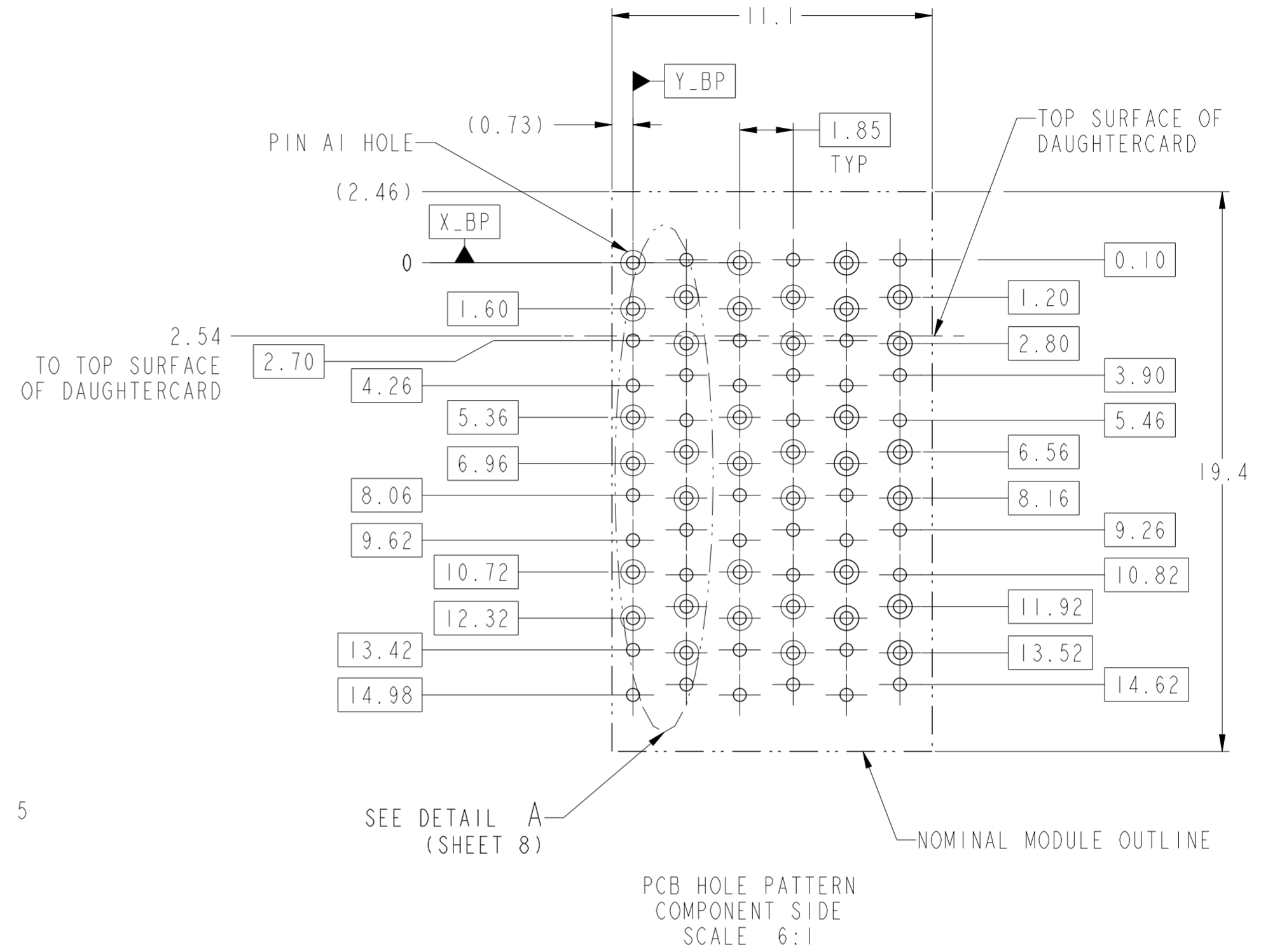
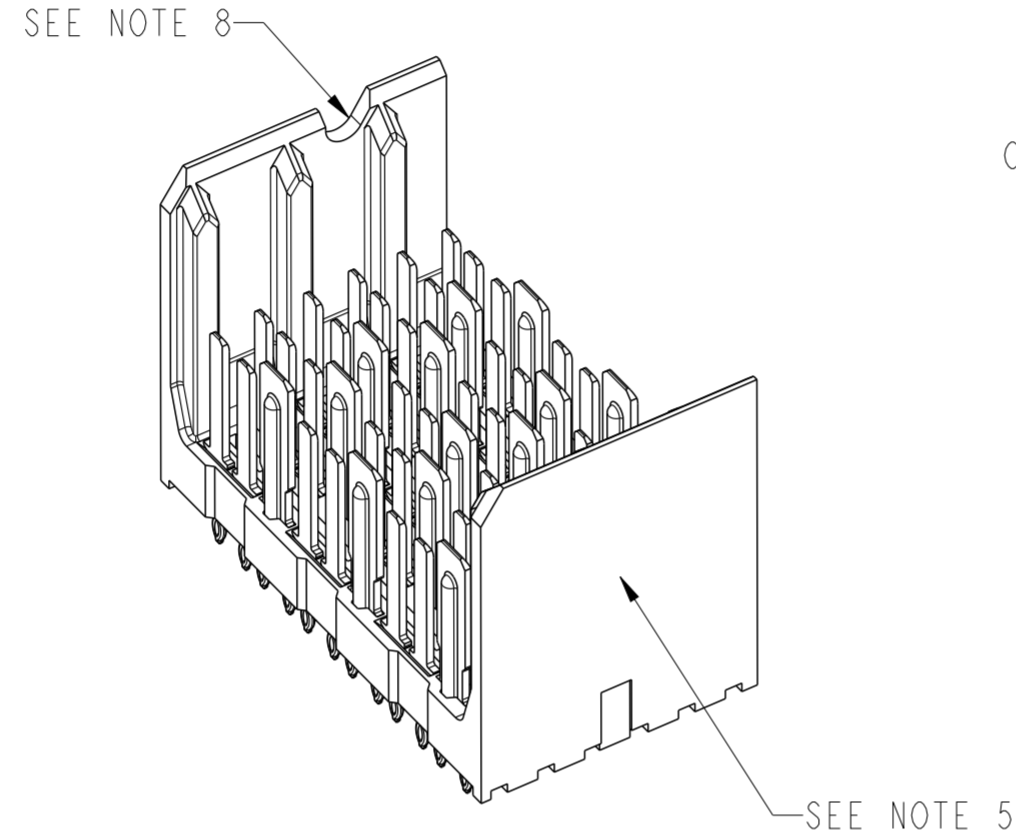
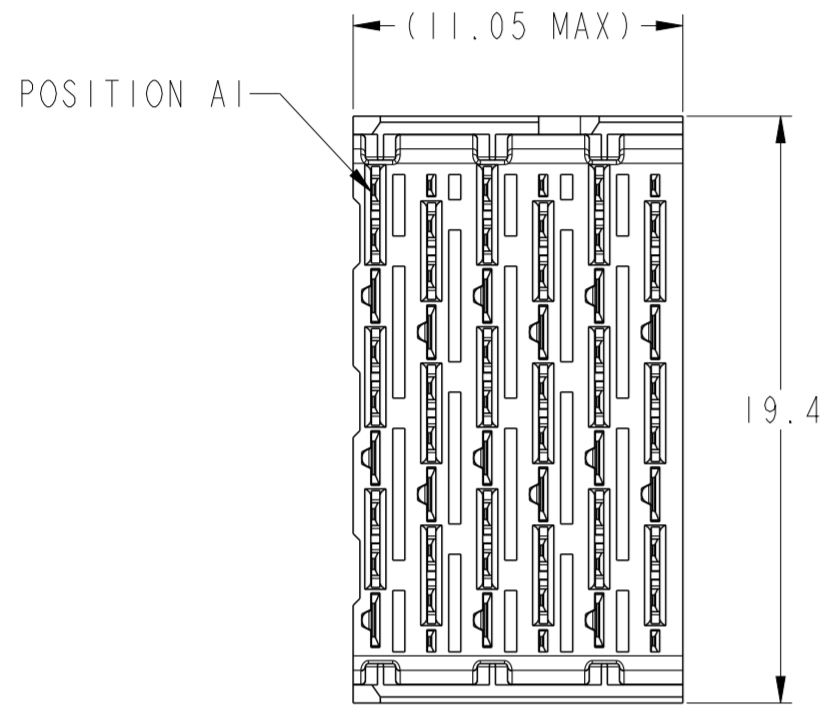

6.2 (4MM WIPE WIDE GROUNDS)
5.2 (3MM WIPE WIDE GROUNDS)

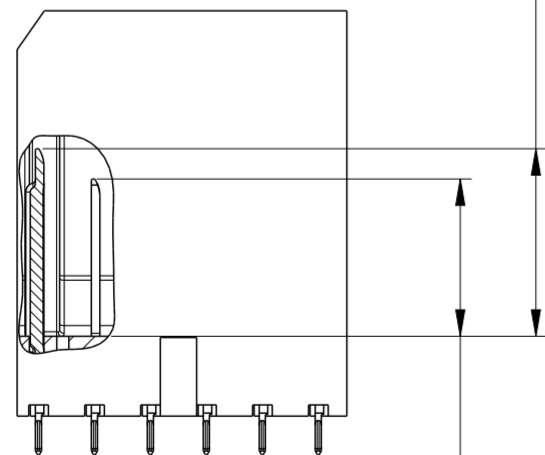

5.2 (3MM SMALL END GROUNDS)
5.2 (3MM WIPE SIGNALS)
4.2 (2MM WIPE SIGNALS)
SEE P/N TREE

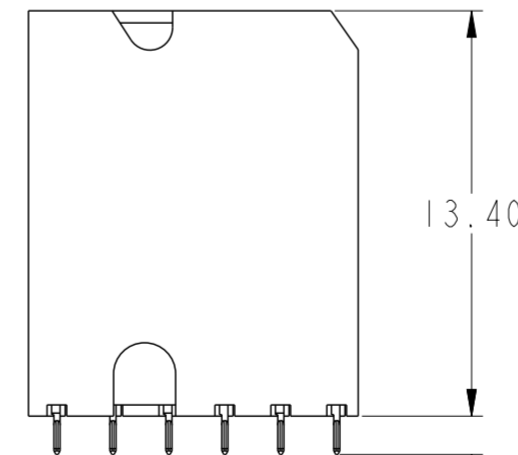
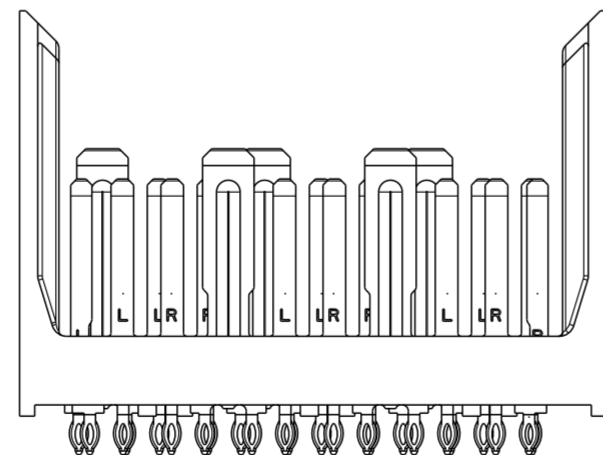

| | | | | | | | | | | | |
|---------------------------------------|------------|---------|------------|------------|------------|---|---------------|---------------|------------------------|--------------------------|--|
| spec ref | - | dr | Roger Ng | 2011/11/22 | projection | MM | size | A2 | scale | 4:1 | |
| tolerance std | ASME Y14.5 | eng | Sandar Soe | 2014/10/02 | | | ecn no | ELX-S-18843-1 | | | |
| TOLERANCES UNLESS OTHERWISE SPECIFIED | | chr | - | appr | | | Chen-Hong Tan | 2014/12/10 | product family | XCEDR rel level Released | |
| surface | ASME Y14.5 | linear | 0.X | ±0.2 | | MODULE ASSEMBLY VERTICAL HEADER, 6 COLUMN, 3 PAIR | dwg no | 10119189 | | | |
| | | angular | 0° | ±2° | | | www.fci.com | cat. no. | Product - Customer Drw | | |
| | | | | | | | | | rev | B | |

LEFT POLARIZING/GUIDE MODULE

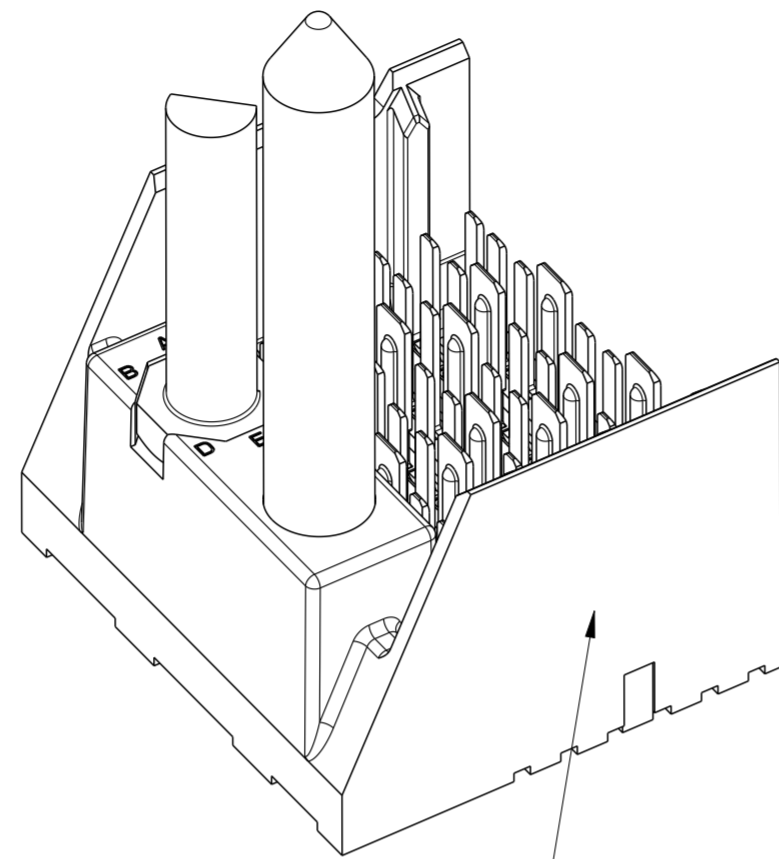
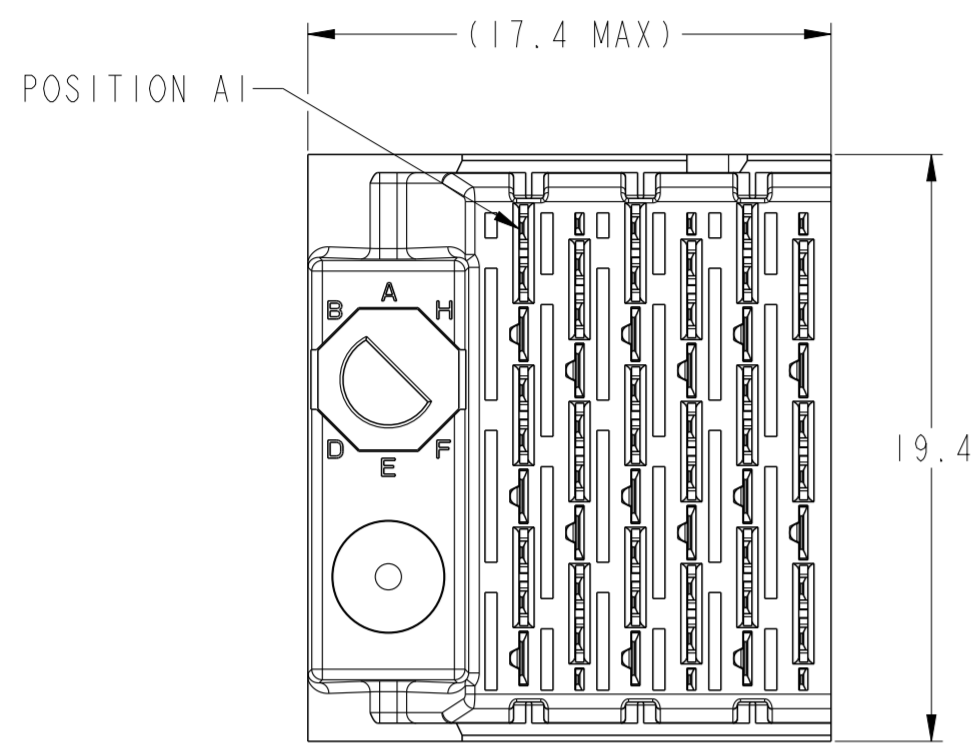

SEE NOTE 5

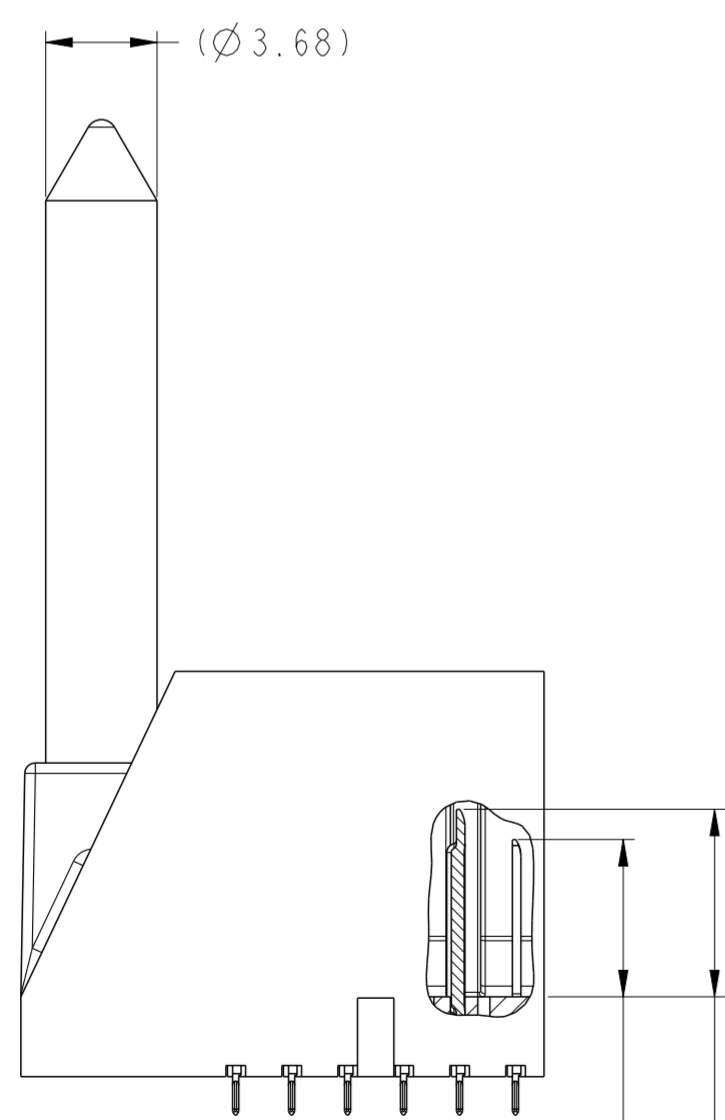
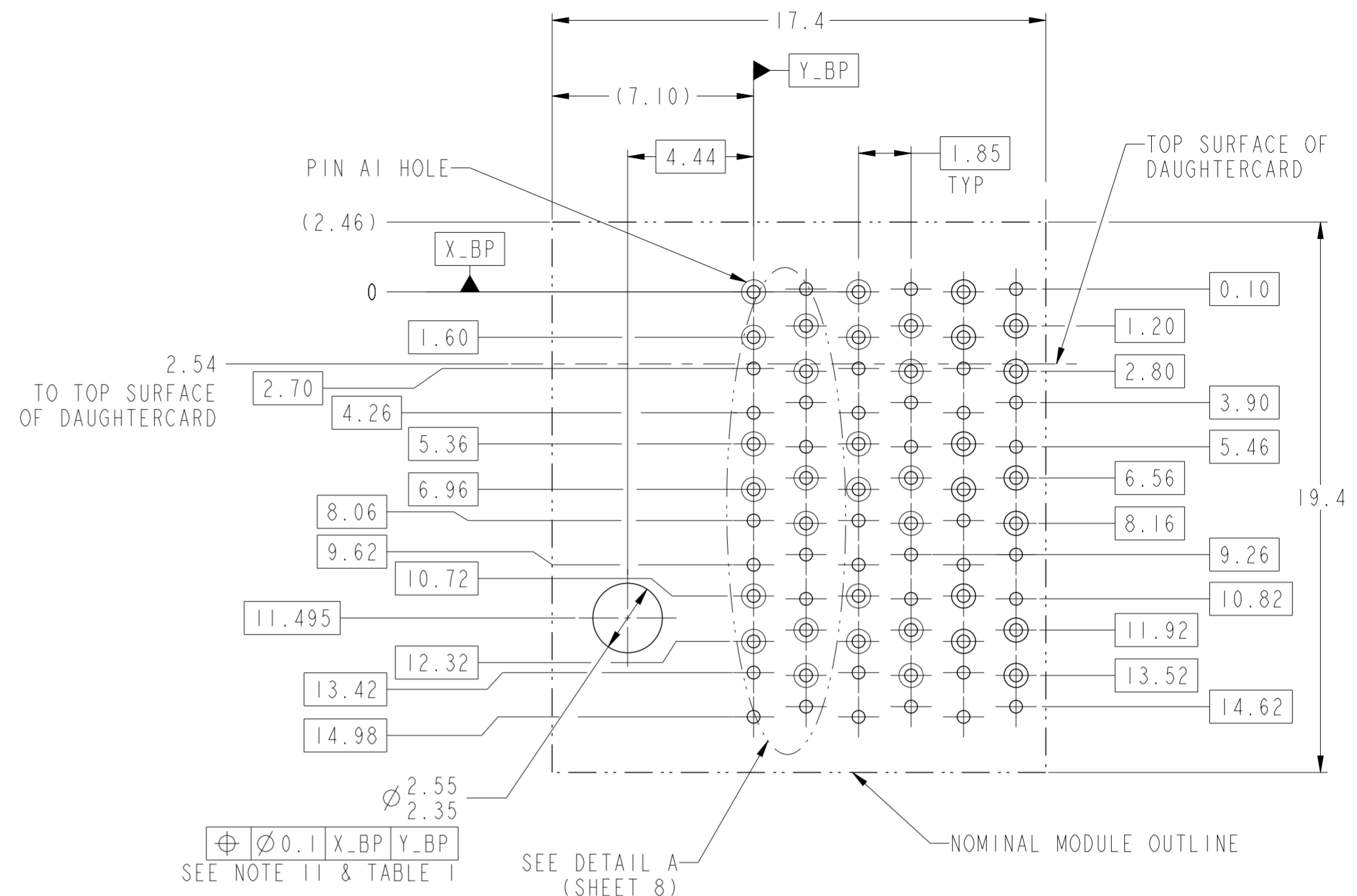

5.2 (3MM SMALL END GROUNDS)
 5.2 (3MM WIPE SIGNALS)
 4.2 (2MM WIPE SIGNALS)
 SEE P/N TREE
 6.2 (4MM WIPE WIDE GROUNDS)
 5.2 (3MM WIPE WIDE GROUNDS)

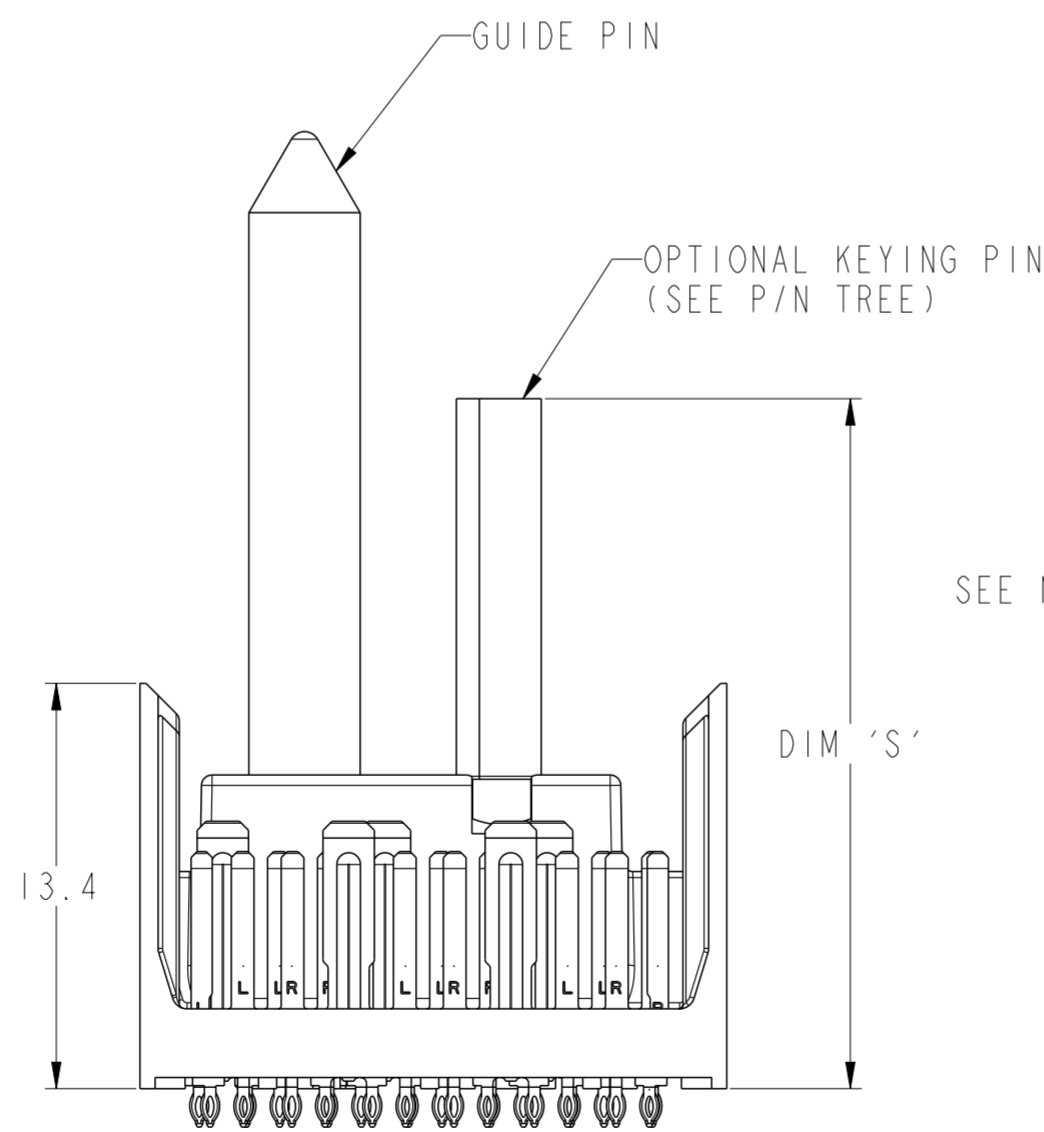

SEE NOTE 8

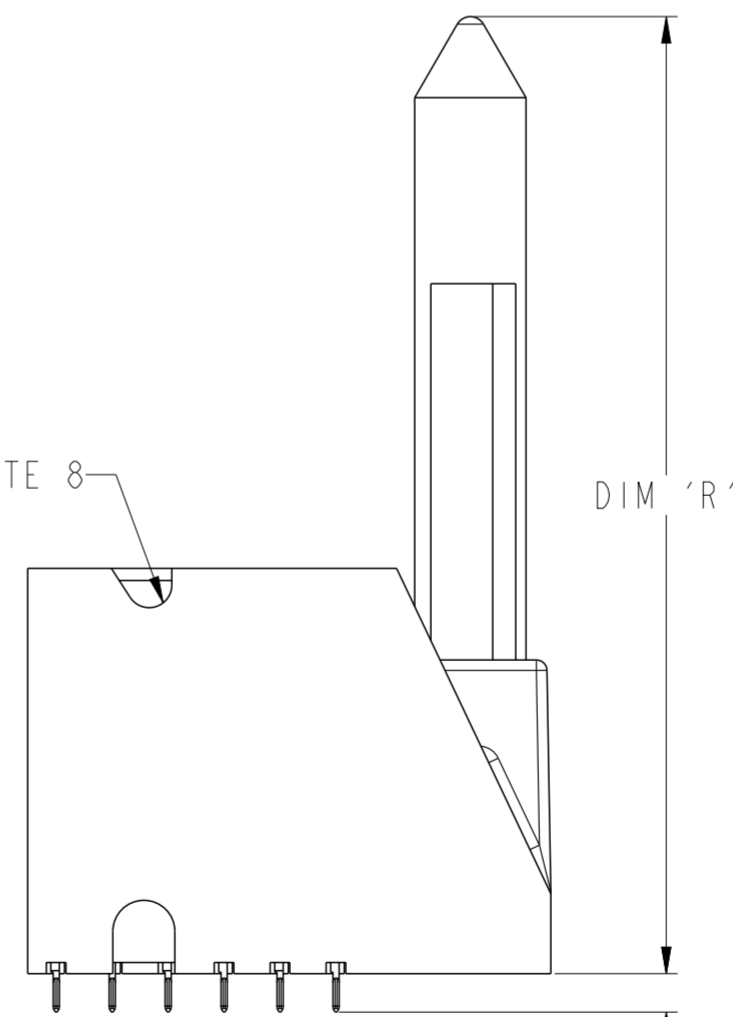

| ASSEMBLY BASE CONFIGURATION END DASH NO. | GUIDE PIN | POLARIZING KEY |
|--|-----------|----------------|
| | DIM 'R' | DIM 'S' |
| -X0X | 31.6mm | 22.8mm |
| -X4X | 25.7mm | 20.0mm |

| | | | | | | | | | | |
|---------------------------------------|------------|-----|------------|-----------------|------------|----------|--------|-------------------------|-----------|--------------|
| spec ref | - | dr | Roger Ng | 2011/1/22 | projection | MM | size | A2 | scale | 4:1 |
| tolerance std | ASME Y14.5 | eng | Sandar Soe | 2014/10/02 | chr | - | ecn no | ELX-S-18843-1 | rel level | Released |
| surface | linear | 0.X | ±0.2 | 0.XX | ±0.10 | 0.XXX | ±0.050 | angular | 0° | ±2° |
| TOLERANCES UNLESS OTHERWISE SPECIFIED | | FCI | | MODULE ASSEMBLY | | 10119189 | | Product - Customer Draw | | sheet 3 of 8 |

RIGHT POLARIZING/GUIDE MODULE

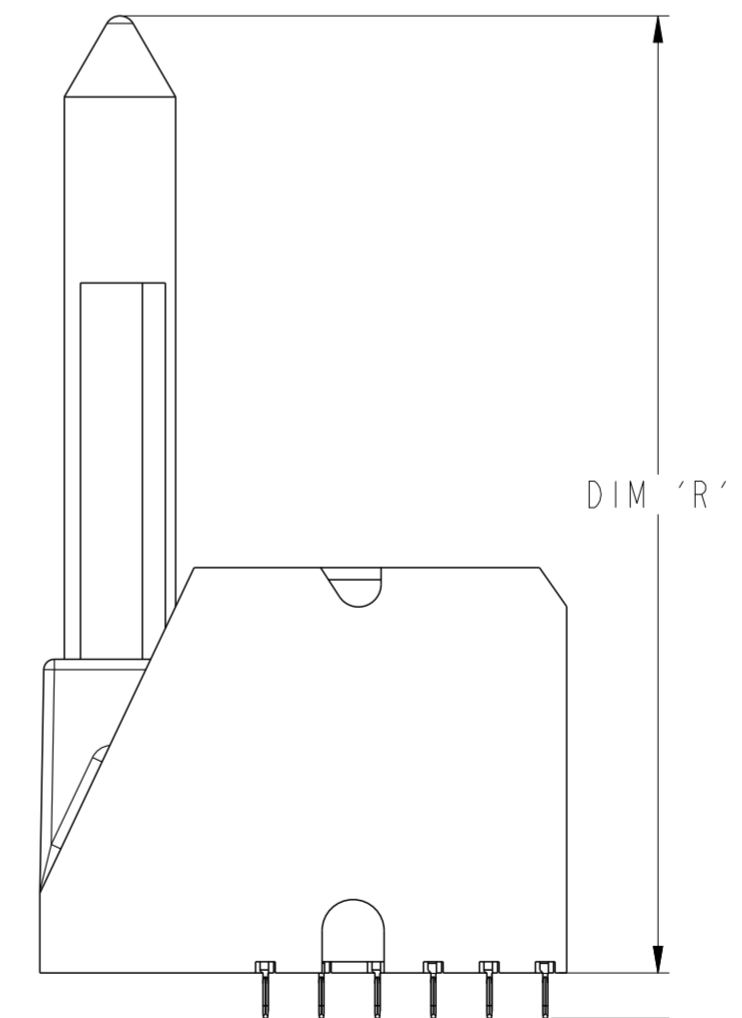
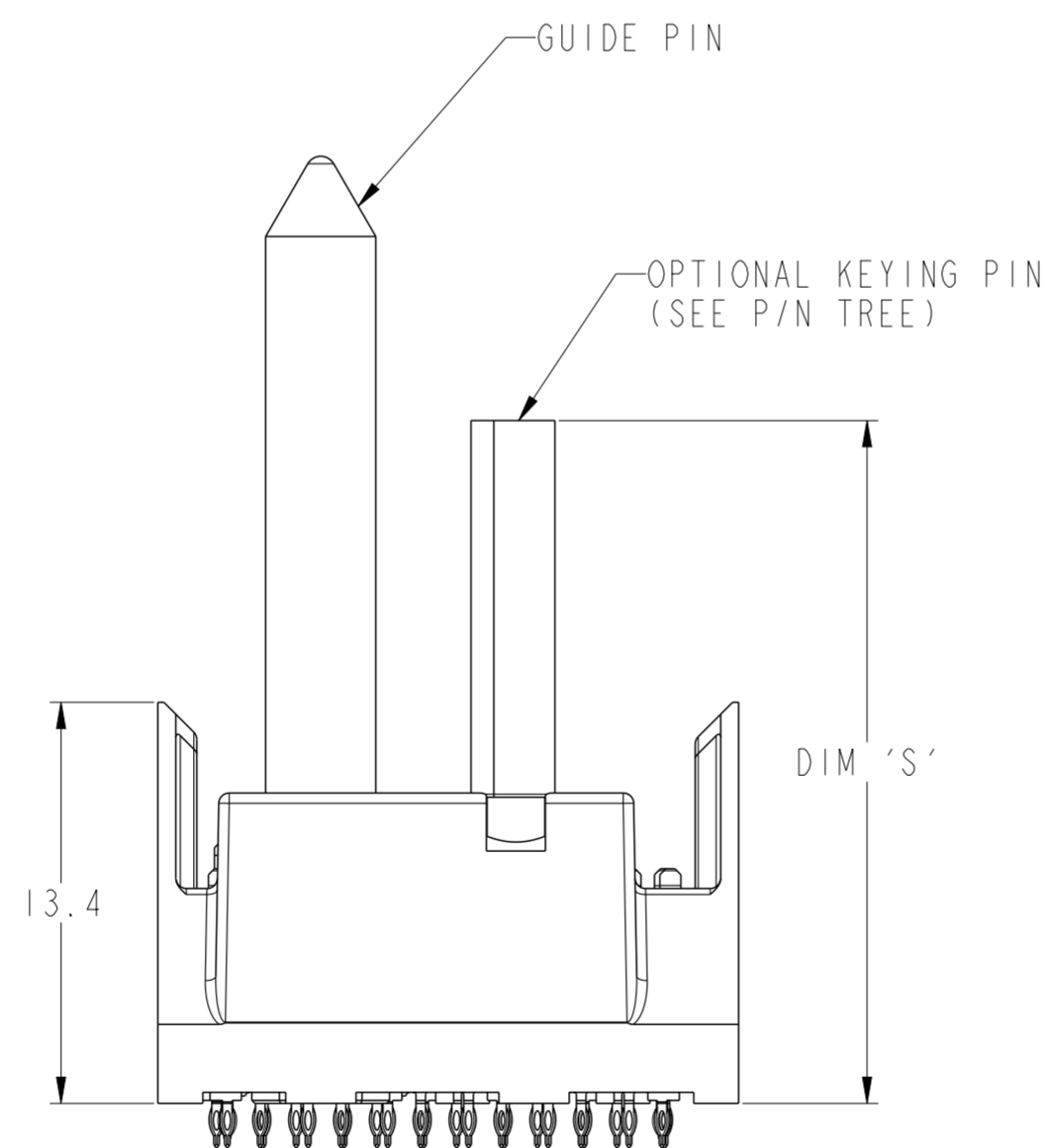
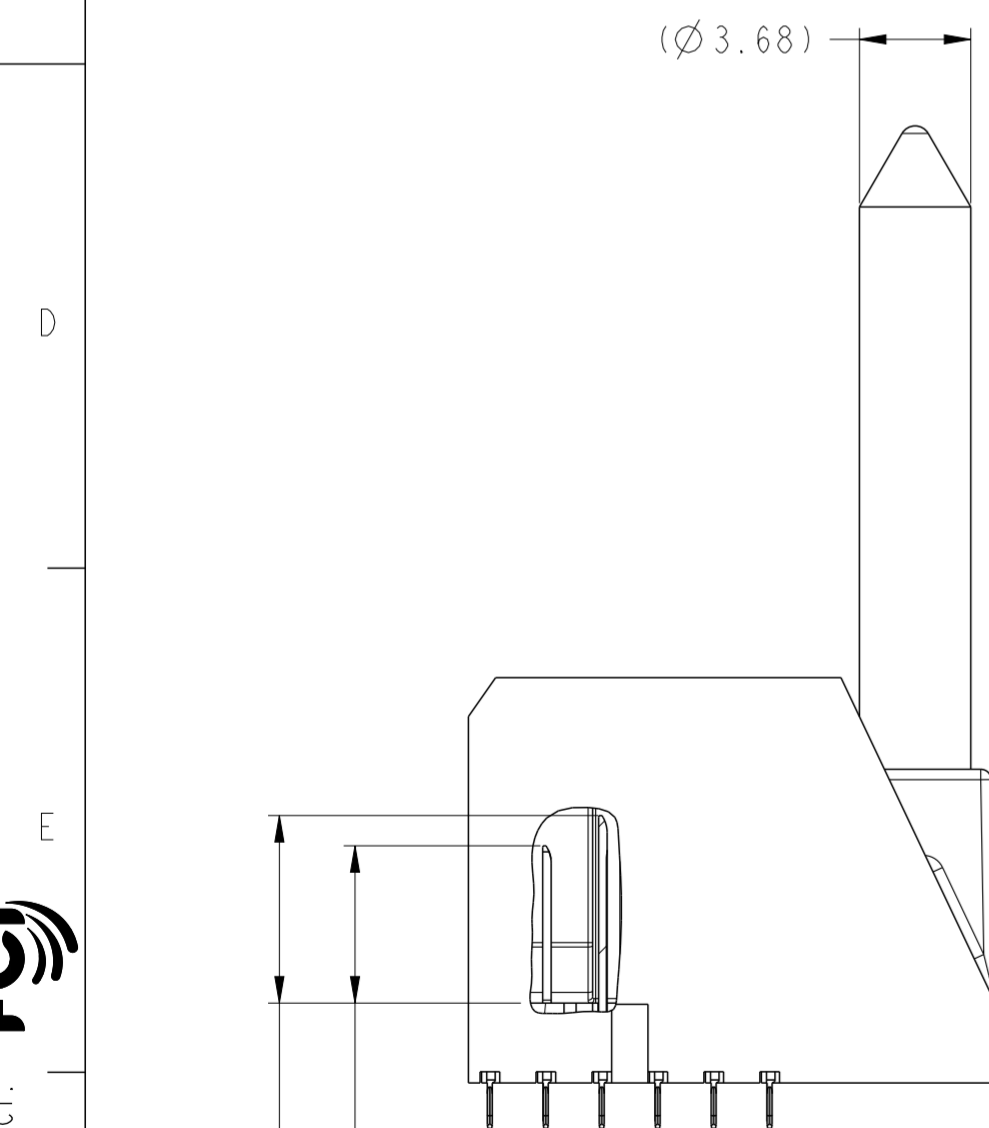
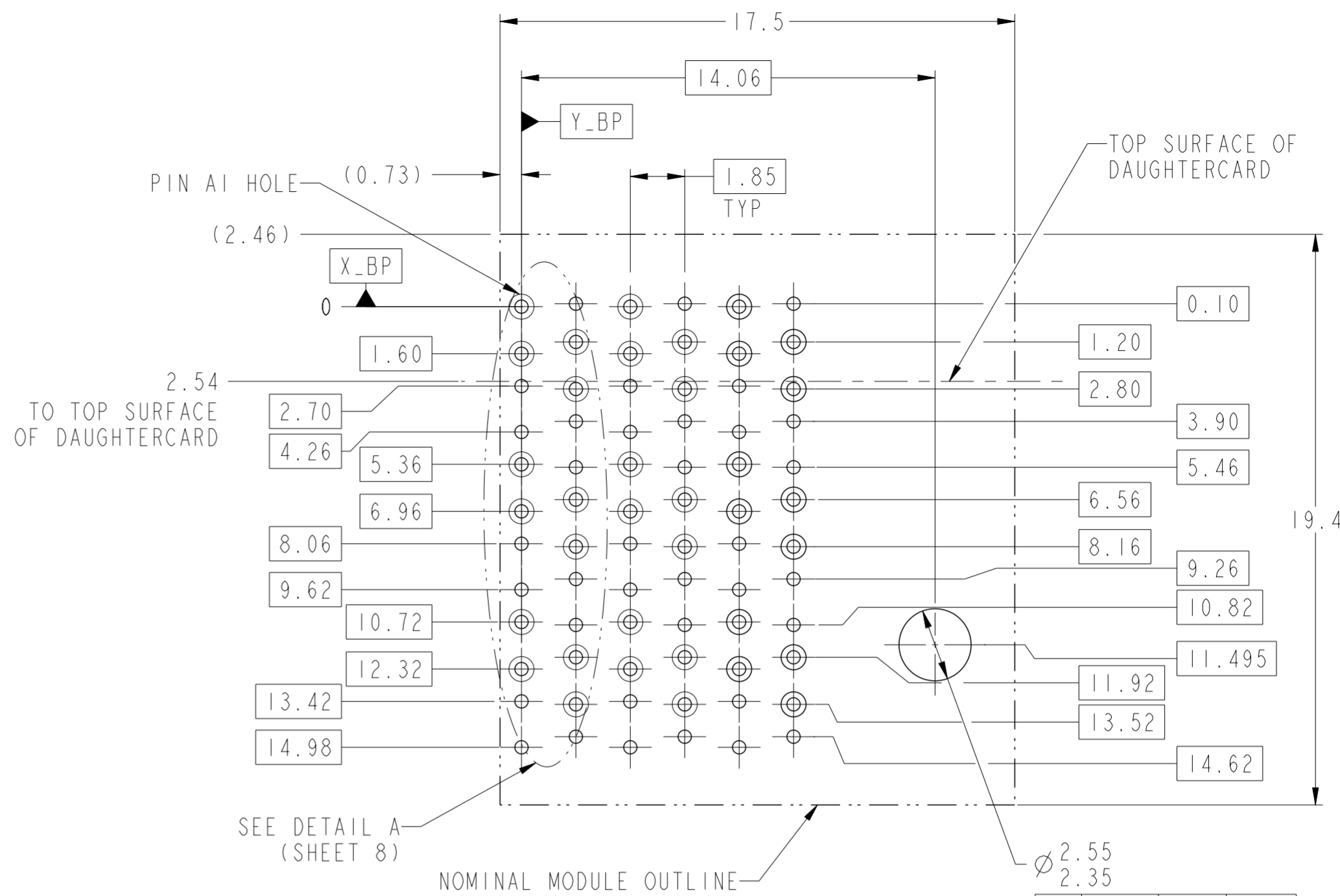
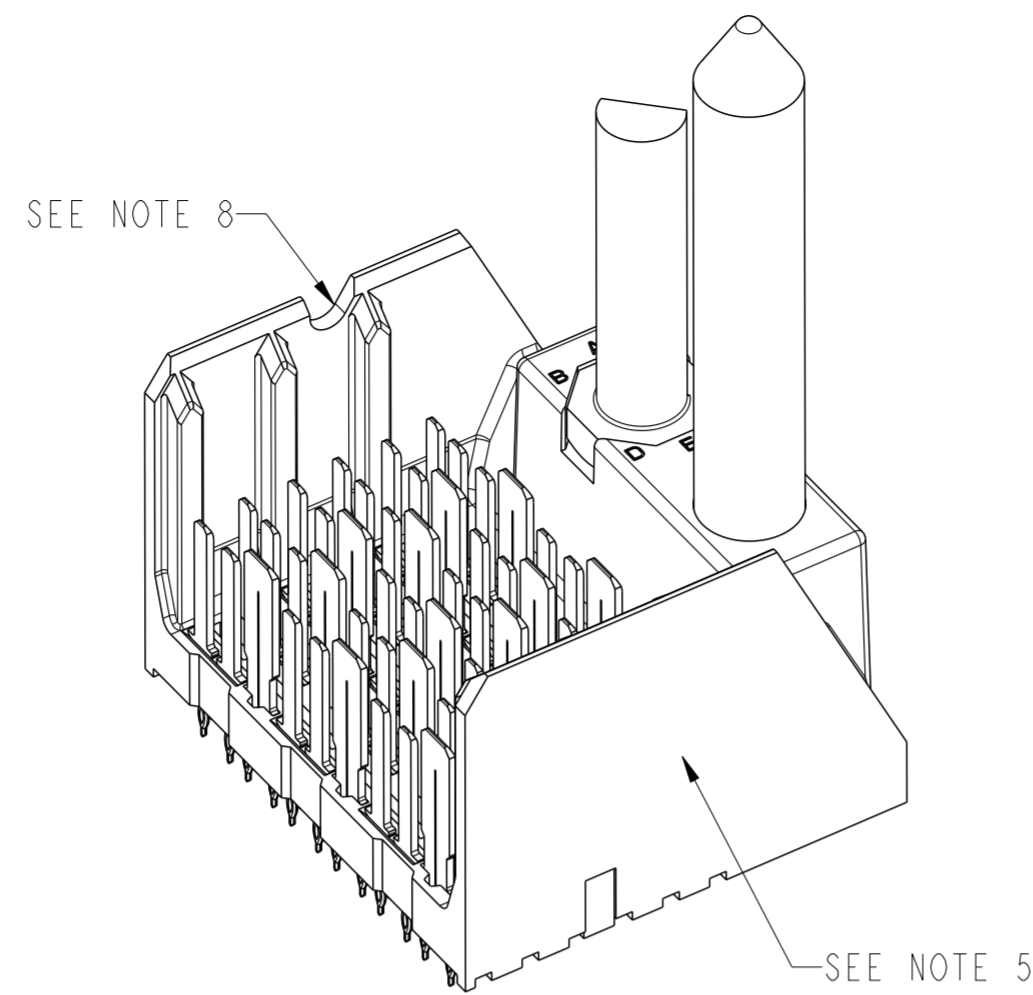
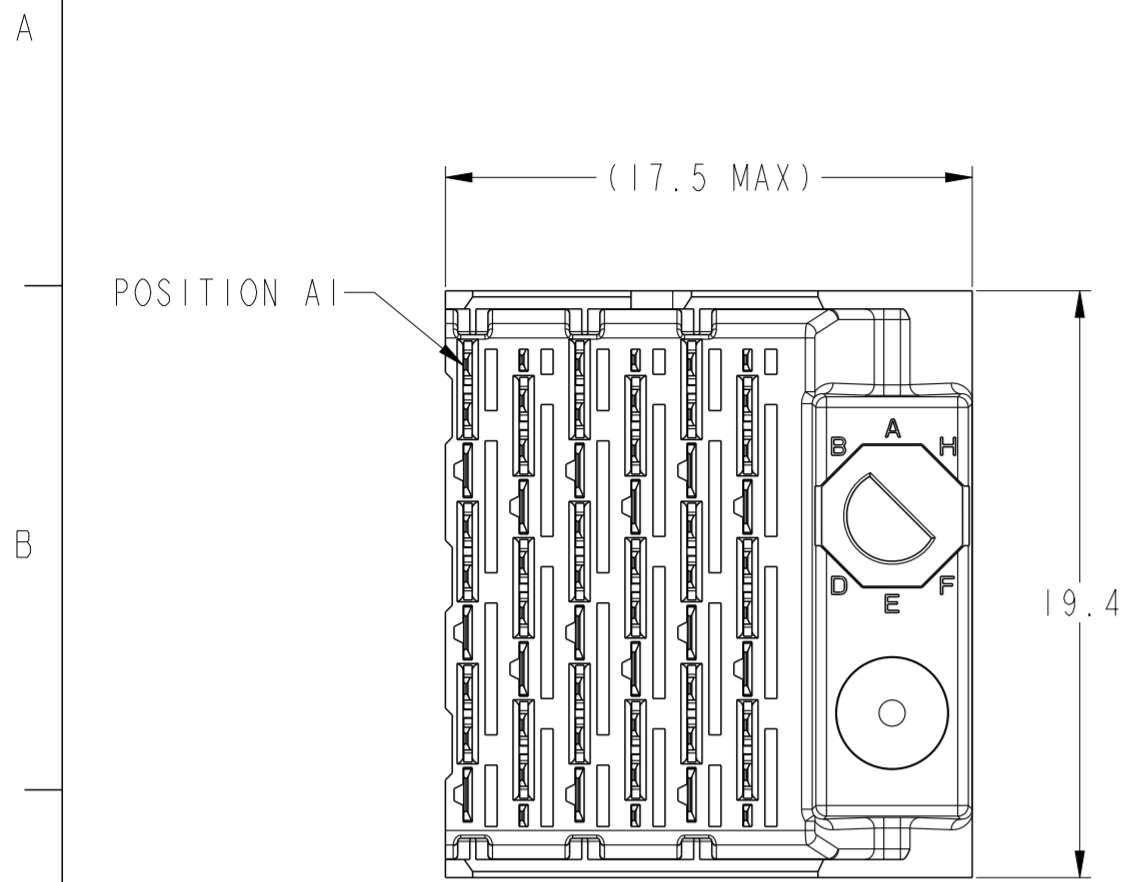

| ASSEMBLY BASE CONFIGURATION END DASH NO. | GUIDE PIN | POLARIZING KEY |
|--|-----------|----------------|
| | DIM 'R' | DIM 'S' |
| -X0X | 31.6mm | 22.8mm |
| -X4X | 25.7mm | 20.0mm |

TAIL LENGTH SEE NOTE 12 $\triangle B$

- 5.2 (3MM SMALL END GROUNDS)
- 5.2 (3MM WIPE SIGNALS)
- 4.2 (2MM WIPE SIGNALS)
- SEE P/N TREE
- 6.2 (4MM WIPE WIDE GROUNDS)
- 5.2 (3MM WIPE WIDE GROUNDS)

| | | | | | | | | | | |
|---------------|------------|------|---------------|------------|----------------|-------|----------|---------------|-----------|----------|
| spec ref | - | dr | Roger Ng | 2011/11/22 | projection | MM | size | A2 | scale | 4:1 |
| tolerance std | ASME Y14.5 | eng | Sandar Soe | 2014/10/02 | chr | - | ecn no | ELX-S-18843-1 | rel level | Released |
| surface | ✓ | appr | Chen-Hong Tan | 2014/12/10 | product family | XCEDE | cat. no. | 10119189 | rev | B |
| ASME Y14.5 | linear | 0.X | ±0.2 | 0.XX | ±0.10 | 0.XXX | ±0.050 | angular | 0° | ±2° |

www.fci.com

MODULE ASSEMBLY
VERTICAL HEADER, 6 COLUMN, 3 PAIR

Product - Customer Draw sheet 4 of 8

LEFT WALL MODULE

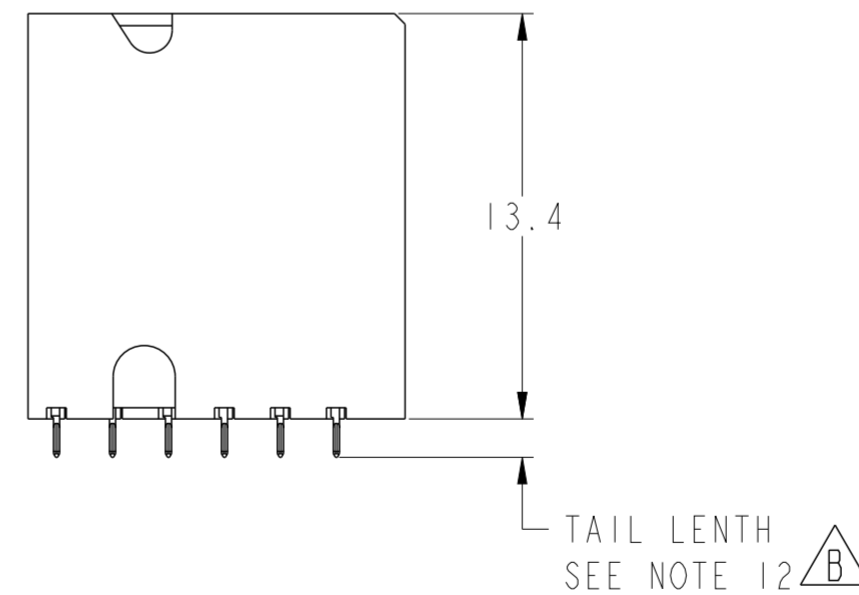
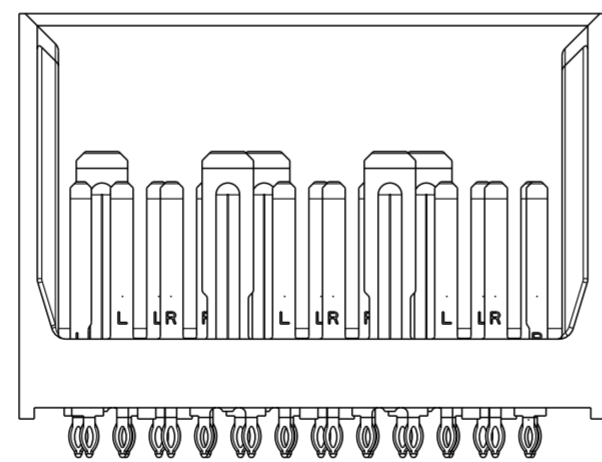
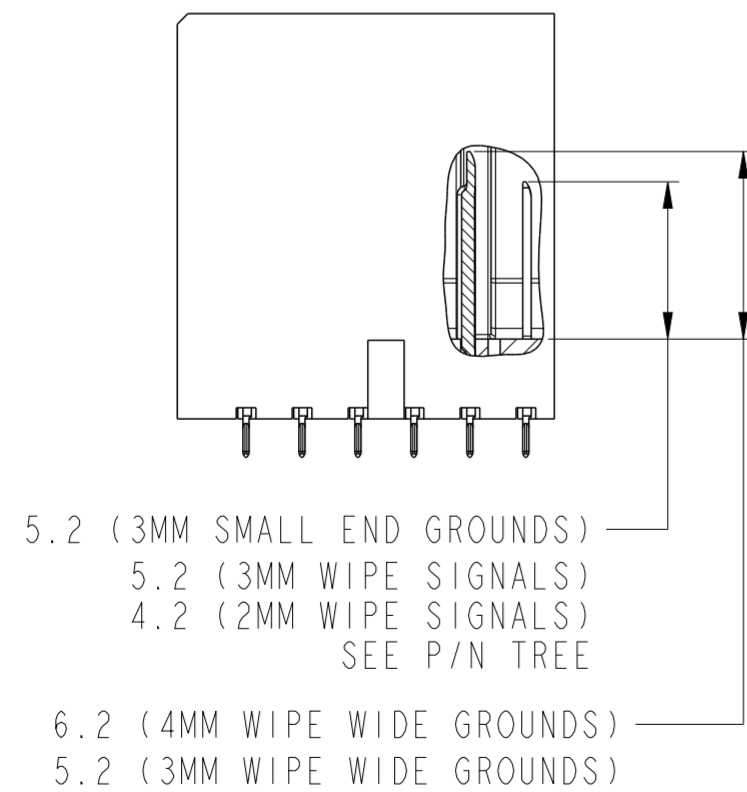
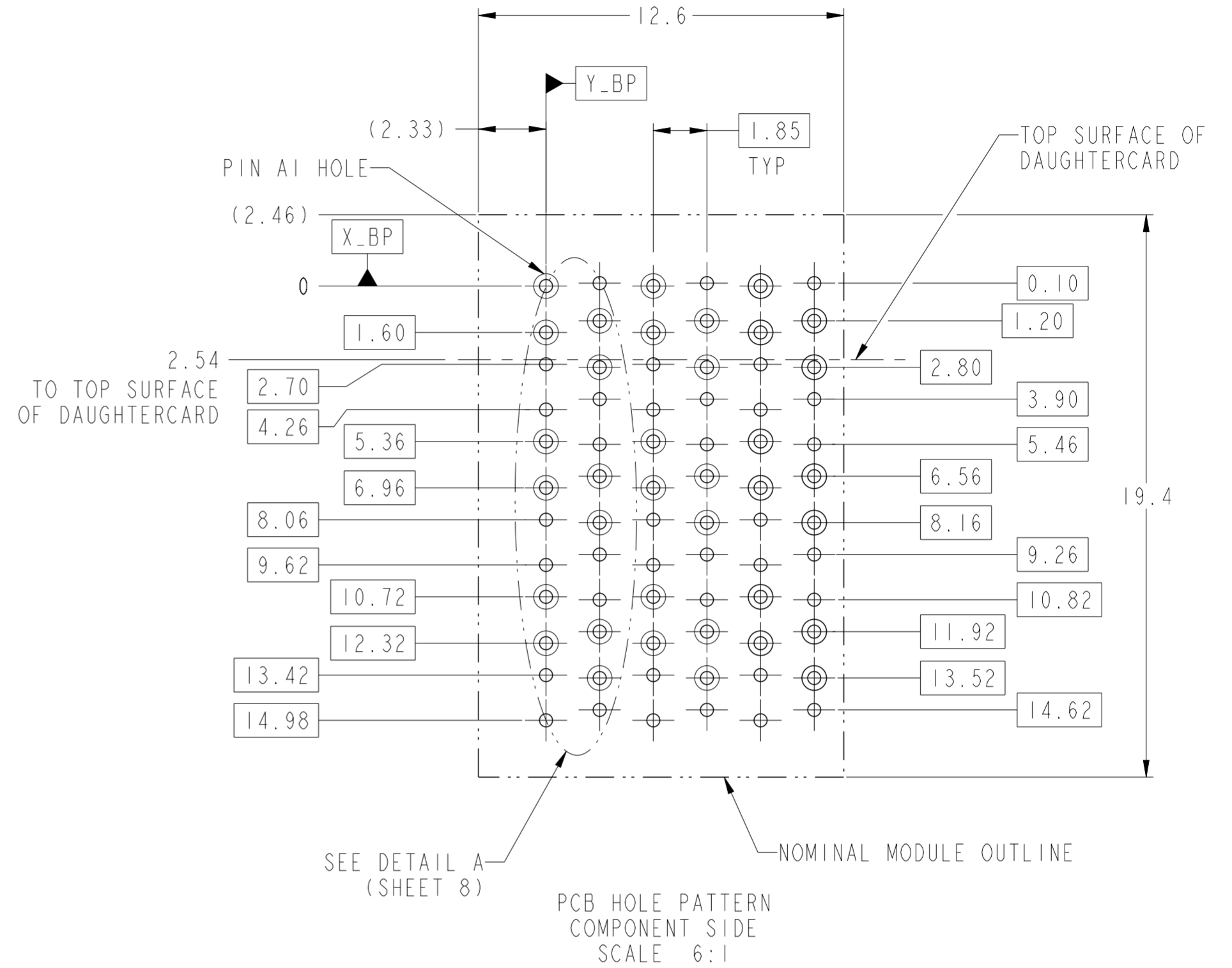
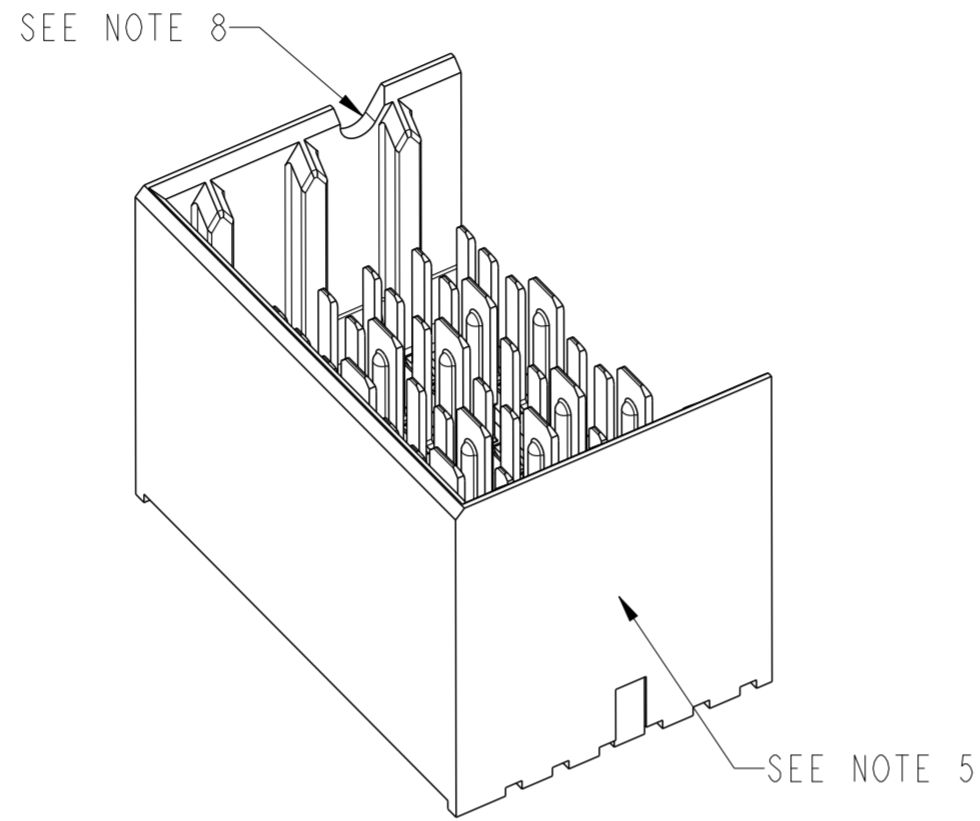
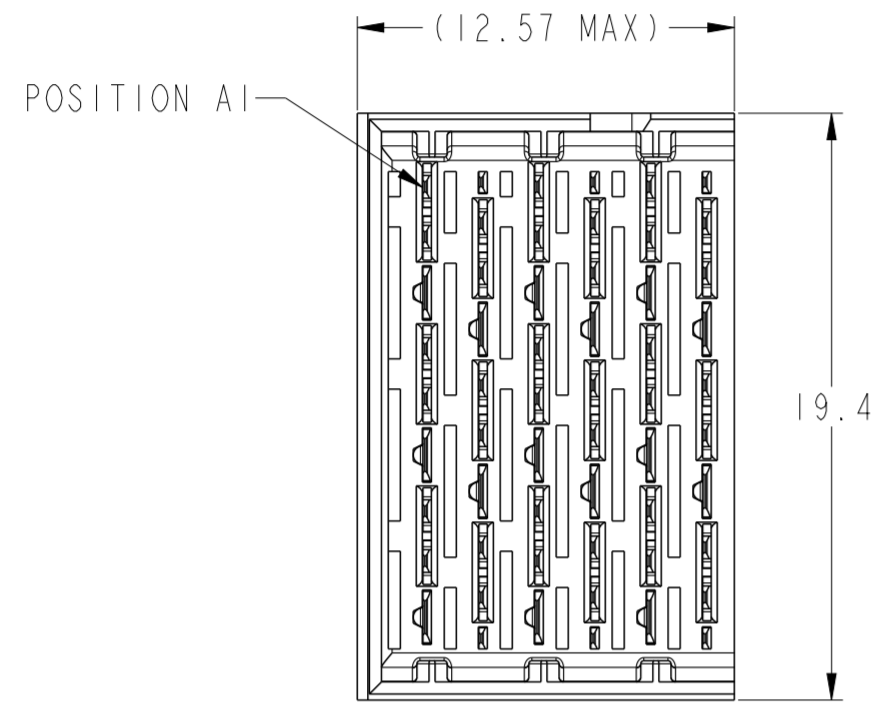

| | | | | | | | | | | |
|---------------------------------------|------------|--------|------------|-------------|------------|---|---------------|------------------------|----------------|-------|
| spec ref | - | dr | Roger Ng | 2011/11/22 | projection | MM | size | A2 | scale | 4:1 |
| tolerance std | ASME Y14.5 | eng | Sandar Soe | 2014/10/02 | | | ecn no | ELX-S-18843-1 | | |
| TOLERANCES UNLESS OTHERWISE SPECIFIED | | chr | - | appr | | | Chen-Hong Tan | 2014/12/10 | product family | XCEDE |
| surface | ✓ | linear | 0.X | ±0.2 | | MODULE ASSEMBLY VERTICAL HEADER, 6 COLUMN, 3 PAIR | rel level | Released | | |
| ASME Y14.5 | angular | 0.XX | ±0.10 | cat. no. | | | - | Product - Customer Drw | sheet 5 of 8 | |
| | | 0.XXX | ±0.050 | www.fci.com | | | | | | |

RIGHT WALL MODULE

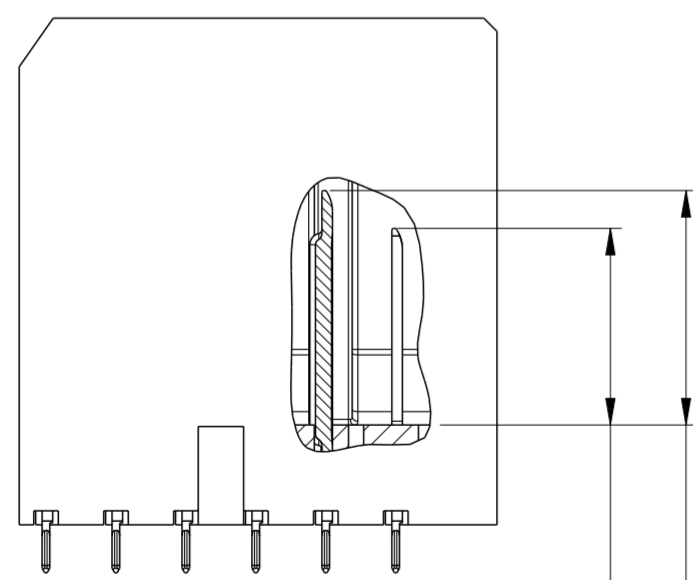
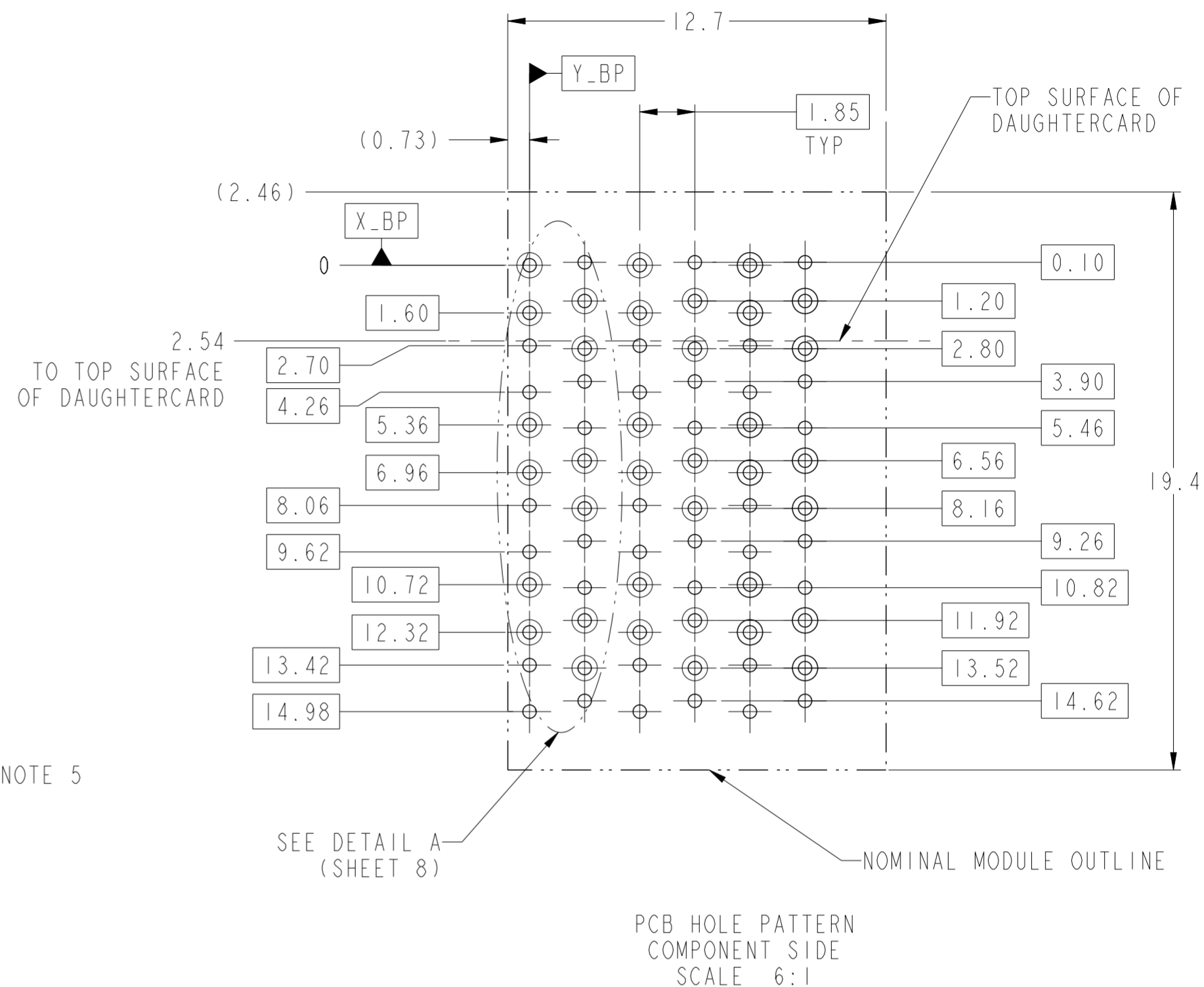
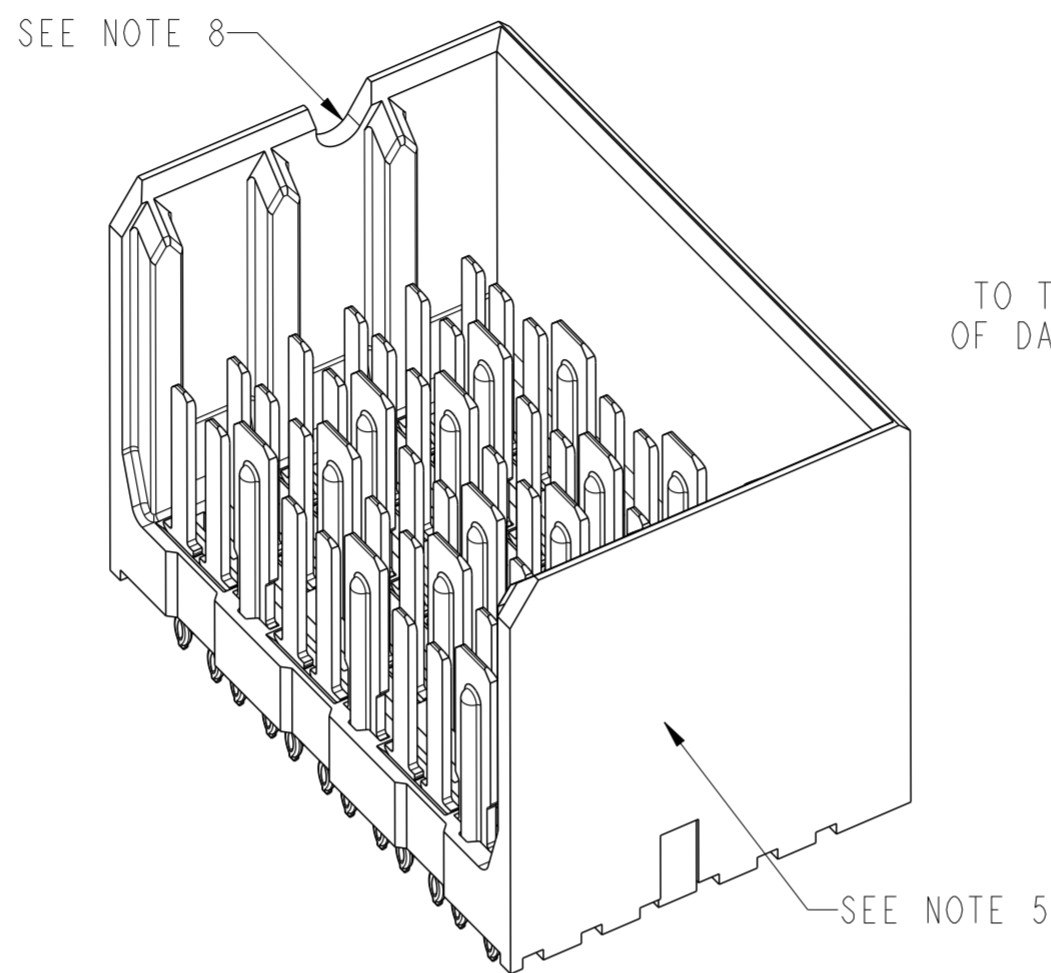
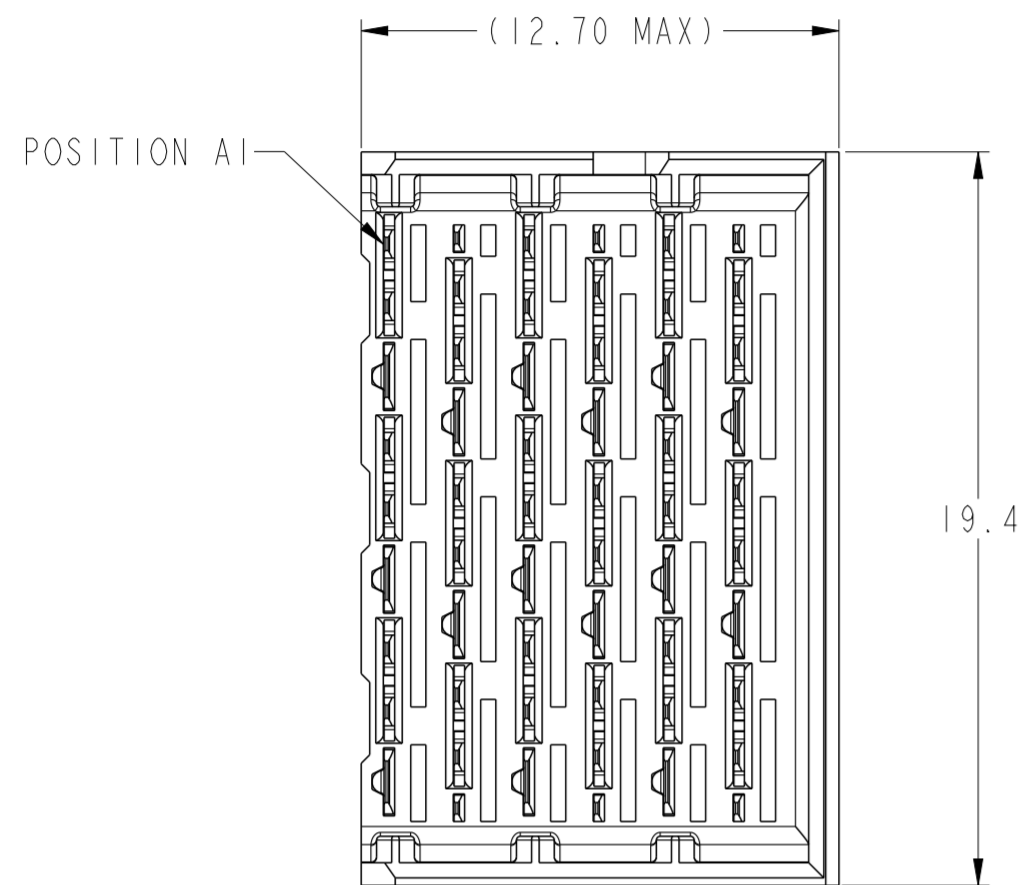

- 5.2 (3MM SMALL END GROUNDS)
- 5.2 (3MM WIPE SIGNALS)
- 4.2 (2MM WIPE SIGNALS)
- SEE P/N TREE
- 6.2 (4MM WIPE WIDE GROUNDS)
- 5.2 (3MM WIPE WIDE GROUNDS)

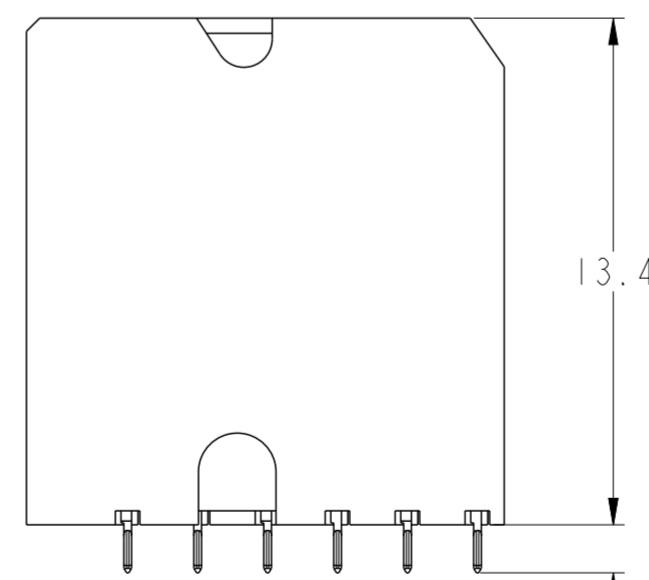
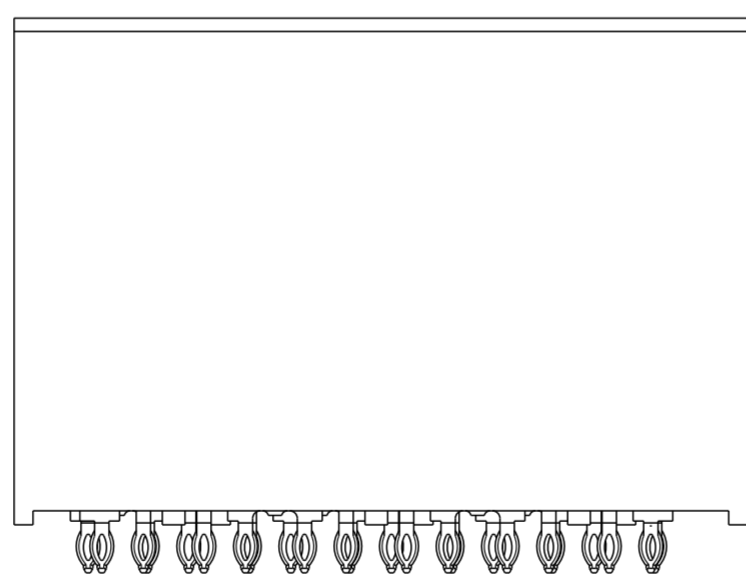

TAIL LENGTH SEE NOTE 12 $\triangle B$

| | | | | | | | | | | | |
|---------------------------------------|------------|---------|------------|------------|------------|----|--------------------|-----------------|----------------|-------|-----------|
| spec ref | - | dr | Roger Ng | 2011/11/22 | projection | MM | size | A2 | scale | 4:1 | |
| tolerance std | ASME Y14.5 | eng | Sandar Soe | 2014/10/02 | | | ecn no | ELX-S-18843-1 | | | |
| TOLERANCES UNLESS OTHERWISE SPECIFIED | | chr | - | appr | | | Chen-Hong Tan | 2014/12/10 | product family | XCEDE | rel level |
| surface | ✓ | linear | 0.X | ±0.2 | | | title | MODULE ASSEMBLY | | | |
| | | | 0.XX | ±0.10 | | | cat. no. | - | | | |
| | | angular | 0° | ±2° | | | Product - Customer | Drw | | | |
| | | | | | | | dwg no | 10119189 | | rev | B |
| | | | | | | | sheet | 6 of 8 | | | |



Copyright FCI.

FOUR WALL MODULE

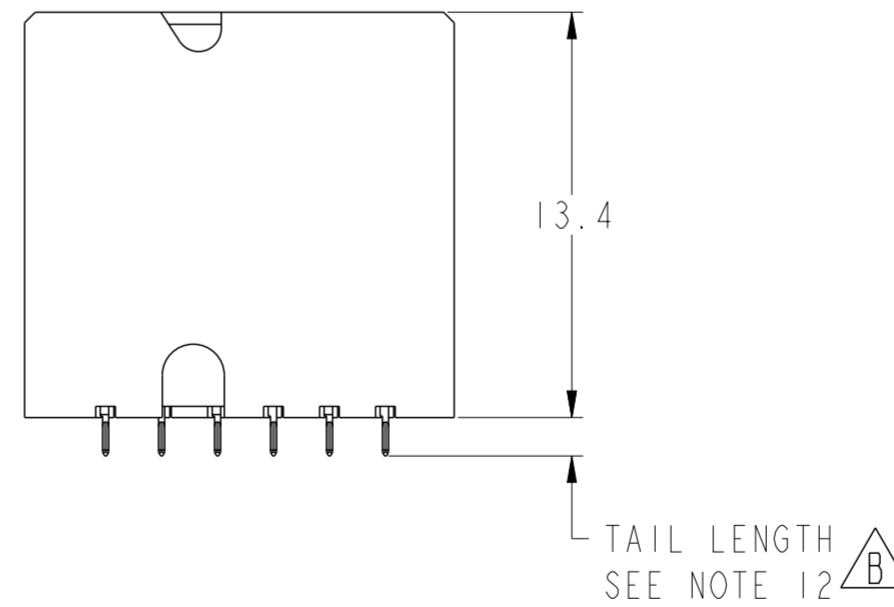
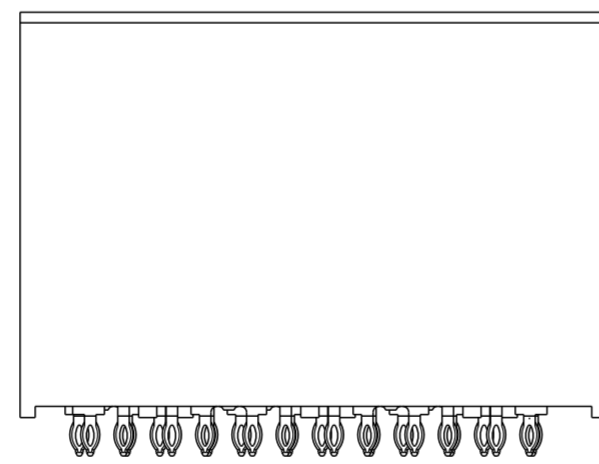
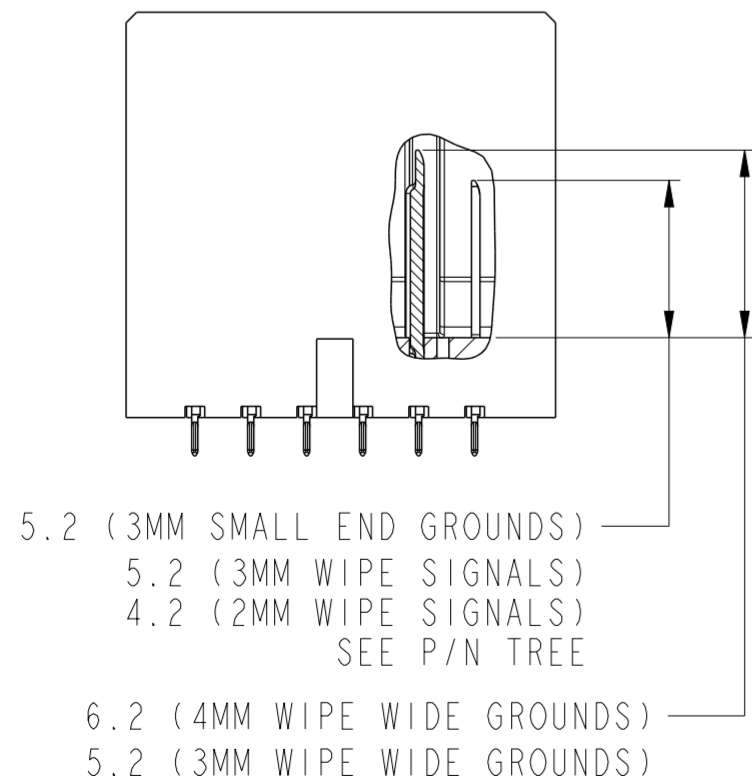
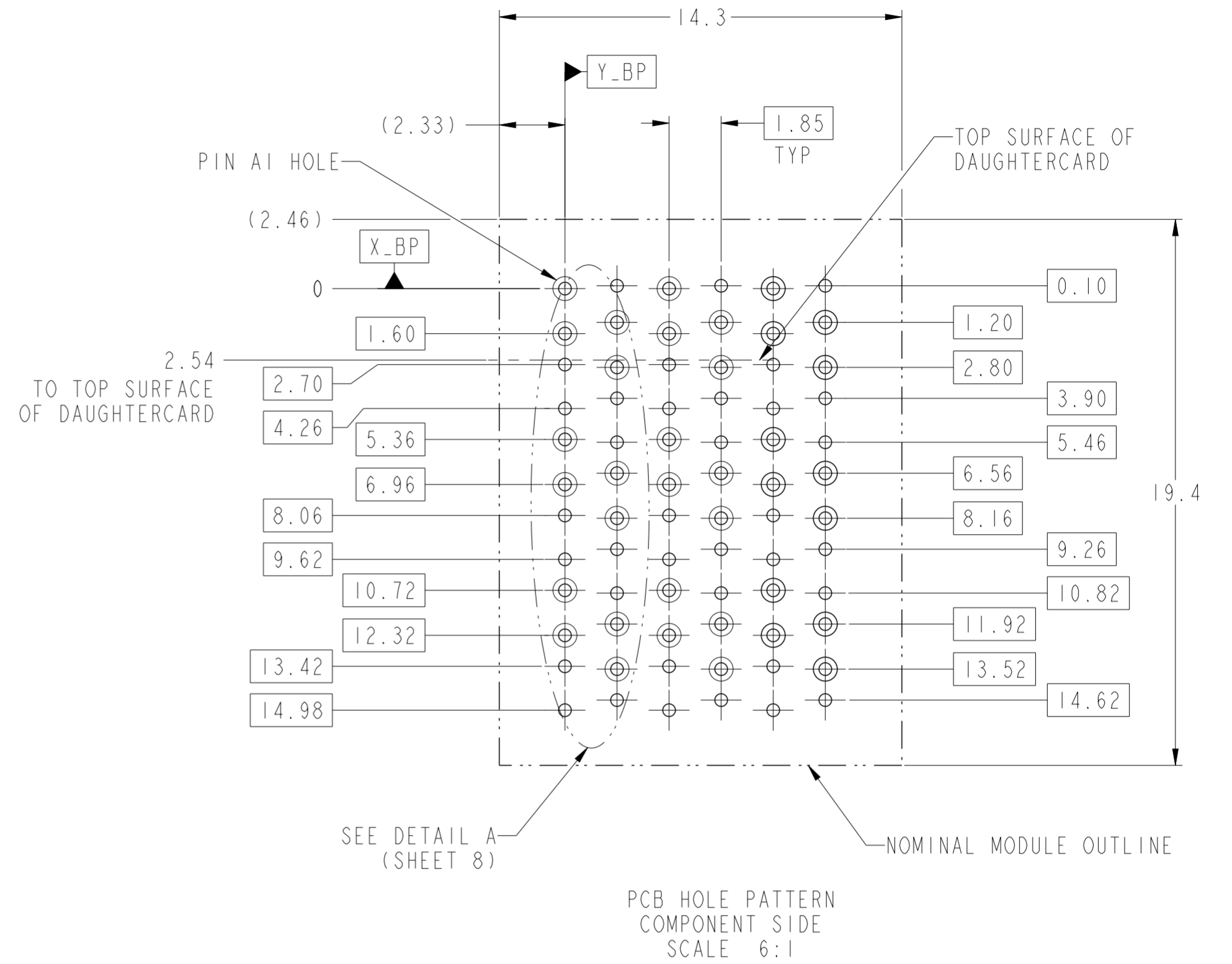
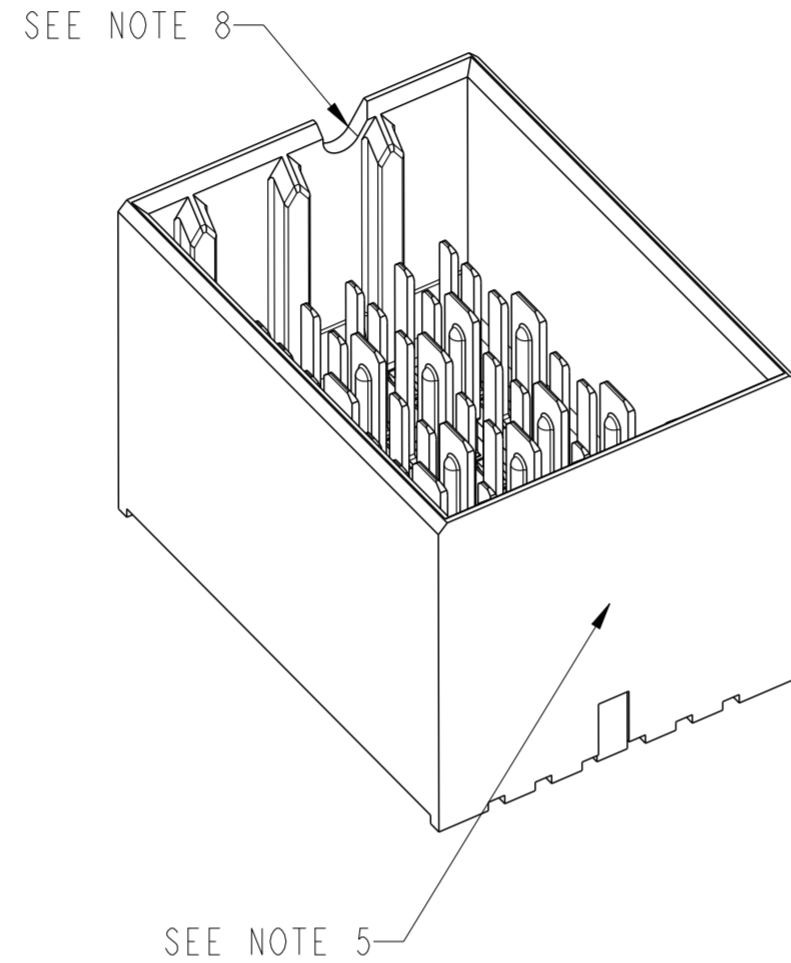
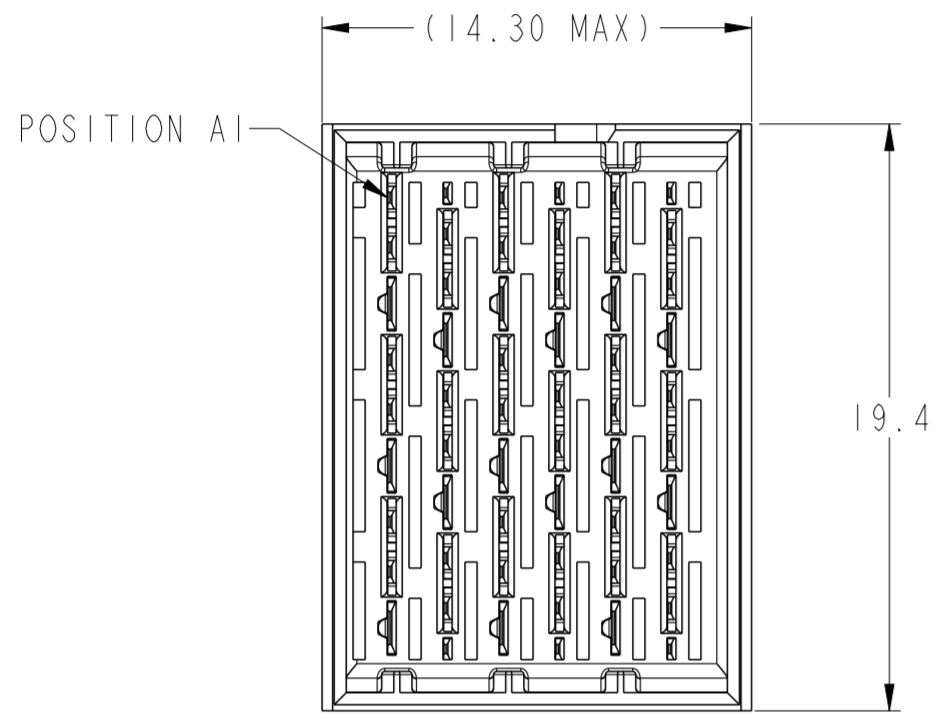

| | | | | | | | | | | |
|---------------------------------------|------------|---------|------------|------------|------------|----|---------------|---|--------------------|----------|
| spec ref | - | dr | Roger Ng | 2011/11/22 | projection | MM | size | A2 | scale | 4:1 |
| tolerance std | ASME Y14.5 | eng | Sandar Soe | 2014/10/02 | | | ecn no | ELX-S-18843-1 | | |
| TOLERANCES UNLESS OTHERWISE SPECIFIED | | chr | - | appr | | | Chen-Hong Tan | 2014/12/10 | product family | XCEDE |
| surface | ASME Y14.5 | linear | 0.X | ±0.2 | | | | title MODULE ASSEMBLY VERTICAL HEADER, 6 COLUMN, 3 PAIR | dwg no 10119189 | rev B |
| | | angular | 0° | ±2° | | | | | | |

| TABLE 3: PTH AND PAD SIZES WITH REFERENCE TO COMPLIANT PIN DRILL | | |
|--|------------|-------|
| COMPLIANT PIN DRILL | PTH | PAD |
| Ø0.55 [0.0217"] | Ø0.45±0.05 | Ø0.85 |
| Ø0.45 [0.0177"] | Ø0.36±0.05 | Ø0.75 |

NOTES:

1. CONNECTOR MATERIALS
SHROUD: HIGH-TEMP THERMOPLASTIC, GRAY, UL94V-0
CONTACTS: HIGH PERFORMANCE COPPER ALLOY
2. CONTACT PLATING:

SEPARABLE INTERFACE: PERFORMANCE-BASED PLATING, QUALIFIED TO MEET THE REQUIREMENTS OF FCI PRODUCT SPECIFICATION GS-12 588, INCLUDING THE TELCORDIA GR-1217-CORE (NOVEMBER 1995) CENTRAL OFFICE (CO) OR UNCONTROLLED ENVIRONMENT (UE) TEST SEQUENCE AS NOTED IN P/N TREE.

PRESS-FIT TAILS: TIN OVER NICKEL (LF), OR TIN-LEAD ALLOY OVER NICKEL (NON-LF). SEE P/N TREE.
3. PRODUCT SPECIFICATION: GS-12-588
4. APPLICATION SPECIFICATION: GS-20-121
5. PRODUCT MARKING (PART NUMBER AND LOT CODE) ON THESE SURFACES.
6. HOUSING MUST WITHSTAND EXPOSURE TO 260°C PEAK TEMPERATURE FOR 40 SECONDS IN A CONVECTION, INFRA-RED, OR VAPOR-PHASE REFLOW OVEN.
7. PACKAGING MEETS GS-14-920 LEAD-FREE LABELING SPECIFICATION.
8. NOTCH INDICATES "ROW A" SIDE OF CONNECTOR.
9. SEE APPLICATION SPECIFICATION FOR ROUTING GUIDELINES, ADDITIONAL PTH GUIDELINES, MATED DIMENSIONS, GUIDE PN SELECTION, ETC.
10. SCREW IS OPTIONAL AND ENGAGES WITH BOTTOM OF GUIDE-PIN FROM BENEATH THE PCB FOR ADDITIONAL GUIDE-PIN SUPPORT.
11. OPTIMAL HOLE LOCATION FOR GROUNDED PIN OR ADDITIONAL GUIDE-PIN SUPPORT. SEE TABLE 1 ON SHEET 1 FOR ADDITIONAL DETAILS.
12. TAIL LENGTH=1.3mm FOR Ø0.55[0.0217"]COMPLIANT PIN DRILL
TAIL LENGTH=1.5mm FOR Ø0.45[0.0177"]COMPLIANT PIN DRILL
13. A \triangle B SYMBOL WILL BE NEXT TO ANY DIMENSION, VIEW OR NOTE THAT HAS BEEN MODIFIED WITH THE CURRENT DRAWING REVISION.

REFER TO TABLE 3 FOR PTH, DRILL & PAD SIZES

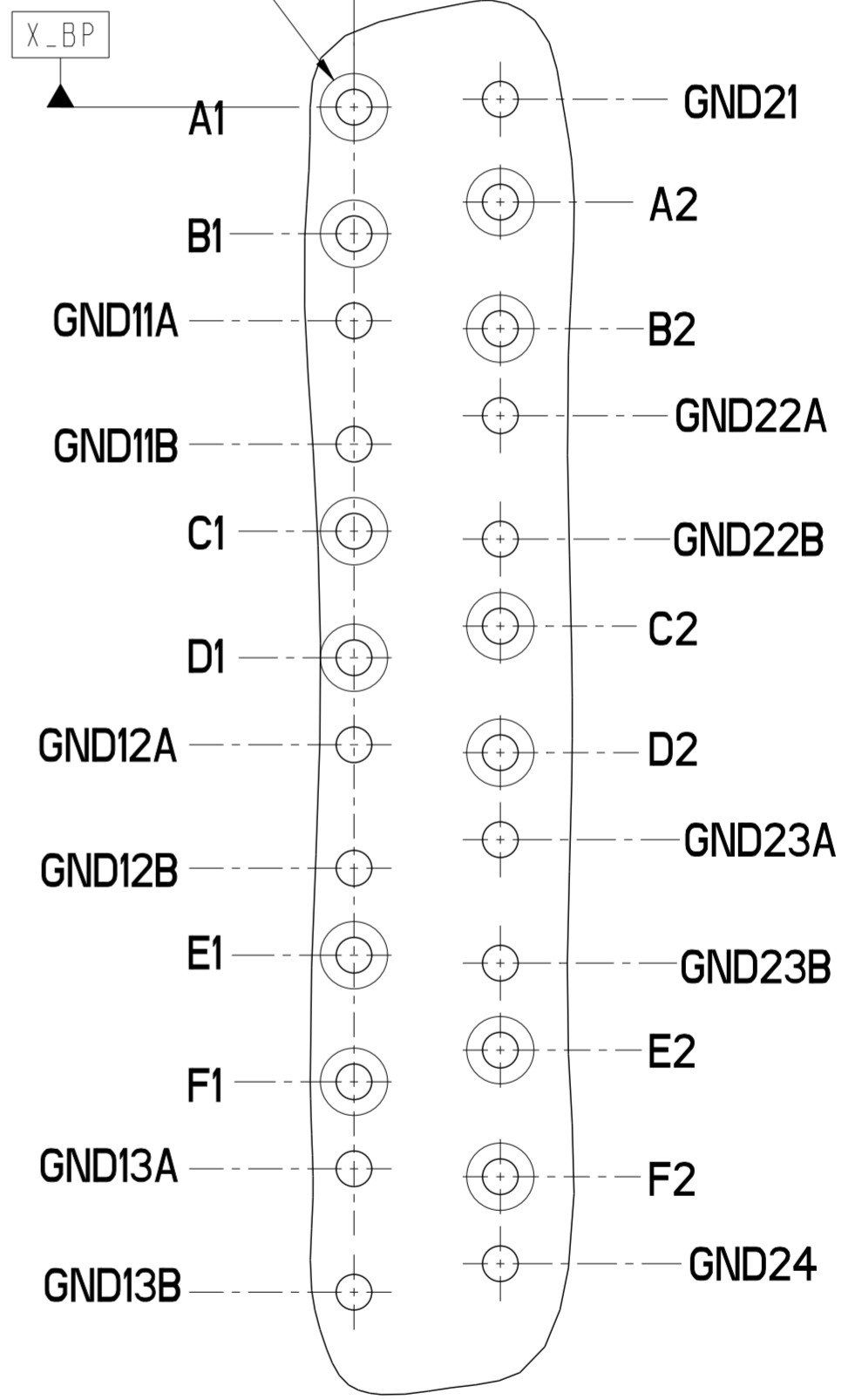
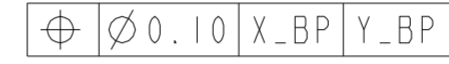

DETAIL A
SCALE 12:1

Copyright FCI. FCI

| | | | | | | | | | | | | |
|---------------------------------------|------------|--------|--|------------|------------|----|---------------|-----------------|----------------|------------------------|------------------------|--------------|
| spec ref | - | dr | Roger Ng | 2011/11/22 | projection | MM | size | A2 | scale | 4:1 | | |
| tolerance std | ASME Y14.5 | eng | Sandar Soe | 2014/10/02 | | | ecn no | ELX-S-18843-1 | | | | |
| TOLERANCES UNLESS OTHERWISE SPECIFIED | | chr | - | appr | | | Chen-Hong Tan | 2014/12/10 | product family | XCEDE | | |
| surface | ASME Y14.5 | linear | 0.X ±0.2 0.XX ±0.10 0.XXX ±0.050 | angular | | | 0° ±2° | www.fci.com | cat. no. | - | Product - Customer Drw | sheet 8 of 8 |
| | | | | | | | title | MODULE ASSEMBLY | | rel level | Released | |
| | | | | | | | dwg no | 10119189 | | rev | B | |
| | | | | | | | cat. no. | - | | Product - Customer Drw | sheet 8 of 8 | |



Компания «ЭлектроПласт» предлагает заключение долгосрочных отношений при поставках импортных электронных компонентов на взаимовыгодных условиях!

Наши преимущества:

- Оперативные поставки широкого спектра электронных компонентов отечественного и импортного производства напрямую от производителей и с крупнейших мировых складов;
- Поставка более 17-ти миллионов наименований электронных компонентов;
- Поставка сложных, дефицитных, либо снятых с производства позиций;
- Оперативные сроки поставки под заказ (от 5 рабочих дней);
- Экспресс доставка в любую точку России;
- Техническая поддержка проекта, помощь в подборе аналогов, поставка прототипов;
- Система менеджмента качества сертифицирована по Международному стандарту ISO 9001;
- Лицензия ФСБ на осуществление работ с использованием сведений, составляющих государственную тайну;
- Поставка специализированных компонентов (Xilinx, Altera, Analog Devices, Intersil, Interpoint, Microsemi, Aeroflex, Peregrine, Syfer, Eurofarad, Texas Instrument, Miteq, Cobham, E2V, MA-COM, Hittite, Mini-Circuits, General Dynamics и др.);

Помимо этого, одним из направлений компании «ЭлектроПласт» является направление «Источники питания». Мы предлагаем Вам помощь Конструкторского отдела:

- Подбор оптимального решения, техническое обоснование при выборе компонента;
- Подбор аналогов;
- Консультации по применению компонента;
- Поставка образцов и прототипов;
- Техническая поддержка проекта;
- Защита от снятия компонента с производства.



Как с нами связаться

Телефон: 8 (812) 309 58 32 (многоканальный)

Факс: 8 (812) 320-02-42

Электронная почта: org@eplast1.ru

Адрес: 198099, г. Санкт-Петербург, ул. Калинина, дом 2, корпус 4, литера А.