

| ASSY P/N             | LED COLOR       |                  |                  |
|----------------------|-----------------|------------------|------------------|
|                      | POSITION 1      | POSITION 2       | POSITION 3       |
| 570-0100-010, -010F  | BLANK           | RED DIFFUSED     | BLANK            |
| 570-0100-011, -011F  | BLANK           | RED DIFFUSED     | RED DIFFUSED     |
| 570-0100-012, -012F  | BLANK           | RED DIFFUSED     | GREEN DIFFUSED   |
| 570-0100-022, -022F  | BLANK           | GREEN DIFFUSED   | GREEN DIFFUSED   |
| 570-0100-023, -023F  | BLANK           | GREEN DIFFUSED   | YELLOW DIFFUSED  |
| 570-0100-032, -032F  | BLANK           | YELLOW DIFFUSED  | GREEN DIFFUSED   |
| 570-0100-033, -033F  | BLANK           | YELLOW DIFFUSED  | YELLOW DIFFUSED  |
| 570-0100-101, -101F  | RED DIFFUSED    | BLANK            | RED DIFFUSED     |
| 570-0100-110, -110F  | RED DIFFUSED    | RED DIFFUSED     | BLANK            |
| 570-0100-111, -111F  | RED DIFFUSED    | RED DIFFUSED     | RED DIFFUSED     |
| 570-0100-112, -112F  | RED DIFFUSED    | RED DIFFUSED     | GREEN DIFFUSED   |
| 570-0100-122, -122F  | RED DIFFUSED    | GREEN DIFFUSED   | GREEN DIFFUSED   |
| 570-0100-123, -123F  | RED DIFFUSED    | GREEN DIFFUSED   | YELLOW DIFFUSED  |
| 570-0100-130, -130F  | RED DIFFUSED    | YELLOW DIFFUSED  | BLANK            |
| 570-0100-131, -131F  | RED DIFFUSED    | YELLOW DIFFUSED  | RED DIFFUSED     |
| 570-0100-132, -132F  | RED DIFFUSED    | YELLOW DIFFUSED  | GREEN DIFFUSED   |
| 570-0100-133, -133F  | RED DIFFUSED    | YELLOW DIFFUSED  | YELLOW DIFFUSED  |
| 570-0100-200, -200F  | GREEN DIFFUSED  | BLANK            | BLANK            |
| 570-0100-202, -202F  | GREEN DIFFUSED  | BLANK            | GREEN DIFFUSED   |
| 570-0100-210, -210F  | GREEN DIFFUSED  | RED DIFFUSED     | BLANK            |
| 570-0100-211, -211F  | GREEN DIFFUSED  | RED DIFFUSED     | RED DIFFUSED     |
| 570-0100-212, -212F  | GREEN DIFFUSED  | RED DIFFUSED     | GREEN DIFFUSED   |
| 570-0100-213, -213F  | GREEN DIFFUSED  | RED DIFFUSED     | YELLOW DIFFUSED  |
| 570-0100-220, -220F  | GREEN DIFFUSED  | GREEN DIFFUSED   | BLANK            |
| 570-0100-221F        | GREEN DIFFUSED  | GREEN DIFFUSED   | RED DIFFUSED     |
| 570-0100-222, -222F  | GREEN DIFFUSED  | GREEN DIFFUSED   | GREEN DIFFUSED   |
| 570-0100-223, -223F  | GREEN DIFFUSED  | GREEN DIFFUSED   | YELLOW DIFFUSED  |
| 570-0100-230, -230F  | GREEN DIFFUSED  | YELLOW DIFFUSED  | BLANK            |
| 570-0100-231, -231F  | GREEN DIFFUSED  | YELLOW DIFFUSED  | RED DIFFUSED     |
| 570-0100-232, -232F  | GREEN DIFFUSED  | YELLOW DIFFUSED  | GREEN DIFFUSED   |
| 570-0100-233, -233F  | GREEN DIFFUSED  | YELLOW DIFFUSED  | YELLOW DIFFUSED  |
| *570-0100-239, -239F | GREEN DIFFUSED  | YELLOW DIFFUSED  | BLUE WATER CLEAR |
| *570-0100-293, -293F | GREEN DIFFUSED  | BLUE WATER CLEAR | YELLOW DIFFUSED  |
| 570-0100-302F        | YELLOW DIFFUSED | BLANK            | GREEN DIFFUSED   |
| 570-0100-303, -303F  | YELLOW DIFFUSED | BLANK            | YELLOW DIFFUSED  |
| 570-0100-311, -311F  | YELLOW DIFFUSED | RED DIFFUSED     | RED DIFFUSED     |
| 570-0100-312, -312F  | YELLOW DIFFUSED | RED DIFFUSED     | GREEN DIFFUSED   |
| 570-0100-322, -322F  | YELLOW DIFFUSED | GREEN DIFFUSED   | GREEN DIFFUSED   |
| 570-0100-323, -323F  | YELLOW DIFFUSED | GREEN DIFFUSED   | YELLOW DIFFUSED  |
| 570-0100-330, -330F  | YELLOW DIFFUSED | YELLOW DIFFUSED  | BLANK            |
| 570-0100-331, -331F  | YELLOW DIFFUSED | YELLOW DIFFUSED  | RED DIFFUSED     |
| 570-0100-332, -332F  | YELLOW DIFFUSED | YELLOW DIFFUSED  | GREEN DIFFUSED   |
| 570-0100-333, -333F  | YELLOW DIFFUSED | YELLOW DIFFUSED  | YELLOW DIFFUSED  |
| 570-0100-723, -723F  | ORANGE DIFFUSED | GREEN DIFFUSED   | YELLOW DIFFUSED  |

NOTES :

- LEADS TO BE FREE OF DEFORMATION AFTER BENDING AND CUTTING
- LED LEAD DIMENSIONS SHOWN ARE MEASURED AT HOUSING EXIT
- PIN NUMBERS FOR REFERENCE ONLY, DESIGNATION NON-EXISTENT ON PARTS.
- DIALIGHT PART NUMBER = 570-0100-XXX AND 570-0100-XXXF
- \*THIS ASSEMBLY CONTAINS ELECTROSTATIC DISCHARGE SENSITIVE DEVICES (ESDS). MAINTAIN ALL PRECAUTIONARY MEASURES DURING ASSEMBLY, HANDLING AND STORAGE IN ACCORDANCE WITH IPC-A-610.

| ABSOLUTE MAXIMUM RATINGS AT 25°C AMBIENT             | RED | ORANGE | YELLOW | GREEN | BLUE | UNITS      |    |
|--|-----|--------|--------|-------|------|------------|----|
| POWER DISSIPATION                                    | 105 | 105    | 105    | 105   | 105  | mW         |    |
| FORWARD CURRENT                                      | 30  | 25     | 30     | 25    | 30   | mA         |    |
| DERATING LINEAR FROM 25°C                            | .40 | .33    | .40    | .33   | .42  | mA/°C      |    |
| REVERSE VOLTAGE                                      |     |        |        |       |      | 5          | V  |
| LEAD SOLDERING TEMPERATURE - 5 SEC., 1/16" FROM BODY |     |        |        |       |      | 260        | °C |
| LEAD SOLDERING TEMPERATURE - 3 SEC., 5/32" FROM BODY |     |        |        |       |      |            |    |
| OPERATING TEMPERATURE                                |     |        |        |       |      | -40 TO +85 | °C |
| STORAGE TEMPERATURE                                  |     |        |        |       |      | -40 TO +85 | °C |

| REV. | ECN NO. | REVISIONS   | DRN. | CKD. | APP. | DATE     |
|------|---------|---|------|------|------|----------|
| A    |         | NEW RELEASE   | TC   | D.C  | A.V  | 11-11-99 |
| B    |         | ADDED 570-0100-133  | TC   | D.C  | N.O. | 2-29-00  |
| C    |         | CHANGED LED SPEC.   | YIS  | JMC  | N.O. | 1-30-03  |
| D    |         | ADDED P/N 570-0100-331F AND RoHS COMPLIANT NOTE; UPDATED FORMAT   | TWC  | MES  | N.O. | 6-23-05  |
| E    |         | ADDED P/Ns 570-0100-200 AND -200F RoHS COMPLIANT PART   | TWC  | TC   | N.O. | 9-14-05  |
| F    |         | ADDED P/Ns 570-0100-239, -239-F, -293, -293F & -331, ESD LOGO & NOTE; ADDED ALL OTHER -XXXF P/Ns AND BLUE LED CHARACTERISTICS AND MAXIMUM RATINGS | TWC  | MES  | N.O. | 11-31-05 |
| G    |         | ADDED P/N 570-0100-723, -723F   | TWC  | MES  | N.O. | 12-12-05 |
| H    |         | LED SCHEMATIC WAS REVERSED; REVISED LED PROTRUSION WAS .060   | TC   | N.O. | AV   | 2-19-07  |
| J    |         | ADDED P/N 570-0100-210, 210F  | SM   | MES  | N.O. | 3-21-07  |
| K    |         | ADDED P/N 570-0100-012, 012F  | SM   | MES  | N.O. | 10-10-07 |
| L    |         | LEAD LENGTH WAS .110±.010 IN ERROR.   | KLJ  | JLC  | N.O. | 6-4-09   |
| M    |         | ADDED P/N 570-0100-302F   | AJF  | KLJ  | NO   | 6-30-09  |
| N    |         | ADDED P/N 570-0100-221F   | JTD  | SM   | NO   | 10-27-11 |

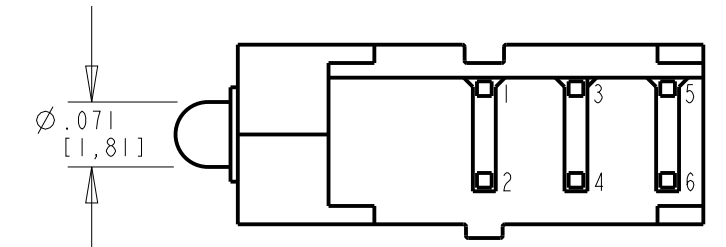

**ATTENTION:**  
OBSERVE PRECAUTIONS FOR  
HANDLING ELECTROSTATIC  
SENSITIVE DEVICES

**RoHS COMPLIANT 570-0100-XXXF**

Part Numbers with the "F" suffix ending are RoHS Compliant.  
Example: 570-0100-331F  
Bag packaging is marked with "RoHS Compliant" label or the equivalent markings. These parts can be wave soldered, dip soldered or hand soldered for 5 sec at 260°C, 1.6mm from led body. Part specifications are the same, with the exception of the led lead finish which is 100% Tin (Sn) over Nickel (Ni) underplating, on a Fe base material. This drawing document is for both the "Non RoHS" Product and the "RoHS Compliant" product.

| OPERATING CHARACTERISTICS AT 25°C AMBIENT |        |     |      |     |        |                                 |
|---|--------|-----|------|-----|--------|---------------------------------|
| CHARACTERISTICS                           | COLOR  | MIN | TYP  | MAX | UNITS  | TEST CONDITIONS                 |
| LUMINOUS INTENSITY                        | RED    | 8   | 15   |     | mcd    | I <sub>F</sub> = 10 mA          |
|   | ORANGE | 5   | 15   |     |        |                                 |
|   | YELLOW | 5   | 8    |     |        |                                 |
|   | GREEN  | 5   | 10   |     |        |                                 |
|   | BLUE   | 380 | 600  |     |        |                                 |
| FORWARD VOLTAGE                           | RED    |     | 2.0  | 2.5 | V      | I <sub>F</sub> = 20 mA          |
|   | ORANGE |     | 2.05 | 2.5 |        |                                 |
|   | YELLOW |     | 2.1  | 2.5 |        |                                 |
|   | GREEN  |     | 2.2  | 2.5 |        |                                 |
|   | BLUE   |     | 3.5  | 4.0 |        |                                 |
| DOMINANT WAVELENGTH                       | RED    |     | 625  |     | nm     |                                 |
|   | ORANGE |     | 610  |     |        |                                 |
|   | YELLOW |     | 588  |     |        |                                 |
|   | GREEN  |     | 568  |     |        |                                 |
|   | BLUE   |     | 470  |     |        |                                 |
| PEAK EMISSION WAVELENGTH                  | RED    |     | 627  |     | nm     |                                 |
|   | ORANGE |     | 607  |     |        |                                 |
|   | YELLOW |     | 590  |     |        |                                 |
|   | GREEN  |     | 565  |     |        |                                 |
|   | BLUE   |     | 468  |     |        |                                 |
| VIEWING ANGLE 2θ <sub>1/2</sub>           | RED    |     | 70   |     | Degree |                                 |
|   | ORANGE |     | 70   |     |        |                                 |
|   | YELLOW |     | 70   |     |        |                                 |
|   | GREEN  |     | 70   |     |        |                                 |
|   | BLUE   |     | 30   |     |        |                                 |
| CAPACITANCE                               | RED    |     | 15   |     | pF     | V <sub>F</sub> = 0 V, f = 1 MHz |
|   | ORANGE |     | 15   |     |        |                                 |
|   | YELLOW |     | 20   |     |        |                                 |
|   | GREEN  |     | 15   |     |        |                                 |
| BLUE                                      |        | 100 |      |     |        |                                 |

|   |                |   |
|---|----------------|---|
| THIS DRAWING AND THE CONTENTS HEREIN ARE CONFIDENTIAL AND THE SOLE PROPERTY OF DIALIGHT. REPRODUCTION OF THIS DRAWING OR CONSTRUCTION OF ANY PARTS WITHIN THIS DRAWING ARE FORBIDDEN WITHOUT THE WRITTEN CONSENT OF DIALIGHT. |                |   |
| SCALE: DRAWING SCALE  | DRAWING NUMBER | REV                                       |
| ALL DIM'S IN: INCHES (MM)   | C-16625        | N   |
| TOLERANCES: UNLESS OTHERWISE SPECIFIED  | TITLE          |   |
| FRACTIONS: ±1/64  | 3XI CBI BLOCK  |   |
| DECIMALS (.XX): ±.02  | MATERIAL       |   |
| DECIMALS (.XXX): ±.015  |                |   |
| ANGLES: ±3°   |                |   |
| FINISH:   |                |   |
| FSCM 83330  | Dialight       | 1501 ROUTE 34 SOUTH FARMINGDALE, NJ 07727 |
|   | SHEET 1 OF 1   | FAMILY TABLE:                             |



Компания «ЭлектроПласт» предлагает заключение долгосрочных отношений при поставках импортных электронных компонентов на взаимовыгодных условиях!

Наши преимущества:

- Оперативные поставки широкого спектра электронных компонентов отечественного и импортного производства напрямую от производителей и с крупнейших мировых складов;
- Поставка более 17-ти миллионов наименований электронных компонентов;
- Поставка сложных, дефицитных, либо снятых с производства позиций;
- Оперативные сроки поставки под заказ (от 5 рабочих дней);
- Экспресс доставка в любую точку России;
- Техническая поддержка проекта, помощь в подборе аналогов, поставка прототипов;
- Система менеджмента качества сертифицирована по Международному стандарту ISO 9001;
- Лицензия ФСБ на осуществление работ с использованием сведений, составляющих государственную тайну;
- Поставка специализированных компонентов (Xilinx, Altera, Analog Devices, Intersil, Interpoint, Microsemi, Aeroflex, Peregrine, Syfer, Eurofarad, Texas Instrument, Miteq, Cobham, E2V, MA-COM, Hittite, Mini-Circuits, General Dynamics и др.);

Помимо этого, одним из направлений компании «ЭлектроПласт» является направление «Источники питания». Мы предлагаем Вам помощь Конструкторского отдела:

- Подбор оптимального решения, техническое обоснование при выборе компонента;
- Подбор аналогов;
- Консультации по применению компонента;
- Поставка образцов и прототипов;
- Техническая поддержка проекта;
- Защита от снятия компонента с производства.



#### Как с нами связаться

**Телефон:** 8 (812) 309 58 32 (многоканальный)

**Факс:** 8 (812) 320-02-42

**Электронная почта:** [org@eplast1.ru](mailto:org@eplast1.ru)

**Адрес:** 198099, г. Санкт-Петербург, ул. Калинина, дом 2, корпус 4, литера А.