

Versatile Filtered Power Entry Module

SCHAFFNER
energy efficiency and reliability



- Rated currents up to 10A
- For one or two fuses
- Fuses Ø6.3 x 32mm or Ø5 x 20mm
- 2-pole rocker switch
- Voltage selector
- Optional earth line choke (E type)

Approvals



Technical specifications

| | |
|--|--|
| Maximum continuous operating voltage: | 250VAC, 50/60Hz |
| Operating frequency: | 50 to 400Hz |
| Rated currents: | 1 to 10A @ 40°C max. |
| High potential test voltage: | P → PE 2000VAC for 2 sec P → N 760VAC for 2 sec |
| Protection category: | IP40 according to IEC 60529 |
| Temperature range (operation and storage): | -25°C to +85°C (25/85/21) |
| Design corresponding to: | UL 1283, CSA 22.2 No. 8 1986, IEC/EN 60939 |
| Flammability corresponding to: | UL 94V-2 or better |
| MTBF @ 40°C/230V (Mil-HB-217F): | 2,200,000 hours |
| Voltage selector description: | |
| Function: | Series/parallel |
| Voltage marking: | |
| Series: | 110-120V |
| Parallel: | 220-240V |
| Rocker switch description: | |
| Function: | 2-pole, dark not illuminated Marking I - 0 |
| Electrical specifications: | |
| | Inrush current 51A |
| | 6,000 on-off operations according to UL 1054, TV 5 |
| | 10,000 on-off operations according to ENEC |
| Mechanical life: | |
| | 50,000 cycles |
| Switch ratings: | |
| USA (UL) and Canada (C-UL): | 10A, 125VAC; 10A, 250VAC; 1/3HP |
| Europe (ENEC): | 10A (4A), 250VAC* |

* Value in () relates to the inductive current charge: $\cos \gamma = 0.65$

The FN 390 power entry module combines an IEC inlet, mains filter with single or dual-fuse holder, voltage selector and 2-pole rocker switch. Choosing FN 390 product line brings you the rapid availability of a standard filter associated with the necessary safety acceptances. Standard IEC connector filters are a practical solution helping you to pass EMI system approval in a short time. Multiple options designed to offer you the desired solution.

Features and benefits

- High conducted attenuation performance, based on chokes with high saturation resistance and excellent thermal behavior.
- Rear or front mounting.
- Single or dual-fuse holder.
- USA Ø6.3 x 32mm or EU Ø5 x 20mm fuses.
- 2-pole rocker switch.
- Voltage selector 110-120V / 220-240V.
- Custom-specific versions are available on request.

Typical electrical schematic

Standard types

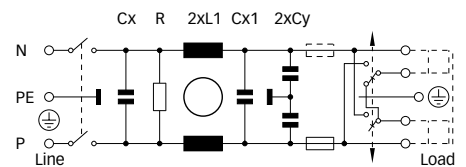

E types

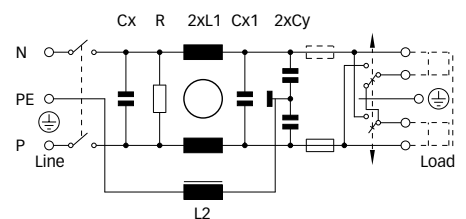

Typical applications

- Portable electrical and electronic equipment
- Consumer goods
- EDP and office equipment
- Single-phase power supplies, switch-mode power supplies
- Test and measurement equipment

Filter selection table

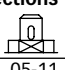
| Filter | Rated current @ 40°C (25°C) [A] | Leakage current* @ 230VAC/50Hz [µA] | Inductance | | Cx [nF] | Capacitance | | Resistance R [kΩ] | Output connections  | Fuses** [Qty] | Weight [g] |
|-------------------|---------------------------------------|---|------------|------------|------------|-------------|------------|-------------------------|--|------------------|---------------|
| | | | L1 [mH] | L2 [mH] | | Cx1 [nF] | Cy [nF] | | | | |
| FN 393-1-05-11 | 1 (1.2) | 560 | 7.5 | | 220 | 3.3 | 1000 | 05-11 | 1 | 200 | |
| FN 393-2.5-05-11 | 2.5 (3) | 560 | 2 | | 220 | 3.3 | 1000 | 05-11 | 1 | 200 | |
| FN 393-6-05-11 | 6 (7.2) | 560 | 0.45 | | 220 | 3.3 | 1000 | 05-11 | 1 | 200 | |
| FN 394-1-05-11 | 1 (1.2) | 560 | 7.5 | | 220 | 3.3 | 1000 | 05-11 | 2 | 200 | |
| FN 394-2.5-05-11 | 2.5 (3) | 560 | 2 | | 220 | 3.3 | 1000 | 05-11 | 2 | 200 | |
| FN 394-6-05-11 | 6 (7.2) | 560 | 0.45 | | 220 | 3.3 | 1000 | 05-11 | 2 | 200 | |
| FN 393E-1-05-11 | 1 (1.2) | 560 | 7.5 | 0.4 | 220 | 3.3 | 1000 | 05-11 | 1 | 205 | |
| FN 393E-2.5-05-11 | 2.5 (3) | 560 | 2 | 0.4 | 220 | 3.3 | 1000 | 05-11 | 1 | 205 | |
| FN 393E-6-05-11 | 6 (7.2) | 560 | 0.45 | 0.4 | 220 | 3.3 | 1000 | 05-11 | 1 | 205 | |
| FN 394E-1-05-11 | 1 (1.2) | 560 | 7.5 | 0.4 | 220 | 3.3 | 1000 | 05-11 | 2 | 205 | |
| FN 394E-2.5-05-11 | 2.5 (3) | 560 | 2 | 0.4 | 220 | 3.3 | 1000 | 05-11 | 2 | 205 | |
| FN 394E-6-05-11 | 6 (7.2) | 560 | 0.45 | 0.4 | 220 | 3.3 | 1000 | 05-11 | 2 | 205 | |
| FN 1393-1-05-11 | 1 (1.2) | 797 | 16 | | 220 | 100 | 4.7 | 470 | 05-11 | 1 | 210 |
| FN 1393-2.5-05-11 | 2.5 (3) | 797 | 8 | | 220 | 100 | 4.7 | 470 | 05-11 | 1 | 210 |
| FN 1393-6-05-11 | 6 (7.2) | 797 | 2.5 | | 220 | 100 | 4.7 | 470 | 05-11 | 1 | 210 |
| FN 1393-10-05-11 | 10 (12) | 797 | 0.6 | | 220 | 100 | 4.7 | 470 | 05-11 | 1 | 210 |
| FN 1394-1-05-11 | 1 (1.2) | 797 | 16 | | 220 | 100 | 4.7 | 470 | 05-11 | 2 | 210 |
| FN 1394-2.5-05-11 | 2.5 (3) | 797 | 8 | | 220 | 100 | 4.7 | 470 | 05-11 | 2 | 210 |
| FN 1394-6-05-11 | 6 (7.2) | 797 | 2.5 | | 220 | 100 | 4.7 | 470 | 05-11 | 2 | 210 |
| FN 1394-10-05-11 | 10 (12) | 797 | 0.6 | | 220 | 100 | 4.7 | 470 | 05-11 | 2 | 210 |

* Maximum leakage under normal operating conditions. Note: if the neutral line is interrupted, worst case leakage could reach twice this level.

** Filters are delivered without fuse.

Note: for medical versions please contact your local partner within Schaffner's global network.

Product selector

FN (1)39xx-y-zz

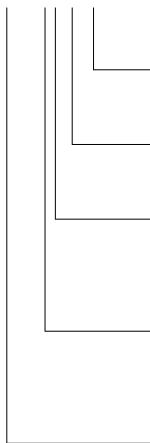

05-11: Faston 6.3 x 0.8mm

1 to 10: Rated current

Blank: Standard version

E: Optional earth line choke

3: 1 fuse (Ø5 x 20mm or Ø6.3 x 32mm)

4: 2 fuses (Ø5 x 20mm or Ø6.3 x 32mm)

Blank: Standard version

1: Additional Cx1 capacitor and higher inductivity

For example: FN 393-1-05-11, FN 394E-2.5-05-11, FN 1394-10-05-11

Typical filter attenuation

Per CISPR 17; A = 50Ω/50Ω sym; B = 50Ω/50Ω asym; C = 0.1Ω/100Ω sym; D = 100Ω/0.1Ω sym

FN 39x: 1A types

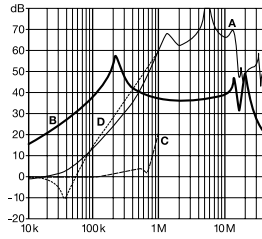

FN 39x: 2.5A types

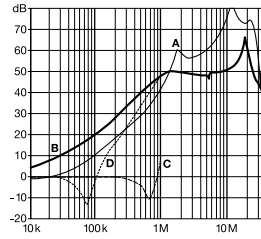

FN 39x: 6A types

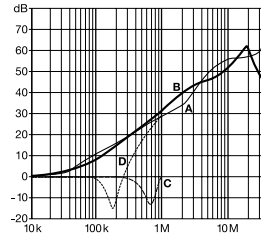

FN 139x: 1A types

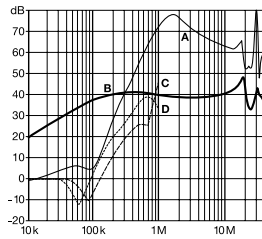

FN 139x: 2.5A types

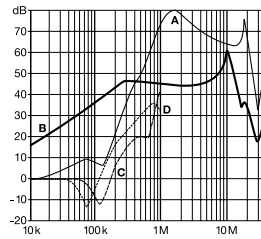

FN 139x: 6 and 10A types

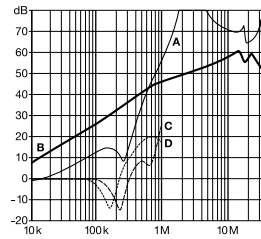

Mechanical data

1 to 10A types

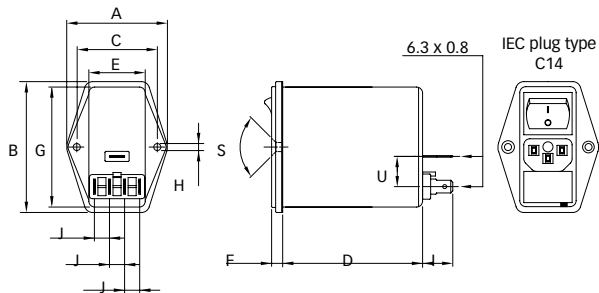

Panel cut out

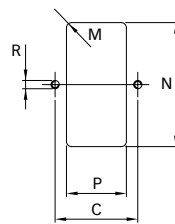

Dimensions

| | 1 to 10A | Tolerances |
|---|----------|------------|
| A | 50 | ±0.3 |
| B | 65 | ±0.3 |
| C | 40 | ±0.1 |
| D | 69.5 | ±0.3 |
| E | 28 | |
| F | 5.5 | ±0.3 |
| G | 59.6 | |
| H | Ø3.3 | |
| I | 15 | |
| J | 7.5 | |
| M | R ≤ 2.5 | |
| N | 60.03 | ±0.2 |
| P | 29.03 | ±0.2 |
| R | M3 | |
| S | 90° | |
| U | 15 | |

All dimensions in mm; 1 inch = 25.4mm
Tolerances according: ISO 2768-m / EN 22768-m

**Headquarters and
global innovation and
development center**

Schaffner Group
Nordstrasse 11
4542 Luterbach
Switzerland
T +41 32 681 66 26
F +41 32 681 66 30
info@schaffner.ch
www.schaffner.com

Sales and application centers

China
Schaffner EMC Ltd. Shanghai
Building 11, Lane 1365
East Kangqiao Road
Shanghai 201319
T +86 21 6813 9855
F +86 21 6813 9811
cschina@schaffner.com
www.schaffner.com

Germany
Schaffner Deutschland GmbH
Schoemperlenstrasse 12B
76185 Karlsruhe
T +49 721 56910
F +49 721 569110
germanysales@schaffner.com

Finland
Schaffner Oy
Tynninkuja 7
08700 Lohja
T +358 19 35 72 71
F +358 19 32 66 10
finlandsales@schaffner.com

France
Schaffner EMC S.A.S.
112, Quai de Bezons
95103 Argenteuil
T +33 1 34 34 30 60
F +33 1 39 47 02 28
francesales@schaffner.com

Italy
Schaffner EMC S.r.l.
Via Galileo Galilei, 47
20092 Cinisello Balsamo (MI)
T +39 02 66 04 30 45/47
F +39 02 61 23 943
italysales@schaffner.com

Japan
Schaffner EMC K.K.
Mitsui-Seimei Sangenjaya Bldg. 7F
1-32-12, Kamiyama, Setagaya-ku
Tokyo 154-0011
T +81 3 5712 3650
F +81 3 5712 3651
japansales@schaffner.com
www.schaffner.jp

Sweden
Schaffner EMC AB
Turebergstorg 1, 6
19147 Sollentuna
T +46 8 5792 1121/22
F +46 8 92 96 90
swedensales@schaffner.com

Switzerland
Schaffner EMV AG
Nordstrasse 11
4542 Luterbach
T +41 32 681 66 26
F +41 32 681 66 41
sales@schaffner.ch

Singapore
Schaffner EMC Pte Ltd.
Blk 3015A Ubi Road 1
05-09 Kampong Ubi Industrial
Estate
T +65 6377 3283
F +65 6377 3281
singaporesales@schaffner.com

Spain
Schaffner EMC España
Calle Caléndula 93,
Miniparc III, Edificio E
El Soto de la Moraleja,
Alcobendas
28109 Madrid
T +34 618 176 133
spainsales@schaffner.com

Taiwan
Schaffner EMV Ltd.
6th Floor, No 413
Rui Guang Road
Neihu District
Taipei City 114
T +886 2 87525050
F +886 2 87518086
taiwansales@schaffner.com

Thailand
Schaffner EMC Co. Ltd.
Northern Region Industrial Estate
67 Moo 4 Tambon Ban Klang
Amphur Muang P.O. Box 14
Lamphun 51000
T +66 53 58 11 04
F +66 53 58 10 19
thailandsales@schaffner.com

UK
Schaffner Ltd.
5 Ashville Way
Molly Millars Lane
Wokingham
Berkshire RG41 2PL
T +44 118 9770070
F +44 118 9792969
uksales@schaffner.com
www.schaffner.uk.com

USA
Schaffner EMC Inc.
52 Mayfield Avenue
Edison, New Jersey 08837
T +1 732 225 9533
F +1 732 225 4789
usasales@schaffner.com
www.schaffner.com/us

To find your local partner within
Schaffner's global network, please go to

www.schaffner.com

May 2011

© 2011 Schaffner EMC.
Specifications subject to change without
notice. All trademarks recognized.

Schaffner is an ISO-registered company.
Its products are designed and manufac-
tured under the strict quality and environ-
mental requirements of the ISO 9001 and
ISO 14001 standards.

This document has been carefully
checked. However, Schaffner does not
assume any liability for errors or inac-
curacies.

Mouser Electronics

Authorized Distributor

Click to View Pricing, Inventory, Delivery & Lifecycle Information:

Schaffner:

[FN394-6-05-11](#) [FN1394-6-05-11](#) [FN1393-6-05-11](#) [FN1393-10-05-11](#) [FN1394-10-05-11](#) [FN393-2.5-05-11](#) [FN393-1-05-11](#) [FN393-6-05-11](#) [FN1393-2.5-05-11](#) [FN394-1-05-11](#) [FN394-2.5-05-11](#) [FN394E-1-05-11](#) [FN394E-2.5-05-11](#)
[FN394E-6-05-11](#)



Компания «ЭлектроПласт» предлагает заключение долгосрочных отношений при поставках импортных электронных компонентов на взаимовыгодных условиях!

Наши преимущества:

- Оперативные поставки широкого спектра электронных компонентов отечественного и импортного производства напрямую от производителей и с крупнейших мировых складов;
- Поставка более 17-ти миллионов наименований электронных компонентов;
- Поставка сложных, дефицитных, либо снятых с производства позиций;
- Оперативные сроки поставки под заказ (от 5 рабочих дней);
- Экспресс доставка в любую точку России;
- Техническая поддержка проекта, помощь в подборе аналогов, поставка прототипов;
- Система менеджмента качества сертифицирована по Международному стандарту ISO 9001;
- Лицензия ФСБ на осуществление работ с использованием сведений, составляющих государственную тайну;
- Поставка специализированных компонентов (Xilinx, Altera, Analog Devices, Intersil, Interpoint, Microsemi, Aeroflex, Peregrine, Syfer, Eurofarad, Texas Instrument, Miteq, Cobham, E2V, MA-COM, Hittite, Mini-Circuits, General Dynamics и др.);

Помимо этого, одним из направлений компании «ЭлектроПласт» является направление «Источники питания». Мы предлагаем Вам помощь Конструкторского отдела:

- Подбор оптимального решения, техническое обоснование при выборе компонента;
- Подбор аналогов;
- Консультации по применению компонента;
- Поставка образцов и прототипов;
- Техническая поддержка проекта;
- Защита от снятия компонента с производства.



Как с нами связаться

Телефон: 8 (812) 309 58 32 (многоканальный)

Факс: 8 (812) 320-02-42

Электронная почта: org@eplast1.ru

Адрес: 198099, г. Санкт-Петербург, ул. Калинина, дом 2, корпус 4, литера А.